



HIGH-EFFICIENCY HEAT ONLY/  
COMBINATION BOILER  
Water | Natural/Propane Gas | 80-155 MBH  
Direct Vent | Efficiency 92.2-94.4%

## SUBMITTAL SHEET

JOB NAME \_\_\_\_\_

LOCATION \_\_\_\_\_

ARCH. / ENGR. \_\_\_\_\_

WHOLESALE \_\_\_\_\_

MECH. CONTRACTOR \_\_\_\_\_

MODEL NO. \_\_\_\_\_ GAS TYPE \_\_\_\_\_

BTU/HR INPUT \_\_\_\_\_ BTU/HR OUTPUT \_\_\_\_\_

### STANDARD EQUIPMENT

#### Features/Standard Equipment

- 92.2-94.4% annual fuel utilization efficiency (AFUE) - low fuel usage, saves energy
- Natural or Propane (LP) gas operation - factory shipped as NG, optional LP conversion kit
- Compact design - increases placement options
- Heavy gauge insulated jacket - provides quiet operation
- 10-to-1 turn down ratio - precisely matches energy usage to the immediate system need
- Low NOx rated - low emissions level achieved South Coast certification
- Single tube, large diameter, ASME certified 316L Stainless Steel heat exchanger
- Pre-wired, plug-in ready electrical design
- Contractor friendly removable sides - makes service clean and easy
- Wall mounting bracket and hardware

- Honeywell® boiler control with digital display
- Commercial grade 120V power cord with 3 prong plug
- Unique 3-in-1 vent adapter - approved to accept PVC, CPVC, SS or PP vent materials
- Multiple vent options - direct vent with 2 pipes or concentric, through sidewall or roof
- Internal condensate trap
- 24VAC thermostat relay
- Water treatment - inhibitor and test kit
- Factory tested

#### Combi Features Only

- Internal 3-speed circulator
- DHW flat plate heat exchanger

#### Optional Equipment

- Propane conversion kit
- Concentric vent kit
- Condensate neutralizer

## SUBMITTAL SHEET

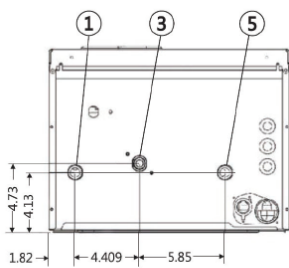

**Heating Only Bottom (80/120)**

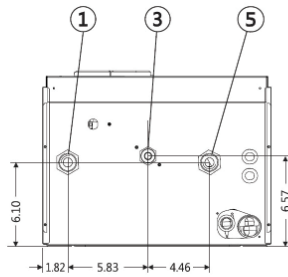

**Heating Only Bottom (155)**

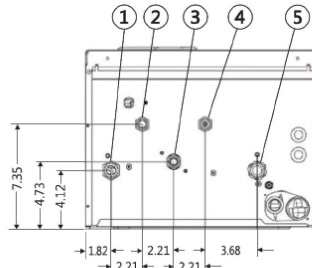

**Combi Bottom (80/120)**

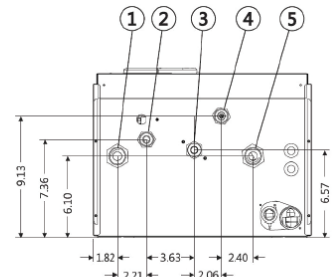

**Combi Bottom (155)**



**Front (80/120/155)**

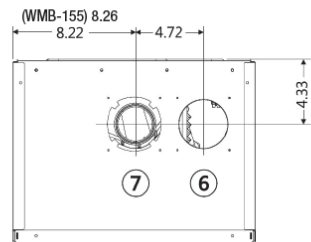

**Top (80/120/155)**

Connections (NPT/Inches)			
		80/120	155
1	Heating system supply tapping	3/4"	1"
2	Domestic hot water outlet	3/4"	3/4"
3	Gas connection	1/2"	1/2"
4	Domestic cold water supply	3/4"	3/4"
5	Heating system return tapping	3/4"	1"
6	Combustion air connection	3"	3"
7	Flue outlet connection	3"	3"

Domestic Hot Water Flow Rate (Based on 70° temperature rise)	
Model <sup>1</sup>	Gallons per minute
<b>WMB-80C</b>	2.0
<b>WMB-120C</b>	3.2
<b>WMB-155C</b>	4.0

	Model <sup>1</sup>	Input MBH		AHRI Certified Ratings			Vent/air pipe size (Inches) <sup>4</sup>	Vent material	Boiler water content (Gallons)	Approx. shipping weight (Lbs.)
		Max.	Min.	DOE heating capacity MBH <sup>2</sup>	Seasonal efficiency AFUE %	Net water rating MBH <sup>3</sup>				
<b>HEAT ONLY</b>	<b>WMB-80</b>	80	8	73	92.4	63	2 or 3	PVC, CPVC, PP, SS	.45	61
	<b>WMB-120</b>	120	12	109	92.2	95	2 or 3	PVC, CPVC, PP, SS	.55	64
	<b>WMB-155</b>	155	15.5	143	94.4	124	3	PVC, CPVC, PP, SS	.65	67
<b>COMBI</b>	<b>WMB-80C</b>	80	8	73	92.4	63	2 or 3	PVC, CPVC, PP, SS	.53	70
	<b>WMB-120C</b>	120	12	109	92.2	95	2 or 3	PVC, CPVC, PP, SS	.63	77
	<b>WMB-155C</b>	155	15.5	143	94.4	124	3	PVC, CPVC, PP, SS	.75	87

<sup>1</sup>Natural gas field convertible to LP with optional kit.

<sup>2</sup>Based on standard test procedures prescribed by the United States Department of Energy. MBH refers to thousands of Btu per hour.

<sup>3</sup>Net AHRI ratings are based on net installed radiation of sufficient quantity for the

requirement of the building and nothing needs to be added for normal piping and pick-up. Ratings are based on piping and pick-up allowance of 1.15. An additional allowance should be made for unusual piping and pick-up loads.

<sup>4</sup>Boilers must be vented directly to the outdoors. See boiler manuals for details.