

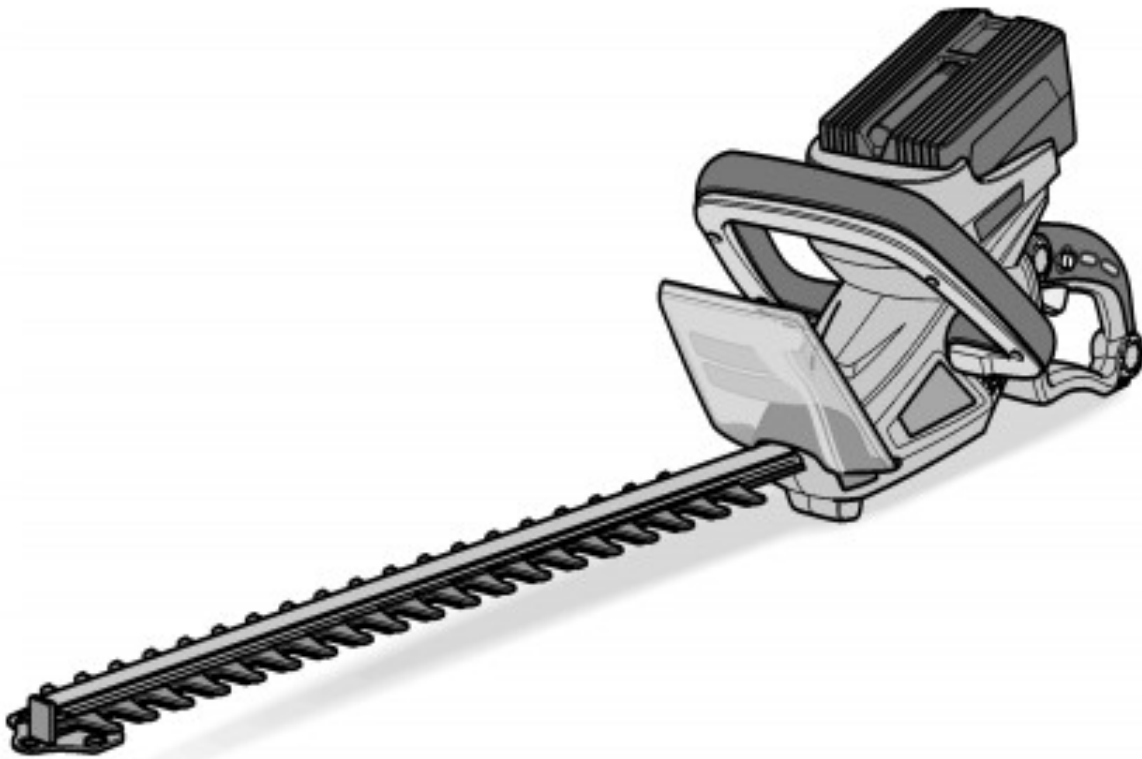

redback

120V Lithium Ion Cordless Hedge Trimmer



MODELS # 106489

Operation Manual



This safety alert symbol identifies important safety messages in this manual. Failure to follow this important safety information may result in serious injury or death.

Part # 106661 Rev A



For Service or Questions

Call 1-877-487-8275

720-287-5182

www.redbackpowerusa.com

Redback products are distributed by



FrictionlessWorld

1100 W 120th Ave, Suite 600
Westminster, CO 80234 • 720-287-5182

Table of Contents

Important Safety Information

Intended Use	4
Personal Protective Equipment	4
General Safety	5
Safety Icons	6
Attaching the Battery	7
Overview of Components	8
Operation	9
Maintenance	10
Storage	11
Warranty & Specifications	Back Cover



Important Safety Information



WARNING

WARNING: Read and thoroughly understand all instructions and safety information before assembling or operating the hedge trimmer. Failure to do so may cause serious injury or death. Do not allow anyone to operate this hedge trimmer who has not read this manual. As with all power equipment, a hedge trimmer can be dangerous if assembled or used improperly. Do not operate this hedge trimmer if you have doubts or questions concerning safe operation.

Call our customer service department at **720-287-5182**, **1-877-487-8275**, or visit **www.redbackpowerusa.com** if you have any questions or concerns about the safe operation of this equipment.



DANGER

Intended Use

The hedge trimmer has been designed for cutting and trimming hedges and bushes which have a maximum branch thickness of 22 mm (55/64") and it is not suitable for work above shoulder height. Do not use the hedge trimmer for any purpose other than for which it was designed. Any other use is unauthorized and may result in serious injury or death.

Personal Protective Equipment

When operating this hedge trimmer it is essential that you wear safety gear including goggles or safety glasses, steel-toed shoes and tight fitting gloves (no loose cuffs or draw strings). Always wear ear plugs or sound deafening headphones to protect against hearing loss when operating this mower. Always wear sturdy footwear. Never wear sandals, sneakers or open shoes, and never operate the hedge trimmer with bare feet. Do not wear loose clothing that might get caught in moving parts.



Important Safety Information

General Safety

Failure to follow warnings, cautions, assembly and operation instructions in the Operation Manual may result in serious injury or death.



DANGER

READ THE OPERATION MANUAL BEFORE OPERATION.

- **Do not** permit children to operate this equipment at any time.
- **Do not** permit others that have not read and understood the complete Operation Manual to operate this equipment.
- Observe the area of operation and ensure there are no obstacles in the hedge trimmer's path.
- **Do not** operate the hedge trimmer when under the influence of alcohol, drugs or medication.
- **Do not** allow a person who is tired or otherwise impaired or not completely alert to operate the hedge trimmer.



DANGER

- Do not operate the hedge trimmer in rain or other wet conditions. Protect the hedge trimmer from rain.
- Keep hands, feet, hair and clothing away from the hedge trimmer.
- The battery should be removed before attempting to remove clippings from the blades, or before making any repairs.
- Carry the hedge trimmer by the handle only. Blades are sharp!

Battery tool use and care

- Recharge only with the charger specified by the manufacturer. A charger that is suitable for one type of battery pack may create a risk of fire when used with another battery pack.
- Use power tools only with specifically designated battery packs. Use of any other battery packs may create a risk of injury and fire.
- When battery pack is not in use, keep it away from other metal objects, like paper clips, coins, keys, nails, screws or other small metal objects, that can make a connection from one terminal to another. Shorting the battery terminals may cause burns or a fire.
- Under certain conditions, liquid may be ejected from the battery; avoid contact. If contact accidentally occurs, flush with water. If liquid contacts eyes, additionally seek medical help. Liquid ejected from the battery may cause irritation or burns.
- **DO NOT USE BATTERIES WITH DAMAGED CASES.** Dispose of batteries properly. Do not dispose of batteries in household waste.



redback

Important Safety Information

Safety Icons

Safety icons are to remind you of important information while you are operating the unit.



Use caution when operating this power equipment



A hedge trimmer can eject objects at high speeds. Use caution when operating around other people and pets.



Use caution when handling, dangerous pinch points!



Use caution around rotating parts!
Do not touch the blades during operation.



Read and understand the Operation Manual before operating the hedge trimmer.

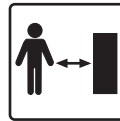

A hedge trimmer can eject objects at high speeds. Use caution when operating near walls, fences, wires and other obstacles.



Wear goggles or other eye protection. The hedge trimmer can propel objects and dust.



Avoid operating in the rain, protect the battery and hedge trimmer from wet conditions.

Safety Decals

Safety decals on the hedge trimmer are to remind you of important information while you are operating the unit. Make sure all decals are attached and in readable condition. Replace missing or defaced decals. Contact Redback USA at 1-877-487-8275 for replacement decals.



Attaching the Battery

Before operating the hedge trimmer, fully charge the battery.

Inserting/Replacing the Battery

Charge the battery as described in the charger operation manual. Press the charged battery into the power tool until it clicks into place (see Figure 1).

To remove the battery, press the release button **1** and pull out the battery **2** (see Figure 2).

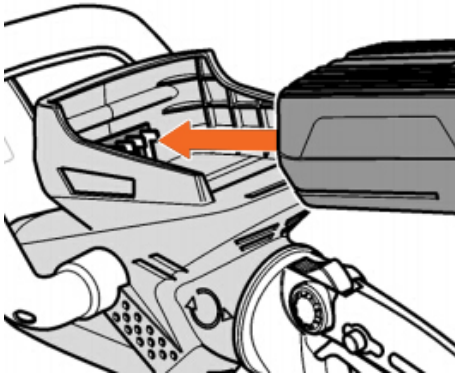

Figure 1

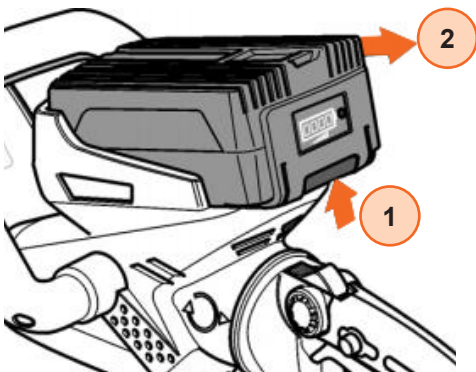

Figure 2



CAUTION

**Protect the battery contacts when the battery is not being used.
Metal objects may short-circuit the contacts and pose
both an explosion and fire hazard!**



redback

Overview of Components

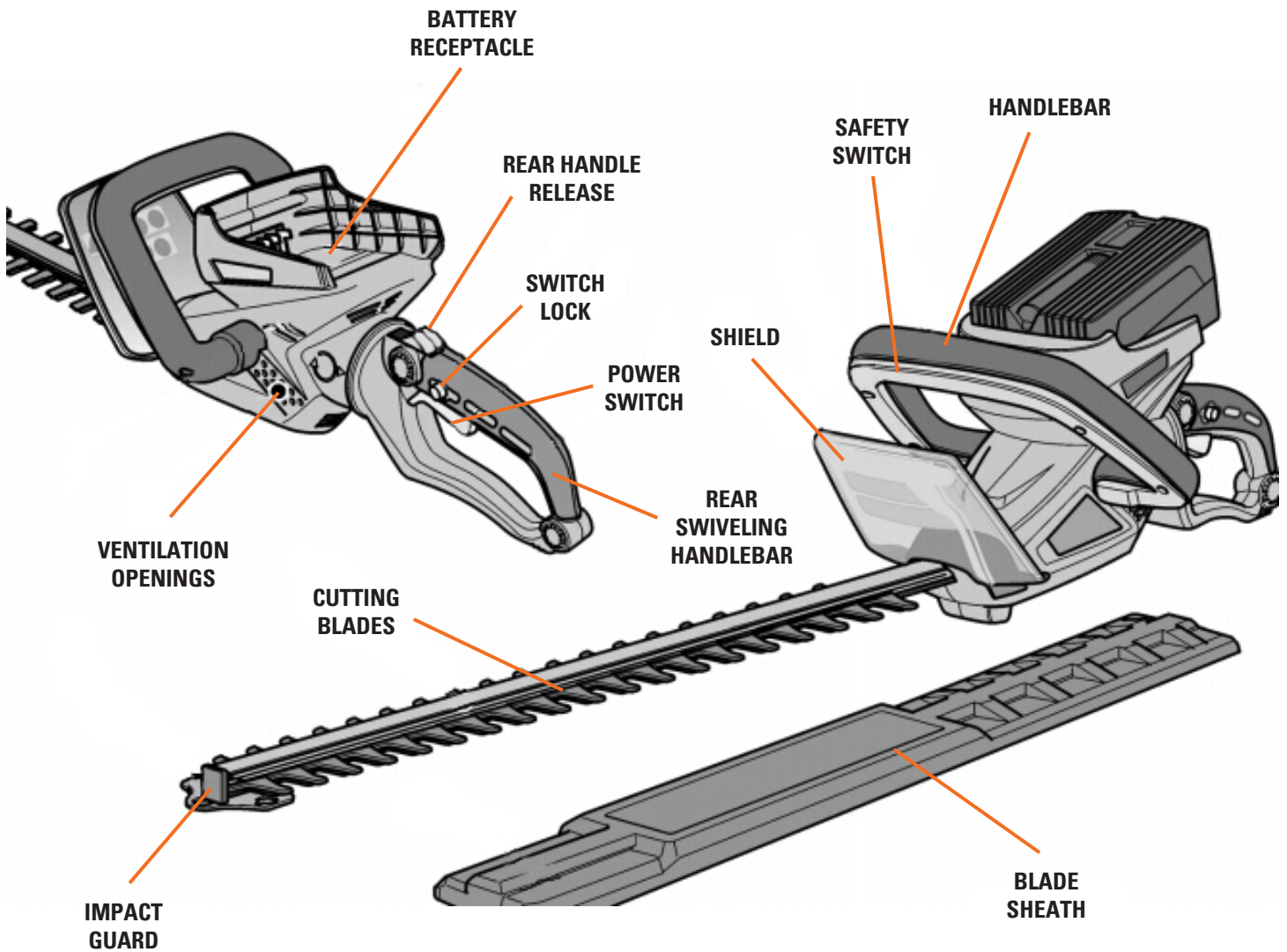

Operation

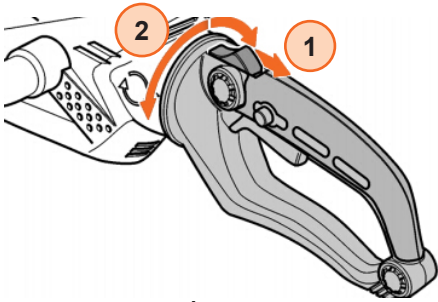

Figure 3

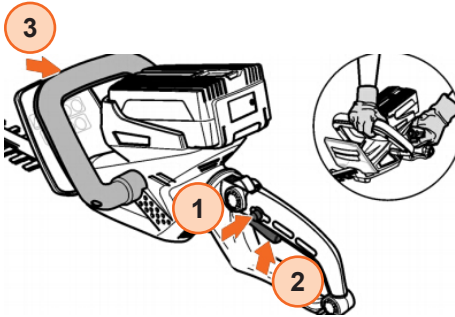

Figure 4

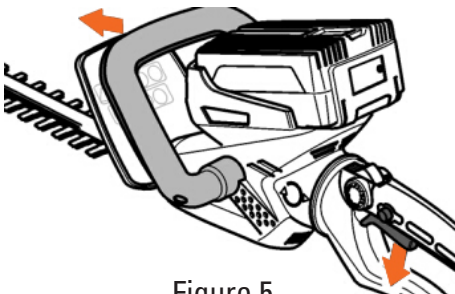

Figure 5

Adjusting the Rear Handle

Depending on the planned use the rear handle can be rotated from the middle position by 90° in either direction (see Figure 3). Press the release button downwards ① and simultaneously rotate the rear handle to the left or right ② until it clicks.

NOTE: The hedge trimmer will not turn on when the rear handle is not securely engaged in the respective end position.

Powering the Hedge Trimmer

The hedge trimmer is switched on and operated with both hands. One hand operates the switch on the rear handle, the second hand the safety switch on the handlebar. If you release one of the two switches, the cutter bar automatically stops.

Switching on

Hold the hedge trimmer firmly with both hands (see Figure 4). Press and hold down the switch interlock ①. Press the switch ② and the safety switch ③. The hedge trimmer runs.

Switching off

Release one of the two switches (see Figure 5). The cutter bar stops immediately. Wait until all rotating parts have stopped. Place the blade sheath on the cutter bar.

Hedge Trimming

Always cut at full engine speed. The impact guard protects against the recoil torque of the cutter when striking a solid object. Cut the upper edges of the hedge slightly round. Cut in several stages if heavy trimming is required.

If cutting hedges over a prolonged period, interrupt your work frequently and oil the cutting bar.

Switch the engine off and remove the battery to remove jammed clippings from the cutting blades.

The hedge trimmer can be guided with its double-sided cutters forwards and backwards or in an oscillating movement from one side to the other. Cut the sides of the hedge first and then the top. When cutting sideways, rotate the rear handlebar sideways.

When cutting down low, hold the handlebar above. Cut the hedge from bottom to top. Hold the hedge trimmer at an angle of 5–10° to the hedge to ensure a straight cut.



Maintenance



CAUTION

Before performing any maintenance on the hedge trimmer, remove the battery and wear protective gloves.

Cleaning the Hedge Trimmer

Remove the battery. Do not use water or liquid detergents. Whenever possible, always clean the unit directly after using with a hand brush.

Keep the ventilation slots clean and dust-free.

After each use, clean the hedge trimmer using a dry cloth or a brush if the unit is very dirty. Never spray the hedge trimmer with water.

Clean the cutting blades after each use. Spray or wipe the cutting blades with a light machine oil to ensure that the hedge trimmer has a long service life.

Repairs

Check the unit for damage. Repairs may be carried out by an authorized customer service center only.



Storage

Storage

Remove the battery from the hedge trimmer before storing. Store the hedge trimmer in a dry, dust-free and frost-free place ideally in a temperature range of 50° - 77°F (10-25 °C).

Store the battery and the unit separately.

Place the blade sheath over the trimmer blades for protection.

Charge the battery before storing the unit in winter.

Keep the unit, in particular its plastic components, away from brake fluids, petrol, petroleum products, penetrating oil, etc. They contain chemical substances which may damage, attack or destroy the plastic components of the unit.

Remove the battery from the hedge trimmer when not in use.



Disposal Information

Recycle raw materials instead of disposing as waste.

Battery, accessories and packaging should be recycled in an environmentally friendly manner. Plastic parts are identified for recycling according to material type.



CAUTION

Do not use batteries with damaged casing.

Do not attempt to open batteries.

Do not dispose of in fire, water or household waste.



redback

Warranty & Specifications

IMPORTANT NOTICE

We, the manufacturer, reserve the right to change the product and/or specifications in this manual without notification. The manual is for information usage only and the pictures and drawings depicted herein are for reference only.

Warranty Repair and Service

Do not return this product to the store for warranty issues or repair. Call our customer service department at **720-287-5182**, **1-877-487-8275**, or visit **www.redbackpowerusa.com** for the location of the nearest service center.

Record the information below for future reference.

Model No. _____

Serial No. _____

Date of Purchase _____

Place of Purchase _____

SKU/Part No.	106489
Description	120V Lithium Ion Cordless Hedge Trimmer
Rated Voltage	120 Volts DC
Stroke Rate	1500/minute (no load)
Blade Length	24 Inches (610mm)
Cutting Thickness	55/64" (22mm)
Sound Rating	88.4 dB (A)
Shipping Weight	8.36 Lbs. (w/o battery)
Battery	2.0Ah (included)
Battery Charger	1.5A Charger (included)
Run Time	Up to 75 minutes/charge
Warranty	5-Year Limited Warranty, 1-Year on Battery



Redback products are distributed by



FrictionlessWorld

1100 W 120th Ave., Suite 600
Westminster, CO 80234 • 720-287-5182

For Service or Questions

Call 1-877-487-8275

720-287-5182

www.redbackpowerusa.com