

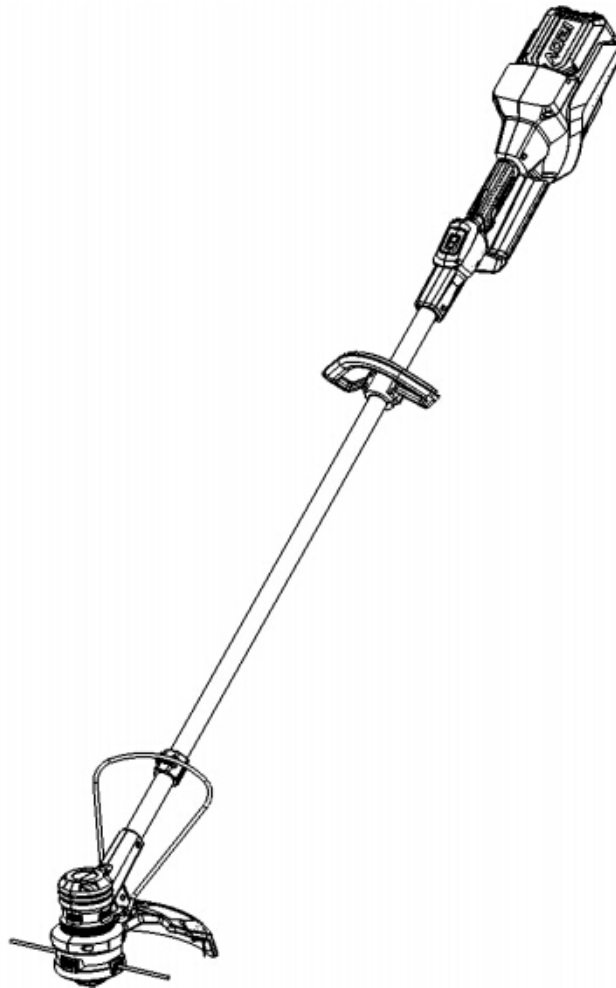

redback

120V Lithium Ion Cordless Line Trimmer



MODEL # 106487

Operation Manual



This safety alert symbol identifies important safety messages in this manual. Failure to follow this important safety information may result in serious injury or death.

Part # 106659 Rev D



For Service or Questions

Call 1-877-487-8275

720-287-5182

www.redbackpowerusa.com

Redback products are distributed by



FrictionlessWorld

1100 W 120th Ave, Suite 600
Westminster, CO 80234 • 720-287-5182

Table of Contents

| | |
|--|------------|
| Important Safety Information | |
| Intended Use | 4 |
| Personal Protective Equipment | 4 |
| General Safety | 5 |
| Safety Decals | 6 |
| Auger Assembly | 7 |
| Overview of Components | 8 |
| Operation | 9 |
| Charging the Battery | 10 |
| Maintenance | 10 |
| Cleaning & Storage | 11 |
| Warranty & Specifications | Back Cover |



Important Safety Information



WARNING

WARNING: Read and thoroughly understand all instructions and safety information before assembling or operating the line trimmer. Failure to do so may cause serious injury or death. Do not allow anyone to operate this line trimmer who has not read this manual. As with all power equipment, a line trimmer can be dangerous if assembled or used improperly. Do not operate this line trimmer if you have doubts or questions concerning safe operation.

Call our customer service department at **720-287-5182**, **1-877-487-8275**, or visit **www.redbackpowerusa.com** if you have any questions or concerns about the safe operation of this equipment.



DANGER

Intended Use

Do not use the line trimmer for any purpose other than for which it was designed. Any other use is unauthorized and may result in serious injury or death.

Personal Protective Equipment

When operating this line trimmer it is essential that you wear safety gear including goggles or safety glasses, steel-toed shoes and tight fitting gloves (no loose cuffs or draw strings). Always wear ear plugs or sound deafening headphones to protect against hearing loss when operating this trimmer. Always wear sturdy footwear. Never wear sandals, sneakers or open shoes, and never operate the line trimmer with bare feet. Do not wear loose clothing that might get caught in moving parts.



Important Safety Information

General Safety

Failure to follow warnings, cautions, assembly and operation instructions in the Operation Manual may result in serious injury or death.



DANGER

READ THE OPERATION MANUAL BEFORE OPERATION.

- **Do not** permit children to operate this equipment at any time.
- **Do not** permit others that have not read and understood the complete Operation Manual to operate this equipment.
- The line trimmer can propel objects it strikes at high speeds. **Keep all people and pets a minimum of 10 feet away from the work area when operating the line trimmer.** It is recommended to wear heavy long pants during operation.
- **Do not** operate the line trimmer when under the influence of alcohol, drugs or medication.
- **Do not** allow a person who is tired, otherwise impaired or not completely alert to operate the line trimmer.



DANGER

- Do not operate the line trimmer in rain or other wet conditions. Protect the line trimmer from rain.
- Always keep hands, feet, hair and loose clothing away from the line trimmer.
- The battery should be removed before any repairs are attempted.

Battery tool use and care

- Recharge only with the charger specified by the manufacturer. A charger that is suitable for one type of battery pack may create a risk of fire when used with another battery pack.
- Use power tools only with specifically designated battery packs. Use of any other battery packs may create a risk of injury and fire.
- When battery pack is not in use, keep it away from other metal objects, like paper clips, coins, keys, nails, screws or other small metal objects, that can make a connection from one terminal to another. Shorting the battery terminals may cause burns or a fire.
- Under certain conditions, liquid may be ejected from the battery; avoid contact. If contact accidentally occurs, flush with water. If liquid contacts eyes, additionally seek medical help. Liquid ejected from the battery may cause irritation or burns.
- **DO NOT USE BATTERIES WITH DAMAGED CASES.** Dispose of batteries properly. Do not dispose of batteries in household waste.



redback

Important Safety Information

Safety Decals

Safety labels on the line trimmer are to remind you of important information while you are operating the unit. Make sure all safety warning decals are attached and in readable condition. Replace missing or defaced decals. Contact Redback USA at **1-877-487-8275** for replacement decals.



Line Trimmer Assembly

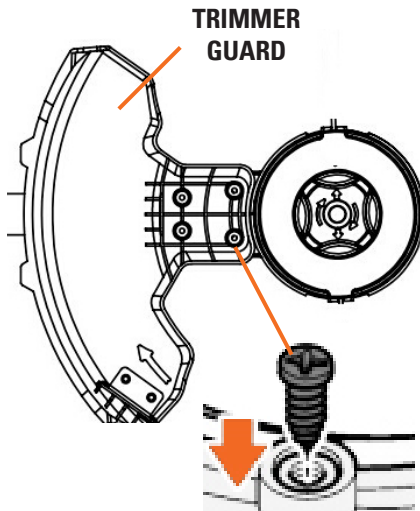

Figure 1

Installing the Trimmer Guard

The trimmer guard is an essential part of the line trimmer and must **ALWAYS** be used to prevent damage to the trimmer and injury to the operator. The guard is not attached to the trimmer when it is delivered to avoid damage in transit. To attach the guard, align the opening in the guard with the underside of the trimmer head (see Figure 1), and secure with four screws in four places.

Attaching the Plant Guard

Insert the plant guard into the holes of motor housing (see Figure 2).

Inserting/Replacing the Battery

Charge the battery as described in the charger operation manual. Attach the charged battery into the power tool by positioning, aligning and then sliding the battery into the power receptacle on the line trimmer until it clicks into place (see Figure 3).



CAUTION

**Protect the battery contacts when the battery is not being used.
Metal objects may short-circuit the contacts and pose
both an explosion and fire hazard!**

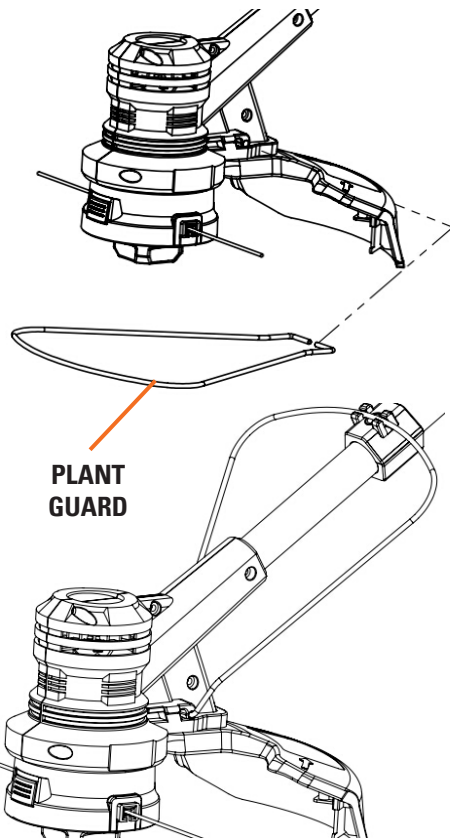
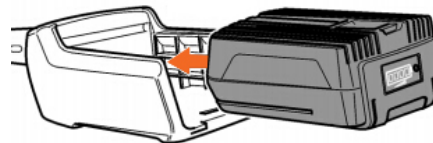

Figure 2



BATTERY
RELEASE

Figure 3



redback

Overview of Components

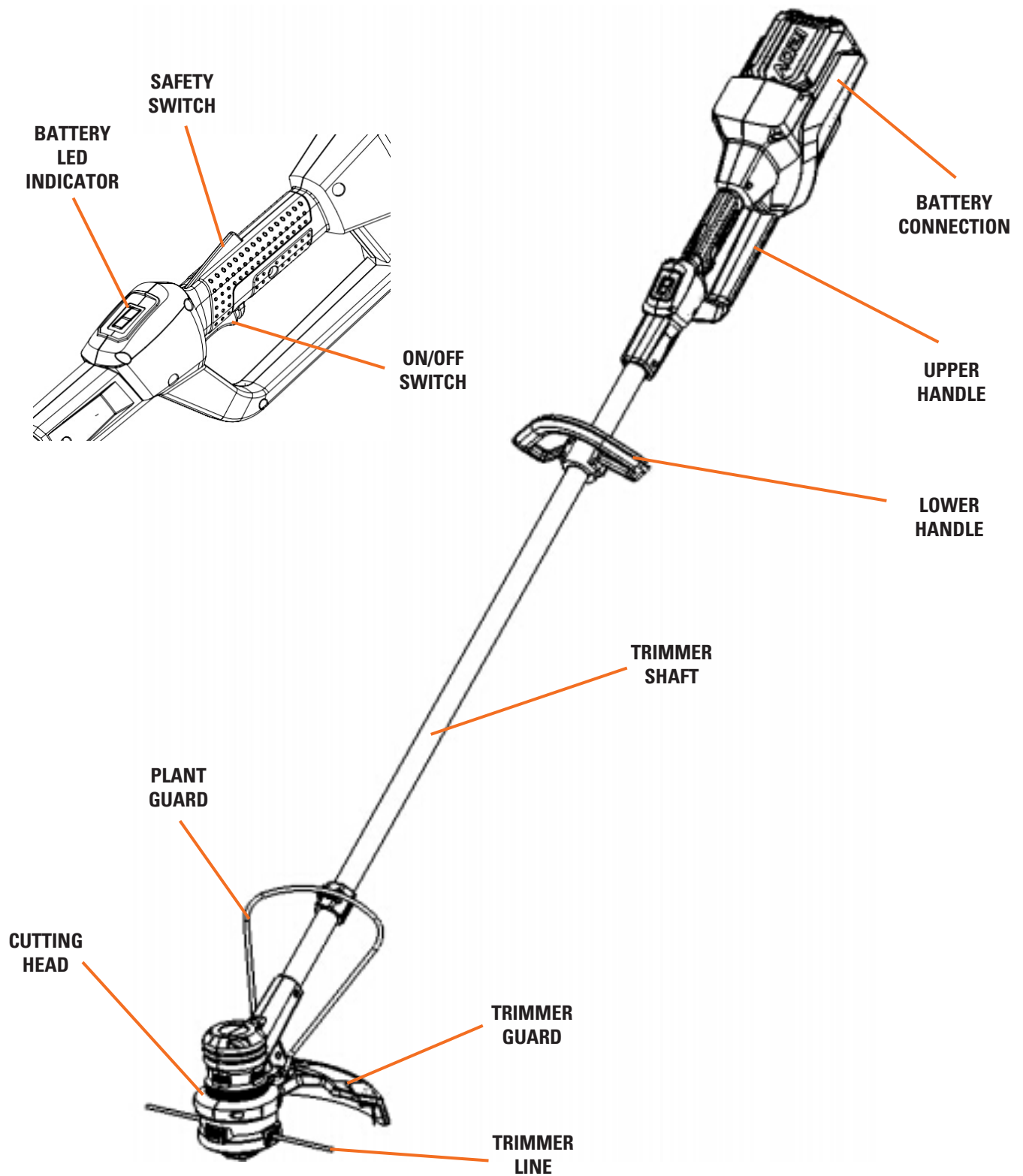

Operation

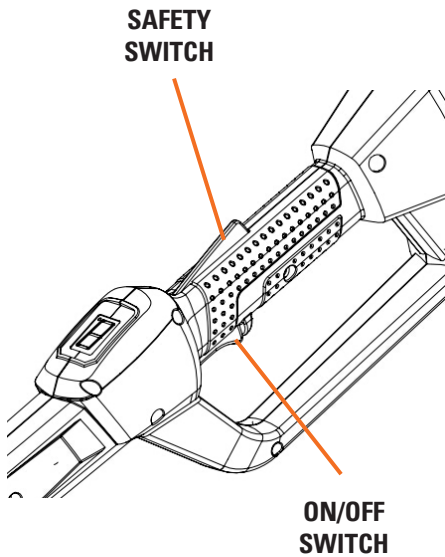

Figure 4

The line trimmer is ready to operate once the battery is installed. To operate press and hold the safety switch at the same time as the ON/OFF switch (see Figure 4).

Keep the cutting attachment parallel to the ground and make sweeping movements from side to side. Walk slowly forwards. Use only the tip of the line for cutting, especially along walls. If more than the tip is used for cutting, the cutting capacity is reduced and the motor may overload. Cut tall grass in two or more passes from the top down to prevent premature wear of the line and motor resistance. Cut dry grass and weeds only. The trim line may break by becoming entangled with foreign objects, with normal wear, by attempting to cut thick-stalked weeds, or by striking walls, garden fences, etc.

Automatic Line Release

You can release the cutting line without stopping the motor. To release more cutting line, gently tap the cutting head on the ground while running the line trimmer. The line blade in the guard cuts the line back to the correct length if too much cutting line is released. It is best to bounce the cutting head on bare ground or hard earth.

LED Battery Indicator

The battery state indicator shows the capacity of the battery. The indicator goes out after 5 seconds. If one of the LEDs flashes, the battery must be recharged. If none of the LEDs light up after the button is pressed, the battery is faulty and should be replaced.





CAUTION

Before performing any maintenance on the line trimmer, remove the battery.

Replacing Trimmer Line

Always use a cutting line with a diameter of 0.095" (2.4mm) max. If a thicker line is used, the motor may overheat or fail.

1. Insert the end of the cutting line into the retaining lug of the spool on one side (see Figure 5).
2. Insert the end of the cutting line into the retaining lug of the spool on the other side (see Figure 6).
3. Attach the joint snap into the spool housing (see Figure 7).
4. Place the spring over the post on the spool housing (see Figure 8).
5. Attach the spool to the retainer (see Figure 9).
6. Attach the cover to the spool housing (see Figure 10).
7. Turn the top of the spool clockwise while holding the spool housing to wind the cutting line on to the spool (see Figure 11).

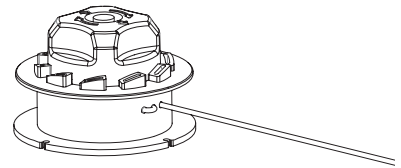

Figure 5

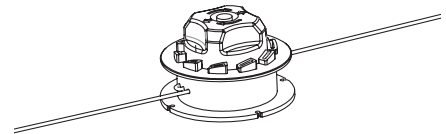

Figure 6

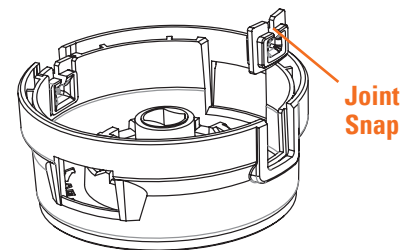

Figure 7

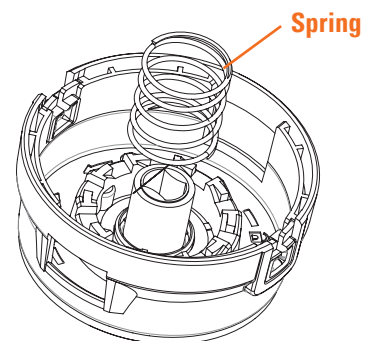

Figure 8

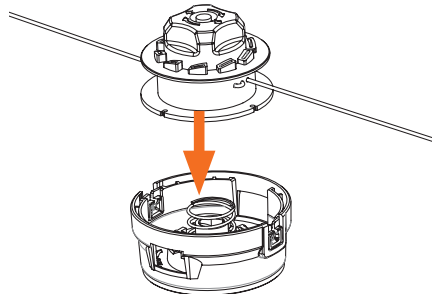

Figure 9

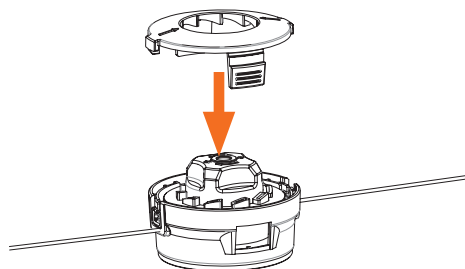

Figure 10

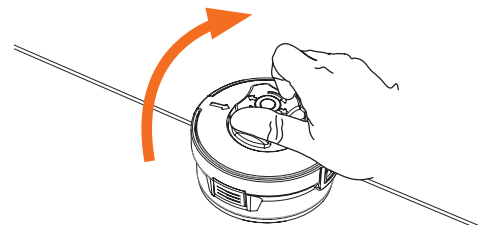

Figure 11



Cleaning & Storage

Cleaning

Do not use water or liquid detergents. Remove dirt and dust from the housing with a soft brush and dry cloth. Remove grass clippings from the underside of the trimmer. Keep the ventilation slots clean and free of dust.

Storage

Remove the battery from the line trimmer when not in use. Store the line trimmer in a dry, dust-free and frost-free place ideally in a temperature range of 50° - 77°F (10-25 °C). Store the battery and the unit separately. Charge the battery fully before storing the unit for a long period.

Keep the unit, in particular its plastic components, away from brake fluids, petrol, petroleum products, penetrating oil, etc. which contain chemical substances which may damage, attack or destroy the plastic components of the unit.



Warranty & Specifications

IMPORTANT NOTICE

We, the manufacturer, reserve the right to change the product and/or specifications in this manual without notification. The manual is for information usage only and the pictures and drawings depicted herein are for reference only.

Warranty Repair and Service

Do not return this product to the store for warranty issues or repair. Call our customer service department at **720-287-5182**, **1-877-487-8275**, or visit **www.redbackpowerusa.com** for the location of the nearest service center.

Record the information below for future reference.

Model No. _____

Serial No. _____

Date of Purchase _____

Place of Purchase _____

| SKU/Part No. | 106487 |
|-----------------------|--|
| Description | 120V Lithium Ion Cordless Line Trimmer |
| Rated Voltage | 120 Volts DC |
| Speed | 6000rpm (no load) |
| Cutting Diameter | 16 inches diameter |
| Cutting Line Diameter | 0.095 Inches (2.4mm) |
| Run Time | Up to 60 minutes |
| Shipping Weight | 11 Lbs. (w/o battery) |
| Batteries | 2.0Ah (included) |
| Battery Charger | 1.0A Charger (included) |
| Warranty | 5-Year Limited Warranty, 1-Year on Battery |



Redback products are distributed by



FrictionlessWorld

1100 W 120th Ave., Suite 600
Westminster, CO 80234 • 720-287-5182

For Service or Questions

Call 1-877-487-8275

720-287-5182

www.redbackpowerusa.com