

OWNERS MANUAL

**Model No.
45-04032-669**

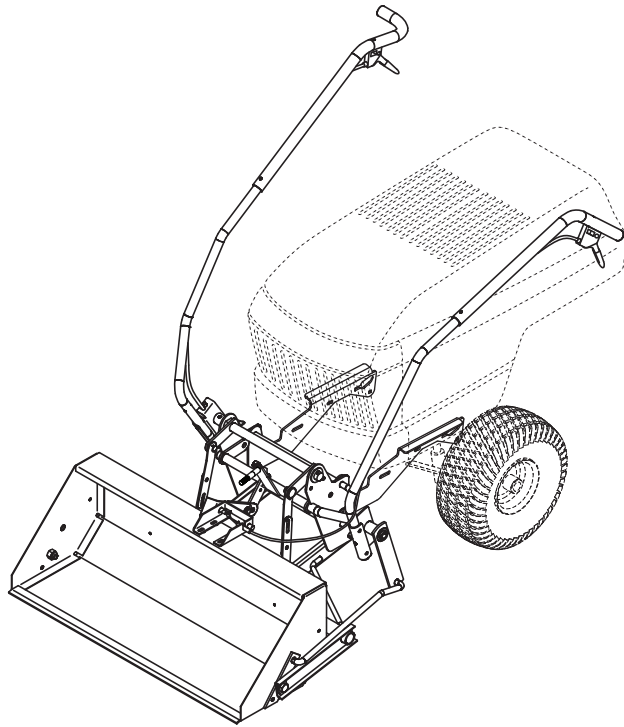

FRONT END SCOOP

CAUTION:
Read Rules for
Safe Operation
and Instructions
Carefully

- **Safety**
- **Assembly**
- **Operating**
- **Maintenance**
- **Repair Parts**

SAFETY RULES

Remember, any power equipment can cause injury if operated improperly or if the user does not understand how to operate the equipment. Exercise caution at all times when using power equipment.

- Read this operator's manual before attempting to assemble or operate the scoop attachment.
- Read the vehicle owner's manual and know how to operate your vehicle before using the scoop attachment.
- Never carry passengers in the scoop bucket. It has not been designed to carry passengers.
- Never allow children to operate the vehicle or the scoop attachment.
- Do not allow adults to operate the vehicle or scoop attachment without proper instructions.
- Always begin with the transmission in first (low) and gradually increase speed as conditions permit.
- Drive the tractor at reduced speed over rough terrain and hillsides or near creeks and ditches to prevent tipping over and loss of control. Do not drive too close to a creek or ditch.
- Never ram the scoop into material at high speed.
- Vehicle braking and stability may be affected with the attachment of this scoop. Do not fill the scoop to maximum weight capacity without checking the capability of the vehicle to safely drive and stop with the scoop attached.
- Before operating vehicle on any grade (hill) refer to the safety rules in the vehicle owner's manual concerning safe operation on slopes. Refer also to the slope guide on page 23 of this manual. **Stay off steep slopes!**
- Follow maintenance and lubrication instructions as outlined in this manual.



Look for this symbol to point out important safety precautions. It means — Attention!! Become alert!! Your safety is involved.

ACCESORIES AND ATTACHMENTS

Rear wheel weights and tire chains will provide extra traction and stability when using the Front End Scoop attachment. These items are available where you purchased your tractor.

WHEEL WEIGHT

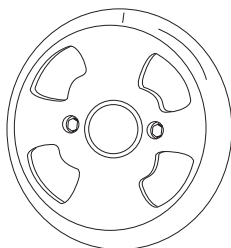

TIRE CHAINS

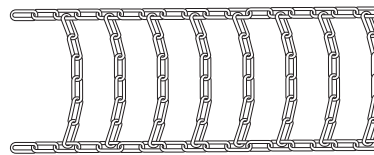

CARTON CONTENTS

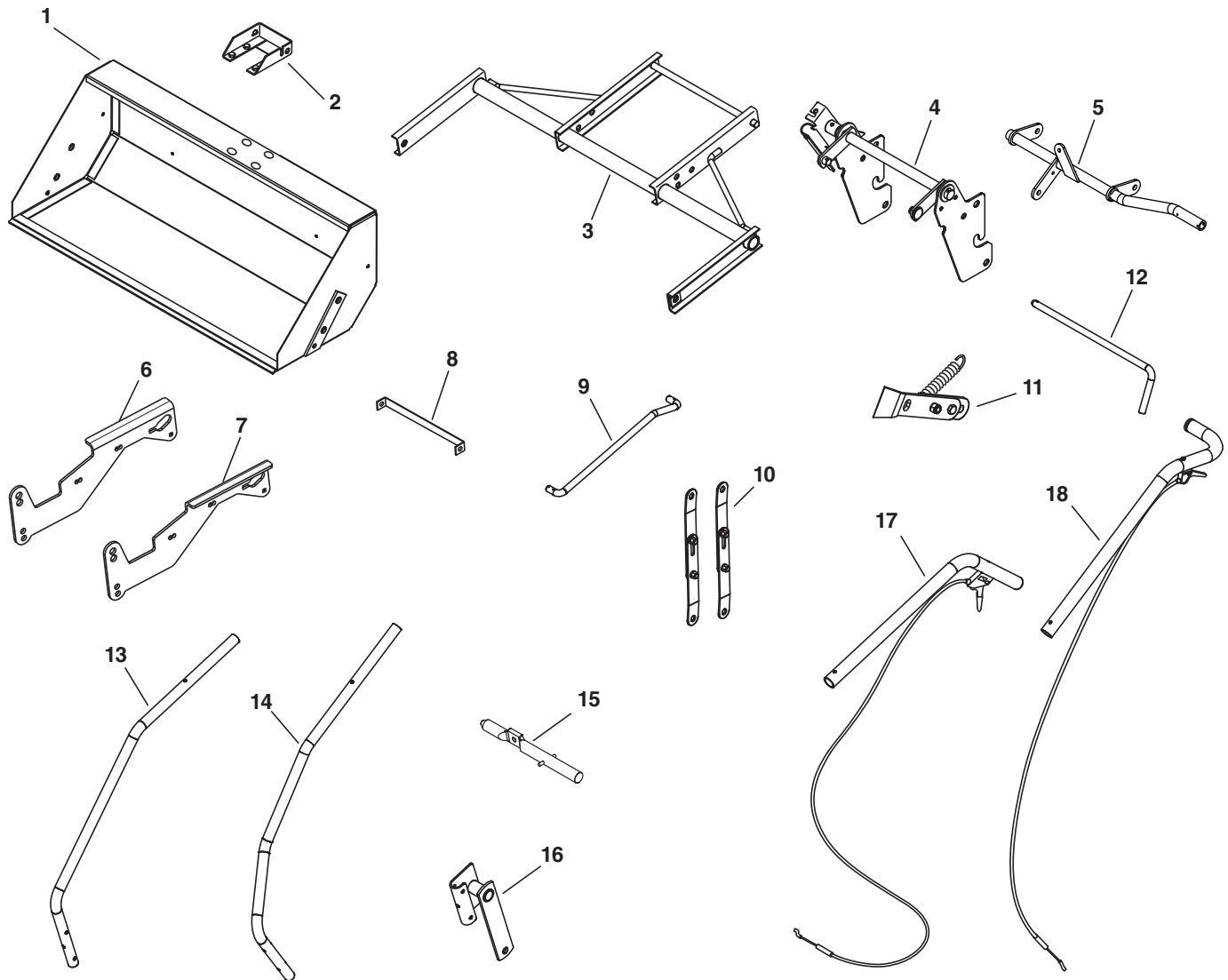

REF	PART NO.	QTY	DESCRIPTION	REF	PART NO.	QTY	DESCRIPTION
1	64962ORG	1	Bucket Assembly	10	----	2	Lift Strap Assembly
2	25335	1	Pin Stop Bracket	11	----	1	Tilt Bracket Assembly
3	64963	1	Lift Frame Assembly	12	47066	1	Attachment Rod
4	----	1	Lift Bracket Assembly	13	49271GY	1	Dump Handle Tube
5	66258	1	Tilt Anchor Assembly	14	49264GY	1	Lift Handle Tube
6	25562GY	1	Right (Long) Side Plate	15	49268	1	Dump Control Pin
7	25563GY	1	Left (Long) Side Plate	16	64968	1	Dump Pivot Bracket
8	25722	1	Frame Brace	17	----	1	Dump Handle Tube Extension
9	49273	1	Dump Control Rod	18	----	1	Lift Handle Tube Extension

FULL SIZE HARDWARE CHART

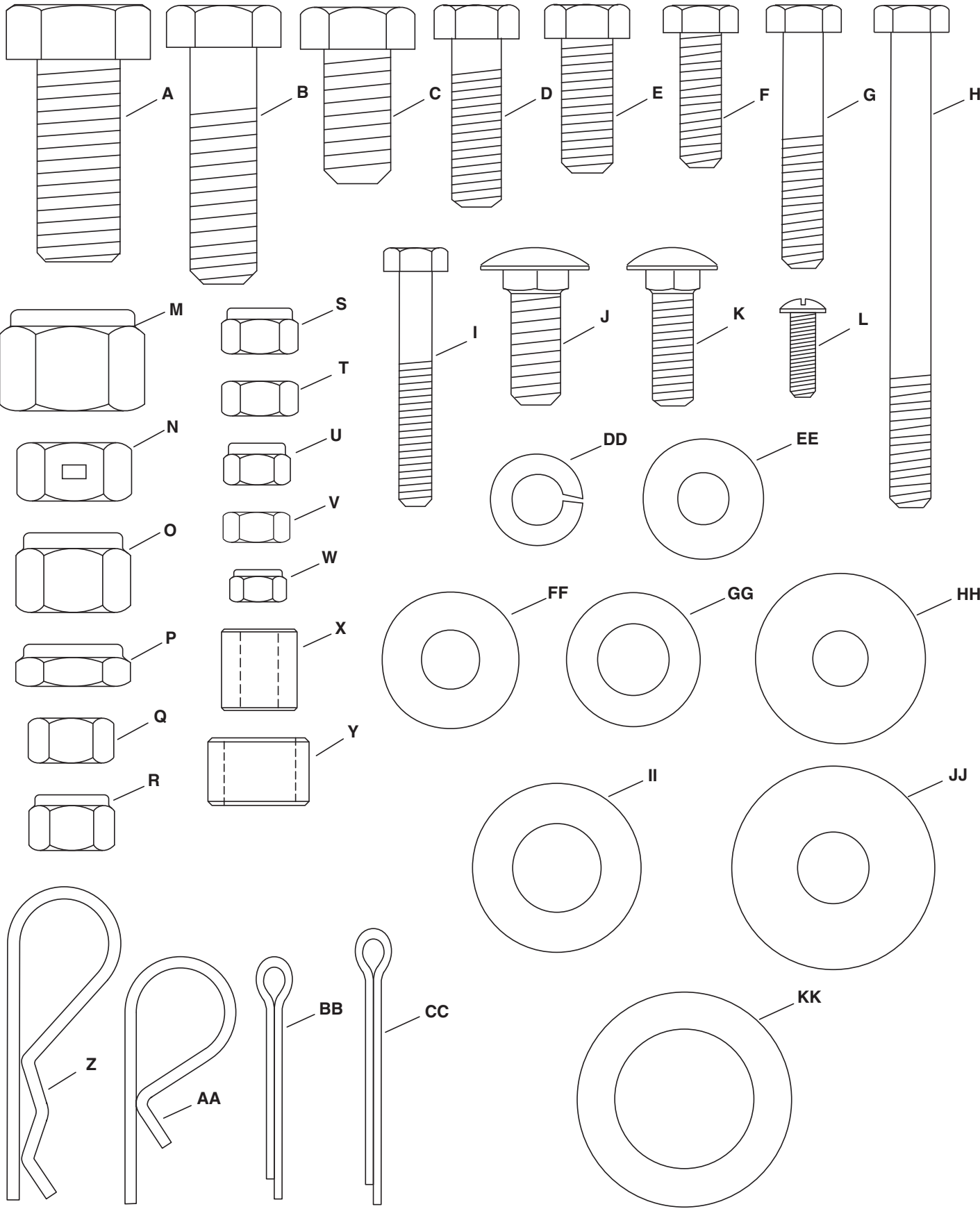

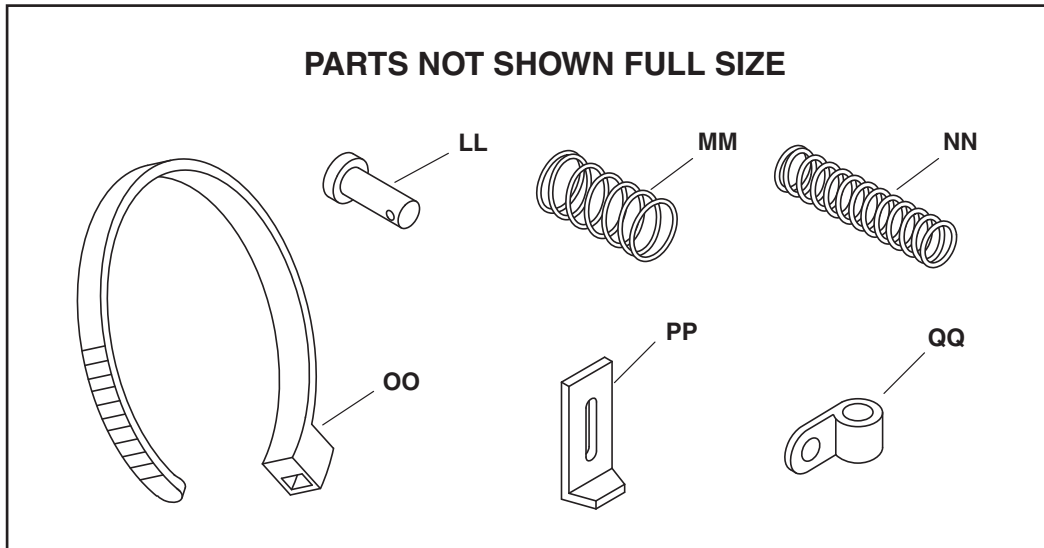

PARTS BAG CONTENTS

Not all parts will be needed for fit-up to any one tractor.
Discard unneeded parts after assembly is finished.

REF	PART NO.	QTY	DESCRIPTION	REF	PART NO.	QTY	DESCRIPTION
A	41614	2	Hex Bolt, 5/8" x 1-1/2"	W	47171	1	Nylock Nut, #10-32
B	R74780828	2	Hex Bolt 1/2" x 1-3/4"	X	23658	2	Spacer, 5/8" Long
C	41616	3	Hex Bolt, 1/2" x 1"	Y	24817	4	Spacer, 1/2"
D	43087	2	Hex Bolt, 3/8" x 1-1/4"	Z	43343	1	Hairpin Cotter, Long
E	43001	6	Hex Bolt, 3/8" x 1"	AA	43055	4	Hairpin Cotter, Short
F	43063	5	Hex Bolt, 5/16" x 1"	BB	43010	6	Cotter Pin, 1/8" x 1-1/4"
G	43084	5	Hex Bolt, 5/16" x 1-3/4"	CC	43093	2	Cotter Pin, 1/8" x 1-1/2"
H	47025	1	Hex Bolt, 5/16" x 3-1/2"	DD	43003	6	Lock Washer, 3/8"
I	1509-69	3	Hex Bolt, 1/4" x 1-3/4"	EE	43081	8	Washer, 5/16"
J	43350	8	Bolt, Carriage 3/8"x 1"	FF	43070	8	Washer, 3/8" (Small)
K	44326	2	Carriage Bolt, 5/16" x 1"	GG	R19171616	4	Washer, 1/2" (Small)
L	43346	1	Truss-Head Bolt #10-32 x 5/8"	HH	42828	2	Washer, 3/8" (Large)
M	41615	2	Nylock Nut, 5/8"	II	R19212016	6	Washer, 5/8"
N	43262	1	Hex Lock Nut, 1/2"	JJ	R19172410	8	Washer, 1/2" (Large)
O	41657	2	Nylock Nut, 1/2"	KK	43601	2	Washer, 1"
P	48115	2	Nylock Jam Nut, 1/2"	LL	44062	2	Clevis Pin
Q	43015	2	Hex Nut, 3/8"	MM	48905	1	Compression Spring, Short
R	HA21362	10	Nylock Nut, 3/8"	NN	42955	1	Compression Spring, Long
S	47810	12	Nylock Nut, 5/16"	OO	726-0178	6	Cable Tie
T	43083	2	Nut, Hex 5/16"	PP	26481	2	Tilt Stop Bracket
U	47189	3	Nylock Nut, 1/4"	QQ	HA23761	1	Hose Clip
V	43178	1	Nut, Hex 1/4"				

ASSEMBLY

TOOLS REQUIRED FOR ASSEMBLY

- (1) Standard Screwdriver
- (2) 15/16" Wrenches (one should be box-end)
- (2) 3/4" Wrenches
- (2) 9/16" Wrenches
- (2) 7/16" Wrenches
- (2) 1/2" Wrenches
- (1) 3/8" Wrench

ADDITIONAL ITEMS NEEDED

Ruler or Tape Measure
Grease

REMOVE PARTS FROM CARTON

- Remove the hardware pack and all loose parts from the carton.
- Lay cardboard on floor to help prevent scratching of painted parts.
- Lay out and identify all the parts and hardware as shown on pages 3 through 5.

ASSEMBLE SCOOP

STEP 1: INSTALL TWO BOLTS (SEE FIGURE 1)

- Assemble two 3/8" x 1-1/4" hex bolts (D) and 3/8" hex nuts (Q), threading the nut all the way onto the bolt until it is tight against the head of the bolt.
- Install a nut/bolt assembly into the bucket assembly and fasten using a 3/8" nylock nut (R). **Tighten.** Repeat for the other side.

STEP 2: INSTALL PIN STOP BRACKET (SEE FIGURE 1)

- Install the pin stop bracket to the top of the bucket assembly using four 5/16" x 1" hex bolts (F), eight 5/16" washers (EE) and four 5/16" nylock nuts (S). Leave the bolts loose enough that the position of the pin stop bracket can be adjusted later.

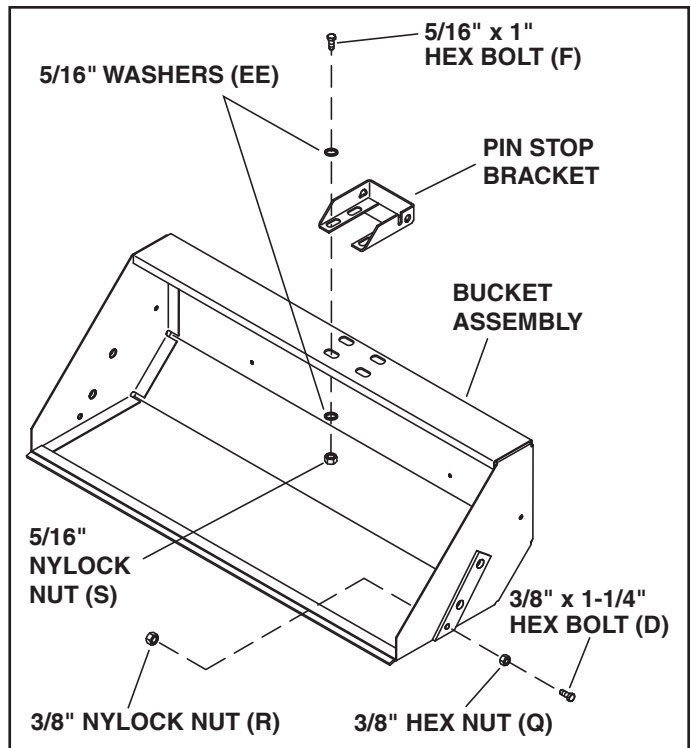

FIGURE 1

STEP 3: INSTALL LIFT FRAME ASSEMBLY (SEE FIGURE 2)

- Apply grease to the mounting surface of the bucket assembly and the inside of the lift frame arms.
- Assemble the lift frame assembly to the bucket assembly using two 5/8" x 1-1/2" hex bolts (A) and 5/8" nylock nuts (M). **Tighten, then loosen** the nuts 1/4 turn, or until the lift frame pivots freely.

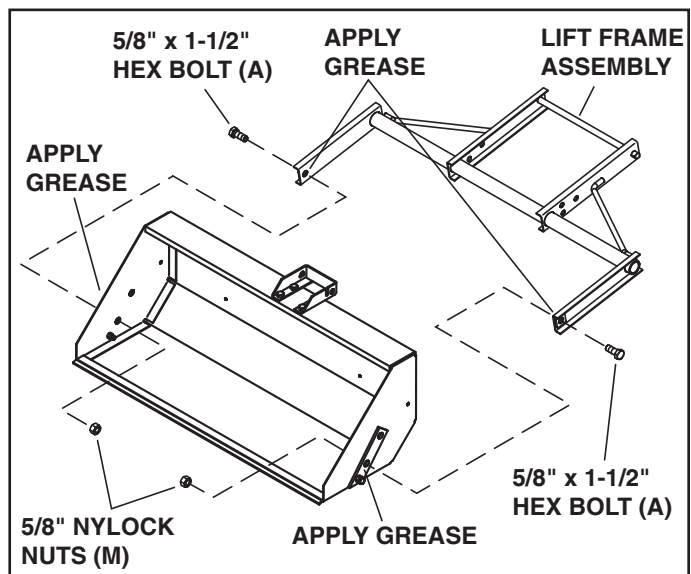

FIGURE 2

STEP 4: INSTALL LIFT BRACKET ASSEMBLY (SEE FIGURE 3)

- Assemble the lift bracket assembly to the lift frame assembly using two 5/8" washers (II) and 1/8" x 1-1/4" cotter pins (BB).

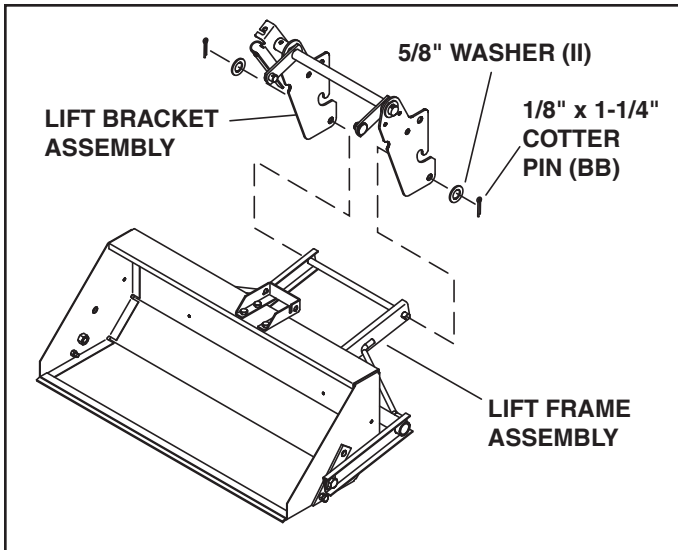

FIGURE 3

STEP 5: INSTALL TILT ANCHOR ASSEMBLY (SEE FIGURE 4)

- Assemble the tilt anchor assembly to the lift bracket assembly using two 1/2" x 1" hex bolts (C) and 1/2" nylock jam nuts (P). **Tighten.**

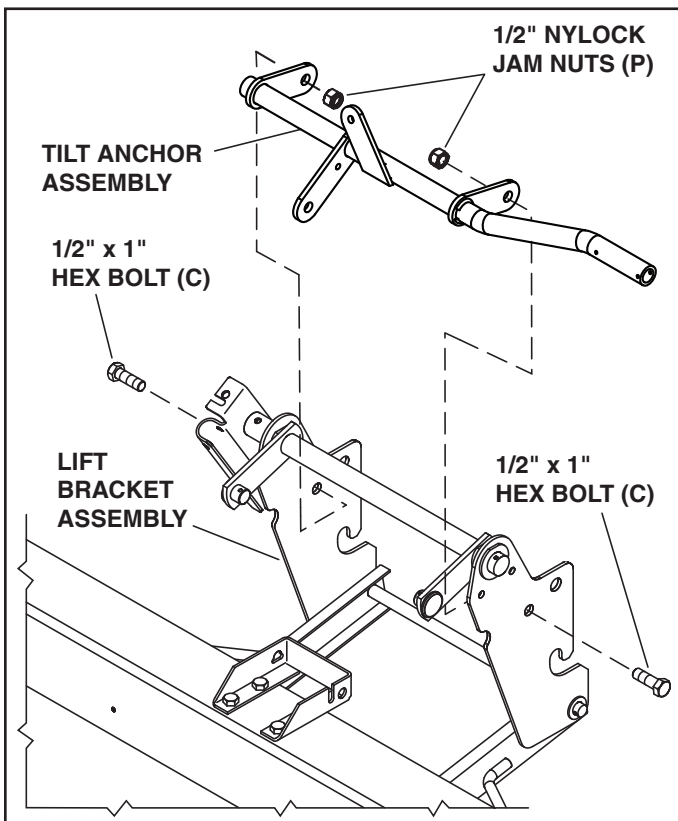

FIGURE 4

STEP 6: INSTALL LIFT STRAP ASSEMBLIES (SEE FIGURE 5)

- Loosen the bolts and nuts** on the lift strap assemblies 1/4 turn or until the straps will slide back and forth. You will retighten them later in step 26.
- Turn the lift strap assemblies as shown. Install each lift strap assembly to an arm of the lift bracket assembly and then secure with a small 1/2" washer (GG) and a short hairpin cotter (AA).
- Position the lower end of each lift strap assembly to the outside of the lift frame. Fasten to the upper front holes in the lift frame using a clevis pin (MM), 1/2" long spacer (Y) and short hairpin cotter (AA) for each assembly.

NOTE: The lift strap assemblies may be installed in the rear mounting holes of the lift frame to increase the lift height, but this will also increase the lifting effort. The front holes give a lift height of about 6-1/2" and require 28 lbs. of force to lift a 150 lb load. The rear holes will give a lift height of about 8-1/2" and require 35 lbs. of force.

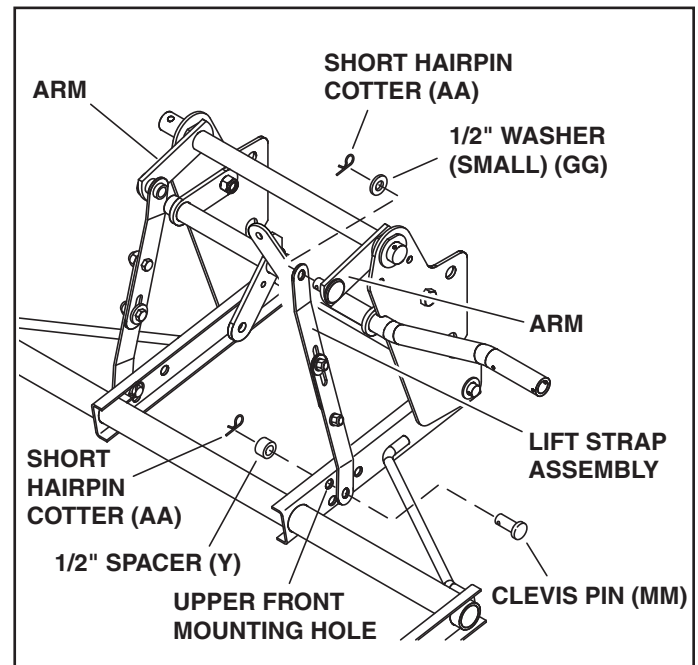

FIGURE 5

Bucket removed for clarity

STEP 7: INSTALL EXTENSION SPRING (SEE FIGURE 6)

- Lightly apply grease to the end of the arm on the tilt anchor assembly and install the tilt bracket assembly to the arm using a 1/2" x 1" hex bolt (C) and 1/2" hex lock nut (N). **Tighten then loosen** the nut 1/4 turn, or until the tilt bracket assembly pivots freely.
- Install a 1/4" x 1-3/4" hex bolt (I) through the end of the extension spring on the tilt bracket assembly and then install a 1/4" hex nut (V) onto the bolt. Next, insert the end of the bolt into the hole in the arm of the tilt anchor assembly and install a 1/4" nylock nut (U) onto the bolt. **Tighten** the nuts to secure the bolt to the arm.

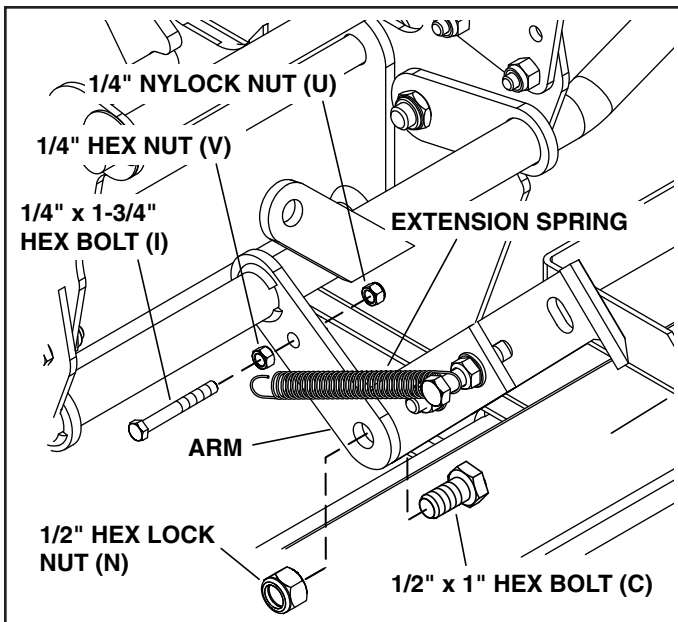

FIGURE 6

STEP 8: INSTALL STOP BRACKET BOLT (SEE FIGURE 7A)

For lift straps installed in front holes

- Install the long compression spring (NN) and then the two 5/8" spacers (X) onto the 5/16" x 3-1/2" hex bolt (H). Insert the bolt into the stop bracket and install two 5/16" hex nuts (T) onto the bolt. Adjust nuts later in step 29.

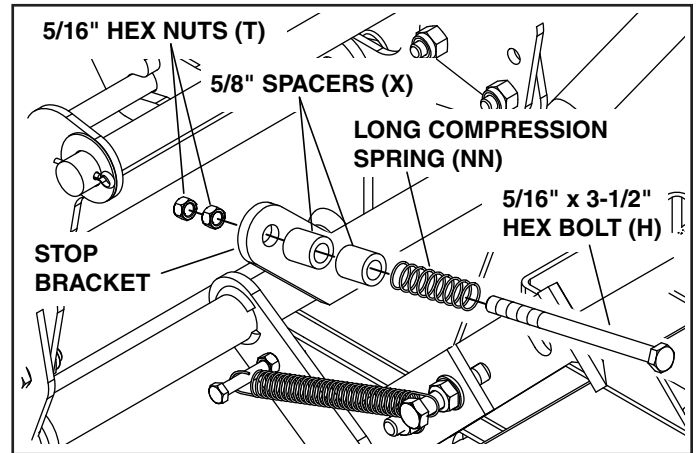

FIGURE 7A

(SEE FIGURE 7B)

For lift straps installed in rear holes

- Install the long compression spring (NN) and then a 5/8" spacer (X) onto the 5/16" x 3-1/2" hex bolt (H). Insert the bolt into the stop bracket and install a 5/8" spacer (X) and two 5/16" hex nuts (T) onto the bolt. Adjust nuts later in step 29.

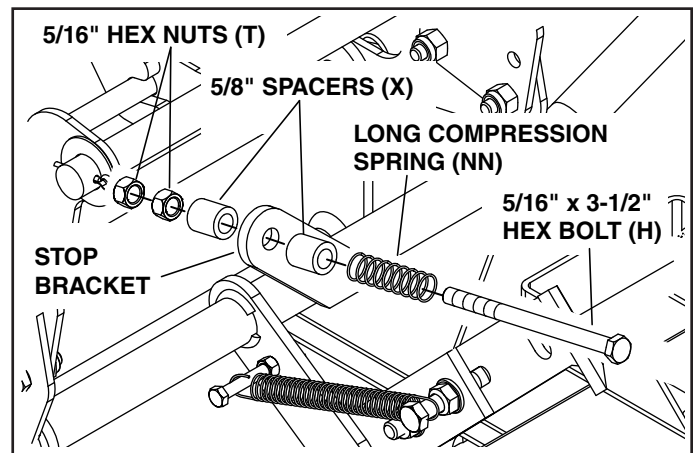

FIGURE 7B

STEP 9: INSTALL DUMP PIVOT BRACKET (SEE FIGURE 8)

- Install a 1/8" x 1-1/2" cotter pin (CC) to the inside hole in the shaft shown in figure 8, and then install a 1" washer (LL) onto the shaft. Apply grease to the end of the shaft and install the dump pivot bracket assembly onto the shaft. Install a 1" washer (KK) onto the shaft and secure it using a 1/8" x 1-1/2" cotter pin (CC).

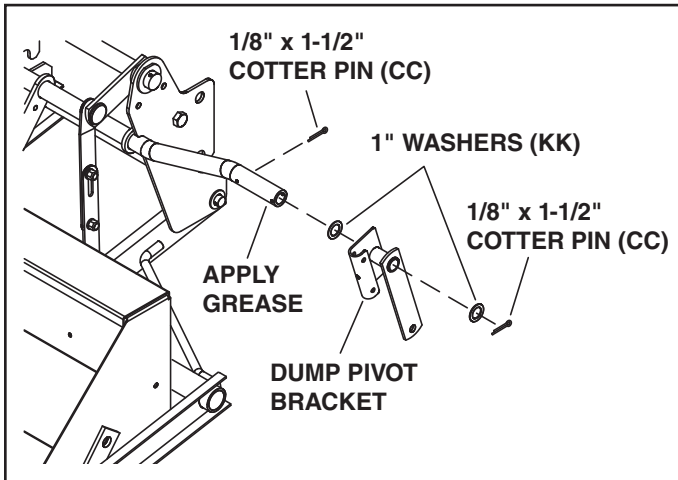

FIGURE 8

STEP 10: INSTALL DUMP CONTROL ROD (SEE FIGURE 9)

- Install a 1/8" x 1-1/4" cotter pin (BB) into the inside hole in each end of the dump control rod. Spread the ends of the cotter pins and wrap around the rod. Install a 5/8" washer (II) onto each end of the control rod.
- Install the dump control rod to the dump pivot bracket and bucket. Fasten using two 5/8" washers (II) and 1/8" x 1-1/4" cotter pins (BB). Spread the ends of the cotter pins and wrap around the rod.

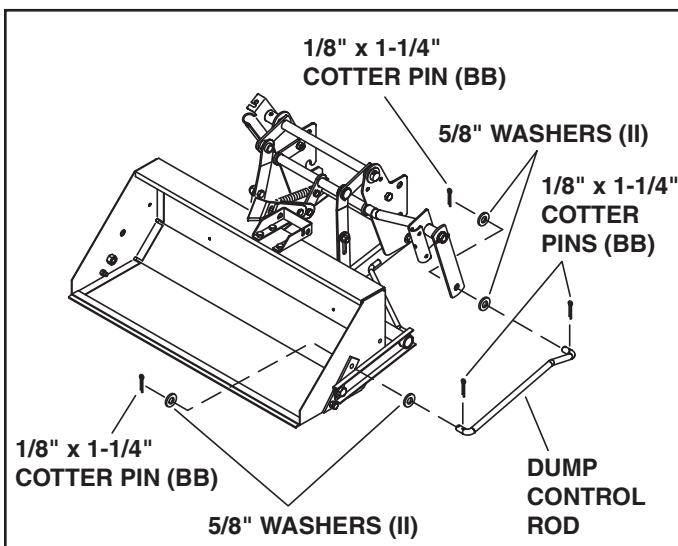

FIGURE 9

STEP 11: INSTALL TILT STOP BRACKETS (SEE FIGURE 10)

- Install a tilt stop bracket (PP) to each side of the bucket using a 3/8" x 1" carriage bolt (J), a small 3/8" washer (FF) and 3/8" nylock nut (R). **Do not tighten** the nuts until step 28.

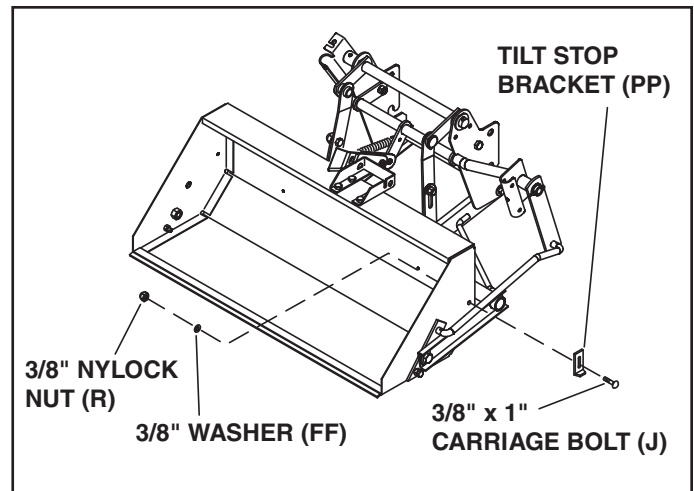

FIGURE 10

STEP 12: INSTALL LIFT HANDLE TUBE (SEE FIGURE 11)

- Install the lift handle tube into the index bracket using two 5/16" x 1-3/4" hex bolts (G) and 5/16" nylock nuts (S).

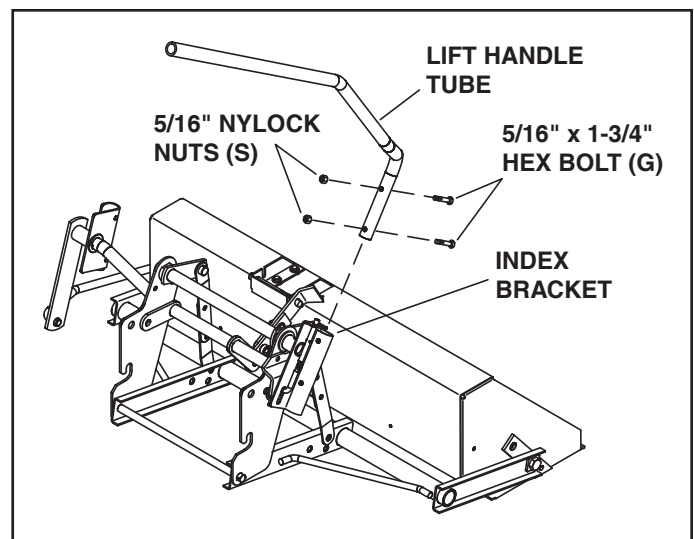

FIGURE 11

STEP 13: INSTALL LIFT HANDLE TUBE EXTENSION (SEE FIGURE 12)

- Install the lift handle tube extension on the lift handle tube using a 1/4" x 1-3/4" hex bolt (I) and 1/4" nylock nut (U).

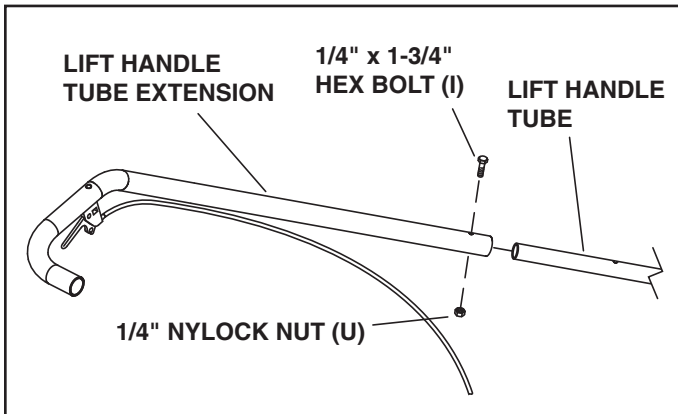

FIGURE 12

STEP 14: INSTALL LIFT CABLE (SEE FIGURE 13)

- Connect the hooked end of the lift cable into the index rod, and install the threaded cable adjuster into the notch in the top of the index bracket, placing a nut on each side of the notch.
- Adjust the cable adjustment nuts so that when the lift trigger is squeezed, the bottom of the index rod raises enough to release from the latched position. The index rod should also lower far enough to lock in the latched position when the trigger is released.
- Attach the lift cable to the lift handle using three cable ties (OO).

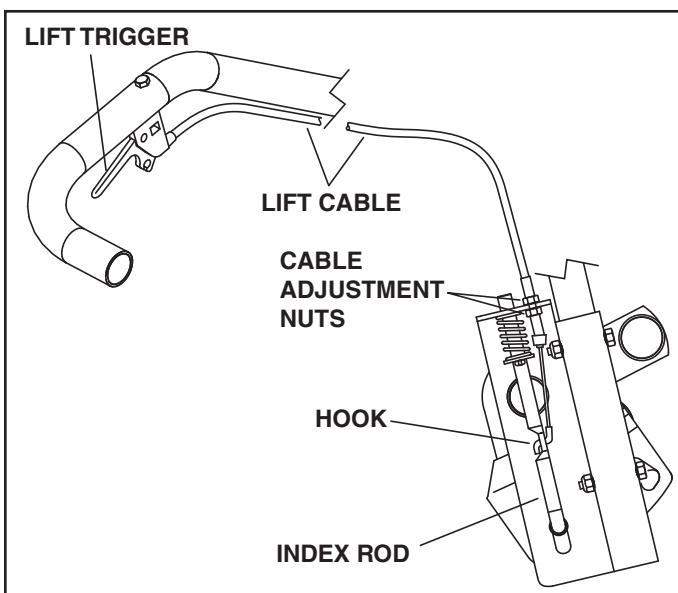

FIGURE 13

STEP 15: INSTALL DUMP HANDLE TUBE (SEE FIGURE 14)

- Install the dump handle tube to the dump pivot bracket assembly using three 5/16" x 1-3/4" hex bolts (G) and 5/16" nylock nuts (S).

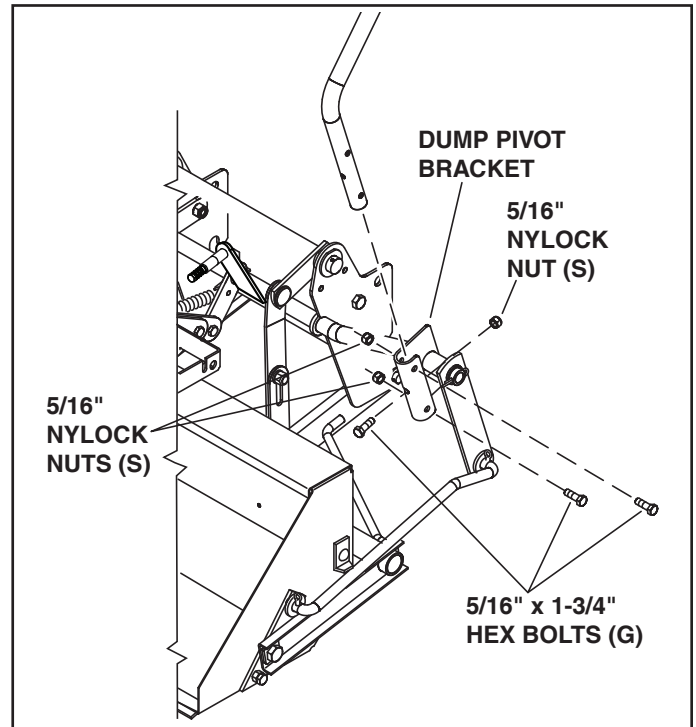

FIGURE 14

STEP 16: INSTALL DUMP HANDLE TUBE EXTENSION (SEE FIGURE 15)

- Install the dump handle tube extension on the dump handle tube using a 1/4" x 1-3/4" hex bolt (I) and 1/4" nylock nut (U).
- Attach the dump cable to the dump handle tube using three cable ties (OO).

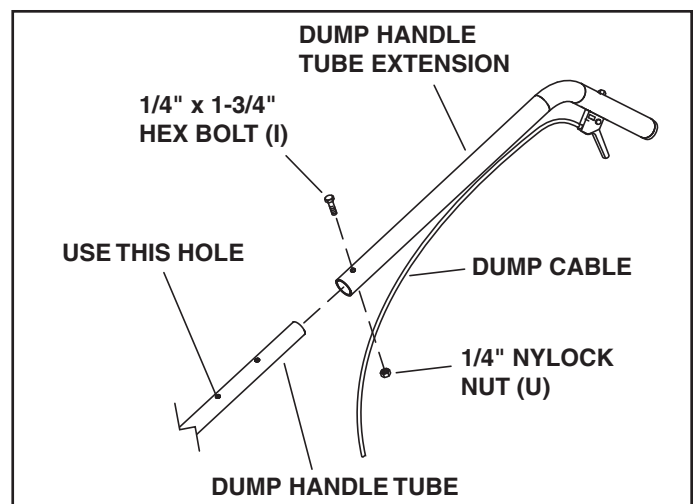

FIGURE 15

STEP 17: INSTALL DUMP CONTROL PIN (SEE FIGURE 16)

- Install a small 1/2" washer (GG) and then the short compression spring (MM) onto the dump control pin. Install the dump control pin into the pin stop bracket. Make sure the flat side of the pin faces to the front when finished.
- Connect the hooked end of the dump cable into the hole in the dump control pin. Install the threaded cable adjuster down into the notch in the pin stop bracket, placing a nut on each side of the notch. Adjust and tighten the adjuster nuts so that the tapered end of the dump control pin extends 3/4" through the side of the pin stop bracket.

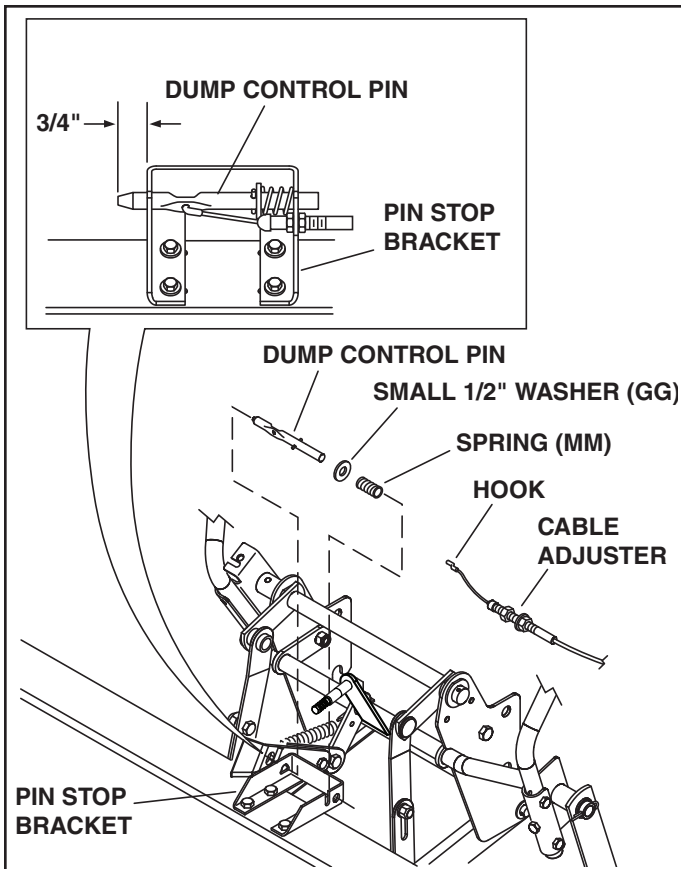

FIGURE 16

STEP 18: INSTALL HOSE CLIP AND SPACER (SEE FIGURE 17)

- Secure the dump cable to the back of the bucket using a hose clip (QQ), a #10 x 5/8" truss-head bolt (L) and a #10-32 nylock nut (W).

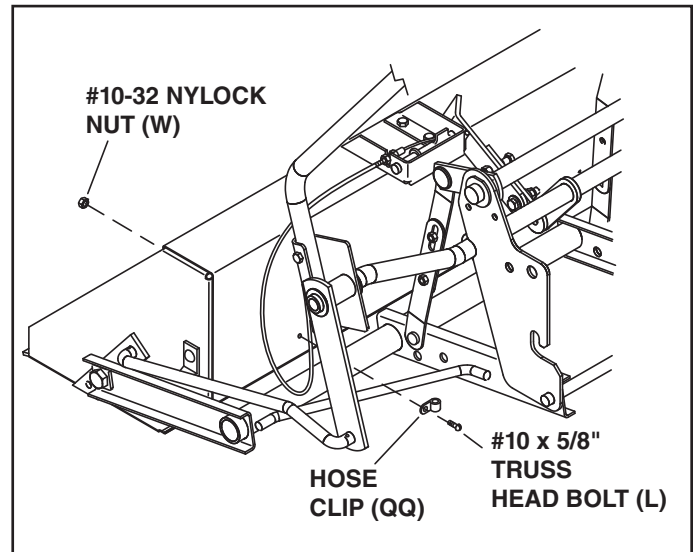

FIGURE 17

INSTALL FRONT SCOOP ON TRACTOR

STEP 19: IDENTIFY YOUR TRACTOR TYPE (SEE FIGURE 18)

- Look underneath the front axle of your tractor. If there is a single mower deck suspension bracket located under the middle of the front axle, continue on to step 20. If your tractor does not have a mower deck suspension bracket underneath the middle of the front axle, skip to step 22 or step 24 on page 13 for tractors with dual suspension brackets.

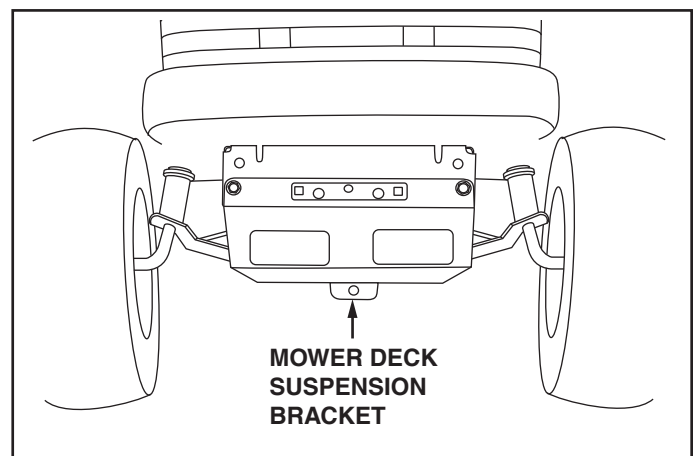

FIGURE 18

LAWN TRACTORS AND GARDEN TRACTORS WITH SINGLE SUSPENSION BRACKETS

STEP 20: INSTALL SIDE PLATES (SEE FIGURE 19)

- Remove any bolts present in the mounting holes on the left side of the tractor frame. **Do not remove** bolts from right side of frame until left side plate has been installed.
- Install the left (long) side plate on the tractor frame using three 3/8" x 1" carriage bolts (J), three 3/8" nylock nuts (R), one 5/16" x 1" carriage bolt (K), one 5/16" nylock nut (S) and three large 1/2" washers (JJ) if needed (see note). **Do not tighten yet.** Repeat for the right (long) side plate.

NOTE: If an engine mounting plate is present (shown with dotted lines) that prevents the side plate from resting flat against the tractor frame, place 1/2" washers (JJ) on the front two 3/8" bolts and on the rear 5/16" bolt to serve as shims between the side plate and the frame.

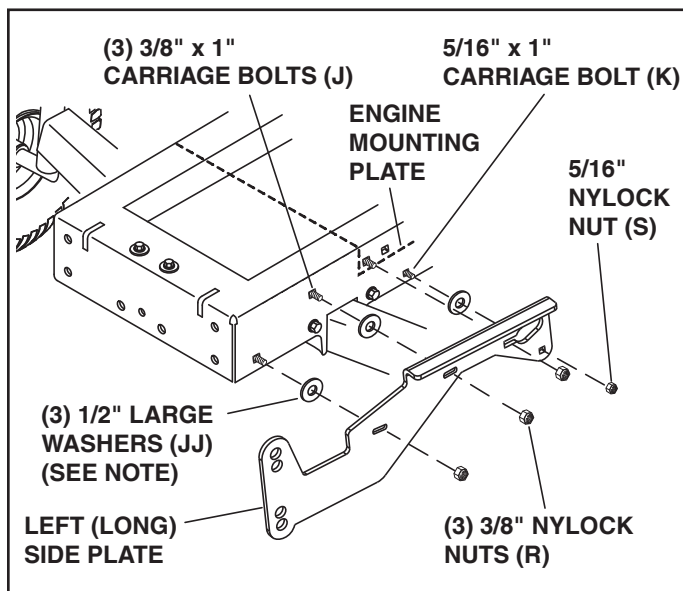

FIGURE 19

STEP 21: INSTALL FRAME BRACE (SEE FIGURE 20)

- Install the frame brace to the inside of the side plates using two 1/2" x 1-3/4" bolts (B), large 1/2" washers (JJ), 1/2" spacers (Y) and 1/2" nylock nuts (O). Install the brace in the bottom holes for Garden (GT) Tractors and the second from bottom holes for Lawn (LT) Tractors. **Do not tighten yet.**
- Tighten all nuts on side plates and frame brace.
- Skip to step 25 on page 14.**

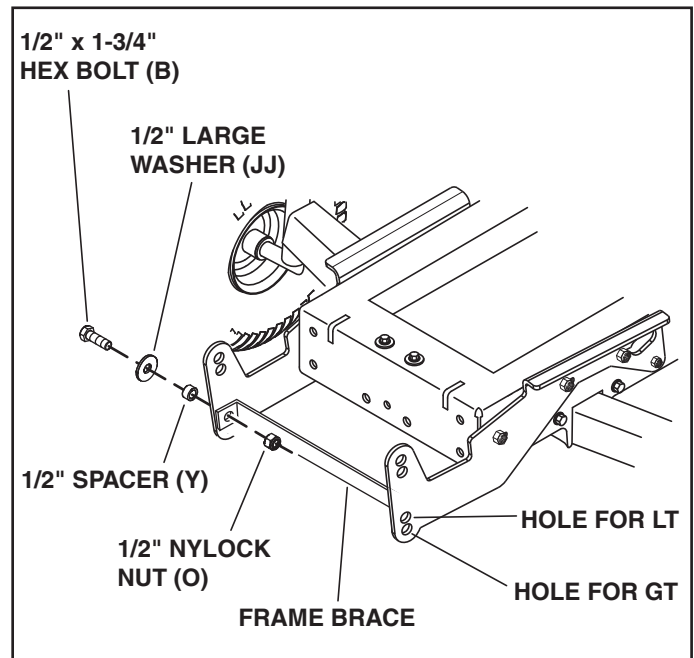

FIGURE 20

LAWN TRACTORS WITH DUAL SUSPENSION BRACKETS

STEP 22: INSTALL SIDE PLATES (SEE FIGURE 21)

- Remove any bolts present in the mounting holes on the left side of the tractor frame. **Do not remove** bolts from right side of frame until done with left side plate.
- Fasten the left (long) side plate to the tractor frame using three 3/8" x 1" hex bolts (E), 3/8" small washers (FF), and 3/8" lock washers (DD). If there is a bracket like the one shown with dotted lines, use a 3/8" large washer (HH) as a shim on the rear bolt. **Do not tighten yet.** Repeat for the right (long) side plate.

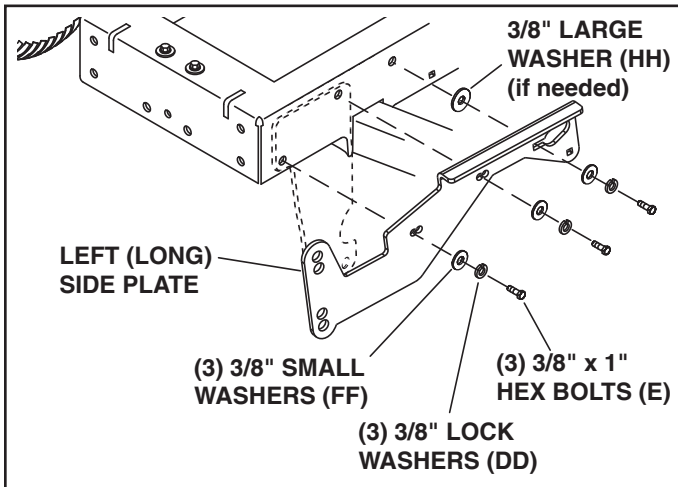

FIGURE 21

STEP 23: INSTALL FRAME BRACE (SEE FIGURE 22)

- Install the frame brace between the side plates using two 1/2" x 1-3/4" bolts (B), large 1/2" large washers (JJ), 1/2" spacers (Y) and 1/2" nylock nuts (O). Use the second hole from the bottom in the plates. **Tighten.**
- Tighten** 3/8" x 1" hex bolts (E) in side plates only until they are snug and the lock washers are flattened.
- Skip to step 25 on page 14.

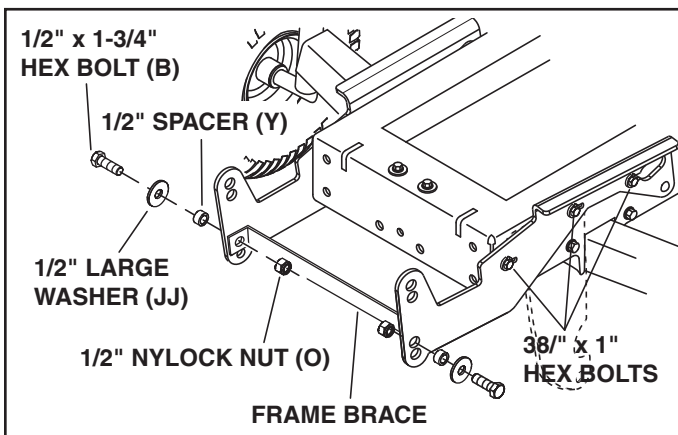

FIGURE 22

INSTRUCTIONS FOR ALL TRACTORS

STEP 24: MOUNT SCOOP TO TRACTOR (SEE FIGURE 23)

- Align the scoop with the side plates on the front of the tractor. Lift the rear of the scoop and slide the notches in the scoop frame onto the bolts or pins in the tractor side plates. Stand on the left side of the tractor and push down on the scoop dump handle until the holes in the scoop frame and the holes in the side plates are aligned. Install the attachment rod through the holes from the left side and secure it with a long hairpin cotter (Z).

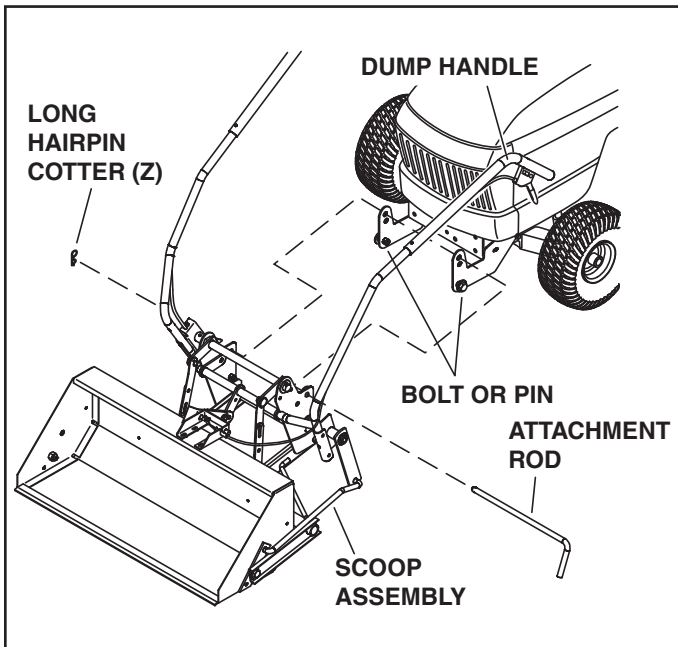

FIGURE 23

STEP 25: ADJUST TILT AND PIN STOP BRACKETS (SEE FIGURE 24)

- Lower the scoop assembly onto a smooth level surface. For normal use, let the bottom of the bucket rest flat on the ground. For more aggressive scraping action, place 1/4" shims under the rear of the bucket at each end.
- Make sure the two smaller bolts in the tilt bracket and the four bolts in the pin stop bracket are slightly loosened.
- Swing the tilt bracket forward and position the pin stop bracket so the end of the dump control pin inserts into the hole in the tilt bracket.
- Adjust the pin stop bracket so that it is flush and square with the front of the bucket. Leave a small gap between the side of the pin stop bracket and the tilt bracket. The taper on the end of the dump control pin should now extend all the way through the tilt bracket. **TIGHTEN** the bolts and nuts in the pin stop bracket
- TIGHTEN** the two bolts and nuts in the tilt bracket.

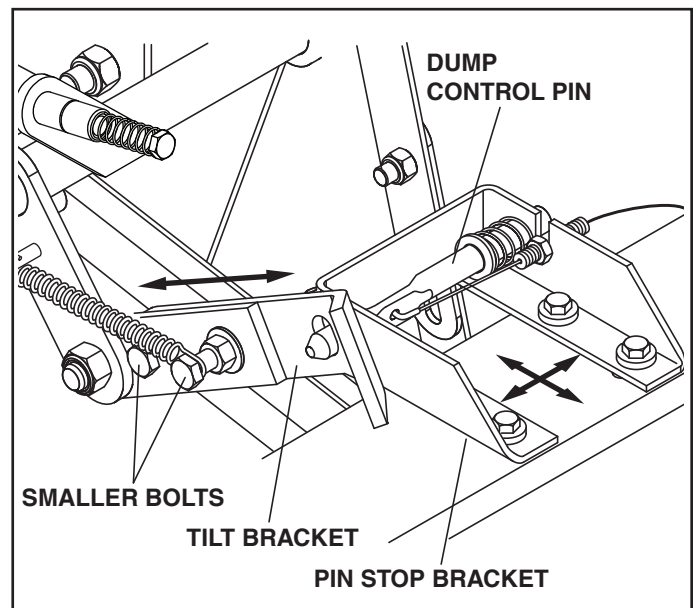

FIGURE 24

**STEP 26: ADJUST LIFT STRAPS
(SEE FIGURE 25)**

- Make sure the nuts and bolts in the lift straps are loose enough to turn by hand. Stand beside the right side of the scoop and **hold the lift handle as far forward as it will go** until you tighten one of the nuts in the lift straps. Let go of the lift handle and tighten the other three nuts in the lift straps.

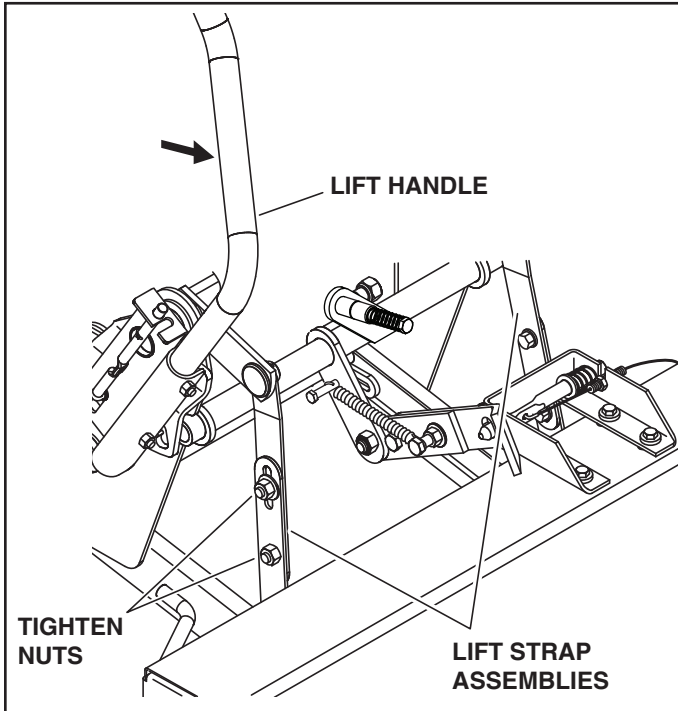

FIGURE 25

**STEP 27: ADJUST TILT STOP BRACKETS
(SEE FIGURE 26)**

- Raise the scoop until it locks in the TRANSPORT position. Push the tilt stop brackets (PP) on each side of the bucket down against the lift frame arms, and tighten the nuts.

NOTE: Readjust the tilt stop brackets if you move the lift strap assemblies from the front to rear holes or from the rear to front holes. Refer to step 6 on page 7.

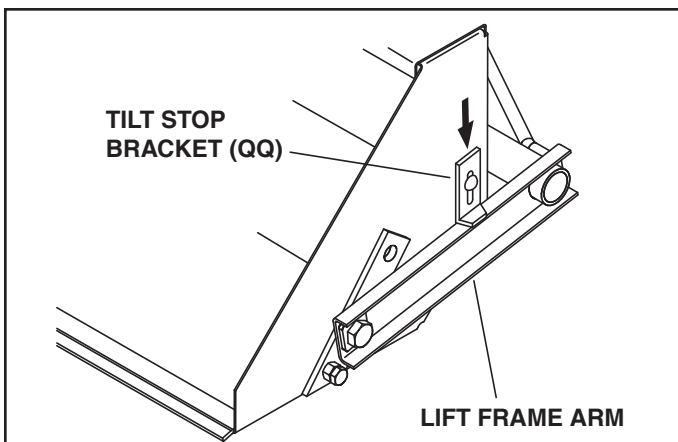

FIGURE 26

**STEP 28: ADJUST STOP BOLT
(SEE FIGURE 27)**

- Keep the scoop locked in the TRANSPORT position. Adjust the nuts on the stop bolt in or out until the dump control pin is centered in the slot of the tilt bracket when the tilt bracket is pulled back against the stop bolt. **Securely tighten** the two nuts together.

NOTE: If the lift strap assemblies are moved to the rear mounting holes, one of the spacers on the stop bolt will need to be moved to the back side of the bolt stop bracket. Refer to step 8 on page 8.

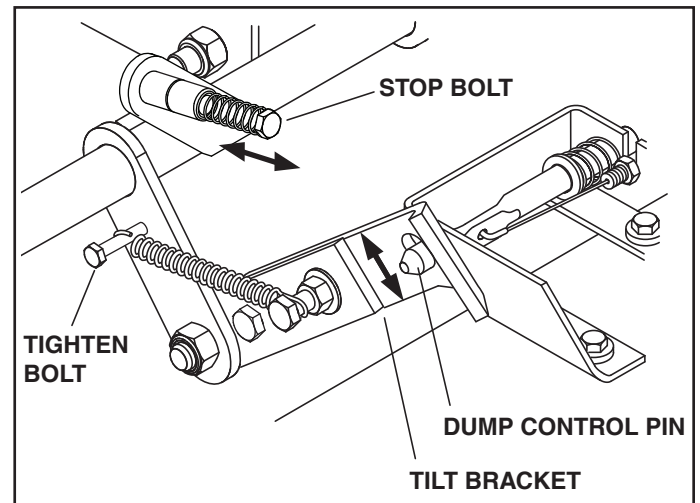

FIGURE 27

STEP 30: CHECK DUMPING OPERATION

- With the scoop in the transport position, squeeze the dump trigger and push down on the dump handle to dump the bucket. Release the dump trigger and lift up on the handle to lock the bucket in the upright position. If the dump control pin does not lock into the tilt bracket, loosen the bolts tightened in steps 25, 26 and 27 and then repeat steps 25, 26, 27, and 28.

OPERATION

KNOW YOUR FRONT END SCOOP

Read this owner's manual and safety rules before operating your front end scoop.

Compare the illustration below with your front end scoop to familiarize yourself with the various controls and their locations.

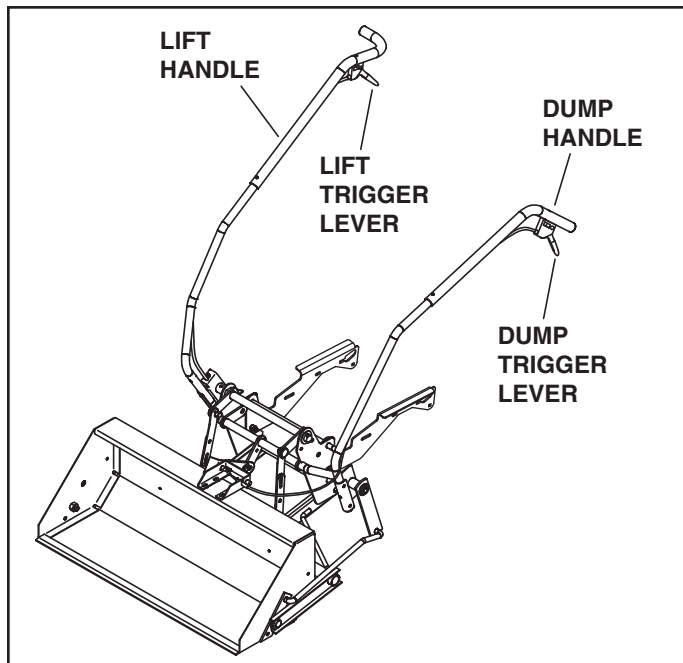

DUMP TRIGGER LEVER Press to release the dump pin.

DUMP HANDLE Press down to dump the bucket.

LIFT TRIGGER LEVER Press to release the index pin.

LIFT HANDLE Press down to lift the bucket assembly.

HOW TO USE YOUR SCOOP

DO NOT EXCEED 200 LB. CAPACITY OF BUCKET

One cubic foot of dirt weighs approximately 80 lbs.

One cubic foot of dry sand or gravel weighs approximately 100 lbs.



CAUTION: VEHICLE BRAKING AND STABILITY MAY BE AFFECTED WITH THE ADDITION OF AN ACCESSORY OR AN ATTACHMENT. BE AWARE OF CHANGING CONDITIONS ON SLOPES.

- Refer to the vehicle owner's manual for instructions on safe operation on slopes.
- Use the slope guide provided on page 23 of this manual to determine whether slope angle is too steep for safe operation.

- Always test to make sure your vehicle has adequate power and braking capabilities whenever hauling a substantial amount of weight in your front end scoop. Use extra caution when operating on slopes.
- For best handling and traction, distribute the weight of the load evenly in the bucket.



CAUTION: NEVER RAM THE SCOOP INTO MATERIAL AT HIGH SPEEDS.

- Keep the lift handle locked in the raised position when tilting the scoop bucket forward to dump.
- The lift handle must be locked in the raised position to allow the dump handle to lock the scoop bucket back in the upright position after dumping.
- Do not scrape or push material with the scoop bucket while it is tilted forward.
- Add wheel weights for improved traction when using the scoop.
- To dump material from the bucket, squeeze the dump trigger and push the dump tube handle down. Release the trigger before returning the bucket to the upright position.
- To lower the bucket, squeeze the lift trigger and then lift up on the lift handle. If the trigger is hard to depress, you may need to push down on the lift handle while squeezing, and then lift up. Release the trigger before returning the bucket to the raised position.
- Do not exceed mowing speed (3 mph) when the front end scoop is attached to the tractor.



CAUTION: TO AVOID POSSIBLE INJURY, MAKE SURE THAT NO ONE IS NEAR THE BUCKET BEFORE DUMPING THE BUCKET.



CAUTION: ALWAYS LOWER THE SCOOP BUCKET TO THE GROUND BEFORE LEAVING THE TRACTOR.

MAINTENANCE

CHECK FOR LOOSE FASTENERS

- Before each use make a thorough visual check of the front end scoop for any bolts and nuts which may have loosened. Retighten any loose bolts and nuts.

CLEANING

- After each use, clean off any dirt and debris from the scoop bucket lift frame.
- Before storing at the end of each season, rinse off the scoop bucket and scoop lift frame. Allow to dry thoroughly. Paint any exposed metal surfaces to protect from rust.
- Store in a clean, dry area.

LUBRICATION

- Lightly oil all pivot points on the scoop lift mechanism.
- Lightly oil the surface on the scoop bucket where the attachment lift frame pivots.
- Apply a good grade of spray lubricant to the trigger assemblies on the lift handle and dump handle.

TROUBLESHOOTING

PROBLEM	CAUSE	CORRECTION
Scoop won't lock into raised/transport position.	1. Index rod is jamming. 2. Frame is hitting tilt stop brackets.	1. Apply grease to the bottom slot in the lift bracket, where the index rod slides 2. Adjust the tilt stop brackets as instructed on page 15.
Scoop bucket won't lock into level position after dumping.	1. Dump control pin does not align with the tilt bracket.	1. Adjust the tilt bracket and lift straps as instructed on page 15. 2. Adjust the stop bolt as instructed on page 15.
Lift handle trigger won't release scoop from the transport position.	1. Index rod is jamming. 2. Lift cable is not adjusted properly.	1. Apply grease to the bottom slot in the lift bracket, where the index rod slides. 2. Adjust cable nuts as instructed on page 10.
Dump handle trigger won't release bucket to dump.	1. Dump control cable is not adjusted properly. 2. Pin stop bracket is not adjusted properly side to side.	1. Adjust parts as instructed in step 17 on page 11. 2. Adjust parts as instructed in step 25 on page 14.
Bucket is becoming more difficult to tilt up or down.	1. Debris is lodged between bucket assembly and lift frame.	1. Remove all debris from between the bucket assembly and the lift frame.

REPAIR PARTS FOR MODEL 45-04032-669 FRONT END SCOOP

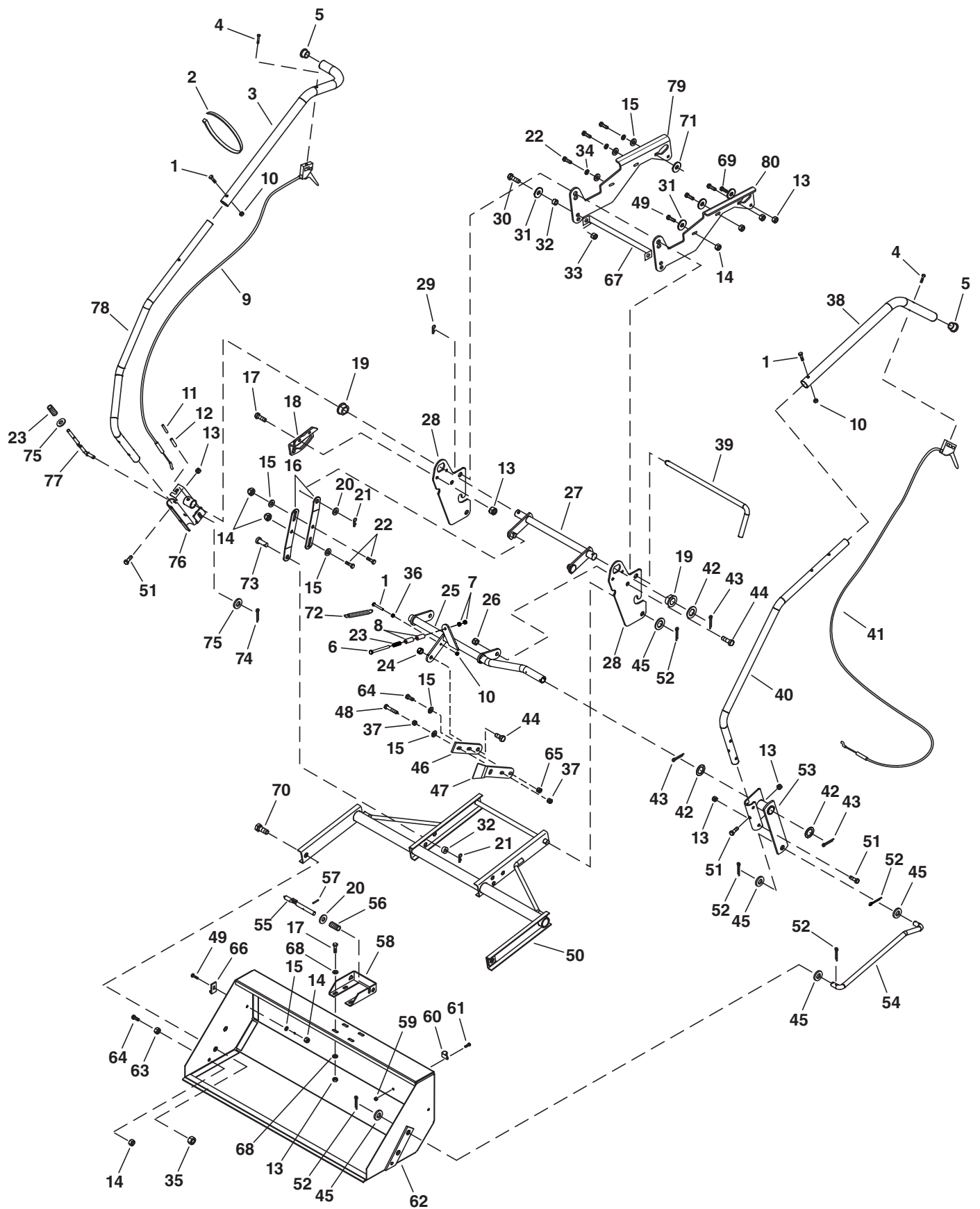

REPAIR PARTS FOR MODEL 45-04032-669 FRONT END SCOOP

REF	PART NO.	QTY	DESCRIPTION	REF	PART NO.	QTY	DESCRIPTION
1	1509-69	3	Hex Bolt, 1/4-20 x 1-3/4" (Grade 5)	42	43601	3	Washer, 1.59" x 1.032" x 0.60"
2	726-0178	6	Cable Tie	43	43093	3	Cotter Pin, 1/8" x 1-1/2"
3	49265GY	1	Lift Handle Extension	44	41616	3	Hex Bolt, 1/2-13 x 1" (Grade 5)
4	49266	2	Oval Screw, 10-24 x 1-1/2"	45	R19212016	6	Flat Washer, 5/8" x 1-1/4" x 16 Ga.
5	47674	2	Plastic Plug, 1-1/4" O.D. Tube	46	25852	1	Tilt Bracket Extension Strap
6	47025	1	Hex Bolt, 5/16-18 x 3-1/2" (Gr. 5)	47	25851	1	Tilt Bracket
7	43083	2	Nut, Hex 5/16-18	48	43062	1	Hex Bolt, 3/8-16 x 1-1/2" (Grade 5)
8	23658	2	Spacer, .39" x .56" x .62" L	49	43350	8	Bolt, Carriage 3/8-16 x 1" (Grade 5)
9	49912	1	Cable, Lift	50	64963	1	Lift Frame Assembly
10	47189	3	Nylock Nut, 1/4"	51	43084	5	Hex Bolt, 5/16-18 x 1-3/4" (Grade 5)
11	47369	1	Roll Pin, 3/16" x 1-3/4"	52	43010	6	Cotter Pin, 1/8" x 1-1/4"
12	47368	1	Roll Pin, 5/16" x 1-3/4"	53	64968	1	Dump Pivot Bracket
13	47810	14	Nylock Nut, 5/16-18	54	49273	1	Dump Control Rod
14	HA21362	14	Nylock Nut, 3/8-16	55	49268	1	Dump Control Pin
15	43070	14	Flat Washer, 3/8"	56	48905	1	Compression Spring
16	25350	4	Lift Strap	57	46055	1	Spring Pin, 1/8" x 1"
17	43063	7	Hex Bolt, 5/16-18 x 1" (Grade 5)	58	25335	1	Pin Stop Bracket
18	25343	1	Lift Bracket	59	47171	1	Nylock Nut, #10-32
19	42939	2	Flange Bearing with Flats	60	HA23761	1	Hose Clip
20	R19171616	4	Flat Washer, 1/2" x 1" (Small)	61	43346	1	Truss-Head Bolt #10-32 x 5/8"
21	43055	4	Hairpin Cotter, 3/32" x 1.8"	62	64962ORG	1	Bucket Assembly
22	43001	10	Hex Bolt, 3/8-16 x 1" (Grade 5)	63	43015	2	Hex Nut, 3/8-16
23	42955	2	Spring, Compression	64	43087	3	Hex Bolt, 3/8-16 x 1-1/4" (Grade 5)
24	43262	1	Hex Lock Nut, 1/2-13	65	47572	1	Nut, Hex 3/8-16 Lock Flanged
25	66258	1	Tilt Anchor Assembly	66	26481	2	Tilt Stop Bracket
26	48115	2	Nylock Jam Nut, 1/2-13	67	25722	1	Frame Brace
27	63675	1	Lift Arm Assembly	68	43081	8	Flat Washer, 5/16"
28	25510	2	Mounting Bracket	69	44326	2	Carriage Bolt, 5/16" x 1" (Grade 5)
29	43343	1	Hairpin Cotter, 3/32" x 2-5/16"	70	41614	2	Hex Bolt, 5/8-11 x 1-1/2" (Grade 5)
30	R74780828	2	Hex Bolt 1/2-13 x 1-3/4" (Grade 5)	71	42828	2	Washer, .41" x 1.25" x .156"
31	R19172410	8	Flat Washer, 1/2" x 1-1/2" (Large)	72	43000	1	Extension Spring
32	24817	4	Spacer, 0.52" x 0.75" x 0.5"	73	44062	2	Clevis Pin, 1/2" x 1"
33	41657	2	Nylock Nut, 1/2-13	74	142	1	Cotter Pin, 1/8" x 3/4"
34	43003	6	Lock Washer, 3/8"	75	R19131316	2	Flat Washer, 3/8" x 13/16" x 1/16"
35	41615	2	Nylock Nut, 5/8-11	76	63773	1	Index Bracket Assembly
36	43178	1	Nut, Hex 1/4-20	77	48049	1	Index Rod
37	42210	2	Nylock Jam Nut, 3/8-16	78	49264GY	1	Lift Handle Tube
38	49270GY	1	Dump Handle Tube Extension	79	25562GY	1	Right (Long) Side Plate
39	47066	1	Attachment Rod	80	25563GY	1	Left (Long) Side Plate
40	49271GY	1	Dump Handle Tube		27984	1	Owner's Manual
41	40173	1	Dump Control Cable				

* Purchase Common Hardware Locally

NOTES

NOTES

NOTES

SLOPE GUIDE FOR TRACTORS

(Keep this sheet in a safe place for future reference.)

Use this guide to determine if a slope is safe for the operation of your tractor and scoop. Refer also to the instructions in your vehicle owners manual.

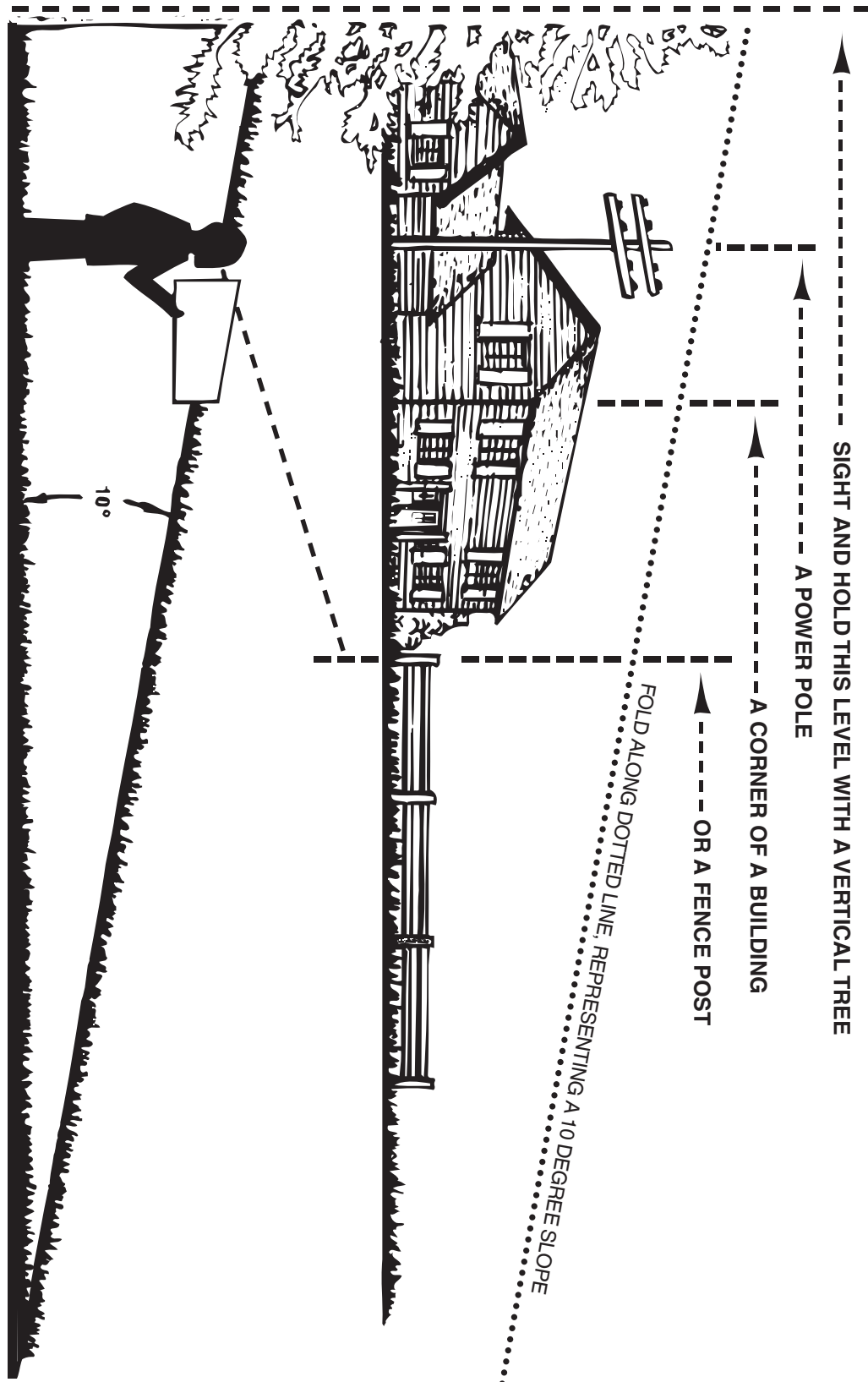

CAUTION: DO NOT OPERATE YOUR TRACTOR AND SCOOP ON A SLOPE IN EXCESS OF 10 DEGREES. BE SURE OF YOUR TRACTOR'S TOWING AND BRAKING CAPABILITIES BEFORE OPERATING ON A SLOPE. AVOID ANY SUDDEN TURNS OR MANEUVERS WHILE ON A SLOPE.

REPAIR PARTS

Agri-Fab, Inc.
809 South Hamilton
Sullivan, IL. 61951
217-728-8388
www.agri-fab.com

This document (or manual) is protected under the U.S. Copyright Laws and the copyright laws of foreign countries, pursuant to the Universal Copyright Convention and the Berne convention. No part of this document may be reproduced or transmitted in any form or by any means, electronic or mechanical, including photocopying or recording, or by any information storage or retrieval system, without the express written permission of Agri-Fab, Inc. Unauthorized uses and/or reproductions of this manual will subject such unauthorized user to civil and criminal penalties as provided by the United States Copyright Laws.