

80V CHAINSAW

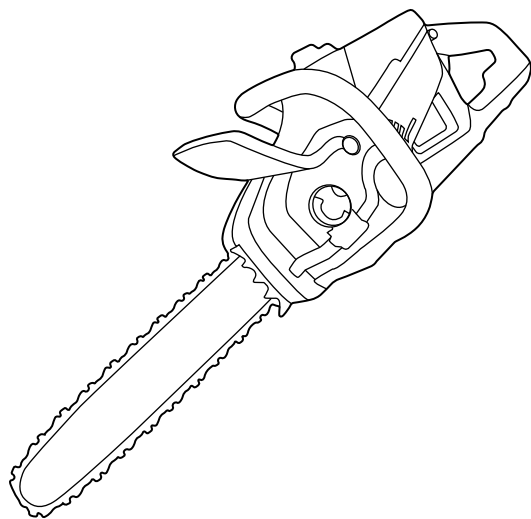

Depending on the model purchased, packaging will contain different accessories and parts.
Refer to the package for more details.

KNOW YOUR MACHINE

1

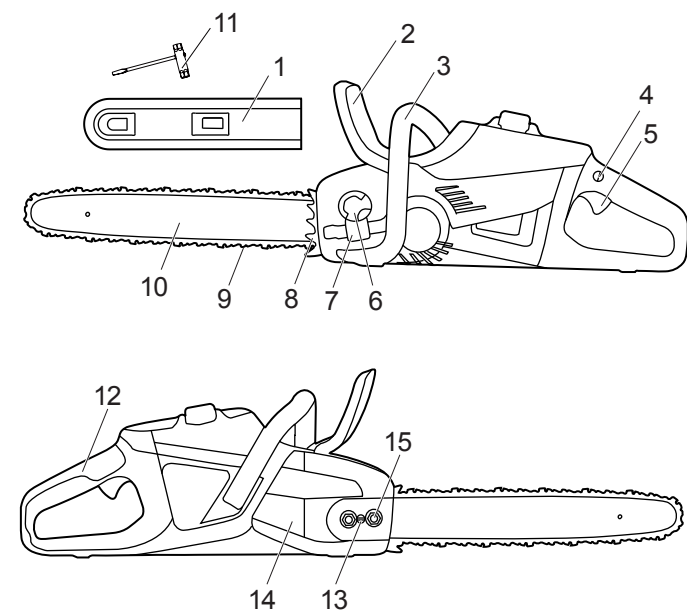

- | | |
|--------------------|-------------------------|
| 1. Scabbard | 9. Chain |
| 2. Chain brake | 10. Guide bar |
| 3. Front handle | 11. Wrench |
| 4. Lock out button | 12. Rear handle |
| 5. Trigger | 13. Chain tension screw |
| 6. Oil cap | 14. Chain cover |
| 7. Oil window | 15. Chain cover nuts |
| 8. Bucking spikes | |

INSTALLATION

Add oil

2

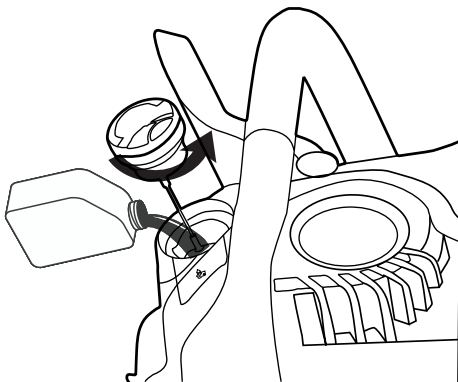

Assemble the bar and chain

3

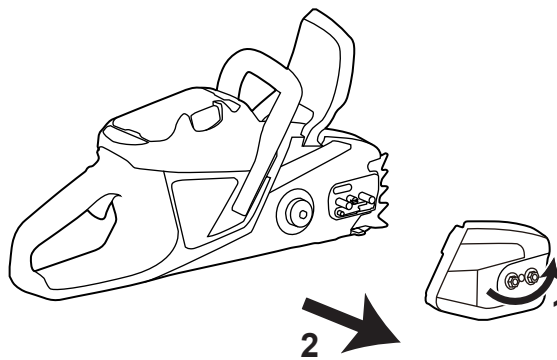

Ensure the chain is put on in the correct direction, do not assemble with the cutters backwards.

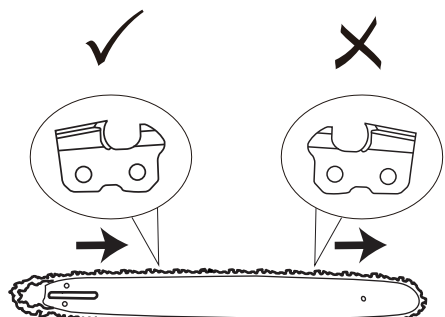

Europe
www.greenworkstools.eu



USA
www.greenworkstools.com



Canada
www.greenworkstools.ca

4

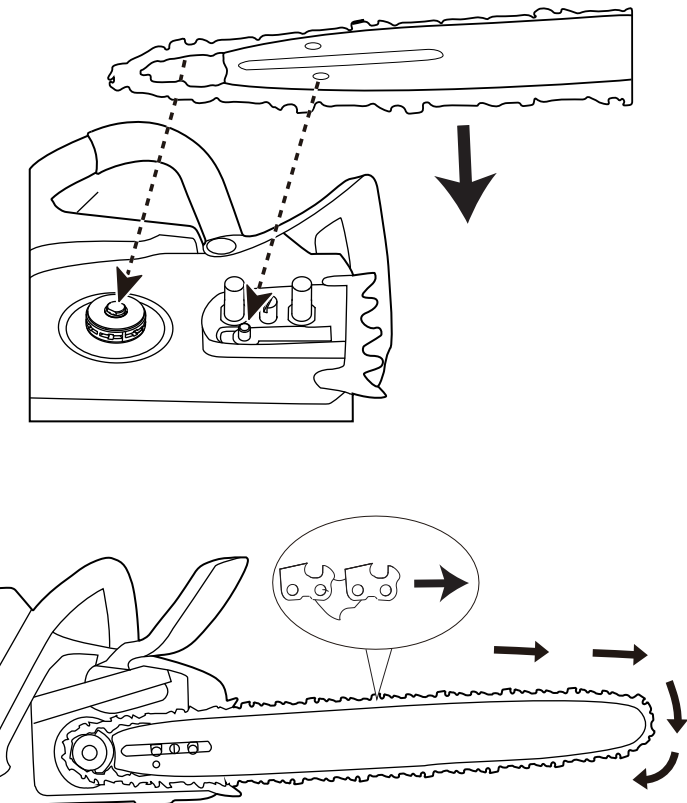

5

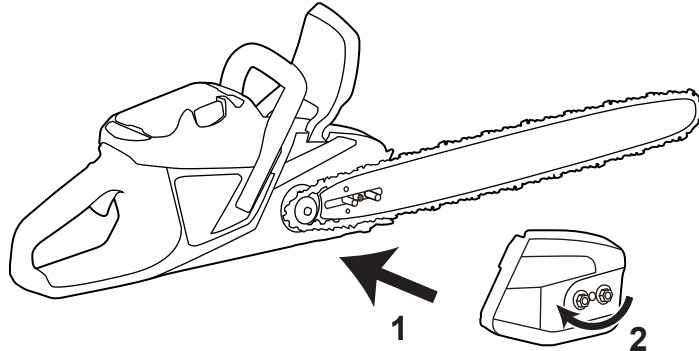

Install the battery pack

6

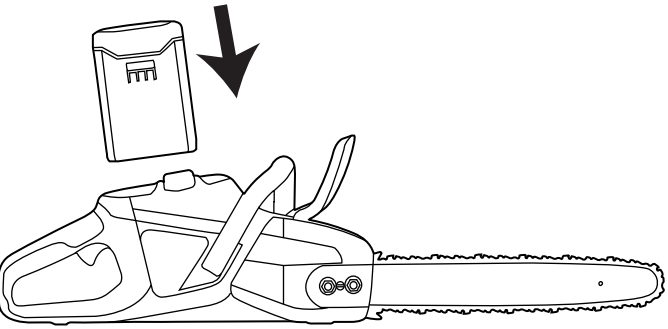

OPERATION

Start the machine

7

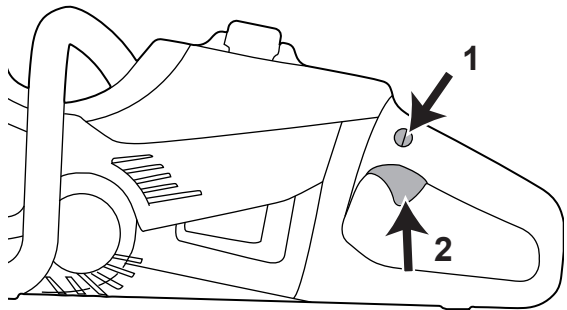

Operate the chain brake

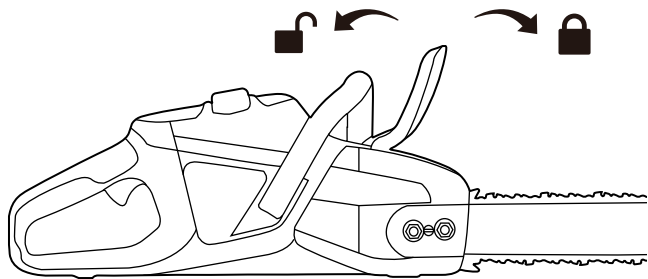

MAINTENANCE

Adjust the chain tension

Loosen the chain cover nuts slightly.

11

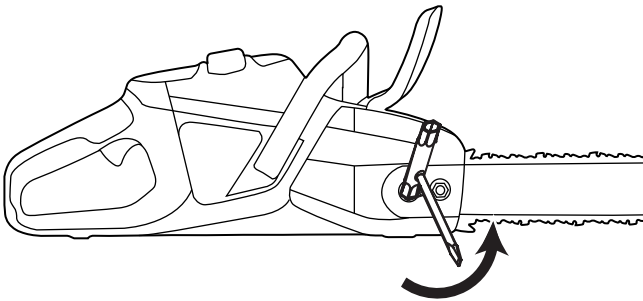

Fell a tree

8

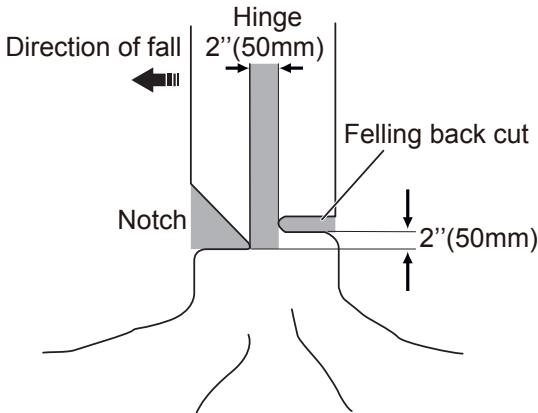
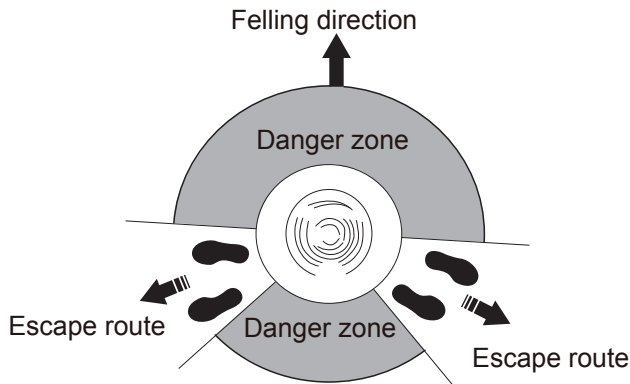

Limb a tree

9



Buck a log

10

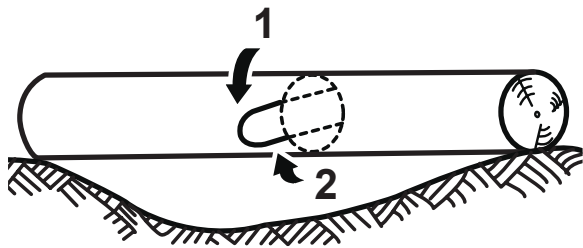
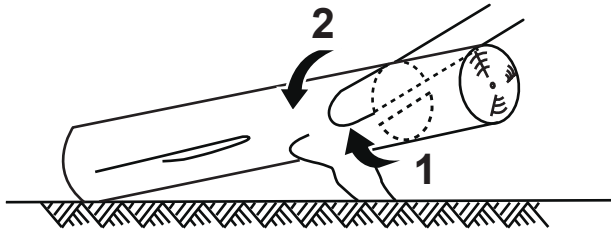
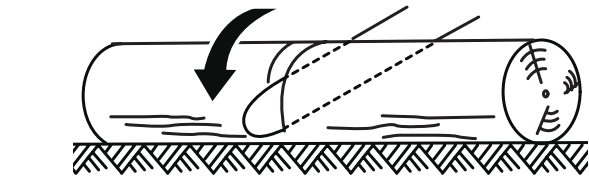

Sharpen the cutters

13

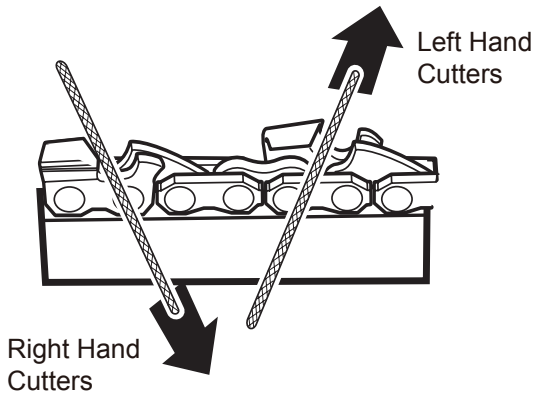
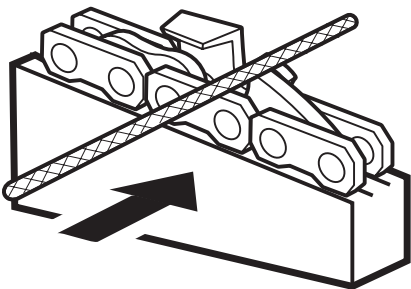

Guide bar maintenance

Remove burr from the edges.

14

