

The Greenworks logo is displayed within a black, rounded hexagonal background. The word "greenworks" is written in a white, lowercase, sans-serif font, with a small trademark symbol (TM) positioned above the letter 's'.

Electric Snow Thrower

2600202

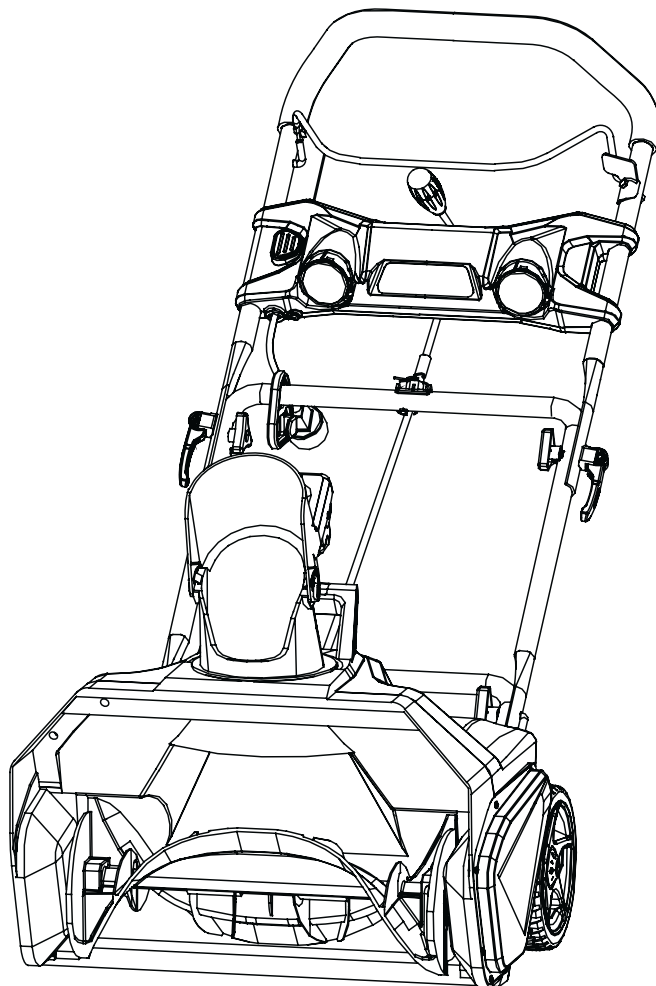

c [®] us
218549



Owner's Manual

TOLL-FREE HELPLINE: 1-888-90WORKS (888.909.6757)

www.GreenWorksTools.com

 Read all safety rules and instructions carefully before operating this tool.

CONTENTS

Contents	2
Product specifications.....	2
Safety information.....	3-5
Symbols	6-7
Electrical	8-9
Know your snow thrower	10
Assembly	11-15
Operation	16-20
Maintenance	21-24
Troubleshooting	25
Warranty	26
Exploded View / Parts List.....	27-29

PRODUCT SPECIFICATIONS

ELECTRIC SNOW THROWER

Motor	120 V, 60 Hz, 13 A
No-load speed.....	2,600 RPM
Working width.....	20" (50.8 cm)
Wheels	7" (17.8 cm)
Weight	33 lbs (15 kg)



SAFETY INFORMATION

FOLLOW THESE RULES WHILE OPERATING THE SNOW THROWER

IMPORTANT

READ AND UNDERSTAND ALL INSTRUCTIONS. Failure to follow all instructions listed below may result in electric shock, fire, and/or serious personal injury.

- Walk. Do not run.
- Verify that the snow thrower is not in contact with anything before turning it on.
- Stay away from the discharge chute and impeller openings at all times. Keep face, hands, and feet away from concealed, moving, or rotating parts.
- Be attentive when using the snow thrower, and stay alert for holes in the terrain and other hidden hazards or traffic.
- Do not use the snow thrower on a gravel or crushed rock surface. Use extreme caution when crossing gravel/crushed rock drives, walks, or roads.
- Move up and down slopes when clearing snow. Do not go across a slope. Use caution when changing direction. Do not use this snow thrower to clear snow from steep slopes.
- Do not attempt to use the snow thrower on a roof or on any steeply inclined slippery surface.
- Do not operate the snow thrower if the guards, plates, and other safety protective devices are not in place.
- Do not operate the snow thrower near glass enclosures, automobiles, trucks, window wells, drop-offs, etc. without properly adjusting the angle of the snow discharge. Keep children and pets away from the work area.
- Do not force or overload the snow thrower. The snow thrower will perform better and safer when it is used at the rate that it was designed to work at.
- Do not operate the snow thrower at high speeds on slippery surfaces. Look behind when backing up and exercise caution.
- Do not direct the discharge toward anyone. Do not allow anyone to move in front of the snow thrower while it is in use.
- Wear safety glasses or goggles that meet ANSI Z87.1 standards, and wear ear/hearing protection when using this snow thrower.
- Use the snow thrower in daylight or in good artificial light. If using at night, turn on the LED lights and be aware of your surroundings.
- To avoid accidental start-ups, remain in the starting position when turning the snow thrower on. The operator and the snow thrower must be in a stable position during start-up. See the section titled Starting/Stopping Instructions.
- Use this snow thrower only for the purposes it was designed.
- Do not overreach. Always keep proper footing and balance.
- Hold the snow thrower with both hands while it is in use. Keep a firm grip on the handles.
- If the impeller does not rotate freely due to frozen ice, thaw the snow thrower thoroughly before attempting to use it.

SAFETY INFORMATION

- Keep the impeller clear of debris.
- Do not attempt to clear the impeller while the motor is running or while the snow thrower is plugged in it. Turn the motor off and unplug the snow thrower from the extension cord or the outlet.
- Keep clothing and body parts away from the impeller.
- Stop the motor when stopped or when moving from one location to another.
- Unplug the snow thrower when it is being transported and when it is not in use.
- After striking a foreign object, turn the snow thrower off and unplug it, and then inspect it for damage. Repair any damage before restarting and using the snow thrower.
- If the snow thrower starts to vibrate abnormally, stop the snow thrower immediately and attempt to determine the cause. Vibration is generally an indication of danger.
- Stop the motor and unplug the snow thrower whenever the operator is not in the operating position, before unclogging the impeller, and before making any repairs, adjustments, or inspections.
- Do not discharge snow onto public roads or near moving traffic.
- Allow the snow thrower to run for a few minutes after clearing snow in order to prevent moving parts from freezing.
- Only use identical replacement parts and accessories for this snow thrower. The use of nonidentical parts or accessories could lead to serious injury to the user or damage the snow thrower, and will void the warranty.
- Do not pick up the snow thrower while it is plugged and running. The snow thrower is designed to travel along the ground.
- Dress Properly – Do not wear loose clothing or jewelry. They can be caught in moving parts.
- Wear rubber boots when operating the snow thrower.
- Operation of the snow thrower in the hand-held position is unsafe, except in accordance with the special instructions for such use provided in the operator's manual.
- Store Idle Snow Throwers Indoors – When not in use, snow throwers should be stored indoors in dry, locked-up place – out of reach of children.

GENERAL SAFETY RULES

- Verify that the snow thrower is secure while transporting.
- Store the snow thrower in a dry area that will prevent unauthorized use or damage. Keep out of the reach of children.
- DKeep handles dry, clean, and free of debris. Clean the snow thrower after each use. Refer to Maintenance Section in this manual for more information.
- If the labels on the snow thrower become defaced or start to lift off, contact the toll-free helpline, at 1-888-909-6757.
- Keep these instructions in a safe place for future reference. Refer to them often, and use them to instruct other users. Anyone who uses this snow thrower must read these instructions carefully.
- Maintain the snow thrower with care. Follow the instructions for lubricating and changing accessories.

SAFETY INFORMATION

WARNING (PROPOSITION 65)

Some dust created by power sanding, sawing, grinding, drilling and other construction activities contains chemicals known to the state of California to cause cancer, birth defects or other reproductive harm. Some examples of these chemicals are:











- Lead from lead-based paints,
- Crystalline silica from bricks and cement and other masonry products, and
- Arsenic and chromium from chemically-treated lumber.

Your risk from these exposures varies, depending on how often you do this type of work. To reduce your exposure to these chemical: work in a well ventilated area, and work with approved safety equipment, such as those dust masks that are specially designed to filter out microscopic particles.

SAVE THESE INSTRUCTIONS

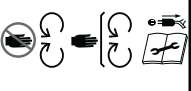

SYMBOLS

Some of the following symbols may be used on this product. Please study them and learn their meaning. Proper interpretation of these symbols will allow you to operate the product better and safer.

SYMBOL	DESIGNATION/EXPLANATION
V	Voltage
A	Current
Hz	Frequency (cycles per second)
min	Time
	Double-insulated construction
AC	Alternating current
RPM	Revolutions per minute
cm	Centimeter
Kg	Kilogram
/min	Revolutions, strokes, surface speed, orbits etc., per minute
	Indicates a potential personal injury hazard.
	To reduce the risk of injury user must read and understand operator's manual before using this product.
	Always wear proper eye and hearing protection.
	Stop the machine before leaving the machine.
	Thrown objects can ricochet and result in personal injury or property damage.
	Danger – Keep hands and feet away from spinning impeller. Spinning impeller can cause severe injury.
	Keep hands, feet away from the discharge area.
	Keep bystanders a safe distance from the machine.
	Stay away from moving parts, keep all guards and shields in place; disconnect power cord from power source and read the instructions before servicing or performing maintenance.
	Do not use a damaged power cord.

SYMBOLS

The following signal words and meanings are intended to explain the levels of risk associated with this product.

SYMBOL	SIGNAL	MEANING
	DANGER	Indicates an imminently hazardous situation, which, if not avoided, will result in death or serious injury.
	WARNING	Indicates a potentially hazardous situation, which, if not avoided, could result in death or serious injury.
	CAUTION	Indicates a potentially hazardous situation, which, if not avoided, may result in minor or moderate injury.
	CAUTION	(Without Safety Alert Symbol) Indicates a situation that may result in property damage.

SERVICE

Servicing requires extreme care and knowledge and should be performed only by a qualified service technician. For service we suggest you return the product to your nearest **AUTHORIZED SERVICE CENTER** for repair. When servicing, use only identical replacement parts.

W A R N I N G

To avoid serious personal injury, do not attempt to use this product until you have read this Owner's Manual thoroughly and understand it completely. If you do not understand the warnings and instructions in this Owner's Manual, do not use this product. Call the Toll-free Helpline (1-888-909-6757) for assistance.

W A R N I N G



The operation of any power tool can result in foreign objects being thrown into your eyes, which can result in severe eye damage. Before beginning power tool operation, always wear safety goggles or safety glasses with side shields and, when needed, a full face shield. We recommend Wide Vision Safety Mask for use over eyeglasses or standard safety glasses with side shields. Always use eye protection which is marked to comply with ANSI Z87.1.

SAVE THESE INSTRUCTIONS

ELECTRICAL

DOUBLE INSULATION

Double insulation is a concept in safety in electric power tools, which eliminates the need for the usual three wire grounded power cord. All exposed metal parts are isolated from the internal metal motor components with protecting insulation. Double insulated tools do not need to be grounded.

WARNING

The double insulated system is intended to protect the user from shock resulting from a break in the tool's internal insulation. Observe all normal safety precautions to avoid electrical shock.

NOTE: Servicing of a product with double insulation requires extreme care and knowledge of the system and should be performed only by a qualified service technician. For service, we suggest you return the product to your nearest authorized service center for repair. Always use identical factory replacement parts when servicing.

ELECTRICAL CONNECTION

This product has a precision-built electric motor. It should be connected to a power supply that is 120 volts, 60 Hz, AC only (normal household current). Do not operate this product on direct current (DC). A substantial voltage drop will cause a loss of power and the motor will overheat. If the product does not operate when plugged into an outlet, double-check the power supply.

EXTENSION CORDS (See Figure 1)

When using a power tool at a considerable distance from a power source, be sure to use an extension cord that has the capacity to handle the current the product will draw. An undersized cord will cause a drop in line voltage, resulting in overheating and loss of power. Use the chart to determine the minimum wire size required in an extension cord. Only round jacketed cords listed by Underwriter's Laboratories (UL) should be used.

When working outdoors with a product, use an extension cord that is designed for outside use. This type of cord is designated with "WA" on the cord's jacket.

Before using any extension cord, inspect it for loose or exposed wires and cut or worn insulation.

It is possible to tie the extension cord and power cord in a knot to prevent them from becoming disconnected during use. Make the knot as shown in figure 1, then connect the plug end of the power cord into the receptacle end of the extension cord. This method can also be used to tie two extension cords together.

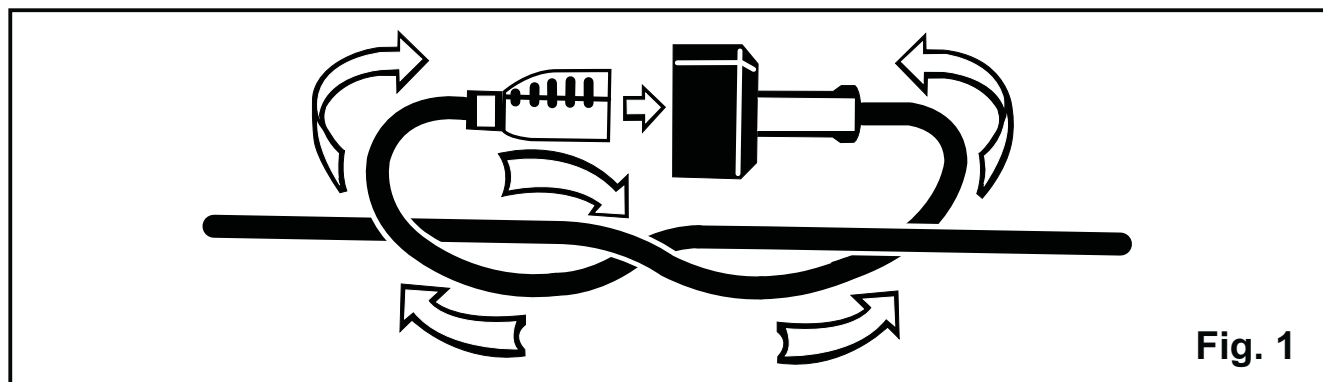

ELECTRICAL

**Ampere rating (on product data plate)

	0-2.0	2.1-3.4	3.5-5.0	5.1-7.0	7.1-12.0	12.1-16.0
Cord Length	Wire Size (A.W.G.)					
25'	16	16	16	16	14	14
50'	16	16	16	14	14	12
100'	16	16	14	12	12	—

**Used on 12 gauge - 20 amp circuit.

NOTE: AWG = American Wire Gauge

WARNING

Keep the extension cord clear of the working area. Position the cord so that it will not get caught on lumber, tools, or other obstructions while you are working with a power tool. Failure to do so can result in serious personal injury.

- Inspect the extension cord and the power cord on a regular basis. Look for deterioration, cuts, or cracks in the insulation. Inspect the connections for damage. Repair or replace the extension cord or the power cord if any damage is found.
- Verify that the impeller and all moving parts have come to a complete stop, and disconnect the snow thrower from the power supply in order to prevent accidental start-ups before cleaning or performing any inspections or repairs.
- Do not abuse the extension cord. Do not carry the snow thrower by the power cord or pull on the cord in order to disconnect it from the receptacle.
- Keep the extension cord away from heat, oil, and sharp edges in order to prevent damage.
- If the extension cord is damaged in any manner while it is plugged in, disconnect it from the outlet immediately.
- Prevent any possible disconnection of the power cord from the extension cord while the snow thrower is in use by using the cord retainer. Refer to the section entitled Using the Cord Retainer.
- Unplug the snow thrower and allow it to cool down before putting it into storage. Store the snow thrower indoors.
- Unplug the snow thrower when it is not in use and before performing any maintenance or repairs.

SAVE THESE INSTRUCTIONS

KNOW YOUR SNOW THROWER

Read this operator's manual and safety rules before operating your snow thrower. Compare the illustration in Figure 2 to your snow thrower in order to familiarize yourself with the location of various controls and adjustments. Save this manual for future reference.

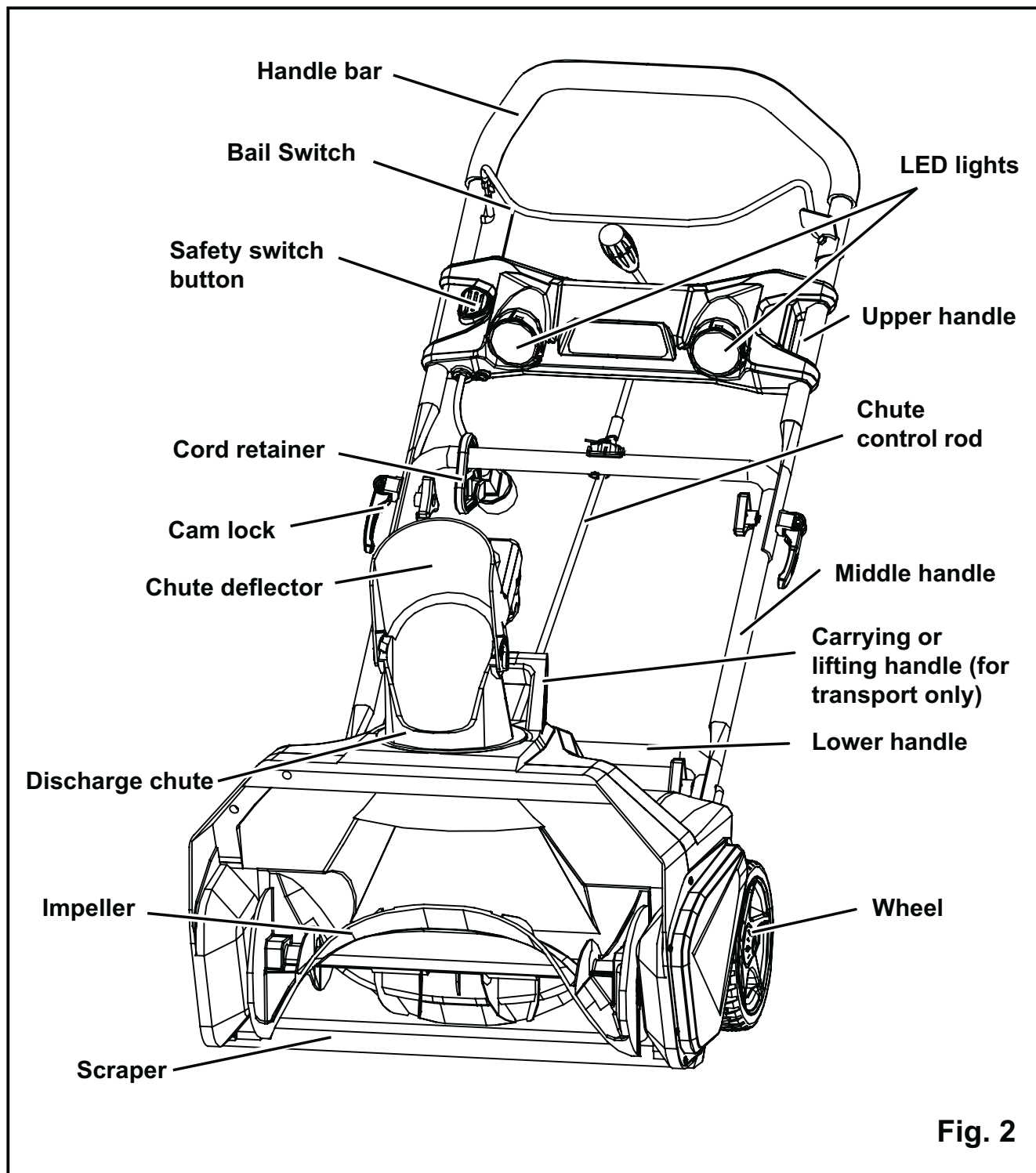

ASSEMBLY INSTRUCTIONS

UNPACKING

- Carefully remove the product and any accessories from the box. Make sure that all items listed in the packing list are included.
- Inspect the product carefully to make sure no breakage or damage occurred during shipping.
- Do not discard the packing material until you have carefully inspected and satisfactorily operated the product.
- If any parts are damaged or missing, please call 1-888-909-6757 for assistance.

PACKING LIST

- Snow thrower
- Upper chute control rod
- Lower chute control rod
- Middle handle assembly
- Chute deflector
- (2) Cam locks
- (2) Bolts
- (4) Handle Knobs
- (1) Hitch pin
- Owner's Manual

WARNING

If any parts are damaged or missing, do not operate this product until the parts are replaced. Failure to heed this warning could result in serious personal injury.

WARNING

Do not connect to power supply until assembly is complete. Failure to comply could result in accidental starting and possible serious personal injury.

WARNING

Do not attempt to modify this product or create accessories not recommended for use with this product. Any such alteration or modification is misuse, and could result in a hazardous condition leading to possible serious personal injury.

ASSEMBLY INSTRUCTIONS

⚠ WARNING

Do not allow familiarity with this product to make you careless. Remember that a careless fraction of a second is sufficient to inflict serious injury.

⚠ WARNING

Do not use any attachments or accessories not recommended by the manufacturer of this product. The use of attachments or accessories not recommended can result in serious personal injury.

ASSEMBLING THE HANDLE (See Figure 3)

- Align the holes (4) on the middle handle (2) and the lower handle (3). Insert the bolts (5), and use the handle knobs (6) to tighten them.
- Align the hole (7) on the middle handle (2) and the upper handle (1). Insert the cam locks (8) and tighten them with the handle knobs (9) provided. Once tightened, close the cam locks to secure them in place.

NOTE: If the upper handle is loose or separated from the middle handle, tighten the cam lock handle knobs by turning them clockwise. Do not overtighten the handle knobs.

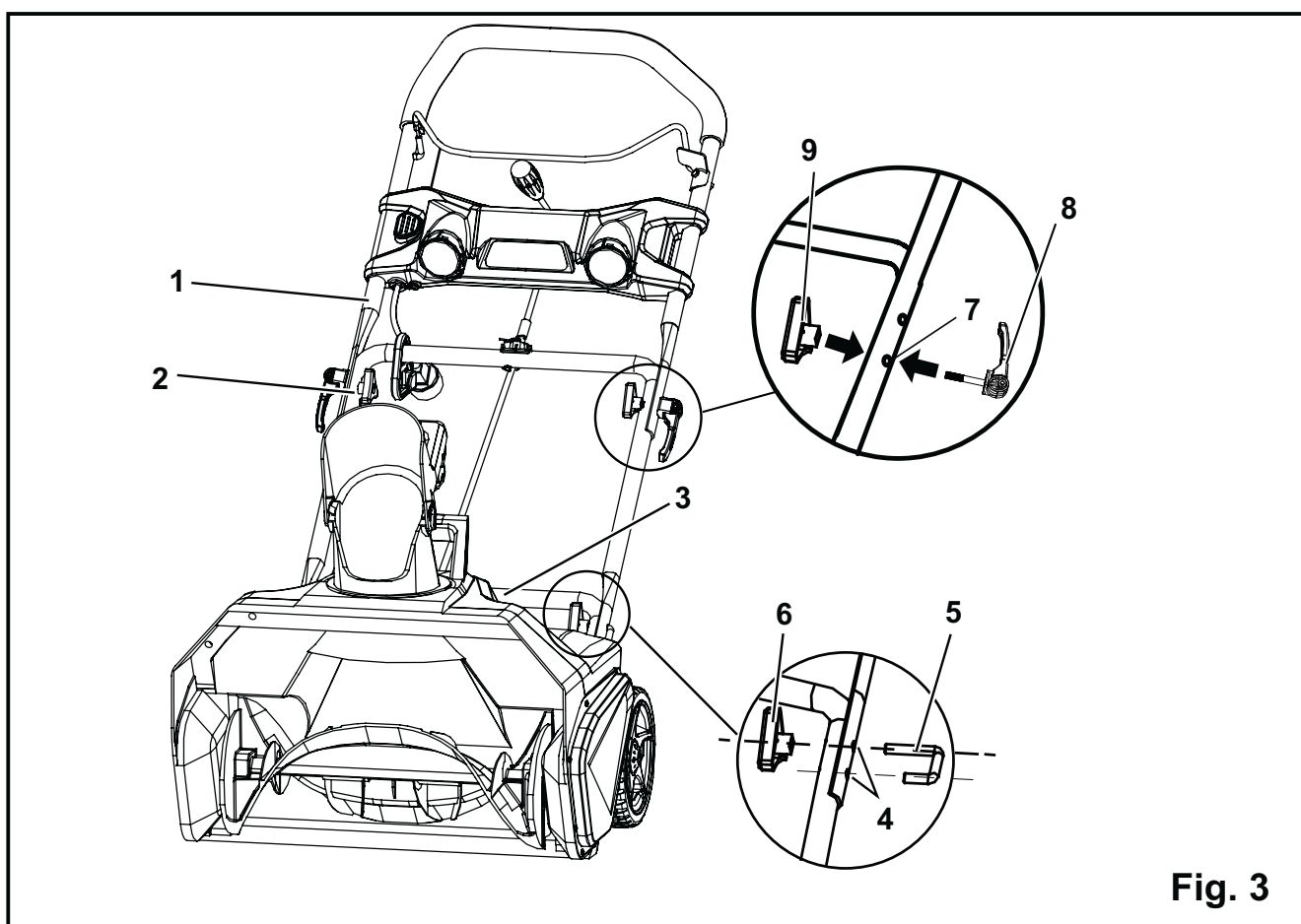

ASSEMBLY INSTRUCTIONS

ASSEMBLING THE DISCHARGE CHUTE (See Figure 4)

- Push the chute deflector (1) until the latching tabs (2) on either side click into the slots (3) and the posts (4) on either side click into the keyed holes (5).

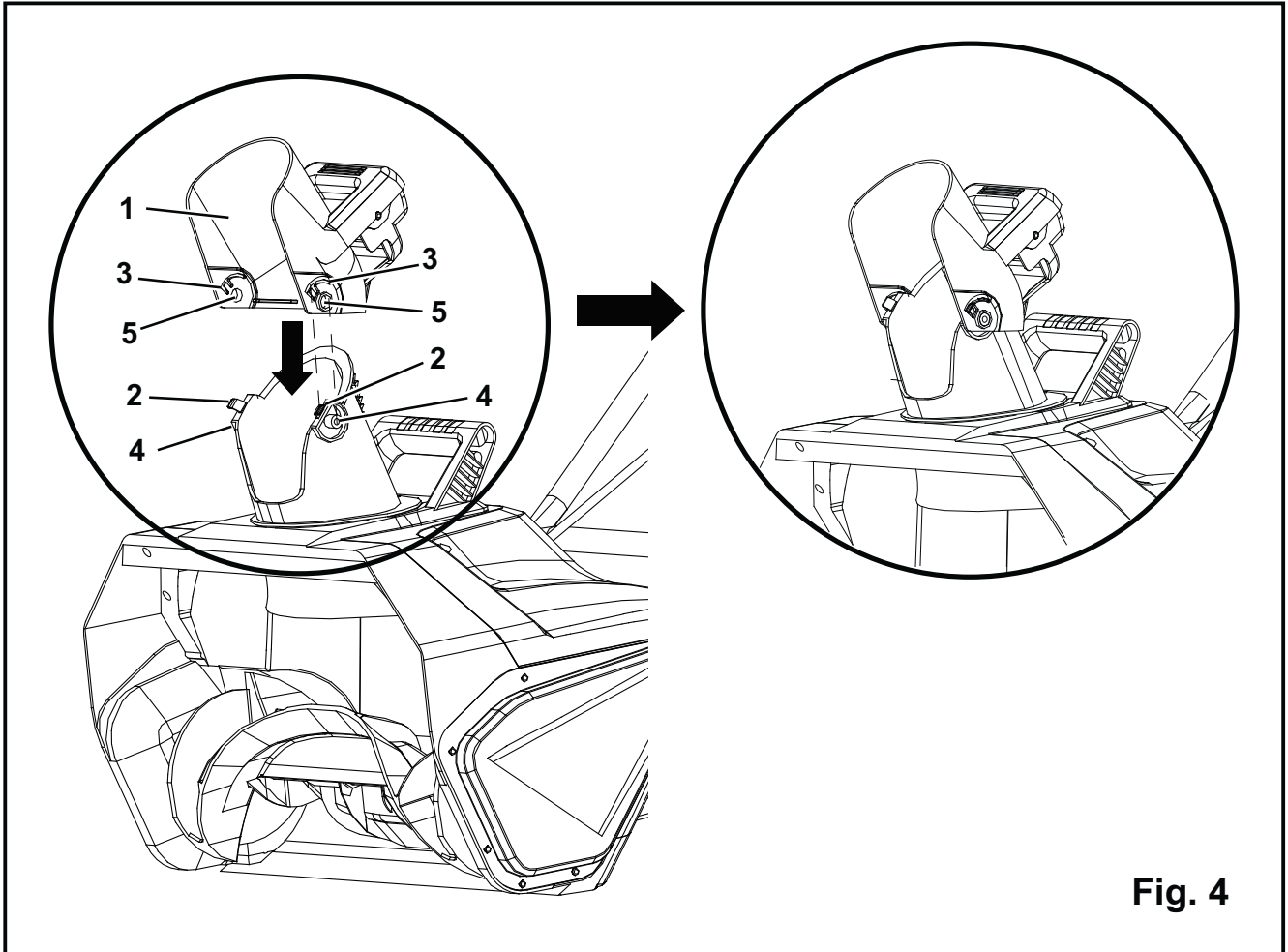

ASSEMBLY INSTRUCTIONS

INSTALLING THE CHUTE CONTROL ROD (See Figure 5-8)

- Position the discharge chute (1) so that it faces forward.

NOTE: Align the arrow (2) on the discharge chute with the arrow on the housing. (Fig. 5)

- Align the holes (3) on the upper chute control rod (4) with the holes on the lower chute control rod (5). Insert the hitch pin (6). Insert the end of the chute control rod (7) through the keyed hole (8) in the bracket that is attached to the top of the middle handle. (Fig. 6)
- Ensure that the handle (9) of the chute control rod points upward, and insert the rod into the keyed hole (10) in the back of the housing. (Fig. 7)
- Firmly push the rod into the keyed hole in the back of the housing until it snaps into place.

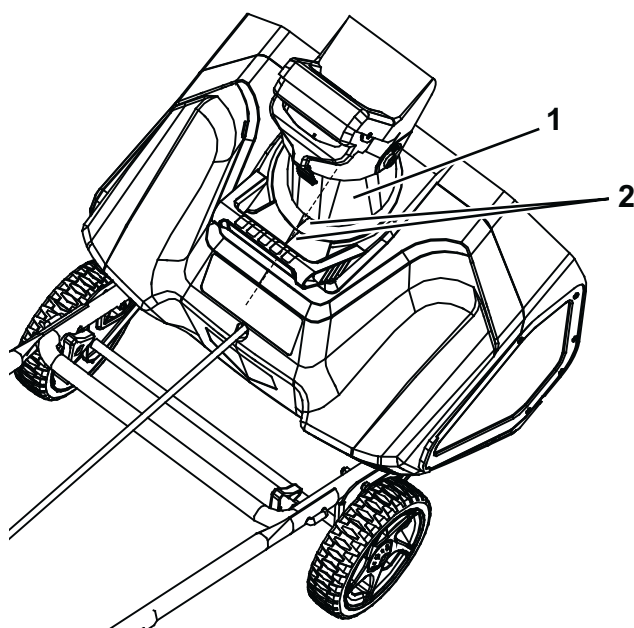

Fig. 5

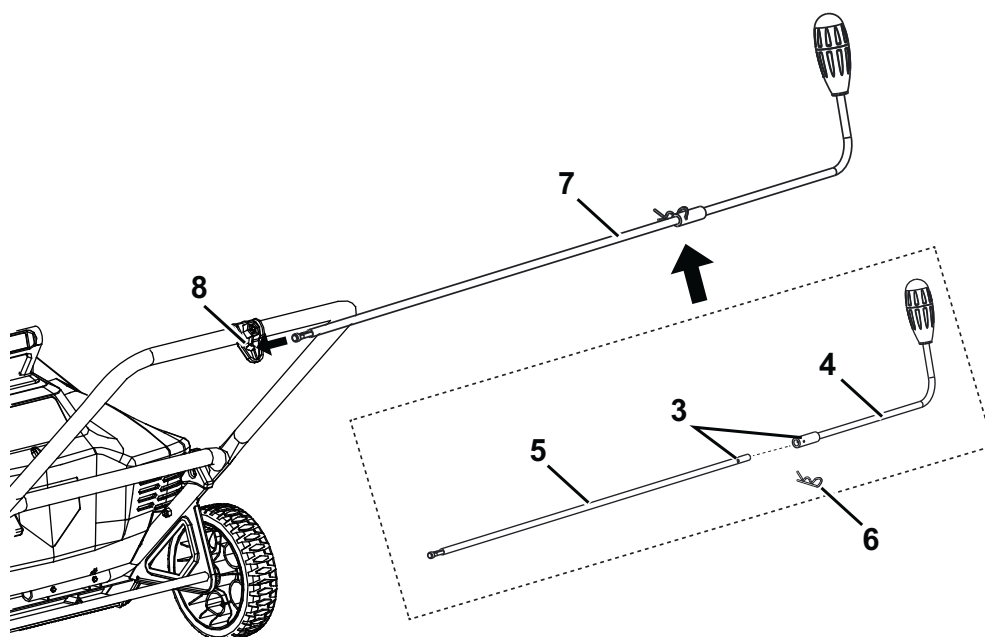
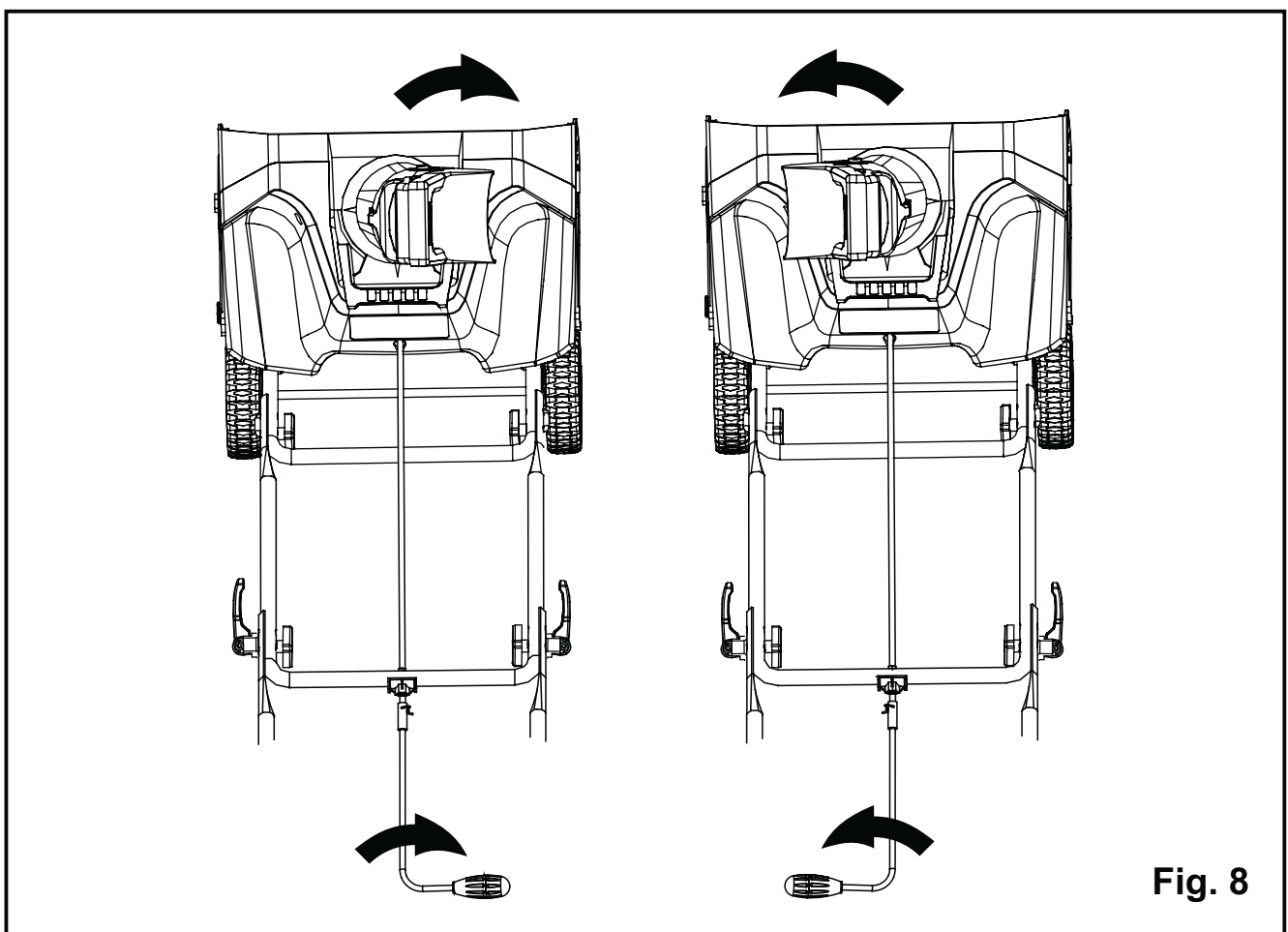
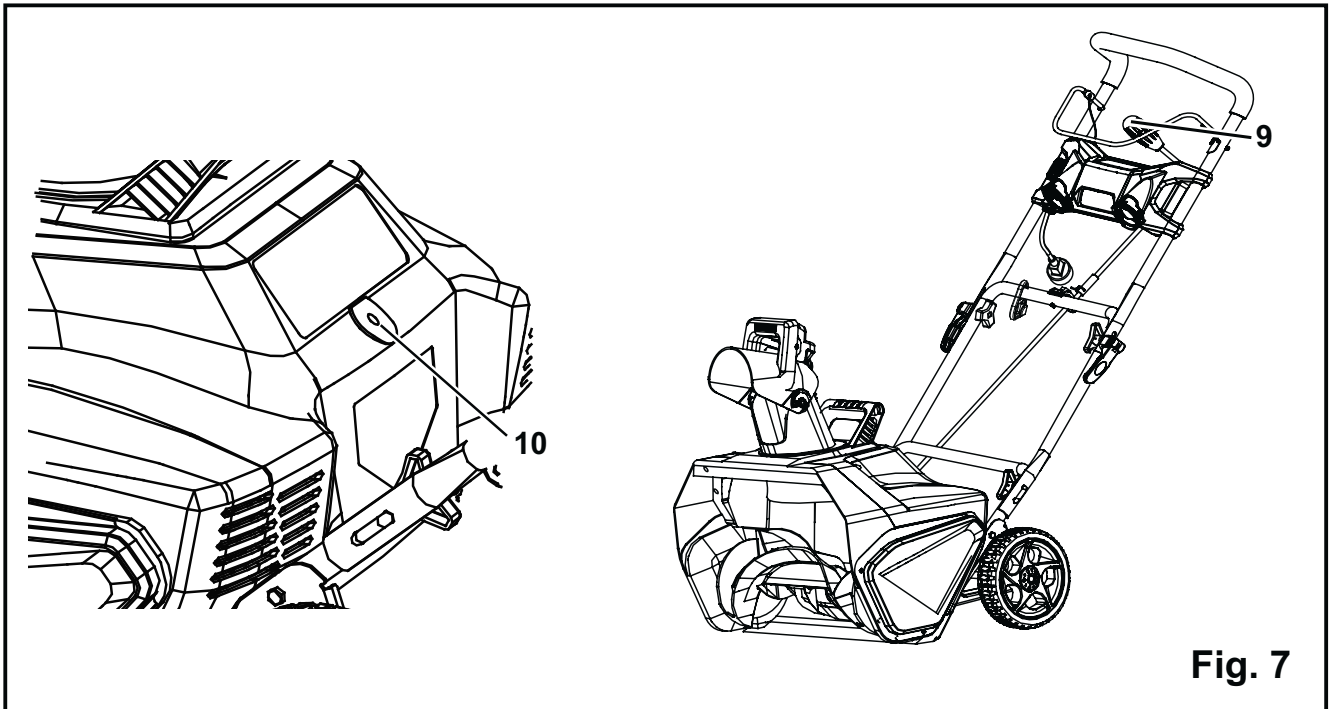

Fig. 6

ASSEMBLY INSTRUCTIONS

- Rotate the handle on the chute control rod to ensure that it moves in the same direction as the chute. (Fig. 8)



OPERATING INSTRUCTIONS

STARTING THE SNOW THROWER

⚠ WARNING

Avoid accidental start-ups. Verify that the operator is in the starting position when using the snow thrower. In order to avoid serious injury, the operator and unit must be in a stable position when starting the snow thrower.

POWERING ON AND OFF (See Figure 9)

- To power on, first press the safety switch button (1).
- While pressing the safety switch button with one hand, use your other hand to simultaneously pull the bail switch (2) toward you. Once the machine powers on, release the safety switch button and proceed with operation. The snow thrower can only be started by pressing the safety switch button first, followed by squeezing the bail switch; reverse operation will not start the machine.
- To power off, release your grip on the bail switch.

NOTE: A high-pitched noise and sparking may occur as the electric motor decelerates. This is normal.

⚠ CAUTION

Do no attempt to override the operation of the bail switch.

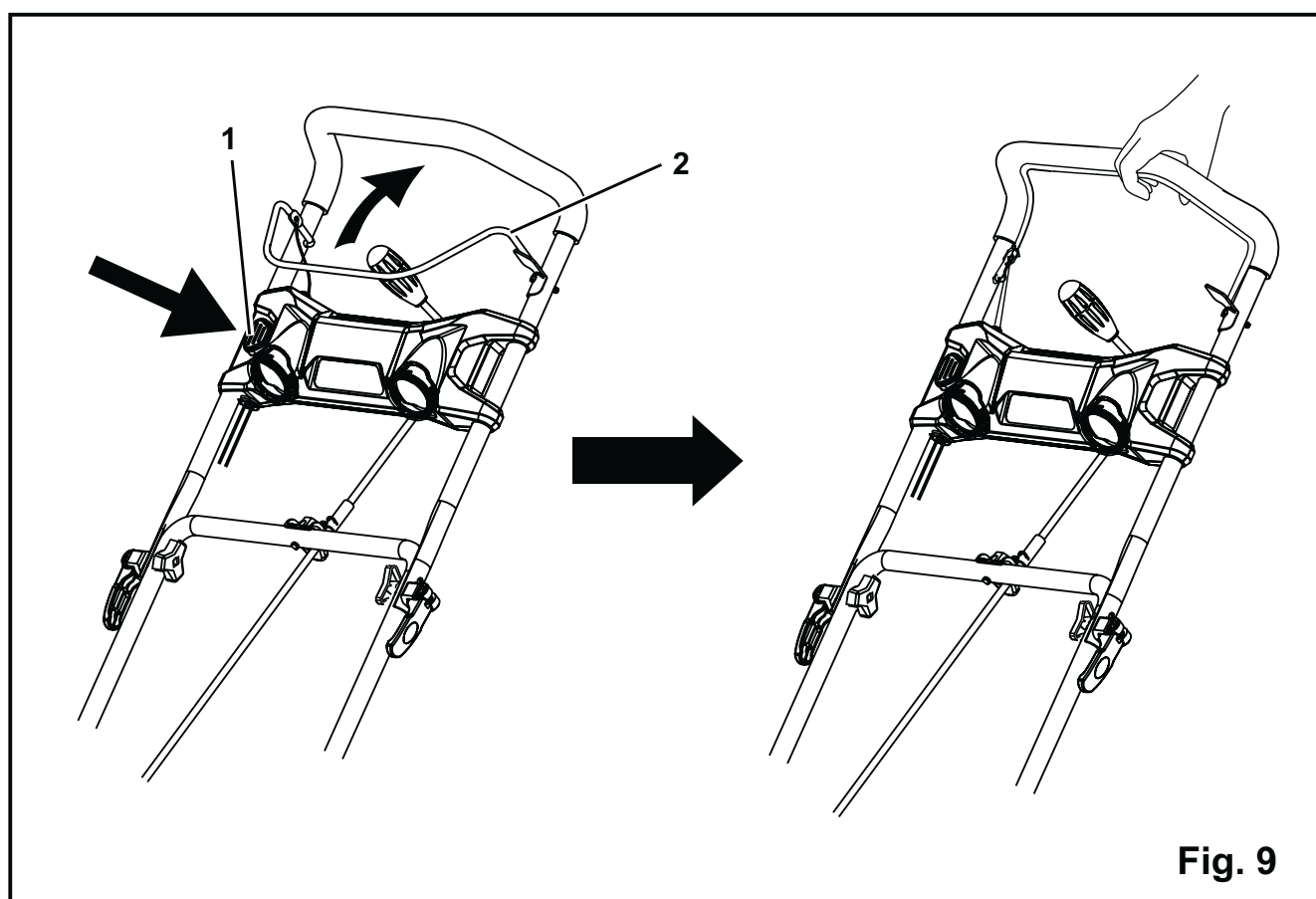

OPERATING INSTRUCTIONS

USING THE CORD RETAINER (See Figure 10)

This snow thrower is equipped with a cord retainer (1) in order to prevent the extension cord from disconnecting from the power cord while the snow thrower is in use. The cord retainer hangs from the cord guide bar.

NOTE: Do not plug the extension cord into the outlet until it has been connected to the cord retainer and plugged into the snow thrower.

To use the cord retainer:

- Fold the extension cord to form a tight loop near the retainer.
- Push the loop through the bottom hole in the retainer.
- Slide the loop over the retaining clip, and pull until the cord is secured.

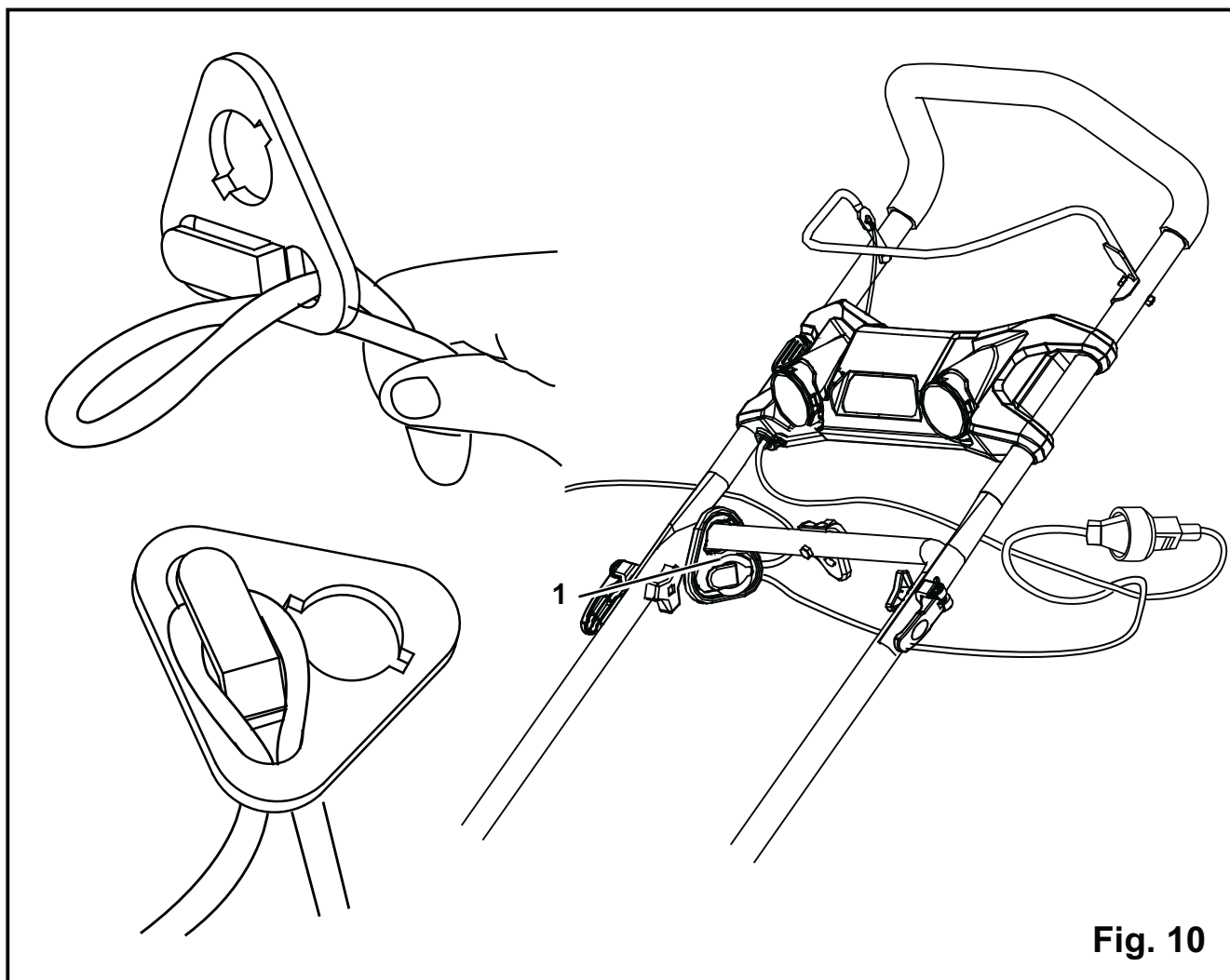

OPERATING INSTRUCTIONS

ADJUSTING THE DISCHARGE CHUTE AND CHUTE DEFLECTOR (See Figure 11)

⚠ WARNING

If there is a gap between the discharge chute and the chute deflector, snow and anything else that can be picked up by snow thrower may fly in the direction of the operator. Thrown objects could cause serious personal injury.

- To adjust the discharge chute, rotate the handle (1) on the chute control rod in the direction that you wish to direct the snow stream.
- To adjust the chute deflector (and therefore the height of the snow stream), squeeze the trigger (2) and raise or lower the chute deflector.

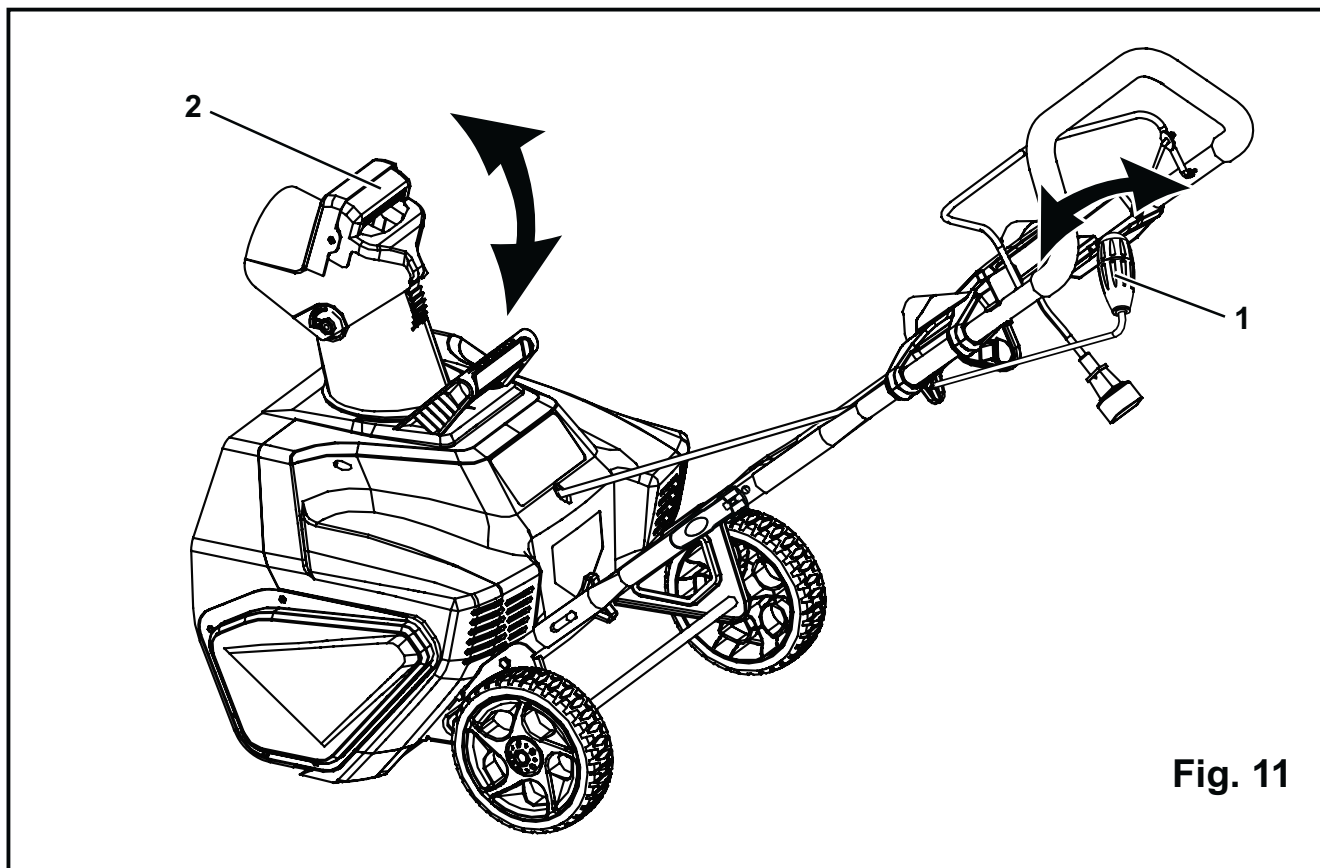

Fig. 11

OPERATING INSTRUCTIONS

UTILIZING THE LED LIGHTS (See Figure 12)

- To utilize the LED lights (1) for night time snow removal, activate the LED light switch (2) .

NOTE: After you have finished using your snow thrower, remember to turn off the light switch.

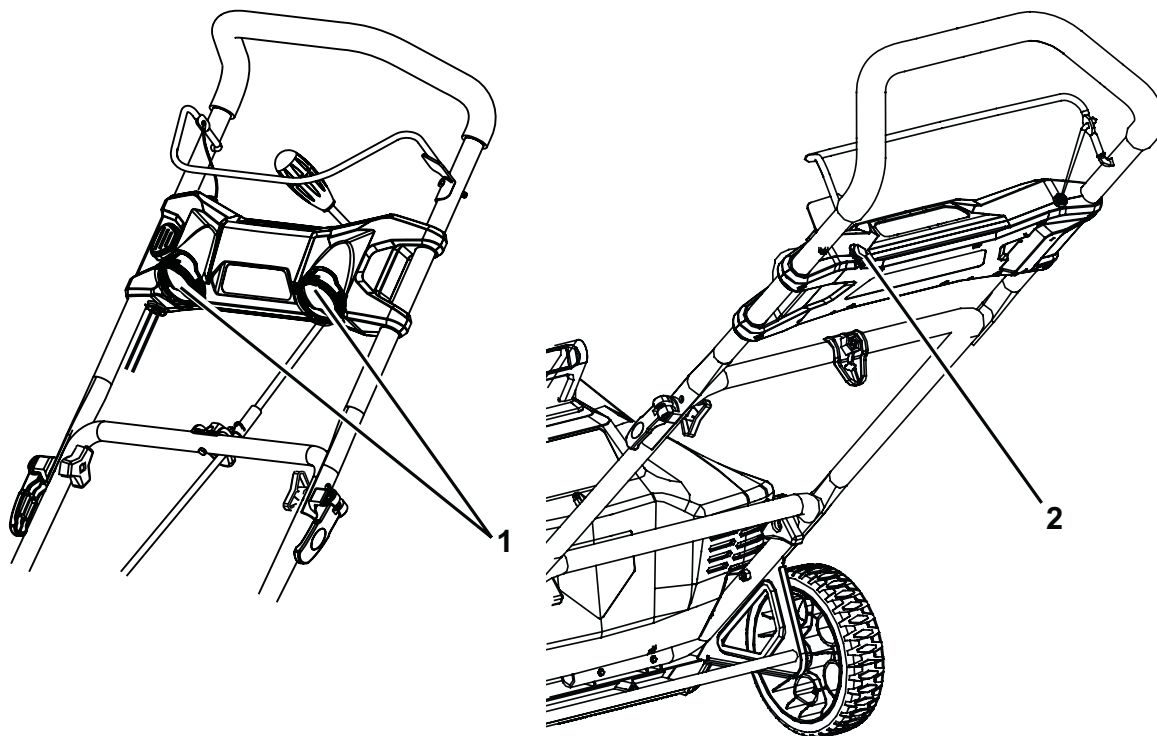

Fig. 12

OPERATING INSTRUCTIONS

OPERATING TIPS

W A R N I N G

If the snow thrower hits a foreign object while it is in use, the object could be thrown in the direction of the operator or a bystander. Thrown objects could cause serious personal injury. Keep the area to be cleared free of all foreign objects that may be picked up and thrown by the impeller.

- Keep children and pets away from the operating area.
- Keep the area to be cleared free of stones, toys, or other foreign objects that the impeller can throw. Such items may be covered by a snowfall and go unnoticed. If the snow thrower strikes an obstruction or a foreign object during operation, stop the snow thrower, unplug the extension cord, remove the obstruction, and inspect the snow thrower for damage.
- Do not force the chute deflector too far forward so that a gap appears between the discharge chute and the chute deflector.
- Begin removing snow near the electrical outlet, and work outward. Work back and forth, and not away from or toward the outlet.
- When turning at the end of a swath, step over the cord, and then turn the snow thrower.
- Overlap each swath, and discharge the snow the same direction of the wind whenever possible.
- Shave down large banks of snow by placing the snow thrower on the bank. Allow the weight of the snow thrower to shave down the bank in a back-and-forth motion.
- Keep the extension cord clear of obstructions, sharp objects, and all moving parts. Do not pull sharply on the cord or abuse it in any manner. Inspect the extension cord for damage that may result in an electric shock on a regular basis. If the extension cord becomes damaged in any way, replace it immediately.
- Some controls and moving parts may freeze in certain cold and snowy weather conditions. If any of the controls become hard to operate, stop the motor, disconnect the extension cord, and inspect the snow thrower for frozen parts.
- Do not use excessive force when trying to operate frozen controls. Free all of the controls and moving parts before using the snow thrower.
- After clearing the snow, allow the motor run for a few minutes so that the ice doesn't freeze any moving parts. Then shut off the motor, wait for all moving parts to come to a complete stop, and wipe the ice and snow off the snow thrower. Rotate the discharge chute several times in order to remove the snow from the discharge chute..
- Disconnect the extension cord when storing the snow thrower.

MAINTENANCE

SERVICING

Servicing should be performed by a qualified technician. Replacement parts for this snow thrower must be identical to the parts that they replace. If repairs are necessary, contact the Toll-Free Helpline, at 1-888-909-6757.

Note: Identify the left and right sides of the snow thrower when standing in the normal operating position.

⚠ WARNING

If the extension cord is plugged into the Snow Thrower, the snow thrower could start accidentally while the operator is performing maintenance on it, which could cause serious personal injury. Disconnect the extension cord before performing any maintenance.

REPLACING THE SCRAPER (See Figure 13)

The scraper is located at the bottom of the impeller housing.

- Ensure that the snow thrower is not plugged in.
- Remove the screw (1) from each side plate that holds the scraper and 3 screws (2) from under the machine that secures the scraper to the machine.
- Remove and discard the old scraper.
- Install the new scraper, and fasten it securely with the 5 screws that you previously removed.

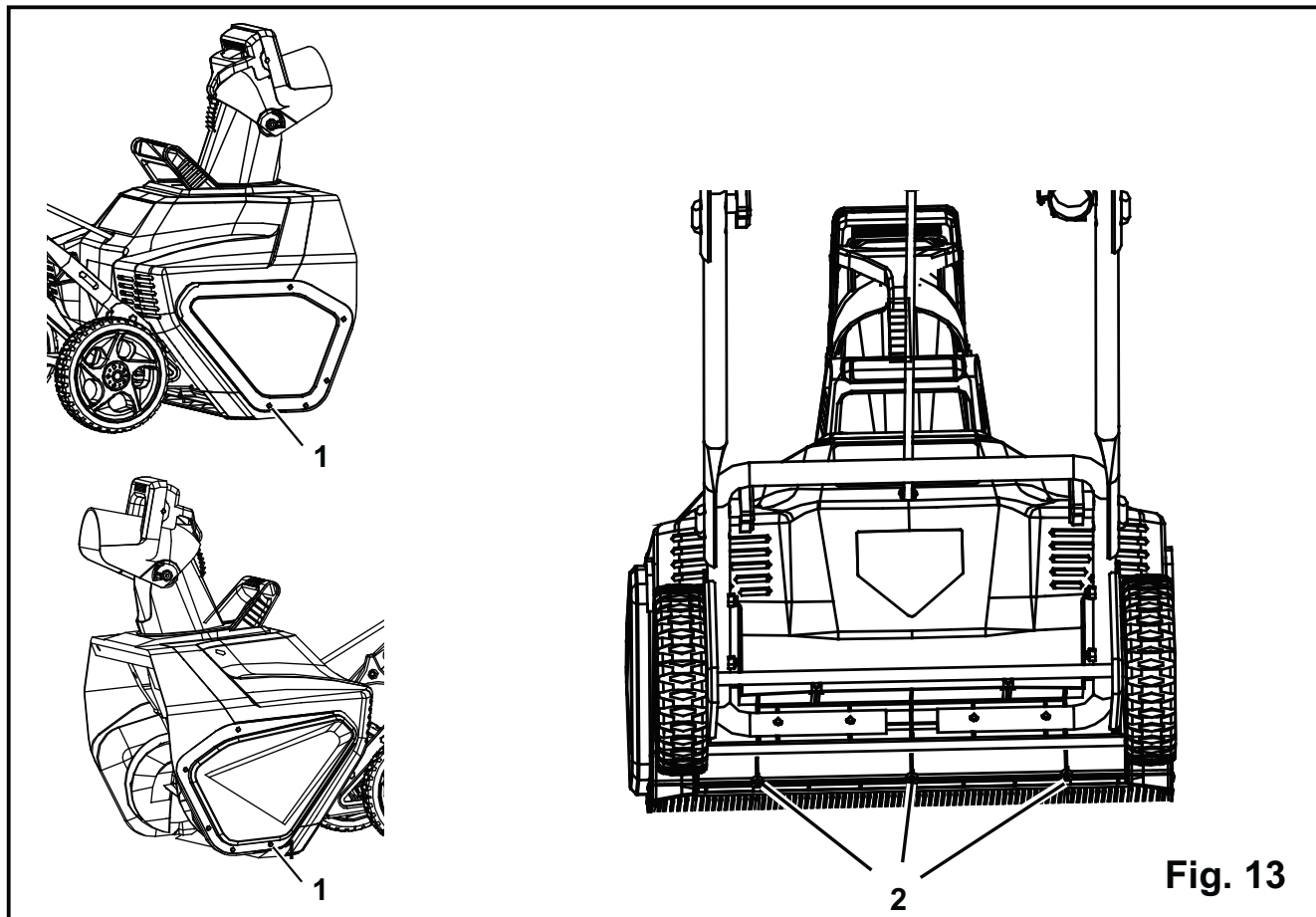
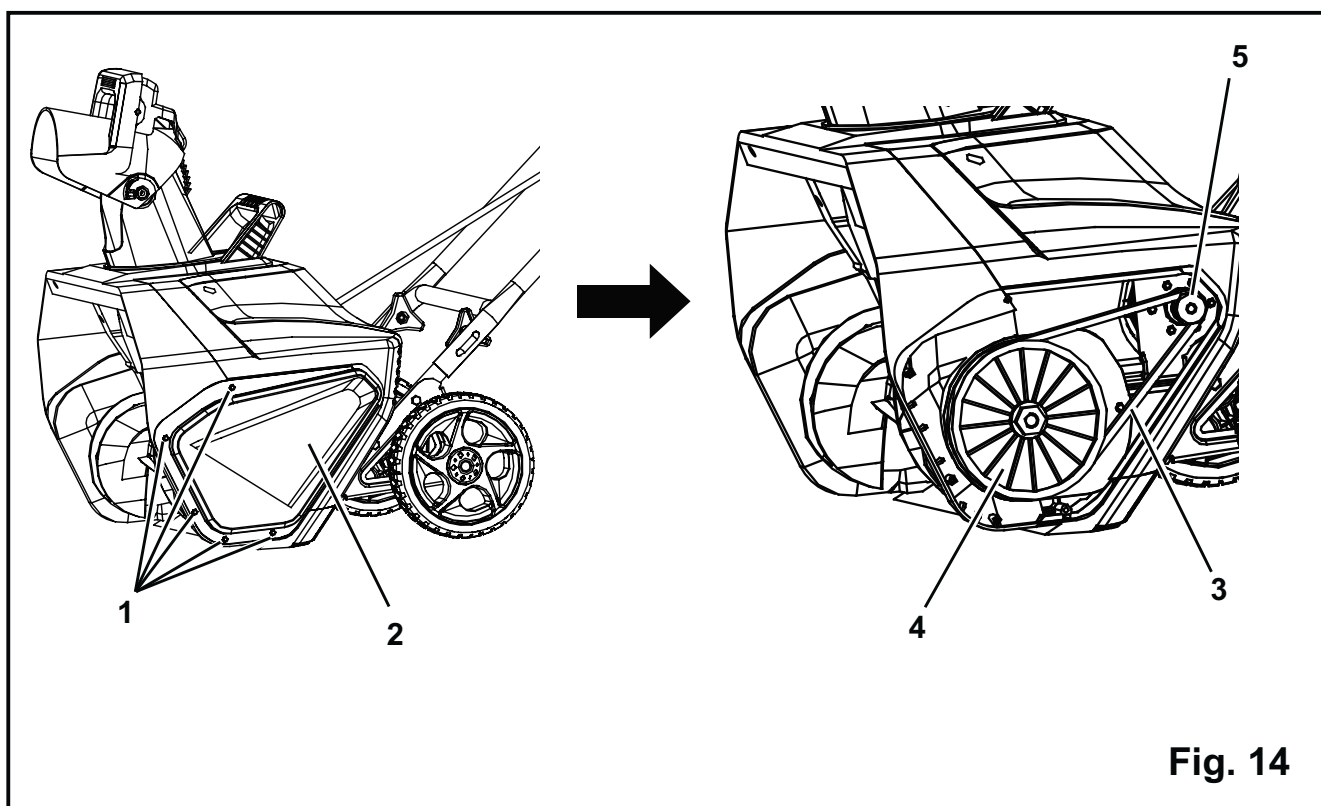

Fig. 13

MAINTENANCE

REPLACING THE DRIVE BELT (See Figures 14)

- Ensure that snow thrower is not plugged in.
- Remove the 5 screws (1) that secure the left side plate (2) to the frame of the snow thrower. Remove the side cover.
- Remove the old belt (3) from the small pulley (5) and large pulley (4).
- Loop one end of the new belt over the small pulley.
- Rotate the impeller with the left hand while positioning the belt on the large pulley with the right hand.
- Install the left side cover, and secure it using the 5 screws that you previously removed.



MAINTENANCE

REPLACING THE IMPELLER (See Figures 15)

- Remove the 5 screws (1) that secure the right side cover (2) to the frame of the snow thrower.
- Remove the nut (3).
- Remove the 5 screws (4) that secure the left side cover (5) to the frame of the snow thrower.
- Remove the belt (6).
- Using a socket wrench, remove the the large pulley (7).
- Remove the 5 screws (8) that secure the left side plate (9) and remove the left side plate.
- Pull the axle (10) and remove the old impeller (11).
- Install the new impeller.
- Reinstall the left side plate, large pulley, belt and left side cover.
- Reinstall the nut and right side cover.

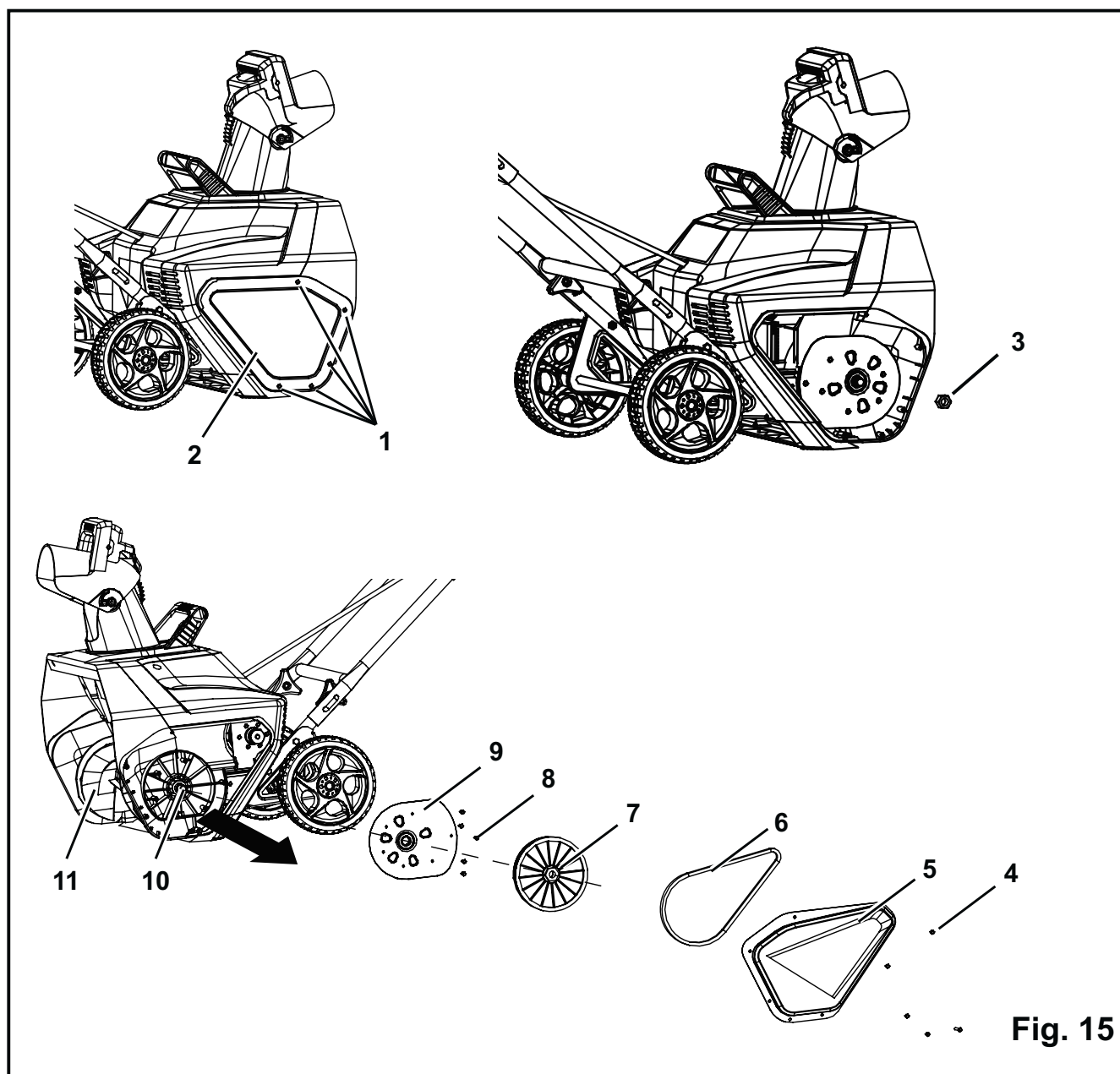

MAINTENANCE

STORAGE

- Run the snow thrower for a few minutes in order to melt any snow that may be left on the snow thrower.
- Wipe the snow thrower off with a dry cloth before storage. This will help prevent ice building up on the unit and parts freezing.
- Disconnect the extension cord from the snow thrower.
- Inspect the extension cord thoroughly for signs of wear or damage. Replace it if it is worn or damaged.
- Inspect the snow thrower thoroughly for worn, loose, or damaged parts. If any parts must be repaired or replaced, contact the toll-tree helpline, at 1-888-909-6757.
- Store the extension cord with the snow thrower.
- Store the snow thrower in a clean, dry place. Cover it in order to provide added protection.

TROUBLESHOOTING

PROBLEM	POSSIBLE CAUSE	SOLUTION
Then handle is not in position.	The bolts are not properly seated.	Make sure the bolts are correctly installed through the handle bars. Check to see if the hand knobs are tight. Refer to Assembling the Handle section in this manual.
The Snow Thrower does not start.	The switch is defective.	Have the switch replaced by an authorized service center.
	The extension cord is not connected to the plug.	Connect the plug on the snow thrower to the extension cord.
	The extension cord is not connected to the power source.	Plug the extension cord into a live 120 V AC, 60 Hz outlet.
The motor is on, but the impeller does not turn.	The belt is damaged.	Replace the belt (see the section entitled Inspecting/Replacing the Drive Belt).
The snow thrower leaves a thin layer of snow behind.	The scraper is worn.	Inspect the scraper for wear or damage. Replace the scraper (see the section entitled Replacing the Scraper).

LIMITED FOUR-YEAR WARRANTY



GREENWORKS™ hereby warrants this product, to the original purchaser with **proof of purchase**, for a period of four (4) years against defects in materials, parts or workmanship. GREENWORKS™, at its own discretion will repair or replace any and all parts found to be defective, through normal use, free of charge to the customer. This warranty is valid only for units which have been used for personal use that have not been hired or rented for industrial/commercial use, and that have been maintained in accordance with the instructions in the owners' manual supplied with the product from new.

ITEMS NOT COVERED BY WARRANTY:

1. Any part that has become inoperative due to misuse, commercial use, abuse, neglect, accident, improper maintenance, or alteration; or
2. The unit, if it has not been operated and/or maintained in accordance with the owner's manual; or
3. Normal wear, except as noted below;
4. Routine maintenance items such as impeller, blade sharpening;
5. Normal deterioration of the exterior finish due to use or exposure.

GREENWORKS HELPLINE (1 888 90WORKS):

Warranty service is available by calling our toll-free helpline, 9am to 5pm EST. Monday – Friday at **1 888 909 6757 (1 888 90WORKS)**.

TRANSPORTATION CHARGES:

Transportation charges for the movement of any power equipment unit or attachment are the responsibility of the purchaser. It is the purchaser's responsibility to pay transportation charges for any part submitted for replacement under this warranty unless such return is requested in writing by GREENWORKS.

EXPLODED VIEW / PARTS LIST

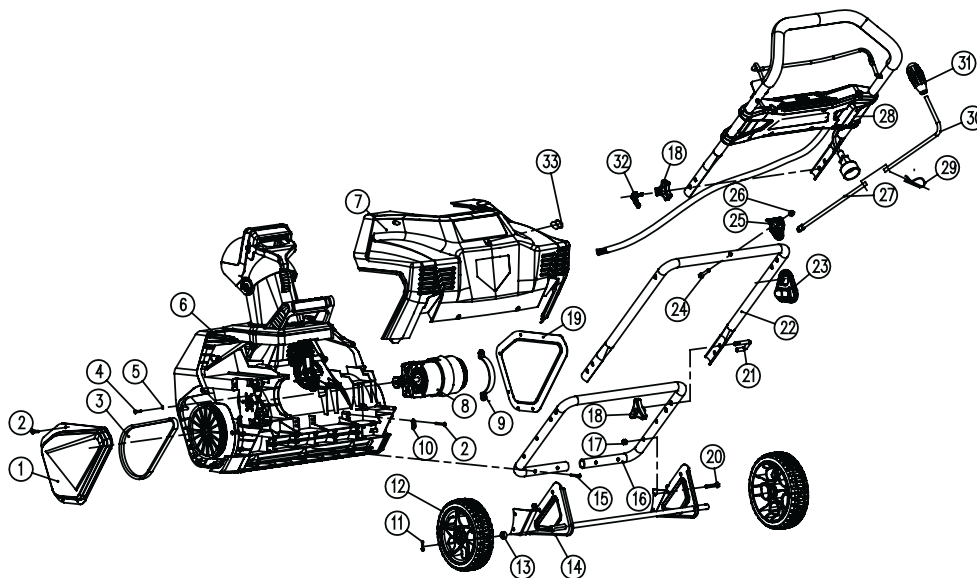

ITEM NO.	PART NO.	DESCRIPTION	QTY
1	332041205-2	Left side cover	1
2	32205877	Screw	20
3	329151205	Belt	1
4	32203100	Screw M5x15	4
5	3290250	Washer	4
6	311011206	Front cover assembly	1
7	341021205-4	Rear cover	1
8	361011210	Motor	1
9	332101210	Motor clamp	1
10	3410801	Wire clamp	1
11	3290135	Split pin	2
12	311031206	7" wheel assembly	2
13	332151205	Rubber sleeve	2
14	332021205	Wheel bracket assembly	1
15	32201699	Screw	4
16	333031205-2	Lower handle	1
17	32222301A	Nut M6	4
18	3410835-20	Knob	4
19	332051205-2	Right side cover	1
20	32204234	Bolt M6x35	4
21	333041205	U bolt	4
22	333021205	Middle handle	1
23	34120227	Cord retainer	1
24	32215301A	Screw	1
25	341131205-4	Bracket for the chute control rod	1
26	32219121	Nut	1
27	333111205-2	Lower chute control rod	1
28	311041206	Handle bar assembly	1
29	3320643	Hitch pin	1
30	333201205	Upper chute control rod	1
31	311051206	Handle for chute control rod	1
32	31102467-2	Cam lock assembly	2
33	342011205	Rubber bushing	1

EXPLODED VIEW / PARTS LIST

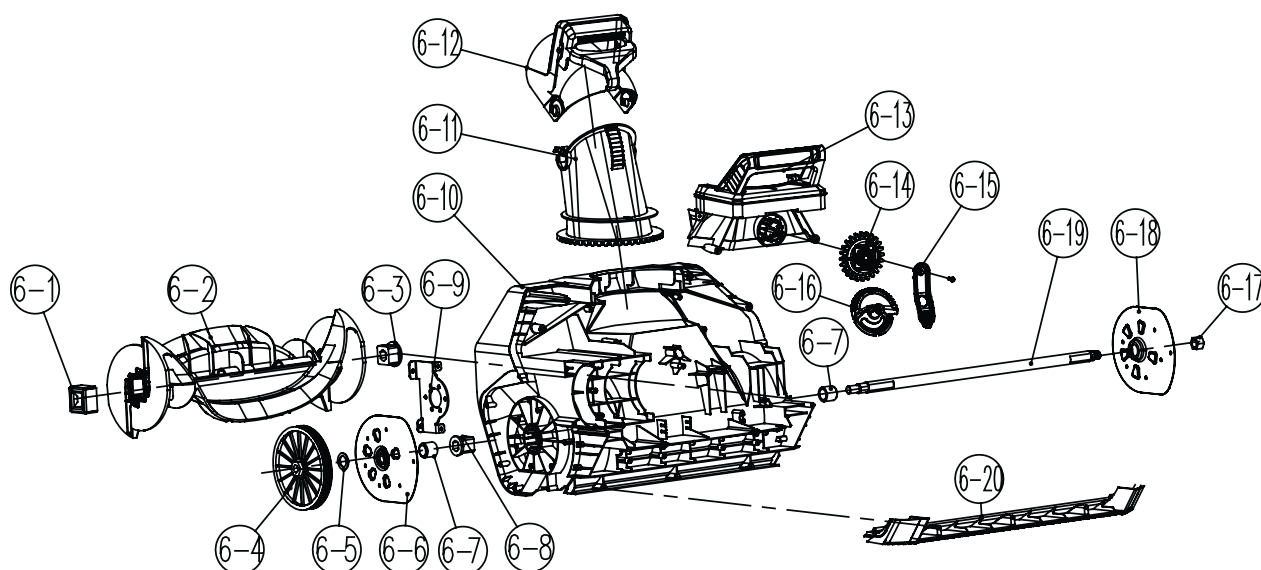

ITEM NO.	PART NO.	DESCRIPTION	QTY
6	311011206	Front cover assembly	1
6-1	332061205	Link block	1
6-2	341171205	Impeller	1
6-3	339011205	Right driving block	1
6-4	34109100-12	Drive wheel	1
6-5	32217100	Washer	1
6-6	311111205	Left side plate	1
6-7	332111205	Bushing	2
6-8	339021205	Left driving block	1
6-9	332011206	Motor support	1
6-10	341011205-4	Front cover	1
6-11	341031205-4	Discharge chute	1
6-12	31121206	Chute deflector	1
6-13	341061205-4	Discharge chute base	1
6-14	341071205	Small gear	1
6-15	341091205	Gear seat	1
6-16	341081205	Big gear	1
6-17	32902250A	Nut M12	1
6-18	311131205	Right side plate	1
6-19	332121205	Axle for the impeller	1
6-20	341111205-4	Scraper	1

EXPLODED VIEW / PARTS LIST

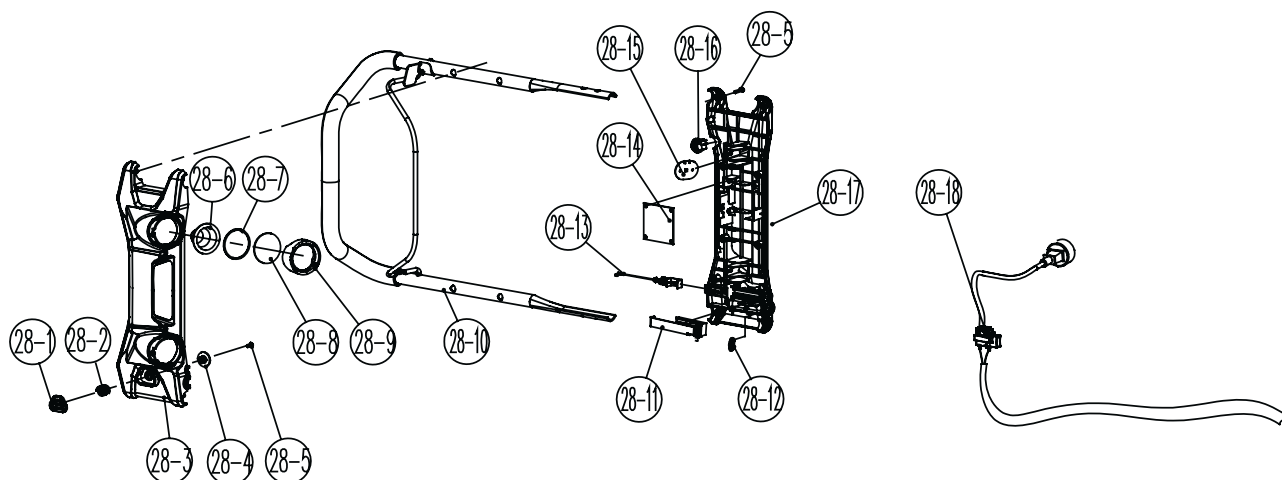

ITEM NO.	PART NO.	DESCRIPTION	QTY
28	311041206	Handle bar assembly	1
28-1	34136486-2	Safety switch button	1
28-2	33401229A	Spring	1
28-3	341141205-4	Faceplate	1
28-4	341201205	Switch pressure head	1
28-5	32205877	Screw	17
28-6	333011108	Parabolic reflector	2
28-7	342011108	Rubber gasket	2
28-8	341051108	Lamp screen	2
28-9	341061108-3	Light head housing	2
28-10	311071206	Upper handle assembly	1
28-11	311081205	Slider block assembly	1
28-12	3410801	Wire clamp	2
28-13	311091205	Start cable assembly	1
28-14	362021205	Circuit board	1
28-15	362011108	LED and aluminum substrate	2
28-16	363051205	Switch	1
28-17	341151205-4	Lower cover	1
28-18	311101206	Cord plug assembly	1



TOLL-FREE HELPLINE: 1-888-90WORKS (888.909.6757)

Rev: 01 (08-01-14)

 Printed in China on 100% recycle material