

# XT8000EFI

ELECTRONIC FUEL INJECTION  
Portable Generator

**GENERAC**<sup>®</sup>



Reliable and Efficient Portable Power and Performance

# XT8000EFI

## ELECTRONIC FUEL INJECTION PORTABLE GENERATOR 10,000 Starting Watts, 8,000 Running Watts

Equipped with automotive technology and a load pickup response system that delivers smooth and steady power at all times, Generac's XT8000EFI portable generator offers hassle-free operation in a variety of outdoor settings. Thanks to a carburetor-free design, the XT8000EFI uses Electronic Fuel Injection to eliminate issues caused by bad fuel and pesky gum-ups when the unit is in storage. To further optimize performance, the XT8000EFI also features idle control, which conserves fuel for extended run times. Other distinctive attributes includes a ControlGuard™ that protects the unit's control panel from Mother Nature's worst, a PowerBar™ to monitor load demands and an hour meter to keep close tabs on maintenance intervals. Whether you're enjoying the great outdoors or simply seeking a backup plan when utility power is lost in your local area, the XT8000EFI can provide the power on which you've come to rely.

### FEATURES AND BENEFITS



# CONTROL PANEL FEATURES

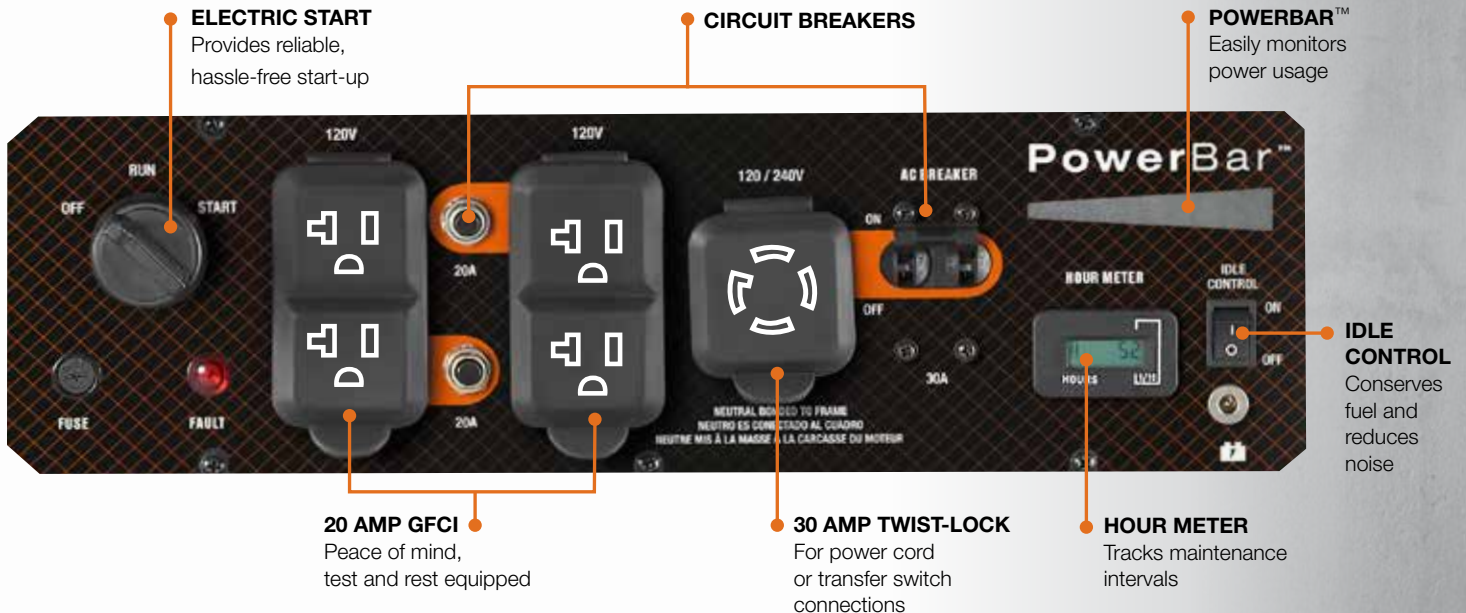

## HOW MUCH POWER DO YOU NEED?

Sizing a portable generator is easy. Check out this sample:

- 1 CHOOSE WHICH DEVICES YOU WANT TO POWER AT THE SAME TIME.**
- 2 RECORD AND ADD THE RUNNING WATTS LISTED FOR EACH DEVICE THAT YOU NEED TO POWER.**
- 3 RECORD THE STARTING WATTS LISTED FOR EACH DEVICE.**
- 4 SELECT THE ONE DEVICE WITH THE HIGHEST STARTING WATTS. ADD THAT NUMBER TO THE TOTAL RUNNING WATTS TO DETERMINE THE TOTAL WATTAGE REQUIREMENT.**

DEVICE	RUNNING WATTS	ADDITIONAL STARTING WATTS	GENERATOR SIZE
Air Compressor - 1 HP	1600	2900	Minimum starting watts for your needs ↓ <b>9500</b> Starting watts
Circular Saw 15 Amp	1800	2300	
Microwave	1000		
Refrigerator/Freezer	700	2200	
LCD TV	450		
SUMP PUMP 1/2 HP	1050	2150	
<b>Total</b>	<b>6600 +</b>	<b>2900 =</b>	

	DEVICE	RUNNING WATTS	ADDITIONAL STARTING WATTS
JOB SITE	Air Compressor - 1 HP	1600	2900
	Air Compressor - 1/2 HP	1000	2000
	Airless Paint Sprayer - 1/3 HP	600	1200
	Belt Sander - 3"	1200	2400
	Bench Grinder - 8"	1400	1100
	Circular Saw - 7-1/4"	1800	2300
	Hand Drill - 1/2"	600	900
	Hand Drill - 3/8"	400	600
	Miter Saw - 10"	1800	1800
	Quartz Halogen Work Light	1000	-
	Reciprocating Saw	960	-
	Table Saw, 10"	2000	2000
	Electric Hedge Trimmer	400	-
	Electric Line Trimmer - 9"	350	-
	Electric Chain Saw - 12" (1/2HP)	900	-
HOUSEHOLD	Computer with a 17" Monitor	800	-
	Microwave - 1000 Watts	1000	-
	Refrigerator/Freezer	700	2200
	Sump Pump 1/2 HP	1050	2150
	Television - 27"	500	-
	Well Pump - 1/2 HP	1000	2100
	Central AC - 24,000 BTU	3800	4950
	Furnace Fan Blower - 1/2 HP	875	2300
	Heat Pump	4700	4500
	Space Heater	1800	-
RECREATION	Window AC - 12,000 BTU	3250	3950
	AM/FM Radio	100	-
	CD / DVD Player	100	-
	Cell Phone Battery Charger	25	-
	Inflator Pump	50	150
RV Air Conditioner (13,500 BTU)	1500	700	

\*Watts listed are approximate. Check your appliance for actual requirements. Total wattage requirements assumes intermittent starting of devices.

# XT8000EFI

## ELECTRONIC FUEL INJECTION PORTABLE GENERATOR



### SPECIFICATIONS

SERIES	XT8000EFI
Model Number (EPA/CARB-California)	7162
Running Watts	8000
Starting Watts	10000
Engine Type	Electronic Fuel Injection (EFI)
Engine Displacement	459cc
Starting Method	Electric/Recoil Pull Start
Low Oil Pressure Shutdown	Yes
Battery Included	Yes
Fuel Tank Capacity	8.0 Gallons
Fuel Gauge	Built-in Tank
Run Time @ 50% Load	9.5 Hrs
Idle Control	Yes
Total Harmonic Distortion	< 5%
Hour Meter	Yes
Rated Voltage	120/240V
Outlets	(2) 120V 20A GFCI 5-20R Duplex (1) 120/240V 30A L14-30R Twist Lock
Covered Outlets	Yes
Handle Style	Single Folding
Wheel Size	10" Solid Wheels
Dimensions (L x W x H)	32.7" x 27.6" x 27.7"
Weight	216
Commercial Warranty	1 Year Limited
Residential Warranty	2 Year Limited