

FIT[®] Series

Low profile HRV and ERV



1

SLIM PROFILE

The compact design allows for clean installation in tight spaces without compromising quality and performance.

- **FIT 120E** 8 3/4" (h)
- **FIT 120H** 10 1/4" (h)

2

NO DRAIN

The **FIT 120E** doesn't require a drain line in order for an easier installation.

3

G90 GALVANIZED HOUSING

The stronger G90 galvanized construction makes the unit more durable than other lightweight products.

4

QUICK INSTALLATION

The exclusive Fantech ceiling bracket allows for the easiest and fastest mounting of any ventilator on the market.

5

EASY ACCESS LATCHES

The design utilizes 2 latches for quickly accessing internal components for cleaning and maintenance.

Fantech’s, newest, low profile **FIT Series** is ideally suited for condos, apartments and single family homes that have no mechanical room, where it must be located within a false ceiling.

FIT 120H
Heat Recovery Ventilator

During winter, fresh incoming air is tempered by the heat that is transferred from the outgoing air so you save on energy costs, while during summer, the incoming air is pre-cooled if the house is equipped with an air cooling system. The model is equipped with automatic defrost mechanisms so you can use your HRV all year round.

- Ideal for apartment buildings and false ceiling applications
- Superior heat and/or energy transfer capability in a smaller package
- All serviceable internal components such as a core, filters, fans and electronic board are easily accessible and can be fully removed
- No drain required for FIT 120E (only)
- Removable quick connect terminals provide easy & convenient electrical connection
- Easy installation of the drain line to the unit with a snap-fit drain for FIT 120H only
- Industry Best Warranty*



The ECO-TOUCH® ventilation controller features a complete touch screen technology. A smart design and user-friendly interface sets this wall control above the rest, allowing homeowners to take their comfort to the next level. Finally, fresh air is made simple.

FIT 120E
Energy Recovery Ventilator

The energy recovery core at the center of the unit transfers heat and moisture from the incoming air to the outgoing air that was cooled and dried by the building's air conditioner.

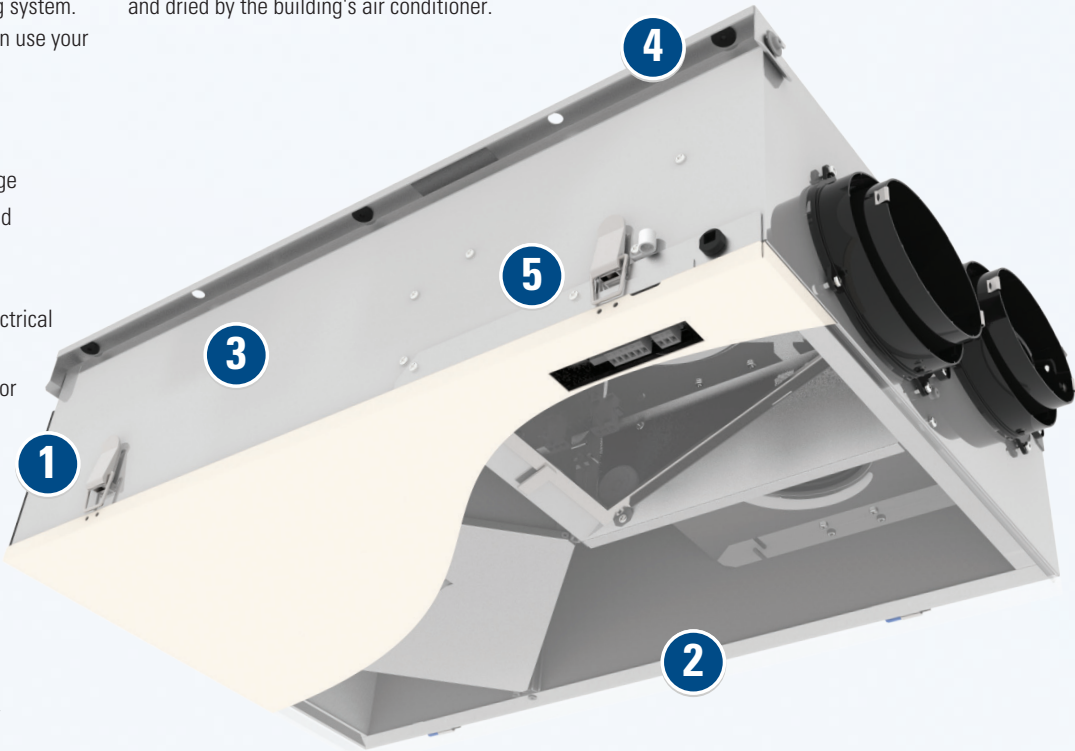

i The **FIT Series** reduces the energy required to heat or cool outdoor air by up to 80%!

FIT 120H
Heat Recovery Ventilator



Apparent Recovery Efficiency
76% @ 32°F (0°C), 86 cfm (41 l/s)
81% @ -13°F (-25°C), 65 cfm (31 l/s)

Sensible Recovery Efficiency
64% @ 32°F (0°C), 86 cfm (41 l/s)
56% @ -13°F (-25°C), 65 cfm (31 l/s)

Maximum Continuous Ventilation
116 cfm (55 l/s)

Physical parameters
• Aluminum heat recovery core
• Supply fan modulation frost prevention
• Side port location
• Oval 5" (125 mm) ducts
• Electrical consumption: more than 1 cfm/W
• Net weight: 42 lbs (19 kg)
• Length - Width - Height: 31" - 21" - 10 1/4" (785 mm - 531 mm - 260 mm)

Installation
• Drain needed
• Ceiling bracket included
• Balancing dampers included

Application
• Condo
• Apartments
• Single family homes

Wall Control Compatibility
ECO-TOUCH®, EDF7, EDF1, RTS2, RTS5, MDEH1

FIT 120E
Energy Recovery Ventilator



Apparent Recovery Efficiency
80% @ 32°F (0°C), 85 cfm (40 l/s)
80% @ 5°F (-15°C), 66 cfm (31 l/s)

Sensible Recovery Efficiency
64% @ 32°F (0°C), 85 cfm (40 l/s)
56% @ 5°F (-15°C), 66 cfm (31 l/s)

Maximum Continuous Ventilation
110 cfm (52 l/s)

Physical parameters
• Polymer membrane energy recovery core
• Supply fan modulation frost prevention
• Side port location
• Oval 5" (125 mm) ducts
• Electrical consumption: more than 1 cfm/W
• Net weight: 36 lbs (16 kg)
• Length - Width - Height: 31 1/4" - 19" - 8 3/4" (870 mm - 485 mm - 222 mm)

Installation
• No drain needed
• Ceiling bracket included
• Balancing dampers included

Application
• Condo
• Apartments
• Single family homes

Wall Control Compatibility
ECO-TOUCH®, EDF7, EDF1, RTS2, RTS5, MDEH1

* Lifetime limited warranty on aluminum core (FIT 120H), 5 year warranty on energy recovery core (FIT 120E), 7 year limited motor warranty, 5 year limited warranty on component parts.



Distributed Locally by:



Customer Support:

Canada

800.565.3548

CANADAsupport@fantech.net

USA

800.747.1762

USsupport@fantech.net



Send Orders:

Canada

877.747.8116

CANADAorders@fantech.net

USA

800.487.9915

USorders@fantech.net

Fantech reserves the right to modify, at any time and without notice, any or all of its products' features, designs, components and specifications to maintain their technological leadership position. The application rendering presented in this brochure is for visual presentation purposes only. Please, contact a building professional for technical guidance.



fantech[®]
a systemair company