

Specifications

	13.3 TQ Pro 44TF Model	14.5 HP Pro XL60TF Model
Engine	See your Engine Manual for oil capacity and other Engine specifications.	See your Engine Manual for oil capacity and other Engine specifications.
Starting System	Manual Start	Electric Start
Fuel Tank	3.5 L (.92 gal), Gasoline, Unleaded	2.5 Gal. (9.46 L), Gasoline, Unleaded
Battery	NA	12V, 9Ah
Wheels	Front: 11 X 4 Turf Tread Rear: 11 X 4 Turf Tread	Front: 11 X 4 Turf Tread Rear: 11 X 4 Turf Tread
Distance From Centerline of Tow Vehicle to Outer Cutting Edge	Straight Back: 22" Offset Position 1 (either L or R): 49.5" Offset Position 2 (either L or R): 68"	Straight Back: 30" Offset Position 1 (either L or R): 57.5" Offset Position 2 (either L or R): 76"
Number of Offset Positions	5	5
Adjustable Cutting Height	From 1-1/2" min. to 5-1/2" max.	From 1-1/2" min. to 5-1/2" max.
Cutting Width	44"	60"
Cutting Capacity	2' high grass	2' high grass
Blade Tip Speed	18,500 - 19,000 ft/min	17,500 - 18,000 ft/min
No. of Blades	2	3
Blades Type	Air Tipped	Air Tipped
Deck	12 GA Welded Steel	12 GA Welded Steel
Discharge	Side	Side
Spindle	1" Dia. Shaft with 2 Sealed 20 mm Bearings	1" Dia. Shaft with 2 Sealed 20 mm Bearings
Belt	A76	AK124
Electric Clutch	75 ft-lb	75 ft-lb
Max Speed Mow/Tow	5mph	5mph
Tongue Weight	10 lbs.	10 lbs.
Machine Dimensions	132" L x 60" W x 29" T	132" L x 75" W x 26" T
Machine Weight	270 lbs.	320 lbs.

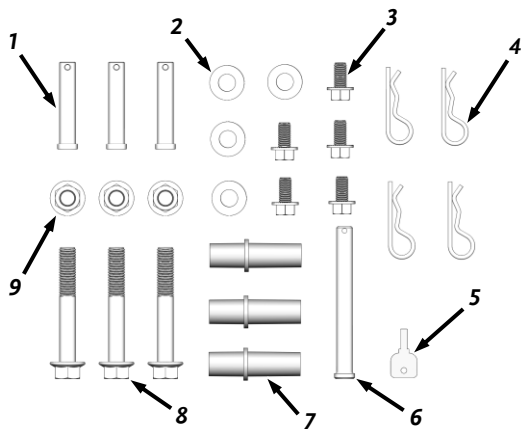

Figure 4

Assembling the DR TOW-BEHIND FINISH MOWER

Hardware Supplied in Product Package (Figure 4 and Table below):

Item #	Part #	Description	Qty
1	255491	Pin, Clevis, 1/2" x 2 1/2", TRT	3
2	234991	Washer, SAE Flat, 1/2", ZP	4
3	352811	Bolt, Hex, Flange, Tri Lobe, 3/8-16 X 3/4", GR5 ZP	5
4	160031	Pin, Hair, 1/2" To 9/16", .12" Wire	4
5	157201	Key Ignition Switch	1
6	187371	Pin, Clevis, 1/2" OD X 4.5" LG	1
7*	362891	Bushing, Sway Brace	3
8*	365721	Bolt, Hex, Flange, 1/2-13 x 3.5", GR5, ZP	3
9*	333351	Nut, Nylon Lock, Flanged, 1/2-13	3

*Mow Pro-60 Model Only

Compare the hardware of the Product Package with **Figure 4** and the "Hardware Supplied" list above. If you have any questions, please contact us at www.DRpower.com.