



## 2015 Magnum Owner/Operator Manual

# MAGNUM



**2250R**

**2550R**

**2460R**

**2560R**

Serial numbers 15XXXXXX and higher

# About This Manual

Congratulations on the purchase of your new Dixie Chopper mower! When operated and maintained as directed in this manual, Dixie Chopper is confident that this mower will provide you with years of excellent performance, durability, and trouble free service.

Should you ever have any questions regarding the operation, maintenance, or safety of your mower, please contact your authorized Dixie Chopper dealer who has been specially trained in the operation and service of Dixie Chopper mowers.

Please take time to record the information about your new Dixie Chopper mower in the space below for future reference. Such information may be needed when you contact your authorized Dixie Chopper dealer with questions.

The general operation, adjustment, and maintenance procedures contained in this manual are meant for both the beginner and the experienced Dixie Chopper operator. Operating conditions vary greatly, as do individual skill sets, so take time to learn how to safely operate this machine.

This owner's manual is considered a permanent part of the mower. It must be available to all of the operators and/or person(s) servicing the mower. Should the mower be resold, this manual must remain with the mower.

Illustrations and photographs used in this manual were current as of date of print. Despite this effort, production changes may have occurred after the time of the purchase of your Dixie Chopper; therefore, your unit may vary slightly from what is depicted in this manual.

All information, illustrations, and specifications contained in this manual were in effect at the time of publication. Dixie Chopper reserves the right to change, modify, and/or discontinue specifications and/or design without notice. If there is a change that has been made to your mower which is not shown or reflected in this manual, please see your authorized Dixie Chopper dealer before operating and/or servicing equipment.

## Authorized Dealer:

--

Model #: \_\_\_\_\_ Engine Model #: \_\_\_\_\_

Serial #: \_\_\_\_\_ Engine Serial #: \_\_\_\_\_

Date purchased: \_\_\_\_\_

# Table of Contents

<i>Topic</i>	<i>Page#</i>
<b>General Safety Precautions</b> .....	1
<b>Safety Information Decals</b> .....	3
<b>Safety Features</b> .....	4
<b>Warranty</b> .....	5
<b>Routine Maintenance</b> .....	8
Maintenance Points...	9
<b>Controls &amp; Operation</b> .....	10
Before Starting the Mower...	11
Safety Interlock System...	11
To Start the Mower...	11
To Mow...	11
Steering Speed Control Levers...	12
OCCDC (Operator Controlled Discharge Chute)...	13
Cut Height Setting...	13
Fuel Level Indicator...	13
Mowing Speed...	13
<b>Shutdown of Mower</b> .....	14
Shutdown Procedure...	14
Moving the Mower Without Power...	14
<b>Adjustments, Maintenance, &amp; Repair</b> .....	15
Blade Replacement...	15
Under Deck Cleaning...	15
Battery Maintenance...	15
Mower Cleaning & Off-season Storage...	15
Drive Belt Adjustment & Replacement...	16
Belt Routing...	17
Hour Meter...	17
Preparation for New Mowing Season...	17
<b>Evaporative Emissions Control System</b> .....	18

# General Safety Precautions

**PLEASE READ AND UNDERSTAND THIS OPERATION MANUAL AND THE INSTRUCTIONS FURNISHED WITH ATTACHMENTS BEFORE ATTEMPTING TO OPERATE THIS MOWER.**

1. Know the location and function of the controls and how to operate them. Know how to stop quickly.
2. Do not allow children under the age of 18 to operate machine.
3. Do not allow anyone to operate the machine without proper instruction.
4. Do not carry passengers.
5. **Do not mow when children, pets, or others are present.** The operator is responsible for the safety of others within the vicinity of the operation of this mower.
6. While operating the machine, always:
  - place roll over protection system in up position (if applicable)
  - wear seat belt if roll over protection system is installed
  - keep hands and feet inside of the machine.
7. Keep hands, feet, and clothing away from rotating blades or other rotating parts while engine is running.
8. Clear the work area of objects (wire, rocks, toys, or debris of any kind).
9. Disengage all attachment clutches, set parking brake, and place steering speed control levers into neutral-lock (open) position before attempting to start engine.
10. Disengage power to attachments, stop engine, engage parking brake and remove ignition key before leaving the operator position or leaving machine unattended.
11. Do not attempt to adjust or repair the mower deck, the drive system, the mower blades, or any moving parts of the machine while the engine is running. You must disengage power to attachments, disengage PTO (Deck Engagement Switch), set steering speed control levers to neutral-lock, set parking brake, **shut off the engine**, and remove key before making any repairs or adjustments or attempting any of the following tasks:
  - Adjusting deck pitch
  - unclogging the mower deck chute
  - checking blade mounting bolts for proper tightness at the specified intervals
  - refueling (never add fuel while engine is running or hot)Failure to comply with the above may result in personal injury or death.
12. Disengage power to attachments when transporting unit or when unit is not in use.
13. Never operate this mower on slopes exceeding 5° while mowing sideways, 10° mowing uphill, and 15° mowing down hill.

**NOTE: To operate on terrain that exceeds these limits constitutes misuse of the equipment and as such, any and all injuries as a result of said use are expressly disclaimed.**
14. Reduce speed and exercise extreme caution on slopes to prevent tipping and/or loss of control of mower. Be especially cautious and **slow down** when changing directions on steep terrain.
15. **DO NOT** operate when grass is wet.
16. When mowing downhill, loss of traction and/or braking ability may occur. Use extreme caution and good judgement before mowing sloped terrain.
17. Stay alert for holes, rocks, roots or other terrain features which may cause loss or sudden increase in traction. Care must be taken to keep away from drop-offs.
18. Use care when pulling loads or using heavy attachments.
  - Use only approved draw bar hitch points.
  - Limit loads to those you can safely control.
  - Do not turn sharply. Use care when reversing.
19. Watch out for traffic when near or crossing roads, and obey traffic laws. Disengage blades and wait for them to stop completely before crossing gravel roads.
20. When using any attachments, never direct discharge of materials toward bystanders, nor allow anyone near the machine while it is in operation.
21. Keep all nuts, bolts, and screws tight to be sure equipment is in safe working condition.

# General Safety Precautions

22. Allow engine to cool before storing in any enclosure.
23. Never attempt to operate mower while under the influence of alcohol or drugs.
24. Handle gasoline with care.  
Follow these guidelines:
  - Use approved gasoline container
  - Place container out of reach of children
  - Use gasoline only as a fuel, never as a cleaner
  - Never remove fuel cap while engine is running or hot
  - Never add fuel while engine is running or hot
  - Never fill fuel tank indoors
  - Wipe up spilled gasoline
  - Do not smoke while refueling the machine
  - Never store equipment with gasoline in the tank inside a building where fumes may reach an open flame or spark
  - Always have a fire extinguisher present when using gasoline or other flammable substance.
25. Keep vehicle and attachments in good operating condition. Keep safety devices, such as guards, shields, and covers, in place and in working condition.
26. Do not operate the mower or attachments if any guards are missing or are not functioning properly.
27. After striking a foreign object, stop and secure the mower, and then inspect for damage. Repair any damage before restarting and operating the equipment.
28. The machine is calibrated at the factory. Do not change engine governor settings or over-speed the engine.
29. Disengage power to mower deck before backing up. The mower is not designed to mow in reverse.
30. Do not mow with mower blades that are out of balance, have worn, or have been damaged.
31. Personal protection equipment such as safety goggles, hearing protection and other devices must be worn while operating the machine. Do not operate or service the mower when barefoot or wearing open-toed shoes.
32. Use caution when handling mower blades during replacement or maintenance. Wear appropriate protective gloves and clothing. Failure to comply may result in personal injury.
33. Operate mower only in daylight or good artificial light.
34. Do not make sudden turns, stops, starts, reversals, or any other abrupt maneuvers, especially when accessing slopes. The steering speed control levers are very responsive to slight movement. Rapid, rough, or jerky manipulation of the steering speed control levers may result in damage to equipment and personal injury.
35. Do not run the engine in an enclosure without adequate ventilation. Exhaust fumes contain carbon monoxide which is harmful to animals and humans. Failure to comply can result in personal injury or death.
36. Do not work underneath the mower unless it is adequately supported by jack stands or similar type devices that have a safe working load of at least 2000 lbs or more. Failure to adequately support the machine in this manner may result in property damage, personal injury, or death.
37. Disconnect the negative battery terminal when setting up, adjusting, or doing repairs on your mower. Failure to comply may result in personal injury or death.
38. Do not touch hot parts of the mower. Failure to comply can result in personal injury.
39. Give complete and undivided attention to the job at hand.
40. Obey all safety decals.

# Safety Information Decals

The following decals are intended to alert you to potential hazards and to provide you with important safety information. Should these decals become difficult to read or missing from the mower, contact your Dixie Chopper dealer for a replacement.

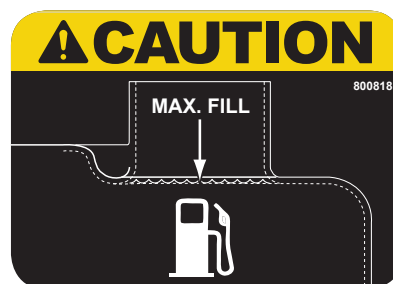
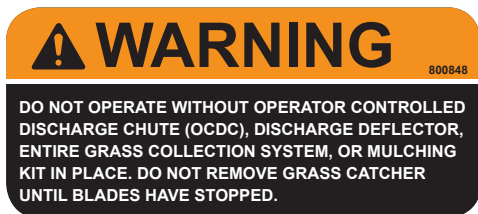



# Safety Features



**Parking Brake** - The parking brake should be engaged whenever the mower is stationary and unoccupied.

**Safety Interlock System** - The mower has a system of safety interlock switches that will not allow the mower to start unless the steering speed control levers are in the neutral lock position, the parking brake is set and/or seat is occupied, and the deck engaging switch (PTO) is off. If the seat is vacated during mowing without positioning the controls as previously outlined, the engine will be stopped by the safety interlock system.

# Warranty

## Dixie Chopper Limited Warranty

### General Warranty Conditions

Dixie Chopper warrants that it will, at its option, adjust, repair, or replace, any factory original part used in the manufacturing of a Dixie Chopper complete unit, found to be defective in material or workmanship. For the purposes of this Warranty, a Dixie Chopper complete unit is defined as a riding lawn mower manufactured by Dixie Chopper. This warranty is non-transferable absent written authorization by Dixie Chopper. Dixie Chopper is in no way liable for any special, incidental or consequential damages for breach of any written or implied warranty on any product. Magnum units are designed with residential use in mind. As such, commercial use of any Magnum unit will void this warranty. For the purposes of this warranty commercial use is defined as any use of the Magnum machine to mow property that is not owned and/or leased by the lawn mowers owner.

### Purchaser/Operator's Responsibilities under the Warranty

As a condition of the Dixie Chopper warranty, the purchaser and or the operator must have fully read and understood the operator's manual. This includes being familiar with how to operate the equipment safely, as well as how to maintain the equipment properly prior to actually operating the equipment. This Warranty applies only to equipment that is operated under normal conditions and maintained per the service schedule specified in this owner's manual. Maintenance of the unit is the sole responsibility of the owner.

To obtain warranty service, the unit must be registered before obtaining any warranty work. This information must be submitted to Dixie Chopper within ten (10) days of the original retail purchase date to enable validation of the warranty period.

A Dixie Chopper mower requiring repair or warranty work must be returned to an authorized Dixie Chopper service dealer within the warranty period. The expense of transporting the unit to and from the authorized Dixie Chopper service dealer for warranty work will be the sole responsibility of the purchaser/owner and in no way will be attributed to Dixie Chopper. All warranty work must be performed by an authorized Dixie Chopper dealer using genuine Dixie Chopper parts. Failure to have warranty repair performed by an authorized Dixie Chopper dealer will result in the denial by Dixie Chopper to pay for said warranty repair work.

Should a Purchaser encounter problems with receiving warranty service from an authorized Dixie Chopper dealer, or is in need of assistance or clarification of this warranty, contact us at:

#### **Dixie Chopper**

6302 E County Road 100 N  
Coatesville, IN 46121

**NOTE: This warranty is void for any new products purchased through auction web sites.** Warranty is valid only for new products purchased through Authorized Dealer. Proof of purchase required for all claims.



# Warranty (cont.)

## Warranty Period & Limitations

The Magnum is warranted to be free of defects in material or workmanship for a period of three (3) years from the retail purchase date by the original purchaser regardless of the amount of hours of service on the machine. For the first two years of the warranty period, Dixie Chopper will be responsible for both parts and labor for all warrantable claims. During the third and final year of the warranty, Dixie Chopper will be responsible for the cost of parts only for warrantable claims. Labor costs will be the sole responsibility of the owner of the machine during the third year of the warranty period.

Dixie Chopper original equipment batteries are warranted against OEM factory defects in materials or workmanship for a period of 1 year from the retail purchase date. If a battery failure occurs before one (1) year has passed since the date of retail purchase, the battery will be replaced at the cost of the standard replacement battery. Abuse or using the battery for purposes not associated with its intended use voids the battery warranty.

Consumable wear items such as tires, blades, spark plugs, belts, etc. are warranted for a period of ninety (90) days from the date of retail purchase for defects in materials or workmanship. This warranty does not apply to damage or wear of such consumable components as a result of abuse or normal wear and tear.

## Warranty Exclusions & Remedies

Dixie Chopper does not warranty the following: 1) parts not manufactured or sold by Dixie Chopper; 2) after market components or accessories for use on a Dixie Chopper brand mower; 3) repairs, alterations or installation of accessories by non-authorized Dixie Chopper service dealers; 4) repairs or replacement resulting from the installation or use of unauthorized parts, accessories or attachments; 5) damage to a Dixie Chopper unit that occurred as a result of it being used for another purpose other than which it was designed; 6) damage or depreciation as a result of normal wear and tear, or improper or inadequate maintenance of the mower as specified in this owner's manual 7) damage as a result of an act of God to include but not limited to hail, wind, rain, flood, lightning, fire, smoke, sun exposure, earthquake, etc.; 8) repairs or replacement as the result of any alterations or modifications, in the determination of Dixie Chopper, which adversely affects the performance or operation of the mower; 9) costs associated with the routine maintenance of the mower or costs of parts associated with such to include those specified by this owner's manual to include oil, grease, and consumable components; 10) repairs associated with improper fuel usage, to include the use of gasoline containing an excess of 10% ethanol alcohol by volume.

# Warranty (cont.)

Dixie Chopper is in no way liable for consequential damages, negligence, strict liability in tort, or any other legal theory. Likewise, Dixie Chopper is not responsible for damages associated with these theories to include but not limited to: 1) lost profits or revenue; 2) loss of the use of any equipment to include the equipment that is subject to this warranty; 3) any down time as a result of warranty work being performed to include temporary replacement equipment; 4) cost of capital; and 5) claims asserted by third parties, including customers. Some jurisdictions prohibit the exclusion or limitation of incidental or consequential damages, so the above may not be applicable to you.

## **DISCLAIMER**

**THE FOREGOING WARRANTIES ARE IN LIEU OF ALL OTHER WARRANTIES, EXPRESSED OR IMPLIED, INCLUDING BUT NOT LIMITED TO THE IMPLIED WARRANTIES OF MERCHANTABILITY AND FITNESS FOR A PARTICULAR PURPOSE. IN THE EVENT THAT A DIXIE CHOPPER IS PURCHASED FOR CONSUMER USE, ANY IMPLIED WARRANTY OF MERCHANTABILITY OR FITNESS FOR A PARTICULAR PURPOSE IS LIMITED TO THE DURATION OF THIS LIMITED WARRANTY. SOME JURISDICTIONS PROHIBIT LIMITATIONS ON THE LENGTH OF TIME AN IMPLIED WARRANTY LASTS; AS SUCH THIS LIMITATION MAY NOT APPLY TO YOU. THIS WARRANTY PROVIDES YOU WITH SPECIFIC LEGAL RIGHTS, AND OTHER RIGHTS MAY BE PROVIDED IN YOUR JURISDICTION.**

## **Complete Warranty**

Absent a modification in writing signed by all the parties and approved by Jacobsen Professional Lawn Care Inc. DBA Dixie Chopper, this agreement constitutes the complete and exclusive agreement between the parties. This agreement is to replace and or supersede all other prior agreements written or oral.

# Routine Maintenance

**Maintenance should be performed per the requirements in the chart below or as needed.**

Routine Maintenance Chart

	Before Each Use	Every 25 Hours	Every 50 Hours	Every 100 Hours or Annually	Every 400 Hours or Annually
Check Safety Interlock System	X				
Inspect unit for loose hardware and/or damaged parts	X				
Inspect tires for wear and proper inflation (front 15 psi, rear 10 psi)	X				
Inspect fuel level	X				
Inspect for fuel and/or oil leaks	X				
Inspect engine oil coolers for build up	X				
Inspect and clean air intake screen	X				
Check oil level in the engine (See engine owner's manual)	X				
Check oil level in the transaxles	X				
Check blades for sharpness and wear	X				
Replace cutting blades		X			
Inspect engine cooling fins under engine shroud (See authorized Dixie Chopper dealer for cleaning if build-up exists).		X			
Check engine air filter. Replace if necessary <sup>1</sup>		X			
Inspect engine to deck belt tension (See authorized Dixie Chopper dealer)		X			
Change engine oil and filter (See engine owner's manual) <sup>2</sup>			X		
Change transaxle oil and filter <sup>3</sup> (See your authorized Dixie Chopper dealer)					X
Change engine fuel filter				X	
Grease deck spindle assemblies				X	
Grease front caster bearings				X	
Grease all other zerk fittings				X	

<sup>1</sup>Engine air filters should be cleaned/changed more frequently in dusty conditions or when airborne debris is present.

**<sup>2</sup>IMPORTANT NOTE:**

CHANGE ENGINE OIL AND FILTER AFTER FIRST 5 HOURS OF USE FOR BRIGGS & STRATTON ENGINES (8 HOURS FOR KAWASAKI) AND THEN EVERY 50 to 100 HOURS DEPENDING UPON ENGINE (refer to engine owners manual). **FAILURE TO DO SO WILL VOID THE ENGINE WARRANTY.**

<sup>3</sup>Transaxle oil and filters must be initially changed at 100 hours; thereafter change every 400 hours or annually. Changes MUST be performed by an Authorized Dixie Chopper Service Dealer ONLY.

**NOTE: THE RECOMMENDED TRANSAXLE OIL FOR YOUR MOWER IS 20W50**

We strongly urge that you use this oil in the event that you should need to refill or add hydraulic reservoir. However if this is unavailable, you may substitute a motor oil of 89 SUS or better (at 212 degrees Fahrenheit) , such as a high grade 10W50, 15W40, or 15W50

**Engine Oil:** Consult engine manual.

# Routine Maintenance

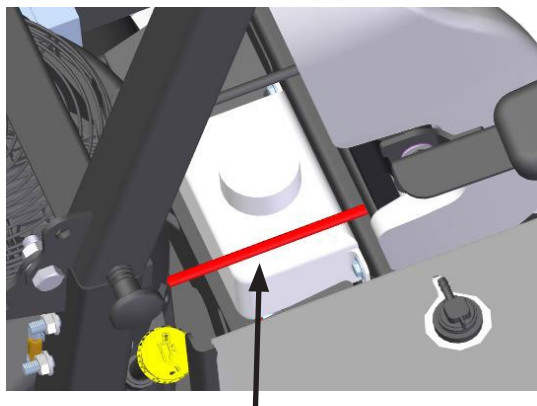

Hydraulic Fluid Reservoir

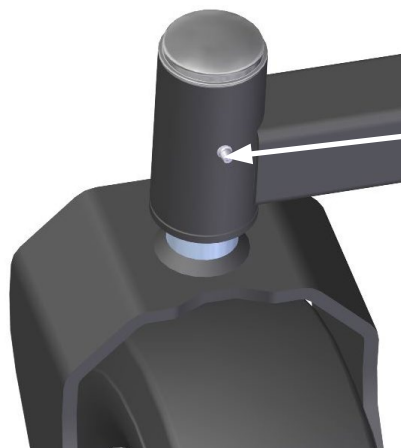

Front Caster  
Grease Zerk  
(1 per side)

Kawasaki® FS Engine

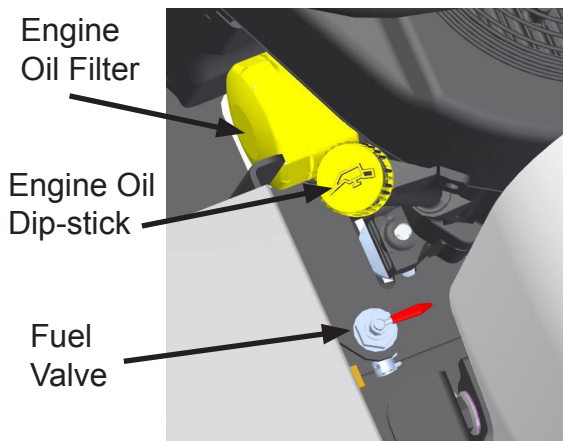

Deck Spindle Grease Zerk  
(1 per spindle, 3 total)

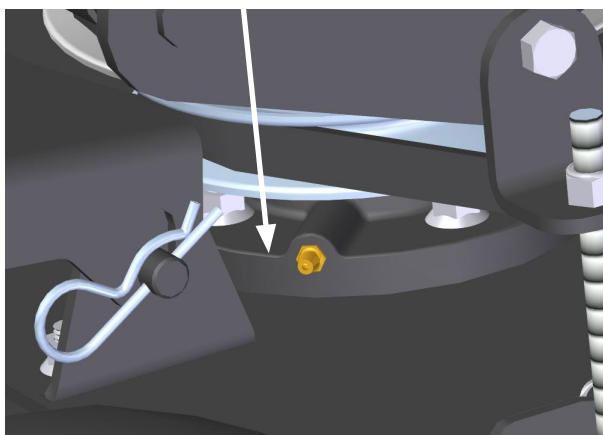

Kawasaki® FS Engine  
Engine Air  
Filter Cover

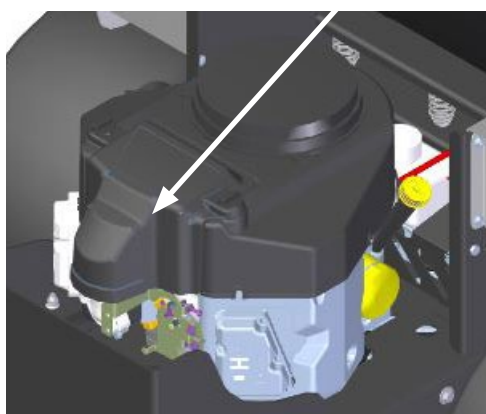

Briggs & Stratton® Cyclonic Engine

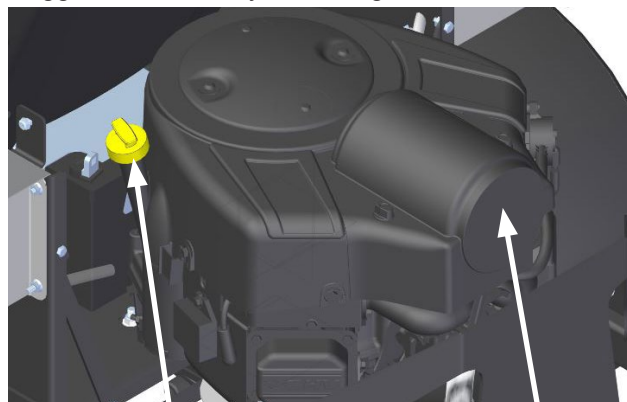

Engine Oil Fill / Dip-Stick

Engine Air  
Filter Cover

# Controls and Operation

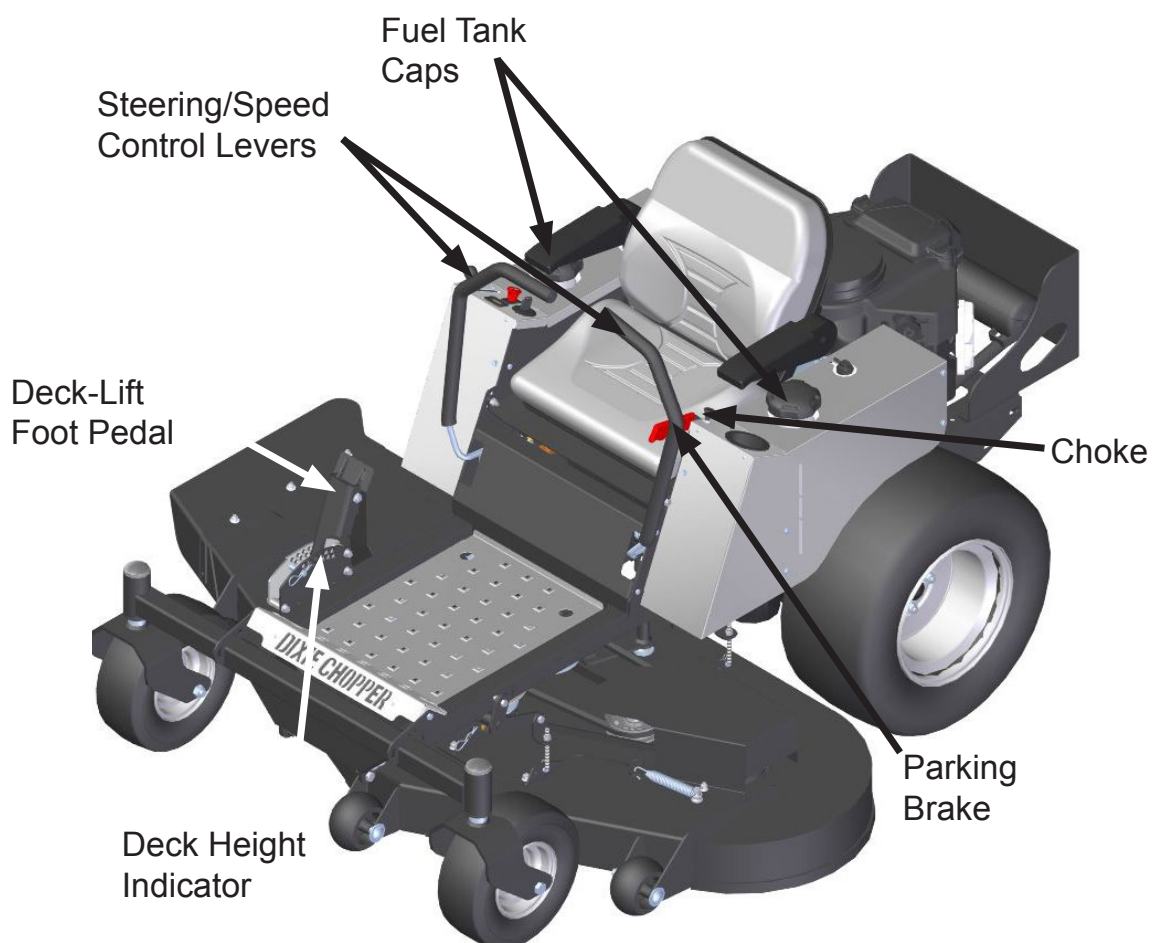
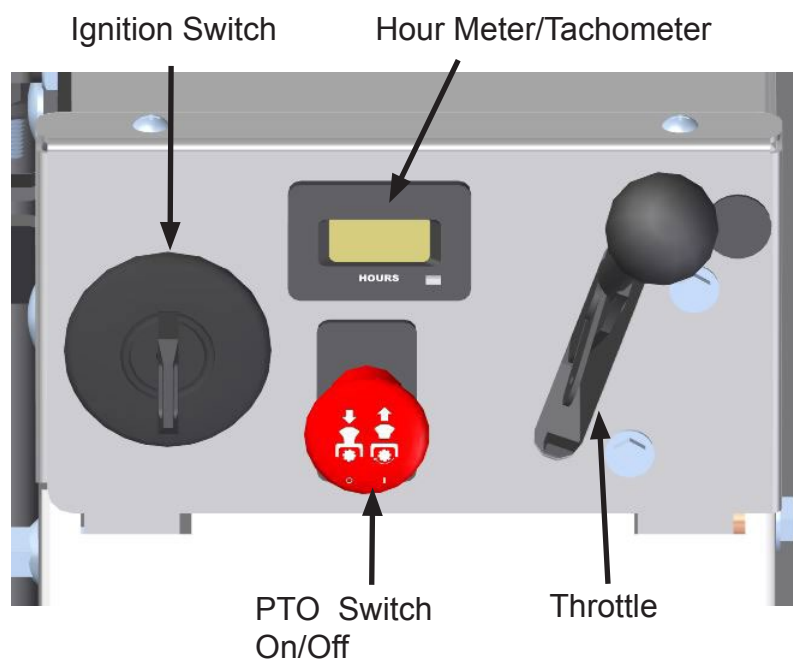



# Controls and Operation



## DANGER

**Do not run the mower engine in confined areas such as a closed garage. Take care not to inhale exhaust gases as they contain carbon monoxide, which is a colorless, odorless gas that can cause unconsciousness and is potentially lethal.**



## WARNING

**Handle fuel with care. Use only approved fuel containers. Never add fuel while the engine is running or hot. Fill fuel tanks outdoors, never indoors. Replace fuel tank cap securely and wipe up all spilled fuel. Failure to comply may result in damage to the equipment and/or injury to persons.**



## CAUTION

**Before starting the engine, become familiar with all controls. Read and understand this Operation Manual thoroughly. Always check for proper engine oil level before starting engine. Failure to comply may result in damage to the equipment and injury to persons.**

### Before Starting the Mower:

1. Ensure all shields and mower deck discharge chute (OCDC) are in place (If equipped). Never attempt to clear discharge areas or mower deck blades without disengaging mower deck, setting parking brake, shutting off engine, and removing ignition key.
2. Confirm that mower deck blades are sharp and balanced to ensure the optimum quality of cut.  
**NOTE: Refer to blade replacement procedures for detailed instructions on how to safely and properly maintain mower blades.**
3. Check tires for wear and proper inflation.
4. Check levels of fuel, engine oil and hydraulic system oil.

### Safety Interlock System

The mower has a system of safety interlock switches that will not allow the mower to start unless these conditions are met:

- Steering speed control levers are in neutral lock position
- Parking brake is set and/or seat is occupied.
- Deck engaging switch (PTO) off.

If the seat is vacated during mowing without positioning the controls as previously outlined, the engine will be stopped by the safety interlock system.

### To Start the Mower:

1. Place the steering speed control levers in the neutral lock position.
2. Sit in the mower seat.
3. Pull the parking brake lever all the way up to set parking brake.
4. Set fuel shut-off valve to desired fuel tank position.
5. Set throttle to 3/4 power.
6. Pull choke knob out.
7. Turn ignition switch to the START position. Release key after engine starts. Key will automatically return to the RUN position.
8. Push choke in as engine warms to operating temperature.

**NOTE: If the engine fails to start after 6-7 seconds of continuous cranking, turn the key to the OFF position and allow the starter motor to cool. See page 11 for location of controls**

### To Mow:

**NOTE: Always set engine speed at full-throttle when mowing. Maintain a minimum engine speed of 3400 RPM and a maximum engine speed of 3600 RPM while mowing. This engine speed will provide the necessary airflow to the engine cowling to prevent overheating, and will maintain blade speed for a satisfactory quality of cut. If the engine pulls below 3400 RPM when under load, slow down the ground speed and allow the engine to recover to the proper RPM. Slow the mower for cutting tall grass or when mowing uphill. If ground speed is too fast, or blade speed is too slow, mowing will be uneven because mower blades will not be able to lift grass into cutting position as mower passes over the ground.**

1. Set mowing deck height to desired cut height
2. To release parking brake, push parking brake lever all the way down.
3. Set throttle to **3/4-power** position.
4. Engage mower deck by pulling up on deck engaging switch (PTO).
5. Set throttle at the full-throttle position.
6. Steer and accelerate mower using the steering speed control levers as explained in this manual.



# Controls and Operation

## Steering Speed Control Levers:

The mower is equipped with a separate transaxle for each rear wheel. The transaxles are controlled by the steering speed control levers. The left lever controls the left rear wheel and the right lever controls the right rear wheel.

**To move forward**, push both levers forward at the same time, slowly and evenly. (See below)

**To speed up** the forward movement, push levers farther forward. The farther they are pushed, the faster the mower will travel.

**To move in reverse**, pull both levers backward at the same time, slowly and evenly. (See below)

**! DANGER** Do not move the steering speed control levers too rapidly or start and stop the mower suddenly, especially on grades. Failure to comply will result in personal injury or death.

**To speed up the backward movement**, pull levers toward you. The closer they are pulled, the faster the mower will travel. **NOTE: Never mow in reverse.**

**To turn**, slow the mower's ground speed, then further slow the speed of the desired direction of travel. Slow the right wheel for a right-hand turn or the left wheel for a left-hand turn. (See below)

**To reduce the speed of the mower**, move the steering speed control levers the opposite direction of travel toward the neutral position.

Refer to the illustrations of steering speed control levers' positions shown below.

**To execute a Zero Radius turn**, you must put one wheel in reverse and one wheel in forward.

Refer to illustrations shown below of the steering speed control levers' position relative to the mower wheels and the direction in which the levers turn them.

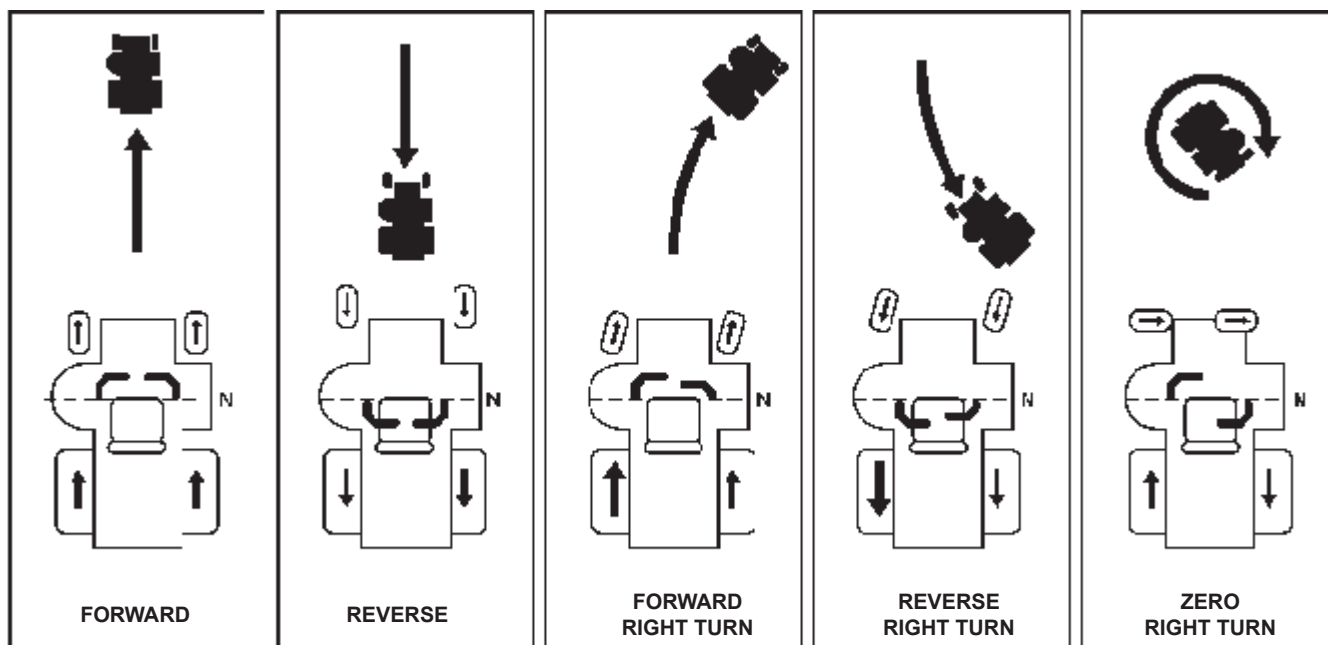

# Controls and Operation

## OCDC (Operator Controlled Discharge Chute)

This mower may be equipped with the patented Operator Controlled Discharge Chute (OCDC) to regulate discharge. This discharge chute has a variable adjustment that ranges from fully open to fully closed.

In the fully closed position, it will serve to keep some of the clipped material under the mower deck for a longer period of time, in order to enhance the mulching capabilities. This will also function as a discharge safety shield. This discharge chute should **ALWAYS BE OPERATED IN THE FULLY CLOSED POSITION WHEN MOWING NEXT TO VULNERABLE OBJECTS**

## OCDC Controls

1. Handle: Used to raise and lower the OCDC.
2. Chute Adjustment: Used to adjust position of the chute. May also be used to hold chute between fully open or fully closed. To adjust the OCDC, move handle to raise or lower the screen to desired position.

**BE AWARE OF SURROUNDINGS AT ALL TIMES!**

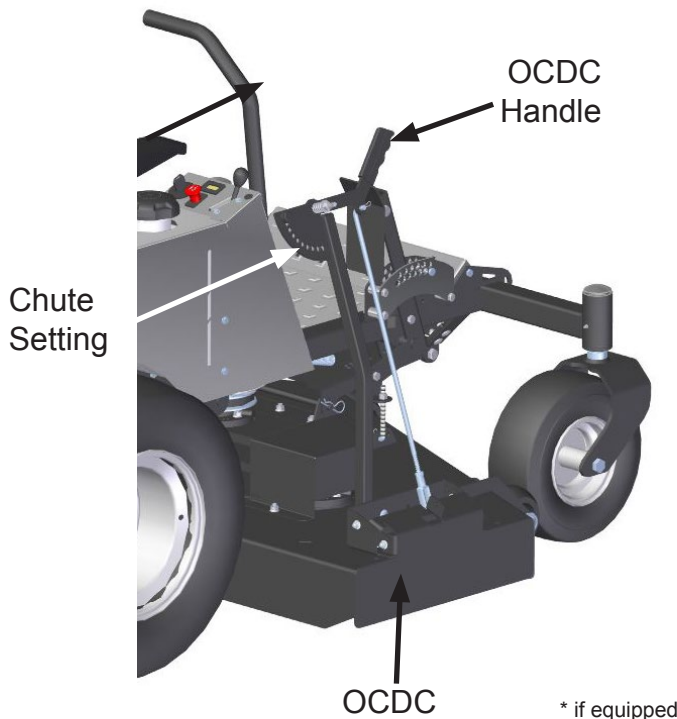

***Before setting cut height, the engine must be OFF and the parking brake must be engaged.***

## Cut Height Setting

Set the mowing deck appropriately to achieve the desired height of your cut. The recommended cutting height is 2-3 inches (5-7 cm), though your preference may be a higher or lower cut.

Tall grass or weeds should be cut with the mower deck set to its highest position.

The first time you mow, set the cut height slightly higher than normal, then adjust accordingly.

1. Refer to the deck height indicator decal on the left side of the deck stop housing.
2. Determine the appropriate setting for your desired cut height.
3. Depress the deck height adjustment pedal until it locks in the upper most setting.
4. Reposition the deck height pin to the selected setting.
5. Slowly lower deck to new height setting by releasing the deck height adjustment pedal.

## Fuel level Indicator

The fenders of the mower have a cut out in the stainless steel allowing for easy fuel level assessment.



## Mowing Speed

The mower is designed to operate most efficiently at maximum blade speed (engine 3600 rpm). The speed of the mower should allow the mower deck blades to maintain this maximum speed while mowing across turf. Control the ground speed with speed control levers. Slow the mower for cutting tall grass, grass that is heavy with moisture, or when moving uphill. If ground speed is too fast, or blade speed is too slow, mowing will be uneven because mower blades will not be able to lift grass into cutting position as mower passes over the ground.

# Shutdown of Mower

## Shutdown Procedure

**NOTE:** Engine may be stopped at any time by turning the ignition key to the OFF position.

1. Move steering speed control levers to neutral position to stop mower movement.
2. Push deck engaging switch (PTO) down to disengage mower deck blades.
3. Pull parking brake lever all the way up to set parking brake.
4. Move throttle to the idle position.
5. Allow engine to idle for two minutes.
6. Turn ignition key to the OFF position and remove key, even if leaving mower unattended for only a few minutes.
7. Position fuel shut-off valve to the OFF position.

## Moving the Mower without Power

**NOTE:** Do not exceed a speed of 2 mph when moving the mower without power.

In order to transport the mower without power, you must first release the hydraulic pressure by using the bypass lever located on each transaxle. Gain access to the bypass levers under the main chassis, behind the rear wheels.

Pull the levers backwards toward the rear of the mower to release the lock, and push the lever forward to the front of the mower, enabling the mower to be moved without power.

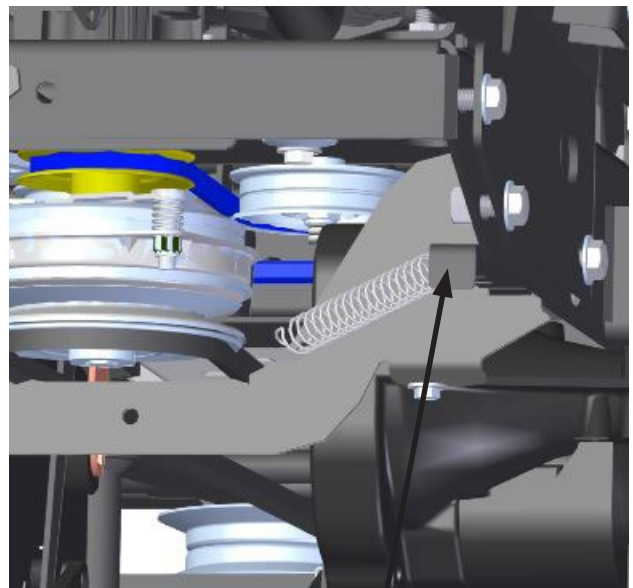

**Bypass Lever**  
(1 per transaxle, 2 total under rear of mower, looking forward)

# Basic Mower Adjustments, Maintenance, and Repair

## Blade Replacement

**! DANGER** *NEVER work with mower blades while engine is running. Make sure that ignition switch is off, key is removed, PTO switch is disengaged, steering speed control levers are in neutral lock, and parking brake is on. Failure to comply will result in personal injury or death.*

**! WARNING** *While setting up, repairing, or transporting your mower, disconnect the negative battery terminal. Failure to comply can result in personal injury or death.*

**! CAUTION** *Use caution when handling mower blades during replacement or maintenance. Wear appropriate protective gloves and clothing. Cover the sharp cutting edges of the blades. Failure to comply can result in personal injury.*

1. Chock rear tires.
2. Lift front end of mower and support it with a jack or jack stands that have a sufficient safe working load capacity.
3. Wedge a short piece of lumber between the mower blade and the mower deck to immobilize the blade while removing and reattaching hardware.
4. Remove bolt, washer, and spacer attaching blade to blade spindle shaft, before removing blades.
5. Apply anti-seize compound to threads of attaching bolts before installation of new or sharpened blades.
6. In reverse order as removed, install new or sharpened blade with spacer, washer, and bolt. Make certain to keep the lift area\ (turned-up section of the blade) facing the underside of mower deck. Ensure that the fiber washer (which acts as a vibration damper) is in contact with the blade.
7. Tighten bolts to a torque of 115-130 ft-lbs.

## Under Deck Cleaning

**! CAUTION** *Do not clean the underside of the deck with a pressure washer. Water can get in and under seals and cause damage to equipment.*

Clean the underside of the deck frequently. Accumulation of debris seriously impairs the mower's ability to "lift" the grass into cutting position and discharge the clippings evenly. Build up on the underside of the mower deck often results in a poor quality of cut.

## Battery Maintenance

Follow the instructions provided with the engine manual.

During off-season storage, use a trickle charger to maintain the battery.

**! WARNING** *Prior to performing any and all maintenance, make sure that the ignition switch is off and key removed, PTO switch is disengaged, steering speed control levers are in neutral lock, and parking brake is on. Failure to comply may result in personal injury or death.*

## Mower Cleaning & Off-Season Storage

Clean and store the mower at the end of the mowing season as follows:

1. Perform steps as applicable under routine maintenance.
2. Remove all grass, dirt, and debris from the machine. Wash mower with an automotive type detergent.
3. Thoroughly apply grease to grease zerks as shown on page 9.
4. Check hydraulic oil level. Add oil if necessary. Change oil and filter if not done in last 100 hours. Refer to routine maintenance.
5. Check tires for proper inflation.
6. Start mower and engage PTO for approximately one minute to remove excess water from belts and pulleys.

# Basic Mower Adjustments, Maintenance, and Repair

**! DANGER** *Never attempt to make any adjustments to mower deck or work under it while engine is running. Make sure that ignition switch is off and key removed, PTO switch is disengaged, steering speed control levers are in neutral lock, and parking brake is on. Failure to comply will result in personal injury or death.*

## Drive Belt Adjustment

There are two drive belts that may need periodic adjustment: the drive belt from the engine to the pumps, and the drive belt from the engine to the mower deck.

These belts may be adjusted as follows:

1. Adjust the engine-to-pump drive belt using the spring tensioner located near the left rear wheel. Tighten the jam nut until spring measures 3 inches.
2. Adjust the engine-to-deck drive belt using the spring tensioner located on the top rear of the mower deck. Tighten the jam nut until spring measures 3 inches.

Engine-to-Pump Tensioner

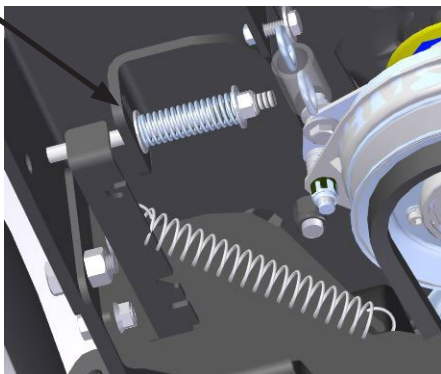

Engine-to-Deck Tensioner



## Drive Belt Replacement

Replace the drive belts if they show signs of cuts, tears, burns caused by slipping, or excessive wear. Refer to the Routine Maintenance section of this manual for a schedule of replacement.

1. Loosen the tension on the vertical/ horizontal idler pulley by pulling it away from belt.
2. Roll belt off the pulley, noting the routing of belt.
3. Roll new belt onto pulley, routing it in the same configuration as belt that was just removed. The pulley can be moved as needed.

See belt routing on page 17.



# Basic Mower Adjustments, Maintenance, and Repair

## Belt Routing

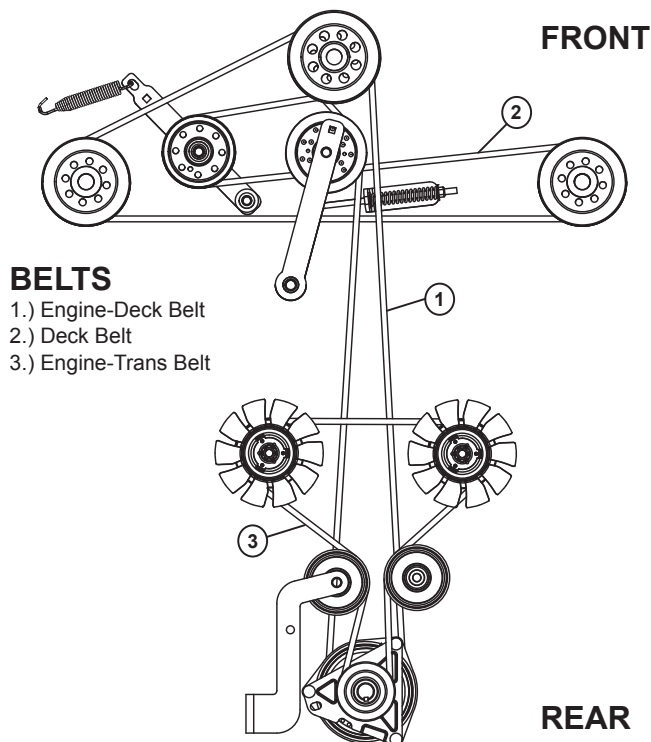

## Preparing the Mower for Storage

Prepare the engine for storage at the end of the mowing season as follows:

1. Run engine for 15 minutes or longer.
2. Shut off engine.
3. Drain oil while engine is still warm.
4. Refill crankcase with fresh oil. Refer to engine owner's manual for proper oil type and viscosity.
5. Position fuel shut off valve to the OFF position and run the engine until it runs out of gas and/or use a fuel stabilizer. Gasoline forms harmful gum and varnish deposits in the carburetor and fuel system as it becomes old.

**CAUTION** Do not store gasoline for more than 2 months. Failure to comply can cause damage to equipment or personal injury.

6. Remove and replace fuel filter if needed.
7. Check oil filler and fuel tank caps to make sure they are securely in place.

## Hour Meter

### Functions:

1. Tachometer
2. Engine Hours
3. System Voltage
4. Initial Oil Change (Break in oil)
5. Scheduled Oil Service Alert
6. Air filter service Alert
7. Fuel filter service Alert

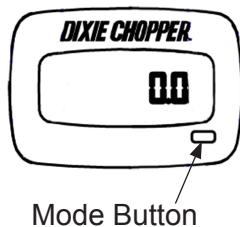

### Operation:

Push and release mode button to toggle between functions, the mode button will also be used to clear alerts and/or timers.

### Operation:

The service alert timer counts down from a set interval, when the hour meter reaches the GENTLE ALERT INTERVAL for a qualifying function your meter will begin to flash messages such as CHG OIL, SVC AIR FILTER and SVC FUEL FILTER. As the interval count-down continues and 0 hours remain for service intervals messages such as CHG OIL NOW, SVC AIR FILTER NOW, SVC FUEL FILTER NOW will be displayed.

### Reset Procedure:

Select the alert or timer you would like to reset press and HOLD the mode button for 3 seconds (an alert or timer reset can be performed at any time).

## Preparation for New Mowing Season

Prepare the stored mower for the new mowing season as follows:

1. Clean mower and remove any debris and dirt accumulation.
2. Check the hydraulic and engine oil levels.
3. Fill fuel tanks with fresh gasoline.
4. Run the engine at half speed for 5 minutes and check the operation of the steering speed control levers. Then, stop engine and check for oil leaks, loose fittings, etc...
5. Ensure all safety devices are operational and review the general safety precautions listed in the front of this manual.
6. Check air pressure in tires. If needed, inflate to proper pressure: front tires-15 psi and rear tires-10 psi.
7. See maintenance chart on page 8.



# Evaporative Emission Control System

## **YOUR WARRANTY RIGHTS AND OBLIGATIONS**

The U.S. EPA, California Air Resources Board, and Jacobsen Professional Lawn Care Inc., DBA Dixie Chopper are pleased to explain the evaporative emission control system's warranty on your 2015 model year small off-road (Mowers) engine. In California, new equipment that use small off-road engines must be designed, built, and equipped to meet the State's stringent anti-smog standards. Dixie Chopper must warrant the evaporative emission control system on your small off-road (mower) engine for the period listed below provided there has been no abuse, neglect or improper maintenance of your equipment.

Your evaporative emission control system may include parts such as: carburetors, fuel tanks, fuel lines, fuel caps, valves, canisters, filters, vapor hoses, clamps, connectors, and other associated components. For engines less than or equal to 80 cc, only the fuel tank is subject to the evaporative emission control warranty requirements of this section.

## **MANUFACTURER'S WARRANTY COVERAGE:**

This evaporative emission control system is warranted for two years. If any evaporative emission-related part on your equipment is defective, the part will be repaired or replaced by Dixie Chopper.

## **OWNER'S WARRANTY RESPONSIBILITIES:**

As the small off-road engine (mower) owner, you are responsible for performance of the required maintenance listed in your owner's manual. Dixie Chopper recommends that you retain all receipts covering maintenance on your (Mower), but Dixie Chopper cannot deny warranty solely for the lack of receipts.

As the small off-road engine (Mower) owner, you should however be aware that the Dixie Chopper may deny you warranty coverage if your fuel tank has failed due to abuse, neglect, or improper maintenance or unapproved modifications.

You are responsible for presenting your lawn cutting equipment to a Dixie Chopper distribution center or service center as soon as the problem exists. The warranty repairs should be completed in a reasonable amount of time, not to exceed 30 days. If you have a question regarding your warranty coverage, you should contact the Technical Service Manager at 765-246-7737.

## **DEFECTS WARRANTY REQUIREMENTS:**

- (a) The warranty period begins on the date the engine or equipment is delivered to an ultimate purchaser.
- (b) General Evaporative Emissions Warranty Coverage. The fuel tank must be warranted to the ultimate purchaser and any subsequent owner that the evaporative emission control system when installed was:
  - (1) Designed, built, and equipped so as to conform with all applicable regulations; and
  - (2) Free from defects in materials and workmanship that causes the failure of a warranted part for a period of two years.
- (c) The warranty on evaporative emissions-related parts will be interpreted as follows:
  - (1) Any warranted part that is not scheduled for replacement as required maintenance in the written instructions must be warranted for the warranty period defined in subsection (b)(2).

## Evaporative Emission Control System (cont.)

If any such part fails during the period of warranty coverage, it must be repaired or replaced by the Jacobsen Professional Lawn Care Inc., DBA Dixie Chopper (Dixie Chopper) issuing the

warranty. Any such part repaired or replaced under the warranty must be warranted for a time not less than the remaining warranty period.

(2) Any warranted part that is scheduled only for regular inspection in the written instructions must be warranted for the warranty period defined in subsection (b)(2). A statement in such written instructions to the effect of "repair or replace as necessary" will not reduce the period of warranty coverage. Any such part repaired or replaced under warranty must be warranted for a time not less than the remaining warranty period.

(3) Any warranted part that is scheduled for replacement as required maintenance in the written instructions must be warranted for the period of time prior to the first scheduled replacement point for that part. If the part fails prior to the first scheduled replacement, the part must be repaired or replaced by Dixie Chopper. Any such part repaired or replaced under warranty must be warranted for a time not less than the remainder of the period prior to the first scheduled replacement point for the part.

(4) Repair or replacement of any warranted part under the warranty provisions of this article must be performed at no charge to the owner at a warranty station.

(5) Notwithstanding the provisions of subsection (4) above, warranty services or repairs must be provided at distribution centers that are franchised to service the subject engines or equipment.

(6) The owner must not be charged for diagnostic labor that leads to the determination that a warranted part is in fact defective, provided that such diagnostic work is performed at a warranty station.

(7) Throughout the evaporative emission control system's warranty period set out in subsection (b)(2), Dixie Chopper must maintain a supply of warranted parts sufficient to meet the expected demand for such parts.

(8) Manufacturer approved replacement parts must be used in the performance of any warranty maintenance or repairs and must be provided without charge to the owner. Such use will not reduce the warranty obligations of the manufacturer issuing the warranty.

(9) The use of any add-on or modified parts will be grounds for disallowing a warranty claim made in accordance with this article. The manufacturer issuing the warranty will not be liable under this Article to warrant failures of warranted parts caused by the use of an add-on or modified part.

(10) Dixie chopper shall provide any documents that describe the warranty procedures or policies within five working days of request by the Air Resources Board.

### **EMISSION WARRANTY PARTS LIST:**

- 1) Tank
- 2) Lines
- 3) Caps

# Notes



6302 E County Road 100 N  
Coatesville, Indiana 46121  
[www.dixiechopper.com](http://www.dixiechopper.com)

Specifications and instructions subject to change without notice.

Dixie Chopper and Jacobsen Professional Lawn Care Inc, are registered trademarks.  
Any and all use and/or reproductions are strictly prohibited.

Printed In USA

REV 102714-A