

2190 Dagenais Blvd. West Tel. : 514.337.4415
Laval (Quebec) Fax : 514.337.4029
Canada info@burcam.com
H7L 5X9 see us at **www.burcam.com**

Your pump has been carefully packaged at the factory to prevent damage during shipping. However, occasional damage may occur due to rough handling. Carefully inspect your pump for damages that could cause failures. Report any damage to your carrier or your point of purchase.

**SUBMERSIBLE
UTILITY PUMP
SET TO DRAIN
POOL COVERS**

Please read these instructions carefully. **Failure** to comply to instructions and **designed** operation of this system, may **void** the warranty.

NOTICE

This unit has been designed to pump water only. This unit is not designed for applications involving salt water, brine or any other liquids including petroleum products. Use with salt, brine or any other liquids including petroleum products will void the warranty.

ELECTRICAL CONNECTION

For pumping systems using more than one pump, each pump needs to be connected to its own dedicated circuit protected by a fuse or breaker. The use of dedicated circuits will allow the other pumps to continue functioning even if the fuse or breaker of one of the pumps trips .



SAFETY INSTRUCTIONS:

This fine pump that you have just purchased is designed using the finest materials and workmanship. Before installation and operation, we recommend the following procedures:

- A** CHECK WITH YOUR LOCAL ELECTRICAL AND PLUMBING CODES TO ENSURE YOU COMPLY WITH THE REGULATIONS. THESE CODES HAVE BEEN DESIGNED WITH YOUR SAFETY IN MIND. BE SURE YOU COMPLY WITH THEM.
- B** WE RECOMMEND THAT THE PUMP BE USED ON A SEPARATE CIRCUIT LED FROM THE HOME'S ELECTRICAL DISTRIBUTION PANEL, AND WHICH IS PROTECTED BY A FUSE OR A CIRCUIT BREAKER. THE MOTOR MUST BE SECURELY PLUGGED INTO A PROPER 'GFCI' ELECTRICAL OUTLET. CONSULT A LICENSED ELECTRICIAN FOR ALL WIRING.
- C** THE GROUND TERMINAL ON A THREE PRONG PLUG SHOULD NEVER BE REMOVED. IT IS DESIGNED FOR YOUR PROTECTION.
- D** NEVER MAKE ADJUSTMENTS TO ANY ELECTRICAL APPLIANCE OR PRODUCT WITH THE POWER CONNECTED. DO NOT ONLY UNSCREW THE FUSE OR TRIP THE BREAKER, REMOVE THE PLUG FROM THE RECEPTACLE.

MONTHLY MANDATORY CHECK-UP :

1. Inspect the pump for any obvious condition that necessitates cleaning, correction, adjustment or repair.
2. Clear the surroundings of any paper, leaves or other debris that might clog the input openings. Remove anything that might float into the suction area.
3. Ensure that the pump is secure and vertical for proper operation.
4. Ensure that there is adequate clearance from any combustible materials or structure. Stored materials must be kept away from the pump. Shelves or cabinet structures must not be in close proximity to the pump.
5. Test the 'GFCI' outlet by pressing its test switch. This should prove that the outlet is energized and will trip off to protect against a ground fault. Be sure to reset the 'GFCI' by pressing its reset switch.
6. Put the necessary pail of water in the sump to prove that the pump will start when required and that any check valve present will permit effluent to flow.
7. Observe that the plumbing can carry the effluent safely out.

APPLICATION

- This submersible utility pump is designed for a portable application, for dewatering around homes.
- This pump is great for water transfer from a basin, pool cover, flooded floor, flat roof.

FEATURES

- Non corrosive material.
- Stainless steel mechanical rotary seal.
- Thermal and overload protection.
- 1/6 HP, 115 V AC, 60Hz, 0.8 A (1.6 A at start up)

CAPACITIES

	<u>LPH</u>		<u>US GPH</u>
1.5m	2080	5'	740
3.0m	1900	10'	500
4.5m	375	15'	100

FRICTION LOSS IN
PIPE NOT INCLUDED

NOTICE

This unit is not designed for applications to pump salt water or brine.
Use with salt water or brine will void warranty.

TYPICAL APPLICATIONS FOR THIS PRODUCT

STEP 1

Screw the garden hose to the pump discharge.

STEP 2

Install the pump at the appropriate place to remove water, using the 20' rope for positioning.

Never run the pump dry

STEP 3

Connect the plug to the electrical outlet.

STEP 4

Note that this electronic switch will continue to provide electricity to the pump for 30 seconds after the switch lever drops down, to allow the water to continue to drain through the pump's bottom suction feature.

STEP 5

Remove the plug from the electrical outlet to immediately stop the pump.



REPAIR PARTS

REF.	PART	DESCRIPTION
1	300442N	Pump Power Cord
2	300463	Screws & washers (2)
3	300456	Cord Clasp
4	310942	Motor housing
5	310950	Capacitor
6	310945	Assembled motor
7	310944	Pump casing screws (6)
8	310948	Impeller
9	300443	Strainer
10	300463	Strainer screws (3)
11	300453	Impeller nut
12	310952	Mechanical seal
13	310943	Pump casing
14	450464	Switch (Not shown)
15	300536SB	Round base (Not shown)

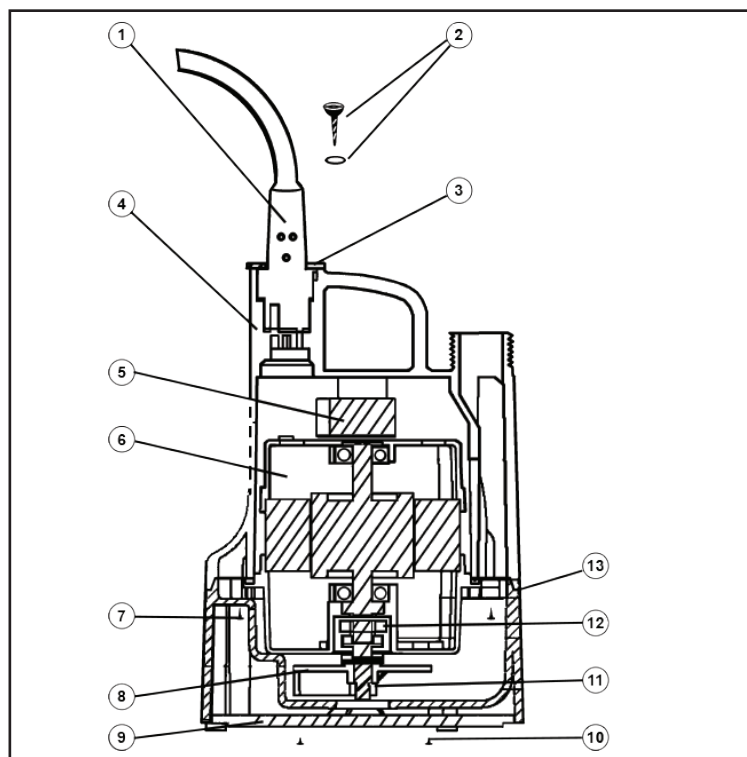

Repair parts may be ordered from your authorized point of sale or from BURCAM PUMPS

TROUBLE SHOOTING GUIDE CHECKLIST

NEVER MAKE ADJUSTMENTS TO ANY ELECTRICAL APPLIANCE OR PRODUCT WITH THE POWER CONNECTED. DON'T JUST UNSCREW THE FUSE OR TRIP THE BREAKER, REMOVE THE POWER FROM THE RECEPTACLE.

TROUBLE

PROBABLE CAUSE

ACTION

**Motor
does
not run.**

Blown fuse
Tripped breaker
Plug disconnected
Corroded plug
Low water level
Thermal overload

Defective motor

Replace
Reset
Re-install
Clean prongs
Add water and verify
Unplug the pump for 15 minutes
than restart.
Replace/repair

**Pump does not
deliver to full
capacity.**

Jammed impeller
Blocked suction/inlet
Discharge leak
Blocked line/pipe
Worn impeller
Defective motor

Clean
Check for debris and clean
Repair
Check for debris or ice
Repair/replace
Replace

TO THE END CONSUMER

If you have any problems with the product, before advising the store, where you've purchased the pump, please contact us at 514 337-4415 , and ask for our sales department, and they will be pleased to help you with any questions you might have, concerning your installation.