

CONSTRUCTION

- Microprocessor controller self tests the battery status, float switch and pump operation every 7 days and sends voice alerts in advance of a problem
- Fully submersible back-up pump for an easy addition to any sump system
- Auto dialer notification calls up to five (5) telephone numbers you program in to alert the homeowner to a problem before flooding occurs (auto dialer requires standard telephone service, a landline or digital telephone service like DSL or cable telephone - product will not work with a PBX or internet phone system)
- Includes connection port for 3rd party security system notification
- Corrosion-resistant Thermoplastic construction for long life in tough sump applications
- Corrosion-resistant Thermoplastic impeller for maximum water flow
- Protective battery case included with LCD screen display
- 1-1/2 in. NPT discharge for easy installation and compliance with building codes
- For use in 14 in. diameter or larger sump basins
- "Drop in the pit" ready, complete with two (2) 1-1/2 in. check valves already installed

SWITCH

- Reliable dual float switch with float cage for added protection
- ON / OFF levels are user adjustable

MOTOR

- Powerful 12 VDC motor, with pumping capacity that nearly matches an AC powered pump
- Requires one (1) 75 Amp or 40 Amp battery for operation (see accessories section)

1/3 HP JOB READY PREASSEMBLED BACK-UP & PRIMARY SYSTEM

PRIMARY 60 GPM @ 5 FT. / BACK-UP 47 GPM @ 5 FT.

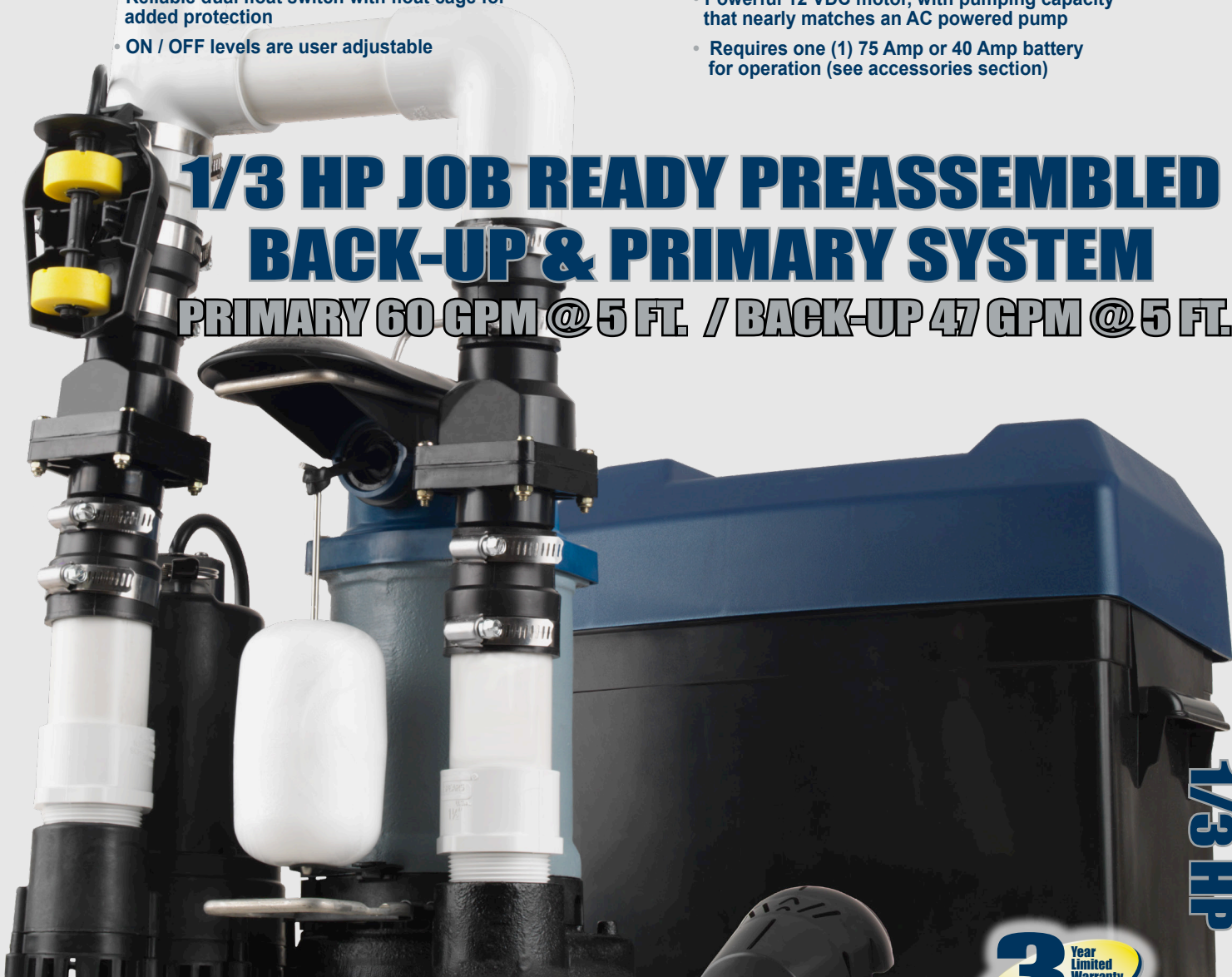

1/3 HP



DIMENSIONAL DATA (INCHES)

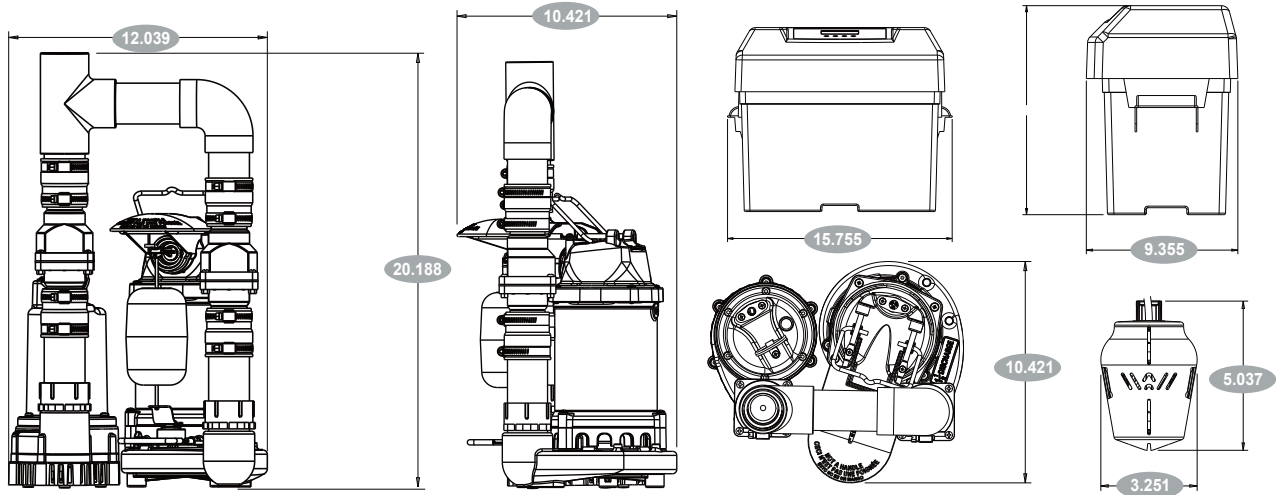

PUMP SNAPSHOT

		Dimensions (in.)									
HP	Construction	Switch Type	Length	Width	Height	Weight	Volts	Footprint	Power Cord		
1/3	Cast Iron	Dual Float	10.421	12.039	20.188	31 lbs	120	14 in.	10 ft.		
		12VDC Thermoplastic									

Impeller	Intake	Discharge	Submersible	UPC 0-40066
Centrifugal	Top / Bottom Suction	1-1/2 in. NPT	Yes (pump)	216243

TYPICAL INSTALLATION

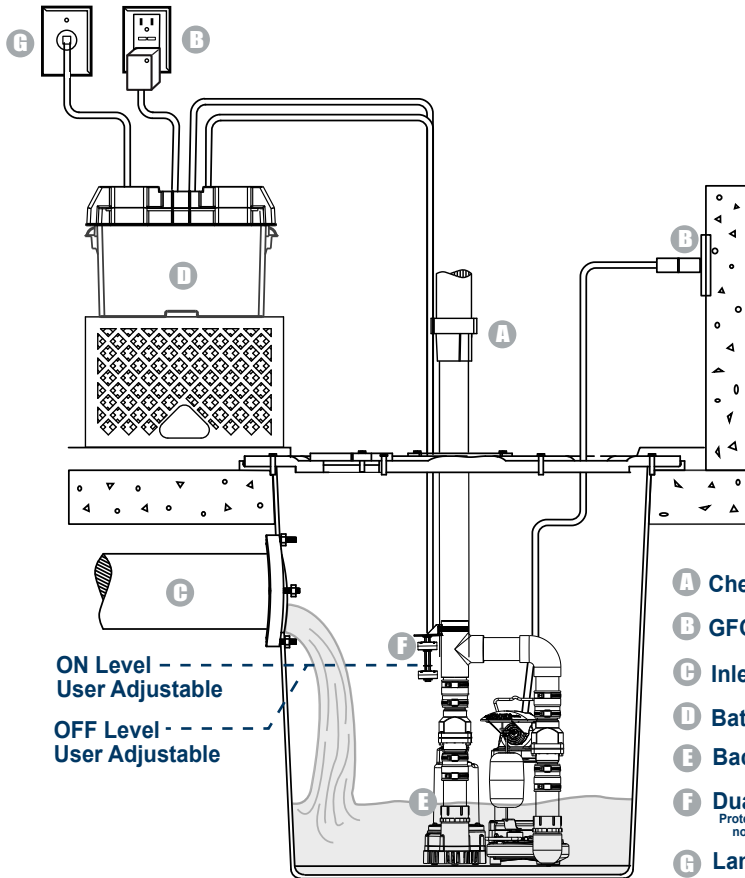

DF33SMS PERFORMANCE

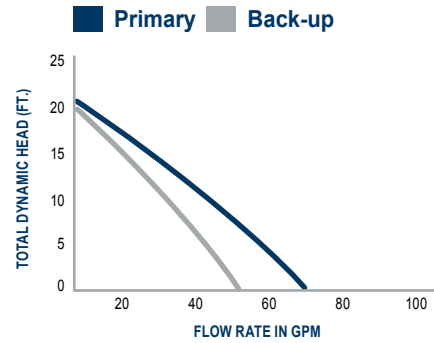

Discharge Head	5 ft.	10 ft.	15 ft.	20 ft.
GPM Primary	60	48	36	14
GPM Back-up	47	38	25	-

- A** Check Valve
- B** GFCI Plug
- C** Inlet
- D** Battery Box
- E** Back-Up
- F** Dual Float
Protective cage not shown
- G** Landline