



Big League LAWNS

CheckMate™ Lawn and Athletic Field Striping Kits

1161 E. Clark Road, Suite #220

◆ DeWitt, MI 48820

◆ 800.411.0150

www.bigleaguelawns.com



CheckMate™ Lawn Striping Kit For Honda HRN Installation Guide

Important

Big League Lawns, LLC warrants their products to be free of defects in material and workmanship. This warranty does not cover defects due directly or indirectly to misuse, abuse, normal wear and tear, failure to properly maintain the product or used for a purpose other than that for which it is intended. The duration of this warranty is expressly limited to one year parts and labor beginning from the date of delivery to the original customer.

The obligation of Big League Lawns, LLC is limited solely to the repair or replacement, at our option, at its factory or authorized repair agent of any part that should prove deficient. Purchaser must maintain the product under normal operating conditions at all times. Prior to operation, become familiar with the attachment and any disconnect features. This product is not intended to be used in a transport position or to be backed over curbs. When not in use, the product should be removed from the mower and transported in a safe manner. Failure to follow these instructions will void the warranty.





US Patent 6,962,039 B2, US Patent 6,993,894 B2

Mounting Instructions Honda HRX Series Mowers

Congratulations on your new purchase! You are just steps away from creating a beautifully patterned lawn using your new CheckMate™ lawn striping roller. To ensure a long life of both your mower and roller, please be sure to follow the mounting recommendations below.

Tools Required:

3/4" Wrench or Socket	7/32" Allen Wrench	9/16" Wrench	12mm Socket	Drill	3/8" Drill Bit
					

Before Installation Process

Safely prop up the backside of your mower and remove the bagger from the mower.

Step 1: Remove Tire

Using a 12mm socket or wrench, rotate tire retaining bolt counter clockwise and remove tire.



Step 2: Mark Drilling Location

Place the provided 3/8" washer against the back of the frame. The 3/8" washer should rest in the back corner of the deck; touching both the bottom and back sidewalls as pictured below. You may mark the hole with a pen or carefully use the washer as your drill guide.



Step 3: Drill Mounting Hole

Using a 3/8" drill bit, carefully drill your mounting hole. Note; very little pressure should be applied to the drill. Simply allow the bit to slowly drill the hole. The newly drilled hole will serve as your mounting location. (Pictured on the right below)

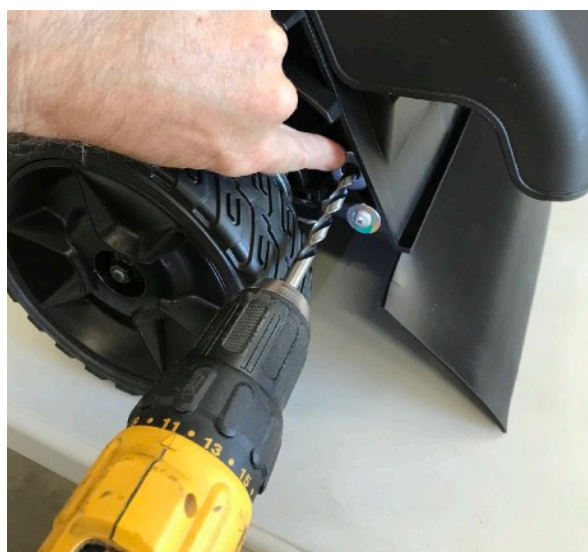

Step 4: Installing Mounting Arms

Install Mounting Arm

Install mounting arm through the mounting hole. On the underside, install one 3/8" flat washer and one 3/8" nylon locknut onto the exposed threads of the mounting bolt.



Tighten

Using a 9/16" wrench and a 7/32" hex key, secure the mounting arm to the mower frame.



Step 5: Reinstall Wheel

Place the wheel back onto the axel; aligning gears. Once aligned, use a 12mm" socket to secure the tire to the axel.



Step 6: Repeat Steps 1-5 For Opposite Side of Mower

Step 7: Assemble Mounting Arms

Using the schematic below, assemble your mounting arms to connect the channel piece in the next step.

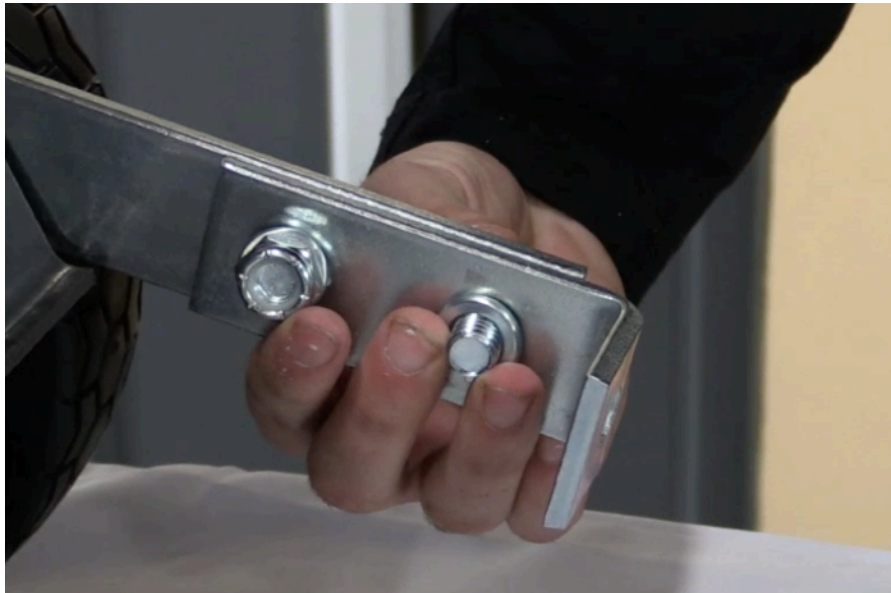
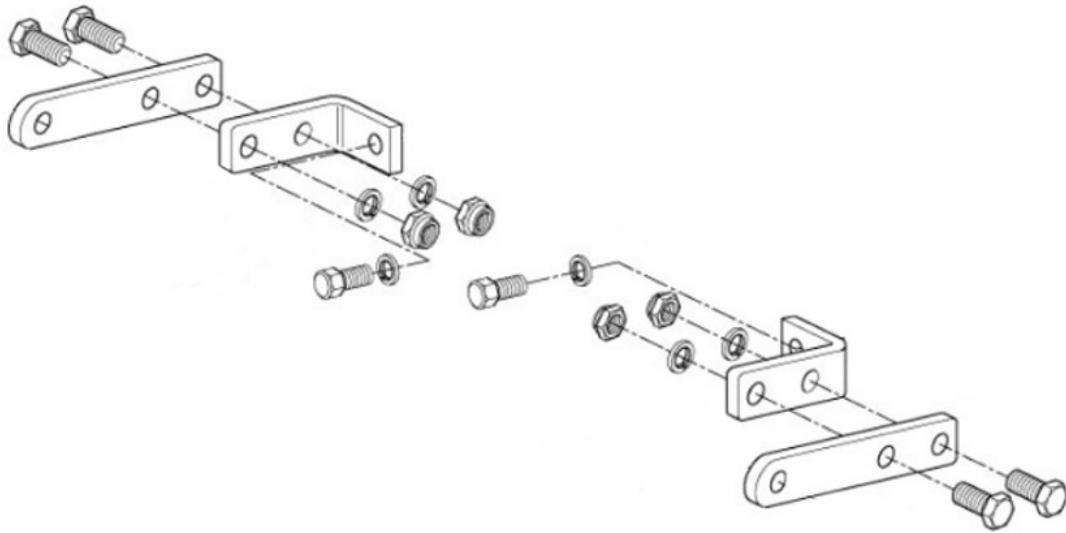

Step 8: Install Striping Kit

Remove preinstalled 1/2" x 1" bolts and lock washers from gray channel. Re-insert the bolt [with split lock washer] through the L shaped bracket and thread into the channel nut inside channel. **(Before tightening bolts all the way down; center roller behind the mower)**

After centering the roller; use a 3/4" wrench to firmly tighten each mounting arm to the striping roller.



Final Steps

Check installation, pick up the roller to confirm it freely pivots up and down.

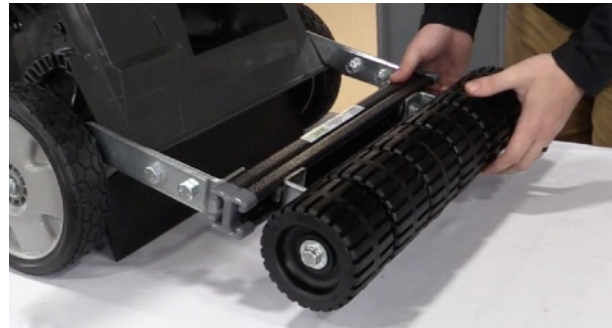
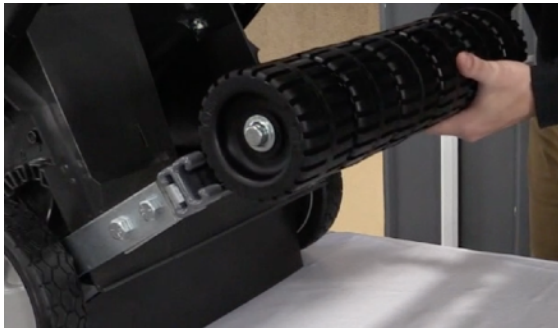

Installation is now complete! Enjoy your striping with your new CheckMate™ Striping kit!

***Installation video can be found on our YouTube page below:**

<http://www.youtube.com/user/bigleaguelawns>

