



CheckMate™ Lawn and Athletic Field Striping Kits

1161 E. Clark Road, Suite #220

DeWitt, MI 48820

800.411.0150

[www.bigleaguelawns.com](http://www.bigleaguelawns.com)



## CheckMate™ TimeMaster/TurfMaster & Exmark Commercial 30 Lawn Striping Kit Installation Guide

### Important

Big League Lawns, LLC warrants their products to be free of defects in material and workmanship. This warranty does not cover defects due directly or indirectly to misuse, abuse, normal wear and tear, failure to properly maintain the product or used for a purpose other than that for which it is intended. The duration of this warranty is expressly limited to one year parts and labor beginning from the date of delivery to the original customer.

The obligation of Big League Lawns, LLC is limited solely to the repair or replacement, at our option, at its factory or authorized repair agent of any part that should prove deficient. Purchaser must maintain the product under normal operating conditions at all times. Prior to operation, become familiar with the attachment and any disconnect features. This product is not intended to be used in a transport position or to be backed over curbs. When not in use, the product should be removed from the mower and transported in a safe manner. Failure to follow these instructions will void the warranty.







US Patent 6,962,039 B2, US Patent 6,993,894 B2

Congratulations on your new purchase! You are just steps away from creating a beautifully patterned lawn using your new CheckMate™ lawn striping roller. To ensure a long life of both your mower and roller, please be sure to follow the mounting recommendations below.



**Note:** For your reference on how to install the Toro TimeMaster specifically, you can watch a video of this installation by going to our website and clicking on the Toro® TimeMaster® and scrolling to the gallery section. Additionally the video can be found on our youtube channel.

**Tools Required:**

<p>1/2" Wrench 3/4" Wrench</p> 	<p>1/8" Allen Wrench 3/16" Allen wrench (Included)</p> 	<p>5/16" Drill Bit</p> 	<p>Drill</p> 
--	--	---	--

**Step 1 (TimeMaster):**

The photos below depict the mounting location of the CheckMate™ striping roller on each mower.

<p>TimeMaster</p> 	<p>TurfMaster/ Exmark Commercial 30</p> 
---	--

**Step 1 (TurfMaster/ Exmark Commercial 30):**

The photo below depicts the mounting location of the CheckMate™ striping roller. Note that a 5/16" hole is required near the existing 5/16" bolt that secures the support arm to the mower frame. To mark your hole, place a 5/16" nylon lock nut on the 'inside' of the support arms **near** the rear discharge door. This will help you to determine where to drill your 5/16" hole from the 'outside' while making sure that the pivot bolt will attach to the 5/16" nylon lock nut once the hole has been drilled.



US Patent 6,962,039 B2, US Patent 6,993,894 B2

**Step 2:**

Using the Mounting Option A schematic below, use the supplied nuts, bolts and lock washers to firmly attach the CheckMate™ pivot arms to the corresponding L brackets.

Using the specially designed 'channel nuts', loosely attach each of your mounting arms to the grey channel that parallels the roller. Please make sure that the 'teeth' of each of these channel nuts are facing 'up' when placed inside the grey channel. Finger tighten each of the mounting arms into place so that they are aligned towards the outer grey protective end caps.

***Hint... you may place the rectangular channel nuts inside the grey channel and then turn them 90 degrees to position them into place.***

**Mounting Option A**

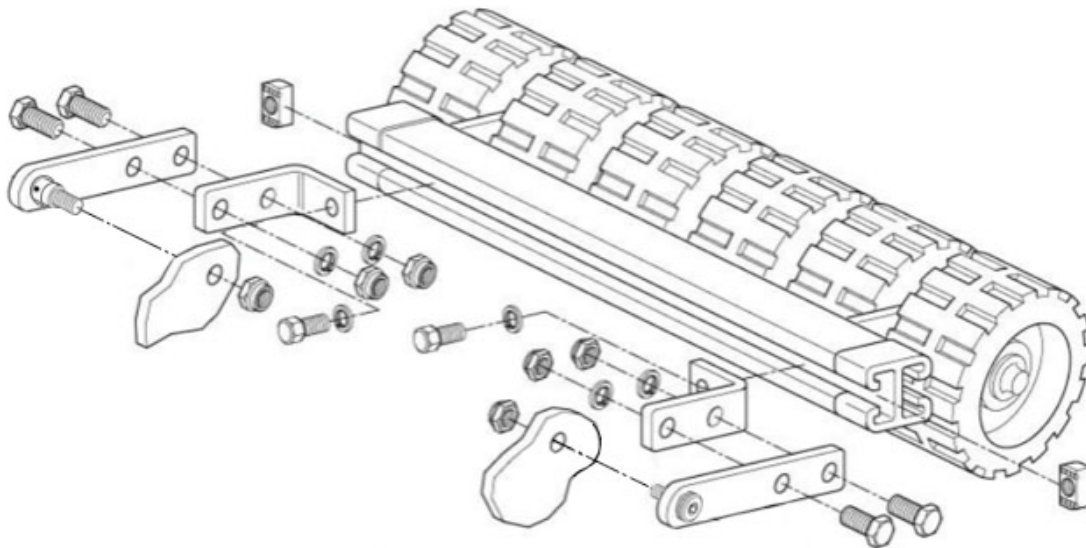

**Step 3:**

You are now ready to mount the roller to your mower. Temporarily remove your bagger from the mower. Slide the roller into place behind the Toro® TimeMaster®. Beginning with one side, insert the hex head pivot bolt, (in the pivot arm) into the existing 5/16" hole in the mower frame. Lock the pivot bolt into place using the supplied 5/16" nylon lock nut. Repeat this process for the opposite side.

Each of the two pivot arms should now be able to freely pivot up and down on their pivot bolt. Your last step is to **center** the roller behind the mower and to firmly tighten each of the two mounting arms to the grey channel.

**Step 4:**

Reinstall your mower bagger and enjoy creating beautiful patterns with your newly purchased CheckMate™ lawn striping system.

**Installation is now complete! Enjoy your striping with your new  
CheckMate™ Striping kit!**