

**Submersible Non-Clog Pumps**

The Laundry Tray system is designed for above the floor “grey water” sump applications. Typical uses include laundry trays, wet bars, dehumidifiers, water softeners and air conditioner condensation. Manufactured with high quality polyethylene resins and tested to industry standards. The pre-assembled system comes complete with pump, tank, 1½” discharge and check valve.

**FEATURES:**

- Basin components are durable, corrosion-resistant polyethylene.
- Box and cover have a matching textured finish.
- 1-1/2” threaded inlet and vent.
- Grommet cord seal.
- Accommodates 1-1/2” discharge piping.
- Stainless steel bolts.
- Large 6 gallon capacity.
- Size: 15” x 15” x 14”
- Package weight 19-1/2 lbs. (Includes pump)

MODEL	PART NO.	PUMP MODEL	PART NO.
SU33LT	131411	SU33	130234

See Section A pages 1 and 2 for additional pump data.

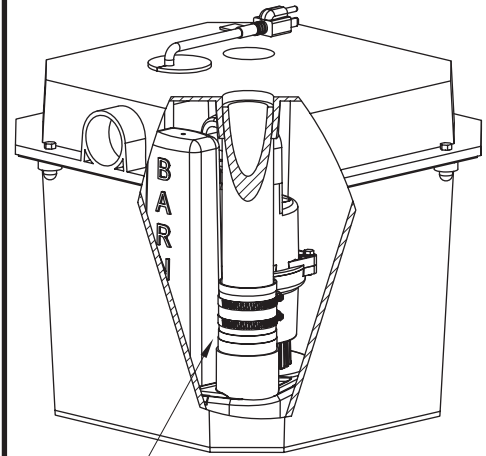

Pre-installed check valve

**Series: SU33LT, 60Hz**  
**P/N: 131411**

**DESCRIPTION:**

GENERAL PURPOSE PACKAGED PUMP SYSTEM FOR RESIDENTIAL APPLICATIONS

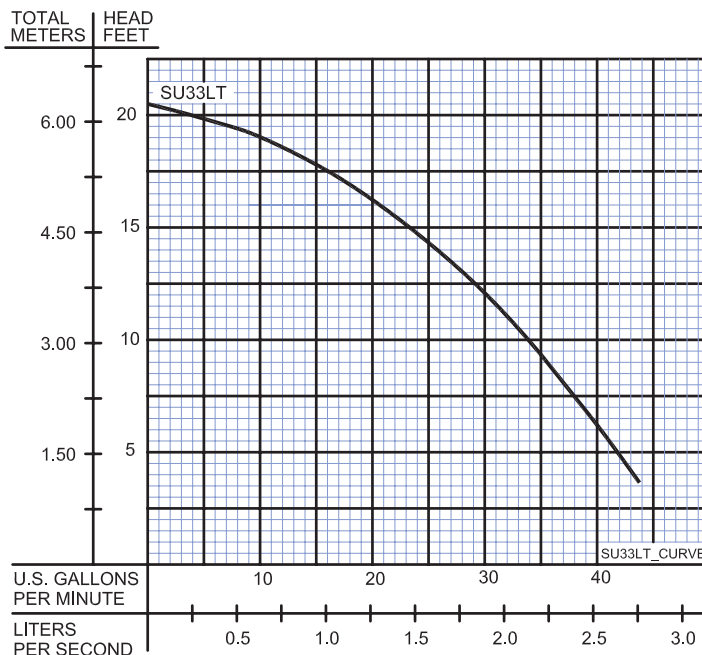

Testing is performed with water specific gravity of 1.0 @ 68°F (20°C), other fluids may vary performance

# Series SU33LT

Laundry Tray System

# BARNES®

Professional Plumbing

www.cranepumps.com

## Submersible Non-Clog Pumps

inches  
(mm)

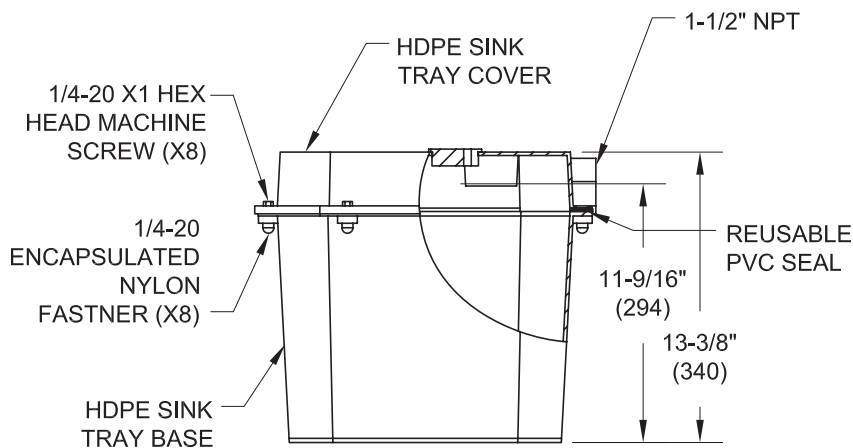
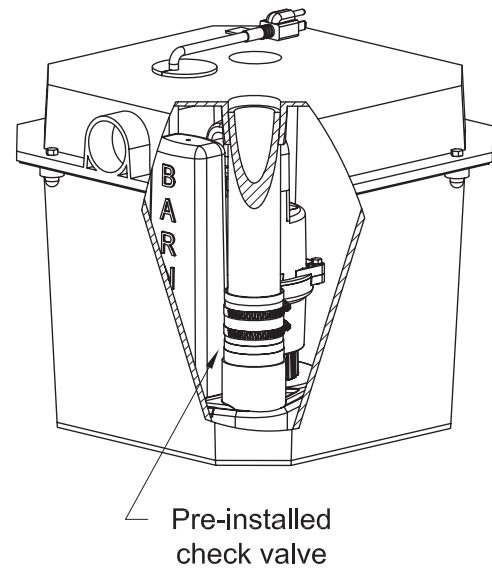
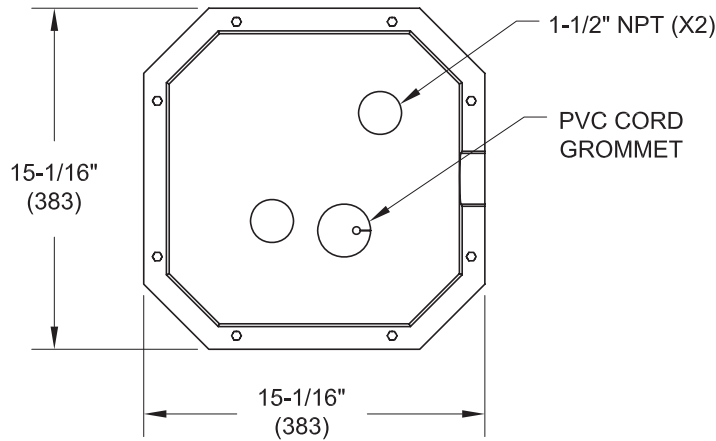

### IMPORTANT !

- 1.) THIS BASIN MUST BE INSTALLED IN ACCORDANCE WITH THE NATIONAL ELECTRIC CODE ANSI/NFPA 70 AND/OR THE AUTHORITY HAVING JURISDICTION. THIS PUMP IS NOT INTENDED FOR USE IN SWIMMING POOLS, RECREATIONAL WATER PARKS, OR INSTALLATIONS IN WHICH HUMAN CONTACT WITH PUMPED MEDIA IS A COMMON OCCURRENCE.

SECTION B  
PAGE 2  
DATE 3/14

## CRANE®

A Crane Co. Company

## PUMPS & SYSTEMS

USA: (937) 778-8947 • Canada: (905) 457-6223 • International: (937) 615-3598