

# Instruction Sheet

## Kit Number: 79107800

### REAR BAGGER ATTACHMENT KIT



**WARNING:** FAILURE TO FOLLOW INSTRUCTIONS could result in personal injury and / or damage to unit.

**IMPORTANT:** Save these instructions for future reference.

### PACKAGE CONTENTS

Check the contents of your kit for the parts listed below. Also see Figure 1.

Item	Description	Qty	Ariens P/N
1	Bagger Support	2	05138551
2	Right-side Support Bracket	1	05116451
3	Left-side Support Bracket	1	05116551
4	Transmission Disconnect Decal	2	03271900
5	1/2"-13 x 3" Hex Bolt	2	05901737
6	1/2"-13 x 3 1/4" Hex Bolt	2	05901634
7	1/2"-13 x 3" Top-Lock Flange Nut	4	06500907

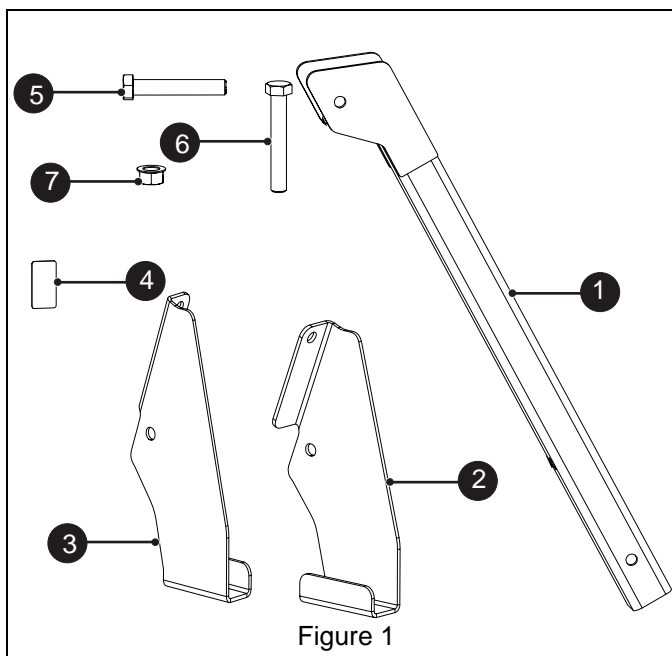

Figure 1

### REMOVAL

1. Stop engine, remove key and engage parking brake. Wait for moving parts to stop and for hot parts to cool.
2. Disconnect spark plug wires.
3. Remove four screws retaining ROPS pocket covers and remove covers. Discard covers; reinstall screws for better appearance. See Figure 2.

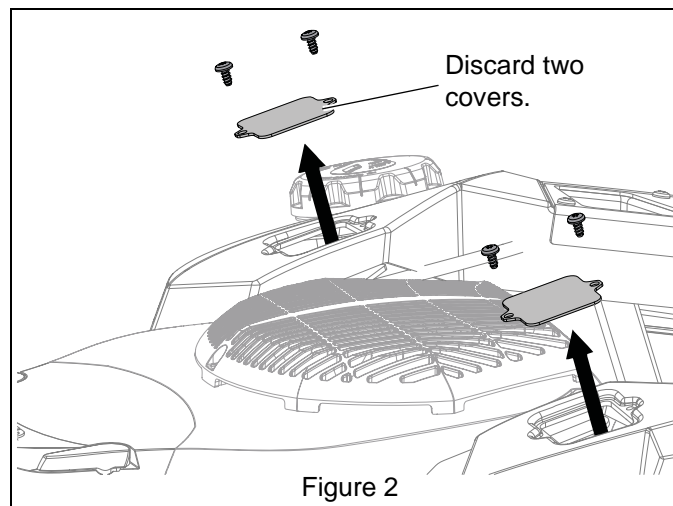
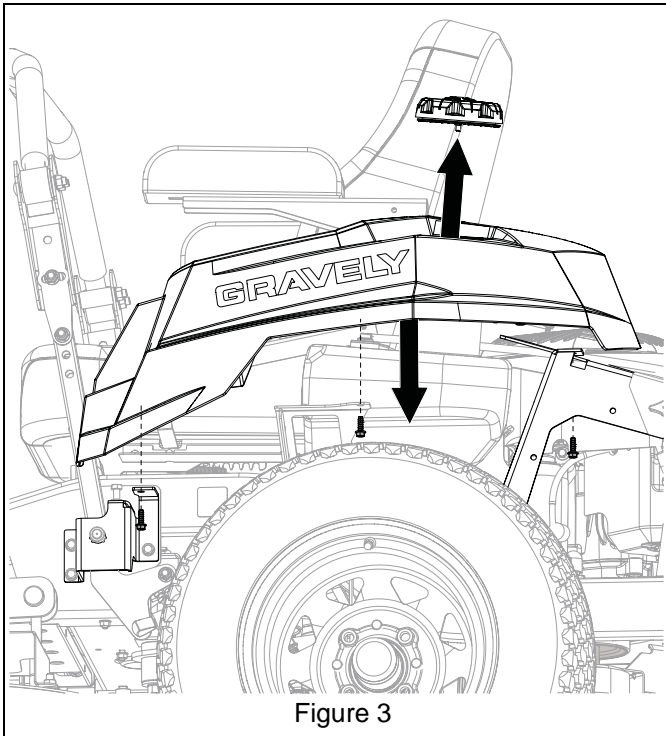

Figure 2

### INSTALLATION

#### Install Left Bagger Support

1. Remove fuel cap.
2. *Apex Models:* Remove three plastic hex screws retaining left fender and remove fender.
3. *HD Models:* Remove four plastic hex screws retaining left fender and remove fender. See Figure 3.



4. Loosen the rear fuel tank strap mounting bolt to allow some fuel tank movement. See Figure 4.

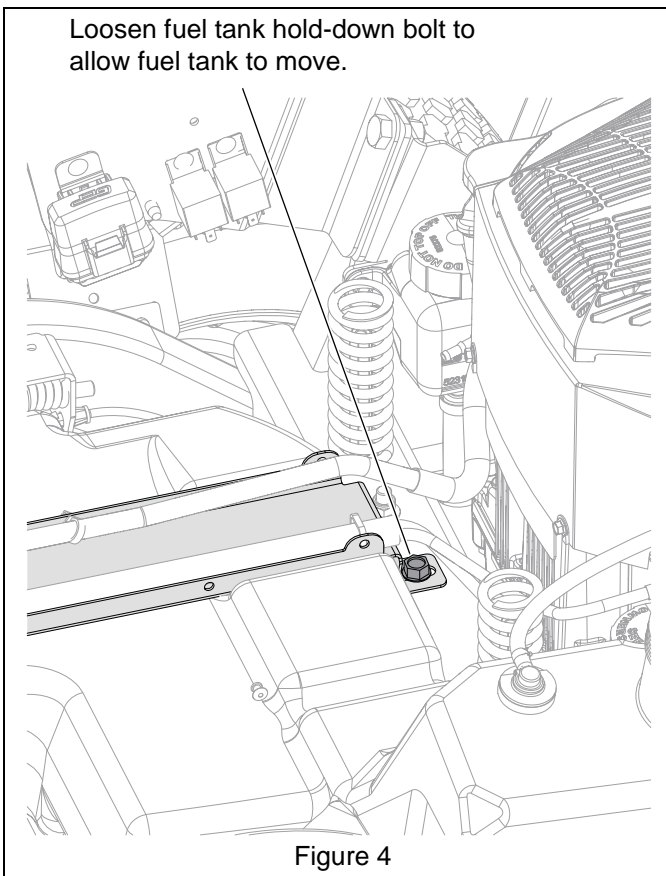

5. Clean surface thoroughly and attach one transmission disconnect decal (item 4) to left-side support bracket (item 3). See Figure 5.

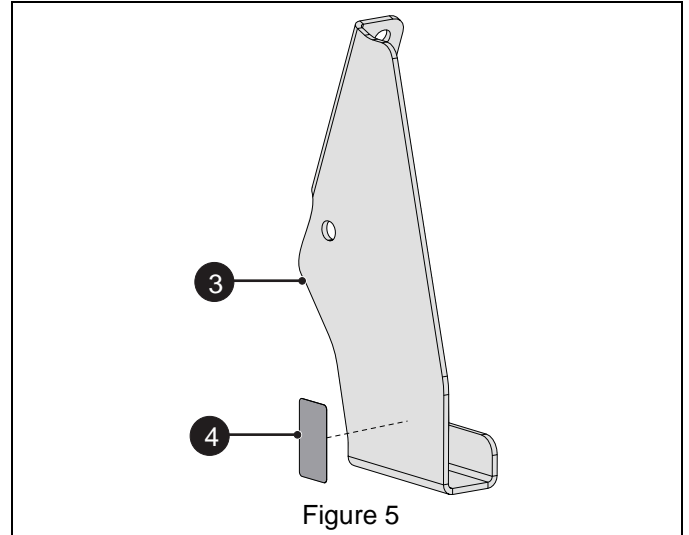

6. From above unit, position bracket on frame. It may be necessary to move the fuel tank filler slightly to provide clearance. See Figure 6.

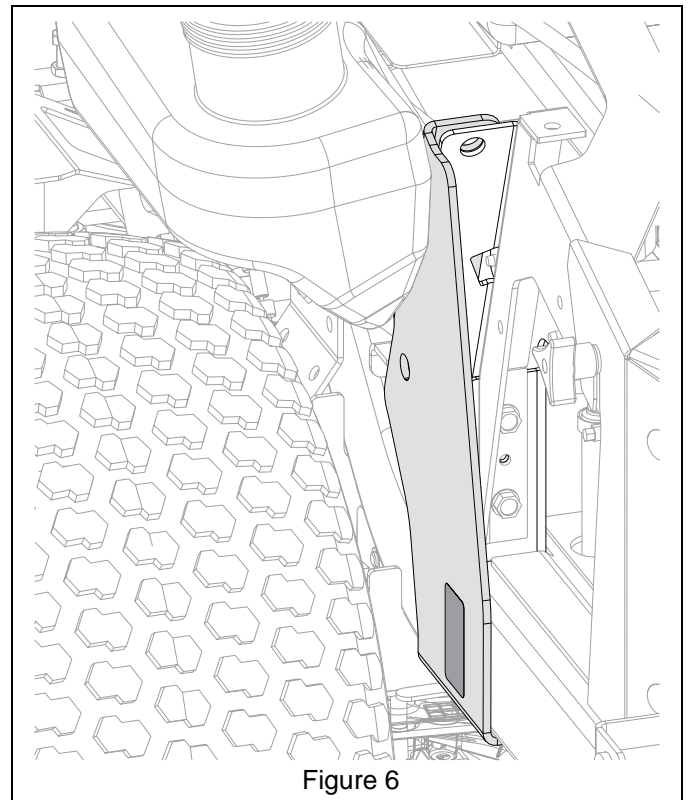

7. Reinstall fender but DO NOT install hex screws at this time.
8. Reinstall fuel cap.
9. Insert bagger support (item 1) through the opening and between left support bracket and frame. Ensure that hinge plates are positioned facing the rear. See Figure 7.

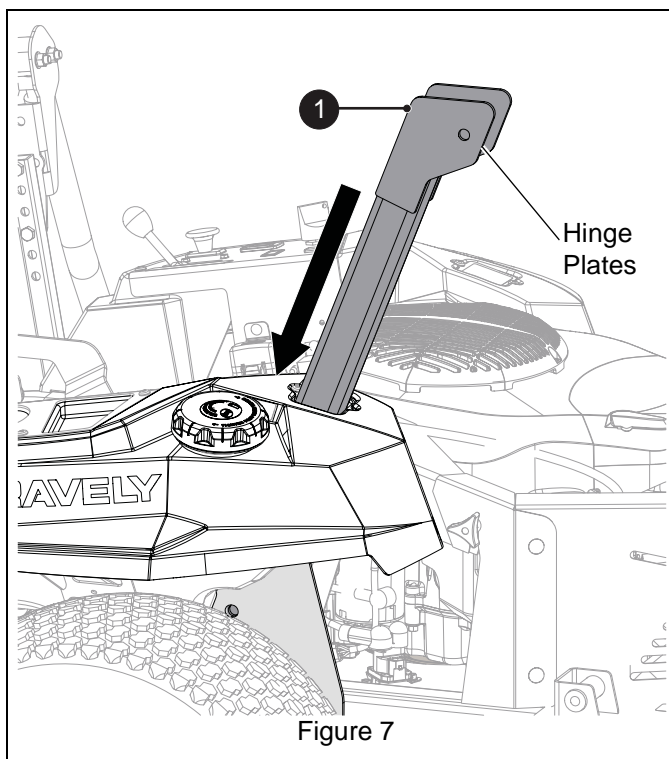

Figure 7

10. Attach bagger support with one 1/2" x 3 1/4" hex bolt (item 6), one 1/2" x 3" hex bolt (item 5) and two 1/2" top-lock flange nuts (item 7). Fully tighten hardware. See Figure 8.

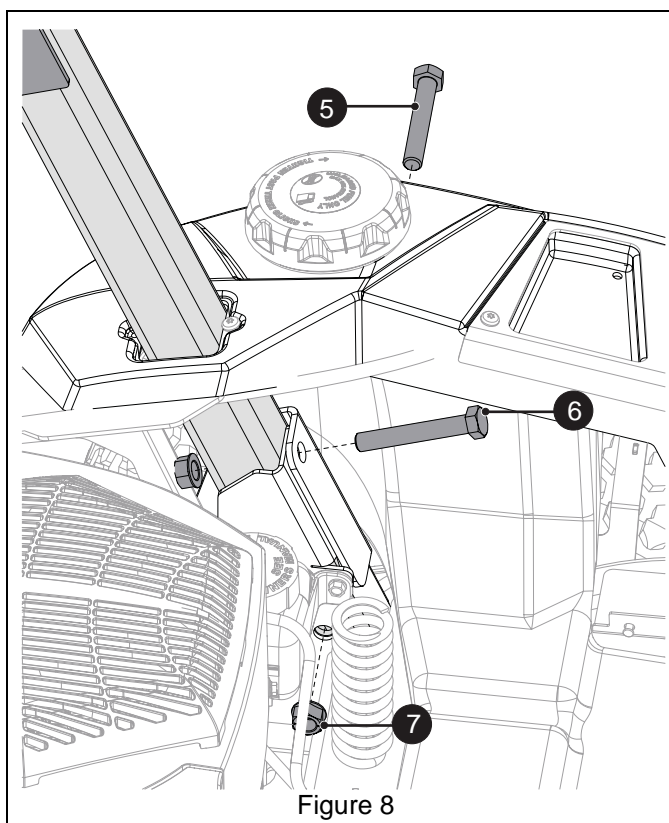

Figure 8

11. Reinstall plastic hex screws retaining left fender.

## Install Right Bagger Support

1. Clean surface thoroughly and attach one transmission disconnect decal (item 4) to left-side support bracket (item 2). See Figure 9.

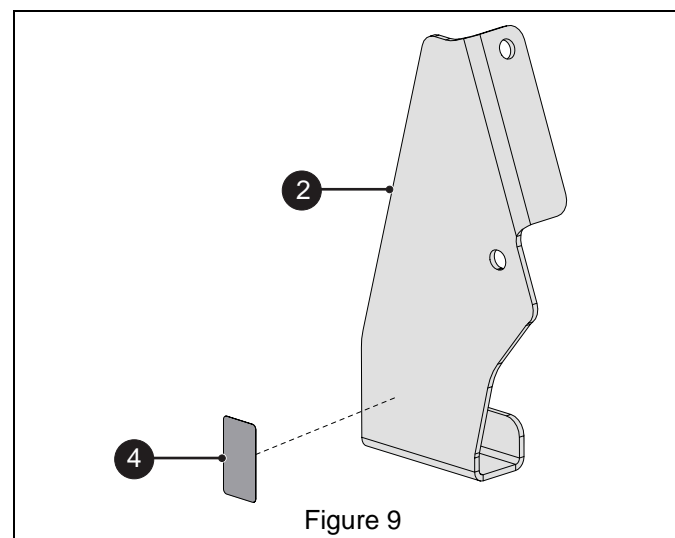

Figure 9

2. Remove 1/2" x 1" bolt and hex nut retaining spacer plate and remove plate. Discard bolt, nut and spacer. See Figure 10.

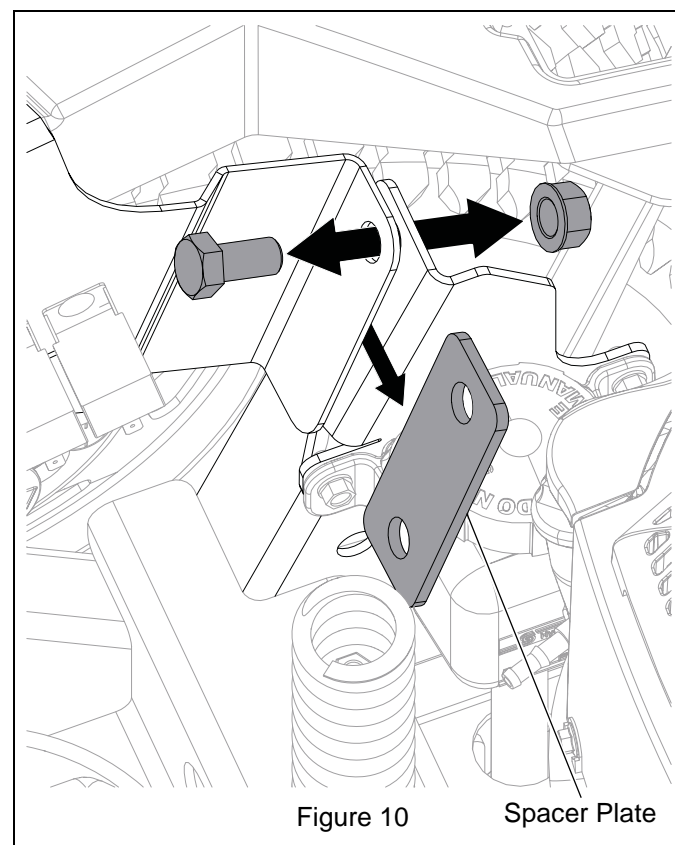

Figure 10

Spacer Plate

3. From below unit, position right-side support bracket on frame. Ensure that support bracket is positioned between control panel bracket and existing support bracket. See Figure 11.

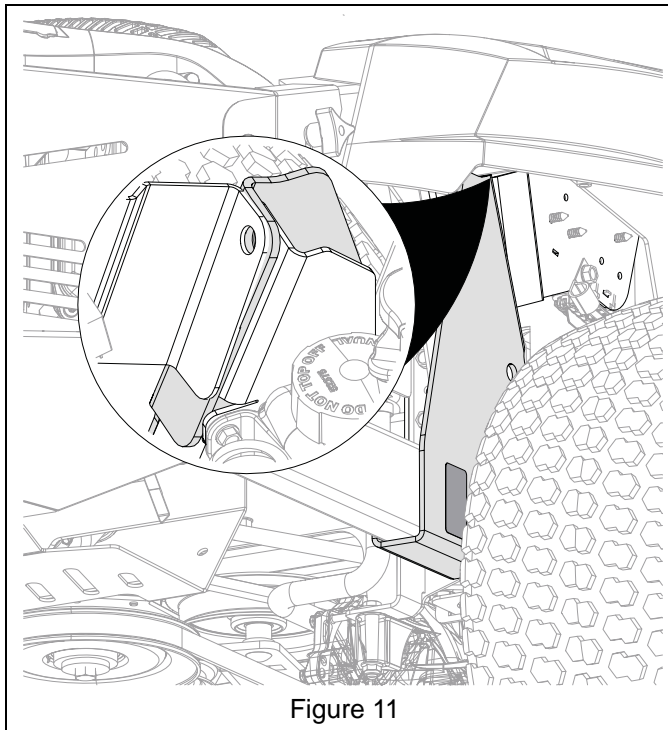

Figure 11

4. Insert bagger support (item 1) through the opening and between right support bracket and frame. Ensure that hinge plates are positioned facing the rear. See Figure 12.

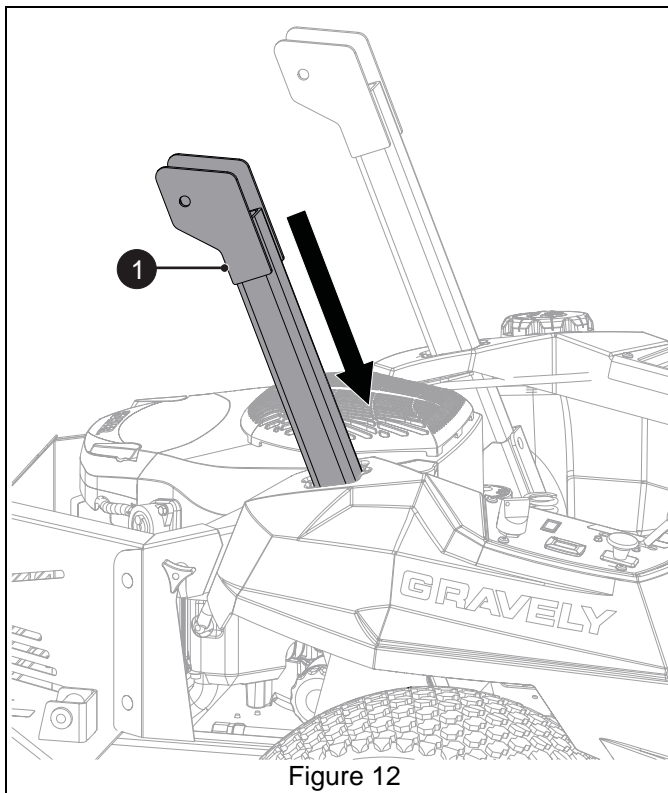

Figure 12

5. Attach bagger support with one 1/2"-13 x 3 1/4" hex bolt (item 6), one 1/2" x 3" hex bolt (item 5) and two 1/2" top-lock flange nuts (item 7). Fully tighten hardware

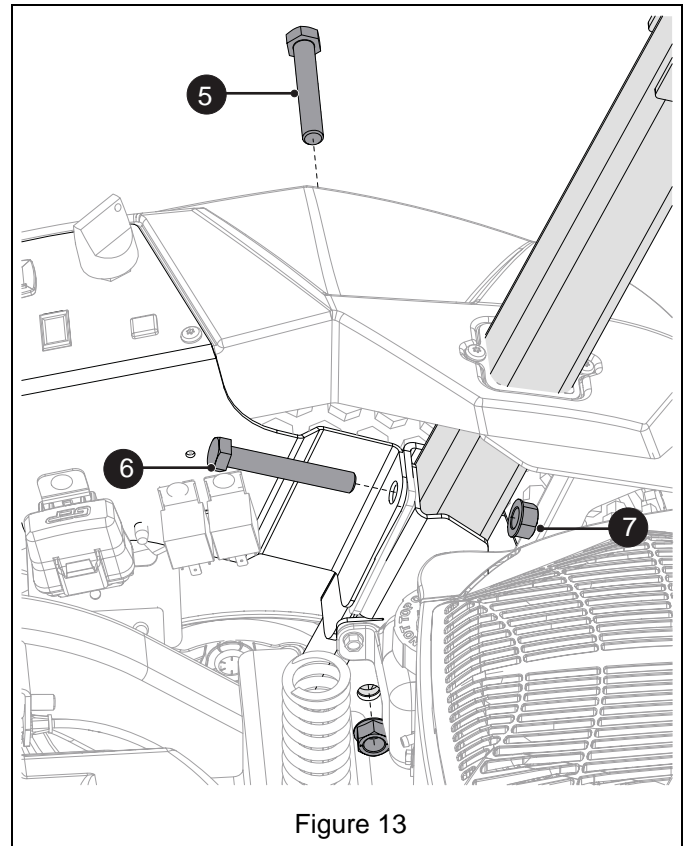

Figure 13

6. Re-tighten the rear fuel tank strap mounting bolt.
7. Complete installation of bagger using the directions provided in the Operator's manual.
8. Reconnect spark plug wires.