

Product Services Information

INSTALLATION INSTRUCTIONS

Dump From Seat Attachment (DFS)

Compatibility

The DFS is compatible with all current production "Timecutter" Zero Turn Mowers with the two bag collector, model numbers 79333, 79334, 79335, 79336 and 79337.

Operation

To empty the bin, pull the lever and drive slowly forward until empty. Push the lever back firmly so it latches.

The front weight kit must be installed when using this attachment.

Safety

Read the general safety operating precautions in your machine installation instruction manual for additional safety information.

★The DFS is limited to carrying only grass or leaves.

★DO NOT allow anyone to ride in the DFS unit.

★Be aware of the potential pinch point when closing the tailgate.

Parts in Kit

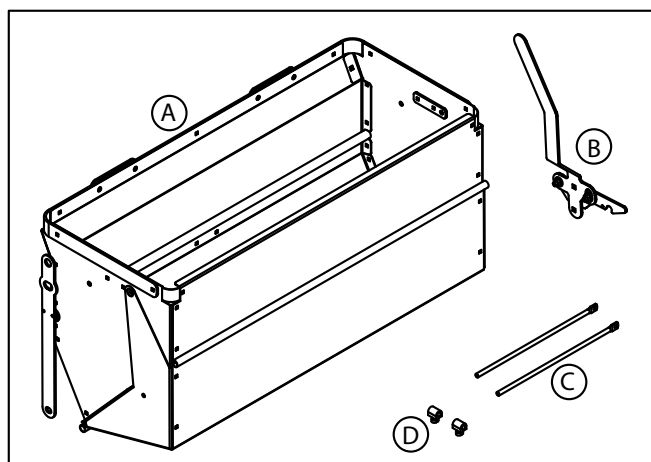

Qty.	Description
1	DFS Bin Assembly (A)
1	Handle and Latch Assembly (B)
1	Lift Link (C)

Hardware Bag

Qty.	Description
2	Adjustment Link (D)
2	3/8" x 1" Carriage Bolt
2	3/8" Nylock Nut
2	3/8" Plastic Washer
4	3/8" Flat Washer
4	3/8" Jam Nut
1	3/8" x 1-3/4" Bolt
1	3/8" Flange Nut
1	Spring
1	Steel Bushing
2	5/16" x 1-3/4" Bolt
4	5/16" Flange Nut

Assembly

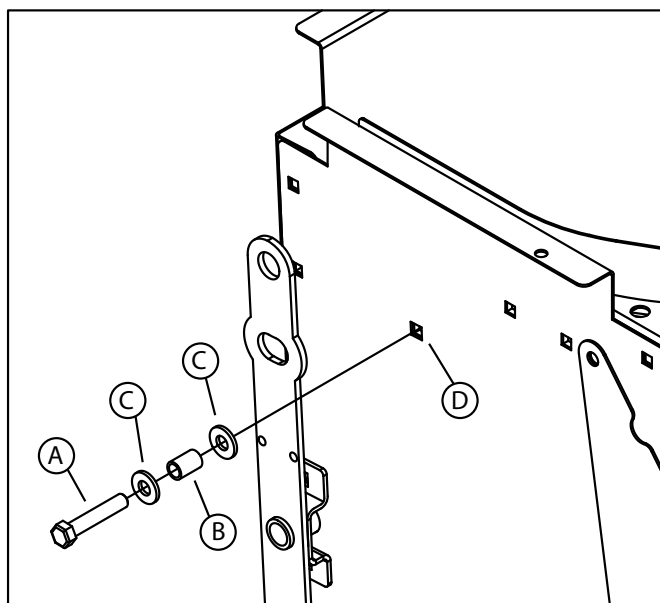

1. Place 3/8" Washer (B), Steel Bushing (A), and another 3/8" Washer (B) over 3/8" x 1-3/4" Bolt (B) and insert it into hole (D). Fasten on the inside with a 3/8" Flange Nut.

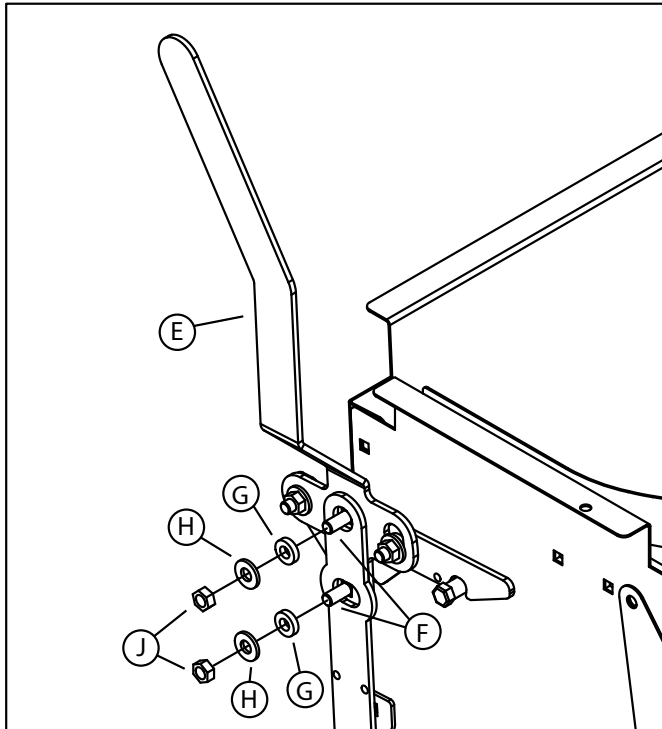

2. Install Handle (E) using two 3/8" x 1" Carriage Bolts (F), two 3/8" Plastic Washers (G), two 3/8" Wide Flat Washers (H), and two 3/8" Nylock Nuts as shown.

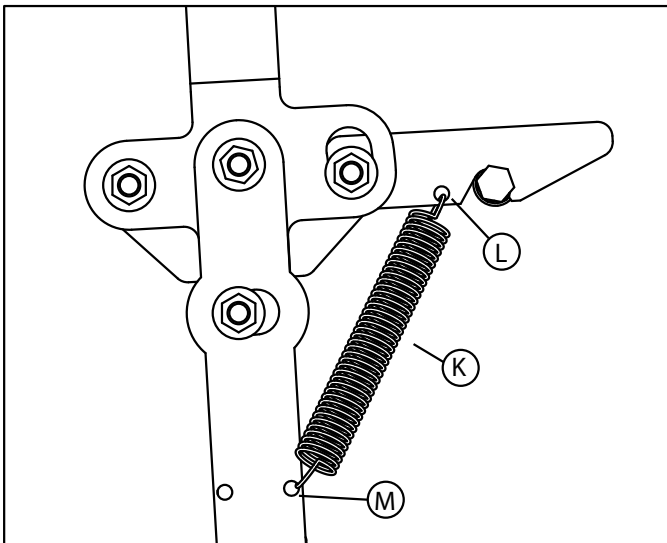

3. Connect Spring (K) from hole (L) in latch to hole (M) in lever.

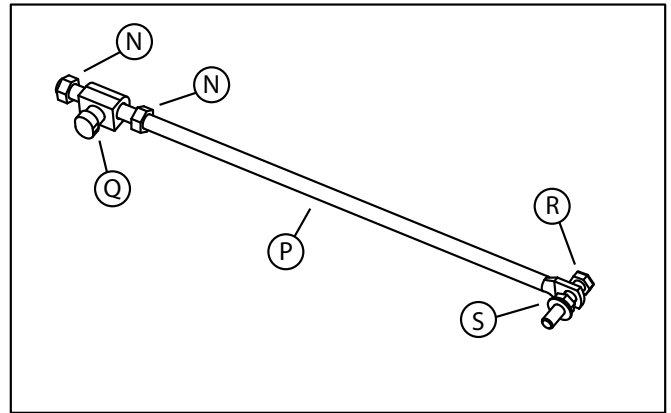

4. On threaded end of Lift Links (P), turn on one 3/8" Jam Nut (N) to the end of the threads. Insert the threads through the Adjustment Link (Q) and put another 3/8" Jam Nut (N) on the end.
5. Insert 5/16" x 1-3/4" Bolt (R) through hole on other side of Lift Link (P) and thread a 5/16" Flange Nut (S) to the end of the threads with the flange facing away from the lift link.

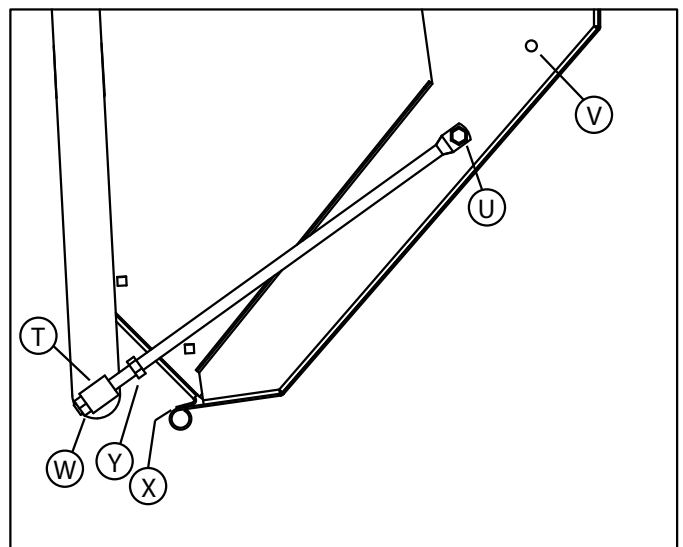

6. Insert the Adjustment Link (T) through the slot in the lever. Rotate lift link to put bolt through the hole in the side of the tailgate. Fasten inside with 5/16" Flange Nut.
7. With the handle latched, tighten 3/8" Jam Nut (W) until there is no gap between the bin and the tailgate (at location (X), over tightening will make it difficult to unlatch and empty). Then tighten Nut (Y) back against the adjustment link to jam it in place.