

Lyric™

Life in tune.

Honeywell

Installation Guide

Removing your existing thermostat 3

Installing your Lyric thermostat 5

Connecting your Lyric thermostat 7

Configuring your Lyric thermostat 8

Personalize your Lyric thermostat 9

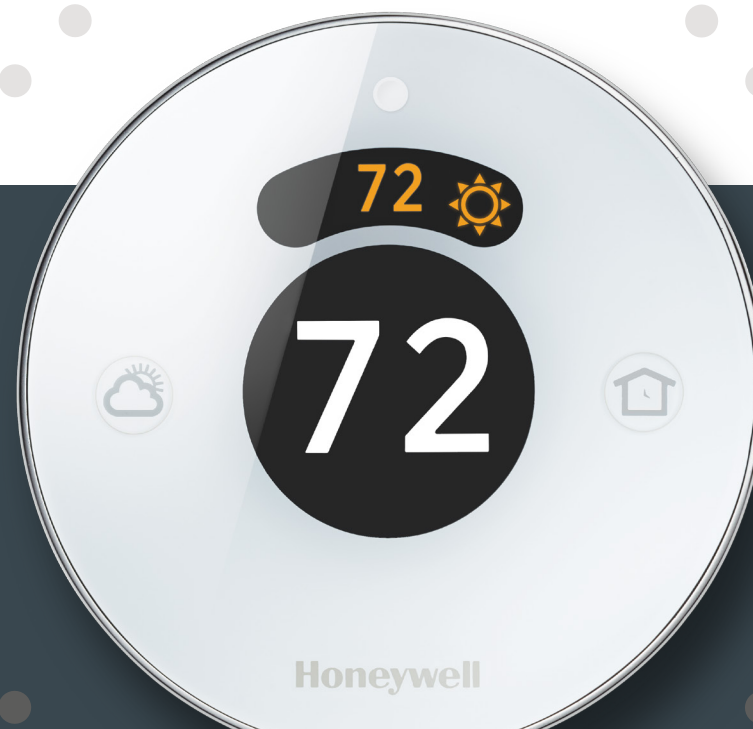

Get started



To get started, download the app by searching for Lyric in the App Store or Google play. Follow the steps to create an account before you get started.

Next, verify you have the following in your package:

- Thermostat
- Wallplate
- Mounting screws
- Backplate - this is an optional piece used to help cover marks left by the old thermostat.

You will need:

- Wi-Fi password
- Ballpoint pen
- Phillips screwdriver
- Pencil

Remove your existing thermostat

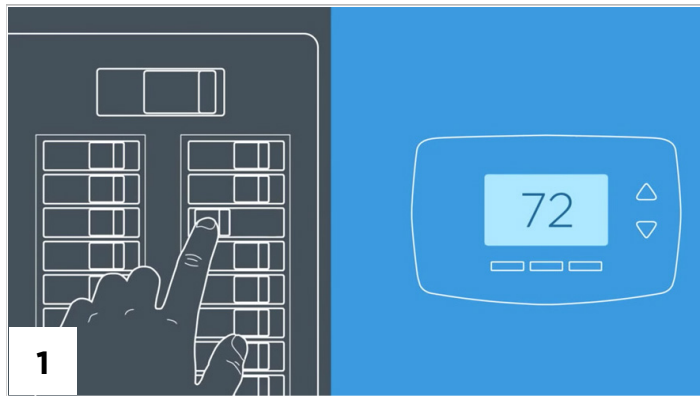

Switch off the power to your heating and/or cooling system at the circuit breaker box or at the system switch or on your heating and/or cooling unit.

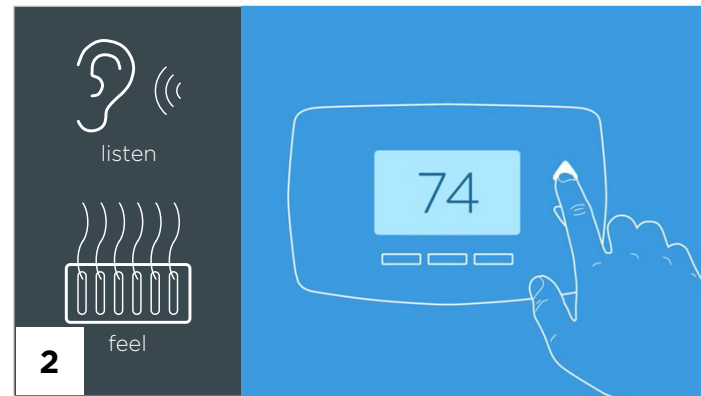

Verify the power is off. Go to your thermostat and try increasing or decreasing the temperature. Many digital thermostats are battery powered, which makes it difficult to tell if the power is off. Listen to ensure your system is turned off before continuing.

Remove your existing thermostat

continued

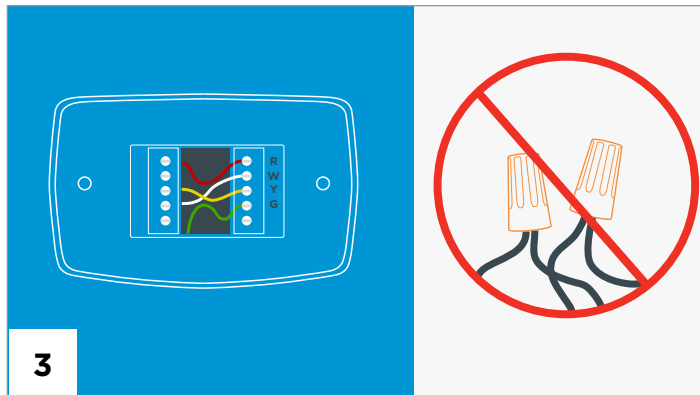

Remove the front of the old thermostat but keep the wallplate with wires attached. Check the wires to see what type of voltage you have. Do you have thick black wires with wire nuts? Is your thermostat 110 volts or higher? If yes, you have a line voltage system, and the Lyric thermostat will not work. For more options, please visit yourhome.honeywell.com/home/Products/Thermostats

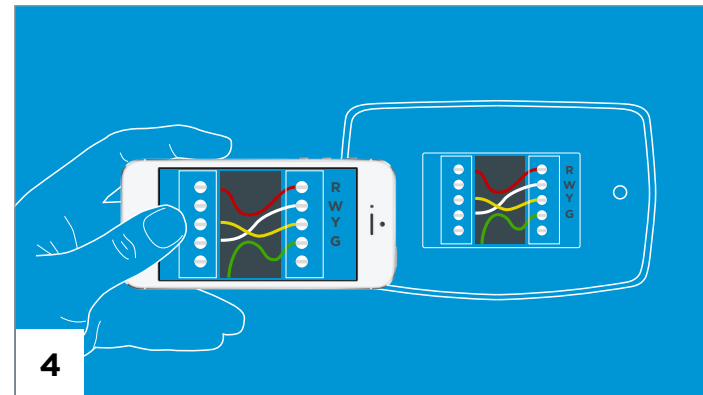

In your app, you'll find a prompt to **take a picture of your current wire configuration**.



Record your current wiring. Within your Lyric app, select the terminals on your old thermostat that have wires connected to them.

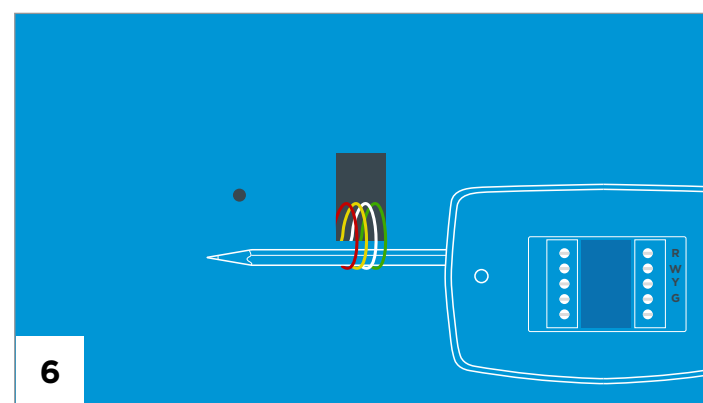

Once all wires have been recorded, **disconnect them** from your old thermostat. **Remove the old wallplate from the wall.** To prevent wires from falling back into the wall, wrap the wires around a pencil.

Install your Lyric thermostat



1

After threading the wires through the wallplate, mount the wallplate of the Lyric thermostat. Make sure it's level by verifying the bubble of the self-contained level is between the two lines. (Included in the box is an optional trim ring you can use to cover wall blemishes. If you choose to use the trim ring, attach it to the wallplate prior to mounting.)

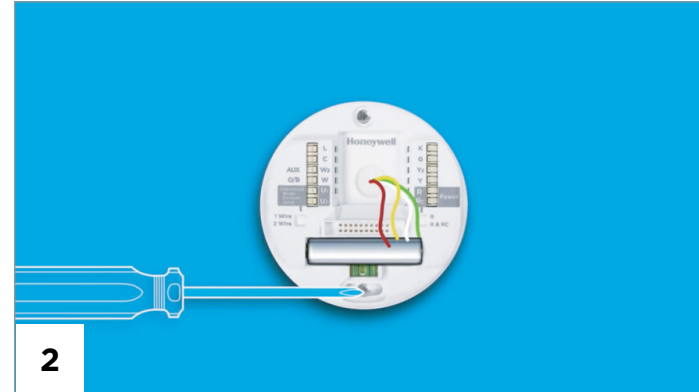

2

Screw the wallplate in place using the included hardware. Note that the screws included in your packaging are specially designed for the Lyric thermostat and are self-anchoring.



3

Follow the directions within the Lyric app based on your unique wiring. Your app will show you the terminals and wires you recorded from your old thermostat.

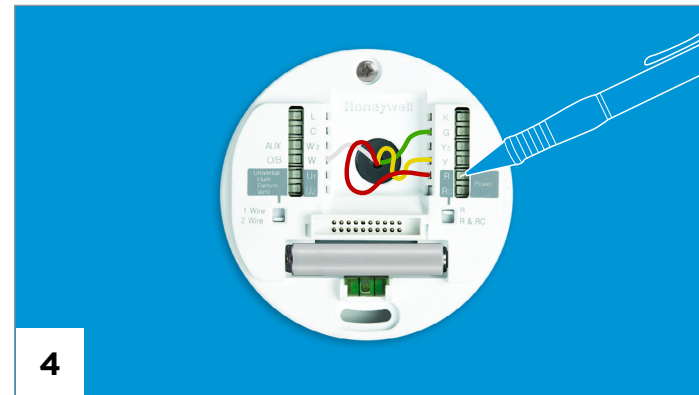

4

To insert wires, slide each wire into its corresponding terminal and ensure it is secure by gently tugging.

To remove wires, gently push down on the terminal tab(s) with a ballpoint pen as you pull the wire.

Install your Lyric thermostat

continued

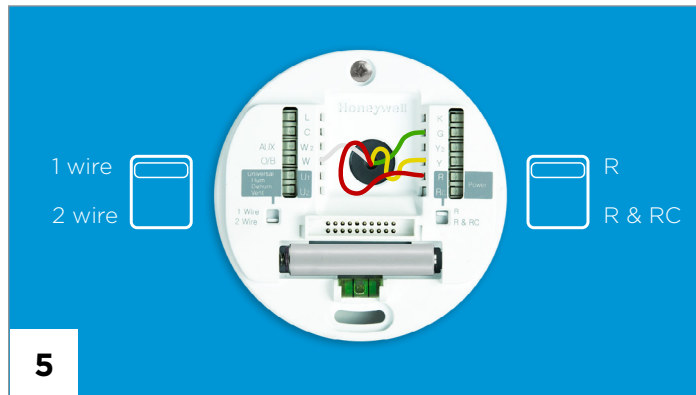

Your app will also tell you whether the **slider tab on the left and right of the wallplate** needs to be pushed up or down based on your R-wire installation. If your old thermostat had only one R-wire connected, make sure the slider tab is pushed up to cover the RC connection. If your thermostat has two R-wire connections, R and RC, push the slider tab down.



After connecting your wiring, **attach the thermostat** by gently pressing it to the wallplate.

Turn the power to your unit back on.

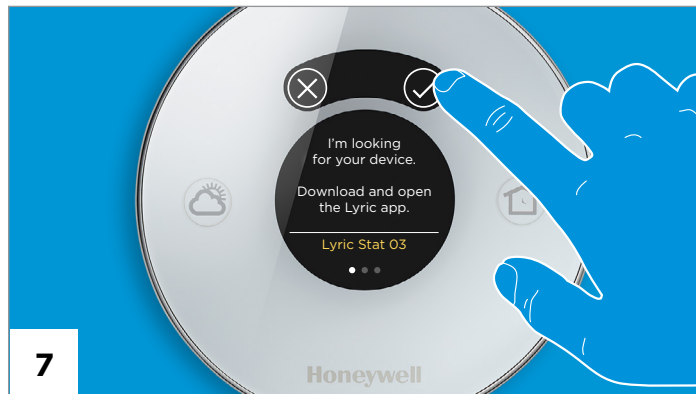

Your thermostat will light up while it starts up - this may take up to 3 minutes. When the thermostat stops, it will display a unique network name, for example, Lyric Stat 03. When you see the unique network name, **touch "OK" to begin your thermostat configuration.**



Go to the Lyric app to see how to configure and personalize your Lyric thermostat. You can also view additional videos at **lyric.honeywell.com**.

Connect your Lyric thermostat



Connect your smartphone or tablet to the thermostat network. Your new thermostat should be displaying a unique network name, such as Lyric Stat 03.



If you have an iOS smartphone or tablet: To connect your iOS smartphone or tablet to the thermostat network, leave the Lyric app, go to your iOS settings and view your Wi-Fi networks. Find and connect to the thermostat's unique network name such as Lyric Stat 03. Close your iOS settings and return to the Lyric app to complete the setup process.

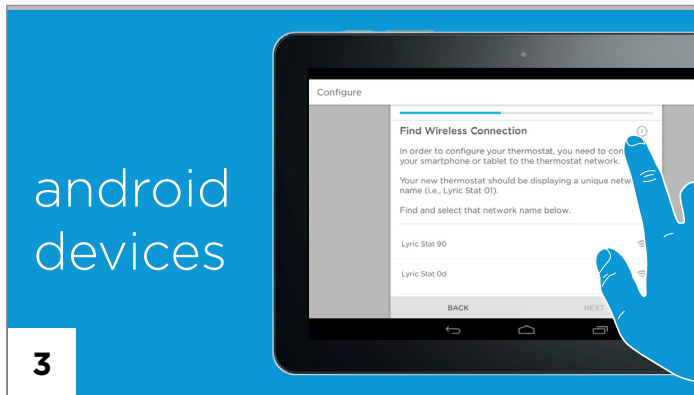

If you have an Android smartphone or tablet: The app will automatically connect to your thermostat.

Configure your Lyric thermostat

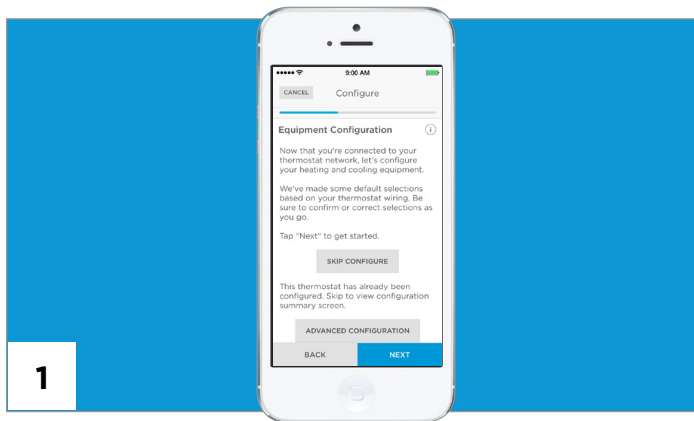

Configure your heating and cooling equipment: The app will ask you a series of questions to determine your equipment configuration.

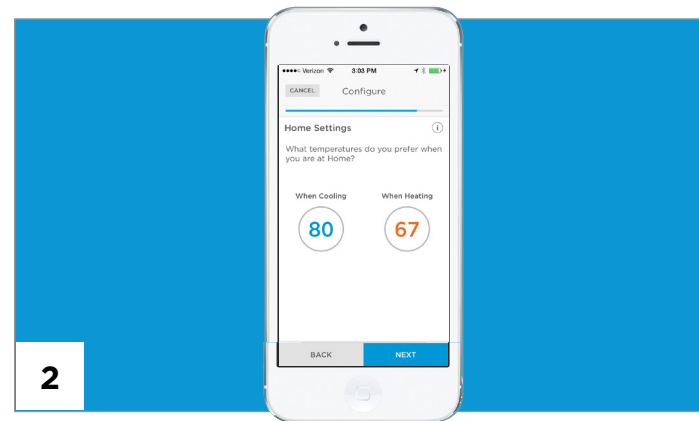

Select the temperatures you prefer when you are home.

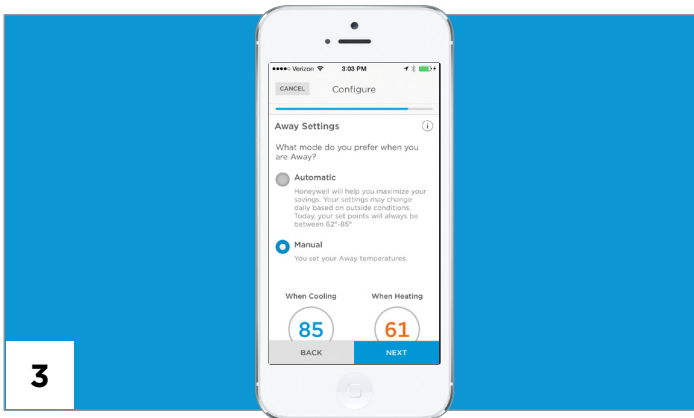

Select whether you prefer automatic or manual mode when you are away. If you select automatic, your thermostat will change your away temperatures automatically to maximize your savings. If you select manual, you will set your away temperatures for your thermostat.

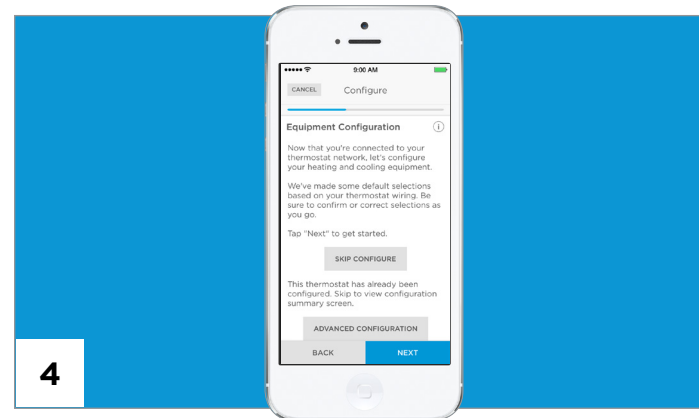

Review your configuration selections and, if everything looks correct, click “next” to complete the configuration.

Personalize your Lyric thermostat



1 From the Lyric app, **select your Wi-Fi network** to connect your thermostat (or manually add it). **Enter your password if password protected.** The thermostat is now connecting to your home Wi-Fi network. It **will take up to three minutes to establish a connection** and sync with Honeywell. (During this time, do not navigate away from the Lyric app.) If an error appears on your thermostat screen, touch "Connect Again" to re-establish the connection.

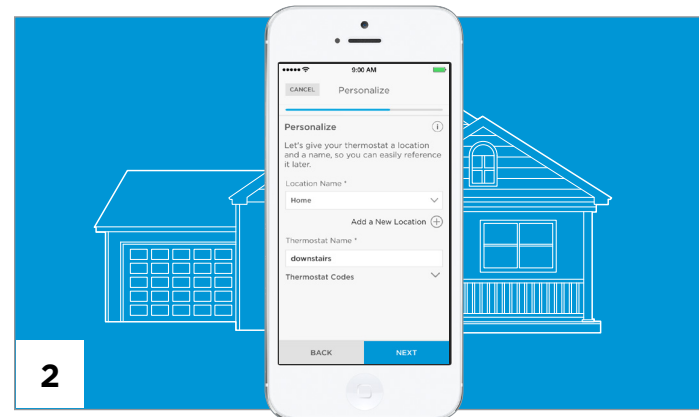

2 **Personalize and register your thermostat with Honeywell.** Give your thermostat a **location name** (home, cabin) and **thermostat name** (living room, basement).

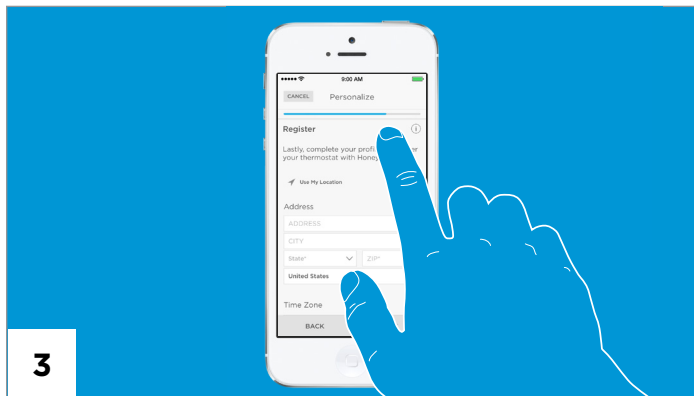

3 Complete your profile to register your thermostat with Honeywell by providing your address and time zone.



4 To learn more about your Lyric thermostat and how to get the most out of it, visit **lyric.honeywell.com**