

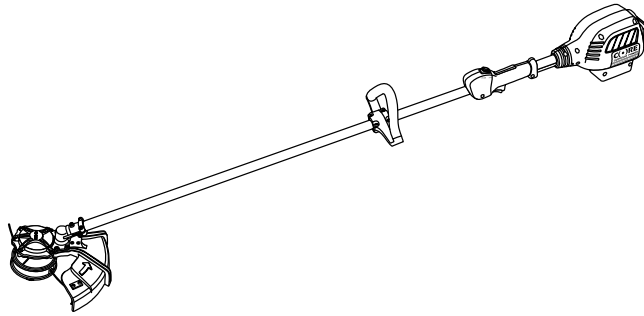

GasLess™ Trimmer

CGT 400

Instruction Manual



PRODUCT SPECIFICATIONS	
Power Cell:	20.5 Volt high energy Li-Ion
Head speed:	7,000 RPM (loaded) Torque mode 5,000 RPM
Head type:	Dual line bump feed
Trimmer line:	.095" Dia. 20' on spool
Chargers:	1 hour Rapid charger or 3 hour Standard Charger
Charger input:	120 V AC, 60 Hz
Charger output:	24 V DC
Replacement Power Cell:	CFC 6500
Replacement chargers:	CRC 6500 or CSC 6500 S
Weight: (with Power Cell)	11 Lbs
Weight: (without Power Cell)	8 Lbs
Need Assistance? Call us on our toll free customer support line: 1-855-831-CORE (2673) <ul style="list-style-type: none">• Technical questions• Warranty or aftermarket service, or replacement parts• Parts missing from package	

CORE™ Outdoor Power, 36235 Kerr Dam Rd., Polson, Montana USA 59860

TABLE OF CONTENTS

Product specifications	1
Table of contents	2
General safety warnings	3-4
Eye, ear & body protection	3-4
Electrical safety	4
Product safety notices – Owner's registration	4
General power tool safety warnings	5-7
Work area safety	5
Electrical safety	5
Personal safety	6
Power tool use and care	6
Service	7
Specific safety rules	7-10
Power Cell and charger safety instructions	10-12
Symbols	13
Know your GasLess™ trimmer	14
Available accessories	14
Contents	15
Assembly and operating	16-30
Charging the Power Cell	16-19
Adjusting the lower handle	20
Reloading the bump head with trimmer line	20-21
Removing the spool to retrieve or untangle trimmer line	21-22
Reinstalling the empty spool into the bump head	22-23
Removing the bump head from the motor shaft	24
Speed / torque switch	25
Motor control switches	25
Installing the Power Cell	27
Operating position	27
Cutting methods	28-30
Trimming	29
Scalping	29
Mowing	29
Sweeping	30
Edging	30
Advancing the polymer line	30
Maintenance	31
Exploded view	32
Parts list	33
Warranty	34-38
Warranty service	39-42
Factory service request form	43-44

GENERAL SAFETY WARNINGS



CAUTION: Before using this tool or any of its accessories, read this manual and follow all Safety Rules and Operating Instructions.

This instruction manual includes the following:

- General Safety Rules
- Specific Safety Rules and Symbols
- Functional Description
- Assembly
- Operation
- Maintenance
- Accessories



WARNING: Retain this manual for future reference. Provide this manual to all operators and be certain that they have read and understand all the Safety Rules and Operating Instructions prior to their using this tool.

EYE AND FACIAL PROTECTION



ALWAYS WEAR EYE PROTECTION THAT CONFORMS WITH THE MOST RECENT ANSI Z87.1 or CAN/CSA – Z94.3 SAFETY STANDARDS.



FLYING DEBRIS can cause permanent eye damage. Prescription eyeglasses ARE NOT a replacement for proper eye protection. The usage of a safety standard compliant face shield placed over proper safety glasses or goggles can reduce the risk of facial injury.



WARNING: Non-compliant eyewear can cause serious injury if broken during the operation of a power tool.

HEARING PROTECTION



WARNING: Use hearing protection if the surrounding environment of the area of operation is loud.

SAVE THESE INSTRUCTIONS FOR FUTURE REFERENCE

GENERAL SAFETY WARNINGS

BODY PROTECTION



WARNING: Always wear non-slip gloves that fit properly to protect your hands and to help you grip the tool.



WARNING: Always wear sturdy clothing with long sleeves and long pants. Never operate the tool while wearing shorts, short sleeve shirt or while shirtless.



WARNING: Always wear non-slip safety boots to prevent foot injuries and slipping that could cause loss of control of the tool.

ELECTRICAL SAFETY



WARNING: To avoid electrical hazards, fire hazards or damage to the tool, use proper circuit protection.

The charger for this tool is wired at the factory for 120 V operation. It must be connected to a 120 V, 15 A circuit that is protected by a time-delayed fuse or circuit breaker. To avoid shock or fire, replace the power cord immediately if it is worn, cut or damaged in any way.

PRODUCT SAFETY NOTICES – OWNER’S REGISTRATION

NOTICE: To permit the receiving of product safety notices from CORE™ Outdoor Power for potential future safety guidance communications and / or safety product recall notices, please register your GasLess™ Trimmer tool, Power Cells and Power Cell chargers online at WWW.COREOUTDOORPOWER.COM. Note: The registration of product model number and serial number is for safety communications purposes only and not for warranty registration purposes.

SAVE THESE INSTRUCTIONS FOR FUTURE REFERENCE

GENERAL POWER TOOL SAFETY WARNINGS

GENERAL POWER TOOL SAFETY WARNINGS

⚠ WARNING: Read all safety warnings and all instructions. Failure to follow the warnings and instructions may result in electric shock, fire and/or serious injury.

Save all warnings and instructions for future reference.

General Power Tool Safety Warnings – Work Area Safety

Keep work area clean and well lit. Cluttered or dark areas invite accidents.

Do not operate power tools in explosive atmospheres, such as in the presence of flammable liquids, gases or dust. Power tools create sparks which may ignite the liquids, fumes or dust.

Keep children and bystanders away while operating a power tool. Distractions can cause you to lose control.

General Power Tool Safety Warnings – Electrical Safety

Power charger plugs must match the outlet. Never modify the plug in any way. Do not use any adapter plugs with earthed (grounded) chargers. Unmodified plugs and matching outlets will reduce risk of electric shock.

Avoid body contact with earthed or grounded surfaces such as pipes, radiators, ranges and refrigerators. There is an increased risk of electrical shock if your body is earthed or grounded.

Do not expose power tools, power chargers or Power Cells to rain or wet conditions. Water entering the tool, chargers or Power Cells will increase the risk of electric shock.

Do not abuse the cord. Never use the power cord for carrying, pulling or unplugging the charger. Keep the power cord away from heat, oil, sharp edges, and moving parts. Damaged or entangled cords increase the risk of electric shock.

When operating a power charger outdoors, use an extension cord suitable for outdoor use. Use of a cord suitable for outdoor use reduces the risk of electric shock.

If operating a power charger in a damp location is unavoidable, use a residual current device (RCD) protected supply. An RCD is also known as a ground fault circuit interrupter (GFCI) or earth leakage circuit breaker (ELCB). Use of an RCD reduces the risk of electric shock.

General Power Tool Safety Warnings – Personal Safety

Stay alert, be aware of your surroundings, watch what you are doing and use common sense when operating a power tool. Do not use a power tool while you are tired or under the influence of drugs, alcohol, or medication. A moment of inattention while operating a power tool may result in serious personal injury.

GENERAL POWER TOOL SAFETY WARNINGS

*General Power Tool Safety Warnings –
Personal Safety – cont'd*

**Use personal protective equipment.
Always wear eye protection.**

Protective equipment such as dust mask, non-skid safety shoes or boots, sturdy gloves, durable long pants and durable long sleeve shirt, [and hard hat, or hearing protection used for appropriate conditions] will reduce personal injuries.

**Prevent unintentional starting.
Ensure the trigger switches are in the off-position before connecting the Power Cell to the power tool, and never pick up or carry the tool by the trigger switches.** *Carrying power tools with your finger on the switch or energizing power tools that have the switch on invites accidents.*

Remove any adjustment key or wrench before turning the power tool on. *A wrench or a key left attached to a rotating part of the power tool may result in personal injury.*

Do not overreach. Keep proper footing and balance at all times. *This enables better control of the power tool in unexpected situations.*

Dress properly. Do not wear loose clothing or jewelry. Keep your hair, clothing and gloves away from moving parts. *Loose clothing, jewelry or long hair can be caught in moving parts.*

**General Power Tool Safety
Warnings – Power tool use and
care**

Do not force the tool. Use the correct tool for the application. *The correct power tool will do the job better and safer when used at the rate for which it was designed.*

Do not use a power tool if the switch does not turn it on or off. *Any power tool that cannot be controlled using the switch is dangerous and must be repaired.*

Remove the Power Cell before making any adjustments, changing accessories, replacing polymer line, leaving the tool idle or unattended, or storing the tool. *Such preventive safety measures reduce the risk of starting the power tool accidentally.*

Store idle power tools out of the reach of children and do not allow persons unfamiliar with the power tool or these instructions to operate the power tool. *Power tools are dangerous in the hands of untrained users.*

Maintain power tools. Check for misalignment or binding of moving parts, breakage of parts and any other condition that may affect the power tool's operation. If damaged, have the power tool repaired before use. *Many accidents are caused by poorly maintained power tools.*

Use the power tool and accessories in accordance with these instructions, taking into account the working conditions and the work to be performed. *Use of the power tool for operations different from those intended could result in a hazardous situation.*

GENERAL POWER TOOL SAFETY WARNINGS

General Power Tool Safety Warnings – Service

Have your power tool or charger serviced by a qualified repair person using only identical replacement parts. This will ensure that the safety of the power tool or charger is maintained.

SPECIFIC SAFETY RULES



WARNING: Know your GasLess™ trimmer. Do not plug in the charger or install the Power Cell into the tool until you have read and understand this Instruction Manual. Learn the tool's applications and limitations, as well as the general and specific potential hazards related to this tool. Following these instructions will reduce the risk of electric shock, fire or serious injury.



WARNING: Always wear appropriate eye protection. Any power tool can throw foreign objects into your eyes and cause permanent eye damage. ALWAYS wear appropriate safety goggles or properly fitted safety glasses that comply with OSHA standards and the most recent version of ANSI Z87.1 or CAN/CSA – Z94.3 safety standards [or other applicable national standard]. Ordinary vision or sun glasses generally do not provide adequate impact or side shield / wrap around penetration protection. Ordinary glasses ARE NOT safety glasses. To reduce the risk of injury to your face CORE Outdoor Power™ recommends that you also wear a face shield or face screen over your safety goggles or safety glasses.

WARNING: Glasses, goggles or face shields not in compliance with ANSI Z87.1 or CAN/CSA – Z94.3 could cause serious injury if they break.



WARNING: To prevent foot injuries, never operate when barefoot, or wearing open toed shoes, or sandals. Always, wear sturdy protective shoes or boots with non-slip soles when operating the trimmer. Steel-toed safety boots are recommended.



WARNING: Protect your hands by wearing heavy-duty, non-slip gloves and to improve your grip and control when handling the trimmer.



Clothing must be durable and snug-fitting, yet allow for freedom of movement. Avoid loose clothing such as scarves, neckties, jewelry, flared or cuffed pants, loose-fitting shirts or jackets, unconfined longhair or anything that can be caught in brush or branches, or entangled with moving parts of the trimmer. Secure hair to above shoulder level. Wear long pants of durable material to protect your legs.

SPECIFIC SAFETY RULES

Cover as much of your body as possible to help protect you from debris and pieces of toxic and allergenic plants being thrown by the spinning line.



WARNING:
Never use fixed blades or metal saw

blades with this trimmer. Serious injury may result. Never use wire or metal-reinforced line or other material in place of the polymer trimmer line. Pieces of wire or metal reinforced line can break off and can be thrown with great force striking against and injuring the operator or bystanders.

Only use CORE™ authorized polymer trimmer line accessories and trimmer line that are designed for use with this tool. Although certain unauthorized attachments might be fitted to the CORE Outdoor Power™ GasLess™ trimmer, their use may be extremely dangerous, and / or damaging to the tool.



The rotating trimmer line and trimmer head will throw objects and debris violently and the objects and debris will ricochet in all directions. You or bystanders can be blinded or injured. Keep children, bystanders, pets and other animals at least 50 feet (15 meters) away from the operating trimmer. Turn the trimmer OFF immediately if approached, or if you are approaching such bystanders. Bystanders should be encouraged to wear eye protection, even if they are kept at a distance. The debris shield on the trimmer is designed

to reduce the danger. The debris shield provided with your trimmer may not protect the operator or bystanders from all objects or debris thrown by the rotating polymer line or trimmer head.

Thrown objects may also ricochet and strike the operator or bystander.

Utilize extra caution, when the trimmer is being used as an Edger or Sweeper, especially near, or on paved or hard surfaces, as pieces of metal, concrete, brick, stones, gravel, sand, glass, sticks and other objects can be thrown at high speed and force by the rotating line and such objects can be thrown, skip along or ricochet long distances off of hard surfaces. Do not use this trimmer for sweeping debris that may contain hard objects, e.g. pebbles, stones, sticks, glass, metal, etc. as such hard objects can be thrown with great force and cause injury to the operator or bystanders, and / or damage property, e.g., screens, windows, building siding, glass doors, or vehicles.

NOTICE: Avoid operating the trimmer near property that can be easily damaged by thrown or ricocheting objects such as screens, windows, building siding, glass doors and vehicles.



WARNING: To reduce the risk of ricochet / rebound injury, or property damage work by going away from any nearby solid object such as wall, steps, large stones, tree, etc. Use great care when working close to solid objects. Where hazardous conditions warrant, do not use the power tool, rather do trimming, edging, mowing or sweeping by hand.

SPECIFIC SAFETY RULES



⚠ WARNING: Inspect the area to be trimmed for hazards before each use.

Remove any foreign objects such as sticks, rocks, broken glass, nails, wire, tools, toys, etc. which can be thrown by or become entangled in the trimmer line. Always locate, and then avoid cutting near electrical power lines, power conduit, or extension power cords. Avoid contacting hard objects with the trimmer head as the objects can damage the trimmer head and / or the objects can be thrown causing serious injury.

Use this trimmer only for trimming, scalping, mowing of grass and weeds, and for light edging of lawns, and for sweeping of only light lawn debris on paved areas. Do not use this trimmer for brush cutting, pruning or hedge trimming. Never use this trimmer on gravelly or sandy areas.



⚠ WARNING: To reduce the potential of serious injury, cut only from your left toward your right, in the

direction of the arrow on the deflector shield. Cutting on the right side of the deflector shield and moving directionally towards your right will cause the debris and objects to be thrown predominately away from the operator thereby reducing the risk of personal injury to the operator, although the risk of injury due to ricochet is not lessened. Whereas cutting on the left-side of the deflector shield or moving directionally towards your left will cause for comparatively more debris to be thrown towards the operator thereby increasing the risk of personal injury.

Hold the trimmer firmly with both hands to ensure proper control. Never operate the trimmer with one hand.

Keep the trimmer head below waist level and away from all parts of your body. Do not draw the trimmer head towards your feet or legs.



⚠ WARNING: Always remove the Power Cell when making adjustments, changing accessories, replacing the polymer trimmer line, removing or untangling debris, leaving the tool idle or unattended, cleaning, servicing, storing or transporting the tool. *Such preventive measures reduce the risk of starting the tool accidentally and causing serious injury.*

Never use the trimmer with the deflector shield removed, damaged or incorrectly positioned. *Serious injury may result.*

Maintain firm footing and balance at all times. Do not overreach or use the trimmer from unstable surfaces such as ladders, trees, steep slopes, slippery surfaces, rooftops, etc.

Inspect the trimmer head before each use. If any parts are worn or damaged, replace them before using the trimmer.

Only use the polymer line size and type recommended for the trimmer. Use of any other type could result in serious injury.

Use only in daylight or in good quality artificial light.

Never use the trimmer for anything other than its intended purpose. Use for anything other than trimming grass and weeds can be dangerous. It may also damage the trimmer.

SPECIFIC SAFETY RULES

⚠ WARNING: Dust created by use of this product may contain chemicals known to the State of California to cause cancer, birth defects or other reproductive harm. Some examples of these chemicals are:

- Comp ounds in fertilizers
- Comp ounds in insecticides, herbicides and pesticides
- Arsenic and chromium from chemically treated lumber.

To reduce your exposure to these chemicals, wear approved safety equipment such as dust masks that are specifically designed to filter out microscopic particles.

Additionally, dust created by this product may contain allergens, bacteria and viruses, PM 10 and / or PM 2.5 particulates, exposure to such hazardous airborne matter can be reduced by wearing approved safety equipment such as dust masks that are specifically designed to filter out the microscopic particles.

POWER CELL & CHARGER SAFETY INSTRUCTIONS

⚠ WARNING: Only use a CORE™ Outdoor Power CSC 6500-S standard charger or a CRC 6500 rapid charger to charge the CORE™ Outdoor Power CFC – 6500 Power Cell. Using any other chargers to charge the CFC-6500 Power Cell may damage the Power Cell and / or the charger and cause fires, explosion, hazardous fumes and possibly burns or other serious injury.

⚠ WARNING: Fire Hazard.

Do not store or carry the Power Cell in a manner in which metal objects could contact the exposed metal terminals. Do not place the Power Cell in aprons, pockets, drawers, tool boxes, etc. with metal objects, such as, but not limited to, loose nails, screws, bolts, keys, coins, staples, foil, etc. Such metal objects could cause the Power Cell to short circuit causing fire, explosion, and hazardous fumes, resulting in personal injury or property damage.

Never attempt to open, modify, dismantle, reverse polarity, crush, puncture or shred the Power Cell for any reason.

If the housing of the Power Cell breaks, cracks, swells, or is punctured immediately discontinue its use and do not recharge.

Do not charge or use the Power Cell if it has been dropped or has received a sharp blow, a heavy weight has been imposed upon it, has been overheated, or is cracked, crushed, deformed or punctured. If a Power Cell has sustained damaged, (as per above, or otherwise) immediately isolate it in a non-combustible, safe outside area, remain a safe distance away but do not leave it unattended. Such a damaged Power Cell should be considered and treated as a potentially thermally unstable, flammable and hazardous material. If the Power Cell ignites DO NOT apply water to it, instead use a Class C fire extinguisher. Avoid exposure to and inhalation of hazardous fumes. Contact hazardous materials authorities for guidance as to appropriate handling and prompt safe disposal of damaged Power Cells. Make arrangements for prompt safe disposal of a damaged Power Cell per local hazardous material regulations.

POWER CELL & CHARGER SAFETY INSTRUCTIONS

Do not use or charge the Power Cell if it is wet or shows any evidence of corrosion.



WARNING: Leakage from the Power Cell may occur under extreme usage, charging or temperature conditions, or if the Power Cell is damaged, crushed or punctured. This leakage indicates a failure of the Power Cell and the Power Cell should be properly disposed of per local hazardous material regulations. If this leakage gets on your skin, or eyes follow these steps:

1. Wash skin immediately and thoroughly with soap and water.
2. If liquid gets into your eyes, flush immediately with clean water for a minimum of 20 minutes and seek immediate medical attention.

If the liquid gets onto your clothing or shoes, remove, isolate and wash the contaminated clothing thoroughly.

Do not wash, splash or immerse a Power Cell in water or other liquids.

Keep the Power Cell out of the reach of children and away from persons not fully familiar with these instructions.

Do not expose the Power Cell to heat or fire. Do not incinerate the Power Cell. It can explode and emit hazardous fumes.

Do not store or use the Power Cell in locations where the temperature may reach or exceed 105°F (40°C) such as in outside sheds or metal buildings, tool boxes, vehicle interiors or trunks during summer. Avoid storing the Power Cell in direct sunlight.

For air, vessel and ground transport purposes, Lithium ion Power Cells are classified as Class 9 Hazardous Goods, subject to ICAO Technical Instructions and IATA Dangerous Goods Regulations and US Department of Transportation and Transport Canada Hazardous Material Regulations [HMR] [and other applicable national regulations]. Such Power Cells are restricted from being placed in checked in baggage and are subject to shipper declarations, standards, quantity and packaging regulations. Confirm with the ground, vessel, air cargo or passenger air travel service provider as to the most current regulations to determine if your lithium ion Power Cells are prohibited, or subject to restrictions or exemptions prior to shipping or travel with your lithium Power Cells.

Do not remove the Power Cell from its original packaging until it is required for use.

Always keep the Power Cell clean and dry. Wipe the terminals with a clean dry cloth if they become dirty.

Storage Recommendations:

The best storage place for Power Cells is a secure and safe place that is cool and dry and away from direct sunlight and excess heat or cold. *Exposure to excess or prolonged heat will degrade the performance and the life expectancy of the Power Cell.*

Do not use an extension cord. Plug the charger cord directly into an electrical outlet.

POWER CELL & CHARGER SAFETY INSTRUCTIONS

Use the charger only in a standard 120 V AC, 60 Hz electrical outlet.



⚠ WARNING: Do not use the charger in wet or damp conditions. The charger is intended for indoor use only. Do not use outdoors. Do not expose to dew, rain or garden sprinklers, frost, or snow. Do not use the charger near sinks or tubs. Do not immerse the charger in water. *Water entering the chargers or Power Cells will increase the risk of electric shock.*

Do not operate power chargers in explosive atmospheres, such as in the presence of flammable liquids, gases or dust. *Power chargers can create sparks which may ignite the liquids, fumes or dust.*

Do not use the CORE™ Outdoor Power CSC 6500-S standard charger or a CRC 6500 rapid charger to charge any batteries other than a CORE™ Outdoor Power CFC 6500 Power Cell. Charging other batteries may cause the batteries to burst, catch fire, emit hazardous fumes or explode.

Do not allow the charger cord to hang over the edge of a table or counter, to be placed in an area where it can become entangled with moving objects, or be a tripping hazard, or to contact sharp or hot surfaces. The charger should be placed away from sinks and hot surfaces.

Do not leave a Power Cell on a prolonged charge. Remove the Power Cell after attaining a complete recharge and unplug the charger when not in further use.

Do not operate the charger if the cord or plug is damaged. Have a qualified technician replace the damaged cord and plug immediately.

Do not operate the charger if it has received a sharp blow, been dropped, crushed, cracked, punctured, immersed or splashed with water or other liquids, or otherwise damaged in any way. Have a qualified technician examine the charger and repair it if necessary. Do not disassemble or modify the charger.

⚠ CAUTION: When the charger is plugged into the power supply, it can become shorted by foreign conductive material and cause sparks or fires. Foreign conductive material such as, but not limited to, metal shavings / chips, steel wool, aluminum foil, nails, staples, paper clips, should be kept away from charger ventilation openings, Power Cell retaining cavity and output terminals.

Do NOT charge the Power Cell when the work area or the Power Cell temperature is at or below 0° C (32° F) or above 45° C (113° F).

Unplug the charger when it is not in use and before cleaning or maintenance.





NOTE: See Page 31 for detailed information concerning preparation for recycling power cells.

POWER CELL RECYCLING

To preserve our natural resources, and reduce landfill please recycle your Power Cells at participating retailers, or dispose of Power Cells properly in accordance with Federal, State, Provincial or local laws.

SYMBOLS

⚠ WARNING: Some of the following symbols may appear on the GasLess™ trimmer, Power Cell or Power Cell chargers, or this manual. Study these symbols and learn their meaning. Proper interpretation of these symbols will allow for more efficient and safer operation of this tool.

V	Volts
A	Amperes
Hz	Hertz
W	Watts
H	Hours
— — —	Direct current
n _o	No load speed
	Alternating or direct current
.../min	Revolutions or reciprocations per minute
	Arrow direction
	Warning symbol
	Shock hazard
	Striking hazard

	Keep bystanders back at least 50' (15m)
	Read the manual
	Safety glasses
	Safety goggles
	Full-face shield
	Safety gloves
	Safety boots
	No fixed blades
	No saw blades

KNOW YOUR GASLESS™ TRIMMER

Power head

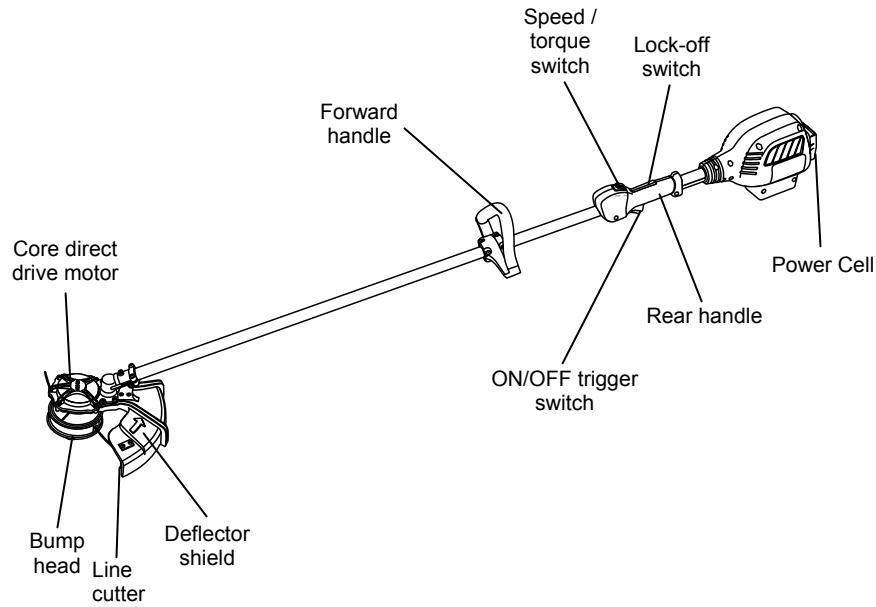

ACCESSORIES

AVAILABLE ACCESSORIES

⚠ WARNING: Use only accessories that are recommended for this gasless trimmer. Follow the instructions that accompany the accessories. The use of improper accessories may result in injury to the operator or damage to the gasless trimmer.

Before using any accessory, carefully read the instructions or the owner's manual for the accessory.

- See chart below

⚠ WARNING: If any part is missing or damaged, do not plug the charger into the power source or install the Power Cell in the tool until the missing or damaged part is replaced.

Part #	Description
CFC 6500	Power Cell
CRC 6500	1 hour rapid charger
CSC 6500 S	3 hour standard charger

CONTENTS

CONTENTS

Carefully unpack the gasless trimmer.
Compare the contents against the
"GASLESS™ TRIMMER
COMPONENTS" chart at right.

GASLESS™ TRIMMER COMPONENTS		
KEY	DESCRIPTION	QTY
A	Trimmer	1
B	Power Cell	1
Depending upon the GasLess™ Trimmer kit purchased, ONE of the following chargers will be included		
C	1 hour rapid charger	1
D	3 hour standard charger	1
O	Owner's Manual	1

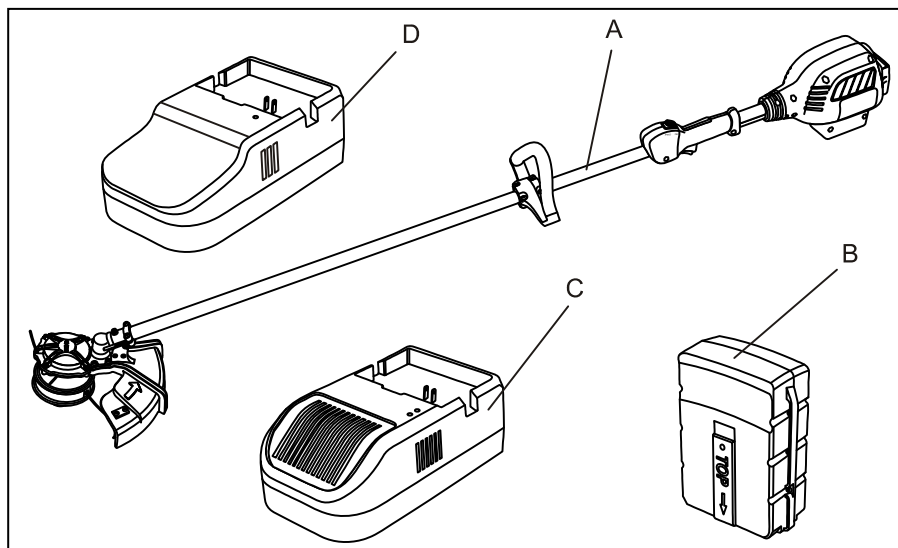

ASSEMBLY AND OPERATING

CHARGING THE POWER CELL

⚠ WARNING: Use only the CORE™ Outdoor Power CSC-6500-S standard charger or the CRC-6500 rapid charger that is supplied with the GasLess™ trimmer to charge the CORE™ Outdoor Power CFC-6500, 20.5V Li-Ion Power Cell supplied with the GasLess™ trimmer. Charging any other Power Cells or batteries with this charger may damage the Power Cells, batteries, or charger, and possibly cause serious injury or property damage from fire, explosion or hazardous fumes.

NOTE: Your GasLess™ Trimmer will include either the CRC-6500 Rapid Charger or the CSC-6500-S Standard Charger. The charger included with your trimmer will depend upon which kit you purchased. The following instructions will detail the charging function of each charger.

CRC-6500 Rapid Charger

1. To charge the CORE™ Power Cell, place the charger (1) in a dry location near a 120 V AC, 60 Hz electrical outlet and plug it into the outlet (Fig. 1).

NOTE: Both the red and green LED's will turn ON, indicating that power is actively being supplied to the charger and that the charger is ready to charge a Power Cell. If the LED's do NOT turn ON, the charger is not receiving power from the electrical outlet or the charger is not functioning properly.

2. Insert the CORE™ Power Cell (2) into the matching cavity (3) in the top of the charger.

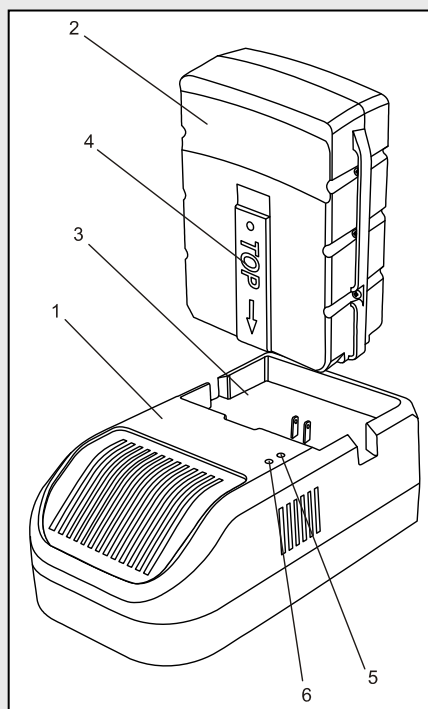

Fig. 1

ASSEMBLY AND OPERATING

CRC-6500 Rapid Charger – cont'd

NOTES:

- a) Make sure the "TOP" marking (4) on top of the Power Cell is facing toward the LED lights (5 & 6) on the charger.
- b) Make sure the Power Cell is pressed fully into the charger cavity.

- 3. When the Power Cell is inserted into the charger, the red LED (5) will remain ON and the second LED (6) will turn to orange, indicating that the Power Cell is being charged.
- 4. When the Power Cell is fully charged, the upper LED (5) will remain red and the lower LED (6) will change to green.
- 5. When the Power Cell is fully charged, remove it from the charger and unplug the charger from the power source.

NOTES:

- a) Lithium-Ion Power Cells will continue to provide nearly full power with minimal power fade unlike traditional batteries; when the Power Cell is fully discharged, the Power Cell electronic control circuitry will immediately cut power output to the tool without notice. A discharged Power Cell should be promptly recharged to maintain its operational voltage potential and to be ready for future use.
- b) Do NOT charge the Power Cell when the work area or the Power Cell temperature is at or below 32° F (0°C) or above 113° F (45°C). The optimal temperature is 68° F (20°C).
- c) Remove the Power Cell from the charger and unplug the charger once the Power Cell has been completely charged.

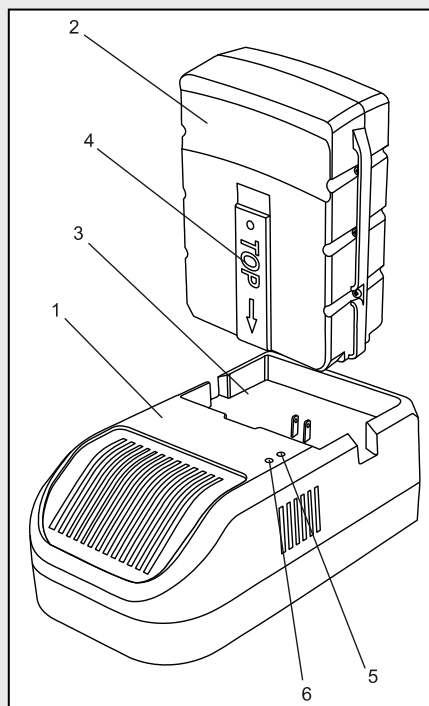

Fig. 1

ASSEMBLY AND OPERATING

CRC-6500-S Standard Charger

1. To charge the CORE™ Power Cell, place the charger (1) in a dry location near a 120 V AC, 60 Hz electrical outlet and plug it into the outlet (Fig. 2).

NOTE: The LED will turn green, indicating that power is actively being supplied to the charger and that the charger is ready to charge a Power Cell. If the LED does NOT turn green, the charger is not receiving power from the electrical outlet or the charger is not functioning properly.

2. Insert the CORE™ Power Cell (2) into the matching cavity (3) in the top of the charger.

NOTES:

a) Make sure the "TOP" marking (4) on top of the Power Cell is facing toward the LED light (5) on the charger.

b) Make sure the Power Cell is pressed fully into the charger cavity.

3. When the Power Cell is inserted into the charger, the LED will change from green to red, indicating the Power Cell is properly installed and is being charged.
4. When the Power Cell is fully charged, the LED will turn green.
5. When the Power Cell is fully charged, remove it from the charger and unplug the charger from the power source.

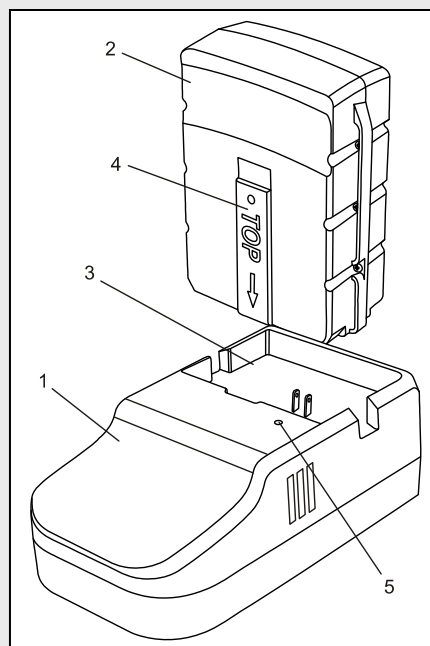

Fig. 2

ASSEMBLY AND OPERATING

CRC-6500-S Standard Charger – cont'd

NOTES:

- a) Lithium-Ion Power Cells will continue to provide nearly full power with minimal power fade unlike traditional batteries; when the Power Cell is fully discharged, the Power Cell electronic control circuitry will immediately cut power output to the tool without notice. A discharged Power Cell should be promptly recharged to maintain its operational voltage potential and to be ready for future use.
- b) Do NOT charge the Power Cell when the work area or the Power Cell temperature is at or below 32° F (0°C) or above 113° F (45°C). The optimal temperature is 68° F (20°C).
- c) Remove the Power Cell from the charger and unplug the charger once the Power Cell has been completely charged.

ASSEMBLY AND OPERATING

ADJUSTING THE LOWER HANDLE

The lower handle can be adjusted to suit the operator.

1. Using a Torx® screwdriver (1), turn the four handle clamp screws (2) counter clockwise until the handle (3) will rotate on the trimmer outer shaft (4) (Fig. 3).
2. Slide the handle up or down (5) and/or rotate it to a comfortable position.
3. Re-tighten the handle clamp screws to hold the handle in the desired position.

NOTE: Do not over tighten the clamp screws. You will break the clamp.

RELOADING THE BUMP HEAD WITH TRIMMER LINE

The GasLess™ trimmer comes with trimmer line already installed. When the trimmer line is used up, you will have to reload the bump head with trimmer line.

⚠ WARNING: Avoid Injury! To prevent accidental start up: Always remove the Power Cell before reloading the bump head.

1. Push the spool knob (1) inward into the bump head housing (2) (Fig. 4).
2. While holding the bump head with one hand, turn the spool knob counter clockwise with the other hand to unspool any existing trimmer line (3) that remains in the spool.

NOTE: Keep turning the spool knob counter clockwise until the remaining trimmer line is unspooled, then pull out the remaining stubs of the trimmer line from the bump head.

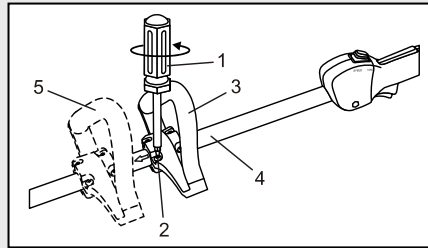

Fig. 3

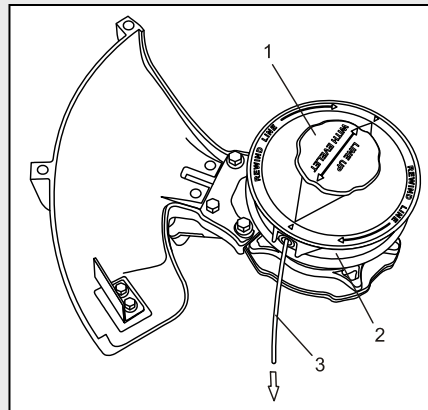

Fig. 4

ASSEMBLY AND OPERATING

RELOADING THE BUMP HEAD WITH TRIMMER LINE – *cont'd*

3. Cut two 10' (3 m) lengths of high quality .095 trimmer line.
4. Rotate the empty spool clockwise until the arrows (4) align with the eyelets (5) in the bump head housing (Fig. 5).
5. Insert one end of one of the pre-cut 10' (3 m) trimmer lines (6) into one of the eyelets as far as it will go. Insert one end of the remaining pre-cut trimmer line into the other eyelet as far as it will go.
6. While holding the bump head housing with one hand, turn the spool clockwise to wind the trimmer line onto the spool. Continue to turn the spool clockwise until only 6" (15 cm) of trimmer line is exposed beyond the bump head housing.

NOTES:

- a) When starting to wind the line onto the spool, make sure the ends of the line remain fully inserted into the eyelets.
- b) Excess line can be cut off with scissors.

REMOVING THE SPOOL TO RETRIEVE OR UNTANGLE TRIMMER LINE

⚠ WARNING: Avoid Injury! To avoid accidental start up: Always remove the Power Cell before removing or reinstalling the spool.

The trimmer line may break off at the eyelet due to hitting debris. It may also become entangled within the bump head spool. In either case, you will have to remove the spool from the bump head as follows:

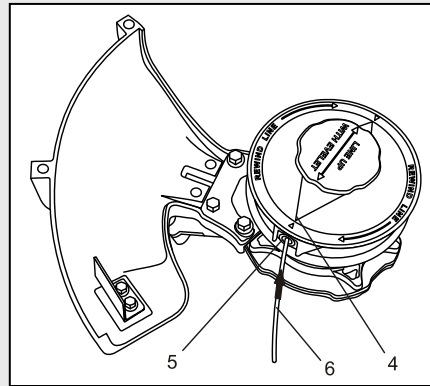

Fig. 5

ASSEMBLY AND OPERATING

1. Remove the Power Cell from the line trimmer as outlined in Fig. 7.
2. Grasp the bump head housing (1) with one hand (Fig. 6).
3. Grasp the spool knob (2) with the other hand and press the spool **firmly** into the spring loaded bump head housing.
4. While pressing the spool firmly into the spring loaded bump head housing, rotate the spool knob clockwise (3) until it will not turn any further.
NOTE: The spool will rotate approximately 15°.
5. Pull the spool out of the bump housing.
6. Remove the trimmer line from the spool and set the line aside so the line if undamaged can be reinstalled onto the spool later.
7. If any trimmer line is entangled on the bump housing shaft, carefully cut it out using scissors, side cutters or a knife.
8. Use a clean rag to clean all debris from the bump head shaft, inside the bump head and from the spool.
NOTE: If the bump head and spool are not properly cleaned, the bump head will not work properly.

REINSTALLING THE EMPTY SPOOL INTO THE BUMP HEAD

To install the empty spool into the bump head, simply reverse the process outlined in steps #2 through #5 above.

NOTE: The spool must be empty and NOT contain any trimmer line.

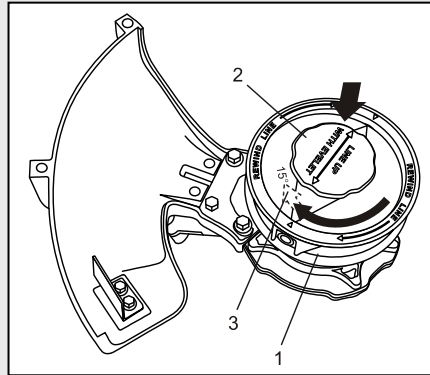

Fig. 6

ASSEMBLY AND OPERATING

REINSTALLING THE EMPTY SPOOL INTO THE BUMP HEAD – cont'd

1. Align the four slots in the spool under side cavity with the four pins (4) on the bump head shaft and slide the spool into the bump head (Fig. 7).
2. Grasp the bump head housing with one hand.
3. Grasp the spool knob with the other hand and press the spool **firmly** into the spring loaded bump head housing.
4. While pressing the spool firmly into the spring loaded bump head housing, rotate the spool knob counter clockwise (5) until it will not turn any further.

NOTES:

- a) The spool will rotate approximately 15° before it is fully locked into position.
- b) Make sure the outer edge of the spool (6) is evenly positioned within the bump head (7) (Fig. 7a). If not, remove the spool and reinstall it properly.
- c) Pull outward on the spool to make sure it is firmly locked into position.

⚠ WARNING: Make sure the outer edge of the spool is evenly positioned within the bump head and that the spool is firmly locked into position. If the spool is not properly locked into the bump head, it could be violently thrown when the trimmer is started and cause serious injury.

5. Reinstall any undamaged trimmer line into the spool as outlined in Fig.5.

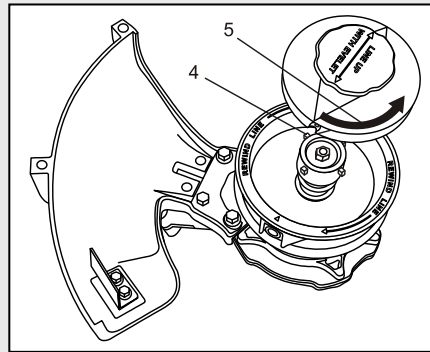

Fig. 7

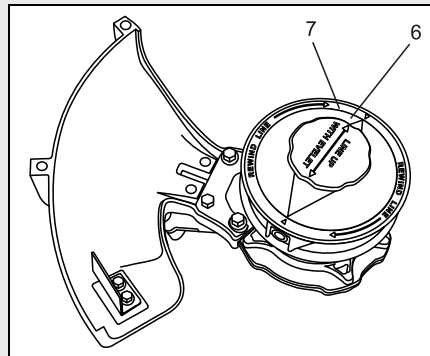

Fig. 7a

ASSEMBLY AND OPERATING

REMOVING THE BUMP HEAD FROM THE MOTOR SHAFT

⚠ WARNING: Avoid Injury! To avoid accidental start up: Always remove the Power Cell before removing or reinstalling the bump head.

The bump head can be removed from the motor shaft to facilitate removal of trimmer line etc. that becomes entangled on the motor shaft.

1. Rotate the bump head until the slot in plastic line guard is aligned with the matching slot (1) in the lower motor casting (Fig. 8).
2. Insert an appropriate sized screwdriver (2) or hex key into the slot in the casting and into the slot in the plastic line guard.
NOTE: When the screwdriver is through both slots, the motor shaft will be locked.
3. Grasp the bump head with one hand and turn it **CLOCKWISE** to remove it from the threaded motor shaft. Continue to turn the bump head until it is removed from the motor shaft.
NOTE: The motor shaft has a reverse "left hand" thread.
4. To reinstall the bump head, simply clean off any tangle line and debris from the motor shaft and the bump head and lock the motor shaft as per items #1 & #2 above. Then thread the bump head onto the motor shaft by turning it **COUNTER CLOCKWISE**.

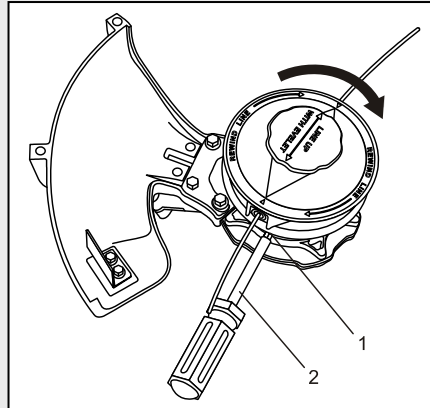

Fig. 8

ASSEMBLY AND OPERATING

REMOVING THE BUMP HEAD FROM THE MOTOR SHAFT – cont'd

NOTES:

- a) Make sure the bump head threads are not cross threaded. You will ruin the bump head.
- b) Tighten the bump head onto the motor shaft by hand only. Do not use a wrench or pliers.

SPEED / TORQUE SWITCH

The speed / torque switch (1) allows you to select either the "torque" or "speed" mode for the motor (Fig. 9). Set the speed control switch at "torque" for most applications. This setting will provide the torque required for most trimming activities. It will also conserve the Power Cell capacity resulting in longer run times between charges. Use the "speed" setting for heavier cutting and when using the guard blade for cutting off excess exposed line.

MOTOR CONTROL SWITCHES

To start the tool, squeeze the lock-off switch (2) into the rear handle (3) (Fig. 10). While squeezing the lock-off switch, squeeze the ON/OFF trigger switch (4). To turn the tool OFF, release both motor control switches.

NOTE: If either the lock-off switch or the trigger switch is released while the tool is running, the tool will automatically turn OFF. To restart the tool, repeat the above procedure.

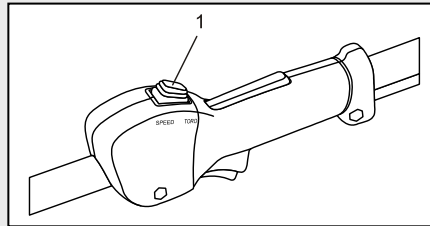

Fig. 9

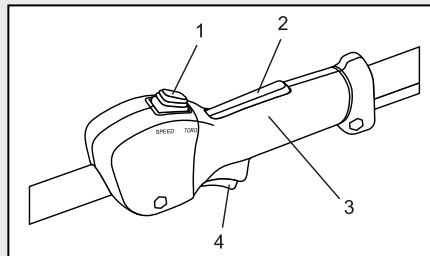

Fig. 10



WARNING

For safety reasons, the operator must read the sections of this Owner's Manual entitled "GENERAL SAFETY WARNINGS", "GENERAL POWER TOOL SAFETY WARNINGS", "SPECIFIC SAFETY RULES", "POWER CELL & CHARGER SAFETY INSTRUCTIONS" and "SYMBOLS" before using this GasLess™ trimmer.

Verify the following every time the GasLess™ trimmer is used:

1. Safety glasses, and all required safety clothing are being worn.
2. Appropriate length of trimmer line is exposed beyond the bump head eyelets.
3. The area to be trimmed is cleared of all debris.
4. Bystanders are at least 50' (15 m) away from the trimming area.

Failure to observe these safety rules will significantly increase the risk of injury.

ASSEMBLY AND OPERATING

INSTALLING THE POWER CELL

Once the Power Cell has been fully charged and you are ready to start trimming, you will have to install the Power Cell into the trimmer.

1. Position the Power Cell (1) with the "TOP" label (2) facing upward (Fig. 11).
2. Slide the Power Cell into the matching cavity (3) in the rear of the upper cowl (4).
NOTE: Make sure you push the Power Cell fully into the cavity. The locking latch (5) will click when the Power Cell is properly installed.
3. Pull outward on the Power Cell to verify that it is being held in place by the locking latch.

To remove the Power Cell for recharging or storage, press the locking latch toward the Power Cell. While holding the locking latch toward the Power Cell, pull the Power Cell out of the tool.

OPERATING POSITION

⚠ WARNING: Never operate the trimmer with one hand. Always hold the trimmer with one hand on the forward handle and the other hand on the rear handle to operate the switches. Operate the trimmer below waist height at all times. Always wear appropriate personal protective equipment. Never operate the trimmer on its edge while trimming grass. The trimming line should always be near and parallel to the ground to avoid scalping and throwing debris.

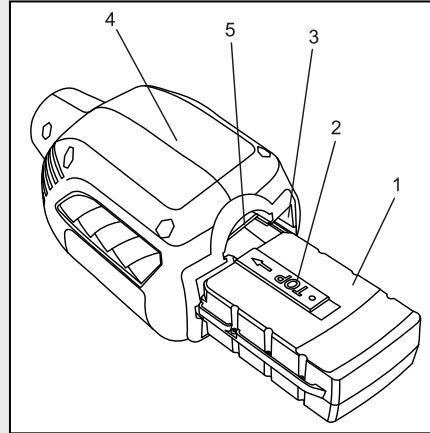

Fig. 11

ASSEMBLY AND OPERATING

CUTTING METHODS

⚠ WARNING: Be extremely careful when cutting around hard objects such as rock, gravel, fence posts etc. that can be contacted by the line or the bump head (Fig. 12). Contacting these items with the line or bump head may cause pieces of the trimmer line and debris to be violently thrown. It may also cause the line to become entangled and damage both the line and the bump head.

When trimming, do not feed the line into the work area too quickly and crowd the line. Only the tip of the line does the cutting (Fig. 13). Feeding the line into the work area too quickly will reduce the head speed, slow the cutting action and overload the motor. It will also reduce the Power Cell capacity before requiring recharging.

NOTE: The trimming line will easily remove grass and weeds from around walls, fences, trees and flower beds, but it can also cut the tender bark of trees or shrubs, scar fences, etc. Be extremely careful when trimming near objects that can be easily damaged by the trimmer line.

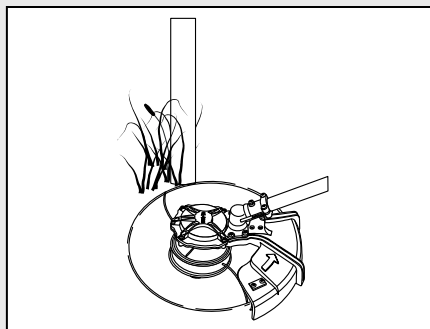

Fig. 12

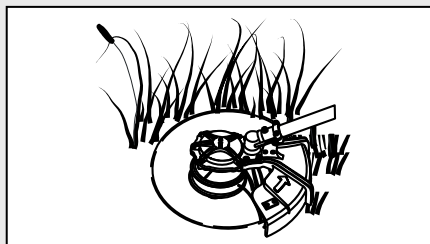

Fig. 13

ASSEMBLY AND OPERATING

CUTTING METHODS – cont'd

Trimming

Position the bottom of the bump head about 3" (8 cm) above the ground and at a slight angle (Fig. 14). Allow only the tip of the line to make contact with the grass.

NOTE: Allowing more than just the tip of the line to do the trimming will result in rougher cutting action and excessive wear on the line.

Scalping

Scalping an area will remove all unwanted vegetation down to the ground. When scalping, position the bottom of the bump head about 3" (8 cm) above the ground and at a slight angle (Fig. 15). Allow only the tip of the line to make contact with the ground.

NOTE: Scalping is ideal for use around trees, shrubs, posts, ornaments, etc. Be aware that scalping will increase trimmer line wear considerably.

Mowing

Use the GasLess™ trimmer to mow small or rough areas where a conventional lawn mower cannot be used. When mowing, keep the line parallel to the ground at the desired height (Fig. 16). Move the trimmer from left to right while cutting. This cutting motion will throw grass and debris predominantly away from the operator.

NOTE: Be careful not to allow the bump head to contact the ground, as this could result in scalping and/or releasing more trimmer line from the spool.

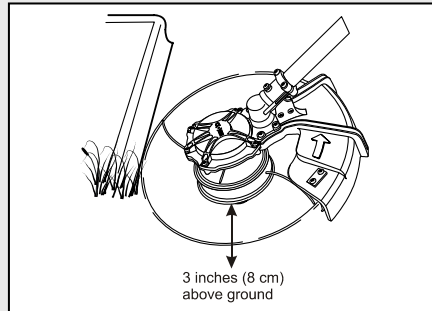

Fig. 14

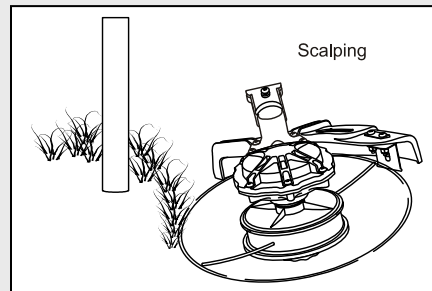

Fig. 15

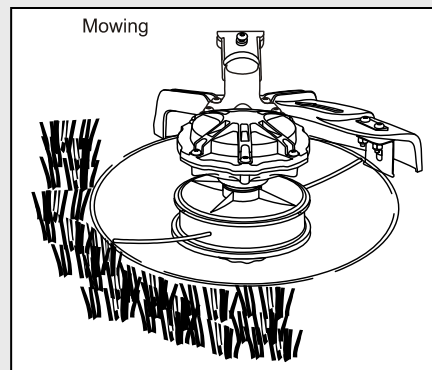

Fig. 16

ASSEMBLY AND OPERATING

CUTTING METHODS – cont'd

Sweeping

Use the GasLess™ trimmer for sweeping cut grass and debris from walkways and driveways. Position the line parallel to and above the surface to be swept (Fig. 17). Swing the trimmer from side to side in a fanning motion. The air flow from the rotating line will blow the grass and debris from the surface being swept.

NOTE: Be careful not to allow the bump head to contact the ground, as this could result in damage to the bump head and/or releasing more trimmer line from the spool.

Edging

Use the GasLess™ trimmer for edging around walkways and flower beds.

⚠ WARNING: Always use long pants, long sleeve shirt, gloves and safety goggles and a face shield when edging. Debris being thrown from the trimmer at high speed can injure your eyes and any exposed skin.

Hold the trimmer in a similar manner to trimming, but with the trimmer head rotated away from you body by 90° (Fig. 18).

ADVANCING THE POLYMER LINE

As the trimmer is used, the polymer line will wear down or the tips will break off. To advance the polymer line and expose a greater length, simply tap the bump head on the ground while the trimmer is turned ON.

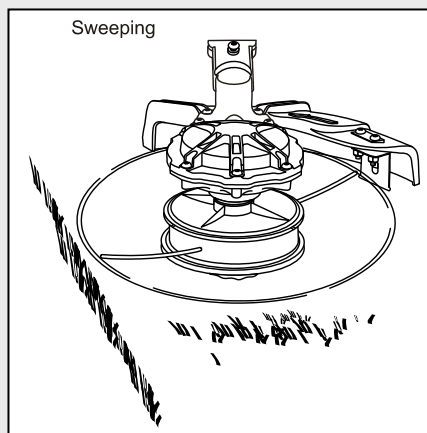

Fig. 17

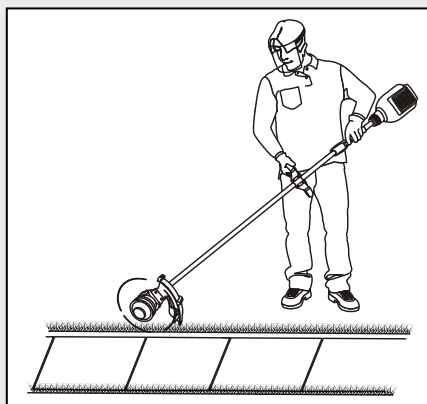

Fig. 18

MAINTENANCE

GENERAL

⚠ WARNING: When servicing, use only original equipment replacement parts. The use of any other parts may create a hazard or cause product damage.

⚠ WARNING: DO NOT use solvents for cleaning the trimmer, the chargers or the Power Cells. Solvents could catch fire or even explode due to exposure to electric sparks and / or degrade and make unsafe the electrical components. Additionally, plastics are susceptible to damage from various types of commercial solvents and may be damaged by their use. Use a clean cloth to remove dirt, dust, oil, grease etc.

⚠ WARNING: Do not allow brake fluids, gasoline, petroleum-based products, penetrating oils, etc. to come into contact with plastic parts. They contain chemicals that can damage, weaken or destroy plastic.

DO NOT abuse power tools. Abusive practices can damage the tool.

⚠ WARNING: DO NOT attempt to modify tools or create accessories. Any such alteration or modification is misuse and could result in a hazardous condition leading to possible serious injury. It will also void the warranty.

LUBRICATION

All of the bearings in this tool are lubricated with a sufficient amount of high-grade lubricant for the life of the unit under normal conditions. Therefore, no further lubrication is required.

POWER CELL REMOVAL AND PREPARATION FOR RECYCLING

To preserve our natural resources, please recycle or dispose of Power Cells properly.

Consult your local waste authority for information regarding available recycling and disposal options.

⚠ WARNING: Upon removal of the Power Cell for recycling, cover the terminals of the Power Cell with electrical tape or heavy-duty adhesive tape. Never touch both terminals with metal objects or body parts, because a short circuit may result. Keep away from children. Do not attempt to destroy or disassemble the Power Cell or remove any of its components. Rechargeable Power Cells must be recycled or disposed of properly. Failure to comply with these warnings could result in fire and serious injury.

LITHIUM-ION POWER CELL MAINTENANCE

Lithium-ion Power Cells share many characteristics with Nickel-Cadmium batteries. The major characteristic that is **NOT** shared with Nickel-Cadmium batteries is that Lithium-ion Power Cells do not have a "memory" and do not require to be completely discharged periodically. It is recommended that you charge your Lithium-ion Power Cell after each use so they will be fully charged when needed.

NOTE: A fully charged Power Cell will lose about 2% of its charge per month during storage.

EXPLODED VIEW

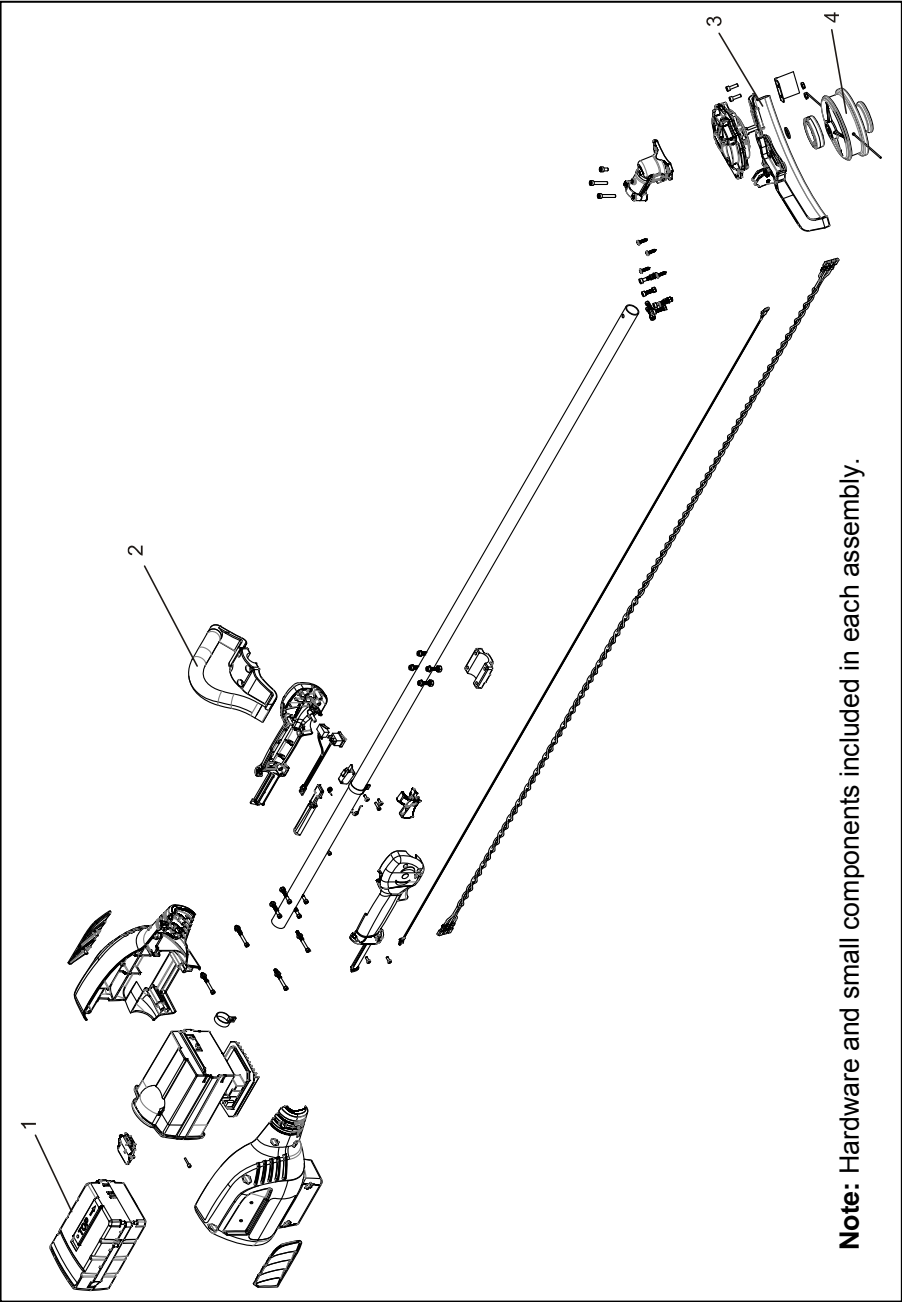

Note: Hardware and small components included in each assembly.

PARTS LIST

⚠ WARNING: When servicing, use only original equipment replacement parts. The use of any other parts may create a safety hazard or cause damage to the GasLess™ Trimmer.

Any attempt to repair or replace electrical parts on this GasLess™ Trimmer may create a safety hazard unless repairs are performed by a qualified technician. For more information, call the Toll-free Helpline, at 1-844-831-CORE (2673).

Always order by PART NUMBER, not by key number.

Key #	Part #	Part Name	Quantity
1	CFC 6500	Power Cell CFC 6500	1
2	CGT 400-AHA	Assist Handle Assembly	1
3	CGT 400-SGA	String Guard Assembly	1
4	CGT 400-BHA	Bump Head with Weed Wrap	1
Not shown	CSC 6500-R	Rapid charger	1
Not shown	CSC 6500-S	Standard charger	1
Not shown	CGT 400 Label Kit	Warning & instructive label kit	1

WARRANTY

CORE™ Outdoor Power - Limited Product Warranty Statement for CGT-400 GasLess™ Trimmer and Accessories Sold Only in the 48 Contiguous United States of America and Canada, effective January 27, 2012.

Page 1 of 5

CORE™ Outdoor Power provides to the original purchaser [for first purchaser other than for purposes of resale] or the person to whom it was originally purchased as a gift, a limited product warranty that CORE™ Outdoor Power GasLess™ Trimmer and accessories are free from defects in material and workmanship under normal application, use and service conditions. CORE™ Outdoor Power warrants, at its option, to repair, or to replace with the same or similar new or refurbished product, or to refund the purchase price as paid by the original purchaser, if inspections shows defects in material and / or workmanship for products delivered to a CORE™ Outdoor Power Authorized Service Center, subject to the below listed application time periods, limitations and exceptions. The repair, replace or refund remedy shall be the sole and exclusive remedy under this limited product warranty. THIS LIMITED WARRANTY IS EXTENDED TO THE ORIGINAL PURCHASER OR TO THE ORIGINAL GIFT RECEIPT ONLY, AND IS NOT TRANSFERABLE TO SUBSEQUENT OWNERS.

Except as provided by applicable law, the purchaser assumes the risk of loss or damage during transit and transportation and are responsible for packaging, delivery and handling charges incurred in the transport of their product(s) to a CORE™ Outdoor Power Authorized Service Center. Product purchased, used, serviced, or product shipped for repair, from outside the 48 contiguous United States of America or Canada to a CORE™ Outdoor Power Authorized Service Center in the 48 contiguous United States of America or Canada is specifically excluded from this limited warranty. A CORE™ Outdoor Power Authorized Service Center will return warranty repaired or warranty replaced product with transportation, delivery and handling charges prepaid under terms of this limited warranty to the original purchaser and will return such product only to return destinations located in the 48 contiguous United States of America or Canada. Product purchased, used, serviced or product shipped for repair, from outside of the 48 contiguous United States of America and Canada may be provided distinct and separate warranties compatible with such jurisdictional laws, market practices or regional authorized service centers and often the products are in fact unique models which differ as to component parts and regulatory requirements but such products are expressly excluded from coverage under this warranty.

WARRANTY

CORE™ Outdoor Power - Limited Product Warranty Statement for CGT-400 GasLess™ Trimmer and Accessories Sold Only in the 48 Contiguous United States of America and Canada, effective January 27, 2012.

Page 2 of 5

A copy of the valid proof of original purchase [which proof documentation provides identification of the product model and the date of original purchase] must be included with the returned product in order to obtain warranty service. This warranty does not apply to damage or failure that CORE™ Outdoor Power determines to be from, repairs made or attempted by anyone other than CORE™ Outdoor Power authorized service personnel, disassembly, modifications /alterations, misuse, neglect, abuse, normal wear and tear, failure to follow directions, improper maintenance, improper storage, improper installation, use of unauthorized or incompatible attachments and accessories, or accidents. The use of non-CORE™ Outdoor Power authorized attachments or accessories, and / or incompatible attachments or accessories will void coverage under this warranty. Furthermore, this warranty does NOT cover additional damage to parts or components due to continued use after operational problem or failure occurs. Should operational problems or failure occur, the product should not be used, but rather delivered as is to a CORE™ Outdoor Power Authorized Service Center for warranty service.

Product Warranty Period:

Residential Application

- **5 Year Warranty** – All products used for residential, [i.e., personal, family or household], non-income producing purposes will be covered by this limited warranty for five (5) years from the original date of purchase.

EXCEPTIONS:

- CORE™ Power Cells and Power Cell chargers will be covered by this limited warranty for failures due to a defect in material or workmanship for a period of **one (1) year** from the original purchase date. If upon return of the Power Cell or a Power Cell charger to an authorized dealer for inspection, a warranty adjustment is determined to be necessary due to a defect in material or workmanship of the Power Cell or Power Cell charger, [and the Power Cell is NOT MERELY DISCHARGED], then, the Power Cell and / or Power Cell charger will be replaced free of charge (except for taxes or other legislatively-imposed fees, where applicable).
- Polymer trimmer line cutting attachments for residential, non-income producing use will be covered by this limited warranty for failures due to a defect in material or workmanship for a period of **sixty (60) days** from the original product purchase date. Any misuse from contact with concrete, rocks, metal or other structures is NOT covered by this warranty.

WARRANTY

CORE™ Outdoor Power - Limited Product Warranty Statement for CGT-400 GasLess™ Trimmer and Accessories Sold Only in the 48 Contiguous United States of America and Canada, effective January 27, 2012.

Page 3 of 5

Commercial Application

- **2 Year Warranty** – All products used for commercial, institutional, agricultural, industrial, or for income producing use [e.g. professional landscape services] will be covered by this limited warranty for **two (2) years** from the original date of purchase.

EXCEPTIONS:

- CORE™ Power Cells and Power Cell chargers will be covered by this limited warranty for failures due to defects in material or workmanship for a period of **one (1) year** from the original purchase date. If upon return of the Power Cell or a Power Cell charger to an authorized dealer for inspection, a warranty adjustment is determined to be necessary due to a defect in material or workmanship of the Power Cell or Power Cell charger, [and the Power Cell is NOT MERELY DISCHARGED], then the Power Cell and / or Power Cell charger will be replaced free of charge to the original purchaser (except for taxes or other legislatively-imposed fees, where applicable).
- Polymer trimmer line cutting attachments for commercial, institutional, agricultural industrial or income producing use will be covered by this limited warranty for failures due to a defect in material or workmanship for a period of **thirty (30) days** from the original product purchase date. Any misuse from contact with concrete, rocks, metal or other damaging structures is NOT covered by this warranty.

Rental Application

- **90 Day Warranty** – All products used for rental or lease use will be covered due to a defect in material and workmanship for a period of **ninety (90) days** from the original date of purchase.

EXCEPTIONS:

- Polymer trimmer line cutting attachments for rental, income producing use will be covered by this limited warranty for failures due to a defect in material or workmanship for a period of **thirty (30) days** from the original product purchase date. Any misuse from contact with concrete, rocks, metal or other damaging structures is NOT covered by this warranty.

WARRANTY

CORE™ Outdoor Power - Limited Product Warranty Statement for CGT-400 GasLess™ Trimmer and Accessories Sold Only in the 48 Contiguous United States of America and Canada, effective January 27, 2012.

Page 4 of 5

It is recommended that consumers keep their original proof of purchase from the retailer in a safe place for reference should warranty service ever become necessary, e.g., staple to or file with the owner's manual. The reason that the authorized dealer or authorized service center requires a copy of the valid proof of original purchase (e.g., copy of a receipt, an invoice, a bill of sale, etc., which denotes the product model number and date of original purchase) is that it provides important information necessary to qualify your right to receive warranty service.

- It proves the exact date of purchase. Our warranties are time oriented and begin with the date of original purchase.
- Possession of the original bill of sale also indicates that you are likely the original owner (these warranties are non-transferable).
- Also, some units are sold by retailers as "used" or "reconditioned". These denotations or comments that the unit may have been sold "as is" are generally stated on the receipt. Used or reconditioned products are not extended coverage under this warranty.

Establishing the valid proof of original purchase with identification of product model and the original purchase date rests solely with the original purchaser, or the person to whom the product was originally purchased as a gift.

All parts or products replaced under warranty become the property of CORE™ Outdoor Power. All repair parts and accessories, or replacement products provided to the purchaser by CORE™ Outdoor Power under this warranty are warranted only for the remaining balance of the original product or accessory warranty period. This limited warranty does not apply to consumable accessory items, such as polymer trimmer line, that are consumed during ordinary use.

OTHER LIMITATIONS

This warranty is the complete and exclusive agreement, and sole remedy, between the original purchaser and CORE™ Outdoor Power. It supersedes all other written or oral communications related to this product. CORE™ Outdoor Power provides no other warranties for this product. The warranty exclusively describes all of CORE™ Outdoor Power's responsibilities regarding the product. There are no other expressed warranties. No one is authorized to make modifications to this warranty and purchaser should not rely on any such modification.

WARRANTY

CORE™ Outdoor Power - Limited Product Warranty Statement for CGT-400 GasLess™ Trimmer and Accessories Sold Only in the 48 Contiguous United States of America and Canada, effective January 27, 2012.

Page 5 of 5

WARRANTY DISCLAIMER: IN NO EVENT WILL CORE™ OUTDOOR POWER BE LIABLE FOR:

- ANY INDIRECT, INCIDENTAL, PUNITIVE OR CONSEQUENTIAL DAMAGES ARISING FROM THE SALE OR USE OF THE PRODUCTS SOLD HEREUNDER, OR
- ANY AMOUNT IN EXCESS OF THE AMOUNT ACTUALLY PAID TO CORE™ OUTDOOR POWER FOR THE PRODUCTS SOLD HEREUNDER FOR ANY LIABILITY ARISING FROM THE SALE OR USE OF THE PRODUCTS SOLD HEREUNDER. THIS WARRANTY LIMITATION APPLIES BOTH DURING AND AFTER THE APPLICABLE EXPRESS WRITTEN WARRANTY PERIOD OF THIS WARRANTY.

CORE™ OUTDOOR POWER DISCLAIMS LIABILITY FOR ANY IMPLIED WARRANTIES, INCLUDING WARRANTIES OF "MERCHANTABILITY" AND "FITNESS FOR A SPECIFIC PURPOSE" AFTER THE EXPRESS WRITTEN APPLICABLE WARRANTY PERIOD OF THIS WARRANTY.

THIS WARRANTY GIVES YOU SPECIFIC LEGAL RIGHTS, AND YOU MAY ALSO HAVE OTHER RIGHTS WHICH VARY FROM STATE TO STATE, OR PROVINCE TO PROVINCE. SOME STATES OR PROVINCES DO NOT ALLOW THE EXCLUSION OR LIMITATION OF INCIDENTAL OR CONSEQUENTIAL DAMAGES, SO THE ABOVE LIMITATION OR EXCLUSION MAY NOT APPLY TO YOU. SOME STATES OR PROVINCES DO NOT ALLOW LIMITATION ON HOW LONG AN IMPLIED WARRANTY LASTS, SO THE ABOVE LIMITATION MAY NOT APPLY TO YOU.

This limited warranty is given by OPE, Inc., d.b.a. CORE™ Outdoor Power, 36235 Kerr Dam Road, Polson, Montana USA 59860.

WARRANTY SERVICE

Instructions for Obtaining Warranty Repair Service or Aftermarket Non-Warranty Repair Service:

To arrange for CORE™ Outdoor Power product warranty or aftermarket repair service:

1. Before returning a non-functioning GasLess™ Trimmer to a CORE™ Authorized Service Center for service, please first determine if the difficult is potentially due to a non-functional Power Cell, or a non-functional Power Cell charger, or a non-functional cutting attachment accessory. To do such, first bring your GasLess™ Trimmer [with attached accessory], your Power Cell[s] and Power Cell charger to a local authorized CORE™ Outdoor Power products dealer, for inspection and determination as to whether it is your Power Cell or Power Cell charger, and / or the GasLess™ Trimmer that is not functioning properly. *Do **not** ship your Power Cells to a local authorized dealer or to a CORE™ Authorized Service Center, as the Lithium-ion Power Cells are restricted and regulated under Dangerous Goods Transport codes and require specialized protective packaging, marking, labeling, etc. to be safely and legally transported by commercial carriers.* Note: The GasLess™ Trimmer will not operate properly, if:
 - a. The Power Cell is discharged and / or dysfunctional, and / or;
 - b. if the Power Cell charger is non-functional so as to not be able to provide a recharge to a discharged but otherwise fully functional Power Cell.
2. Your local authorized CORE™ Outdoor Power products dealer should be able to readily assess which, if any, of the three CORE™ Outdoor Power GasLess™ Trimmer system's components is non-functional [that is, either: A) Your Power Cell: B) Your Power Cell charger: C) Your Gasless™ Trimmer or accessory]. Be sure to bring a copy of your Valid Proof of Original Purchase with you so as to allow the dealer to determine the applicability of your warranty coverage period. The original purchaser will be able to obtain a free replacement from the authorized dealer of a Power Cell, Power Cell charger, and / or a CORE™ accessory, if:

WARRANTY SERVICE

- a. The CORE™ Outdoor Power authorized dealer determines that there is a non-functioning Power Cell, Power Cell charger, and / or CORE™ accessory.
 - b. And that such non-functional component is found to be as a result of a defect in material or workmanship as covered within the applicable terms and period of the limited warranty.
The authorized dealer should be able to sell to you non-warranty covered replacements of the Power Cell, Power Cell charger or CORE™ authorized cutting accessory components.
3. If after first ruling out the prospect of a non-functional or defective CORE™ Power Cell, Power Cell charger, or CORE™ accessory [as per above], the problem is thus determined to require service repair of the GasLess™ Trimmer tool, carefully package the GasLess™ Trimmer tool [with CORE™ accessory attached], using sufficient packaging materials, and place in sturdy outer boxes to prevent damage during transit for warranty service, or aftermarket non-warranty repair at a CORE™ Outdoor Power Authorized Service Center. Again Note: Do NOT ship either functional or dysfunctional Power Cell(s) to a CORE™ Outdoor Power Authorized Service Center due to restrictive Dangerous Goods Transport regulations. Ship only the GasLess™ Trimmer tool [with accessory attached] for service to a CORE™ Outdoor Power Authorized Service Center as your local authorized CORE™ Outdoor Power products dealer should be able to satisfactorily resolve issues associated with the Power Cells, Power Cell chargers, or accessories.
4. Packaging cartons used for shipping should be of a strong outer packaging and properly sealed.
 - c. Complete the attached CORE™ Outdoor Power Factory Service request form provided below. Place the service request form within a separate envelope which envelope should be packaged with the product inside the outer shipment packaging.
 - d. Attach a copy of the valid proof of original purchase [which documentation identifies the product model and the date of original purchase] with the service request form. Please retain for your records, your original of the valid proof of original purchase.

WARRANTY SERVICE

5. We recommend the package be shipped insured for full value utilizing ground freight. The recommended freight couriers for delivery to a CORE™ Outdoor Power Factory Service center are either, FedEx, UPS, US Postal Service or Canada Post. CORE™ Outdoor Power will not be responsible for lost shipments or product damage during transit to the CORE™ Outdoor Power Authorized Service Center. In case of lost, missing packages, or damage during shipment to the CORE™ Outdoor Power Authorized Service Center, a claim with the shipper must be initiated by and pursued by the purchaser. Freight costs to the CORE™ Outdoor Power Authorized Service Center are to be prepaid by the purchaser.
6. If the product is covered under warranty the return shipping cost will be paid by CORE™ Outdoor Power Factory Service, with such freight prepaid terms being applicable to only return destinations in the contiguous 48 United States of America or Canada as per this limited warranty. CORE™ Outdoor Power products sold within Alaska and Hawaii are likely to have a separate limited warranty policy.
7. If upon inspection of the returned product it is determined that the product is not covered under this warranty, you will be contacted with costs estimates for non-warranty repair work and parts costs, and return freight delivery costs as per CORE™ Outdoor Power Authorized Service policies and procedures.

You may locate the nearest CORE™ Outdoor Power Authorized Service Center by searching our online authorized service center locator at WWW.COREOUTDOORPOWER.COM. Should you require assistance or have questions concerning CORE™ Outdoor Power Warranty Statement, or need assistance in obtaining warranty or aftermarket non-warranty repair service, you can contact our Customer Product Support Department at 1-844-831-2673 [Monday through Friday, between 8AM and 5PM, Mountain time], or contact us through the web at WWW.COREOUTDOORPOWER.COM.

WARRANTY SERVICE

Can I have parts sent to me under the CORE™ Outdoor Power warranty?

Unfortunately, we are unable to send out warranty replacement parts directly to consumers. However, local authorized retailers or dealers may assist consumers with warranty or aftermarket service replacement of Power Cells, Power Cell chargers and CORE™ accessories.

As our warranty states, warranty service is available with valid proof of original purchase through CORE™ Outdoor Power's Authorized Service Center. These policies exist for many reasons. First and foremost is your safety. By having the authorized service center service the product, we are assured that the unit is being repaired by properly trained service technicians. The service technicians will also inspect the unit to be sure that there are no other apparent repairs needed as well. These additional repairs may not be obvious to an untrained person, or to a person without appropriate analytical testing and repair equipment.

Secondly, concerns assurance the warranty repairs provide for continuity of the original period of warranty coverage for the product or accessories. If we send a warranted part out at no-charge and dismiss the labor provided section of the warranty we cannot be assured that the warranted part is installed properly. Conversely, if a consumer purchases a service part and installs it themselves, the consumer then assume all liability for the repairs. Any repairs not made by CORE™ Outdoor Power's Authorized Service Center will void the continuance of the warranty on the product.

We apologize for any inconveniences and want to assure you that our company stands behind the warranty fully. Please comply with the warranty guidelines for warranty service by having the unit properly serviced at a CORE™ Authorized Service Center.