



DCH SERIES

**3 - 6 TONS PACKAGED HEAT PUMPS
13 SEER / UP TO 11.3 EER / 8.0 HSPF**

**6-TON WITH TWO-SPEED BLOWER MOTOR AND
TWO-STAGE COMPRESSOR UP TO 15.5 IEER
COOLING CAPACITY: 35,000 — 71,000 BTU/H
HEATING CAPACITY: 34,600 — 70,000 BTU/H**

SUBMITTAL DATA FORM

Job Name _____

Location _____

Purchaser _____

Order No. _____

Engineer _____

Unit No. _____

Model No. _____

Unit Designation _____

Performance Data Certified By: _____

Standard Features

- High-efficiency scroll compressor
- Copper tube / aluminum fin coils
- High- and low-pressure switches
- Refrigerant accumulator
- Contactor with lugs
- High-capacity, steel-cased filter drier
- Heater kits with single-point entry
- 24-volt terminal strip
- Convertible airflow orientation
- Easy to service
- Built-in filter rack with standard 2" filters
- Bottom utility entry
- AHRI Certified; ETL Listed
- 3-6 Tons with single speed blower motor units meet the performance specified in Table 6.8.1A of ASHRAE Standard 90.1-2010
- 6-ton with two-speed blower motor and two-stage compressor meet the performance specified as of 1/1/2016 in Table 6.8.1-2 of ASHRAE STANDARD 90.1-2013

Cabinet Features

- Heavy-gauge, galvanized-steel cabinet with UV-resistant powder-paint finish
- Full Perimeter Rail
- Sloped drain pan



* Complete warranty details available from your local dealer or at www.daikincomfort.com.

PERFORMANCE DATA

Cooling Performance		
Total Capacity	_____	MBH
Sensible Capacity	_____	MBH
Outdoor Design TMP	_____	°F DB / WB
Air Temp entering	_____	
Evaporator Coil	_____	°F
Power Input Required (less blower motor)	_____	kW
Heating Performance		
Total Heating Capacity	_____	kW
	_____	BTU/h
Supply Air Blower Performance		
Total Supply Air	_____	CFM
Ext. Static Pressure	_____	IWG
Blower Speed	_____	RPM
Power Output Required	_____	BHP
Motor Ratings	_____	HP
Power Input Required	_____	kW
Electrical Data		
Power Supply	_____	
Total Unit Amps	_____	Amps
Max Overcurrent Device:		
Fuse	_____	Breaker _____ Amps _____

DIMENSIONS

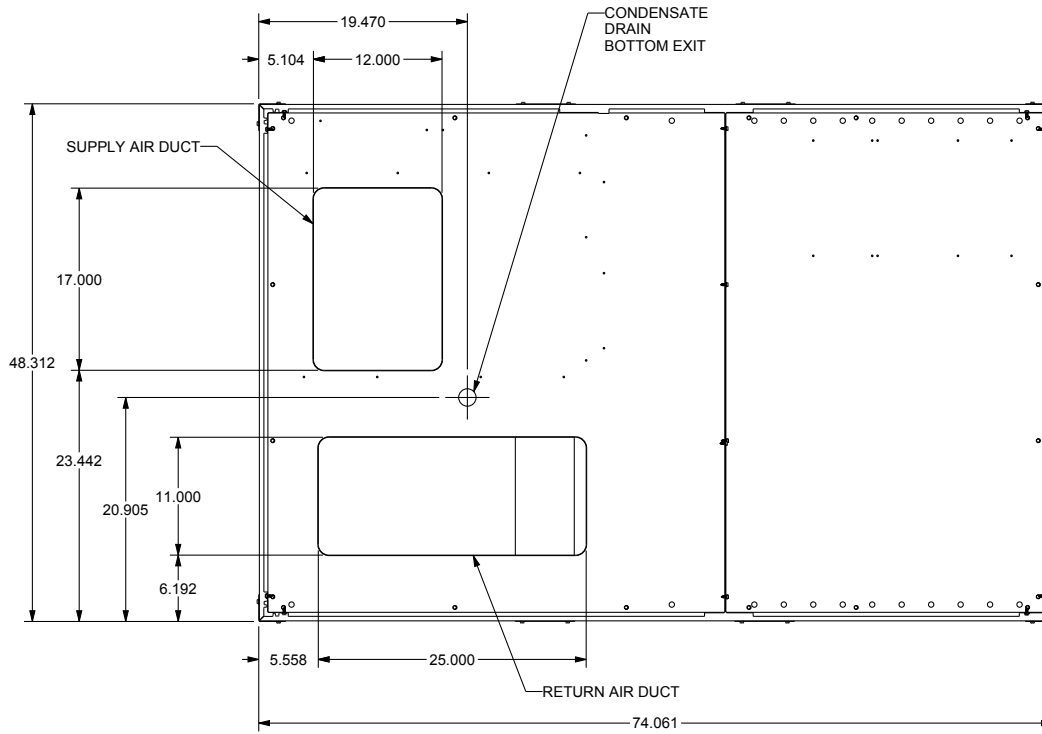

BASE PAN VIEW
(VIEWED FROM TOP)

MODEL TONNAGES	"A"	"B"	"C"
3 TON COMMERCIAL GAS, HT PUMP, AIR CONDITIONER	38.840	16.555	26.055
4 TON COMMERCIAL GAS, HT PUMP, AIR CONDITIONER	38.840	16.555	26.055
5 TON COMMERCIAL GAS, HT PUMP, AIR CONDITIONER	38.840	16.555	26.055
6 TON COMMERCIAL GAS, HT PUMP, AIR CONDITIONER	42.840	20.555	30.055

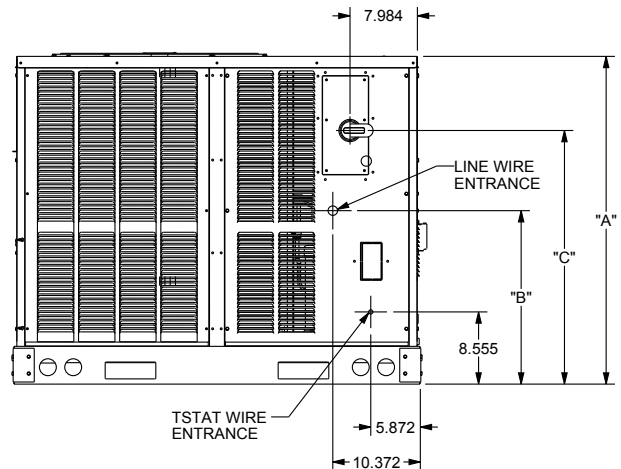

LEFT END VIEW

ACCESSORIES LIST

DAIKIN MASTER ITEM #	DESCRIPTION	FITS MODEL SIZES	FIELD- INSTALLED	FACTORY- INSTALLED	✓
	Curb				
14CURB3672B	14" Roof Curb	3-6 tons	✓		
18CURB3672B	18" Roof Curb	3-6 tons	✓		
24CURB3672B	24" Roof Curb	3-6 tons	✓		
GHRC-3672	Hurricane Restraint Clips	3-6 tons	✓		
	Ultra Low-Leak Economizer & Power Exhaust¹				
10-365-09C	Ultra Low-Leak Downflow Economizer w/ Dry Bulb	3-6 tons	✓		
10-366-09C	Ultra Low-Leak Downflow Economizer w/ Enthalpy	3-6 tons	✓	✓	
10-395-09	Ultra Low-Leak Horizontal Economizer w/ Dry Bulb	3-6 tons	✓		
10-396-09	Ultra Low-Leak Horizontal Economizer w/ Enthalpy	3-6 tons	✓		
10-455-09*-23	Centrifugal Power Exhaust 230v	3-6 tons	✓		
10-455-09*-33	Centrifugal Power Exhaust 460v	3-6 tons	✓		
10-455-09*-43	Centrifugal Power Exhaust 575v	3-6 tons	✓		
10-457-09xA-23	Modulating Power Exhaust 208-230v	3-6 tons	✓		
10-457-09xA-33	Modulating Power Exhaust 460v	3-6 tons	✓		
10-465-09-21	Prop Power Exhaust 230v	3-6 tons	✓		
10-465-09-31	Prop Power Exhaust 460v	3-6 tons	✓		
10-465-09-41	Prop Power Exhaust 575v	3-6 tons	✓		
	Low-Leak Economizer & Power Exhaust²				
DDNECNJ3672C	Low-Leak Downflow Economizer	3-6 tons	✓	✓	
DPE36722	Downflow Power Exhaust (208/230 Volt)	3-6 tons	✓		
DPE36724	Downflow Power Exhaust (460 Volt)	3-6 tons	✓		
DPE36727	Downflow Power Exhaust (575v)	3-6 tons	✓		
DHZECNJ3672	Horizontal Economizer	3-6 tons	✓		
DHPE36722	Horizontal Power Exhaust (208/230 Volt)	3-6 tons	✓		
DHPE36724	Horizontal Power Exhaust (460 Volt)	3-6 tons	✓		
DHPE36727	Horizontal Power Exhaust (575 Volt)	3-6 tons	✓		
	Downflow Accessories				
D25FD3672	25% Manual Fresh Air Damper	3-6 tons	✓		
D25MFD3672	25% Motorized Fresh Air Damper	3-6 tons	✓		
DDNBBS3672	Burglar Bar Sleeves with Supply & Return	3-6 tons	✓		
DDNECNJ3672NR	Downflow Economizer2 w/o Barometric Relief	3-6 Tons	✓		
DDNSQRD3616	Downflow Square-to-Round Adapter (16" Round)	3 tons	✓		
DDNSQRD487218	Downflow Square-to-Round Adapter (18" Round)	4-6 tons	✓		
	Horizontal Accessories				
DBRD3672	Barometric Relief Damper	3-6 tons	✓		
	Concentrics				
CDK36	Concentric Duct Kit	3 tons	✓		
CDK4872	Concentric Duct Kit	4-6 tons	✓		
	DDC Accessories³				
	DDC communicating controller (built-in BACnet® MS/TP) includes Standard Room Sensor to be installed in field	3-6 tons		✓	

ACCESSORIES LIST (CONT.)

DAIKIN MASTER ITEM #	DESCRIPTION	FITS MODEL SIZES	FIELD- INSTALLED	FACTORY- INSTALLED	✓
10366D09C	DDC Ultra Low-Leak Downflow Economizer	3-6 tons	✓	✓	
10366D09	DDC Ultra Low-Leak Horizontal Economizer	3-6 tons	✓		
10465DDC	Power Exhaust kit used with DDC Ultra Low-Leak Economizer	3-6 tons	✓		
DLAKT01	Low-Ambient	3-6 tons	✓	✓	
LONKT01	LonWorks® card	3-6 tons	✓		
3PMK01	Phase Monitor (3-Phase Only)	3-6 tons	✓	✓	
DFSKT01	Dirty Filter Switch	3-6 tons	✓		
3 phase 208-230V Electric Heat Kits					
SPKT02	Single Point Wiring Kit 3phase Heat Kits	3-6 tons	✓	✓	
EHK3-10	10kw 208-230 3ph Electric Heat Kit	3-6 tons	✓	✓	
EHK3-15	15kw 208-230 3ph Electric Heat Kit	3-6 tons	✓	✓	
EHK3-18	18kw 208-230 3ph Electric Heat Kit	4 tons	✓	✓	
EHK3-20	20kw 208-230 3ph Electric Heat Kit	5 tons	✓	✓	
EHK3-25	25kw 208-230 3ph Electric Heat Kit	6 tons	✓	✓	
3 phase 460V Electric Heat Kits					
EHK4-10	10kw 460v 3ph Electric Heat Kit	3-6 tons	✓	✓	
EHK4-15	15kw 460v 3ph Electric Heat Kit	3-6 tons	✓	✓	
EHK4-18	18kw 460v 3ph Electric Heat Kit	4 tons	✓	✓	
EHK4-20	20kw 460v 3ph Electric Heat Kit	5 tons	✓	✓	
EHK4-25	25kw 460v 3ph Electric Heat Kit	6 tons	✓	✓	
3 phase 575V Electric Heat Kits					
EHK7-10	10kw 575v 3ph Electric Heat Kit	3-6 tons	✓	✓	
EHK7-15	15kw 575v 3ph Electric Heat Kit	3-6 tons	✓	✓	
EHK7-18	18kw 575v 3ph Electric Heat Kit	4 tons	✓	✓	
EHK7-20	20kw 575v 3ph Electric Heat Kit	5 tons	✓	✓	
EHK7-25	25kw 575v 3ph Electric Heat Kit	6 tons	✓	✓	
High-Static Kits⁴					
HSKT036B	High-Static Kit (230/460v)	3 tons	✓	✓	
HSKT036B-7	High-Static Kit (575v)	3 tons	✓	✓	
HSKT048B	High-Static Kit (230/460v)	4 tons	✓	✓	
HSKT048B-7	High-Static Kit (575v)	4 tons	✓	✓	
HSKT060B	High-Static Kit (230/460v)	5 tons	✓	✓	
HSKT060B-7	High-Static Kit (575v)	5 tons	✓	✓	
HSKT072B	High-Static Kit (230/460v)	6 tons	✓	✓	
HSKT072B-7	High-Static Kit (575v)	6 tons	✓	✓	
Crankcase Heater Kits					
0163R00002S	40W 230V	3 tons	✓		
0163R00031S	40W 460V	3 tons	✓		
0163R00032S	40W 575V	3 tons	✓		
0130L00017S	70W 230V	4 - 6 tons	✓		
0130L00018S	70W 460V	4 - 6 tons	✓		
0130L00019S	70W 575V	4 - 6 tons	✓		

ACCESSORIES LIST (CONT.)

DAIKIN MASTER ITEM #	DESCRIPTION	FITS MODEL SIZES	FIELD- INSTALLED	FACTORY- INSTALLED	√
High Efficiency Filters					
0160L00203	High Efficiency MERV 13 Air Filter Nom. Size: 24x24x2; (Order Qty 1)	3 tons	√		
0160L00204	High Efficiency MERV 13 Air Filter Nom. Size: 14x20x2; (Order Qty 4)	4 tons	√		
0160L00205	High Efficiency MERV 13 Air Filter Nom. Size: 16x20x2; (Order Qty 4)	5 & 6 tons	√		
Misc Accessories					
HAILGD03D	Condenser Coil Hail Guard	3-5 tons	√		
HAILGD04D	Condenser Coil Hail Guard	6 tons	√		
	Convenience Outlet: Non Powered	3-6 tons		√	
	Convenience Outlet: Powered	3-6 tons		√	
	Disconnect Switch	3-6 tons		√	
LAKT12	Low Ambient Kit, 208-230V - non-DDC	3-6 tons	√	√	
LAKT15	Low Ambient Kit, 460V - non-DDC	3-6 tons	√	√	
LAKT16	Low Ambient Kit, 575V - non-DDC	3-6 tons	√	√	
3PMNDK01	Phase Monitor - Non DDC	3-6 tons	√	√	
	Smoke Detector (supply and/or return air)	3-6 tons		√	
	Hinged Panels	3-6 tons		√	

¹ Use Economizer & Power Exhaust listed within Ultra Low-Leak section

² Use Economizer & Power Exhaust listed within Low-Leak section

³ For a full list of DDC accessories, please refer to DDC Controller Technical Guide manual (DK-DDC-TGD-01B)

⁴ HSKT High-Static Kits are for use with standard single-speed belt-drive units only.

Note: Where multiple variations are available, the heaviest combination is listed.

ROOF CURB — #D14CURB3672

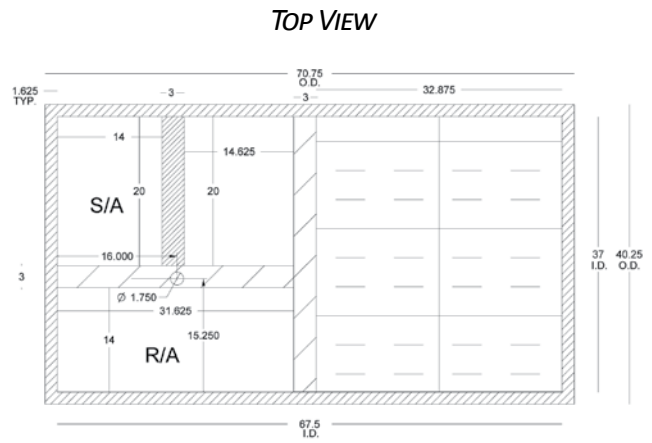
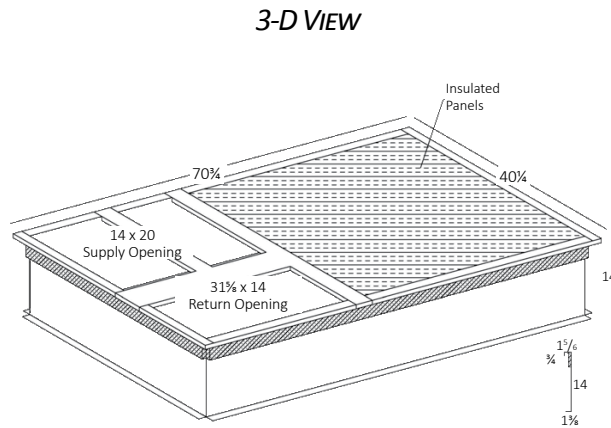

SPECIFICATIONS

- 14" Tall
- 18-Gauge Construction
- 1x4 Wood Nailer
- Shipped knocked down with all hardware
- Gasket included
- Bed-rail style corners
- Weighs 95 lbs

Note: outside duct dimension should be 1/2" less than opening dimensions above.

NO CURB ADAPTER REQUIRED WHEN REPLACING CARRIER & BRYANT MODELS

No curb adapter is required when replacing an existing Carrier or Bryant RTU with a Daikin RTU in these situations; the footprints and locations of the return and supply duct work match.

NEW UNIT	EXISTING CARRIER	EXISTING BRYANT
3 TO 6 TONS	48/50 TJ, LJ, DJ, QJ 48/50 TM, HJ 004 - 007	580C-D, 558C-D, 548C-D 580F, 558F, 581B 036 - 072

MANUAL FRESH AIR DAMPER — #D25FD3672
MOTORIZED FRESH AIR DAMPER — #D25MFD3672

SPECIFICATIONS

D25FD3672 Manual Damper

- Provides up to 25% fresh air
- Slide damper for easy adjustment
- Weighs 12 pounds

D25MFD3672 Motorized Damper

- 24 VAC Damper motor with spring return
- Factory wired for easy connection
- Weighs 14 pounds
- Fits all 3 - 6 ton package units in all fuels
- All dampers painted to match daikin units

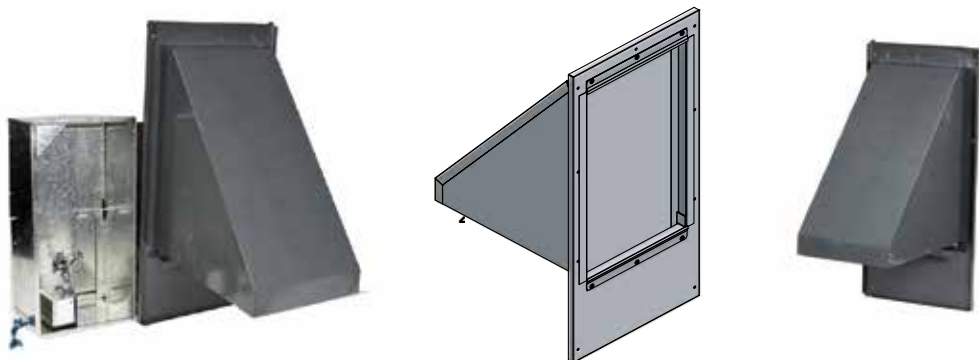
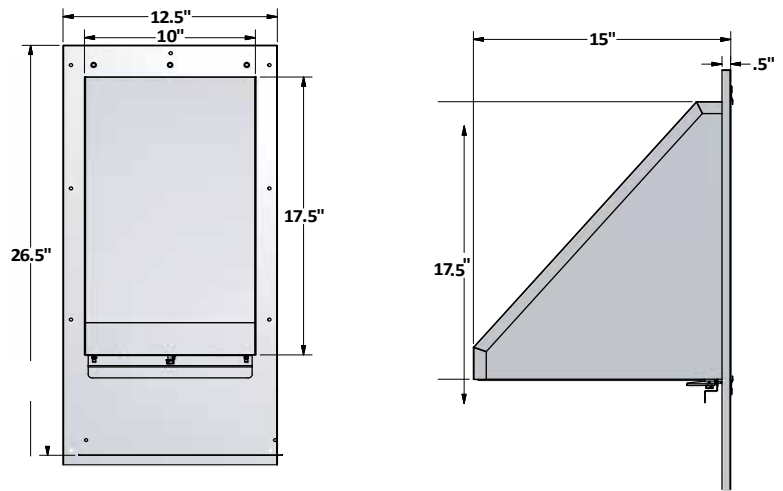

HAIL GUARD — #HAILGDO*



SPECIFICATIONS

- Condenser coil protection
- Prevents hail damage
- Easy to remove and clean
- Powder paint finish

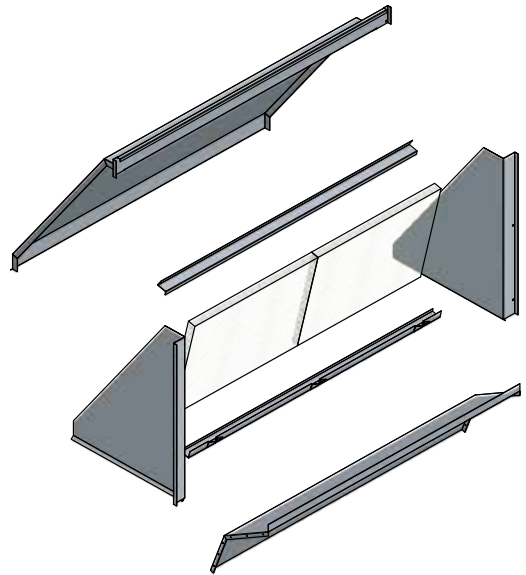
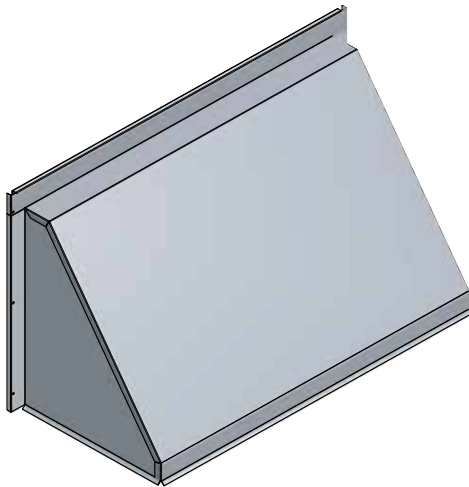
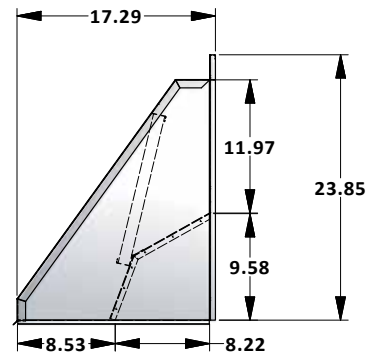
DOWNFLOW ECONOMIZER — #DDNECNJ3672B**SPECIFICATIONS**

- Fully modulating
- Up to 100% fresh air
- Integral barometric relief
- Hoods painted to match unit
- Honeywell JADE economizer control
- Single adjustable enthalpy control convertible to dual enthalpy
- Adjustable minimum fresh air
- Fits all models, all fuel types 3-6 Ton DC series and 3-5 Ton DT series
- Weighs 65 lbs

HORIZONTAL ECONOMIZER — #DHZECNJ3672

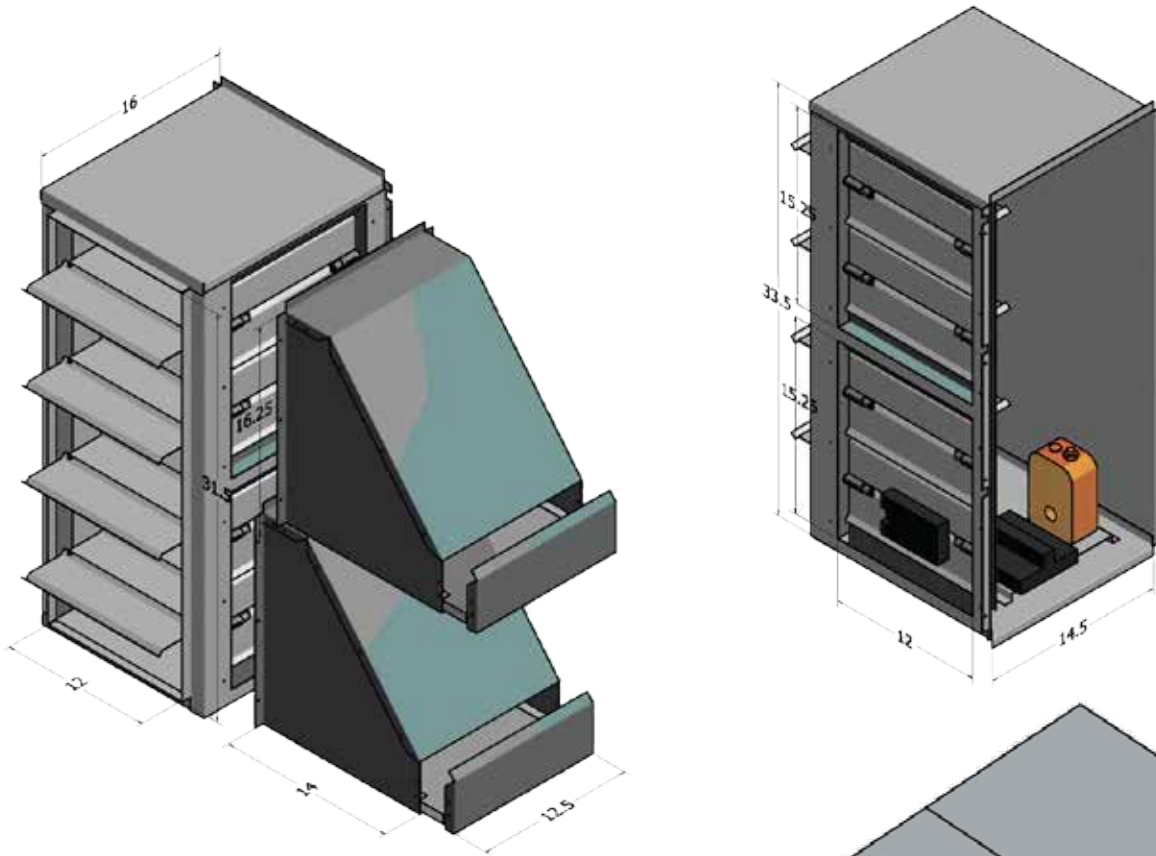

SPECIFICATIONS

- Fully modulating
- Up to 100% fresh air
- Honeywell JADE economizer control
- Single adjustable enthalpy control convertible to dual enthalpy
- Factory wired for easy connection
- Adjustable minimum fresh air
- Fits all models, all fuel types 3-6 Ton DC series and 3-5 Ton DT series
- Weighs 75 lbs

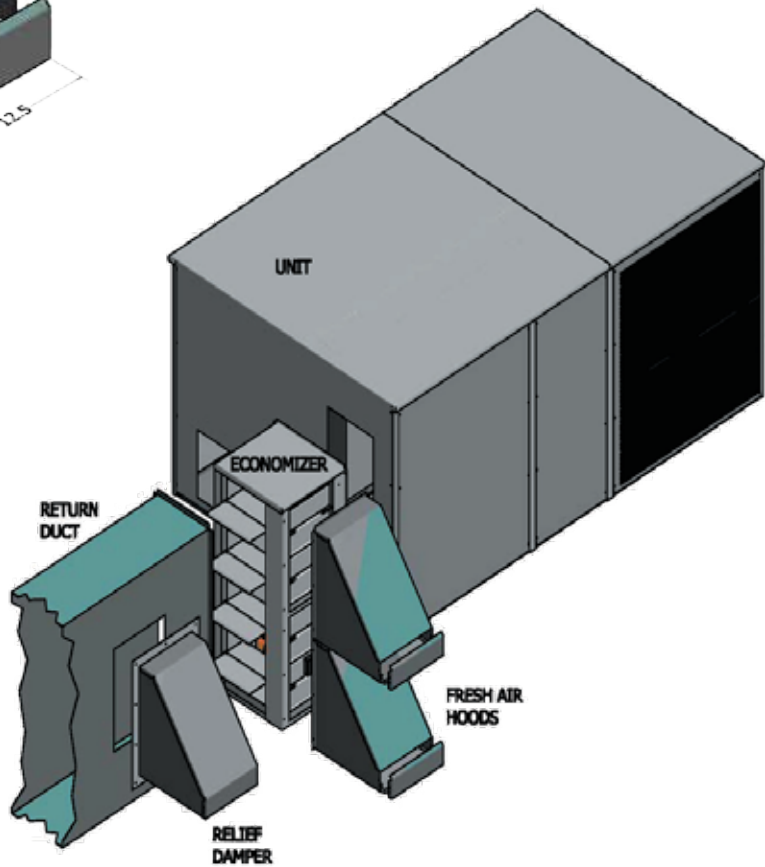

BAROMETRIC RELIEF DAMPER — #DBRD3672

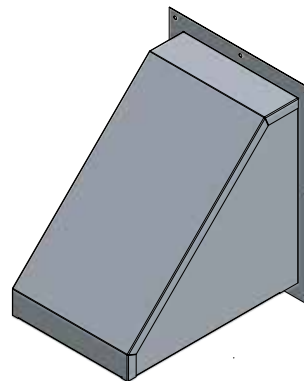
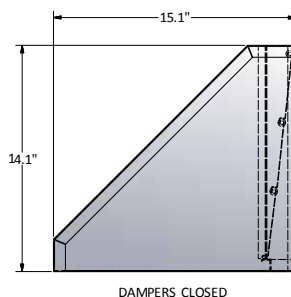
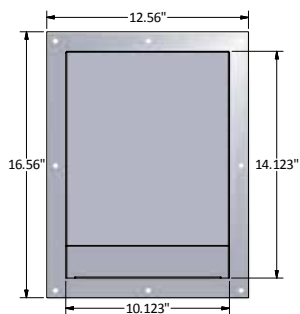

SPECIFICATIONS

- Applications up to 6 tons require one damper
- Applications from 7.5 - 12.5 tons require 2 damper
- Installed upstream of economizer return dampers in Horizontal applications
- Painted nickle gray to match Daikin equipment
- Weighs 15 pounds

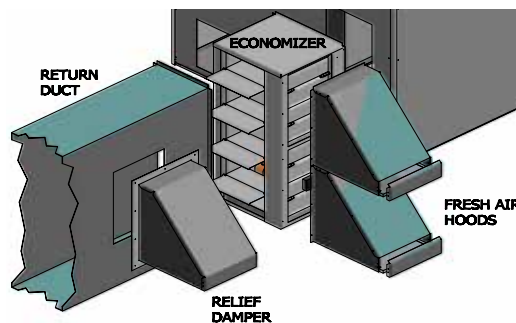
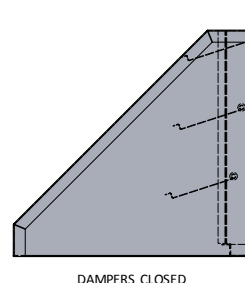

HURRICANE / SEISMIC CLIP — DHRC-1

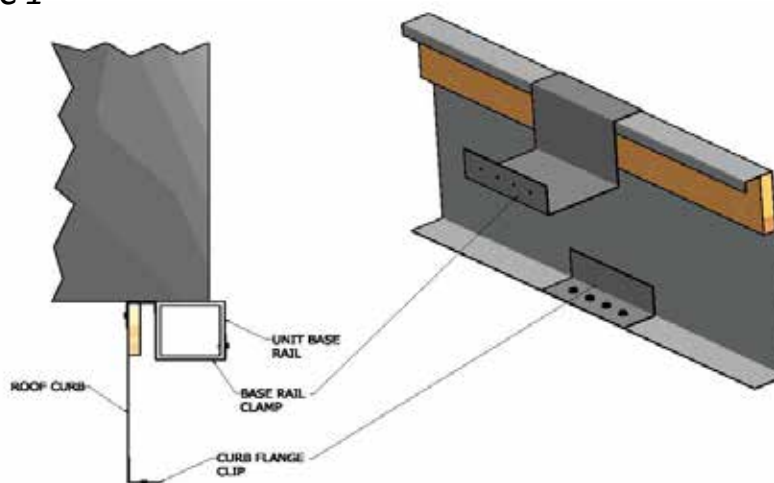

SPECIFICATIONS

- 14-gauge construction typical
- Location and quantity of clips dictated local code and unit size
- Optional angle for seismic applications
- Weigh 2 pounds each

CONCENTRIC DUCT KIT — #CDK36 / #CDK4872

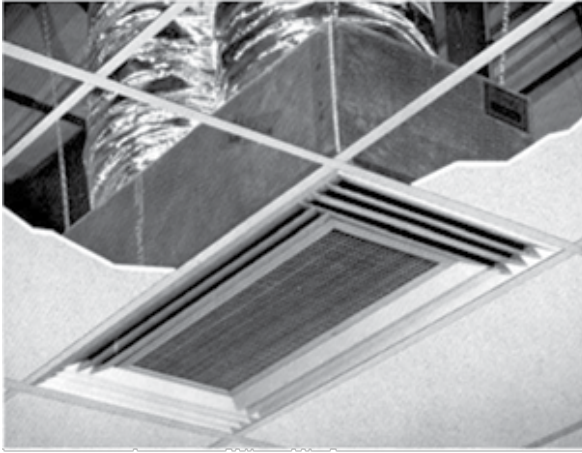

Light Commercial
T-Bar Ceiling

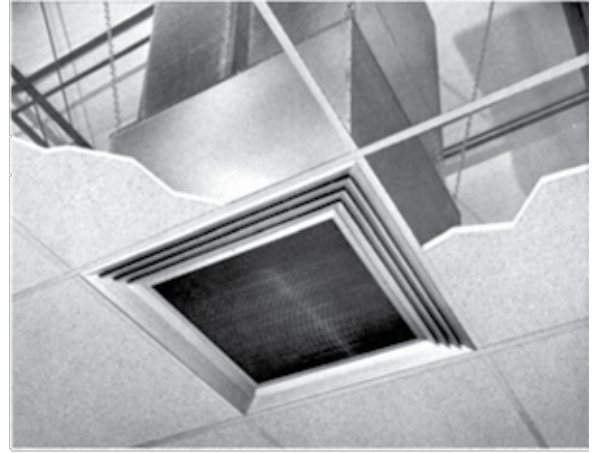

Commercial
T-Bar Ceiling

SPECIFICATIONS

- All-aluminum diffuser with aluminum return air egg crate
- Built-in anti-sweat gasket
- Molded fiberglass transition (through five tons)
- Built-in hanging supports
- Diffuser box constructed of fiberglass duct board (through 7½ tons) or sheet metal

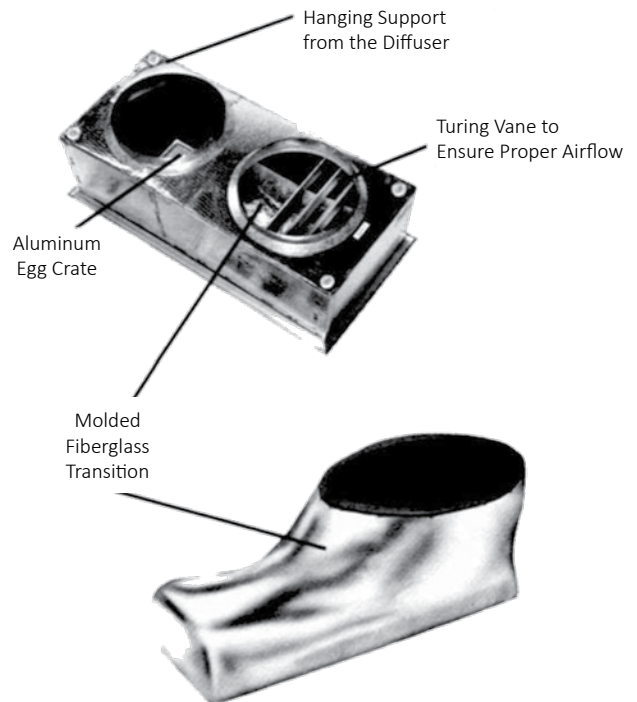

3 - TON SQUARE-TO-ROUND — #DDNSQRD3616

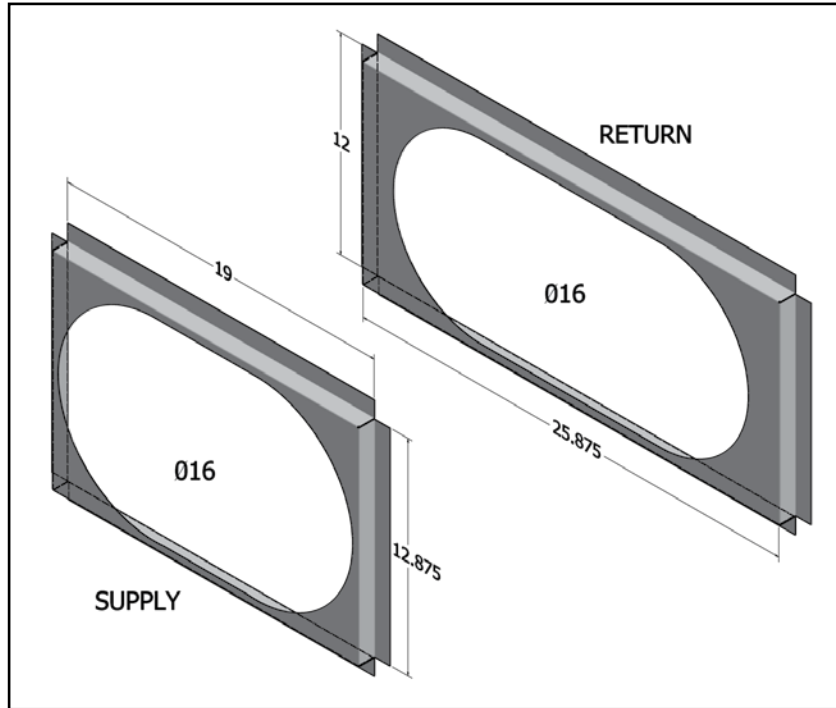

4 - 6 TON SQUARE-TO-ROUND — #DDNSQRD487218

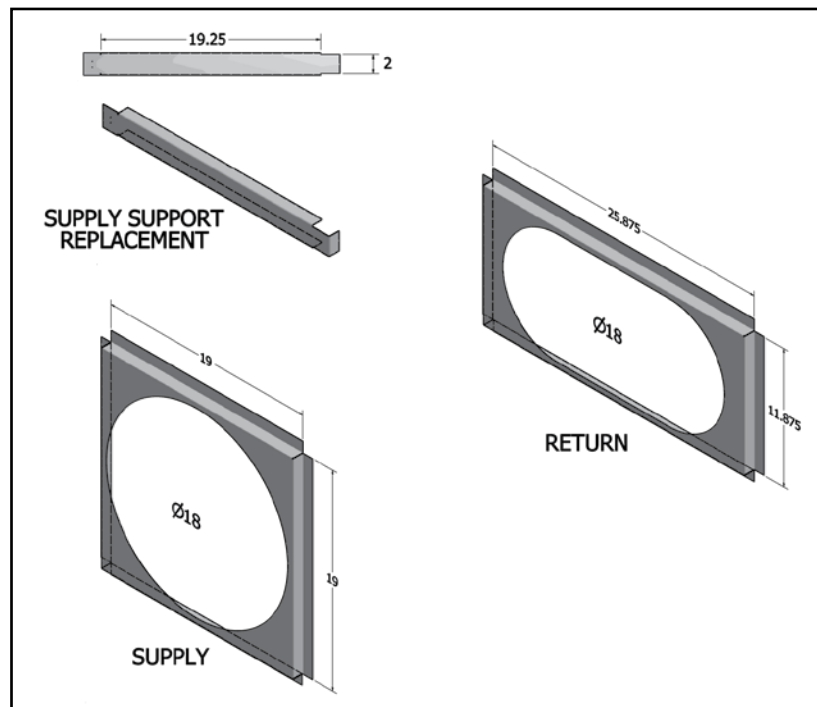

DOWNFLOW BURGLAR BAR SLEEVES – #DDNBBS3672

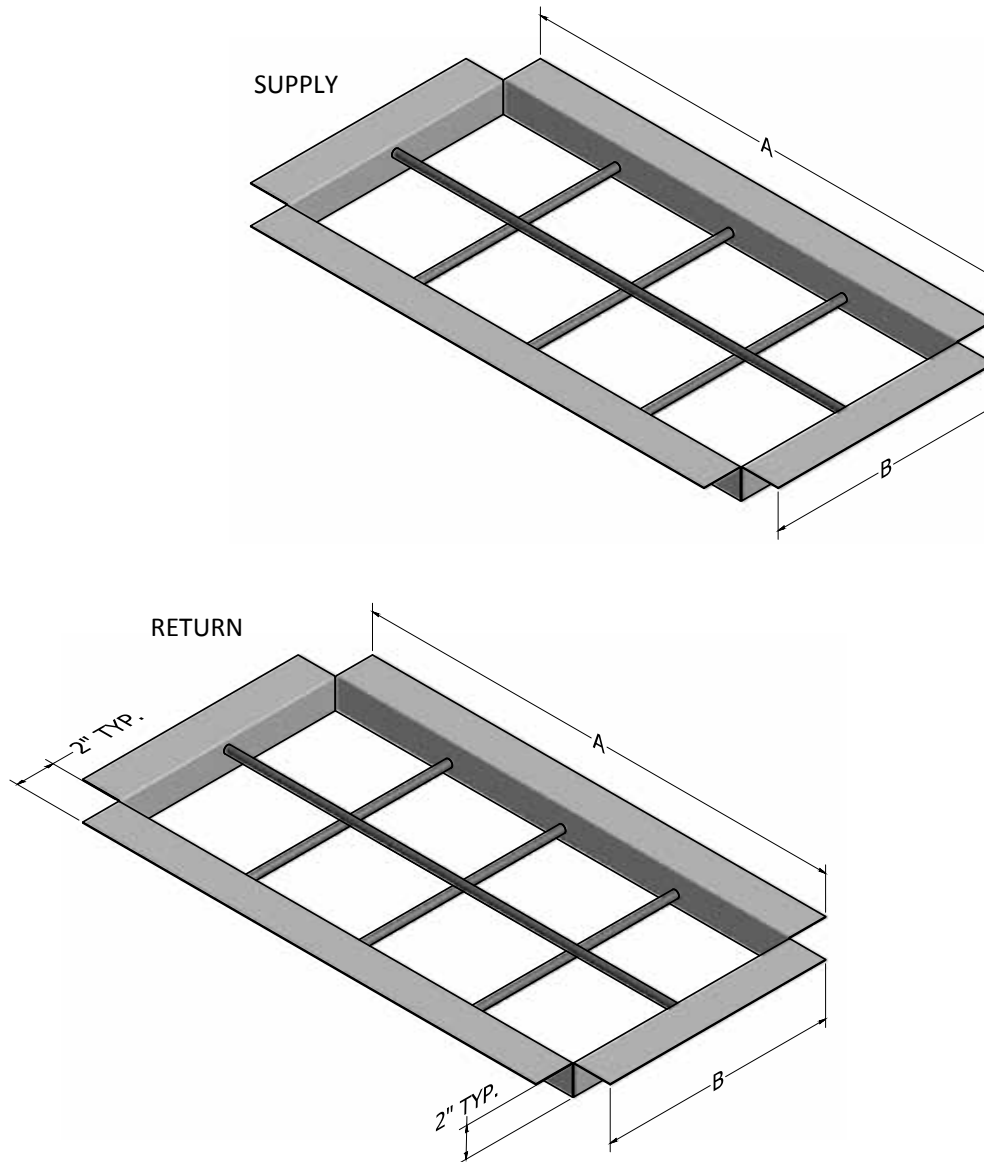

Part Number	Return 'A'	Return 'B'	Supply 'A'	Supply 'B'
DNBBS3672B	30 $\frac{3}{8}$	13 $\frac{1}{4}$	19 $\frac{1}{4}$	13 $\frac{1}{4}$
DNBBS90150	37 $\frac{3}{8}$	13 $\frac{3}{8}$	30 $\frac{3}{8}$	14 $\frac{3}{8}$
DNBBS180240	61 $\frac{3}{8}$	23 $\frac{3}{8}$	61 $\frac{3}{8}$	22 $\frac{3}{8}$

SPECIFICATIONS

- Fully Welded 18 Gauge Sleeve
- Fully Welded 1/2" Bars
- 8" Openings Standard
- Supply and Return Sleeves Packaged Together
- Install in the Top of the Roof Curb, Inside of the Supply and Return Duct Drops

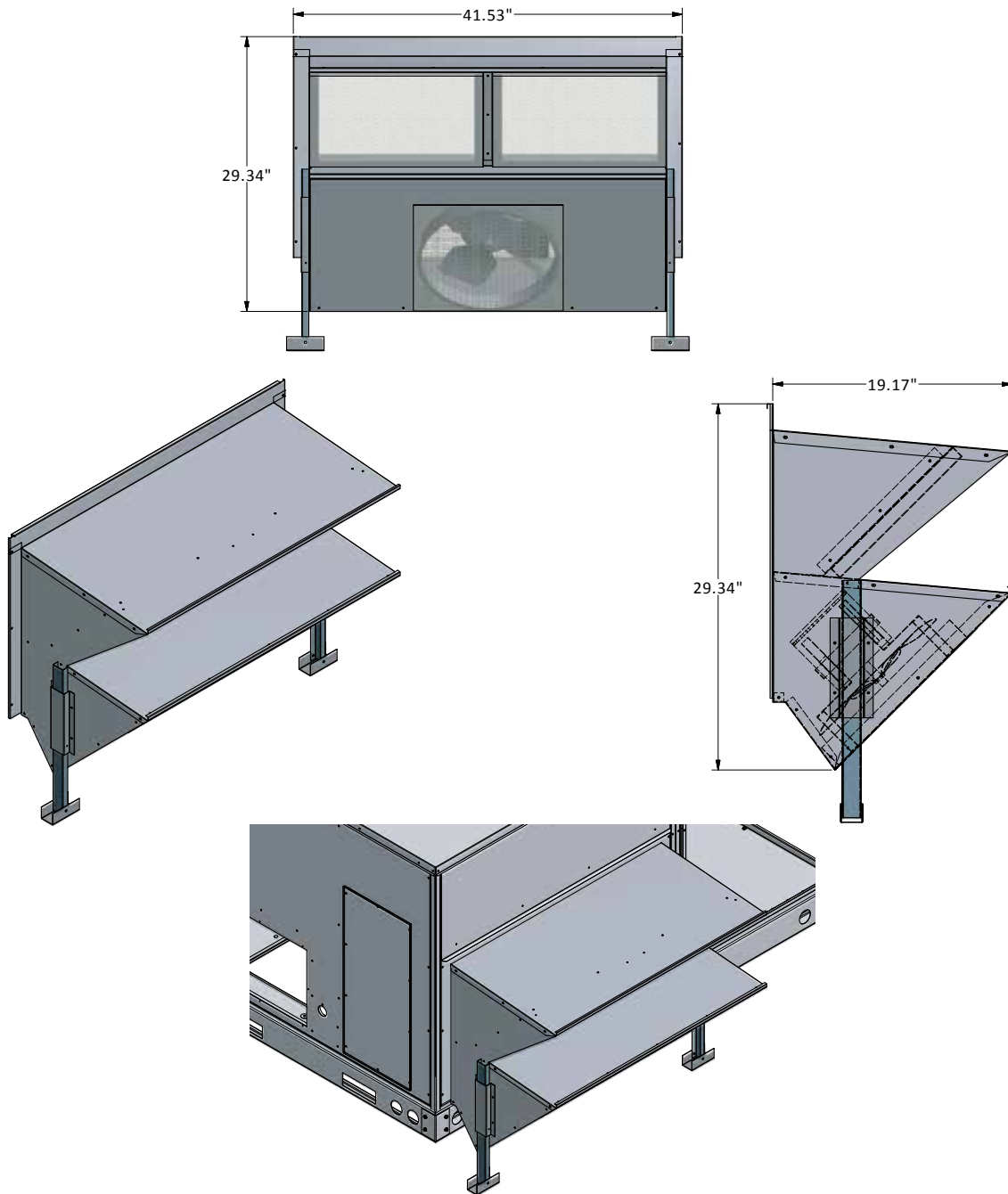
DOWNFLOW POWER EXHAUST – #DPE3672***SPECIFICATIONS**

- Propeller type fans
- 208/230V, 460V, 575v models available
- Used in conjunction with DDNECNJ3672B
- Up to 100% relief
- Replaces Outside Air/Barometric Relief Hood
- Weighs 58 Pounds

NOTES