

ATTACHMENT OPERATOR'S MANUAL

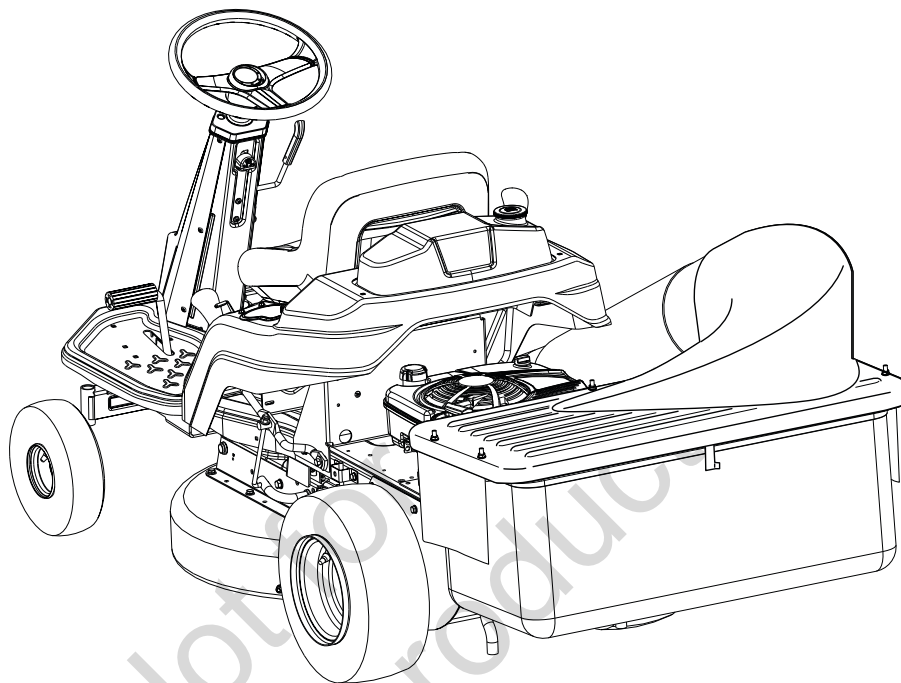

Single Bag Catcher for Rear Engine Rider

Mfg. No.
7600199

Description
Single Bag Catcher



CAUTION: Read and follow all instructions

7106052
Rev.: A

Not for
Reproduction

Table of Contents

Operator Safety	4
Assembly	5
Operation	11
Warranty	12
Parts List	14

NOTE: In these instructions, “left” and “right” are referenced from the operating position.

Not for
Reproduction

Operator Safety

⚠ Read these safety rules and follow them closely. Failure to obey these rules could result in loss of control of unit, severe personal injury or death to you, or bystanders, or damage to property or equipment. The ⚠ triangle in text signifies important cautions or warnings which must be followed.

⚠ General Warnings

- Know the unit's controls and how to stop quickly. **READ THE OPERATOR'S MANUALS.**
- Read and obey all safety decals.
- Only allow responsible adults, who are familiar with the instructions, to operate the unit.
- Disengage the PTO. Shut off the engine and wait for all moving parts to stop before attaching, adjusting, or disconnecting any part of the collection system.
- Check the collection system to make sure it is bolted tightly to the unit.
- **DO NOT** operate the unit without either the entire grass catcher or the deflector in place.
- Turn off the PTO to disengage the blades when not mowing.
- **DO NOT** mow in reverse unless absolutely necessary. Always look down and behind before and while travelling in reverse.
- **DO NOT** turn sharply when travelling alongside a building or any object. Slow down before turning.
- **DO NOT** carry passengers.
- When collection system is removed from the mower deck, the deflector must be properly installed.
- Collector bags are subject to deterioration and wear during normal use. Inspect the bag periodically for tears, holes, or weak spots and replace with a new bag that meets manufacturer's durability standards.
- For added stability and to prevent tipping or loss of control:
 - a. Use reduced speed on uneven ground and when turning corners.
 - b. Reduce loads on hillsides. It is recommended that the collection system be kept only half full when negotiating any slopes. Start mowing on slopes when the collection system is empty.
 - c. Mow up and down the face of slopes; never across the face of any slope.
- **Never operate on slopes greater than 17.6% (10°).**

Safety Decals

Several safety labels are installed on the unit to remind you of important information while you are operating your unit.

All DANGER, WARNING, CAUTION and instructional messages on your rider, attachments and mower should be carefully read and obeyed. Personal bodily injury can result when these instructions are not followed. The safety decals below are on your product.

If any decals are lost or damaged, replace them at once. See your local dealer for replacements.

These labels are easily applied and will act as a constant visual reminder to you, and others who may use the equipment, to follow the safety instructions necessary for safe, effective operation.

Attachment Decal



Decal - WARNING Chute / Deflector Decal
Part Number 7046720SM

NOTE: In this manual, “left” and “right” are always defined from the standpoint of the operator position facing forward from seat.

! WARNING

Before beginning any service work, turn off the blade, set the parking brake, turn off the ignition, and disconnect the spark plug wire(s).

Rear Bumper Installation

1. Remove the two self-threading bolts (A, Figure 1) from the rear of the rider. Store in a safe place for future use.
2. Attach each of the supplied bumpers (B) to the rear of the rider as shown with two 5/16 x 1-1/2 bolts (C). Secure the bottom bolt with a 5/16 flange nut (D). (The top hole is threaded and requires no nut.)
3. Install a bumper cap (E) onto the top of each of the bumpers.

! WARNING

DO NOT stand the unit on end. Attempting to do so may cause an unstable condition, resulting in serious injury or equipment damage.

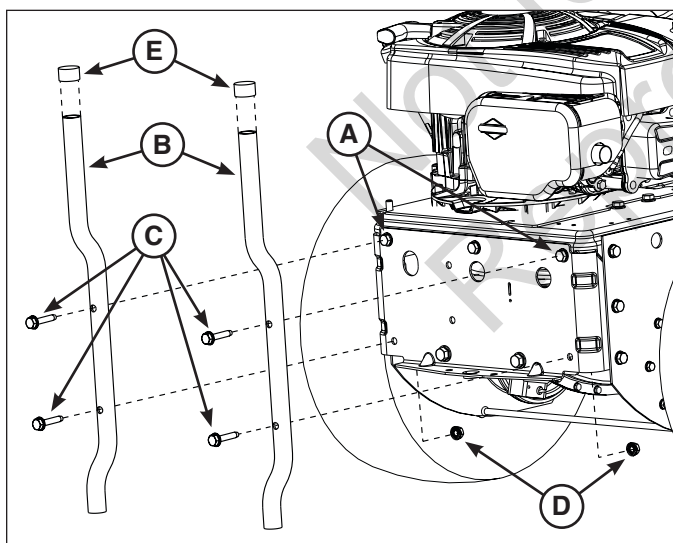

Figure 1

Bag Rod Installation

1. Slide the bag rod (A, Figure 2) through the sleeve on the upper edge of the grass bag (B).

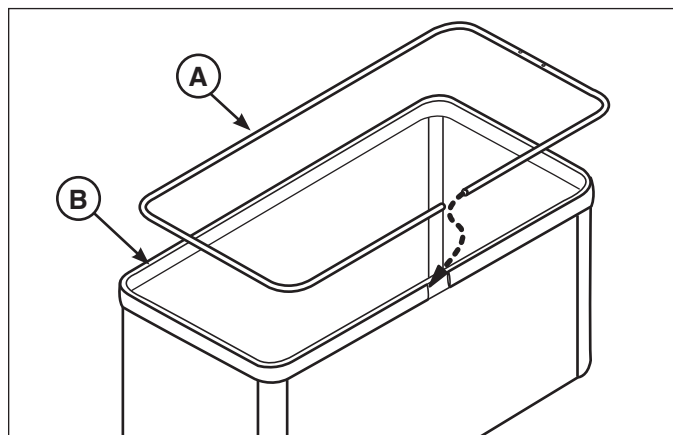

Figure 2

2. Stand the grass bag assembly (C, Figure 3) on end.
3. Secure the rod ends (D) with the connector (E).

NOTE: Use of a rubber mallet may be necessary to carefully tap the rod ends tightly into the connector.

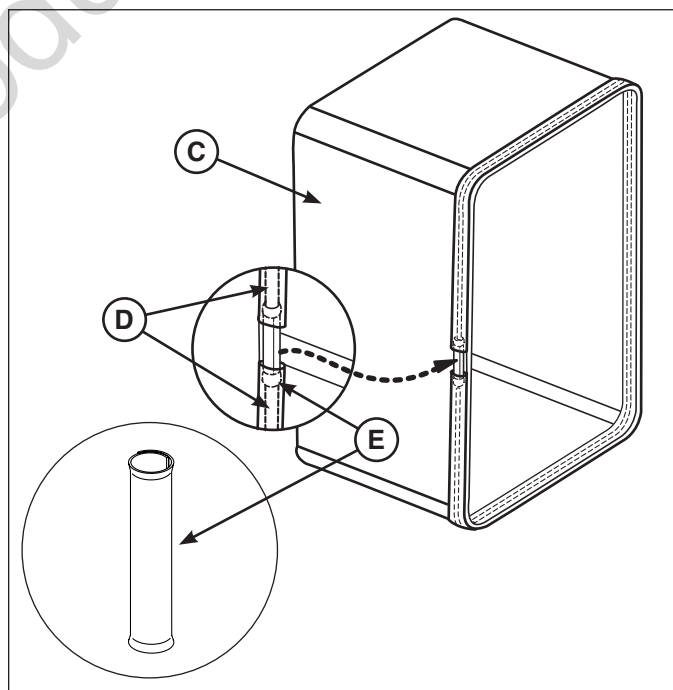

Figure 3

Assembly

Frame Assembly

1. Insert the #10 machine screw (A, Figure 4) through the hole of the catcher latch (B) and the grass catcher frame (C). Secure with the #10 lock nut (D).

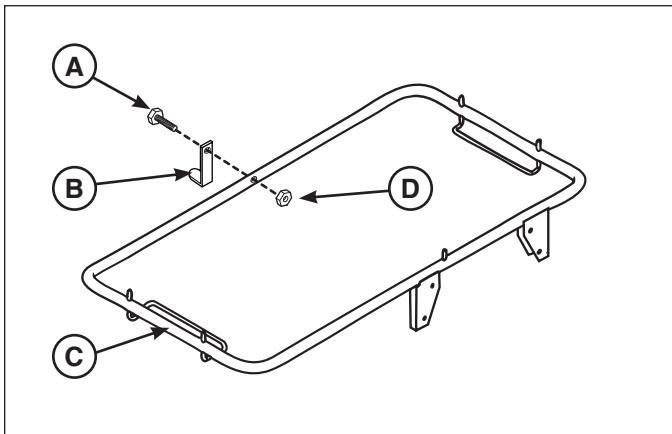

Figure 4

Dust Skirt Installation

1. With the dust skirt (A, Figure 5) aligned with the catcher frame (B) as shown, slip the large holes (C) in the skirt up and over the frame brackets (D).
2. Wrap the front and sides of the dust skirt around and over the front and sides of the catcher frame, slipping the five hanger holes (E) over the frame pegs (F).

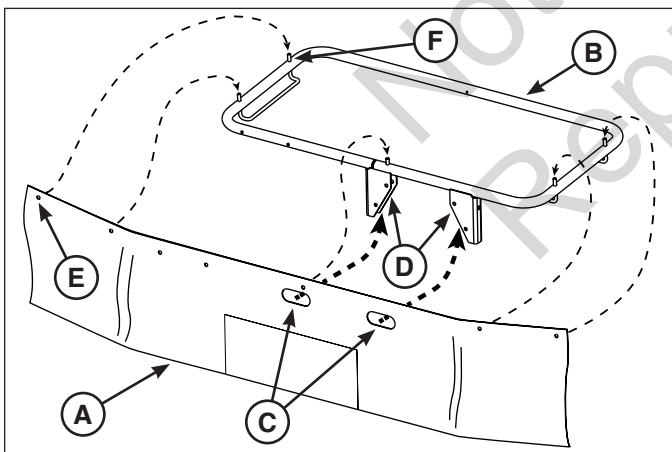

Figure 5

Cover Assembly

1. Place the cover (A, Figure 6) over the top of the grass catcher assembly (B), and insert the frame pegs (C) through the holes (D) in the cover.
2. Using a 1/2" socket wrench, secure the capped washer nuts (E) onto the frame pegs.

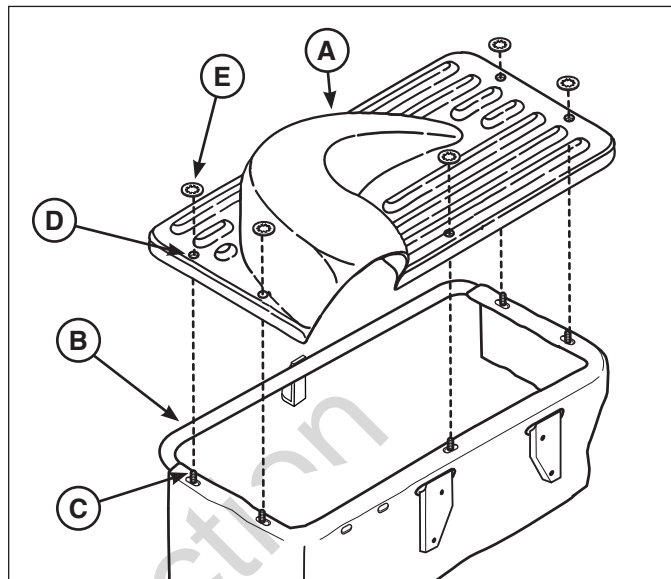

Figure 6

Heat Shield Installation

1. Determine the correct orientation of the heat shield for your particular model (Figure 7):
 - A - Manual drive models (muffler on right side of unit)
 - B - Hydro drive models (muffler on left side of unit)
 2. Align the top holes in the heat shield (C, Figure 8, manual drive orientation shown) with the top holes in the catcher frame brackets (D).
- NOTE:** Make sure the dust skirt (not shown) is moved back away from the frame brackets during installation. The dust skirt should be located behind the heat shield after installation.
3. Secure the heat shield to the catcher frame with two 5/16 x 1/2 hex bolts (E) and flange nuts (F). Tighten securely.

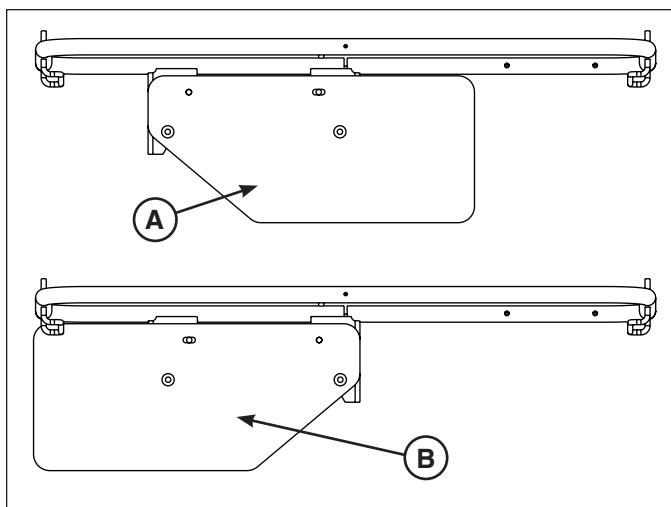

Figure 7 (Viewed from rear of catcher frame)

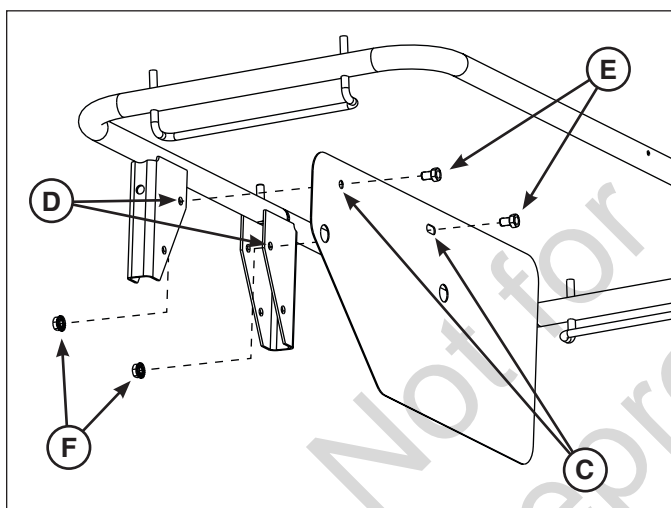

Figure 8 (Components removed for clarity)

Attach Cover / Frame Assembly to Rider

1. Install the bagger frame brackets (A, Figure 9) onto the rear bumpers (B).
2. Insert the clevis pins (C) through the bottom holes on each side of the bagger frame brackets, and secure with the hairpins (D).

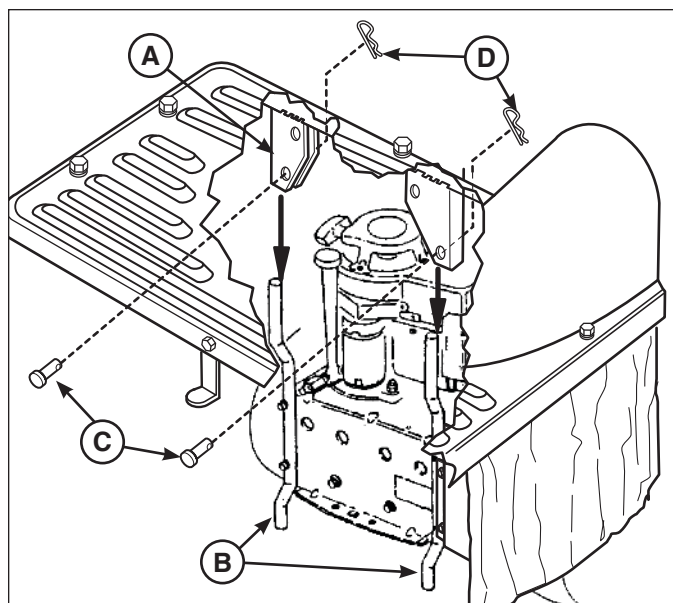

Figure 9 (Components removed for clarity)

Catcher Boot Assembly

1. Place the tube latch (A, Figure 10) onto the catcher boot (B) as shown.
2. Insert a 1/4 x 3/4" carriage bolt (C) through the mounting hole (D) and latch, and secure with an internal tooth lock washer (E) and hex nut (F). Tighten securely.

NOTE: On catcher boots with two mounting holes, install the tube latch to the innermost hole (hole closest to the rider) (D).

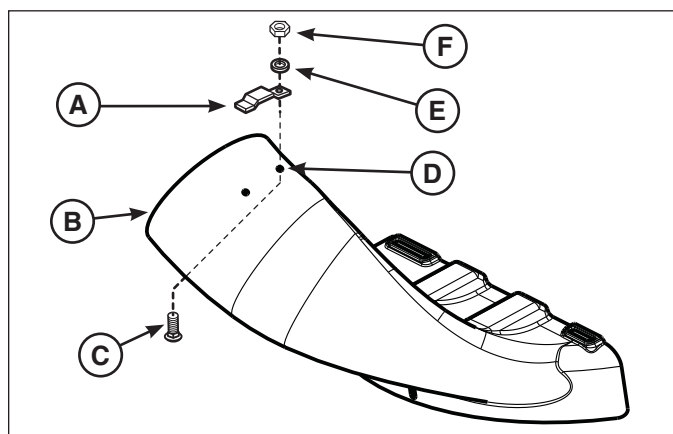

Figure 10

Assembly

Catcher Boot Installation

1. Raise the mulching cover. Refer to the Operator's Manual.
2. Install the 5/16 x 3/4" carriage bolt (A, Figure 11) out through the middle hole in the side of the deck, and secure with the 5/16" bolt retainer (B).

NOTE: Your rider may come with this hardware already installed.

3. Install the catcher boot (C) onto the mower deck, making sure the slots (D) in the boot fit securely onto the tabs on the mulching cover hinge (E).
4. Secure the bottom of the boot to the deck with a 5/16" flat washer (F) and 5/16" wing nut (G).

NOTE: If provided, use the securing hardware that came with your rider.

5. Insert one 5/16 x 1" carriage bolt (H) out through the front hole in the deck and catcher boot, and secure with a 5/16" flat washer and 5/16" wing nut. Tighten securely.
6. Lay the rear bracket (I, inset) against the rear of the catcher boot, and secure both to the deck with the remaining 5/16 x 1" carriage bolt, 5/16" flat washer, and 5/16" wing nut. Tighten securely.

NOTE: There are two holes (J, inset) in the rear of the catcher boot and the rear bracket. Be sure to use the one that corresponds with your deck.

7. Lower the mulching cover.

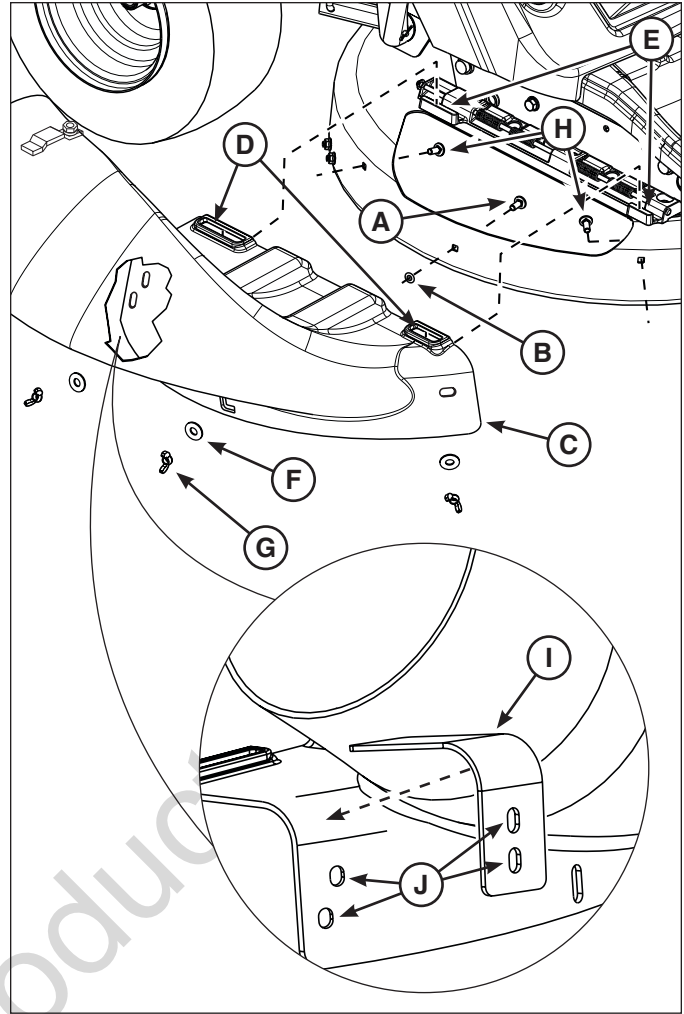

Figure 11 (Mulching cover not shown to provide clarity)

Catcher Tube Assembly

1. Insert the two remaining 1/4 x 3/4" carriage bolts (A, Figure 12) through the handle base (B), catcher tube (C) and handle (D).
2. Secure with the internal tooth lock washers (E) and hex nuts (F).

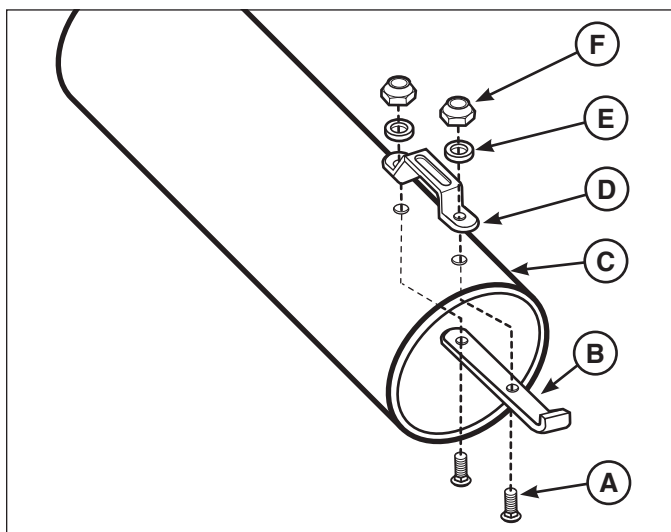

Figure 12

Catcher Tube Installation

1. Insert the catcher tube (A, Figure 13) into the opening of the grass catcher cover (B).

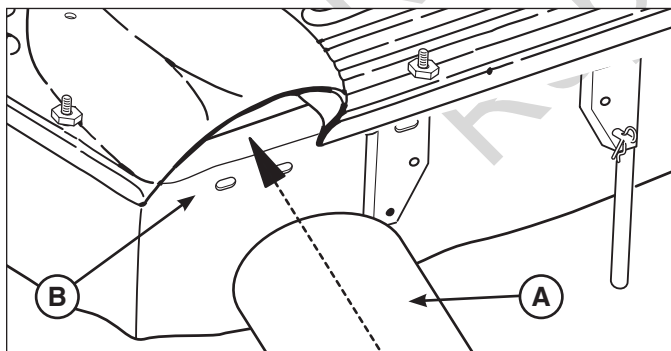

Figure 13

2. Slide the lower end of the catcher tube (C, Figure 14) over the end of the catcher boot (D).
3. Rotate the catcher tube towards the mower to secure the handle base (E) under the tube latch (F).

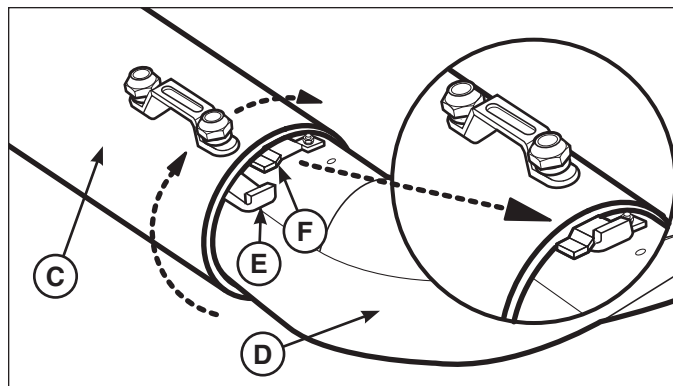

Figure 14

4. Place the debris shield (G, Figure 15) under the catcher tube (H) with the offset hole pattern towards the center of the rider as shown.

NOTE: If there are no holes in the dust skirt for mounting the debris shield, CAREFULLY punch two holes to accommodate the shield.

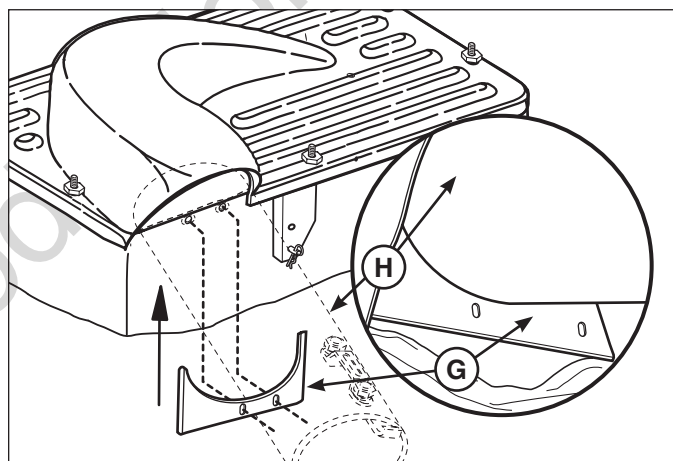

Figure 15

Assembly

5. Insert the two 1/4 x 1-1/2 bolts (I, Figure 16) through the 1/4" flat washers (J), debris shield (K), dust skirt, and catcher frame.

NOTE: The debris shield needs to be positioned close enough to the catcher tube to prevent any gap between the tube and shield, but without squeezing the catcher tube.

6. Secure the debris shield with the tapered lock nuts (L).

Note: The catcher tube must slide freely between the catcher and debris shield. If the tube does not slide freely, loosen the hardware and adjust the debris shield.

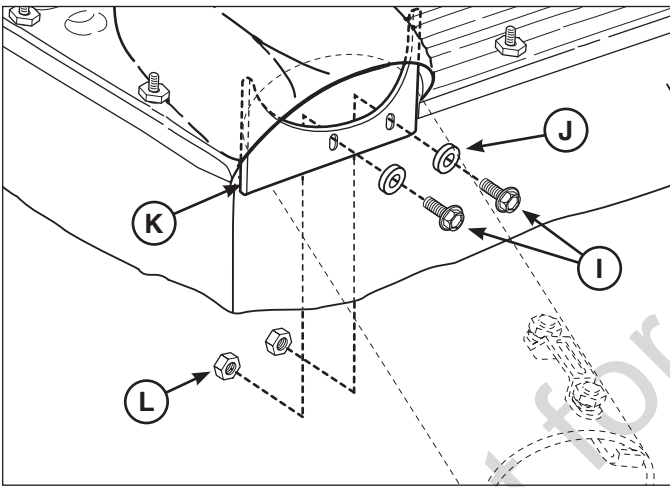

Figure 16

Final Assembly

1. Rotate the latch (A, Figure 17) on the catcher frame (B) up to a horizontal position.
2. Slide the grass bag assembly (C) into the brackets (D) on the underside of the catcher frame.

NOTE: The mesh side of the catcher bag should face away from the rider.

3. Rotate the latch down to lock the bag in place.

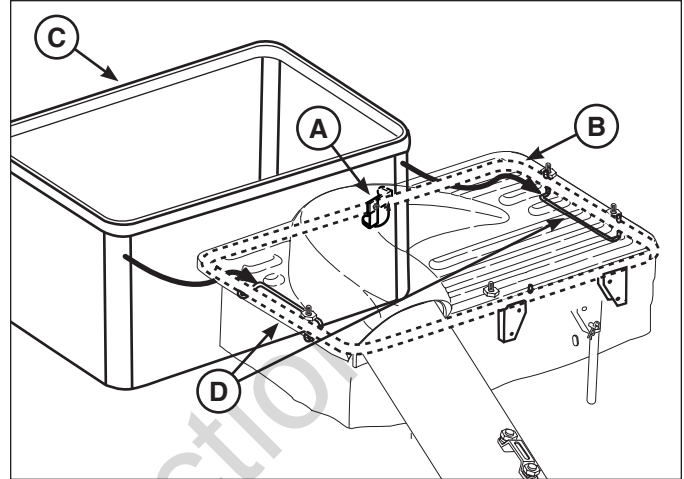

Figure 17

Before Operation

Clear the lawn of all sticks, stones, wire and other debris which may be caught or thrown by the mower blades.

Check grass condition. If wet, wait until later in the day. If grass is wet, the grass catcher is likely to become plugged.

For efficient bagging, air circulation under the mower deck, through the catcher components, and into the catcher bag is very important.

For this reason, **BEFORE YOU BEGIN MOWING**, make sure the underside of the mower deck as well as the inside of the catcher components are free from grass and debris.

Make sure that there is a snug fit between mower deck, catcher boot, catcher tube, and grass catcher.

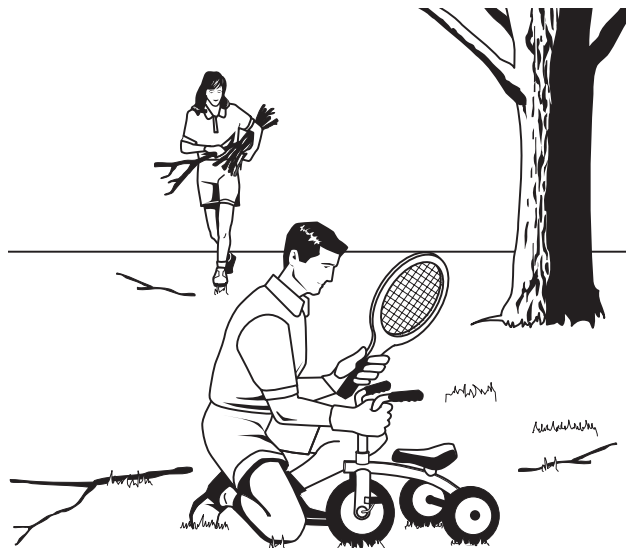

CAUTION: Before you begin operating the unit be certain you have read all of the safety and operational information of this instruction sheet, as well as the Operator's Manual for the rider and any other attachments.

NOTE: Never operate on slopes greater than 17.6% (10°).

Mowing with the Catcher

Always operate with throttle at full speed when mowing.

Grass should be cut often, and not too short. If grass is too long or lush it may be necessary to keep ground speed to a minimum or to cut only half the width of the mower to prevent clogging. If grass is long, operate with mower in high cutting position for first pass, cutting again in a lower position on a second pass.

Do not open the cover with mower engaged.

If a large amount of cut grass is spilling out from under deck, the tube may be plugged or the bag may be full—discontinue mowing, stop the unit, disengage the blade, shut off the engine and then empty the catcher or clear the tube.



WARNING: ALWAYS shut off the rider.

Disengage the blade, and allow all moving parts to stop **BEFORE** disconnecting or clearing tube, or emptying catcher.

Before leaving the operator's position for any reason, engage the parking brake, disengage the blade, stop the engine and remove the key.

To reduce fire hazard, keep the engine, rider and mower free of grass, leaves and excess grease. Do not stop or park rider over dry leaves, grass or combustible materials.

After Operation

Remove any debris from the underside of the catcher cover.

The catcher boot and catcher tube should be removed for cleaning.

Inspect the grass bag for wear or damage. Make sure that there is a snug fit between mower deck, blower housing, tubes, and grass catcher cover.



CAUTION: Do not leave grass in the catcher bag. Empty the bag after each use and before storing. Failure to do so may result in spontaneous combustion which could develop into a fire.

LIMITED WARRANTY

Briggs & Stratton warrants that, during the warranty period specified below, it will repair or replace, free of charge, any part that is defective in material or workmanship or both. Transportation charges on product submitted for repair or replacement under this warranty must be borne by purchaser. This warranty is effective for and is subject to the time periods and conditions stated below. For warranty service, find the nearest Authorized Service Dealer in our dealer locator map at www.BriggsandStratton.com. The purchaser must contact the Authorized Service Dealer, and then make the product available to the Authorized Service Dealer for inspection and testing.

There is no other express warranty. Implied warranties, including those of merchantability and fitness for a particular purpose, are limited to one year from purchase, or to the extent permitted by law. All other implied warranties are excluded. Liability for incidental or consequential damages are excluded to the extent exclusion is permitted by law. Some states or countries do not allow limitations on how long an implied warranty lasts, and some states or countries do not allow the exclusion or limitation of incidental or consequential damages, so the above limitation and exclusion may not apply to you. This warranty gives you specific legal rights and you may also have other rights which vary from state to state or country to country.**

WARRANTY PERIOD

Item	Consumer Use	Commercial Use
Equipment	1 year	0

** In Australia - Our goods come with guarantees that cannot be excluded under the Australian Consumer Law. You are entitled to a replacement or refund for a major failure and for compensation for any other reasonably foreseeable loss or damage. You are also entitled to have the goods repaired or replaced if the goods fail to be of acceptable quality and the failure does not amount to a major failure. For warranty service, find the nearest Authorized Service Dealer in our dealer locator map at BRIGGSandSTRATTON.COM, or by calling 1300 274 447, or by emailing or writing to salesenquires@briggsandstratton.com.au, Briggs & Stratton Australia Pty Ltd, 1 Moorebank Avenue, NSW, Australia, 2170.

The warranty period begins on the date of purchase by the first retail consumer or commercial end user, and continues for the period of time stated in the table above. "Consumer use" means personal residential household use by a retail consumer. "Commercial use" means all other uses, including use for commercial, income producing or rental purposes. Once a product has experienced commercial use, it shall thereafter be considered as a commercial use product for purposes of this warranty.

No warranty registration is necessary to obtain warranty on Briggs & Stratton products. Save your proof of purchase receipt. If you do not provide proof of the initial purchase date at the time warranty service is requested, the manufacturing date of the product will be used to determine the warranty period.

ABOUT YOUR WARRANTY

We welcome warranty repair and apologize to you for being inconvenienced. Warranty service is available only through Briggs & Stratton Authorized Service Dealers. Most warranty repairs are handled routinely, but sometimes requests for warranty service may not be appropriate. This warranty only covers defects in materials or workmanship. It does not cover damage caused by improper use or abuse, improper maintenance or repair, or normal wear and tear.

Improper Use and Abuse - The proper, intended use of this product is described in the Operator's Manual. Using the product in a way not described in the Operator's Manual or using the product after it has been damaged will void your warranty. Warranty is not allowed if the serial number on the product has been removed or the product has been altered or modified in any way, or if the product has evidence of abuse such as impact damage, or water/chemical corrosion damage.

Improper Maintenance or Repair - This product must be maintained according to the procedures and schedules provided in the Operator's Manual, and serviced or repaired using genuine Briggs & Stratton parts or equivalent. Damage caused by lack of maintenance or use of non-original parts is not covered by warranty.

Normal Wear - Like all mechanical devices, your unit is subject to wear even when properly maintained. This warranty does not cover repairs when normal use has exhausted the life of a part or the equipment. Maintenance and wear items such as filters, belts, cutting blades, and brake pads (except engine brake pads) are not covered by warranty due to wear characteristics alone, unless the cause is due to defects in material or workmanship.

Other Exclusions - This warranty excludes damage due to accident, abuse, modifications, alterations, improper servicing, freezing or chemical deterioration. Attachments or accessories that were not originally packaged with the product are also excluded. This warranty also excludes failures due to acts of God and other force majeure events beyond the manufacturer's control.

Not for
Reproduction

Parts List

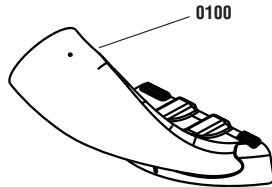
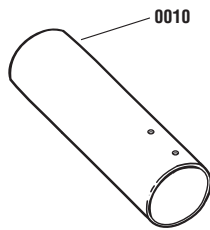
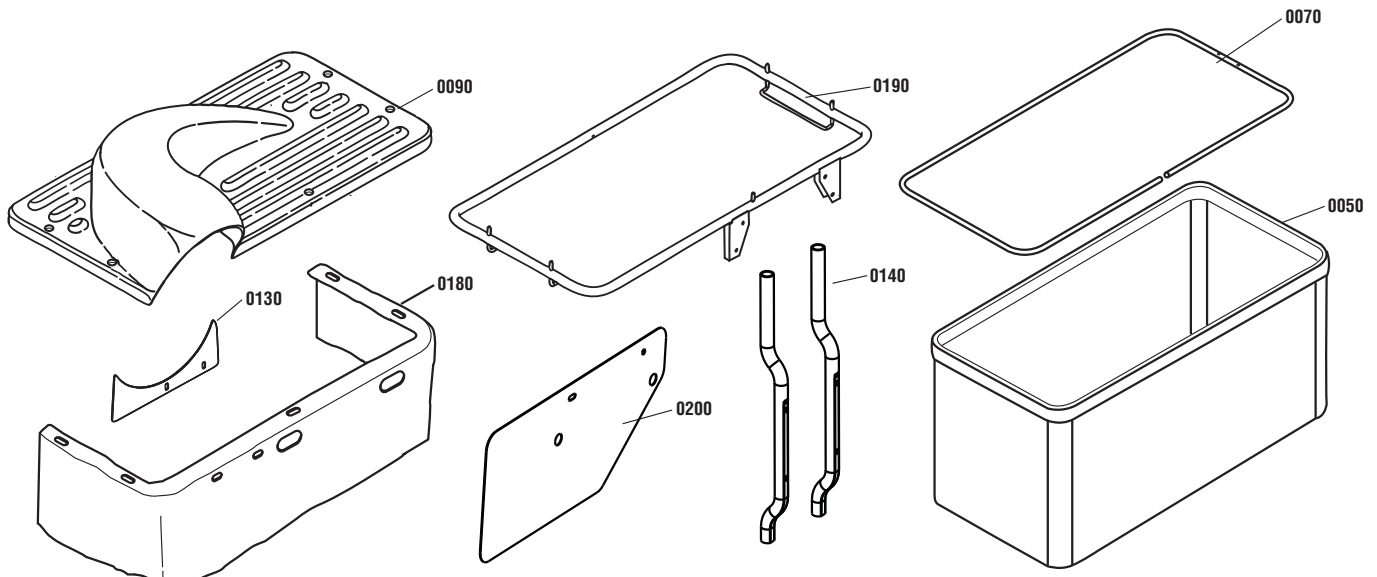

0100-0020

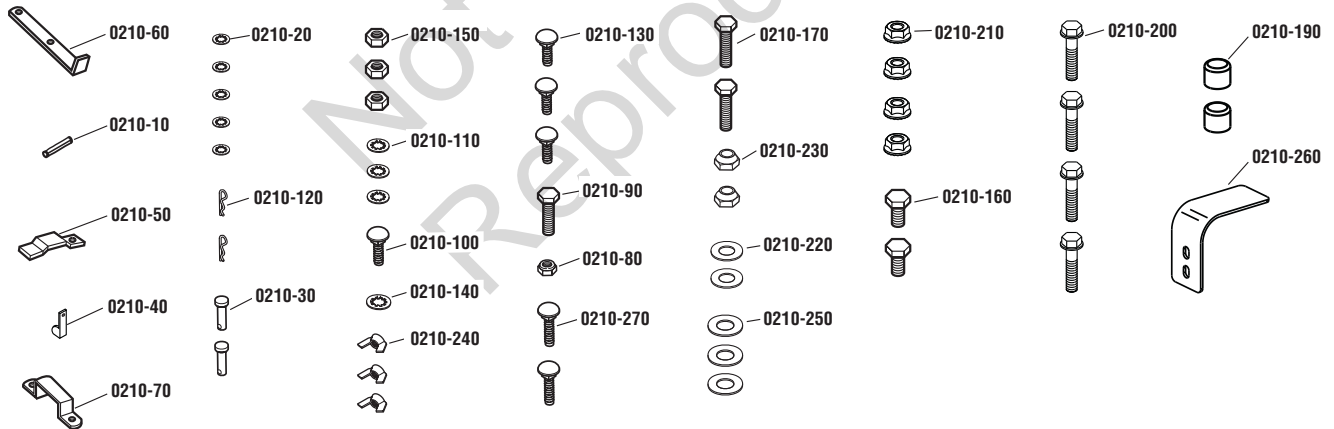

Kit Contents:

Item	Number	Object Description	Quantity
0010	7027915YP	CATCHER TUBE, Single Bagger	1
0050	7019251YP	GRASS BAG, Single Bagger	1
0070	7037758YP	ROD, Bag	1
0090	7104012YP	CATCHER COVER, Top	1
0100	7503112YP	CATCHER BOOT ASSEMBLY, Bagger	1
0100-0020	7046720SM	DECAL, Warning - Chute/Deflector (on Catcher Boot)	1
0130	7063287YP	SHIELD, Debris	1
0140	7030798YP	BUMPER, Rear	2
0180	7106050YP	SKIRT, Dust	1
0190	7400336YP	FRAME, Catcher	1
0200	7301376YP	SHIELD, Heat	1
0210	7503113YP	HARDWARE BAG *	1

*** Hardware Bag Contents:**

0210-10	7012556YP	CONNECTOR, 1/2 x 3	1
0210-20	7029840YP	NUT, Washer, Capped, 5/16	5
0210-30	7029841YP	CLEVIS PIN, 5/16 x 1-11/16	2
0210-40	7031725YP	LATCH, Catcher	1
0210-50	7031951YP	LATCH, Tube	1
0210-60	7031952YP	BASE, Tube Handle	1
0210-70	7037745YP	HANDLE, Tube	1
0210-80	7090376YP	NUT, Hex, Locking, #10	1
0210-90	7090532YP	SCREW, Hex Head Machine, #10 x 1-3/8, G2	1
0210-100	80004072YP	BOLT, Carriage, 5/16 x 3/4, GR5	1
0210-110	80004414YP	WASHER, 1/4, Internal Tooth Lock	3
0210-120	80002737YP	HAIRPIN, 3/32 x 1-5/8	2
0210-130	80003579YP	BOLT, Carriage, 1/4 x 3/4, GR5	3
0210-140	80002734YP	RETAINER, 5/16, GR5	1
0210-150	80003586YP	NUT, Hex, 1/4, GR5	3
0210-160	7090534YP	BOLT, Hex Head, 5/16 x 1/2, GR5	2
0210-170	80002713YP	BOLT, Hex Head, 1/4 x 1-1/2, GR5	2
0210-190	7010153YP	CAP, Bumper	2
0210-200	7091506YP	BOLT, Hex Washer Head, Self-Tapping, 5/16 x 1-1/2	4
0210-210	80002728YP	NUT, Flange, 5/16, GR5	2
0210-220	80002742YP	WASHER, Flat, 1/4	2
0210-230	7091705SM	NUT, Hex, Locking, Tapered, 1/4	2
0210-240	7024085YP	WINGNUT, Nylon Insert, 5/16	3
0210-250	703298	WASHER, Flat, 5/16	3
0210-260	7301385BMYP	BRACKET, Rear	1
0210-270	7091903YP	BOLT, Carriage, 5/16 x 1, GR5	2

Not for
Reproduction

Copyright © 2013 Briggs & Stratton Power Products Group, LLC
Milwaukee, WI USA. All Rights Reserved

BRIGGS & STRATTON POWER PRODUCTS
is a registered trademark of Briggs & Stratton Corporation.