

INSTALLATION INSTRUCTIONS

MODEL 750896 VISUAL LIQUID STRAINER

Please read these instructions carefully. Failure to comply to instructions and designed operation of this system, may void the warranty.

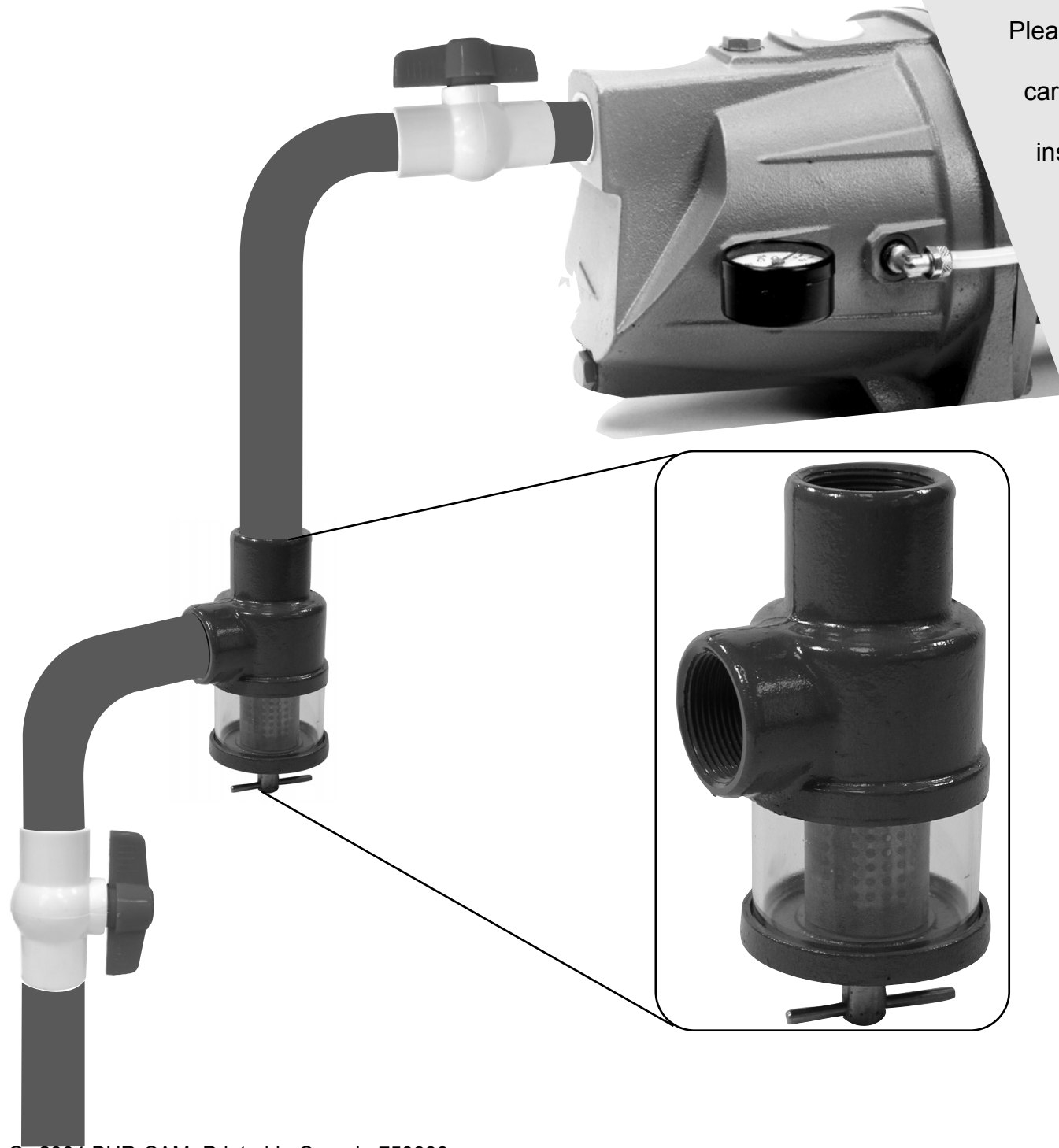

IMPORTANT NOTICE

HERE ARE SOME THINGS YOU SHOULD KNOW ABOUT YOUR NEW VISUAL LIQUID STRAINER

The VLS will stop sand and grit over 170 microns from getting in your critical valves and pump parts, etc.
If the clear sleeve of the VLS gets dirty, and you can't see the screen, take the VLS apart and clean well. You want to be able to see the screen.
If you find that you have to empty the VLS quite often, you may want to put 2 units in parallel.
If you put in 2 units with shutoff valves, you can clean one while the other keeps working.
If you accidentally damage the screen beyond repair, you can operate the VLS without a screen while waiting for a replacement.

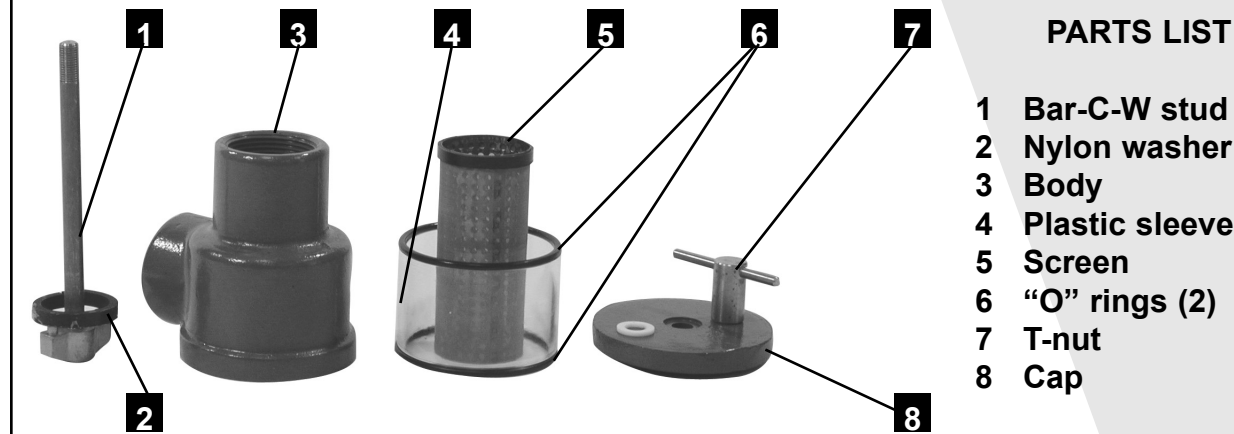

PARTS LIST

- 1 Bar-C-W stud
- 2 Nylon washer
- 3 Body
- 4 Plastic sleeve
- 5 Screen
- 6 "O" rings (2)
- 7 T-nut
- 8 Cap

INSTALLATION STEPS

Your VLS comes with 1 1/4" iron pipe thread "in and out". Some of the ways it can be adapted for other sizes are shown below.

- OPTION 1** 1/2 inch copper pipe parts needed.
- 1- 1/2" union copper to copper
 - 2- 1/2" male adapter copper MIP
 - 3- Galvanized bushing 1/2" X 1 1/4".

- OPTION 2** 1 inch plastic pipe. *NOTE Support is needed for VLS when plastic pipe used in and out.*
- 1- Male adapter 1"
 - 2- Galvanized bushing 1 X 1 1/4".

- OPTION 3** 1 inch plastic pipe with shutoff valve.
- 1- Male adapter 1"
 - 2- Globe valve 1"
 - 3- 1 inch IPS galvanized nipple. length as needed.
 - 4- Bushing 1 X 1 1/4".

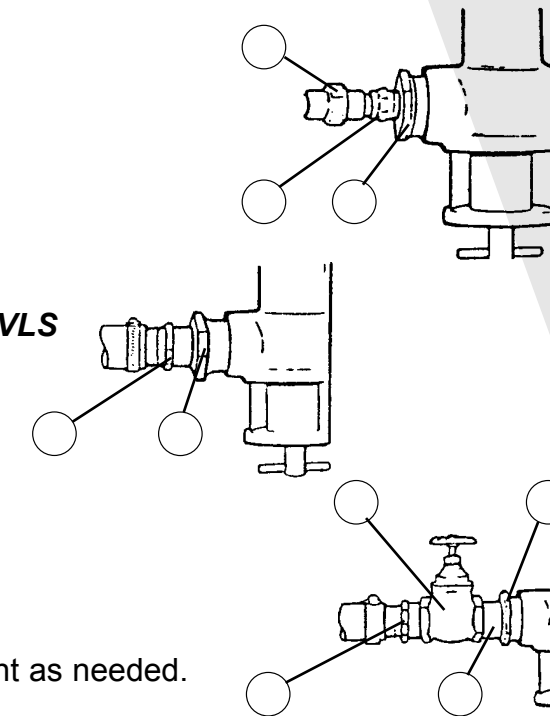

CLEANING INSTRUCTIONS

DISASSEMBLY

- STEP 1** Remove T-nut completely. If the VLS has not been cleaned for some time, it may be necessary to use a wrench.
- STEP 2** Twist the bottom cap back and forth to loosen.
- STEP 3** Remove bottom cap, sleeve and screen - straight down, - if possible, to avoid damage to screen. Then clean thoroughly. Make sure O-rings and gooves are cleaned and that O-rings are undamaged.

NOTE:
If VLS leaks around the sleeve joint, disassemble and check O-rings for damage or dirt as in step 3.

REASSEMBLY

- STEP 4** Carefully adjust screen in bottom cap. Check that the rubber seal on the free end is properly in place.
- STEP 5** Put the clear sleeve in place on the bottom cap. Rotate a little to seat on O-ring gasket.
- STEP 6** Carefully replace screen, sleeve and bottom cap on main body. CAUTION: Be careful not to damage screen against the stud. Make sure the screen is properly seated in the upper body. DO NOT FORCE.
- STEP 7** Hold cap, sleeve and screen in place with one hand. With the other, thread the T-nut on for 2 or 3 threads.
- STEP 8** Make sure the screen is properly seated in the cap. Then rotate the cap back forth until it feels "solid". Gently snug up the T-nut. Rotate the cap back and forth about 1/4 turn to be sure all is seated. Tighten T-nut about 1/4 turn. repeat until cap will no longer turn. Tighten T-nut.

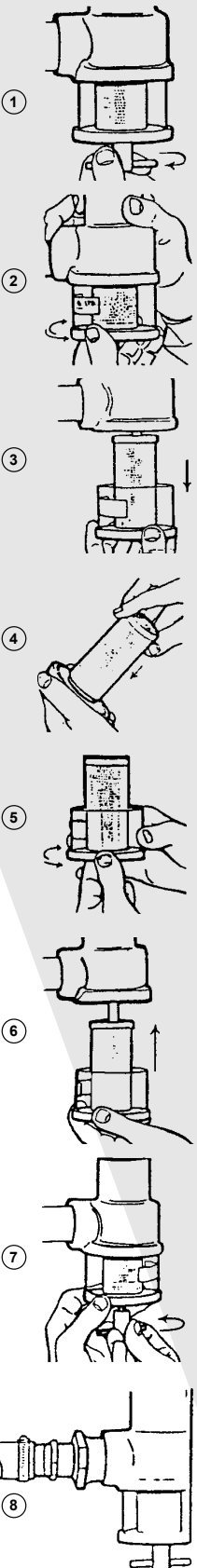

Service parts kits

Description:
O-ring set
Screen
Plastic sleeve
c-w O-rings

Specifications

Max. Press.: 100 PSI
Max. Temp.: 130°F (55°C)
Max. Vacuum: 30 in
Screen Mesh: 60
Screen Material: Brass
Thread Size: 1 1/4 in IPS
Body Material: Cast iron

