

Instruction Sheet

Kit Number: 72101800

TRACK CONVERSION KIT

For All Wheel-Drive 921000 Models



WARNING: FAILURE TO FOLLOW INSTRUCTIONS could result in personal injury and/or damage to unit.

Read, understand, and follow all safety practices in Owner/Operator Manual before beginning.

SPECIAL TOOLS REQUIRED

- 1/8" (3mm) and 9/32" (7mm) Drill bits
- Drill
- Anti-seize compound, or waterproof grease
- 3/8", 7/16", 1/2" and 9/16" Combination wrenches or adjustable wrenches.
- #2 Phillips screwdriver

NOTE: Right and Left are used in these instructions from the operators perspective.

Package Contents

Check contents of kit for parts listed in chart below and shown in Figure 1:

Item	Ariens P/N	Description	Qty
1	72101900	Deluxe Track Speed-Up Kit (N/S)	1
2	52105500	Deluxe Track Carriage Assembly	1
3	03291500	Track Drive Axle	1
4	05500122	Bushing, Sleeve 1.012 x 1.125 x 1	3
5	00371000	Gear, Spur	1
6	06601200	Key, Woodruff	1
7	05800300	Pin, Roll .188 x 1.25	1
8	06436300	Washer, Steel Flat	2
9	06600002	Key, Rectangle	2
10	05700001	Clip, Snap	2
11	06220100	Bolt, 1/4-20 x 1.25 Round Head Extra Long Square Neck	1
12	03389051	Plate, Bearing Spacer	2
13	05400706	Bearing, Flange	2
14	05946800	Bolt, 1/4-20 x .75 Hex	6
15	06543500	Nut, 1/4-20 Top Lock Flange	11
16	06219900	Bolt, 1/4-20 x .75 Round Head Square Neck	4
17	06534800	Nut, 3/8-16 Center Lock Flange	2
18	04520000	Wheel, Cast Drive	2
19	00669700	Track, Rubber	2
20	04568300	Template, Deluxe Track Conversion Drill	1
21	06305200	Internal Locking Washer	1
22	06100007	Oval Head Machine Screw	1

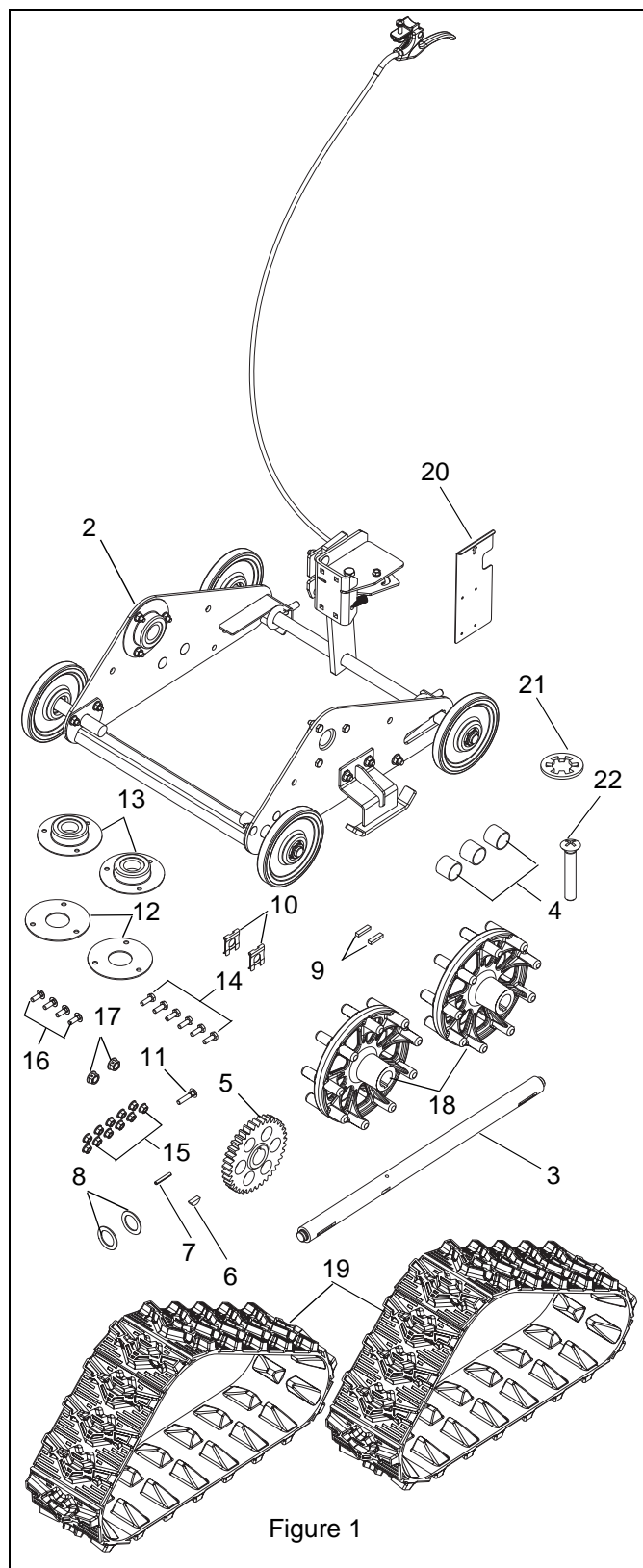

Figure 1

INSTALLATION

WARNING: Before tipping unit up onto housing, remove fuel so no spills will occur. Ensure unit is secure and will not tip over during service procedure.

1. Place unit on a flat level surface. Tip unit forward onto front of auger housing into service position. Ensure unit is secure and will not tip over. Strap and clamp onto bench if needed. See Figure 2.

NOTE: Retain all removed parts and attachment hardware should unit need to be converted back in the future.

2. Remove wheel snap clips or pins and remove wheels from both sides. Remove any keys from axles.

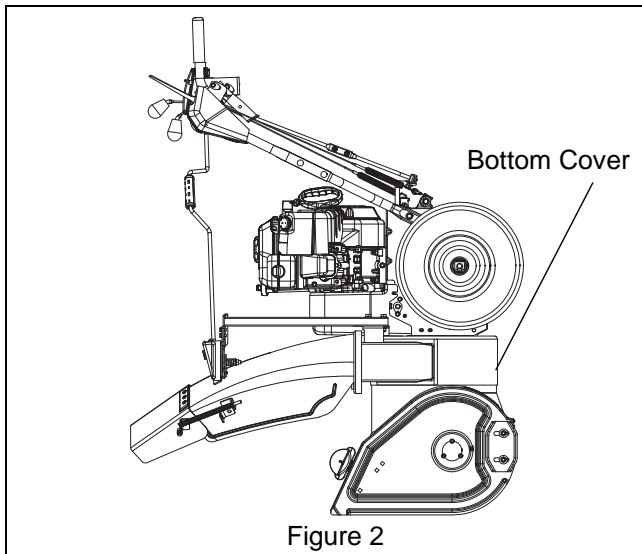

Figure 2

3. Remove six bolts retaining bottom cover and remove cover. See Figure 2.
4. If the unit is equipped with a remote locking differential or remote wheel lock, disconnect cable from unit. Remove remote trigger from left handlebar. Install 1/4" round head square neck bolt (item 11) and hex nut (item 15) in trigger mount location. See Figure 3.

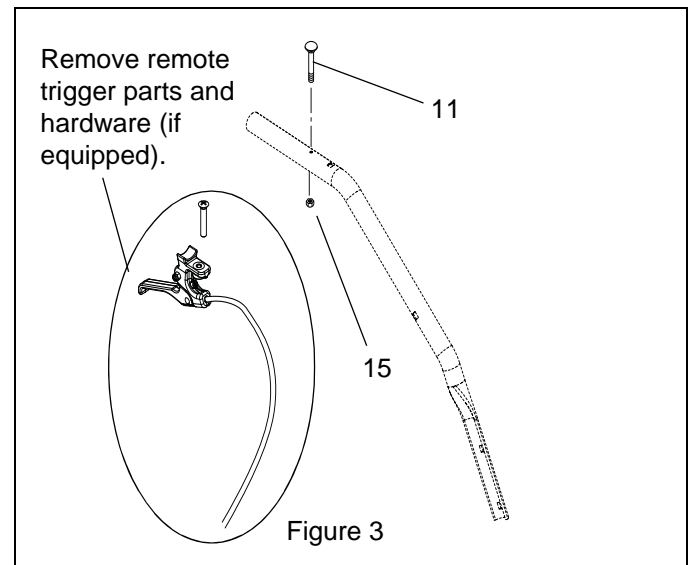

Figure 3

5. Remove clicker cable mount bracket by removing two tapping screws. See Figure 4.

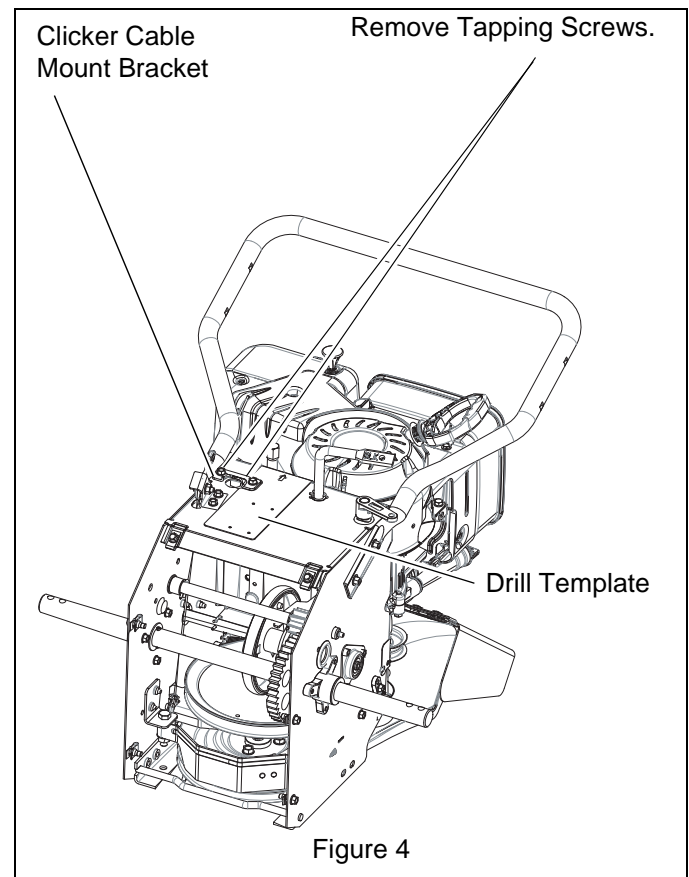
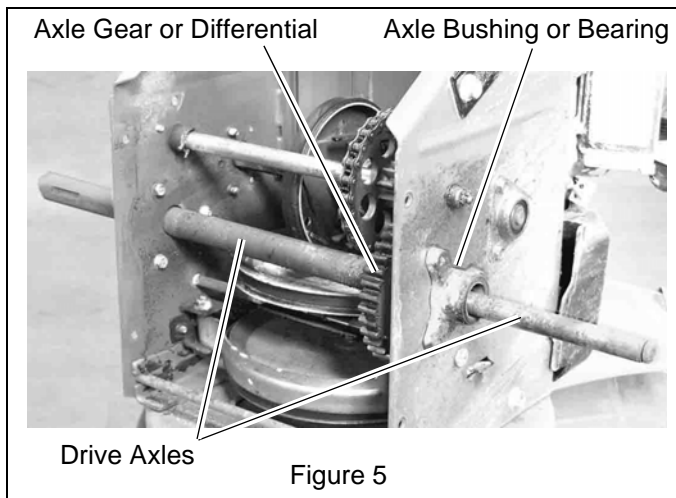

Figure 4

6. Remove drive axle(s) and axle gear, or differential.

NOTE: There may be additional components on axles of some models preventing its removal. Remove any additional axle components as needed. See Figure 5.

7. Remove bolts holding axle bushings or bearings and remove bushings or bearings from both sides. See Figure 5.



NOTE: Some units will not have holes to mount height adjuster bracket and will need to be drilled. See Figure 6 for location of four holes on back of frame. If the frame has holes to mount the bracket, proceed to step 9.

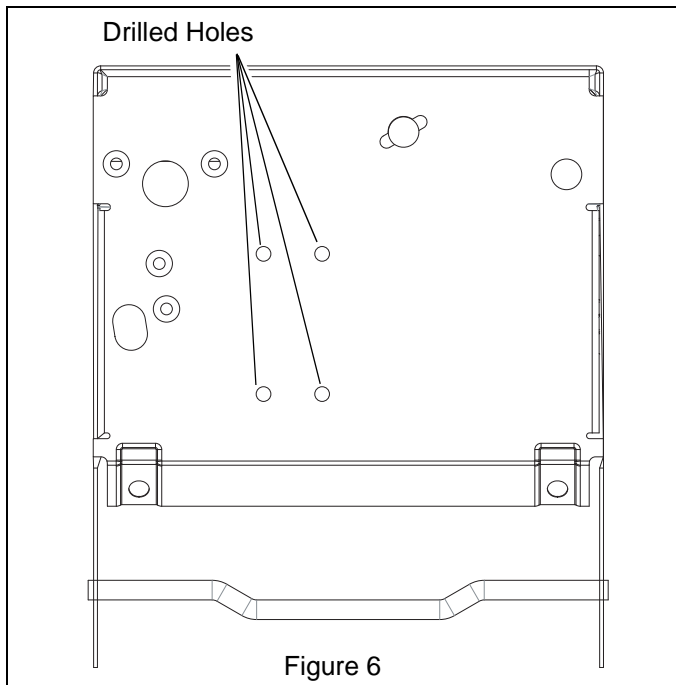

8. Position hole drilling template (item 20) on back of frame. Slide template left until it contacts cable pulley bracket. See Figure 7.

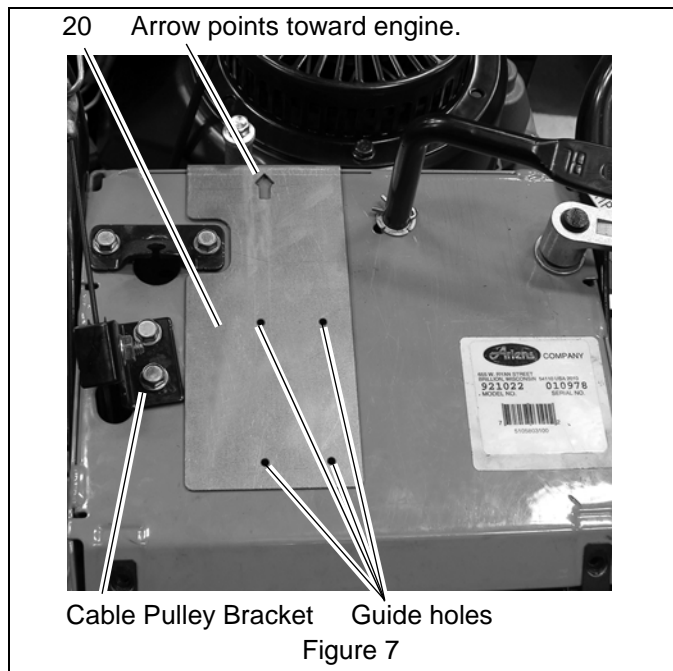

9. Using template to locate hole locations, drill four 1/8" (3mm) pilot holes. Remove template and finish drilling holes with 9/32" (7mm) drill. Remove burrs from holes. Make sure that arrow on template points toward engine.

10. Mount bearing spacer plates (item 12) and flange bearings (item 13) with 1/4" x 3/4" hex bolts (item 14) and 1/4" locking top flange nuts (item 15). Spacer plates are mounted between flange bearings (item 13) and frame. Install head of hex bolt from inside of unit. See Figure 8.

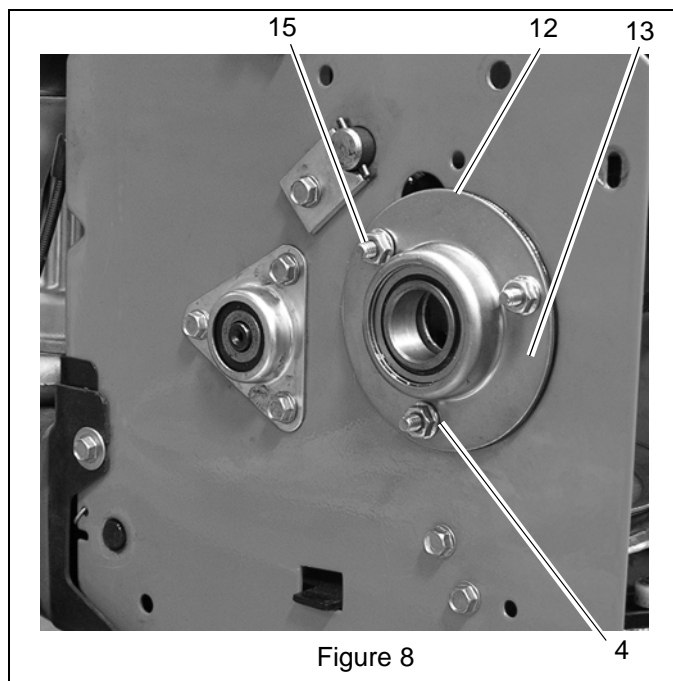

11. Perform steps 7 – 11 on page 2 from included 72101900 Deluxe Track Speed-Up Kit (See 04568400 instructions).

12. Perform steps 1 – 8 on pages 3 and 4 from included 72101900 Deluxe Track Speed-Up Kit (See 04568400 instructions).
13. Lift carriage assembly (item 2) into position around frame with adjustable axle toward rear of unit. Align bearings on frame to bearings on track carriage and and insert track drive axle (item 3) into left side of track carriage (item 2), spacer (item 4), and into flange bearing (item 13) so that carriage assembly is supported on left side. See Figure 9 and Figure 10.

NOTE: It will be necessary to move trigger lock mechanism out of the way while attaching carriage. See Figure 20.

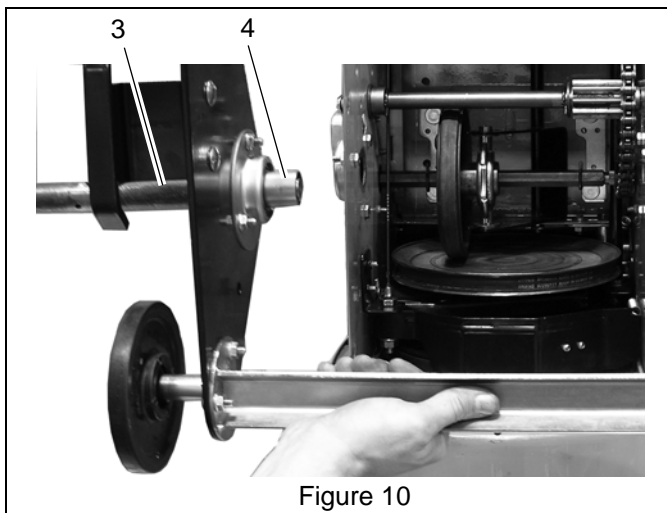
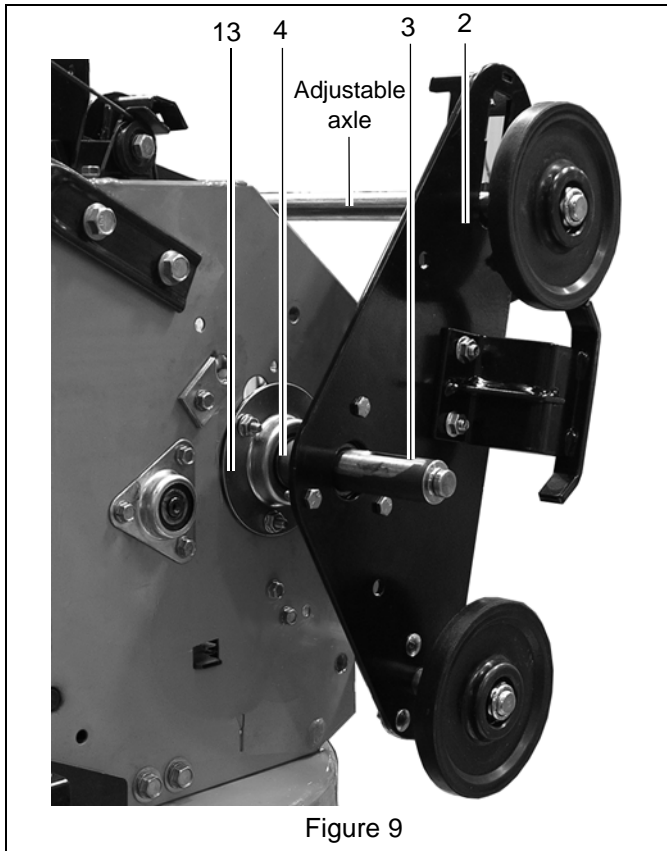

14. Install spur gear (item 5) onto track drive axle (item 3) followed by spacer (item 4). See Figure 11.

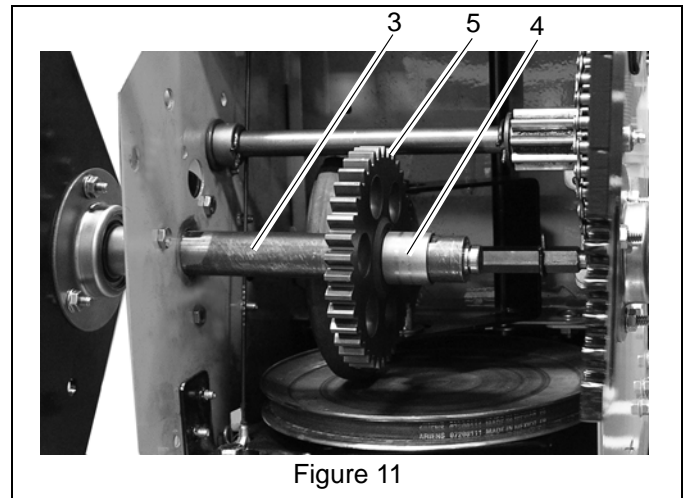

15. Slide track drive axle (item 3) through flange bearing (item 13) attached to right side of frame. Install spacer (item 4) between frame flange bearing (item 13) and track carriage assembly (item 2). Slide track drive axle (item 3) through track carriage assembly so that it is now fully supported. See Figure 12.
16. Install woodruff key (item 6) into groove in track drive axle (item 3). Align spur gear (item 5) key slot with installed woodruff key (item 6) and slide into place. See Figure 12.
17. Install roll pin (item 7) into track drive axle (item 3), locking spur gear (item 5) into place. Make sure roll pin (item 7) is centered in track drive shaft (item 3) and will not easily fall out. See Figure 12.

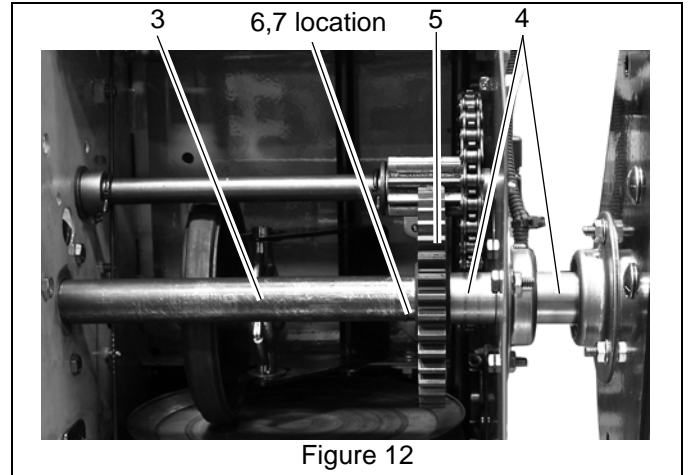

18. Install flat steel washer (item 8) onto track drive axle (item 3) followed by rectangle key (item 9). Repeat on other side of unit. See Figure 13.

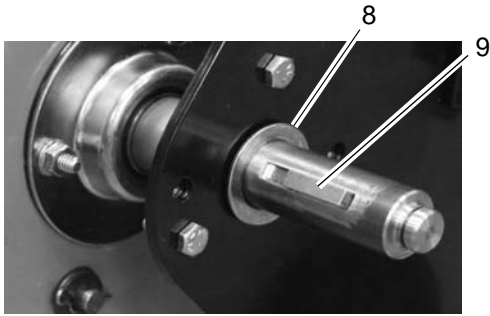

Figure 13

19. Apply anti-seize compound or waterproof grease to track drive axle ends (item 3).
20. Install cast drive wheels (item 18) onto shaft ends and secure with snap clips (item 10). See Figure 14.

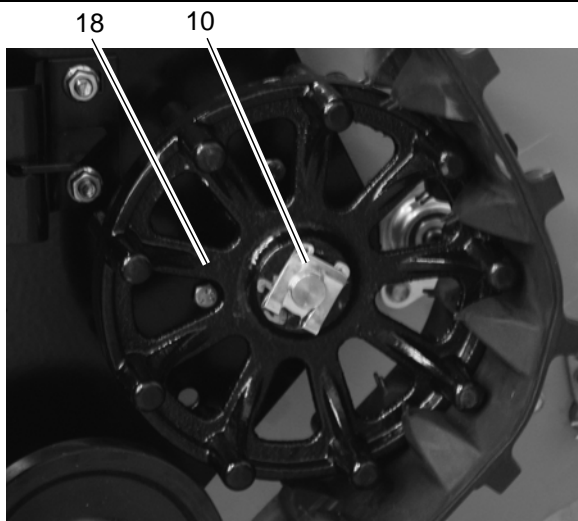

Figure 14

21. Rotate trigger lock assembly up to meet back of frame. Align holes drilled in step 8 to holes on bracket. Install head of 1/4" x 3/4" round head square neck bolts (item 16) through holes in height adjuster bracket, and through drilled holes from exterior of unit. Install 1/4" flange nut (item 15) onto all four bolts. See Figure 15.

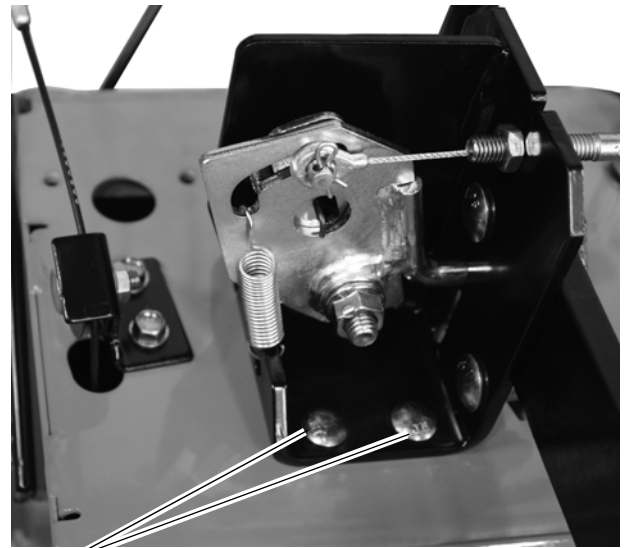

Figure 15

22. Remove nut and bolt located in handlebar on right side of machine. See Figure 16.



Figure 16

23. Position trigger beneath right side of handlebar. Insert 1/4" machine screw (item 22) through 1/4" internal locking washer (item 21). Insert 1/4" machine screw (item 22) through handlebar in place of bolt removed in Step 21. Thread screw (item 22) into trigger to attach it to machine. See Figure 17.

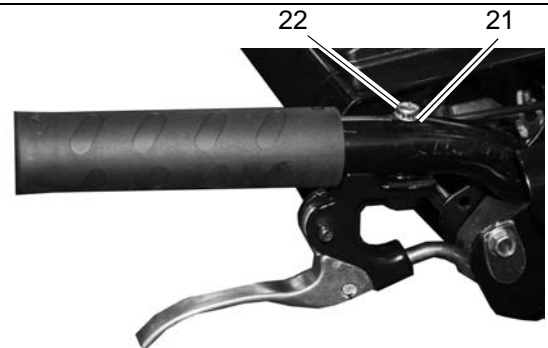
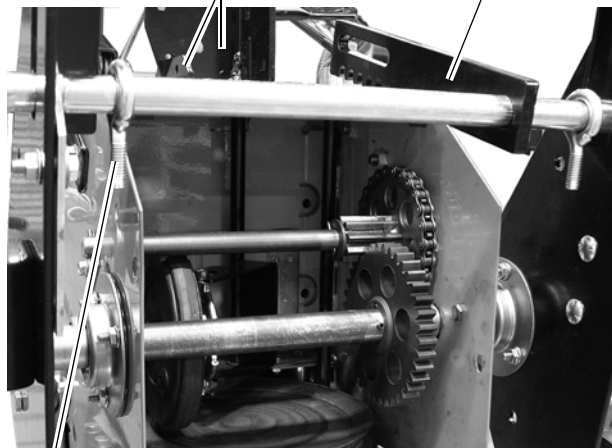

Figure 17

NOTE: It is necessary to first loosen height adjuster stop from height adjuster bracket and remove tension adjuster nuts from eye bolts on rear axle to install tracks. See Figure 18.

Height Adjuster Bracket Height Adjuster Stop



Eye Bolt

Figure 18

24. Position track (item 19) so tread lugs point in direction shown and install onto track carriage assembly. Install track on front idler and cast drive wheel (item 18) first and then over rear idler. Repeat on other side of unit. See Figure 19.



Front Idler

Figure 19

25. With assistance from a helper or lifting device, pull up (back) on rear idler axle until eye bolts can be inserted into mounts on track carriage assembly. See Figure 20.

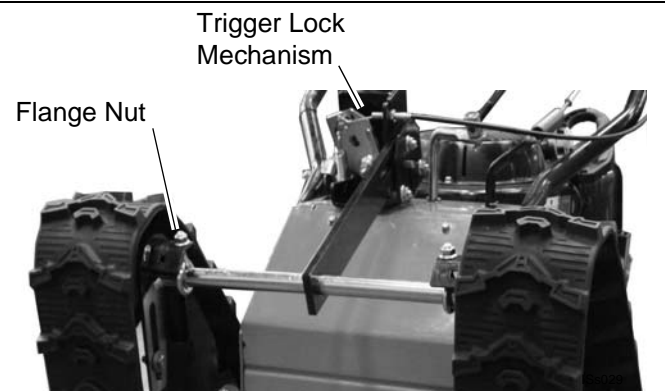

Trigger Lock Mechanism

Flange Nut

Figure 20

26. Install tension adjuster nuts on eye bolts. See Figure 18 and *Track Tension Adjustment* on page 7.
27. Apply grease to gears. See Figure 21. Lubricate other normal maintenance items if desired. See *Owners Manual*.

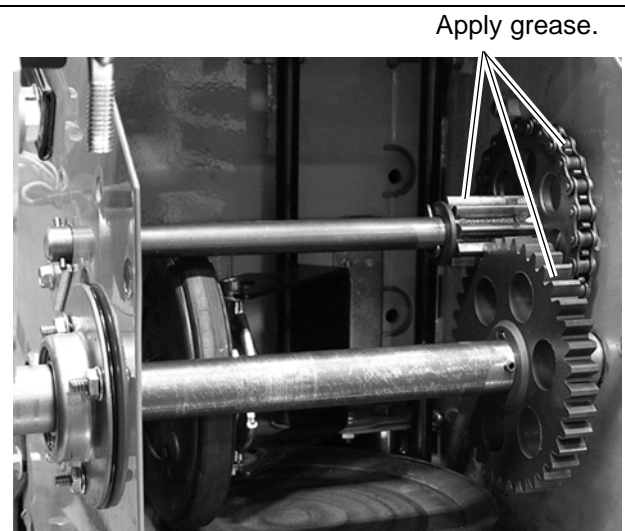

Apply grease.

Figure 21

28. Install bottom cover removed in step 3.
29. Return unit to operating position. See *Operation* on page 7.
30. Perform steps 14 – 30 on pages 4 and 5 from included 72101900 Deluxe Track Speed-Up Kit (See 04568400 instructions).

OPERATION

Track Angle

(Figure 22)

The track angle can be adjusted to position auger housing for level clearing, deep cutting or transport.

Squeeze trigger and press down on handlebars to move auger housing into transport position. Release trigger to lock in place.

Squeeze trigger and lift up on handlebars to move auger housing into deep cutting position. Release trigger to lock in place.

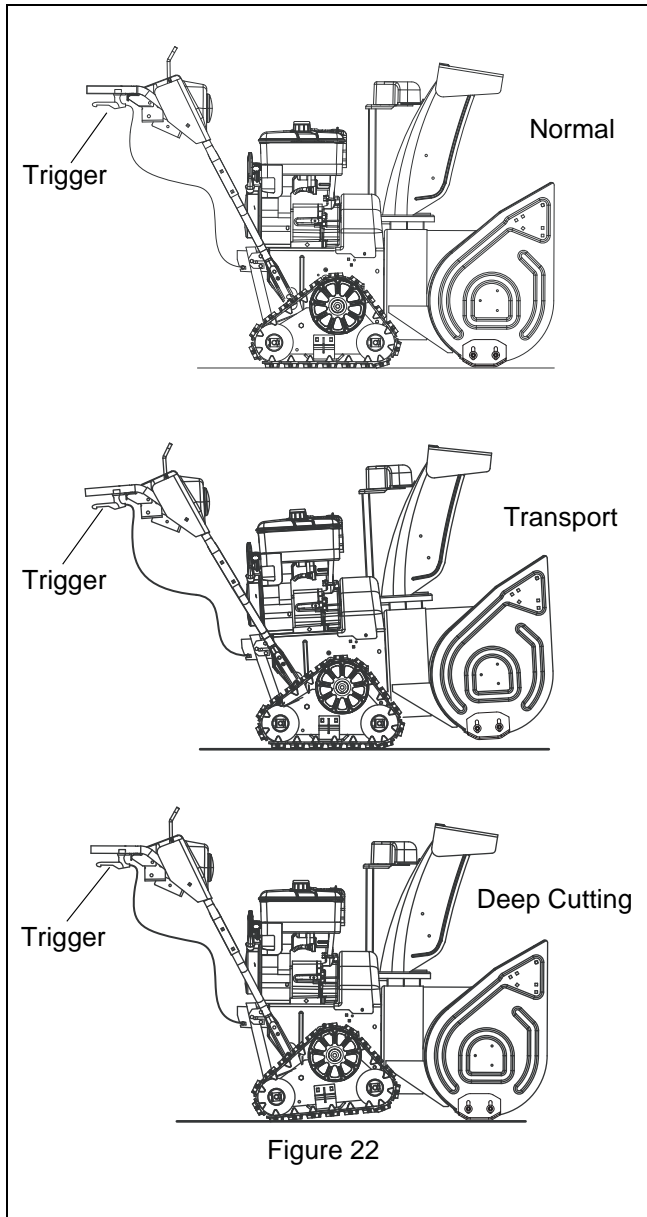

TRAVELING

To travel from one work area to another:

1. Set throttle to slow or part-throttle position.
2. Place the unit in the transport position.
3. Engage track drive clutch without engaging attachment drive clutch.

TRACK TENSION ADJUSTMENT

Check track tension by applying pressure on track midway between drive wheel and rear track bogie wheel. Deflection should be approximately 3/8" (9.6 mm). See Figure 23.

If deflection is excessive, tighten track tension.

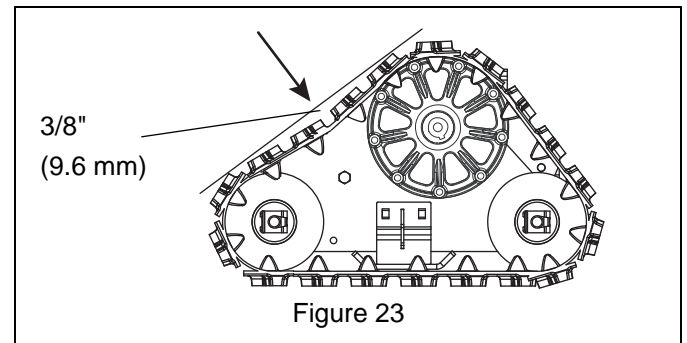

If unit pulls to left or right when a straight path is desired adjust track tension. If the unit is pulling left, tighten left track adjuster. If unit is pulling right, tighten right track adjuster.

To adjust (Figure 24):

1. Tighten locking nut to increase track tension. Loosen locking nut to reduce track tension.
2. Check that unit tracks straight with no pulling to either side.

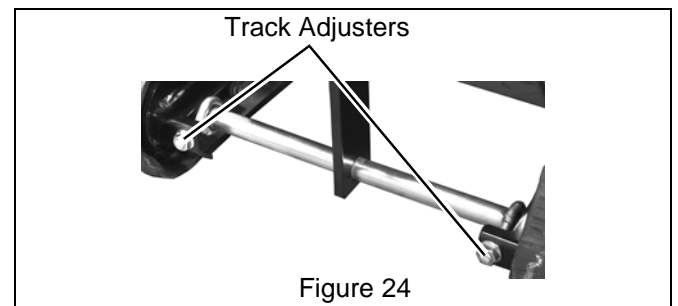

PARTS

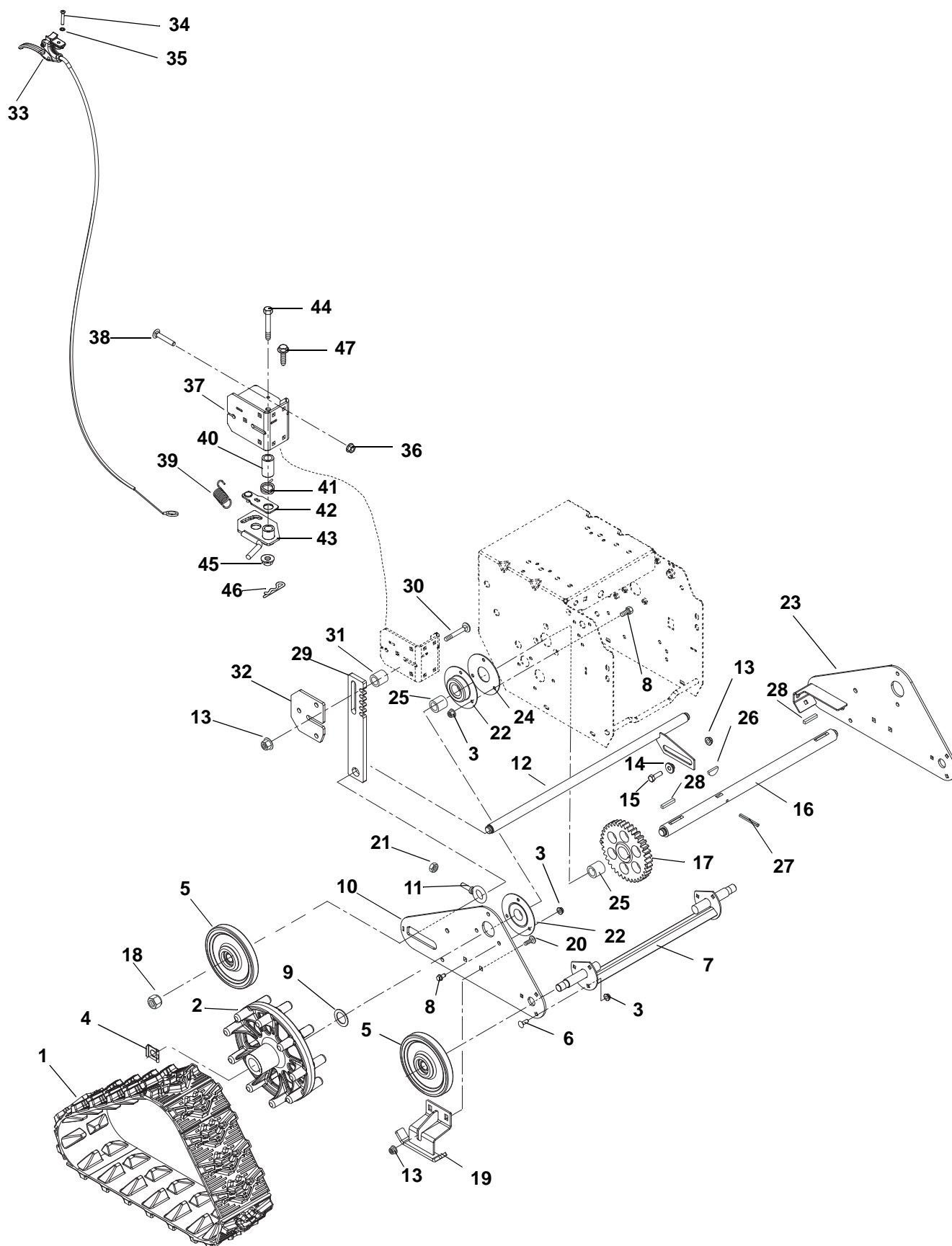

Item	Part No.	Qty.	Description
1	00669700	2	Track
2	04520000	2	Wheel, Cast Drive
3	06543500	18	Nut, Locking Top Flange .25-20
4	05700001	2	Clip, Snap
5	03293600	4	Wheel, Bogie
6	06219900	6	Bolt, Round Head Square Neck .25-20 x .75
7	03275800	1	Axle, Front
8	05946800	12	Bolt, Hex .25-20 x .75
9	06436300	2	Washer, Flat, Steel 1.010 x 1.505 x .062
10	03375751	1	Side Plate, Right Hand
11	07000040	2	Bolt, Eye
12	03293700	1	Axle, Rear
13	06543100	8	Nut, Locking Top Flange .31-18
14	01305900	1	Flange Bushing
15	05946900	1	Bolt, Hex .31-18 x 1.00
16	03291500	1	Shaft, Axle
17	00371000	1	Gear
18	06530300	4	Nut, Locking, Nylon .63-18
19	00660751	2	Runner, Guide
20	06215700	4	Bolt, Round Head Square Neck .31-18 x .75
21	06534800	2	Nut, Locking Center Flange .38-16
22	05400706	4	Bearing
23	03375851	1	Side Plate, Left Hand
24	03389051	2	Plate, Bearing Spacer
25	05500122	3	Bushing, Sleeve
26	06601200	1	Key, Woodruff .25 x .750 x .313 SAE 91
27	05800300	1	Pin, Roll .188 x 1.25
28	06600002	2	Key, Rectangular .25 x .188 x 1.00
29	03293851	1	Stop, Height Adjuster
30	06200008	3	Bolt, Round Head Square Short Neck .31-18 x 1.25
31	01103100	3	Spacer
32	03294151	1	Plate, Height Adjuster
33	06900510	1	Cable, Track (921023, 316, 317)
34	06100007	1	Screw, Machine, Oval Head .25-20 x 1.50
35	06305200	1	Washer, Lock, Internal .25
36	06543500	6	Nut, Locking Top Flange .25-20
37	03293951	1	Bracket, Height Adjuster
38	06219900	4	Bolt, Round Head Square Neck .25-.20 x .75
39	08300103	1	Spring
40	05500106	1	Bushing, Sleeve
41	08300015	1	Spring
42	03376200	1	Arm, Overtravel
43	03294000	1	Lock, Height Adjuster
44	05958500	1	Bolt, Hex .38-16 x 1.75
45	06534800	1	Nut, Locking Center Flange .38-16
46	06701900	1	Pin, Hair, Internal .06 x .18 x .77
47	07400034	1	Screw, Tapping Hex Washer Head Thread Rolling .25-20 x .50