

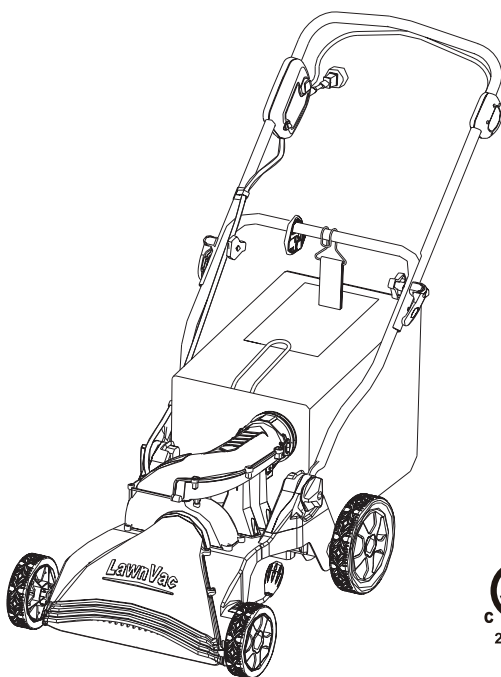

greenworks™

14A ELECTRIC LAWN VAC 26262



Owner's Manual

TOLL-FREE HELPLINE: 1-888-90WORKS (888.909.6757)



Read all safety rules and instructions carefully before operating this tool.

CONTENTS

Specifications.....	2
Safety Information.....	3-7
Symbols.....	8-9
Electrical.....	10-11
Know your lawn vac	12-13
Assembly instructions.....	14-18
Operating your lawn vac.....	19-21
Maintenance.....	22-23
Troubleshooting	24
Warranty.....	25
Exploded view.....	26
Parts list.....	27-28
Notes	29-31

SPECIFICATIONS

14A ELECTRIC LAWN VAC

Motor.....	120 V AC, 60 Hz, 14 A
Vacuuming path.....	16" (40.6 cm)
Impeller type.....	6" (15 cm), metal
Air volume (vacuum).....	604 CFM
Air velocity.....	27 MPH
Mulching ratio.....	16:1
Collection bag capacity.....	1 1/4 bushel (45 L)
Noise rating.....	95 dBA
Weight.....	35 lbs (15.9 kg)



SAFETY INFORMATION

IMPORTANT SAFETY INSTRUCTIONS

IMPORTANT

READ AND UNDERSTAND ALL INSTRUCTIONS. Failure to follow all instructions listed below may result in electric shock, fire, and/or serious personal injury. READ THESE INSTRUCTIONS BEFORE USING THE LAWN VAC..

- Carefully read all instructions on the LAWN VAC. and in the manual before attempting to assemble and operate the LAWN VAC. Keep this manual in a safe place for future reference, and consult it regularly.
- Become familiar with all controls and their proper operation. Know how to stop the LAWN VAC and how to disengage the power in an emergency.
- Do not allow children under the age of 14 to operate this LAWN VAC. Children who are 14 years of age and older must read and understand the operating instructions and the safety rules in this manual, and must be trained and supervised by a parent.
- Do not allow anyone to operate this LAWN VAC until they have read and understand the instructions.
- In order to avoid contact with the blade or injury caused by a thrown object, stay in the operator's zone behind the handles, and keep children and bystanders at least 100' (30 m) away from the Lawn Vac while it is in operation. Stop the motor immediately if someone enters the working area.
- Thoroughly inspect the area where the equipment is to be used. Remove all stones, sticks, wire, bones, toys, and other foreign objects that could be tripped over or thrown by the blade. Thrown objects can cause serious personal injury.
- Plan your working pattern in such a way as to avoid discharging material toward roads, sidewalks, bystanders, etc. Do not discharge material against a wall or obstruction. Doing so may cause the discharged material to ricochet back toward the operator.
- Always wear proper eye protection in order to protect your eyes while operating or performing any adjustment or repair. Thrown objects that ricochet can cause serious eye injury.
- Always wear a face mask or a dust mask when operating the Lawn Vac in a dusty environment.
- Always wear hearing protection.
- Dress properly. Do not wear loose clothing or jewellery that can get caught in moving parts. The wearing of protective gloves and safety footwear is recommended.
- Do not put hands and feet near rotating parts or in the feeding chambers and discharge opening. Contact with the rotating impeller can amputate fingers, hands, and feet.
- Never attempt to unclog either the feed intake or discharge opening, remove or empty vacuum bag, or inspect and repair the machine while the Lawn Vac is running. Stop the machine and wait until all moving parts have come to a complete stop.
- As an added safety measure, Ground Fault Circuit Interrupter (GFCI) protection should be provided on the circuit(s) or outlet(s) that will be used to power the Lawn Vac.

SAFETY INFORMATION

- In order to prevent electric shock, use this mower only with a CSA/CUL listed extension cord that is approved for outdoor use, such as Type SW-A, SOW-A, STW-A, STOW-A, SJW-A, SJOW-A, SJTW-A, or SJTOW-A.
- Extension Cord: Verify that the extension cord is in good condition, is heavy enough to carry the current that your Lawn Vac will draw, and is polarized (one blade of the plug is wider than the other). A 25' (7.6 m) extension cord should be of 14 AWG, a 50' (15 m) extension cord should be 12 AWG. Undersized cords cause a drop in the line voltage, which leads to a loss of power and overheating.
- In order to reduce the likelihood of disconnecting the Lawn Vac from the extension cord, be sure to use the cord lock provided, as shown in the illustration below:

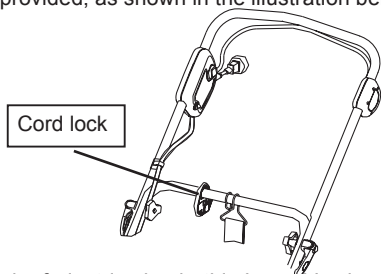

- In order to reduce the risk of electric shock, this Lawn Vac is equipped with a polarized plug (one blade is wider than the other), and must be used with a polarized extension cord. The Lawn Vac's plug will only fit into the polarized extension cord one way. If the plug does not fit into the extension cord properly, reverse the plug. If the plug still does not fit, obtain a proper polarized extension cord. A polarized extension cord must be plugged into a polarized wall outlet. This plug will only fit into the polarized outlet one way. If the plug does not fit into the outlet properly, reverse the plug. If the plug still does not fit, contact a qualified electrician to install a proper outlet. Do not alter the Lawn Vac's plug, the receptacle on the extension cord, or the plug on the extension cord in any way.
- Household circuit: This Lawn Vac is designed to operate on a 15 A circuit. If the Lawn Vac has difficulty starting when connected to a circuit that contains a standard 15 A fuse or circuit breaker, call the toll-free helpline (1-888-909-6757). Do not use a fuse or circuit breaker with higher rating than that specified for your particular branch circuit.
- Do not abuse the cord by pulling the Lawn Vac by the cord or yanking on the cord in order to disconnect it from the outlet. Keep the cord away from heat, oil, and sharp edges.
- Many injuries occur as a result of the Lawn Vac being pulled over the operator's foot during a fall caused by slipping or tripping. Do not operate this Lawn Vac in bare feet, or while wearing sandals or lightweight (e.g.: canvas) shoes. Do not hold on to the Lawn Vac if you are falling. Release the handle immediately.
- Never pull the Lawn Vac back toward you while you are walking. If you must back the Lawn Vac away from a wall or an obstruction, first look down and behind in order to avoid tripping, and then follow these steps:
 - Step back from the Lawn Vac in order to fully extend your arms.
 - Be sure that you are well balanced.
 - Pull the mower back slowly.
 - Repeat these steps as necessary.

SAFETY INFORMATION

- Do not use Lawn Vac for any job except that for which it is intended. Do not force the Lawn Vac.
- Do not operate the Lawn Vac while under the influence of alcohol or drugs.
- Stay Alert: Do not operate the Lawn Vac when you are tired. Pay attention to what you are doing. Use common sense.
- Do not attempt to adjust the wheels or the vacuuming height while the motor is running.
- Avoid dangerous environments. Do not operate the Lawn Vac in the rain or in wet or damp grass.
- If the impeller strikes a foreign object or if your Lawn Vac should start making an unusual noise or vibration, immediately stop the motor. Allow the impeller to come to a complete stop. Perform the following steps:
 - Inspect for damage.
 - Repair or replace any damaged parts.
 - Check for any loose parts, and tighten them in order to ensure continued safe operation.
- Do not allow an accumulation of processed material to build up in the discharge area. This can prevent proper discharge, and result in kickback of material through the feed opening.
- Do not attempt to shred or chip material larger than specified on the machine or in this manual. Personal injury or machine damage could result.
- Never attempt to unclog either the feed intake or discharge opening while the engine is running. Stop the motor, wait until all moving parts have stopped. Clear debris.
- Never operate without vacuum bag and discharge chute properly attached to the machine. Never empty or change vacuum bag while the motor is running. Zippered end of vacuum bag must be kept closed at all times during operation.
- Never operate without either the inlet nozzle or optional hose attachment properly attached to the machine. Never attempt to attach or change either attachment while the motor is running.
- Keep all guards, deflectors and safety devices in place and operating properly.
- Keep your face and body back and to the side of the chipper chute while feeding material into the machine in order to avoid accidental kickback injuries.
- Never operate this machine without good visibility or light. Always be sure of your footing, and keep a firm hold on the handles.

SLOPE OPERATION

Slopes are a major factor related to slip-and-fall accidents, which can result in severe injury. All slopes require caution. If you feel uneasy on a slope, do not vacuum it. Always take the following precautions when using this machine on slopes:

ALWAYS:

- Vacuum across the face of slopes; Never up and down. Exercise extreme caution when changing direction on slopes.
- Remove objects such as stones, wire, rope, or rags.
- Watch for holes, ruts, or bumps in the landscape.

SAFETY INFORMATION

NEVER:

- Never vacuum near drop-offs, ditches, or embankments. You could lose your footing or balance.
- Never vacuum on slopes greater than 20 degrees or any excessively steep slopes.
- Never vacuum on wet or slippery slopes; Reduced traction could result in slipping.
- Never park the vacuum on a steep grade or slope.

SAFETY FOR CHILDREN

Tragic accidents can occur if the operator is not alert to the presence of children. Children are often attracted to the machine and the vacuuming activity. Never assume that children will remain where you last saw them.

- Keep children out of the work area and under the watchful care of a responsible adult.
- Be alert, and always turn off the Lawn Vac if children enter the work area.
- Before and while moving backwards, Look behind and down for small children before and while moving backwards.
- Never allow children to operate the Lawn Vac.
- Use extra care when approaching blind corners, shrubs, trees, or other objects that may obscure your vision.

MAINTENANCE AND STORAGE

- When servicing the Lawn Vac, use only replacement parts that are listed in this manual. The use of parts that do not meet the original equipment specifications may lead to improper performance, and may compromise safety.
- Before cleaning, repairing, or inspecting, stop the engine and make certain the impeller and all moving parts have stopped. In order to prevent accidental start-ups, disconnect the power cord when the Lawn Vac is not in use.
- Follow the instructions for lubricating and changing accessories.
- Inspect the Lawn Vac's power cord and extension cords regularly, and replace them immediately if they are damaged. In order to obtain replacement parts, call the Toll-free Helpline, at 1-888-909-6757.
- Keep the handles dry, clean, and free of oil and grease.
- In order to reduce the risk of fire, keep the motor free of grass, leaves, and debris build-up.
- Check bolts and screws for proper tightness at frequent intervals to keep the machine in safe working condition. Also, visually inspect machine for any damage, and repair if needed.
- Never tamper with safety devices. Check their proper operation regularly.
- After striking a foreign object, stop the motor and disconnect the power cord. Thoroughly inspect the Lawn Vac for any damage. Repair any damage before operating the Lawn Vac.
- The grass catcher components, discharge cover, and trail shield are subject to wear and damage, which could expose moving parts or allow objects to be thrown. As a safety precaution, check the components frequently, and immediately replace any parts that show signs of wear or that are cracked or broken. Use original equipment manufacturer's (OEM) parts only, as listed in this manual.

SAFETY INFORMATION

- When it is not in use, store the Lawn Vac indoors in a dry area, locked up or out of the reach of children.
- Maintain or replace safety and instruction labels as necessary.

DOUBLE INSULATED

- Double insulation eliminates the need for the usual three-wire grounded power cord and grounded power supply system. Wherever there is electric current in the Lawn Vac, there are two complete sets of insulation to protect the user. All exposed metal parts are isolated from the internal metal motor components by protecting insulation.

IMPORTANT

Servicing a lawn Vac with double insulation requires extreme care and knowledge of the system, and should only be performed by a qualified service technician. If repairs are required, call the Toll-free Helpline, at 1-888-909-6757. Always use original factory replacement parts when servicing.

WARNING (PROPOSITION 65)

Some dust created by power sanding, sawing, grinding, drilling and other construction activities contains chemicals known to the state of California to cause cancer, birth defects or other reproductive harm. Some examples of these chemicals are:









- Lead from lead-based paints,
- Crystalline silica from bricks and cement and other masonry products, and
- Arsenic and chromium from chemically-treated lumber.

Your risk from these exposures varies, depending on how often you do this type of work. To reduce your exposure to these chemical: work in a well ventilated area, and work with approved safety equipment, such as those dust masks that are specially designed to filter out microscopic particles.

SAVE THESE INSTRUCTIONS



SYMBOLS

Some of the following symbols may be used on this product. Please study them and learn their meaning. Proper interpretation of these symbols will allow you to operate the product better and safer.

SYMBOL	NAME	DESIGNATION/EXPLANATION
V	Volts	Voltage
A	Amperes	Current
Hz	Hertz	Frequency (cycles per second)
W	Watts	Power
min	Minutes	Time
~	Alternating Current	Type of current
≡	Direct Current	Type or a characteristic of current
n_0	No Load Speed	Rational speed, at no load
	Class II Construction	Double-insulated construction
/min	Per Minute	Revolutions, strokes, surface speed, orbits etc., per minute
	Wet Conditions Alert	Do not expose to rain or use in damp locations
	Read The Operator's Manual	To reduce the risk of injury user must read and understand operator's manual before using this product.
	Eye and Head Protection	Wear eye and head protection when operating this equipment.
	Ricochet	Thrown objects can ricochet and result in personal injury or property damage.
	Sharp Blade	Danger – Keep hands and feet away from blade.
	Operating on a slope	Do not mow a slope that has an angle of greater than 15°.
	Keep Bystanders Away	Keep all bystanders at least 50 ft. away.

SYMBOLS

The following signal words and meanings are intended to explain the levels of risk associated with this product.

SYMBOL	SIGNAL	MEANING
	DANGER	Indicates an imminently hazardous situation, which, if not avoided, will result in death or serious injury.
	WARNING	Indicates a potentially hazardous situation, which, if not avoided, could result in death or serious injury.
	CAUTION	Indicates a potentially hazardous situation, which, if not avoided, may result in minor or moderate injury.
	CAUTION	(Without Safety Alert Symbol) Indicates a situation that may result in property damage.

SERVICE

Servicing requires extreme care and knowledge and should be performed only by a qualified service technician. For service we suggest you return the product to your nearest **AUTHORIZED SERVICE CENTER** for repair. When servicing, use only identical replacement parts.

WARNING

To avoid serious personal injury, do not attempt to use this product until you have read this Owner's Manual thoroughly and understand it completely. If you do not understand the warnings and instructions in this Owner's Manual, do not use this product. Call the Toll-free Helpline (1-888-909-6757) for assistance.

WARNING



The operation of any power tool can result in foreign objects being thrown into your eyes, which can result in severe eye damage. Before beginning power tool operation, always wear safety goggles or safety glasses with side shields and, when needed, a full face shield. We recommend Wide Vision Safety Mask for use over eyeglasses or standard safety glasses with side shields. Always use eye protection which is marked to comply with ANSI Z87.1.

SAVE THESE INSTRUCTIONS

ELECTRICAL

DOUBLE INSULATION

Double insulation is a concept in safety in electric power tools that eliminates the need for the usual three-wire grounded power cord. All exposed metal parts are isolated from the internal metal motor components with protecting insulation. Double insulated tools do not need to be grounded.

⚠ WARNING

The double insulated system is intended to protect the user from shock resulting from a break in the tool's internal insulation. Observe all normal safety precautions to avoid electric shock.

NOTE: Servicing a product with double insulation requires extreme care and knowledge of the system, and should be performed only by a qualified service technician. If servicing is required, call the Toll-free Helpline, at (1-888-909-6757. Always use original factory replacement parts when servicing.

ELECTRICAL CONNECTION

This product has a precision-built electric motor. It should be connected to a power supply that is 120 V, 60 Hz, AC only (normal household current). Do not operate this product on direct current (DC). A substantial voltage drop will cause a loss of power, and the motor will overheat. If the product does not operate when plugged into an outlet, double-check the power supply.

EXTENSION CORDS (See Figure 1.)

When using a power tool at a considerable distance from a power source, be sure to use an extension cord that has the capacity to handle the current the product will draw. An undersized cord will cause a drop in line voltage, resulting in overheating and loss of power.

Use the chart to determine the minimum wire size required in an extension cord. Only round-jacketed cords listed by Underwriter's Laboratories (UL) should be used. When working outdoors with a product, use an extension cord that is designed for outside use. This type of cord is designated with "WA" on the cord's jacket. Before using any extension cord, inspect it for loose or exposed wires and cut or worn insulation.

It is possible to tie the extension cord and power cord in a knot to prevent them from becoming disconnected during use. Make the knot as shown in figure 1, then connect the plug end of the power cord into the receptacle end of the extension cord. This method can also be used to tie two extension cords together.

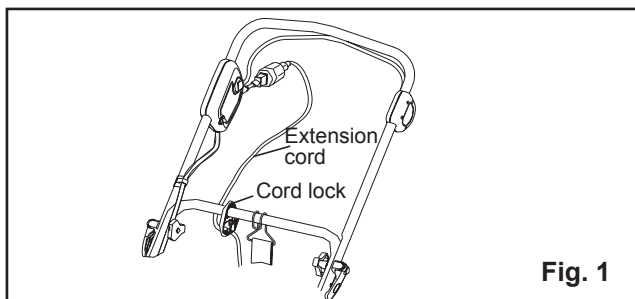

Fig. 1

ELECTRICAL

MINIMUM GAUGE FOR EXTENSION CORDS (AWG)

(WHEN USING 120 V ONLY)

Amp Rating		Total Length of Cord in Feet (meters)			
More Than	Not More Than	25' (7.6 m)	50' (15 m)	100' (30.4 m)	150' (45.7 m)
0	6	18	16	16	14
6	10	18	16	14	12
10	12	16	16	14	12
12	16	14	12	Not Recommended	

Make sure your extension cord is properly wired and in good electrical condition. Always replace a damaged extension cord or have it repaired by a qualified person before using it. Keep your extension cords away from sharp objects, excessive heat and damp or wet areas.

Use a separate electrical circuit for your tools. This circuit should not be less than #12 wire and should be protected with a 15 A time delayed fuse. Before connecting the motor to the power line, make sure the switch is in the OFF position and the electric current is rated the same as the current stamped on the motor nameplate. Running at a lower voltage will damage the motor.

WARNING

ALTHOUGH THIS TOOL IS DOUBLE INSULATED, THE EXTENSION CORD AND RECEPTACLE MUST STILL BE GROUNDED WHILE IN USE TO PROTECT THE OPERATOR FROM ELECTRIC SHOCK.

SAVE THESE INSTRUCTIONS

KNOW YOUR LAWN VAC

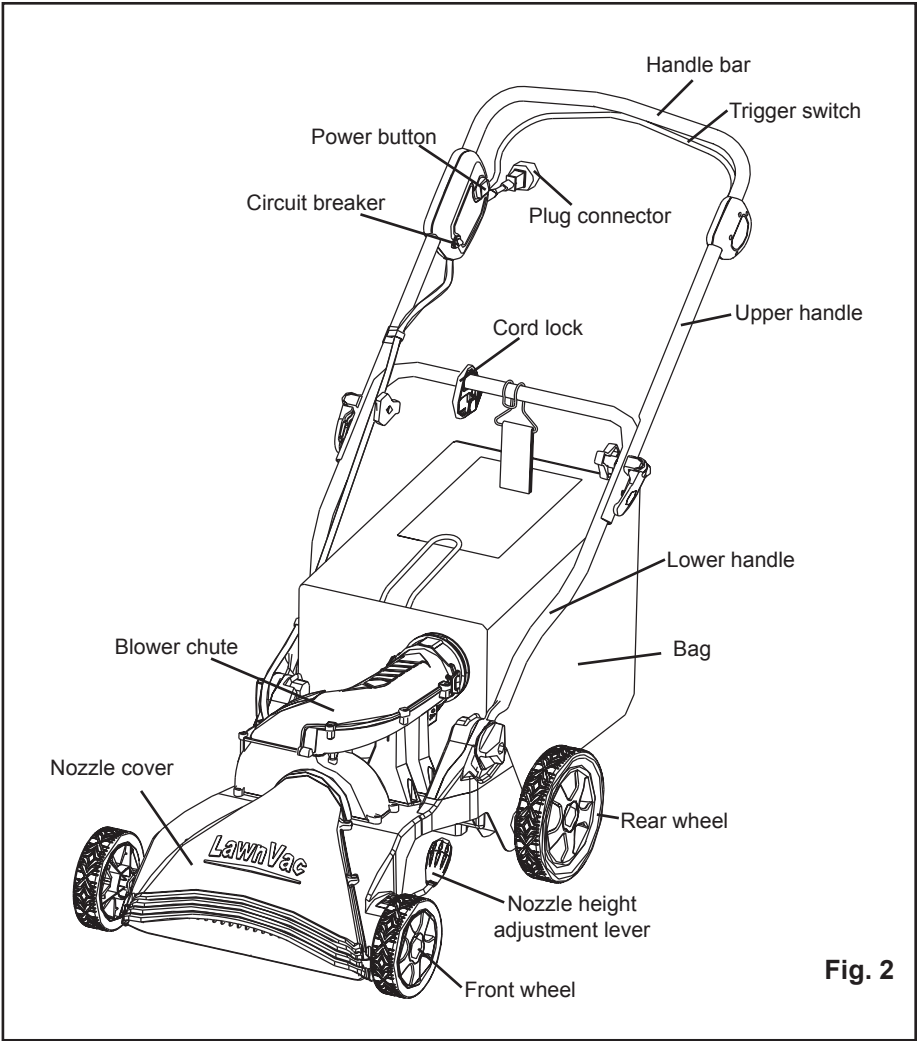

KNOW YOUR LAWN VAC

The safe use of this product requires an understanding of the information on the product and in this Owner's Manual, as well as a knowledge of the project you are attempting. Before using this product, familiarize yourself with all operating features and safety rules.

NOZZLE

Yard waste such as leaves or pine needles can be vacuumed up through the nozzle for shredding.

BAG

Collects shredded material fed through the chipper chute or vacuumed through the nozzle.

BAG HANDLE

Used to grasp bag in order to assist in attaching, removing, and emptying bag.

NOZZLE HEIGHT ADJUSTMENT LEVER

Used to adjust the nozzle ground clearance ranging approximately from 1/2 to 2 3/4" (1.3 to 7 cm).

WARNING

The operation of any yard vacuum can result in foreign objects being thrown into the eyes, which can damage your eyes severely. Always wear the safety glasses provided with this unit or eye shields while operating or performing any adjustments or repairs on it.

ASSEMBLY INSTRUCTIONS

UNPACKING

This product requires assembly.

- Carefully remove the product and any accessories from the box. Make sure all items listed on the packing list are included.
- Inspect the product carefully to make sure no breakage or damage occurred during shipping.
- Do not discard the packing material until you have carefully inspected and satisfactorily operated the product.
- If any parts are damaged or missing, please call the Toll-free Helpline (1-888-909-6757) for assistance.

PACKING LIST

Lawn Vac

Upper and Lower Handle

Bag

Owner's Manual

Cord Lock

Mounting bracket

Bracket hardware

WARNING

If any parts are damaged or missing, do not operate this product until the parts are replaced. Failure to heed this warning could result in serious personal injury.

WARNING

Do not attempt to modify this product or create accessories not recommended for use with this product. Any such alteration or modification is misuse, and could result in a hazardous condition leading to possible serious personal injury.

WARNING

Disconnect the product from the power supply until assembly is complete. Failure to comply could result in accidental starting and possible serious personal injury..

ASSEMBLY INSTRUCTIONS

ATTACHING THE HANDLE (See Figure 3.)

1. Remove any packing material that may have been inserted between the upper and lower handles for shipping purposes.
2. Align the holes (2) on the upper handle (1). Insert carriage screw (3) through the holes in upper handle from the inside, and secure with handle knob (4).
3. Align the holes (6) on the lower handle (5). Insert the carriage fixed knob (7) through the holes in lower handle from the outside, and tighten it up.

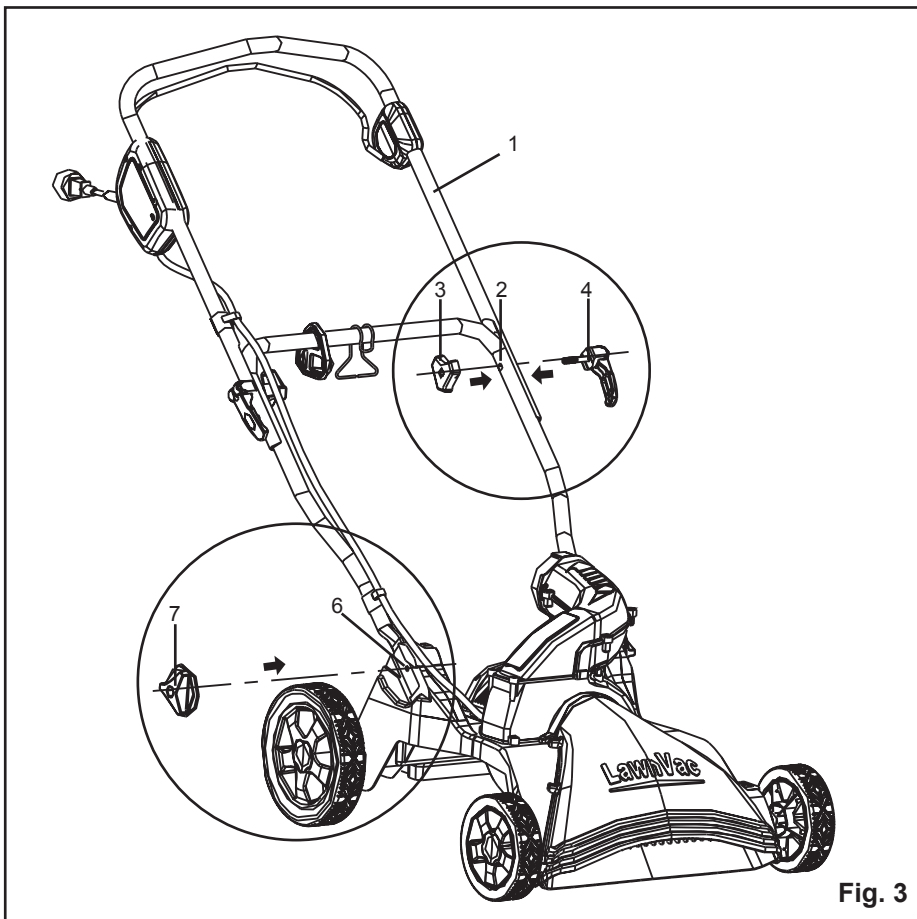

Fig. 3

ASSEMBLY INSTRUCTIONS

ATTACHING THE BAG (See Figure 4.)

- Grasp bag handle (1) with one hand, and press the bag tube (2) with another hand.
- Hitch the hooks (3) on the bag to the mounting bracket of the unit.
- Slide the bag tube over the discharge opening on the unit.
- Press latching tabs (4) on both sides of the bag tube to secure bag in place.
- Snap bag clip (5) to the top of the lower handle.

NOTE: The bag/chute switch button attached to the mounting bracket must be fully depressed by the tip of front tab on bag handle when securing the bag, or the motor will not start.

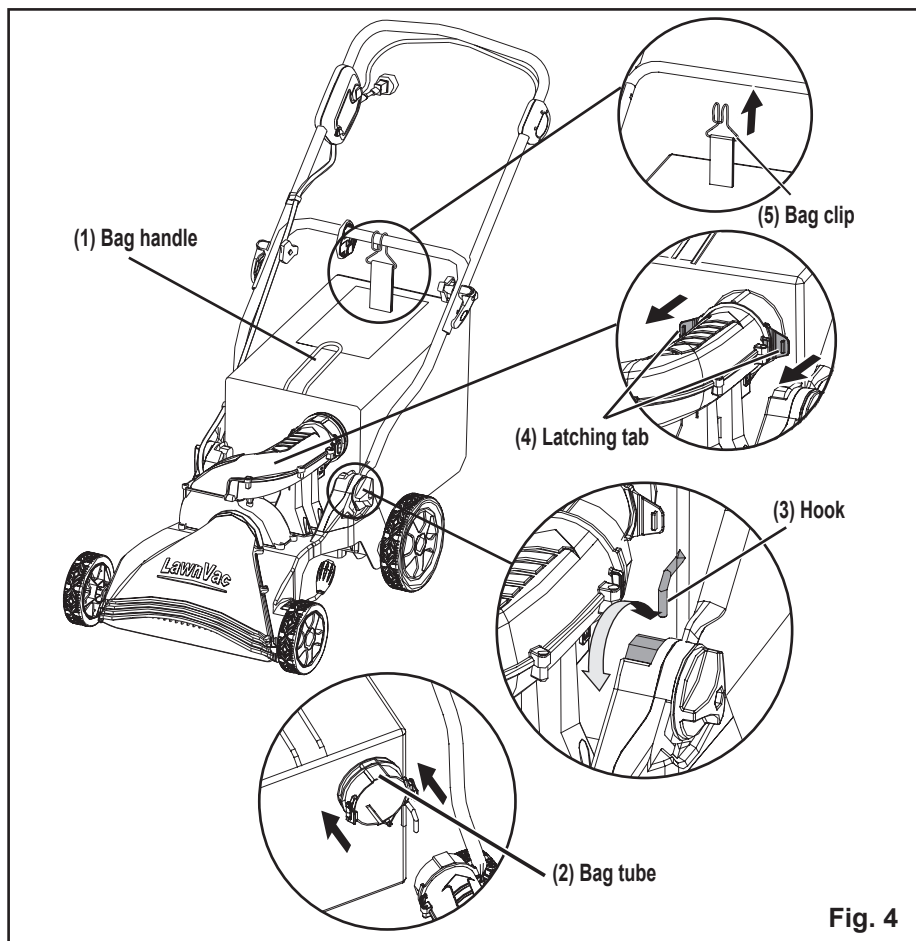

Fig. 4

ASSEMBLY INSTRUCTIONS

NOZZLE HEIGHT ADJUSTMENT (See Figure 5.)

The nozzle can be adjusted to any of six positions, ranging from 1/2 to 2 3/4" (1.3 to 7 cm) ground clearance. The nozzle height has to be adjusted according to yard conditions. The lever is located beside the left front wheel.

⚠ WARNING

Before performing any maintenance or adjustments, always release the switch to turn the LAWN VAC off, and wait for blade to come to a complete stop. Always wear safety glasses during operation or while performing any adjustments or repairs.

1. Depress nozzle height adjustment lever (1) toward wheel.
2. Move the height adjustment lever forward or backward to adjust the nozzle upward or downward.
3. Release lever toward deck.

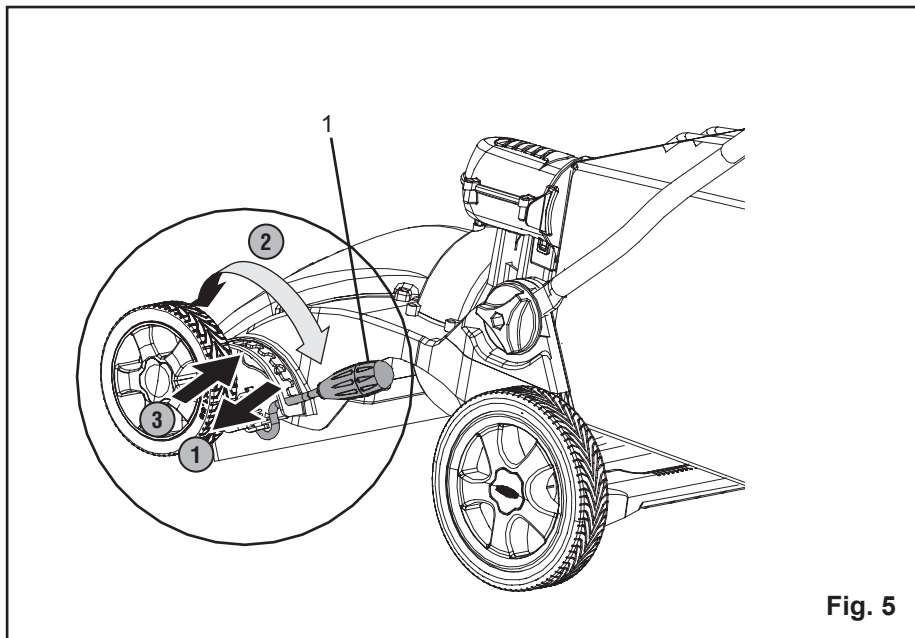
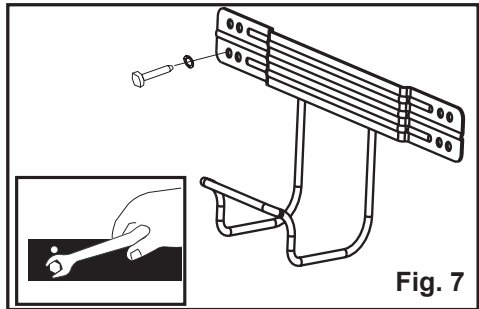
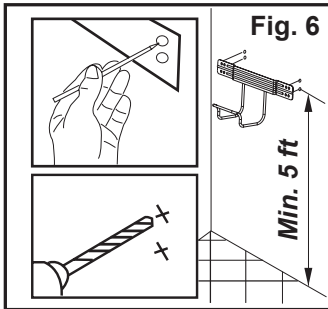

Fig. 5

ASSEMBLY INSTRUCTIONS

WALL BRACKET INSTALLATION (See Figure 6-7.)

1. Find a proper mounting location on the studs, not lower than 5' from the floor.
2. Mark a level line on the wall.
3. Mark the position of the holes on the studs, using the bracket as a template (Fig. 6).
4. Pre-drill the holes in the studs using a 1/8" (3 mm) drill bit (not included) (Fig. 6).
5. Mount the wall bracket onto the studs using the four screws and washers provided (Fig. 7).
 - Insert the four screws and washers into the pre-drilled holes.
 - Tighten the screws firmly.
6. After fastening, make sure the wall bracket is level, and securely mounted on the wall.



HANGING YOUR LAWN VAC ON WALL HOOK (See Figure 8.)

- Remove the bag.
- Lower the handle.
- Hang Lawn Vac on wall hook.
- Bind the handle with a strap.

CAUTION

Must be mounted to studs only. Do not use wall anchors.

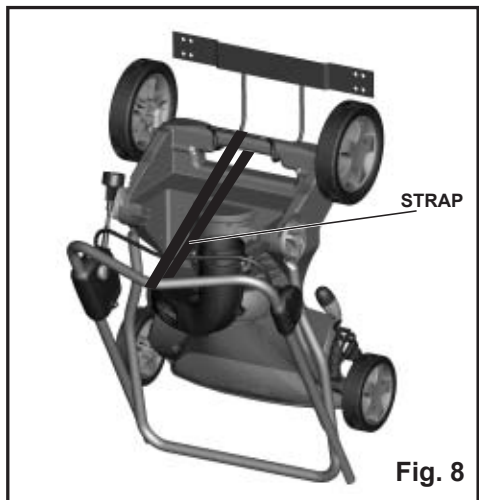

OPERATING YOUR LAWN VAC

STARTING AND STOPPING THE LAWN VAC (See Figure 9.)

STARTING THE LAWN VAC:

- Plug the LAWN VAC into an approved outdoor extension cord.
- Press and hold the Power button (1). This makes the trigger switch operational.
- Pull the trigger switch (2) upward to the handlebar to operate.

STOPPING THE LAWN VAC:

- Release the trigger switch.

CIRCUIT BREAKER

This LAWN VAC is equipped with a circuitbreaker in order to protect the supply circuit from short-circuit overloads.

Follow these steps if the switch pops out:

1. Release the trigger switch, and allow the LAWN VAC to stop and cool down for a minute.
2. Press the circuit breaker in order to reset it. Resume operation (See Figure 9.).

Follow these steps if the switch pops out again shortly after the first time:

1. Allow the LAWN VAC to stop and cool down for 15 to 30 minutes.
2. After the LAWN VAC has cooled down, press the circuit breaker in order to reset it. Resume operation.

If the circuit breaker does not stay in, or if it continues to pop out during operation, contact the Toll-Free Helpline, at 1-888-909-6757.

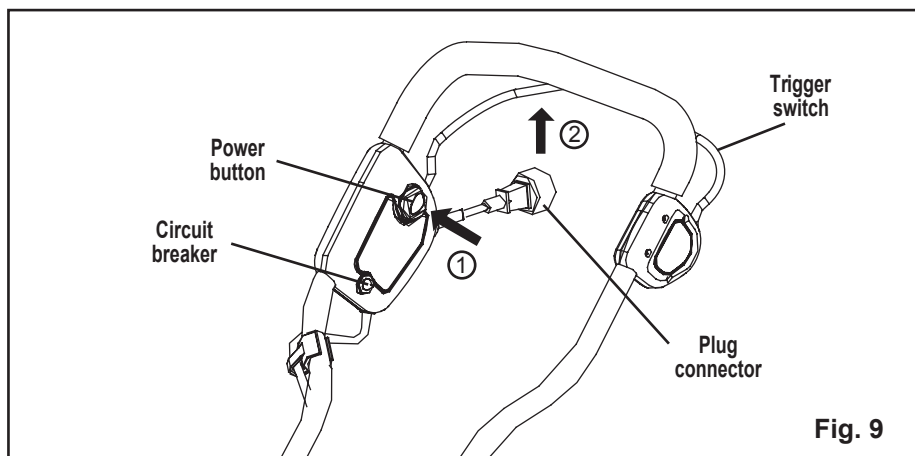

OPERATING YOUR LAWN VAC

TO EMPTY BAG (See Figure 10.)

There is a transparent placket on the upper part of the bag. It's easy to see whether the bag is full. When the bag is full, empty the bag:

- Lift the bag by its handle and lift to remove from the LAWN VAC.
- Unzip the zipper on the upper part of the bag.
- Empty the bag.
- Reinstall the bag as described earlier in this manual.

⚠ WARNING

In order to avoid serious personal injury, do not unzip or remove the bag while the LAWN VAC is running.

⚠ WARNING

Wear eye protection and a dust mask when emptying the bag.



Fig. 10

OPERATING YOUR LAWN VAC

CLEARING A BLOCKED NOZZLE/IMPELLER (See Figure 11.)

- Disconnected the power supply, and wait until the LAWN VAC comes to a complete stop.
- Remove the 6 screws that are holding the nozzle cover onto the deck.
- Remove the nozzle cover from the deck.
- Carefully remove the material that is blocking the nozzle or impeller. Inspect the blades in order to verify that no damage has occurred. Rotate the impeller blades by hand in order to ensure that the blockage is completely cleared.
- Reinstall the nozzle cover.

⚠ WARNING

In order to avoid serious personal injury, verify that the LAWN VAC is turned off and unplugged before clearing the impeller.

⚠ WARNING

In order to avoid serious personal injury, always wear gloves to protect the hands from the impeller blades.

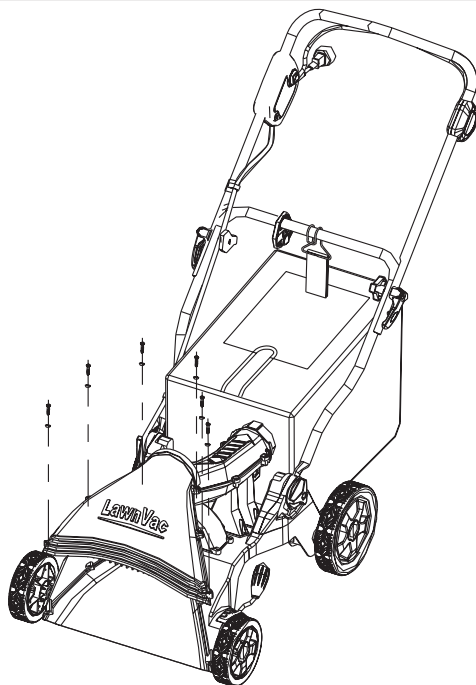

Fig. 11

MAINTENANCE

WARNING

Before performing any maintenance or adjustments, always release the switch to turn the LAWN VAC off, and wait for impeller to come to a complete stop. Always wear safety glasses during operation or while performing any adjustments or repairs.

GENERAL RECOMMENDATIONS

- Always observe safety rules when performing any maintenance.
- The warranty on this LAWN VAC does not cover items that have been subjected to operator abuse or negligence. To receive full value from warranty, operator must maintain the equipment as instructed here.
- Some adjustments will have to be made periodically to maintain your unit properly.
- Periodically check all fasteners and make sure they are tight.

SERVICING DOUBLE-INSULATED UNITS

This unit is double insulated. In a double-insulated unit, two systems of insulation are provided instead of grounding. There is no grounding provided, and no means of grounding should be added to this unit. Extreme care and knowledge of the system is required when servicing a double-insulated unit. Service should be performed by qualified service personnel only. Replacement parts for a double-insulated unit must be identical to the parts they replace. Refer any repairs to an authorized service dealer. A double-insulated unit is marked with the words "double insulation" or "double insulated."

CLEANING THE UNIT

Use a small brush to clean off the outside of the unit. Do not use strong detergents, household cleaners that contain aromatic oils such as pine and lemon, or solvents such as kerosene, which can damage plastic housing or handle. Wipe off any moisture with a soft, dry cloth.

CLEANING THE BAG

- Empty the bag after each use to avoid deterioration and obstructing air flow, which will reduce the performance of the vac.
- Wearing eye protection and a dust mask, clean the bag as needed. Turn the bag inside-out after initial emptying, and vigorously shake out dust and debris.
- Wash the bag once per year, or more often if needed.
 - a. Remove the bag.
 - b. Turn the bag inside-out.
 - c. Hang it up.
 - d. Hose it down thoroughly.
 - e. Hang it in order to dry it.
 - f. Turn the bag right-side-out, and reinstall it.

INSPECT EXTENSION CORDS

Inspect all extension cords periodically. Look closely for deterioration, cuts or cracks in the insulation. Inspect the connectors for damage. Replace cords if defective or damaged.

MAINTENANCE

STORING THE LAWN VAC

- Disconnect the LAWN VAC from the power supply.
- Turn the LAWN VAC on its side, and clean leaf clippings that have accumulated on the underside of the LAWN VAC deck.
- Wipe the LAWN VAC clean with a dry cloth.
- Check all nuts, bolts, knobs, screws, fasteners, etc., for tightness.
- Inspect moving parts for damage, breakage, and wear. Have repairs made on any damaged or missing parts.
- Store LAWN VAC indoors in a clean, dry place, out of the reach of children.
- Do not store near corrosive materials such as fertilizer or rock salt.

LOWER THE HANDLE BEFORE STORING (See Figure 12.)

- Fully loosen the handle knobs on the sides of the handle, and fold the upper handle down.
- Fully loosen the carriage fixed knobs, push outward on each side of the lower handle, and lift the sides of the lower handle from the slot (1) of the handle mounting brackets to another slot (2).
- Fold the lower handle forward, making sure not to bend or kink the power cord.

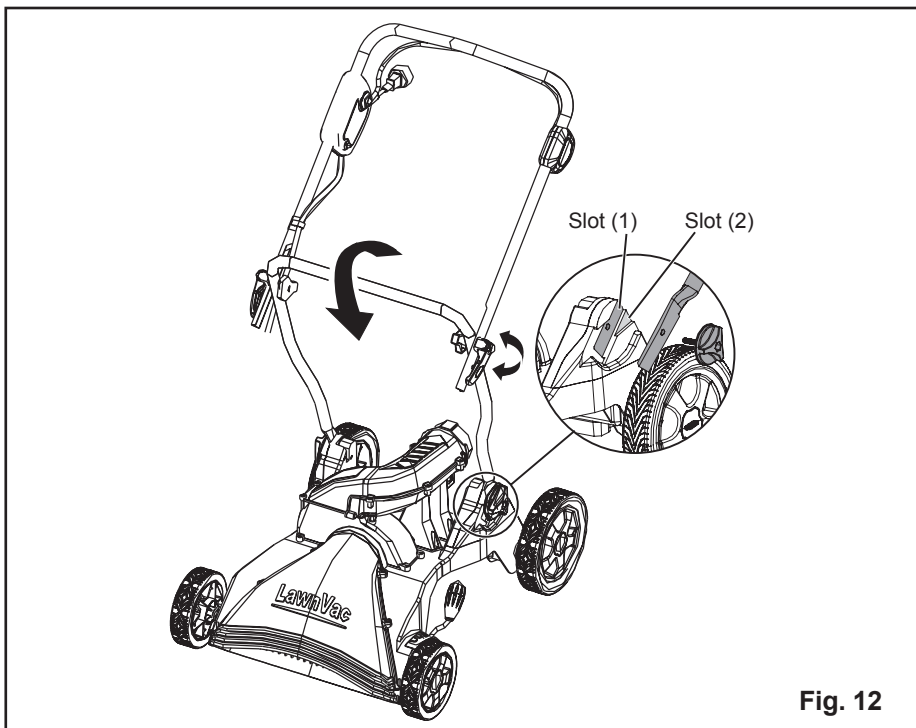

TROUBLESHOOTING

PROBLEM	POSSIBLE CAUSE	SOLUTION
The Lawn Vac will not vacuum.	The bag is full.	Empty the bag.
	The nozzle is blocked.	Clear the blockage.
	The impeller is blocked.	Clear the blockage
	The impeller is damaged.	Call the Toll-Free Helpline (1-888-909-6757).
	The bag is dirty.	Clean the bag.
	The bag is torn.	Replace the bag.
	The bag is unzipped.	Zip up the bag.
	Extension cord not connected to the Lawn Vac plug.	Reconnect the cord.
	Extension cord not connected to power source.	Connect the extension cord to a live 120 V AC, 60 Hz receptacle.
	The circuit breaker in the switch has been tripped.	Reset the circuit breaker. If it trips again, call the Toll-Free Helpline (1-888-909-6757).
	Motor control switch defective.	Have motor control switch replaced by an authorized service centre.
Handle not in position.	Carriage bolts not seated properly.	Adjust the height of the handle, and make sure the carriage bolts are seated properly.
	Handle knobs not tightened.	Tighten handle knobs.
The Lawn Vac is hard to push.	Vacuuming height is too low.	Raise Vacuuming height.

LIMITED FOUR-YEAR WARRANTY



GREENWORKS™ hereby warrants this product, to the original purchaser with **proof of purchase**, for a period of four (4) years against defects in materials, parts or workmanship. GREENWORKS™, at its own discretion will repair or replace any and all parts found to be defective, through normal use, free of charge to the customer. This warranty is valid only for units which have been used for personal use that have not been hired or rented for industrial/commercial use, and that have been maintained in accordance with the instructions in the owners' manual supplied with the product from new.

ITEMS NOT COVERED BY WARRANTY:

1. Any part that has become inoperative due to misuse, commercial use, abuse, neglect, accident, improper maintenance, or alteration; or
2. The unit, if it has not been operated and/or maintained in accordance with the owner's manual; or
3. Normal wear, except as noted below;
4. Routine maintenance items such as lubricants, blade sharpening;
5. Normal deterioration of the exterior finish due to use or exposure.

GREENWORKS HELPLINE (1 888 90WORKS):

Warranty service is available by calling our toll-free helpline, 9 a.m. to 5 p.m. EST. Monday – Friday at **1 888 909 6757 (1 888 90WORKS)**.

TRANSPORTATION CHARGES:

Transportation charges for the movement of any power equipment unit or attachment are the responsibility of the purchaser. It is the purchaser's responsibility to pay transportation charges for any part submitted for replacement under this warranty unless such return is requested in writing by GREENWORKS.

EXPLODED VIEW

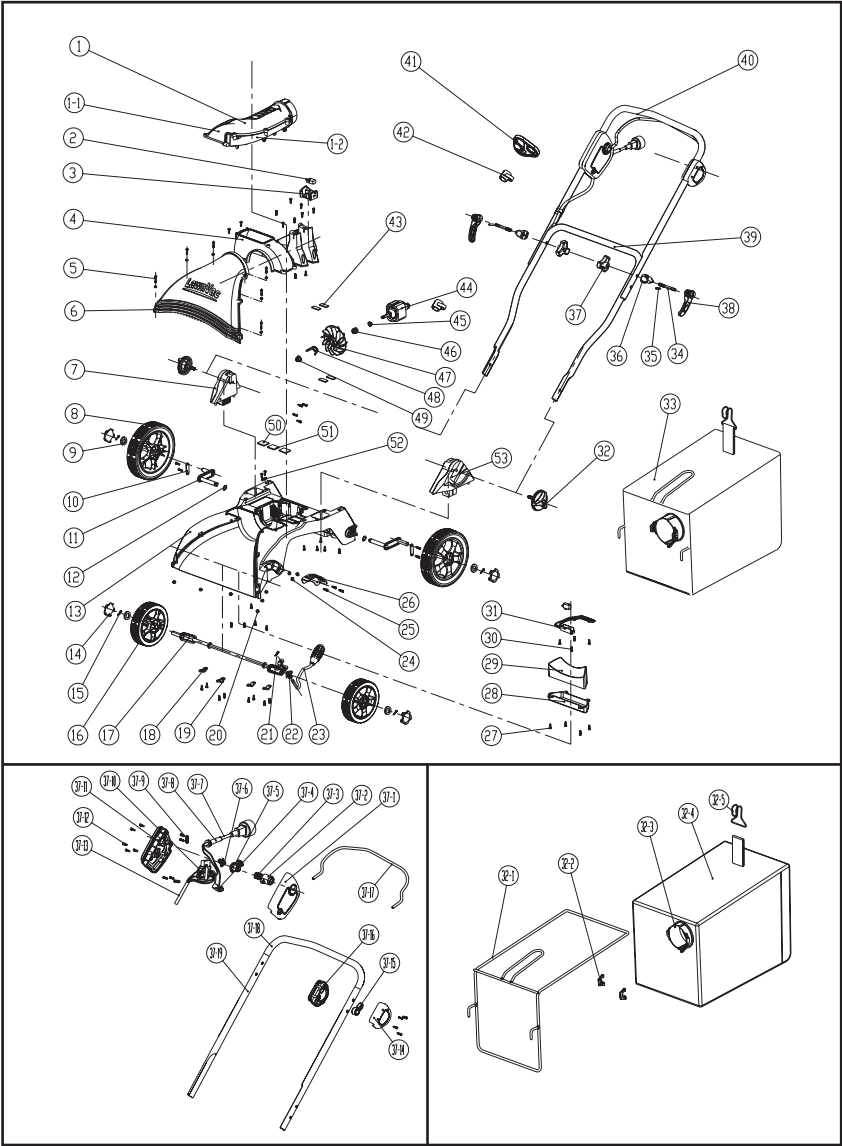

PARTS LIST

ITEM NO.	PART NO.	DESCRIPTION	QTY
1	31103143-2	Venting assy.	1
1-1	34105143-2	Upper venting cover	1
1-2	34106143-2	Lower venting cover	1
2	36301143	Micro switch(125VAC)	2
3	34116143-2	Switch cover	1
4	34104143-2	Motor cover	1
5	32201162-2	Screw M4×23	6
6	34103143	Cover	1
7	31104143-2	Handle right fixing bracket assy.	1
8	34120143-2	8" wheel	2
9	3331638	Washer	4
10	33316143	Rear axle board	2
11	31102143	Rear axle assy.	2
12	3290440	Retaining ring Ø12	2
13	34102143-2	Lower housing	1
14	3411799C-2	Wheel cover	4
15	3290153	Pin Ø2.5	6
16	34119143-2	6" wheel	2
17	31101143	Front axle assy.	2
18	33308143	Axle board	2
19	33328143	Axle board II	2
20	32202143	Hex nut M4	6
21	32901143	Pin Ø2×12	1
22	33901143	Spring	1
23	31105143	Height adjustment handle assy.	1
24	32222301	Lock nut M6	3
25	3220150	Screw M6×15	3
26	33307143	Height adjustment board	1
27	3220951	Screw ST5×16-C	4
28	34117143-2	Balance block board	1
29	33903143	Balance block	1
30	3220239	Screw ST3 x12-F	4
31	3410403	Cord holder	1
32	34114143-2	Lock nut	2
32-1	33312143-2	Grass catcher bracket	1
32-2	34115143-2	Latching tab	2
32-3	34107143-2	Grass catcher connector	1
32-4	34901143-2	Bag	1
32-5	33313143	Bag clip	1
33	31106143-2	Grass catcher assy.	1
34	33201466	Knob	

PARTS LIST

ITEM NO.	PART NO.	DESCRIPTION	QTY
35	32901466	Column pin	2
36	34103466	Locking pad	2
37	3410835-8	Turncap	2
37-1	34208281-1	Switch left box	1
37-2	34205281-1	Switch spring	1
37-3	33903281	Switch spring	1
37-4	36501227-2	Over-current protector	1
37-5	34206281-2	Switch knob	1
37-6	33902281-1	Switch spring	1
37-7	36402143	Power cord	1
37-8	3420102	Strain relief	1
37-9	3411435	Cord holder	2
37-10	36302143	Switch	1
37-11	34204281-1	Switch right box	1
37-12	3220404-1	Screw ST4.2×25-F	2
37-13	36401143	4-core cord	1
37-14	34202281-1	Switch handle left cover	1
37-15	34211281-3	Switch handle knob	1
37-16	34203281-1	Switch handle right cover	1
37-17	33308227	Handle bar	1
37-18	34904143	Handle sponge	1
37-19	33314143-1	Upper handle assy.	1
38	34102466	Cam lock	2
39	33315143-1	Lower handle	1
40	31108143-2	Switch box assy.	1
41	34120227	Cord restraint	1
42	3411135	Cord lock	3
43	3420311	Foam pad	4
44	36101143	Motor	1
45	33902143	Bushing	1
46	34113143	Insulating nylon sleeve	1
47	33101143	Fan	1
48	33328143	Blade	1
49	34114143	Lock nut	1
50	34918143	Bottom dust-proof sponge	2
51	34919143	Side dust-proof sponge	1
52	3410403	Cord holder	1
53	31110143-2	Cam lock assy.	1

[illegible]

[illegible]

[illegible]



TOLL-FREE HELPLINE: 1-888-90WORKS (888.909.6757)

Rev: 01 (07-06-2010)

 Printed in China on 100% Recycled Paper