

WAGNER®

PAINT EATER™

Owner's Manual • Guide d'utilisation • Manual del Propietario

Read all instructions and product labels. When using electrical tools, follow all precautions to reduce the risk of fire, electric shock, and other personal injury.

Veillez lire toutes les instructions et les étiquettes du produit. Lorsque vous utilisez des outils électriques, veuillez observer toutes les précautions afin de réduire les risques d'incendie, de choc électrique ou de blessures.

Lea todas las instrucciones y las etiquetas de los productos. Cuando utilice herramientas eléctricas, observe todas las precauciones para disminuir el riesgo de incendio, descargas eléctricas y otras lesiones físicas.



Need help? Call us first for answers fast.

Call Wagner toll-free if you have any comments or problems with this Wagner Product.



1-800-727-4023

Wagner Technical Service

Register your product online at:

Enregistrement du produit en ligne sur le site :

Regístrelo del producto en línea en:

<http://www.wagnerspraytech.com>

Besoin d'aide? Appelez-nous pour des réponses rapides.

Téléphonez à Wagner sans frais d'appel si vous avez des commentaires ou des problèmes avec l'appareil.

¿Necesita Ayuda? Llámenos primero para obtener respuestas rápidas.

Llame a la línea gratuita de Wagner si quiere hacer un comentario o tiene problemas con este producto de Wagner.



WARNING! Read all safety warnings and all instructions. Failure to follow the warnings and instructions may result in electric shock, fire and/or serious injury.

Save all warnings and instructions for future reference.

The Paint Eater™

FOR EXTERIOR USE ONLY NOT FOR USE WITH LEAD BASED PAINTS!

WARNING! Removal of old paint by sanding, scraping or other means may generate dust or fumes that contain lead. Exposure to lead dust or fumes may cause brain damage or other adverse health effects, especially in children or pregnant women. Controlling exposure to lead or other hazardous substances requires the use of proper protective equipment, such as a properly fitted respirator (NIOSH approved) and proper containment and cleanup. For more information, call the National Lead Information Center at 1-800-424-LEAD (in US) or contact your local health authority.

Read the booklet, "Protect Your Family From Lead In Your Home", included with this product, or obtain a copy from the U.S. Environment Protection Agency or the U.S. Consumer Product Safety Commission.

Many paints contain toxic or harmful substances. Read the enclosed User's Manual for further precautions and instructions.

Table of Contents

General Safety Rules	3-4
Grounding Instructions.....	5
Safety Instructions and Warnings - Sanders.....	5-6
General Description.....	7
Parts and Components	7
Hand Positions	7
Usage	8
Changing the Disc.....	9
Inspection and Cleaning.....	9
Product Registration / Warranty.....	26



WARNING! Read all safety warnings and all instructions. Failure to follow the warnings and instructions may result in electric shock, fire and/or serious injury.

Save all warnings and instructions for future reference.

General Safety Rules

Read and understand all instructions. Failure to follow all instructions listed below may result in electric shock, fire and/or serious personal injury.

Work Area Safety

- **Keep your work area clean and well-lit.** Cluttered benches and dark areas invite accidents.
- **Do not operate power tools in explosive atmospheres, such as in the presence of flammable liquids, gases, or dust.** Power tools create sparks which may ignite the dust or fumes.
- **Keep children and bystanders away while operating a power tool.** Distractions can cause you to lose control.

Electrical Safety

- **Power tool plugs must match the outlet. Never modify the plug in any way. Do not use any adapter plugs with earth (grounded) power tools.** Unmodified plugs and matching outlets will reduce risk of electric shock.
- **Avoid body contact with earthed or grounded surfaces, such as pipes, radiators, ranges and refrigerators.** There is an increased risk of electric shock if your body is earthed or grounded.
- **Do not expose power tools to rain or wet conditions.** Water entering a power tool will increase the risk of electric shock.
- **Do not abuse the cord. Never use the cord for carrying, pulling or unplugging the power tool. Keep cord away from heat, oil, sharp edges or moving parts.** Damaged or entangled cords increase the risk of electric shock.
- **When operating a power tool outdoors, use an extension cord suitable for outdoor use.** Use of a cord suitable for outdoor use reduces the risk of electric shock.
- **If operating a power tool in a damp location is unavoidable, use a ground fault circuit interrupter (GFCI) protected supply.** Use of a GFCI reduces the risk of electric shock.

Personal Safety

- **Stay alert, watch what you are doing and use common sense when operating a power tool. Do not use tool while tired or under the influence of drugs, alcohol or medication.** A moment of inattention while operating power tools may result in serious injury.
- **Use personal protective equipment. Always wear eye protection.** Protective equipment such as dust masks, non-skid safety shoes, hard hat, or hearing protection used for appropriate conditions will reduce personal injuries.
- **Prevent unintentional starting. Ensure the switch is in the off-position before connecting to power source and/or battery pack, picking up or carrying the tool.** Carrying power tools with your finger on the switch or energizing power tools that have the switch on invites accidents.
- **Remove any adjusting key or wrench before turning the power tool on.** A wrench or a key left attached to a rotating part of the power tool may result in personal injury.
- **Do not overreach. Keep proper footing and balance at all times.** This enables better control of the power tool in unexpected situations.
- **Dress properly. Do not wear loose clothing or jewellery. Keep your hair, clothing and gloves away from moving parts.** Loose clothes, jewellery or long hair can be caught in moving parts.
- **If devices are provided for the connection of dust extraction and collection facilities, ensure these are connected and properly used.** Use of dust collection can reduce dust-related hazards.



WARNING! Read all safety warnings and all instructions. Failure to follow the warnings and instructions may result in electric shock, fire and/or serious injury.

Save all warnings and instructions for future reference.

Power Tool Use and Care

- **Do not force the power tool. Use the correct power tool for your application.** The correct power tool will do the job better and safer at the rate for which it was designed.
- **Do not use the power tool if the switch does not turn it off and on.** Any power tool that cannot be controlled with the switch is dangerous and must be repaired.
- **Disconnect the plug from the power source and/or the battery pack from the power tool before making any adjustments, changing accessories, or storing power tools.** Such preventive safety measures reduce the risk of starting the power tool accidentally.
- **Store idle power tools out of the reach of children and do not allow persons unfamiliar with the power tool or these instructions to operate the power tool.** Power tools are dangerous in the hands of untrained users.
- **Maintain power tools. Check for misalignment or binding of moving parts, breakage of parts and any other condition that may affect the power tool's operation. If damaged, have the power tool repaired before use.** Many accidents are caused by poorly maintained power tools.
- **Keep cutting tools sharp and clean.** Properly maintained cutting tools with sharp cutting edges are less likely to bind and are easier to control.
- **Use the power tool, accessories and tool bits, etc., in accordance with these instructions, taking into account the working conditions and the work to be performed.** Use of the power tool for operations different from those intended could result in a hazardous situation.

Service

- **Have your power tool serviced by a qualified repair person using only identical replacement parts.** This will ensure that the safety of the power tool is maintained.



Some dust created by power sanding, sawing, grinding, drilling, and other construction activities contains chemicals known to cause cancer, birth defects or other reproductive harm. Some examples of these chemicals are:

- lead from lead-based paints
- crystalline silica from bricks and cement and other masonry products
- arsenic and chromium from chemically-treated lumber (CCA).

Your risk from these exposures varies, depending upon how often you do this type of work. To reduce your exposure to these chemicals: work in a well-ventilated area and work with approved safety equipment, such as dust masks that are specifically designed to filter out microscopic particles.

- **Avoid prolonged contact with dust from power sanding, sawing, grinding, drilling and other construction activities. Wear protective clothing and wash exposed areas with soap and water.** Allowing dust to get into your mouth, eyes, or any on the skin may promote absorption of harmful chemicals.



Use of this tool can generate and/or disperse dust, which may cause serious and permanent respiratory or other injury. Always use NIOSH/OSHA approved respiratory protection appropriate for the dust exposure. Direct particles away from face and body.



WARNING! Read all safety warnings and all instructions. Failure to follow the warnings and instructions may result in electric shock, fire and/or serious injury.

Save all warnings and instructions for future reference.

Grounding Instructions

This product must be grounded. In the event of an electrical short circuit, grounding reduces the risk of electrical shock by providing an escape wire for the electrical current. This product is equipped with a cord having a grounding wire with an appropriate grounding plug. The plug must be plugged into an outlet that is properly installed and grounded in accordance with all applicable codes and ordinances.

WARNING - Improper installation of the grounding plug can result in a risk of electric shock.

If repair or replacement of the cord or plug is necessary, do not connect the green grounding wire to either the flat blade terminal. The wire with insulation at one end has a green outer surface with or without yellow stripes. The grounding wire and must be connected to the grounding pin.

Check with a qualified electrician or serviceman if the grounding instructions are not completely understood, or if you are in doubt as to whether the product is properly grounded. Do not modify the plug provided. If the plug will not fit the outlet, have the proper outlet installed by a qualified electrician.

This product is for use on a nominal 120 volt circuit and has a grounding plug that looks like the plug as illustrated. Make sure that the product is connected to an outlet having the same configuration as the plug. **No adapter should be used with this product.**

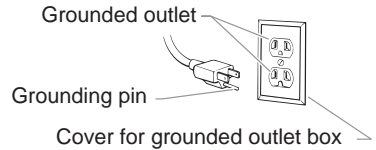

IMPORTANT - Use only a 3-wire extension cord that has a 3-blade grounding plug and a 3-slot receptacle that will accept the plug on the product. Make sure your extension cord is in good condition. When using an extension cord, be sure to use one heavy enough to carry the current your product will draw. For lengths less than 50 feet, use a No. 18 AWG extension cord. For lengths more than 50 feet, use a No. 14 or No. 16 AWG extension cord. An undersized cord will cause a drop in voltage resulting in loss of power and overheating.

Wagner Spray Tech accessory extension cords recommended:

P/N 0090241 20 foot extension cord
P/N 0090242 35 foot extension cord

Minimum gauge for extension cords									
Ampere rating range	Voltage	Cord length (feet)							
		120V	25-50	100	150	200	250	300	400
3 - 4		18	16	14	12	12	10	10	8

Safety Warnings and Instructions - Sanders

- **This power tool is intended to function as a sander. Read all safety warnings, instructions, illustrations and specifications provided with this power tool.** Failure to follow instructions stated below may result in electrical shock, fire and/or serious injury.
- **Operations such as grinding, wire brushing, polishing or cutting-off are not recommended to be performed with this power tool.** Operations for which the power tool was not designed may create a hazard and cause personal injury.
- **Do not use accessories which are not specifically designed and recommended by the tool manufacturer.** Just because the accessory can be attached to your power tool, it does not assure safe operation.
- **The rated speed of the accessory must be at least equal to the maximum speed marked on the power tool.** Accessories running faster than the rated speed can break and fly apart.
- **The outside diameter and the thickness of your accessory must be within the capacity rating of your power tool.** Incorrectly sized accessories cannot be adequately guarded or controlled.
- **The arbor size of wheels, flanges, backing pads, or any other accessory must properly fit the spindle of the power tool.** Accessories with arbors that do not match the mounting hardware of the power tool will run out of balance, vibrate excessively and may cause loss of control.
- **Do not use a damaged accessory. Before each use inspect the accessory such as abrasive wheels for chips and cracks, backing pad for cracks, tear or excess wear, wire brush for loose or cracked wires. If power tool or accessory is dropped, inspect for damage or install an undamaged accessory. After inspecting and installing an accessory and run the power tool at maximum no-load speed for one minute.** Damaged accessories will normally break apart during this test time.



WARNING! Read all safety warnings and all instructions. Failure to follow the warnings and instructions may result in electric shock, fire and/or serious injury.

Save all warnings and instructions for future reference.

- **Wear personal protective equipment.** Depending on application, use face shield, safety goggles or safety glasses. As appropriate, wear dust mask, hearing protectors, gloves and workshop apron capable of stopping small abrasive or workpiece fragments. The eye protection must be capable of stopping flying debris generated by various operations. The dust mask or respirator must be capable of filtering particles generated by your operation. Prolonged exposure to high intensity noise may cause hearing loss.
- **Keep bystanders a safe distance away from work area. Anyone entering the work area must wear personal protective equipment.** Fragments of workpiece or of a broken accessory may fly away and cause injury beyond immediate area of operation.
- **Hold power tool by insulated gripping surfaces only, when performing an operation where the cutting accessory may contact hidden wiring or its own cord.** Cutting accessory contacting a “live” wire may make exposed metal parts of the power tool “live” and shock the operator.
- **Position the cord clear of the spinning accessory.** If you lose control, the cord may be cut or snagged and your hand or arm may be pulled into the spinning accessory.
- **Never lay the power tool down until the accessory has come to a complete stop.** The spinning accessory may grab the surface and pull the power tool out of your control.
- **Do not run the power tool while carrying it at your side.** Accidental contact with the spinning accessory could snag your clothing, pulling the accessory into your body.
- **Regularly clean the power tool’s air vents.** The motor’s fan will draw the dust inside the housing and excessive accumulation of the material or powdered metal may cause electrical hazards.
- **Do not operate the power tool near flammable materials.** Sparks could ignite these materials.
- **Do not use accessories that require liquid coolants.** Using water or other liquid coolants may result in electrocution or shock.
- **Maintain a firm grip on the power tool and position your body and arm to allow you to resist kickback forces. Always use auxiliary handle, if provided, for maximum control over kickback or torque reaction during start-up.** The operator can control torque reactions or kickback forces, if proper precautions are taken.
- **Never place your hand near the rotating accessory.** Accessory may kickback over your hand.
- **Do not position your body in the area where power tool will move if kickback occurs.** Kickback will propel the tool in a direction opposite to the wheel’s movement at the point of snagging.
- **Use special care when working corners, sharp edges, etc. Avoid bouncing and snagging the accessory.** Corners, sharp edges or bouncing have a tendency to snag the rotating accessory and cause loss of control or kickback.
- **Do not attach a saw chain woodcarving blade or toothed saw blade.** Such blades create frequent kickback and loss of control.
- **Do not use excessively oversized sanding discs. This tool is designed to use only the sanding disc sold with the tool, or replacement purchased from the manufacturer or manufacturer representative. Do not purchase or install any type of sanding disc that uses paper, or any other accessory not purchased directly from the manufacturer or manufacturer representative.**

General Description

The Paint Eater™ is an excellent surface preparation tool when preparing solid wood, wood siding and masonite siding for paint. **Do not use Paint Eater™ on textured siding or shakes.**

The Paint Eater™ has been designed to perform a number of tasks associated with surface preparation. It will remove paint chips and feather the paint edges; it can be used to remove paint oxides and mildew; and will abrade the painting surface and provide for excellent paint adhesion. The Paint Eater™ is the perfect surface preparation tool for large, flat, solid surfaces.

IMPORTANT - This tool is intended for outdoor use only on solid wood, masonite siding, wood siding, concrete and steel for paint preparation. If the surface you want to prepare for paint is rotted or damaged, it should be replaced.

Parts and Components

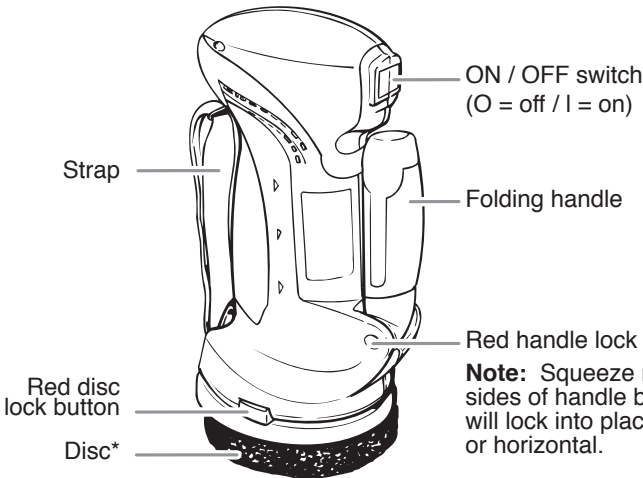

Specifications

Amps	3.2
Volts.....	120VAC, 60Hz
r/min.....	2600
Disc size	4.5 inches

Note: Squeeze red buttons on both sides of handle base to unlock. Handle will lock into place when fully vertical or horizontal.

* Replacement discs: P/N 0513041
(not to be used with anything other than the Paint Eater™)

** The power cord on this tool is not replaceable.

Hand Positions

See the graphics below for the different options for hand placement when using the Paint Eater™. The Paint Eater™ can be used whether you are right- or left-handed.



Usage



Wear an NIOSH/OSHA approved respirator, safety glasses and gloves when using the Paint Eater™.

IMPORTANT - The Paint Eater™ should be used only on clean, dry surfaces. Do not use in conjunction with any paint removal chemicals.

1. Make sure the OFF (O) switch is pressed, and plug in the power cord.
2. Place hands onto unit using one of the methods shown on the previous page.
3. Turn the switch ON (I), and place the rotating disc onto the surface you want to prepare.

Tips:

- Test the Paint Eater™ in an inconspicuous place or on a piece of scrap wood to become accustomed to the tool.
- Hold the disk flat to the surface to remove large paint chips or to feather paint edges. **Do not force tool or hold the disc in one place for too long or the painting surface can become damaged. Too much force will cause the motor to slow down and overheat, and will cause premature wear on the sanding disc.**



- Hold the disc on its edge to remove paint chips that are more difficult to remove. The outer edges of the disc can be used to prepare underneath lap siding.

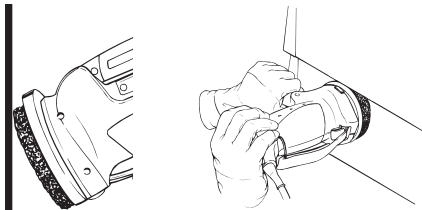

- After a period of operation, check the disc to see if paint is sticking to the disc. Too much paint embedded into the disk will affect performance and should be removed. Run the disc momentarily on a concrete sidewalk or a large concrete block. This will knock the paint loose from the disc. Make sure cleaning surface is stable and disc is placed flat onto the cleaning surface. Do not hold block used for cleaning in your hand. Do not immerse the disc into a solvent, such as turpentine.

Changing the disc

The disc on the Paint Eater™ will wear out over time and will need to be changed. You can find new discs at the original retailer where you purchased the Paint Eater™, or by calling customer service at 1-800-727-4023 and ordering replacement discs (part number 0513041).

To change discs, follow the instructions below.

1. Make sure the unit is turned OFF (O) and unplugged. Press the disc lock on the bottom of the unit and unscrew the disc by turning it counterclockwise.
2. While pressing the disc lock on the bottom of the unit, thread new disc onto unit by turning it clockwise and tightening by hand.

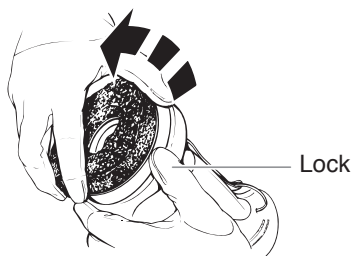
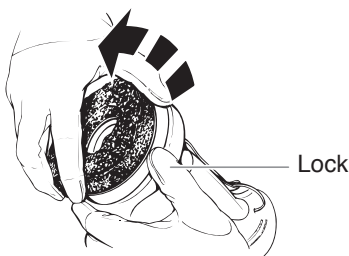

Inspection and Cleaning



Make sure the Paint Eater™ is turned OFF (O) and unplugged before performing any inspection or cleaning.

Before using, inspect the general condition of the Paint Eater™. Check for loose screws, a cracked, broken, or worn disc, a damaged power cord or any other condition that could affect the safe operation of the Paint Eater™. If the Paint Eater™ makes an abnormal noise or vibration, take it to an authorized service center for repair. **Do not use damaged equipment.**

IMPORTANT: Use only a clean cloth and mild detergent to clean the body of the Paint Eater™. Do not use solvents or immerse the Paint Eater™ into any liquid.