

WAGNER®

PREP FAST. PREP SMART.

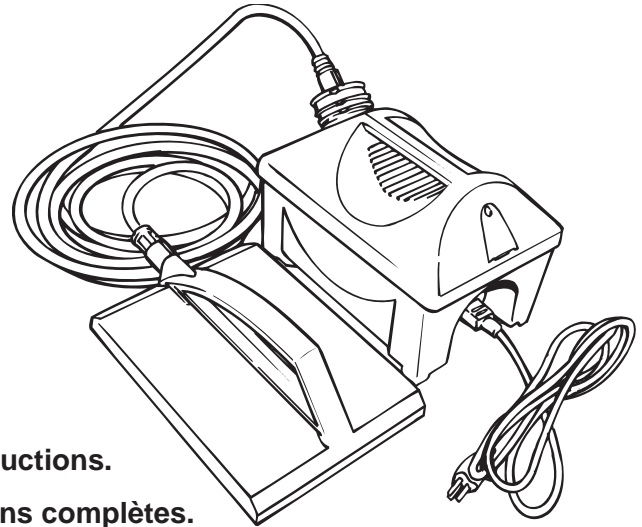

Power Steamer™

Owner's Manual • Read this manual for complete instructions.

Guide d'utilisation • Ce manuel contient les instructions complètes.

Manual del propietario • Lea este manual para obtener instrucciones completas.



1
Read all warnings
Lisez tous les avertissements
Lea todas las advertencias

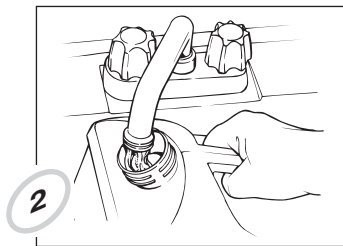

2
Fill container
Remplissez le réservoir
Llene el recipiente

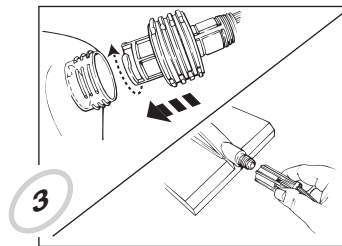

3
Attach hose
Attachez le tuyau
Enchufe la manguera

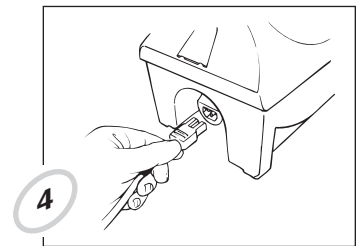

4
Attach cord
Attachez le cordon électrique
Enchufe el cable

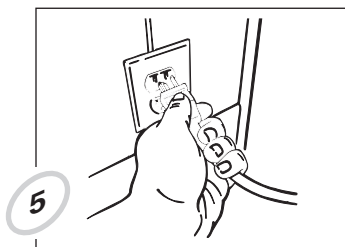

5
Plug in power cord
Branchez l'appareil à prise de courant
Enchufe el cable en el tomacorriente

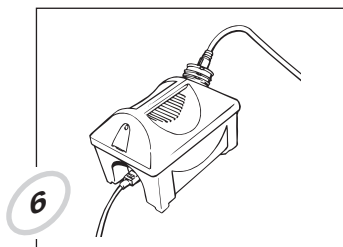

6
Allow unit to heat
Laissez l'appareil chauffer
Deje calentar al unidad

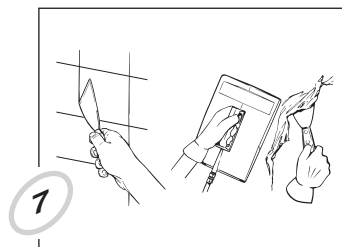

7
Score and remove wallpaper
Coupez le papier et enlevez-le
Raspe y retire el papel de la pared

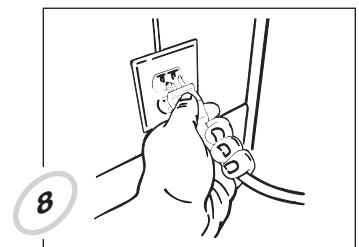

8
Unplug power cord
Débranchez le cordon électrique
Desenchufe el tomacorriente

1-800-727-4023
Wagner Technical Service
Register your product online at
Enregistrement du produit en ligne sur le site :
Regístrelo del producto en línea en
<http://www.wagnerspraytech.com>

Need Help?
Call us first for answers fast.
Call Wagner Spray Tech toll-free if you have any comments or problems with this product.

Besoin d'aide?
Appelez-nous pour des réponses rapides.
Téléphonez à Wagner sans frais d'appel si vous avez des commentaires ou des problèmes avec l'appareil.

¿Necesita Ayuda?
Llámenos primero para obtener respuestas rápidas.
Llame a la línea gratuita de Wagner si quiere hacer un comentario o tiene problemas con este producto de Wagner.



Important Safety Information - Read all safety information before operating the equipment. SAVE THESE INSTRUCTIONS.

To reduce the risks of fire or explosion, electrical shock and the injury to persons, read and understand all instructions included in this manual. Be familiar with the controls and proper usage of the equipment.



This symbol indicates a hazardous situation, which, if not avoided could result in death or serious injury.

HAZARD: Hot steam and parts. May cause injury, including skin burns or property damage. Temperatures exceed 212° F (100°C).



PREVENTION:

- Stay clear of steam, hose, hose fittings and steam plate surface. DO NOT place hand in front of steam plate.
- Water drops are hot and may burn skin. Use extreme caution when using steam plate overhead, and routinely empty water from steam plate. Wear eye protection and gloves when using this steamer.
- Allow parts to cool before changing accessories and /or opening fill cap.
- Never point steam plate at anyone.
- DO NOT over fill water container.
- DO NOT strain or kink hose. Replace hose if it is cracked, worn, or damaged. Never repair a damaged hose.

HAZARD: Fire. May cause severe injury and/or property damage.



PREVENTION:

- DO NOT allow water to boil dry. Boiling dry may cause overheating and fire.
- DO NOT allow water or steam to enter light switches or sockets.

HAZARD: Electrical Shock. May cause severe injury.



PREVENTION:

- Power cord must be connected to grounded (3 prong) outlet.
- DO NOT use the unit if the power cord is worn or damaged. Never repair a power cord.
- DO NOT pull water container by power cord.
- DO NOT allow water or steam to enter light switches or sockets.

HAZARD: General. May cause injury and/or property damage.

PREVENTION:

- DO NOT stand or sit on water container. (Use a step ladder.)
- DO NOT modify parts or components. Never repair damaged or worn parts.
- Water container must rest on a sturdy, level surface and in upright position.
- Keep power steamer away from children.
- NEVER leave power steamer unattended.
- Read all instructions and warnings before each use.

Grounding Instructions

This product should be grounded. In the event of an electrical short circuit, grounding reduces the risk of electric shock by providing an escape wire for the electric current. This product is equipped with a cord having a grounding wire with an appropriate grounding plug. The plug must be plugged into an outlet that is properly installed and grounded in accordance with all local codes and ordinances.

WARNING! — Improper installation of the grounding plug can result in a risk of electric shock.

If repair or replacement of the cord or plug is necessary, have your nearest Wagner Authorized Service Center replace it. Check with a qualified electrician or serviceman if the grounding

instructions are not completely understood, or if in doubt as to whether the product is properly grounded. Do not modify the plug provided; if it will not fit the outlet, have the proper outlet installed by a qualified electrician.

Extension Cords

Use only a 3-wire extension cord that has a 3-blade grounding plug, and a 3-slot receptacle that will accept the plug on the product. Make sure your extension cord is in good condition. When using an extension cord, be sure to use one heavy enough to carry the current your product will draw. An undersized cord will cause a drop in line voltage resulting in loss of power and overheating. For lengths up to 100 feet, use 14 AWG extension cords.

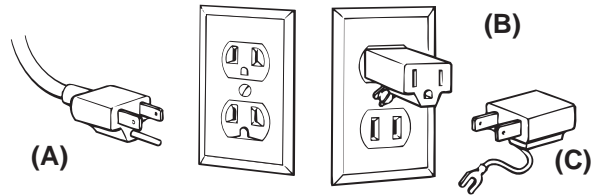

Thermal Safety Fuse Reset

Always fill the unit before plugging it in. If the steamer is plugged in before it is filled with water, or if the steamer is allowed to run dry, a thermal safety fuse will open, causing the unit to turn off. If this happens, unplug the unit and allow it to cool for at least 10 minutes. The safety fuse will reset itself.

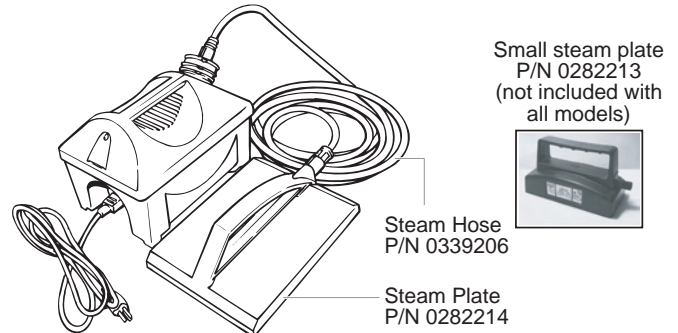

NOTE: The water container, heating element and hose are not serviceable. Should a problem occur with the steamer, contact Wagner Technical Service.

Small Steam Plate (not included with all models)



Always wear protective gloves and eye protection when using the small steam plate.



The small steam plate can be used to strip wallpaper in small awkward areas, such as around door frames, between windows, in corners, etc.

Setup / Usage:

1 Fill with clean tap water. Do not exceed water level shown.



SKIN BURN HAZARD. Water container must rest on a sturdy, level surface and in upright position.

Filling the steamer with hot water will greatly reduce the time to produce steam. A full container will operate for about 70 minutes.

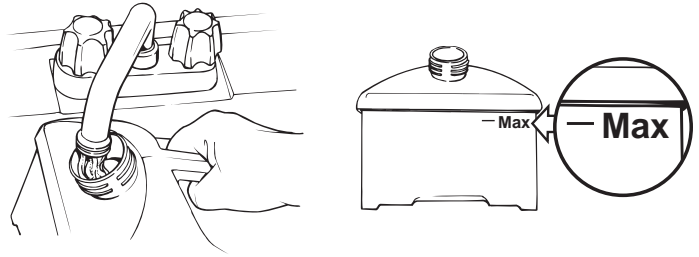

2 Line up notch in hose receptacle (a) with the guide on the hose (b). Insert hose and turn **clockwise** approximately 130°. Hand-tighten locking nut. **DO NOT cross-thread the locking nut.**

Connect other end of hose to the steam plate. Hand-tighten fitting onto plate.

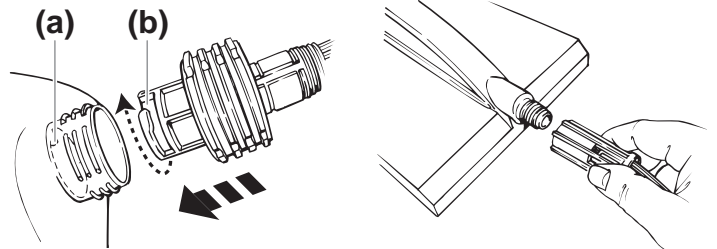

3 Connect matching end of cord to the steamer. Plug in the power cord.



Make sure steamer is placed on a sturdy, level surface.

Once the power cord is plugged in, it will take about 12-15 minutes to produce steam. **DO NOT** leave steam plate unattended, or face down on any surfaces.

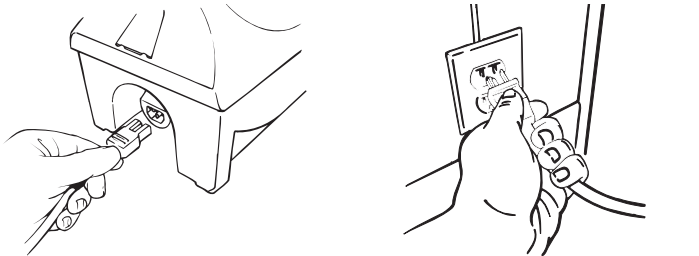

4 For best results, use a scoring tool or a putty knife and gently score the wallpaper in a crisscross pattern. The perforations will allow the steam to penetrate the wallpaper.

Once steam is flowing out of the steam plate, hold the steam plate flat against the scored wallpaper for about 10 seconds. Move the steam plate to a new section and remove the steamed section with the scraper blade.

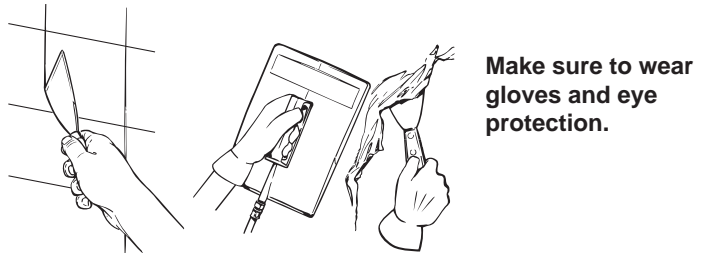

5 **DO NOT operate the steamer once the water container is empty.**

To refill, unplug power cord and let steamer cool for 2 minutes. **SLOWLY** remove steam hose and refill the container. Replace hose, plug in power cord and allow unit to reheat.

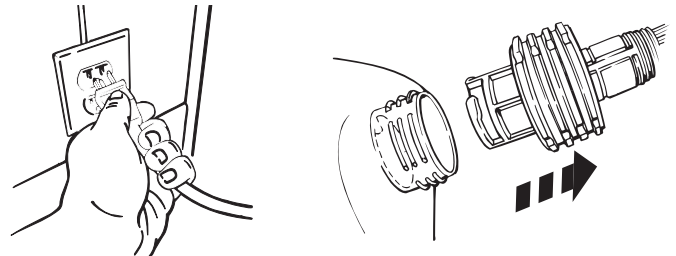

Storage :

1 Unplug the steamer from the power source.

Wait a minimum of 2 minutes and slowly open the hose connection.

Drain remaining water from the container. **NEVER** store the unit with water in the container.

