

WIRING INSTRUCTIONS

TITLE **SDS-MAX COMBINATION and DEMOLITION HAMMERS**

BULLETIN

MILWAUKEE ELECTRIC TOOL CORP. 13135 WEST LISBON RD. BROOKFIELD, WIS.

DATE

58-01-5400

Sept. 2014

NOTE:

Early production and service switches were designed without a jumper wire. Wires 5 and 6 connect to switch as shown in Fig. 1. Replacement service switches now have a **jumper wire (23-94-0018)**. Wires 5 and 6 should be connected to switch as shown in Fig. 2.

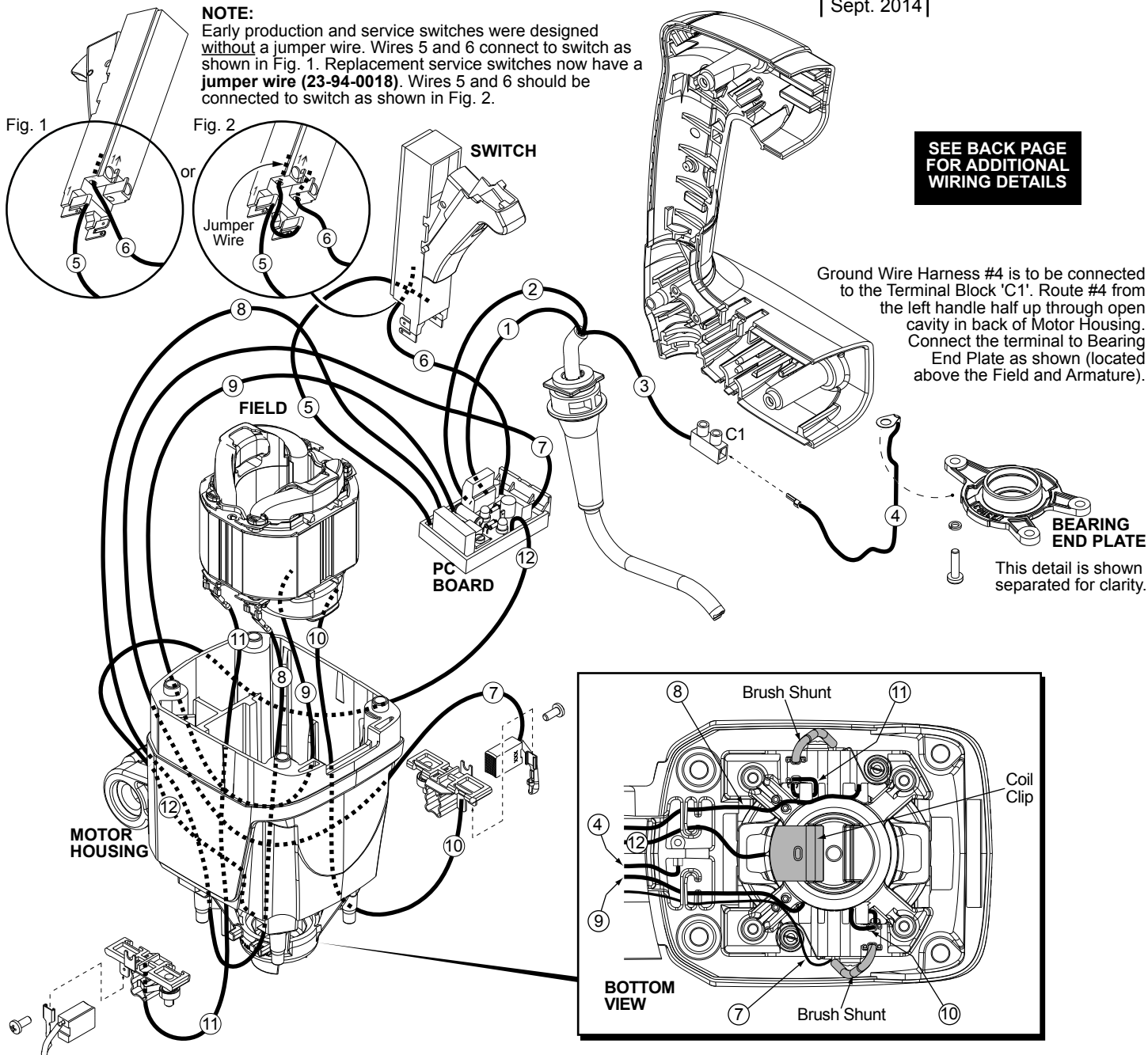

SEE BACK PAGE FOR ADDITIONAL WIRING DETAILS

Ground Wire Harness #4 is to be connected to the Terminal Block 'C1'. Route #4 from the left handle half up through open cavity in back of Motor Housing. Connect the terminal to Bearing End Plate as shown (located above the Field and Armature).

BEARING END PLATE

This detail is shown separated for clarity.

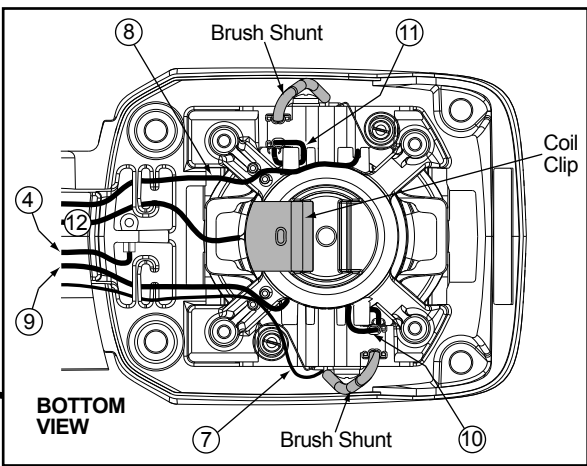

WIRING SPECIFICATIONS

Wire No.	Wire Color	Origin or Gauge	Length	Terminals, Connectors and 1 or 2 End Wire Preparation
1	Black	22-64-0880	-----	Component of Cord Set, connect to PC Board.
2	White	22-64-0880	-----	Component of Cord Set, connect to PC Board.
3	Green	22-64-0880	-----	Component of Cord Set, connect to Terminal Block C1.
4	Green	23-94-0430	-----	Ground Wire Harness. Connect to C1 and to Bearing End Plate.
5	Black	14-20-0340	-----	Component of PC Board, connect to switch per Fig. 1 or Fig. 2.
6	Black	14-20-0340	-----	Component of PC Board, connect to switch per Fig. 1 or Fig. 2.
7	Brown	22-22-0046	-----	Component of 2 wire Carbon Brush Assy., connect to PC Board.
8	Blue	14-20-0340	-----	Component of PC Board, connect to Field as shown.
9	Red	14-20-0340	-----	Component of PC Board, connect to Field as shown.
10	Red	23-94-0110	-----	Wire Harness. Connect to Field & Brush Holder Assy. as shown.
11	Red	23-94-0110	-----	Wire Harness. Connect to Field & Brush Holder Assy. as shown.
12	Gray/Blk	14-20-0340	-----	Component of PC Board, clip coil holder to bottom of Motor housing.

AS AN AID TO REASSEMBLY, TAKE NOTICE OF WIRE ROUTING AND POSITION IN WIRE GUIDES AND TRAPS WHILE DISMANTLING TOOL.

BE CAREFUL AND AVOID PINCHING WIRES BETWEEN HANDLE HALVES WHEN ASSEMBLING.

NOTE:
All leads must be held to ± 1/8".
All lead lengths are before stripping.

TERMINAL DESCRIPTION

Code	Part No.	Qty.
C1	22-56-0010	1

BULK LEAD WIRE - BULLETIN NO. 58-01-0003

