

Manual Contents

Safety Instructions	2
Assembly.....	4-13
Operation.....	2
Maintenance.....	11
Parts.....	14-15
Warranty.....	16

Your Lawn Sweeper

Congratulations on your purchase of a new Precision Products, Inc. Lawn Sweeper. Your Lawn Sweeper has been engineered and built to give you the most dependable and best performing product possible.

If you experience any problem you can not easily resolve, please feel free to contact our knowledgeable and helpful customer service department toll-free at **1 (800) 225-5891**.

Caution: Carefully read all rules and instruction for safe operation. Retain this manual for reference.



Safety Instructions

All power equipment can cause injury or property damage if operated improperly. Please read and observe the following safety rules and exercise caution at all times when operating equipment.

- Read and understand your tractor owner's manual and towing safety rules, know how to operate your tractor before using any attachment.
- Never allow children to operate the towing vehicle. Do not allow adults to operate the vehicle without having read the owner's manual or receiving proper instruction.
- Do not allow anyone to ride or sit on the tow behind equipment during operation.
- Keep adults, children and animals at a safe distance.
- Always wear substantial footwear. Do not wear loose fitting clothing that may get caught in moving parts.
- Keep your eyes and mind on your tractor/attachment and area being covered. Do not let yourself be distracted.
- Stay alert for holes in the terrain and other hidden hazards.
- Tractor braking and stability may be affected with the attachment of this unit. Be aware of changing conditions on slopes. Refer to safety rules in your tractor owner's manual concerning safe operation on slopes. **Stay Off Steep Slopes.**
- Always operate up and down a slope, never across the face of a slope.
- This equipment should be operated at reduced speed(s) on rough terrain and on hillsides to prevent tipping or loss of control.
- Do not operate close to creeks, ditches or public highways.
- Always begin with the transmission in first (low) gear and the engine at low speed, and gradually increase speed as conditions permit.
- Keep the tractor and attachment in good operating condition and keep safety devices in place.
- Keep all nuts, bolts and screws tight to be sure the equipment is in safe working condition.
- The tractor and attachment should be stopped and inspected for damage after striking a foreign object. Any damage should be repaired before restarting and operating the equipment.
- Follow the maintenance instructions as outlined in this owner's manual.
- Do not exceed maximum towing speed of 4 miles per hour.
- Do not Allow the Hamper Dump Rope to have too much slack, when operating, the rope can get caught

Parts and Support



Please do not return this product to the store prior to contacting Precision.

At Precision Products, Inc. our goal is to deliver quality, value and outstanding service. If for any reason our product does not meet your expectations, please contact us and we will take care of any problem you may have with this unit.

When ordering replacement parts please have the model number, part description, part number, inspector number and date on box, available so that we can best serve you.

1 (800) 225-5891

www.precisionprodinc.com

**Precision Products Inc.
316 Limit St.
Lincoln IL 62656**

Carton Contents pages 3 & 4

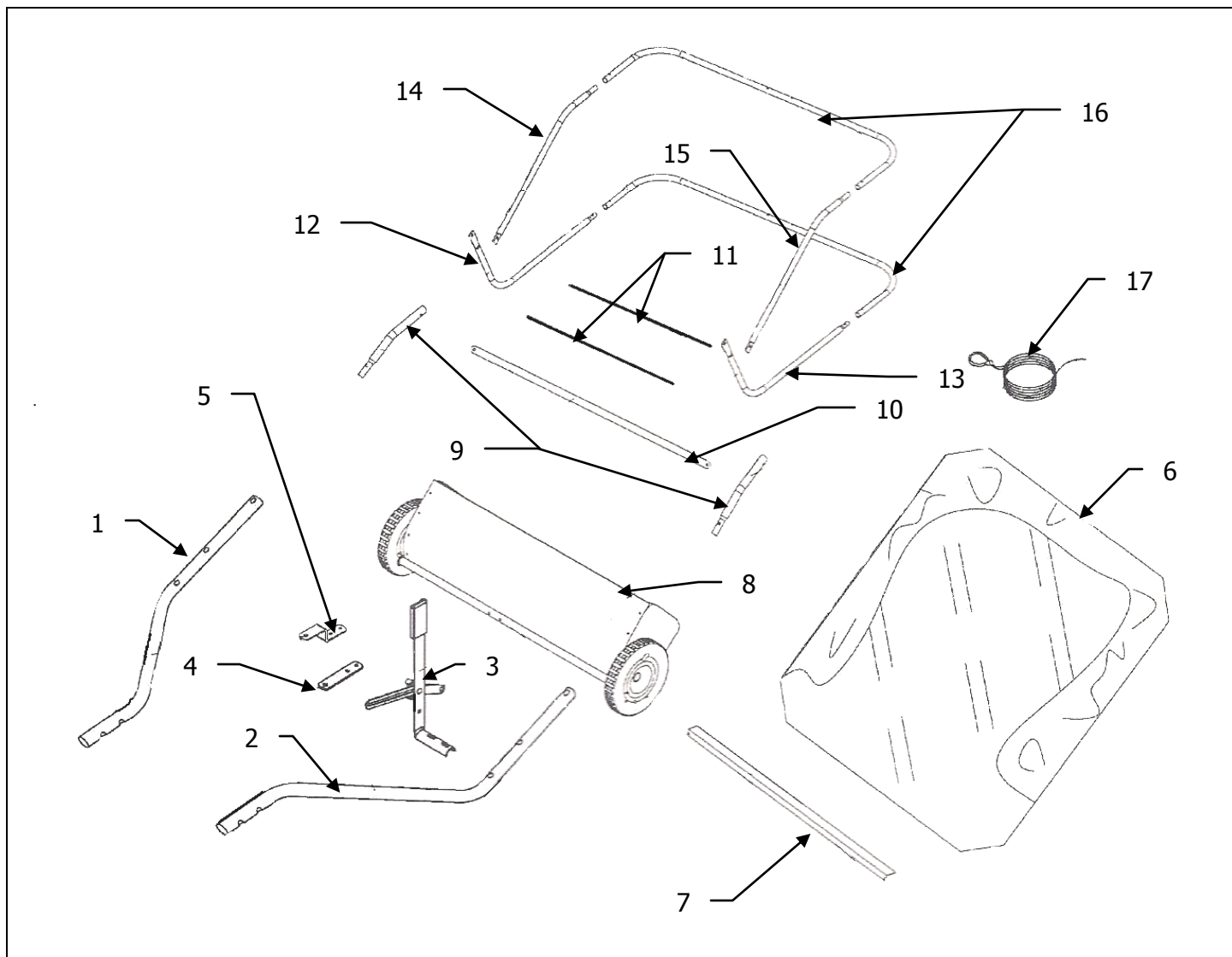

Ref.	Qty.	Description
1	1	Hitch Tube R.H.
2	1	Hitch Tube L.H.
3	1	Handle Assembly
4	1	Clevis Plate (straight)
5	1	Clevis Plate
6	1	Hopper Bag
7	1	Connecting Bar
8	1	Sweeper Housing Assembly
9	2	Bag Arm Tube

Ref.	Qty.	Description
10	1	Bag Frame Strap
11	2	Hopper Support Rod
12	1	Lower Hopper Side Tube R.H.
13	1	Lower Hopper Side Tube L.H.
14	1	Upper Hopper Side Tube R.H.
15	1	Upper Hopper Side Tube L. H.
16	2	Rear Hopper Tube
17	1	Rope

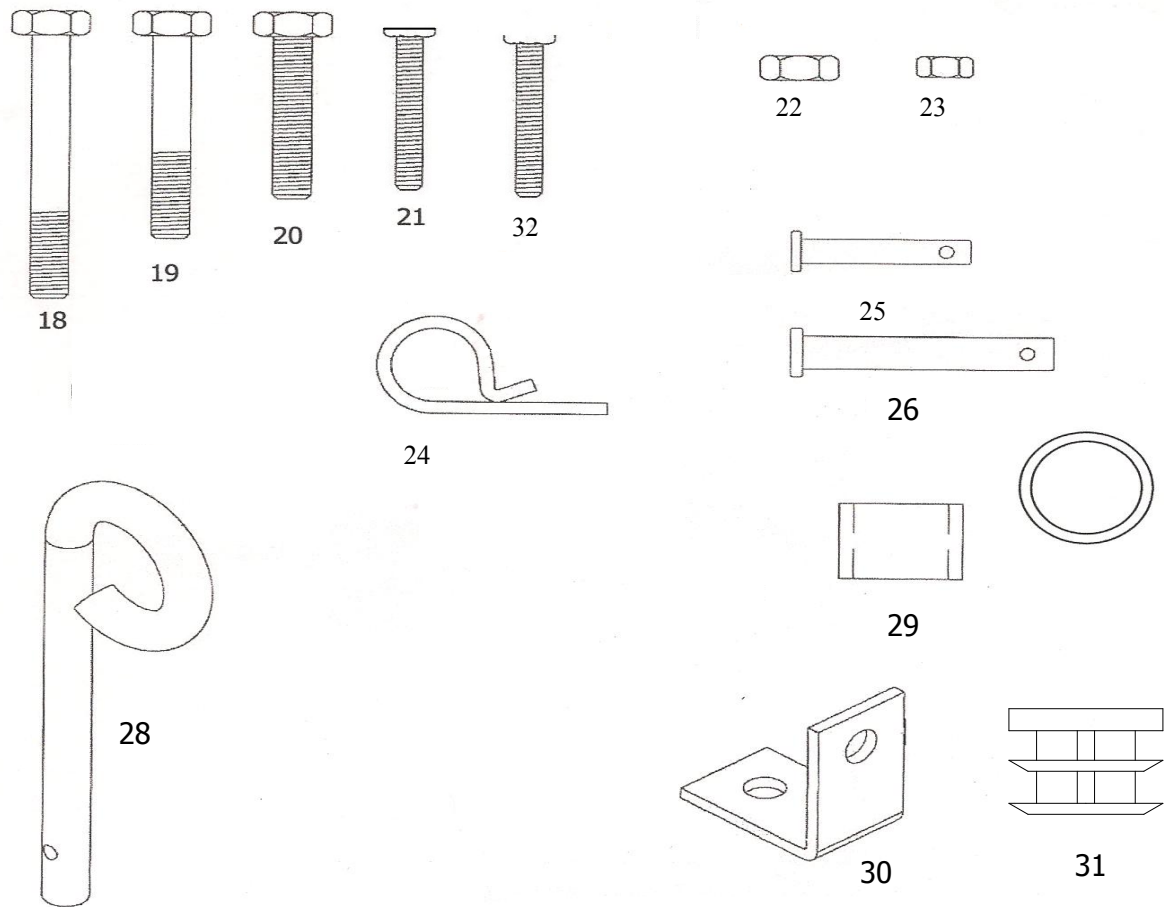

Ref.	Qty.	Description
18	2	Hex Head Bolt M8x65
19	2	Hex Head Bolt M8x50
20	2	Hex Head Bolt M8x40
21	6	Allen Head Bolt M6x30
22	6	Nylock Nut M8
23	10	Nylock Nut M6
24	7	Hitch Pin Clip 03
25	2	Clevis Pin 08x37
26	2	Clevis Pin 08x58

Ref.	Qty.	Description
27	2	Clevis Pin 08x25 (Not Shown)
28	1	Hitch Pin
29	2	Hitch Spacer
30	1	Angle Bracket
31	2	Tube Plug
32	4	Allen Head Bolt M6x40

Assembly

Remove the Hardware Sack or (hardware may be attached to other parts) and all loose parts from the carton and verify that all the Parts and Fasteners shown on pages 3 and 4 are included.

Assembly Instructions

Note Right hand (R.H.) and Left hand (L.H.) are determined from the operator's position while seated on the Tractor.

1. (Pre-Assembled at Factory) Assemble the Angle Bracket to the Sweeper Housing using a M8x16 Hex Head Bolt and a M8 Nylock Nut. Make sure the Angle Bracket is turned as shown and aligned straight with the housing and tighten. See Figure 1.

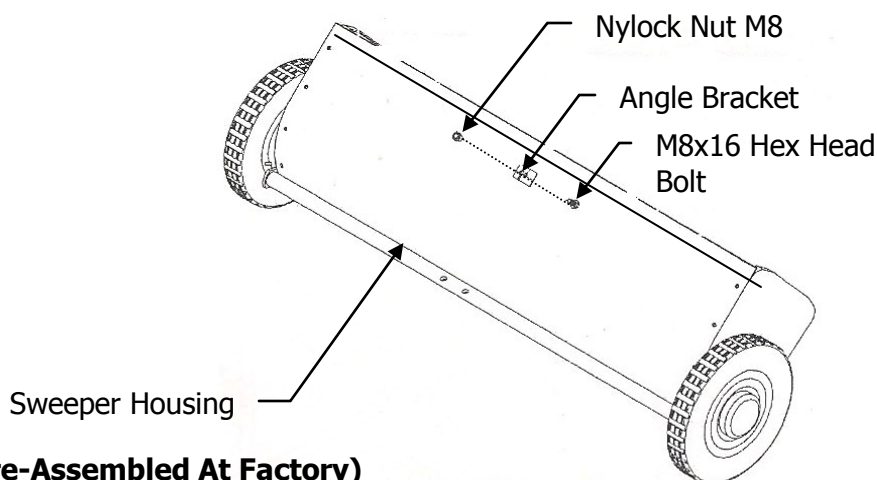

Figure 1 (Pre-Assembled At Factory)

2. Assemble the R. H. Hitch Tube to the Sweeper Housing using two M6x40 Bolt and two M6 Nylock Nuts (hand tighten only at this time), insert Tube Plug into Hitch Tube. Then repeat the process on the L. H. Hitch Tube. See Figure 2.

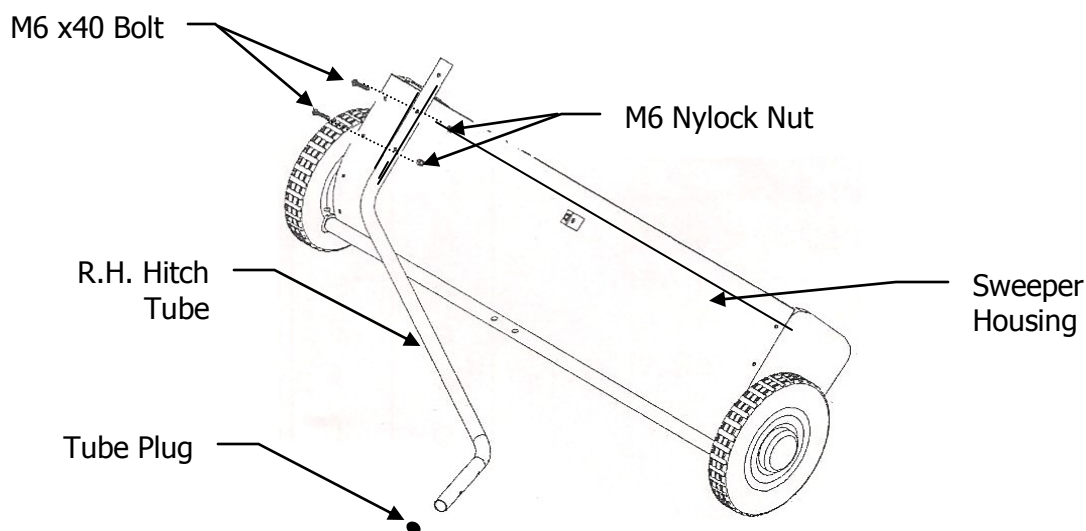
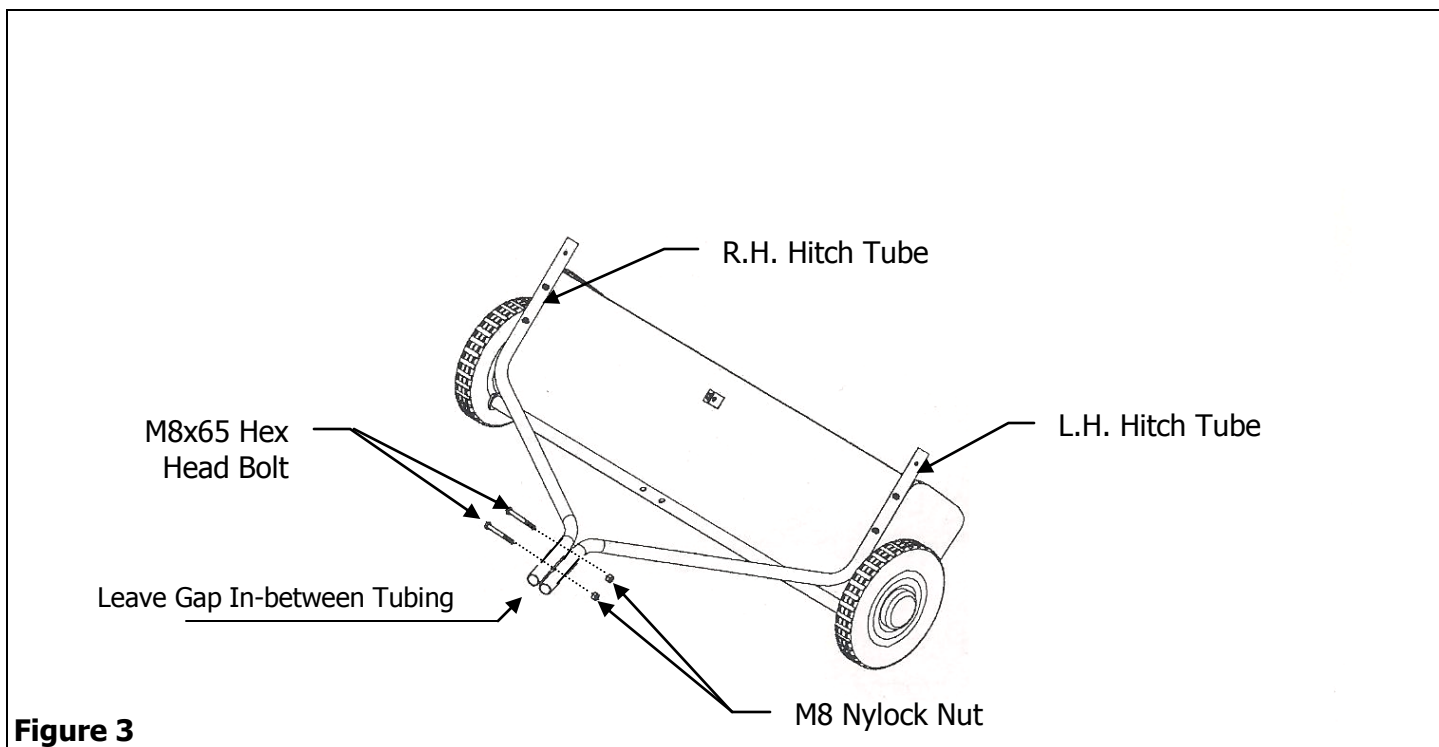

Figure 2

3. Attach the Hitch Tubes together using two M8x65 Hex Head Bolts and two M8 Nylock Nuts. Do not tighten yet. See Figure 3.



If your tractor hitch is between 11" to 13" of ground clearance see Figure 4. If your tractor hitch has between 8" to 11" of ground clearance see Figure 5.

4. Assemble the Clevis Plates to the Hitch Tubes using two M8x50 Hex Head Bolts and two M8 Nylock Nuts. The bolts should straddle the front Hitch Tube Bolts. At this time tighten the four bolts attaching the Hitch Tubes to the Sweeper Housing. See Figure 4 or 5.

5. Tighten the two bolts attaching the ends of the Hitch Tubes together. Now, tighten the two bolts attaching the Clevis Plates to the Hitch Tubes. Attach the Hitch Pin, Spacers and the Hitch Pin Clip to the Hitch Brackets. See Figure 4 or 5.

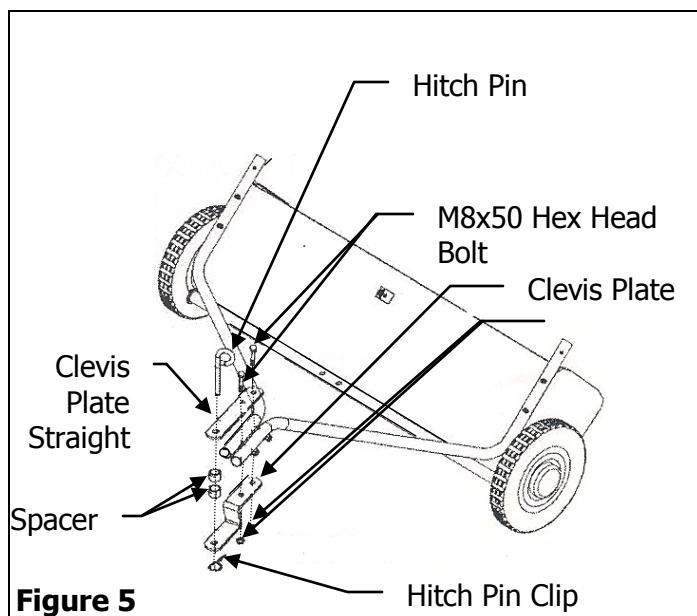
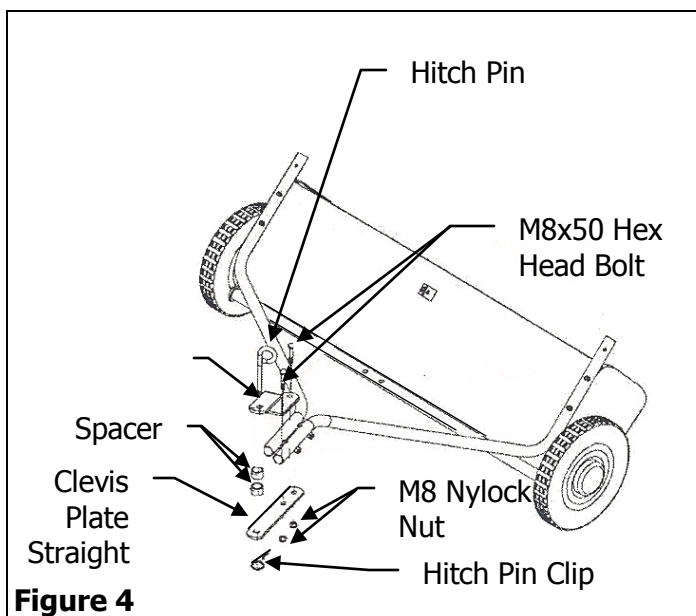

6. Attach the Height Adjustment Handle to the Height Adjustment Tube, using two M8x40 Hex Head Bolts and two M8 Nylock Nuts. Do not tighten yet. See Figure 6.

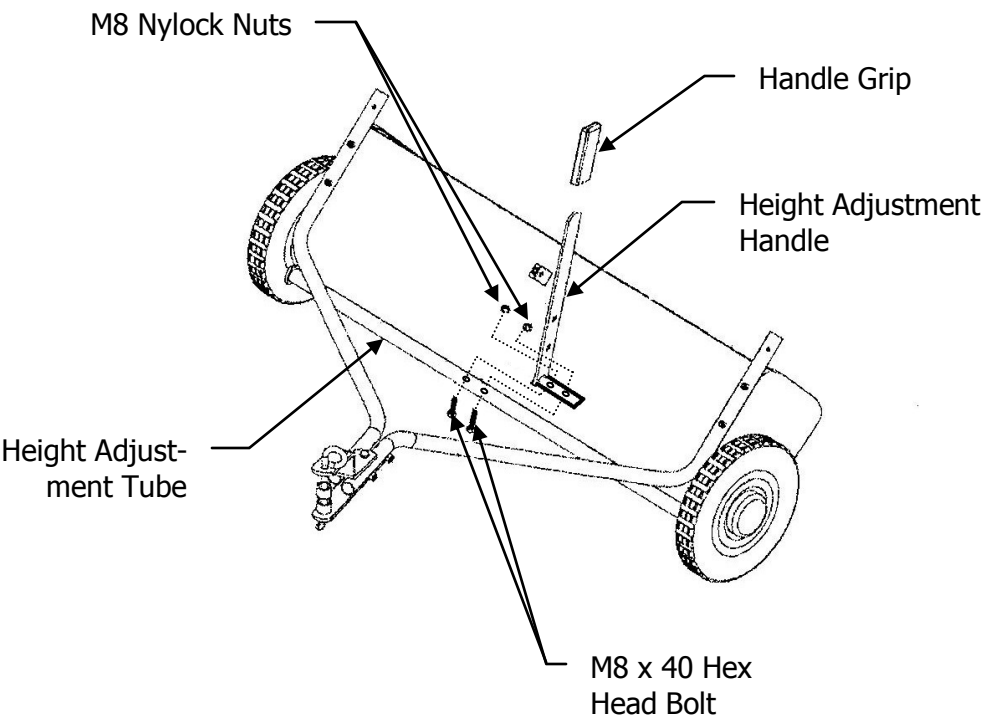

Figure 6

7. **(Pre-Assembled At Factory)** Insert a M8x20 Hex Head Bolt through Angle Bracket into the Height Adjustment Strap, attach the Flat Washer and secure with a M8 Nylock Nut. See Figure 7.

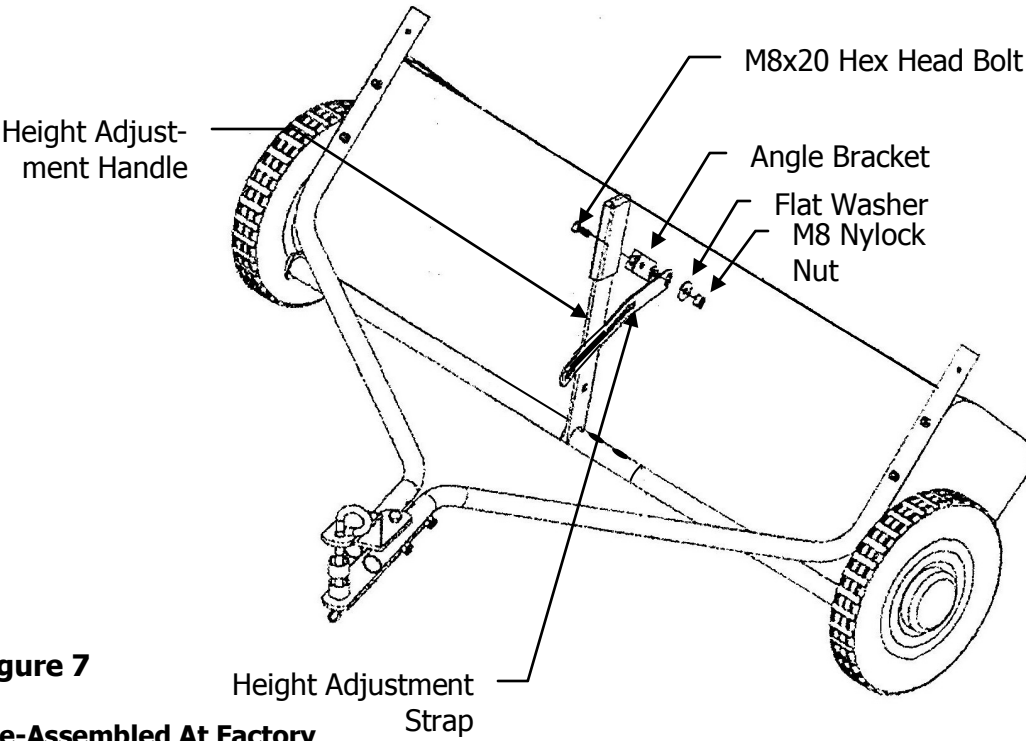
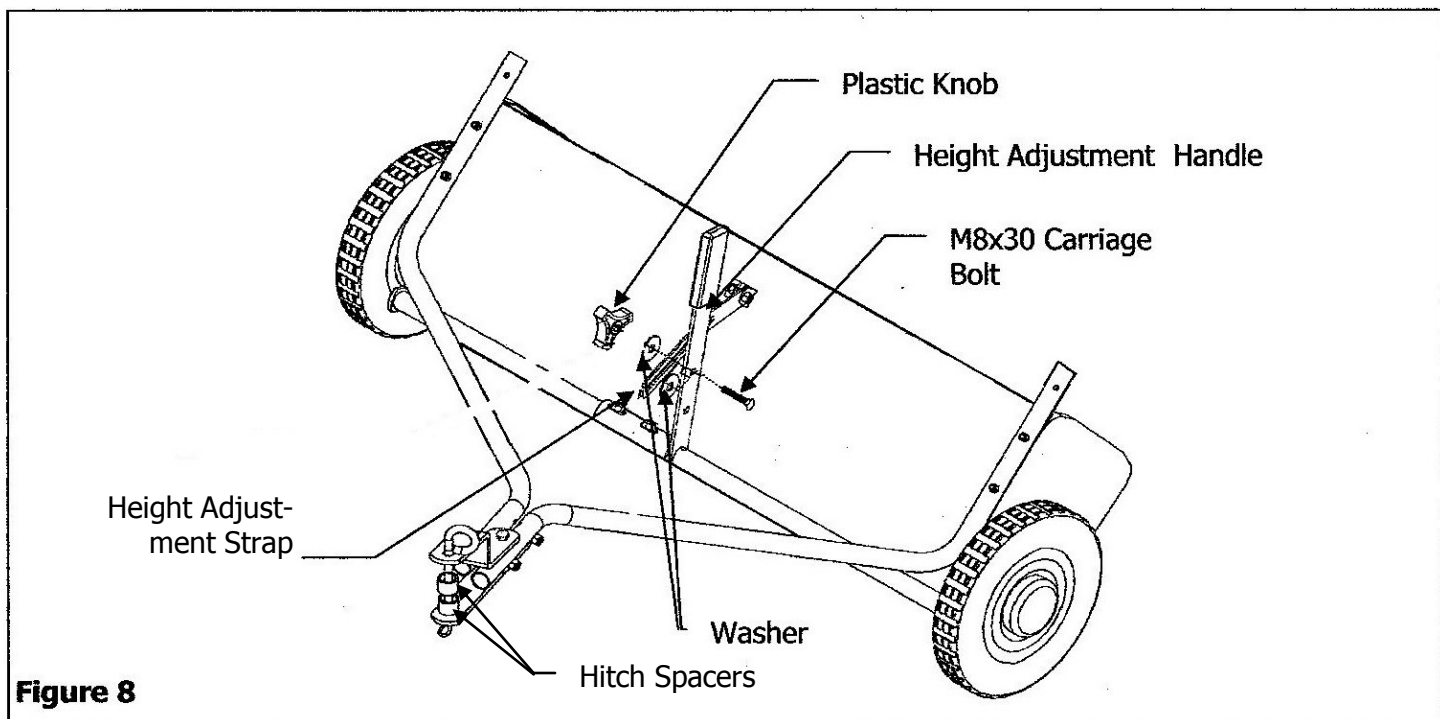

Figure 7

Pre-Assembled At Factory

8. Insert a M8x30 Carriage Bolt into the Height Adjustment Handle, into a Washer, into the Height Adjustment Strap, place another Washer onto the Bolt and secure with the Plastic Knob. See Figure 8.



9. **(Pre-Assembled At Factory)** Assemble the Connecting Bar to the Sweeper Housing by using two M6x12 Hex Head Bolts and secure with two M6 Nylock Nuts.

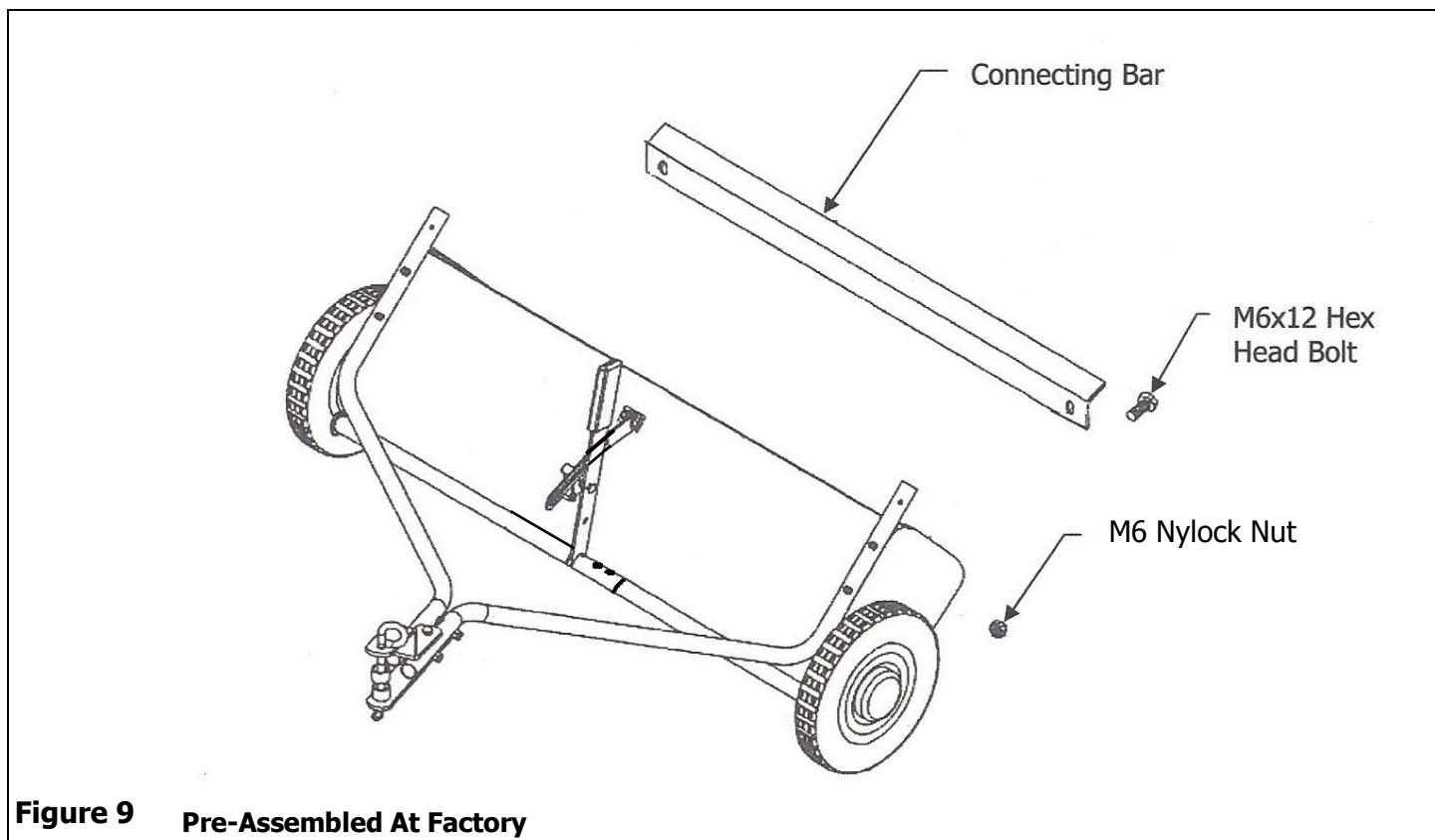

10. Turn a Rear Hopper Tube so that the Brace Holes in the middle of the tube face down. Slide the tube through the two loops sewn to the top rear seam inside of the hopper bag. See Figure 10.

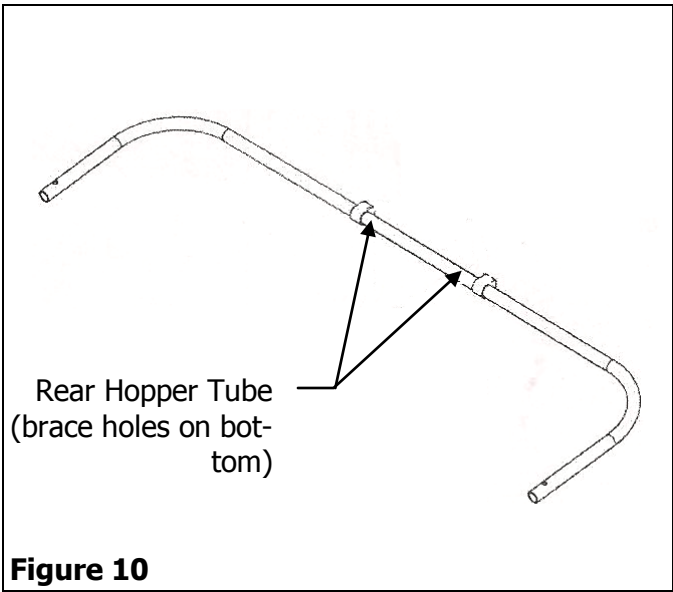

11. Insert the two Hopper Side Tubes through the stitched flaps on each side of the Hopper Bag. Assemble the ends of the Rear Hopper Tube onto the ends of the Upper Hopper Side Tubes, insert M6x30 Bolt into the holes and secure with a M6 Nylock Nut. See Figure 11.

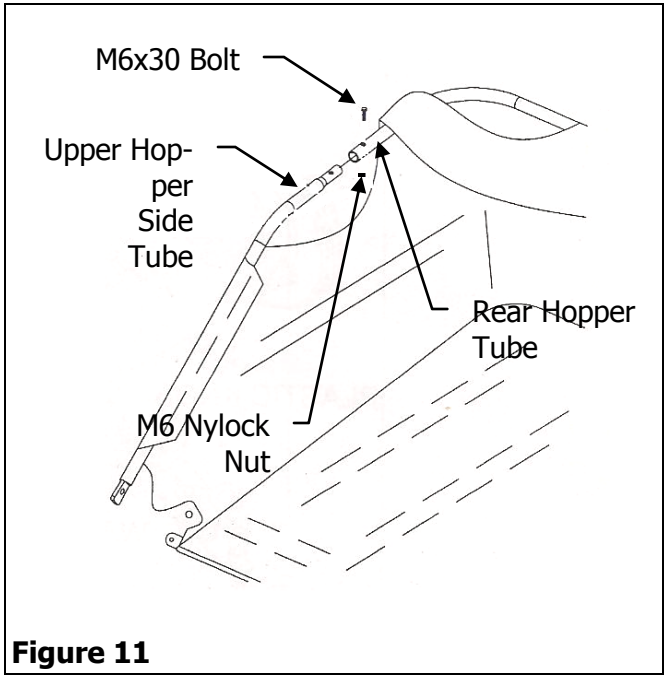

12. Turn the second Rear Hopper Tube so that the Brace Holes in the middle of the tube face up. Assemble the ends of the Rear Hopper Tube onto the ends of the Lower Hopper Side Tubes. Attach them using M6x30 Bolt and secure with a M6 Nylock Nut. See Figure 12.

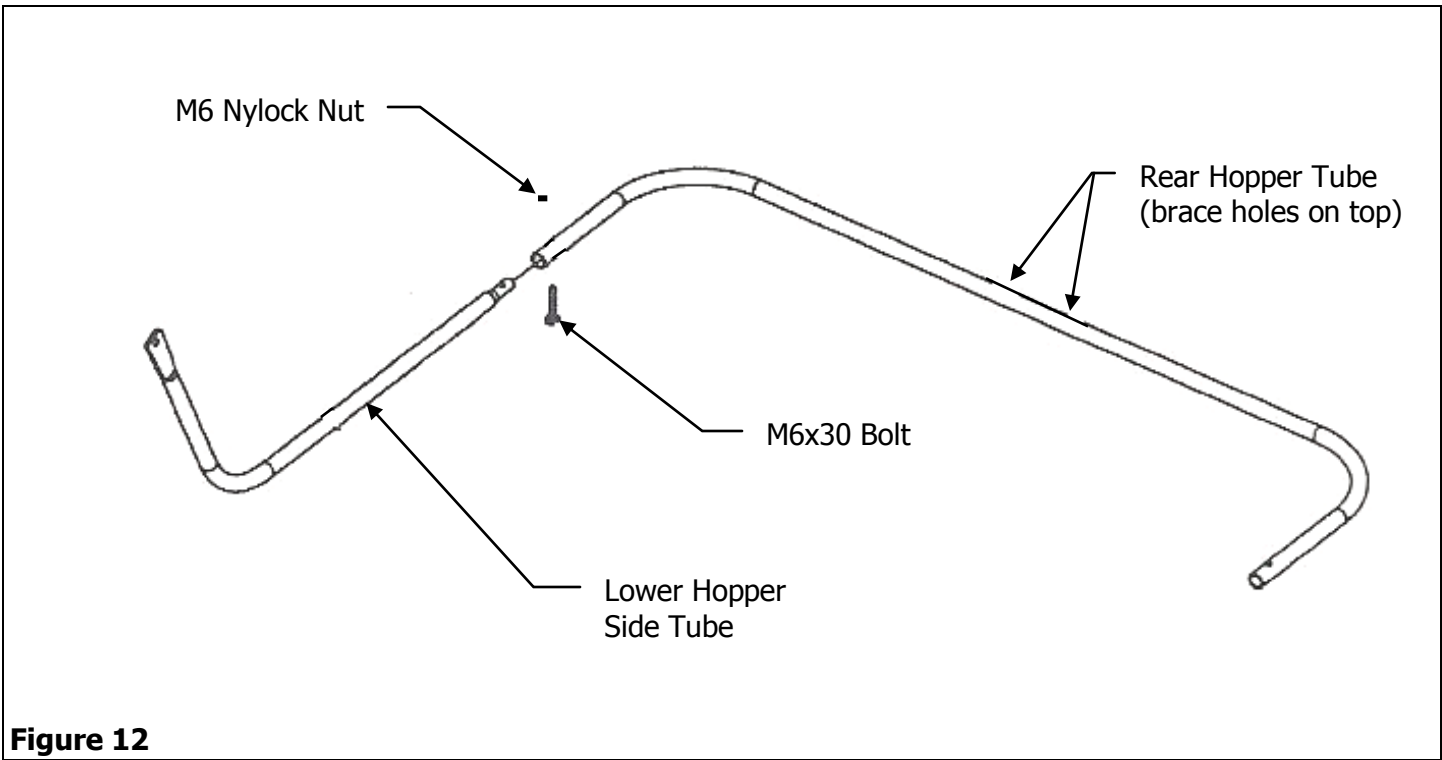

13. Attach the ends of the Lower Hopper Side Tubes to the inside of the Upper Side Tubes using two 08x25 Clevis Pins, insert them from the inside and secure with two Hitch Pins Clips. See Figure 13.

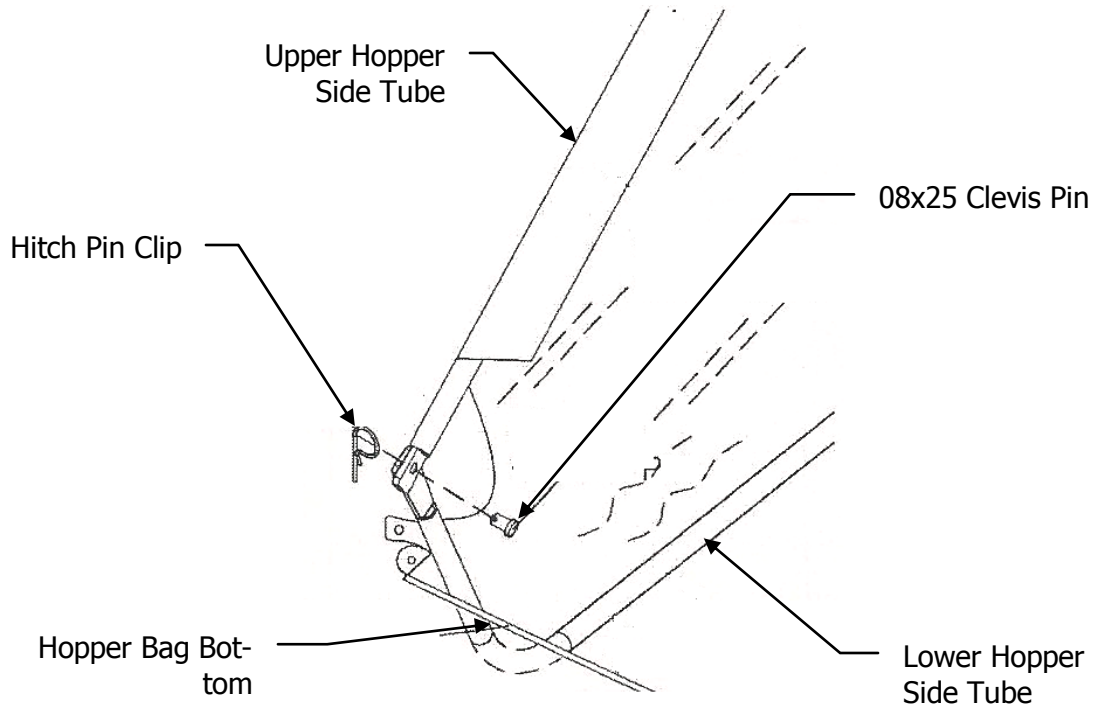

Figure 13

14. Insert the Bag Frame Strap into the stitched sleeve along the front edge of the bag bottom. Attach the Bag Frame Strap to the Lower Hopper Side Tubes using two M6x30 Bolts and two M6 Nylock Nuts. See Figure 14.

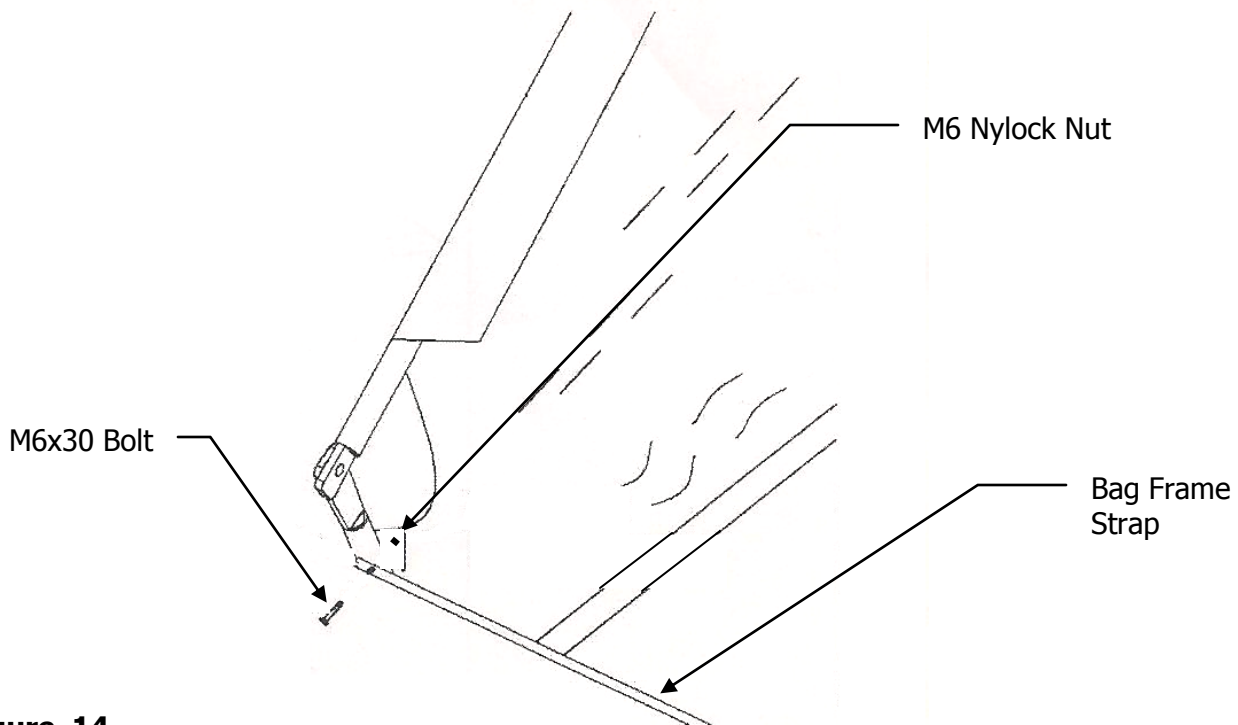

Figure 14

15. Secure the bag corners around the Lower Hopper Side Tubes by snapping the Bag Flaps to the Bag Bottom on both sides. See Figure 15.

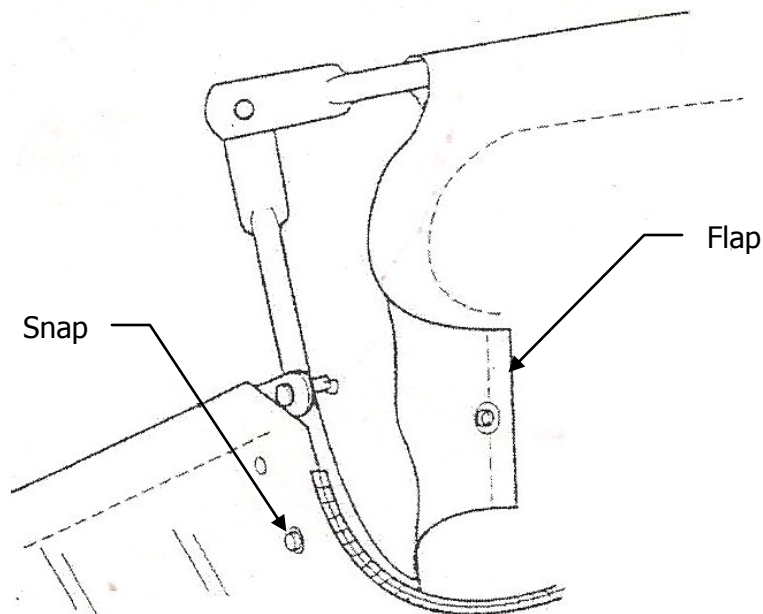

Figure 15

IMPORTANT: Do not over bend the Support Rods during the following step. Over bending will cause the steel rods to lose supporting tension.

16. Tip the Hopper onto it's back to assemble the two Hopper Support Rods. Place the ends of each rod into the Upper and Lower Rear Hopper Tubes, bending the rod just enough to fit into the holes of the tubes. See Figure 16.

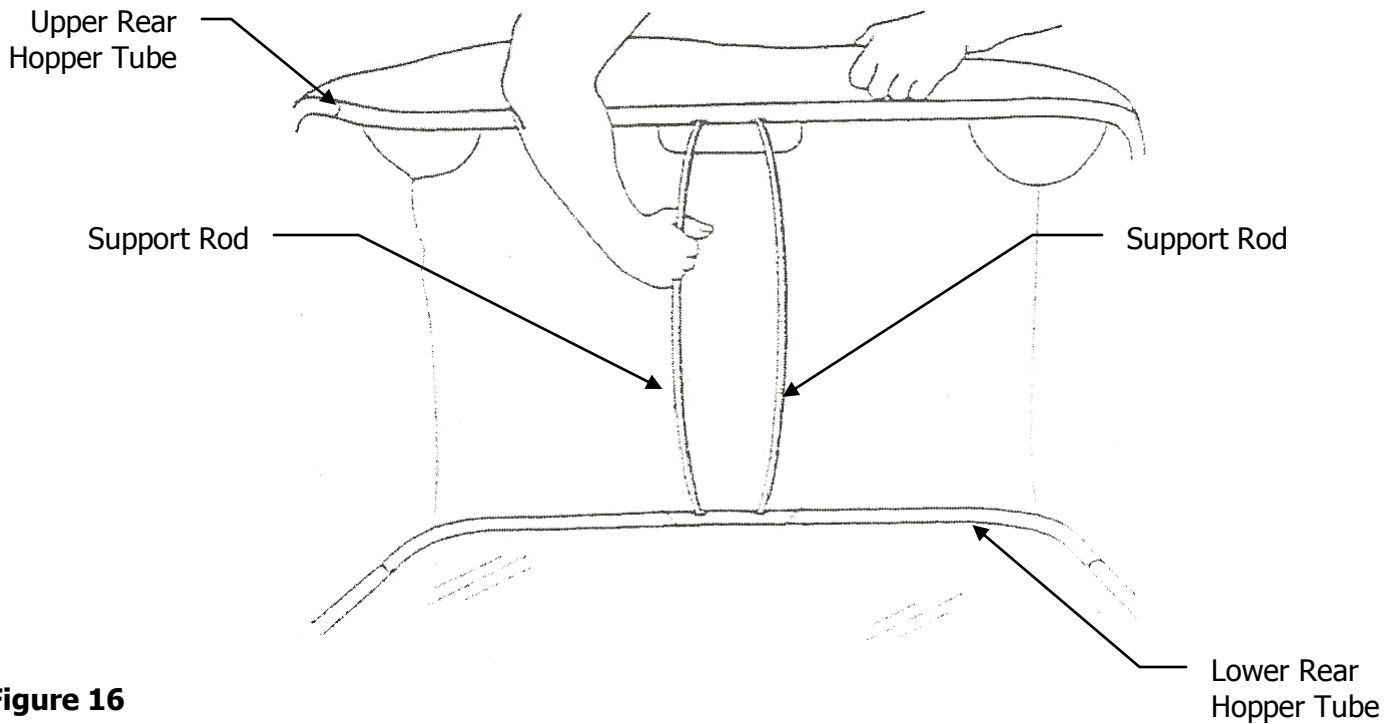

Figure 16

17. Feel along the stitched flap on the Hopper Bag to locate the lower hole in each Upper Hopper Side Tube. Place a hole through both sides of the stitched flaps in alignment with the lower hole. See Figure 17.

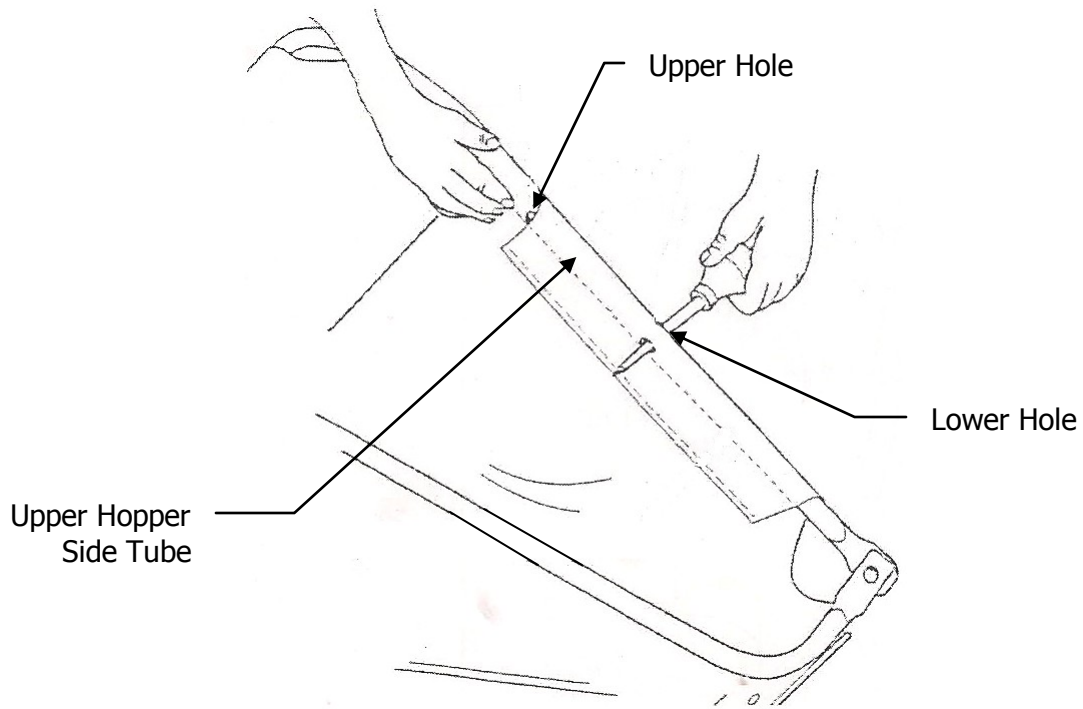

Figure 17

18. Insert a 08 x 58 Clevis Pin through the lower hole in each Upper Hopper Side Tube. Next assemble a Bag Arm Tube onto each Clevis Pin and secure with a Hitch Pin Clip. Place Vinyl Cap onto Bag Arm Tube. See Figure 18.

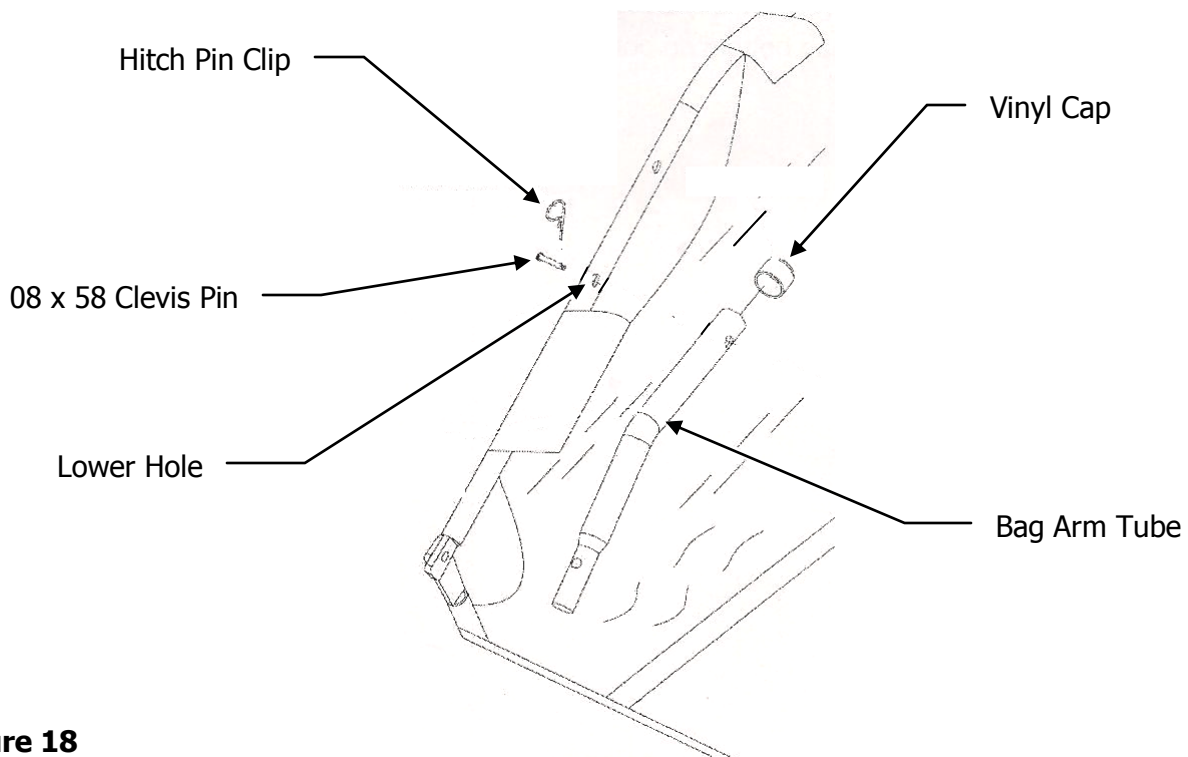
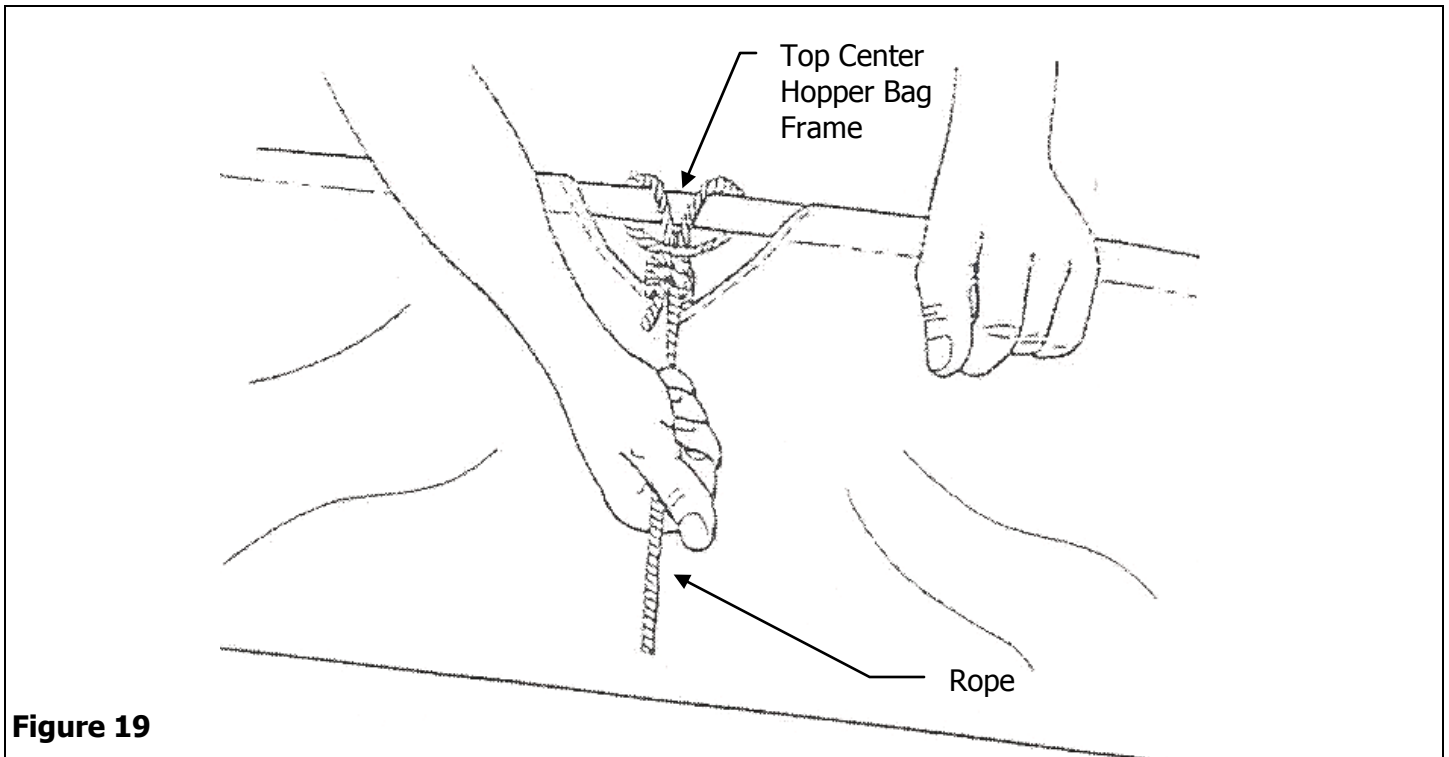
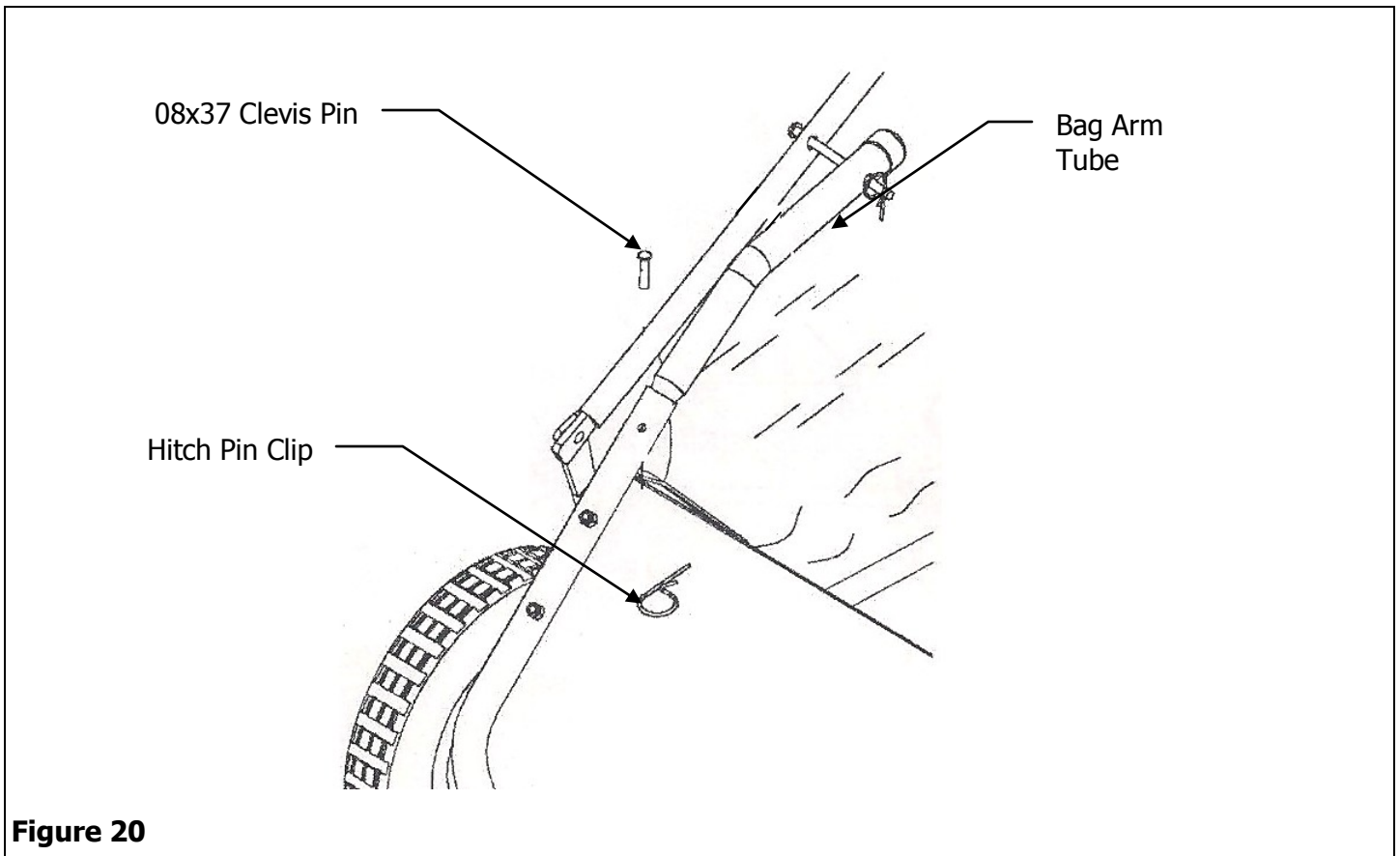

Figure 18

19. Secure the Rope to the top center of the Hopper Bag Frame. See Figure 19.



20. Attach the Hopper Bag to the Sweeper, slide the ends of the Bag Arm Tubes into the ends of the Sweeper's Hitch Tubes and secure with two 08x37 Clevis Pins and Hitch Pin Clips. See Figure 20.



Exploded View

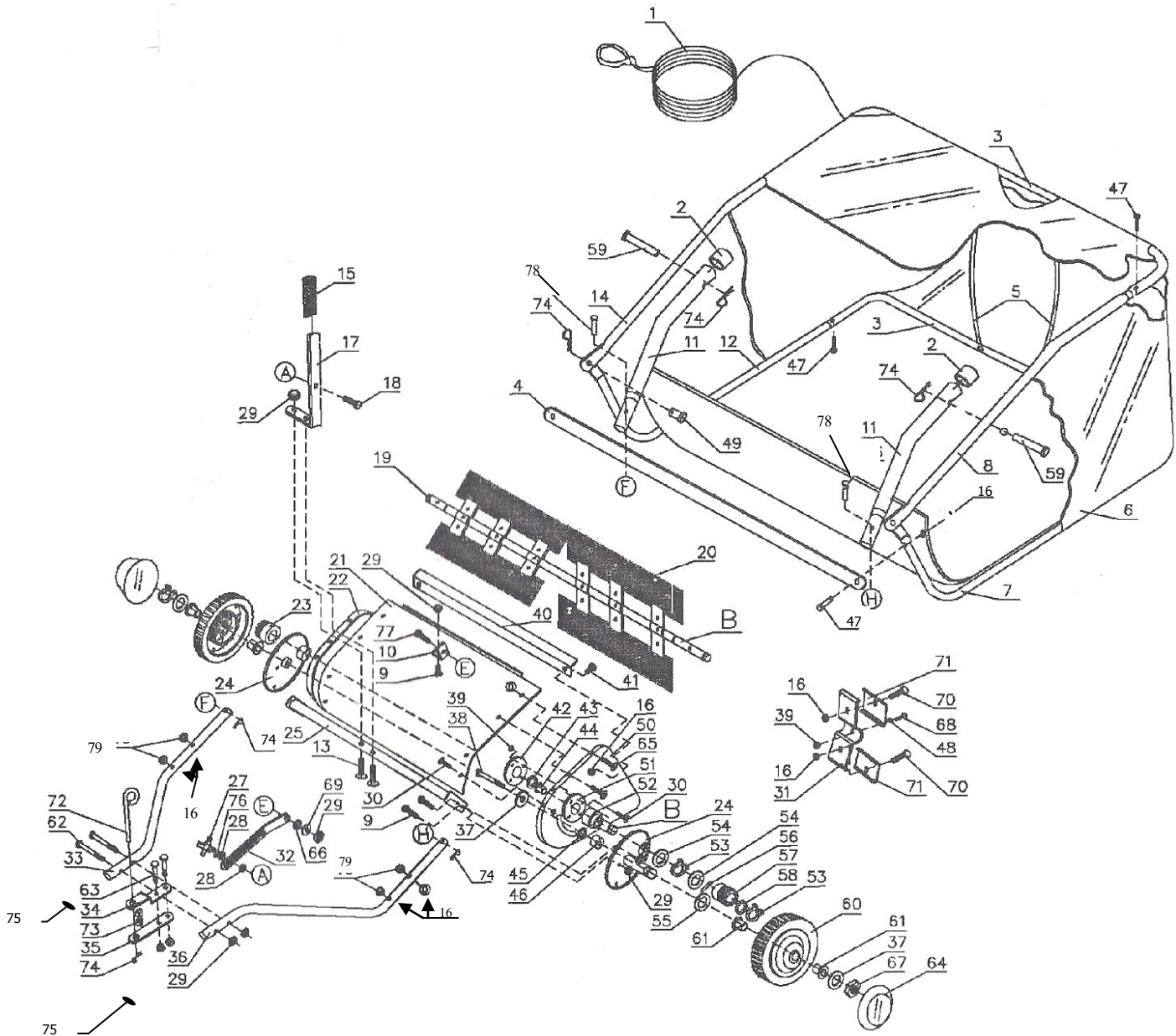

Parts List LSP48

Part No.	Description	Qty.	Part No.	Description	Qty.
1-38	Hopper Rope	1	40-48	Connecting Bar	1
2-38	Vinyl Cap	2	41-38	M6x12 Hex Head Bolt	2
3-48	Hopper Frame Tube (Rear)	2	42-38	Dust Cover Retainer	2
4-48	Bag Frame Strap	1	43-38	Inside Star Washer	2
5-38	Hopper Support Rod	2	44-38	Brush Shaft Bushing	2
6-48	Hopper Bag	1	45-38	Spacer Bushing	2
7-38	Lower Hopper Frame Tube (L.H.)	1	46-38	Spacer for Axle	2
8-38	Upper Hopper Frame Tube (L.H.)	1	47-38	M6x30 Allen Head Bolt	6
9-38	M8x16 Hex Head Bolt	5	48-38	Star Washer 05	6
10-38	Angle Bracket	1	49-38	Clevis Pin C	2
11-38	Bag Arm Tube	2	50-38	End Plate (L.H.)	1
12-38	Lower Hopper Frame Tube (R.H.)	1	51-38	Special Washer	2
13-38	M8x40 Hex Head Bolt	2	52-38	Bushing	2
14-38	Upper Hopper Frame Tube (R.H.)	1	53-38	Retaining Ring 015	4
15-38	Height Adjustment Grip	1	54-38	Adj. Washer A	4
16-38	M6 Nylock Nut	24	55-38	Adj. Washer C	2
17-38	Height Adjustment Handle	1	56-38	Dowel Pin (Drive)	2
18-38	M8x30 Carriage Bolt	1	57-38	Pinion Gear (L.H.)	1
19-48	Brush Shaft	1	58-38	Adj. Washer B	2
20-48	Brush	4	59-38	Clevis Pin 08x58	2
21-48	Wrapper	1	60-38	Wheel & Tire Assembly	2
22-38	End Plate (R.H.)	1	61-38	Wheel Bushing	4
23-38	Pinion Gear (R.H.)	1	62-38	M8x65 Hex Head Bolt	2
24-38	Dust Cover Assembly	2	63-38	M8x50 Hex Head Bolt	2
25-48	Height Adjustment Tube Assembly	1	64-38	Hub Cap	2
26-38	Clevis Pin 08x37	2	65-38	M6x35 Hex Head Bolt	4
27-38	Knob Plastic	1	66-38	Spacer Bushing for Height Adj. Strap	1
28-38	Washer 10 MM	2	67-38	M10 Nylock Nut	2
29-38	M8 Lock Nut	12	68-38	M5x25 Hex Head Bolt	6
30-38	Slotted Pan Head Screw M5x12	14	69-38	Big Flat Washer 08	1
31-38	Retainer Brush	6	70-38	M6x20 Hex Head Bolt	12
32-38	Height Adjustment Strap	1	71-38	Retainer Brush	12
33-48	Hitch Tube (R.H.)	1	72-38	Hitch Pin	1
34-38	Clevis Plate	1	73-38	Hitch Spacer	2
35-38	Clevis Plate (Straight)	1	74-38	Hitch Pin Clip 03	7
36-48	Hitch Tube (L.H.)	1	75-38	Tube Plugs	2
37-38	Big Flat Washer 010 MM	4	76-38	Big Flat Washer 10 MM	2
38-38	M10x85 Hex Head Bolt	2	77-38	M8x20 Hex Head Bolt	1
39-38	M5 Nylock Nut	20	78-38	Clevis Pin 08x25	2
			79-38	M6x40 Allen Head Bolt	4

Manufacture's Limited Warranty for **Precision** Tow Behind Accessories

The limited warranty set forth below is given by Precision Products, Incorporated with respect to new merchandise purchased and used in the United States, its possessions and territories.

Precision Products, Incorporated warrants the product (s) listed against defects in material and workmanship, and will at our option, repair or replace, free of charge, any part found to be defective in materials or workmanship. This limited warranty shall only apply if this product has been assembled, operated, and maintained in accordance with the owner's manual furnished with the product, and has not been subject to misuse, abuse, neglect, accident, improper maintenance, alteration, vandalism, theft, fire, water, or damage because of other peril or natural disaster.

Normal wear parts or components thereof are subject to separate terms as follows: All normal wear parts or component failures will be covered on the product for a period of one year. Parts found to be defective within the warranty period will be replaced at our expense. Our obligation under this warranty is expressly limited to the replacement or repair, at our option, of parts found to be defective in material and workmanship.

Contacting Service

Warranty parts replacements are available, ONLY WITH PROOF OF PURCHASE, through our Customer Service Department.

Call **1 (800) 225-5891**

This limited warranty does not provide coverage in the following cases:

1. Routine maintenance items such as lubricants and filters.
2. Normal deterioration of the exterior finish due to use or exposure.
3. Transportation and/or labor charges.

No implied warranty, including any implied warranty of merchantability of fitness for a particular purpose, applies after the applicable period of express written warranty above as to the part as identified below. No other expressed warranty, whether written or oral, except as mentioned above, given by any person or entity, including a dealer or retailer, with respect to any product, shall bind Precision Products Inc. during the period of the warranty, the exclusive remedy is repair or replacement of the product as set forth above. The provisions as set

forth in this warranty provide the sole and exclusive remedy arising from the purchase.

Precision Products, Inc. will not be liable for incidental or consequential loss or damage including, without limitation, expenses incurred for substitute or replacement lawn care services, or for rental expenses to temporarily replace a warranted product.

Some states do not allow the exclusion or limitation of incidental or consequential damages, or limitations on how long an implied warranty lasts, so the above exclusions or limitations may not apply to you.

During the warranty period, the exclusive remedy is replacement of the part. In no event shall recovery of any kind be greater than the amount of the purchase price of the product sold. Alteration of safety features of the product shall void this warranty. You assume the risk and liability for loss, damage, or injury to you and your property and/or to others and their property arising out of the misuse or inability to use this product.

This limited warranty shall not extend to anyone other than the original purchaser or to the person for whom it was purchased as a gift.

Local Law to this Warranty

This limited warranty gives you specific legal rights, and you may also have other rights which vary from state to state.

Warranty Period

The warranty period stated below begins with the **Proof of Purchase**. Without the proof of purchase, the warranty period begins from the date of manufacture, determined by the serial number's manufacturing date.

Product Warranty Period

The warranty period for this product is as follows: All parts are covered for 1 year.