



Vac 35

Owner/Operator Manual Manuel Du Propriétaire/Utilisateur

Model

995810 – Vac 35 Push



Gasoline containing up to 10% ethanol (E10) or up to 10% MTBE (methyl tertiary butyl ether) is acceptable for use in this machine.

The use of any gasoline exceeding 10% ethanol (E10) or 10% MTBE will void the product warranty.

Il est possible d'utiliser de l'essence contenant jusqu'à 10% d'éthanol (E10) ou 10% de MTBE (éther méthyl-tertiobutylque) sur cette machine.

L'utilisation d'une essence contenant plus de 10% d'éthanol (E10) ou de 10% de MTBE annulent la garantie.



(GB) ENGLISH

(F) FRANÇAIS

04067900B 1/11
Printed in USA

TABLE OF CONTENTS

SAFETY.....	4	STORAGE.....	13
ASSEMBLY.....	7	TROUBLESHOOTING	14
CONTROLS and FEATURES.....	10	SPECIFICATIONS.....	15
OPERATION	11	WARRANTY	16
MAINTENANCE	13		

INTRODUCTION



WARNING: AVOID INJURY. Read and understand the entire *Safety* section before proceeding.

NON-ENGLISH MANUALS

Manuals in languages other than English may be obtained from your Dealer. Visit your dealer or www.ariens.com for a list of languages available for your equipment.

Manuals printed in languages other than English are also available as a free download on our website:

<http://www.ariens.com>

MANUALES EN IDIOMAS DIFERENTES DEL INGLES

Puede obtener manuales en idiomas diferentes del inglés en su distribuidor. Visite a su distribuidor o vaya a www.ariens.com para obtener una lista de idiomas disponibles para su equipo.

También puede imprimir manuales en idiomas diferentes del inglés descargándolos gratuitamente de nuestra página Web: <http://www.ariens.com>

MANUELS NON ANGLAIS

Des manuels dans différentes langues sont disponibles chez votre revendeur. Rendez-vous chez votre revendeur ou allez sur le site www.ariens.com pour consulter la liste des langues disponibles pour votre équipement.

Les manuels imprimés dans des langues différentes de l'anglais sont également disponibles en téléchargement gratuit sur notre site Web:

<http://www.ariens.com>

MANUALS

Before operation of unit, carefully and completely read your manuals. If used improperly, this unit could be dangerous and cause personal injury or property damage. The contents will provide you with safety instructions for the safe use of your unit during normal operation and maintenance. All reference to left, right, front, or rear are given from operator standing in operation position and facing the direction of forward travel.

ENGINE MANUAL

The engine on this unit is covered by a separate manual specific to the engine. This manual is included in the literature package that shipped with the unit. Refer to this manual for engine service recommendations. If the engine manual is not available, contact the engine manufacturer for a replacement manual.

MODEL AND SERIAL NUMBERS

When ordering replacement parts or making service inquiries, know the Model and Serial numbers of your unit and engine.

Numbers are located on the product registration form in the unit literature package. They are printed on a serial number label, located on the frame of your unit.

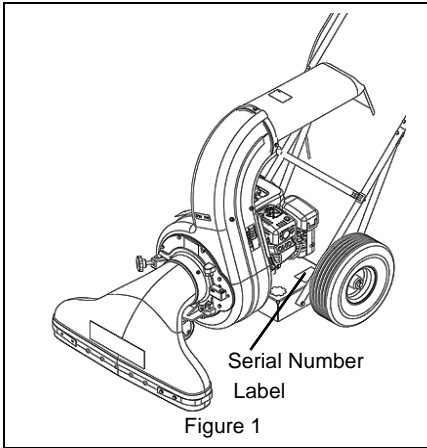

Figure 1

- Record Unit Model and Serial numbers here.

- Record Engine Model and Serial numbers here.

PRODUCT REGISTRATION

The dealer must register the product at the time of purchase. Registering the product will help the company process warranty claims or contact you with the latest service information. All claims meeting requirements during the limited warranty period will be honored, whether or not the product registration card is returned. Keep a proof of purchase if you do not register your unit.

Customer Note: If the dealer does not register your product, please fill out, sign, and return the product registration card to Ariens or go to www.ariens.com.

UNAUTHORIZED REPLACEMENT PARTS

Use only Parker replacement parts. The replacement of any part on this vehicle with anything other than a Parker authorized replacement part may adversely affect the performance, durability, or safety of this unit and may void the warranty. Parker disclaims liability for any claims or damages, whether warranty, property damage, personal injury or death arising out of the use of unauthorized replacement parts. To locate your nearest Parker Dealer, go to www.ariens.com on the internet.

DISCLAIMER

Parker reserves the right to discontinue, make changes to, and add improvements upon its products at any time without public notice or obligation. The descriptions and specifications contained in this manual were in effect at printing. Equipment described within this manual may be optional. Some illustrations may not be applicable to your unit.

DELIVERY

Customer Note: If you have purchased this product without complete assembly and instruction by your retailer, it is your responsibility to:

1. Read and understand all assembly instructions in this manual. If you do not understand or have difficulty following the instructions, contact your nearest Parker Dealer for assistance. Make sure all assembly has been properly completed.

NOTE: To locate your nearest Parker Dealer, go to www.ariens.com on the Internet.



WARNING: Improper assembly or adjustments can cause serious injury.

2. Understand all Safety Precautions provided in the manuals.
3. Review control functions and operation of the unit. Do not operate the unit unless all controls function as described in this manual.
4. Review recommended lubrication, maintenance and adjustments.
5. Review Limited Warranty Policy.

NOTE: This machine comes with a one-year limited warranty. The selling dealer is responsible for explaining the terms and limitations of the warranty coverage offered in the country of sale.

6. Fill out a Product Registration Card and return the card to the Ariens Company or go to www.ariens.com.

SAFETY



WARNING: This cutting machine is capable of amputating hands and feet and throwing objects. Failure to observe the safety instructions in the manuals and on decals could result in serious injury or death.

Slopes are a major factor related to slip and fall accidents. Operation on all slopes requires extra caution.

Tragic accidents can occur if the operator is not alert to the presence of children. Never assume that children will remain where you last saw them.

Gasoline is extremely flammable and the vapors are explosive, handle with care.

Stop unit and engine, remove key (if equipped) and allow moving parts to stop before leaving operator's position.



CAUTION: POTENTIALLY HAZARDOUS SITUATION! If not avoided, MAY RESULT in minor or moderate injury. It may also be used to alert against unsafe practices.

NOTATIONS

NOTE: General reference information for proper operation and maintenance practices.

IMPORTANT: Specific procedures or information required to prevent damage to unit or attachment.

PRACTICES AND LAWS

Practice usual and customary safe working precautions, for the benefit of yourself and others. Understand and follow all safety messages. Be alert to unsafe conditions and the possibility of minor, moderate, or serious injury or death. Learn applicable rules and laws in your area. Always follow the practices set forth in this manual.

SAFETY ALERTS



Look for these symbols to point out important safety precautions. They mean:

Attention!



Personal Safety Is Involved!

Become Alert!

Obey The Message!

The safety alert symbols above and signal words below are used on decals and in this manual. Read and understand all safety messages.



DANGER: IMMINENTLY HAZARDOUS SITUATION! If not avoided, WILL RESULT in death or serious injury.



WARNING: POTENTIALLY HAZARDOUS SITUATION! If not avoided, COULD RESULT in death or serious injury.

REQUIRED OPERATOR TRAINING

Original purchaser of this unit was instructed by the seller on safe and proper operation. If unit is to be used by someone other than original purchaser; loaned, rented or sold, ALWAYS provide this manual and any needed safety training before operation.

SAFETY DECALS AND LOCATIONS

ALWAYS replace missing or damaged Safety Decals. Refer to figure below for Safety Decal locations.

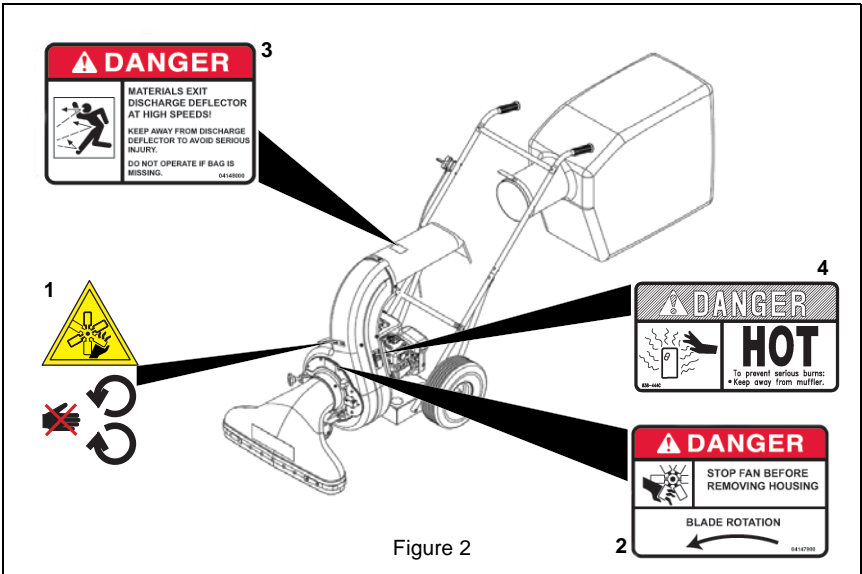

Figure 2

1. DANGER! TO AVOID SERIOUS INJURY OR DEATH

Do not open or remove safety shields while engine is running.

Keep safety devices (guards, shields, switches, etc.) in place and working.

2. Stop fan before removing housing

3. DANGER! TO AVOID SERIOUS INJURY OR DEATH



OL0910

Never direct discharge toward other people. Thrown objects can cause injury.

4. HOT SURFACES!



OD0061

DO NOT touch parts which are hot from operation. ALWAYS allow parts to cool.

SAFETY RULES

OPERATION

To prevent personal injury or property damage, do not attempt to start engine until all assembly steps are complete and you have read and understand the safety and operating instructions in this manual.

If unit is to be used by someone other than original purchaser; loaned, rented or sold, ALWAYS provide this manual and any needed safety training before operation.

If the operator or the mechanic cannot read the manual, it is the owner's responsibility to explain it to them. Only the user can prevent and is responsible for accidents or injuries occurring to themselves, other people or property.

This product is equipped with an internal combustion engine. DO NOT use on or near any unimproved, forest or brush covered land unless the exhaust system is equipped with a spark arrestor meeting applicable local, state or federal laws. A spark arrestor, if used, must be maintained in effective working order by the operator. See your Parker Dealer or engine manufacturer's service center.

Wear approved safety glasses when operating this equipment. The operation of any powered machine can result in foreign objects being thrown by high-speed rotating parts.

Wear work gloves, sturdy footwear, and hearing protection when operating this equipment.

Remove hearing protection and watch for traffic when operating near, or when crossing roadways.

Before inspecting or servicing any part of equipment, shut off engine, disconnect spark plug wire from spark plug, and make sure that all moving parts have come to a complete stop. Be aware that rotating blades slow down gradually after engine is shut off.

Exercise extreme caution on slopes and avoid excessively steep slopes.

Never leave equipment unattended when engine is running. Shut off engine and disconnect spark plug wire from spark plug before leaving equipment. Turn off fuel shut-off if equipped.

Do not vacuum any burning or smoldering materials such as cigars, cigarettes, ashes, or cinders.

Do not vacuum areas that have been recently treated with fertilizers, pesticides, or herbicides.

Follow chemical manufacturer's safety instructions regarding contact with treated areas.

Do not vacuum flammable liquids such as gasoline, kerosene, diesel fuel, paint thinner, etc.

Do not vacuum any airborne combustibles, dust from wood, paper, metal ECT.

Do not operate the equipment on a paved, gravel, or hard surface unless the collection bag is installed. Discharged material may bounce from a hard surface.

Never pick up or carry equipment while the engine is running.

Walk, never run.

ALWAYS be sure of your footing. Use caution to avoid slipping and falling.

Operate machine only in daylight or good artificial light.

NEVER operate after or during the use of medication, drugs or alcohol. Unit requires complete and unimpaired attention.

If the machine should start to vibrate abnormally, stop the engine (motor) and check for the cause immediately. Vibration is generally a warning of trouble.

Never allow children or untrained adults to operate this equipment.

Keep the area of operation clear of all persons, particularly small children, and pets. Keep bystanders at least 25 feet away from the area of operation.

Do not run engine in an enclosed area. Engine exhaust contains carbon monoxide gas, a deadly poison that is odorless, colorless, and tasteless.

Before removing or installing collection bag, shut off engine, disconnect spark plug wire from spark plug, and allow all moving parts to come to a complete stop.

Do not allow hands or any other part of the body or clothing inside the vacuum inlet.

Do not start engine or operate this equipment with any safety guards or housing removed.

If equipment jams or becomes clogged, immediately shut off engine, disconnect spark plug wire from spark plug, and allow all moving parts to come to a complete stop. Use only a wooden stick to clear away debris.

Empty the collection bag after each use.

Decomposed debris could generate enough heat to catch fire.

Before emptying the collection bag, shut off engine, disconnect spark plug wire from spark plug, and allow all moving parts to come to a complete stop.

See manufacturer's instructions for proper operation and installation of accessories.

Only use accessories approved by the manufacturer.

Emission Control System Certification Label

NOTE: Tampering with emission controls and components by unauthorized personnel may result in severe fines or penalties. Emission controls and components can only be adjusted by EPA and/or CARB authorized service centers. Contact your Parker Equipment Retailer concerning emission controls and component questions.

Fuel is highly flammable and its vapors can explode. ONLY use approved fuel containers.

- NO Smoking!
- NO Sparks!
- NO Flames!
- Allow engine to cool before filling fuel tank.

Never fill containers inside a vehicle or on a truck or trailer bed with a plastic liner. Always place containers on the ground away from your vehicle before filling.

When practical, remove gas-powered equipment from the truck or trailer and refuel it on the ground. If this is not possible, then refuel such equipment on a trailer with a portable container, rather than from a gasoline dispenser nozzle.

Keep the nozzle in contact with the rim of the fuel tank or container opening at all times until fueling is complete. Do not use a nozzle lock-open device.

Check fuel supply before starting engine.

DO NOT fill gasoline tank indoors, when engine is running, or while engine is hot. Allow engine to cool several minutes before removing fuel cap.

Do not mix oil with gasoline.

DO NOT overfill. Allow about 1/2" (12 mm) of tank space for fuel expansion.

Replace gasoline tank cap securely and clean any spilled fuel before starting engine.

If fuel is spilled on clothing, change clothing immediately.

NEVER store fuel inside where there is an open flame, such as a water heater.

ALWAYS drain fuel outdoors away from ignition sources.

ALWAYS shut off engine, and remove key, and close fuel shutoff valve when transporting unit on a truck or trailer.

MAINTENANCE AND STORAGE

Keep all nuts, bolts, and screws tight to be sure the equipment is in safe working condition.

Never store equipment with fuel in the tank inside a building where fumes may reach an open flame or spark.

Allow engine to cool before storing in any enclosure.

To reduce the fire hazard, keep the engine, silencer, battery compartment, and fuel storage area free of grass, leaves, or excessive grease.

Replace worn or damaged parts for safety.

ASSEMBLY



WARNING: AVOID INJURY. Read and understand the entire *Safety* section before proceeding.

The VAC 35 covered in this owner's guide is shipped complete in one box. Follow all instructions on assembly very carefully.

Carton Contents

- Unit
- Literature Pack
- Spin-Pak® Deflector

ASSEMBLY

1. Remove all items from carton.
2. Tip box over so wheels are toward floor. Pull unit out of box and stand upright.

IMPORTANT: DO NOT discard the carton or any of the inserts until the unit is completely assembled.

3. All hardware is on the unit in its proper location. If something is missing, notify the dealer/distributor where unit was purchased. If unable to purchase parts locally, contact Parker.

HANDLE ASSEMBLY

Figure 3

1. Remove the four 1/4-20 hex bolts and hex lock nuts from the bottom end of the upper handles and place upper handles over the ends of the lower handles.
2. Align the mounting holes in upper and lower handles. Replace 1/4-20 hex bolts in the bottom two mounting holes.

3. Lift handles until the back braces can be installed on the hex bolts installed in step 2. Loosely install 1/4-20 hex lock nuts.
4. Align the upper holes in both upper and lower handles. Install the two 1/4-20 hex bolts and hex lock nuts. Do not tighten.

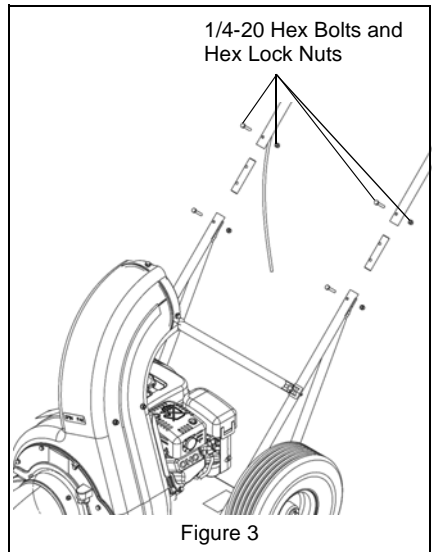

5. Align the crossbar with the mounting holes at the top of the upper handles and install with two 1/4-20 hex bolts and hex lock nuts. See Figure 4.

NOTE: Check handle alignment. The hex lock nuts have been left loose to allow movement between the holes and the bolts. Do not bend tubing to accomplish proper alignment.

6. Once handles are aligned, tighten all hex lock nuts.

NOTE: Nuts should be tightened enough that at least two of the bolt threads extend through the nut. It may be necessary to collapse the tubing SLIGHTLY to accomplish this.

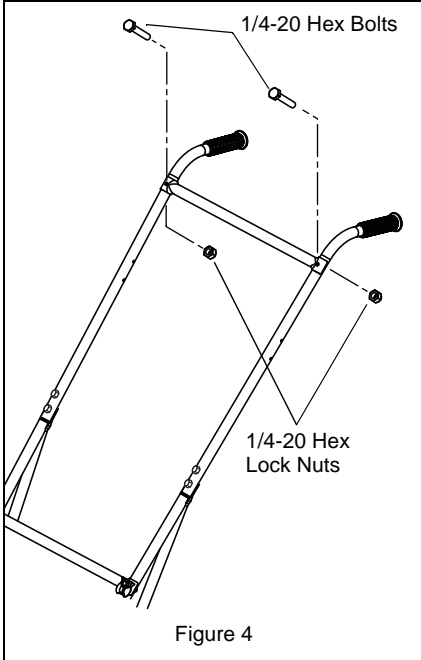

Figure 4

THROTTLE CONNECTION

Figure 5

1. Remove throttle control from the right lower handle.
2. Straighten the throttle cable and run it up the right hand handle and attach the throttle control to the upper right hand handle with the furnished hex bolts and hex nuts.
3. Attach snap-on clamps to handles to secure throttle cable.
4. Make sure no bends are less than 8" radius.

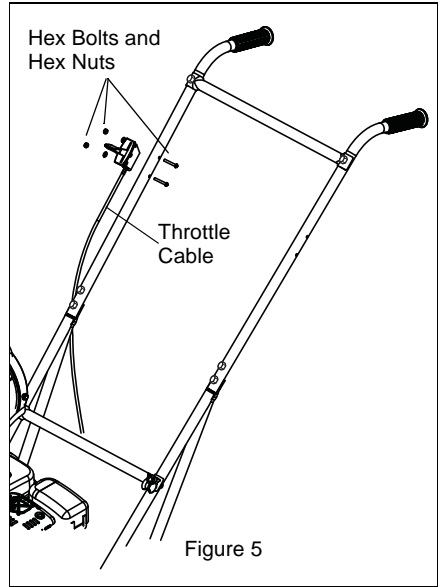

Figure 5

INSTALL SPIN-PAK® DEFLECTOR

Figure 6

1. Remove hex head bolts, flat washers, and lock nuts from the three upper holes used to secure retaining ring to housing assembly. DO NOT remove the bottom bolt or retaining ring from housing assembly.
2. Align the holes in Spin-Pak deflector with three upper holes in retaining ring and housing assembly.
3. Replace hardware removed in Step 1 and tighten.

NOTE: Illustration shows two of the three hex bolts, washers and lock nuts.

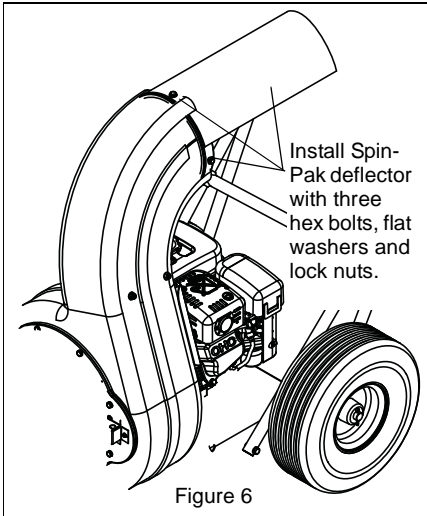

Figure 6

INSTALL INTAKE HOUSING

Figure 7

1. Hook the hinge bosses on the inlet housing on the pins on the front cover assembly.
2. Swing intake housing to lie flat against front cover assembly.
3. Secure by placing flat washer and adjusting knob on pivot bolt over the collar of the intake housing and then tightening the adjusting knob.

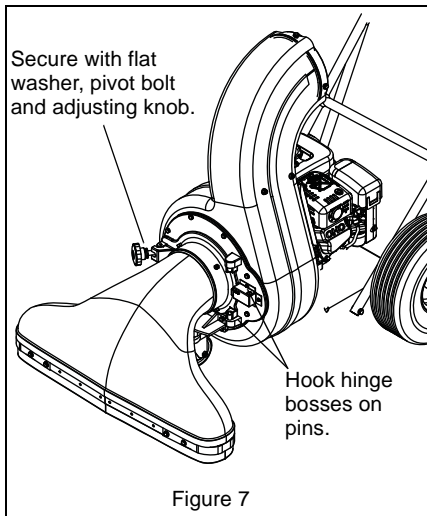

Figure 7

ATTACHING DUST BAG

1. Place large loop in upper bag straps over the upper handles.
2. Place neck of dust bag over Spin-Pak® deflector until tie strap can be pulled tight around neck of housing, just over bead on retaining ring. Bead must be covered.
3. Place bag hooks onto loops in lower bag straps and hook to lower cross bar.



WARNING: Failure to attach bag hooks to lower cross bar can cause premature wear of bag and neck at the Spin-Pak®. The Spin-Pak® may also break prematurely due to excessive weight from the bag.

WARNING: The engine contains NO OIL. Read the Engine Instruction Manual carefully before operating the VAC 35. Be sure you know how to start and stop the engine before proceeding further. Do not start the engine until all assembly is finished.

WARNING: Make a thorough inspection to see that all fasteners are tight and all parts are properly installed. DO NOT start engine without intake housing and dust bag in place. If engine is started without intake housing attached, serious injury may result by drawing clothing or parts of the body into the fan. If engine is run without Spin-Pak® or dust bag, small stones or other objects may be picked up and propelled at operator or bystanders through the unprotected opening causing serious injury.

CONTROLS AND FEATURES

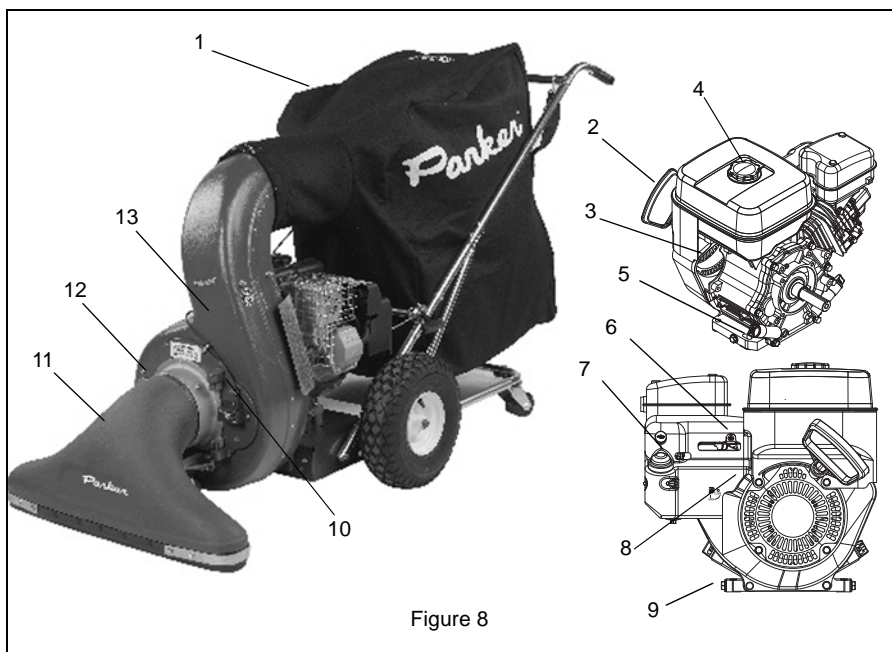

- | | |
|----------------------|------------------------|
| 1. Dust Bag | 8. Fuel Shut-Off Valve |
| 2. Recoil Starter | 9. Oil Drain Plug |
| 3. Engine Switch | 10. Hinge and Pins |
| 4. Fuel Tank and Cap | 11. Intake Housing |
| 5. Oil Fill/Dipstick | 12. Pivot Bolt |
| 6. Throttle | 13. Blower |
| 7. Choke | |

OPERATION



WARNING: AVOID INJURY. Read and understand the entire *Safety* section before proceeding.

SAFETY INTERLOCK

The switches on the front vacuum housing and on the cloth bag assembly must be engaged for the engine to start.

Engine Switch

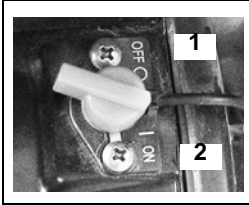

The engine switch has two positions:

1. OFF – Engine will not start or run.
2. ON – Engine will start and run.

Choke Control Lever

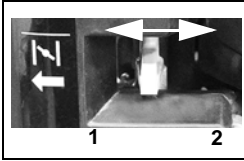

1. Choke Closed position: chokes off air to engine for easier start.
2. Choke Open position: allows for normal operation.

IMPORTANT: Gradually open choke after engine starts.

Throttle Control Lever

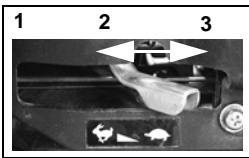

The throttle controls the engine speed. To increase or decrease the engine speed, adjust to:

1. Fast (normal or warm starts)
2. Part-Throttle
3. Slow (cold weather starts)

Fuel Shut-Off Valve

IMPORTANT: The fuel shut-off valve **MUST** be in the closed position prior to transporting the unit.

The fuel shut-off valve has two positions:



Closed Position: Use this position to service, transport, or store the unit.



Open Position: Use this position to run the unit.

Figure 9

Recoil Starter Handle

When pulled, handle will turn engine over.

IMPORTANT: DO NOT let handle snap back against starter.

USING THE VAC

Avoid heavy concentrations of sand and gravel. The Vac 35 is designed to handle moderate amounts of these abrasive materials, not heavy applications.

The VAC 35 will handle most common kinds of debris found around industrial plants, commercial buildings, homes and farms. Acid contaminated materials, magnesium, dust and other **DANGEROUS DEBRIS** that is considered hazardous should not be handled with the VAC 35.

The efficiency of this unit depends on the breathing capacity of the dust bag. Under extremely dusty conditions the bag should be emptied and cleaned frequently. Always empty and clean bag before storing after use. Debris allowed to remain in the bag may cause spontaneous combustion, resulting in an explosion or fire. See instructions supplied with dust bag.

Clearing the Machine of Clogs and Jams

A clog or jam in the machine can cause the vacuuming operation to decrease or even stop completely. If this occurs, take the following steps:

1. STOP THE ENGINE IMMEDIATELY and disconnect the spark plug wire from the spark plug. Wait for all moving parts to come to a complete stop.
2. Check (and clean, if necessary) the following areas in this order:
 - Check that the collection bag is not overfilled. Remove and empty bag.
 - While the bag is removed, check that the discharge deflector is not clogged or jammed. Use a stick to clear away any debris.
 - Check that the vacuuming attachment is not clogged or jammed. Remove the attachment and thoroughly clean the opening. While the attachment is removed, check the inlet opening to the machine. Use a stick to clear away any debris.



WARNING: AVOID INJURY. NEVER use hands to clear debris from discharge deflector, vacuum inlet or vacuum attachment.

BEFORE STARTING ENGINE

IMPORTANT: Read the Engine Manual CAREFULLY before operating the VAC 35. Before starting the engine read and understands the following:

1. Be sure the engine crankcase is filled with the proper type and amount of oil.
2. Spin-Pak® is in place.
3. Dust bag or discharge hose is in place.
4. Intake housing or hose kit is attached to the fan housing.

Add Fuel to Fuel Tank

1. ALWAYS place unit in open or well-ventilated area.
2. Stop engine and allow to cool.
3. Clean fuel cap and surrounding area to prevent dirt from entering fuel tank.
4. Remove cap.

IMPORTANT: DO NOT use gasohol or gasoline containing alcohol. See Engine Manual for correct type and grade of fuel.

5. Fill fuel tank to within 1/2 in. (1.2 cm) of bottom of filler neck with unleaded gasoline.

NOTE: Tank capacity is 0.9 gallon (3.4 liters).

6. Replace fuel cap and tighten.
7. ALWAYS clean up any spilled fuel.

Start Engine

1. Move the engine switch to the ON position.
2. Open the fuel shut off valve.
3. Set the choke lever based on engine temperature (see *Choke Control Lever* on page 11).
4. Slowly pull the recoil starter until engine compression makes pulling difficult. Let the starter rewind a little, and then pull smoothly and quickly to start the engine.
5. Repeat step 4 as needed.
6. Fully open the choke and set the throttle to full fast before operating the unit.

Stop Engine

1. Move throttle lever to slow position.
2. Move the engine switch to the OFF.
3. Close the fuel shut-off valve.
4. Remove any hearing protection and listen for all moving parts to come to a complete stop.

MAINTENANCE



WARNING: AVOID INJURY. Read and understand the entire *Safety* section before proceeding.

DUST BAG CARE

1. To clean dust bag, turn the bag inside out and reattach to unit.
2. Start engine and run at full throttle. Lightly tap bag to release dirt trapped in the weave.
3. When clean, turn bag right side out and reattach to unit.
4. Bag can be washed if extremely dirty.

LUBRICATION

Add a few drops of oil to the throttle control cable and wire to help keep it operating smoothly.

STORAGE



CAUTION: AVOID INJURY. Read and understand the entire *Safety* section before proceeding.

IMPORTANT: NEVER spray unit with high-pressure water or store unit outdoors. Store unit in a cool, dry, protected location.

Cleaning

NOTE: Allow unit to cool before cleaning.

Clean unit thoroughly with mild soap and low pressure water. Brush off dirt and debris from all surfaces. Touch up all scratched surfaces to prevent rust. Matching touch-up paint is available from your Dealer. Do not use abrasives, solvents, or harsh cleaners.

Inspection

Inspect unit and repair or replace worn or damaged parts to avoid delays when beginning use again.

Regularly check all hardware and keep fasteners tight. Know unit is in safe working condition.

Dust Bag

Wash out dust bag and allow to dry before storage. Dust bag may be stored in position on mower.

Engine

When storing unit for extended periods of time, remove all fuel from tank and carburetor (run dry). Refer to engine manual.

Fuel System

Gasoline left in the fuel system for extended periods without a stabilizer will deteriorate, resulting in gum deposits in the system. These deposits can damage the carburetor and the fuel hoses, filter and tank. Prevent deposits from forming in the fuel system during storage by adding a quality fuel stabilizer to the fuel. Follow the recommended mix ratio found on the fuel stabilizer container.

To treat the fuel system for storage:

1. Add fuel stabilizer according to manufacturer's instructions.
2. Run engine for at least 10 minutes after adding stabilizer to allow it to reach the carburetor.

NEVER store the engine with fuel in the fuel tank inside of a building with potential sources of ignition.

TROUBLESHOOTING

PROBLEM	PROBABLE CAUSE	CORRECTION
Vacuum fails to pick up debris	<ol style="list-style-type: none"> 1. Collection bag is full. 2. Clog or jam in the intake system. 	<ol style="list-style-type: none"> 1. Shut off engine and empty collection bag. See <i>ATTACHING DUST BAG</i> on page 9. 2. Shut off engine and check for clogs in the discharge deflector, vacuum attachment, intake opening. See <i>Clearing the Machine of Clogs and Jams</i> on page 12.
Engine will not start.	<ol style="list-style-type: none"> 1. No gas in the fuel tank. 2. Fuel shut-off valve closed. 3. Engine shutoff switch is in the off position. 4. Build up of dirt and residue around governor/carburetor. 5. Interlock switches are not engaged. 	<ol style="list-style-type: none"> 1. Fill tank with clean, fresh gasoline. 2. Open fuel shut-off valve. 3. Turn the engine shutoff switch to On. 4. Clean area around governor/carburetor. 5. Make sure the intake assembly and dust bag are properly installed and are engaging the safety switches. See your dealer for repair.
Engine runs briefly and stops.	<ol style="list-style-type: none"> 1. Fuel shut-off valve closed. 2. Contaminated fuel supply. 3. Interlock switches not engaging properly. 	<ol style="list-style-type: none"> 1. Open fuel shut-off valve. 2. Replace with clean fuel. 3. Make sure the intake assembly and dust bag are properly installed and are engaging the safety switches. See your dealer for repair of faulty switch.

SPECIFICATIONS

Model Number	995810
Description	Vac 35
Length - in. (cm)	80.0 (203.2)
Height - in. (cm)	41.0 (104.1)
Width - in. (cm)	30.0 (76.2)
Actual Weight - lbs (kg)	137.0 (62.1)
Engine, 4 cycle	Subaru Robin
Model	SP170
Governed RPM (May be different from maximum rpm.)	3,600 +/- 50
Displacement Cu. In. (cc)	10.31 (169)
Cylinder Bore	Aluminum
Engine Oil Type	See Engine Manual.
Crank Case Capacity - Oz. (Liter)	20.8 (0.615)
Oil System	Splash
Spark Plug Gap - in. (mm)	0.02 – 0.03 (0.6 – 0.7)
Fuel Type	Unleaded Gasoline
Fuel Tank Capacity - Gal. (Liter)	0.9 (3.4)
Throttle	Yes
Starting	Recoil
Front Wheel Dia. - in.	
Rear Wheel Dia. - in.	9.0 x 2.50
Warranty	One Year Consumer Warranty



Parker One Year Limited Warranty

Ariens Company (Ariens) warrants to the **original purchaser** that Parker brand consumer products manufactured and sold by Ariens will be free from defects in material and workmanship for a period of one year after the date of purchase. An authorized dealer will repair any defect in material or workmanship, and repair or replace any defective part, subject to the conditions, limitations and exclusions set forth herein. Such repair or replacement will be free of charge (labor and parts) to the original purchaser except as noted below.

90-Day Limited Warranty on Service Parts and Accessories

Genuine Parker brand service parts and accessories are warranted to be free from defects in material and workmanship for a period of 90 days after the date of purchase. An authorized dealer will repair or replace any such part or accessory free of charge, except for labor, during that period.

The duration of all warranties herein applies only if the product is put to personal use around a household or residence. If the product is put to any business use, agricultural, commercial, or industrial, then the duration of these warranties shall be 90 days after the date of purchase. If any product is rented or leased, then the duration of these warranties shall be 90 days after the date of purchase.

Exceptions, Limitations, Exclusions

Customer Responsibilities

Register the product immediately at the time of sale. If the dealer does not register the product, the customer must complete the product registration card in the literature package and return it to the Ariens Company, or register the unit online at www.ariens.com.

To obtain warranty service, the **original purchaser** must:

- Perform the maintenance and minor adjustments explained in the owner's manual.
- Promptly notify Ariens or an authorized service representative of the need for warranty service.
- Transport the product to and from the place of warranty service.
- Have the warranty service performed by an authorized service representative.

To find an authorized service representative, contact Ariens at:

655 W. Ryan Street
Brillion, WI 54110
(920) 756 - 4688
www.ariens.com

Exceptions and Limitations

- Batteries are warranted only for a period of 12 months after date of purchase, on a prorated basis. For the first 90 days of the warranty period, a defective battery will be replaced free of charge. If the applicable warranty period is more than 90 days, Ariens will cover the prorated cost of any defective battery, for up to 12 months after the date of purchase.

Exclusions – Items Not Covered by This Warranty

- Engines and engine accessories are covered only by the engine manufacturer's warranty and are not covered by this warranty.
- Parts that are not genuine Parker brand service parts are not covered by this warranty.
- The following maintenance, service and replacement items are not covered by this warranty unless they are noted in the Limitations section above: lubricants, spark plugs, oil, oil filters, air filters, fuel filters, vacuum filters, brake linings, brake arms, brake shoes, runners, scraper blades, shear bolts, blower blades, blower vanes, vacuum vanes, vacuum hoses, tines, brushes.
- Any misuse, alteration, improper assembly, improper adjustment, neglect, or accident which requires repair is not covered by this warranty.
- This warranty applies only to products purchased in the United States (including Puerto Rico) and Canada. In all other countries, contact place of purchase for warranty information.

Disclaimer

Ariens may from time to time change the design of its products. Nothing contained in this warranty shall be construed as obligating Ariens to incorporate such design changes into previously manufactured products, nor shall such changes be construed as an admission that previous designs were defective.

LIMITATION OF REMEDY AND DAMAGES

Ariens Company's liability under this warranty, and under any implied warranty that may exist, is limited to repair of any defect in workmanship, and repair or replacement of any defective part. Ariens shall not be liable for incidental, special, or consequential damages (including lost profits). Some states do not allow the exclusion of incidental or consequential damages, so the above limitation or exclusion may not apply to you.

DISCLAIMER OF FURTHER WARRANTY

Ariens Company makes no warranty, express or implied, other than what is expressly made in this warranty. If the law of your state provides that an implied warranty of merchantability, or an implied warranty of fitness for particular purpose, or any other implied warranty, applies to Ariens Company, then any such implied warranty is limited to the duration of this warranty. Some states do not allow limitations on how long an implied warranty lasts, so the above limitation may not apply to you.

This warranty gives you specific legal rights, and you may also have other rights which vary from state to state.

CALIFORNIA AND EPA (UNITED STATES ENVIRONMENTAL PROTECTION AGENCY) EVAPORATIVE EMISSION CONTROL WARRANTY STATEMENT

YOUR WARRANTY RIGHTS AND OBLIGATIONS

The CARB (California Air Resources Board), the EPA, and Ariens Company are pleased to explain the evaporative emission control system's warranty on your 2011 model year small off-road equipment. In California, new equipment that uses small off-road engines must be designed, built, and equipped to meet the State's stringent anti-smog standards. Ariens Company must warrant the evaporative emission control system on your small off-road equipment for the period listed below provided there has been no abuse, neglect or improper maintenance of your equipment.

Your evaporative emission control system may include parts such as: fuel tanks, fuel lines, fuel caps, valves, canisters, filters, vapor hoses, clamps, connectors, and other associated components.

MANUFACTURER'S WARRANTY COVERAGE:

This evaporative emission control system is warranted for two years. If any evaporative emission-related part on your equipment is defective, the part will be repaired or replaced by Ariens Company.

OWNER'S WARRANTY RESPONSIBILITIES:

- As the small off-road equipment owner, you are responsible for the performance of the required maintenance listed in your Owner's Manual. Ariens Company recommends that you retain all receipts covering maintenance on your small off-road equipment, but Ariens Company cannot deny warranty solely for the lack of receipts.
- As the small off-road equipment owner, you should however be aware that the Ariens Company may deny you warranty coverage if your evaporative emission control system part has failed due to abuse, neglect, or improper maintenance or unapproved modifications.
- You are responsible for presenting your small off-road equipment to an authorized Ariens, Gravely, or Parker service representative as soon as the problem exists. The warranty repairs should be completed in a reasonable amount of time, not to exceed 30 days. If you have a question regarding your warranty coverage, you should contact Ariens Company Technical Service Center at 1-920-756-2141.

DEFECTS WARRANTY REQUIREMENTS:

- (a.) The warranty period begins on the date the small off-road equipment is delivered to an ultimate purchaser.
- (b.) General Evaporative Emissions Warranty Coverage. Ariens Company warrants to the ultimate purchaser and any subsequent owner that the evaporative emission control system when installed was:
 - (1.) Designed, built, and equipped so as to conform with all applicable EPA and CARB regulations; and
 - (2.) Free from defects in materials and workmanship that causes the failure of a warranted part for a period of two years.
- (c.) The warranty on evaporative emissions-related parts will be interpreted as follows:
 - (1.) Any warranted part that is not scheduled for replacement as required maintenance in the written instructions must be warranted for the warranty period defined in subsection (b)(2). If any such part fails during the period of warranty coverage, it must be repaired or replaced by the Ariens Company. Any such part repaired or replaced under the warranty must be warranted for a time not less than the remaining warranty period.
 - (2.) Any warranted part that is scheduled only for regular inspection in the written instructions must be warranted for the warranty period defined in subsection (b)(2). A statement in such written instructions to the effect of "repair or replace as necessary" will not reduce the period of warranty coverage. Any such part repaired or replaced under warranty must be warranted for a time not less than the remaining warranty period.
 - (3.) Any warranted part that is scheduled for replacement as required maintenance in the written instructions must be warranted for the period of time prior to the first scheduled replacement point for that part. If the part fails prior to the first scheduled replacement, the part must be repaired or replaced by the Ariens Company. Any such part repaired or replaced under warranty must be warranted for a time not less than the remainder of the period prior to the first scheduled replacement point for the part.

- (4.) Repair or replacement of any warranted part under the warranty provisions of this article must be performed at no charge to the owner at an authorized Ariens, Gravely, or Parker service representative.
- (5.) Notwithstanding the provisions of subsection (4) above, warranty services or repairs must be provided at authorized Ariens, Gravely, or Parker service representatives that are franchised to service the subject small off-road equipment.
- (6.) The owner must not be charged for diagnostic labor that leads to the determination that a warranted part is in fact defective, provided that such diagnostic work is performed at an authorized Ariens, Gravely, or Parker service representative.
- (7.) Throughout the evaporative emission control system's warranty period set out in subsection (b)(2), the Ariens Company must maintain a supply of warranted parts sufficient to meet the expected demand for such parts.
- (8.) Manufacturer-approved replacement parts must be used in the performance of any warranty maintenance or repairs and must be provided without charge to the owner. Such use will not reduce the warranty obligations of the manufacturer issuing the warranty.
- (9.) The use of any add-on or modified parts will be grounds for disallowing a warranty claim made in accordance with this article. The manufacturer issuing the warranty will not be liable under this Article to warrant failures of warranted parts caused by the use of an add-on or modified part.

Evaporative Emission Warranty Parts List

The following parts are considered emission-related components for evaporative emissions:

- Fuel Tank, Fuel Cap and Tether
- Fuel Line, Fuel Line Fittings, Clamps*
- Pressure Relief Valves, Control Valves*
- Control Solenoids*, Electronic Controls*
- Vacuum Control Diaphragms*
- Control Cables*, Control Linkages*
- Purge Valves
- Vapor Hoses, Liquid/Vapor Separator
- Carbon Canister, Canister Mounting Brackets
- Carburetor Purge Port Connector

* As related to the evaporative emission control system

Disclaimer

New equipment sold in the state of California that uses small off-road engines must be exclusively certified and appropriately labeled for sale in California. Some equipment covered by this Owner's Manual may not be certified for sale in California and the presence of the preceding CARB and EPA Warranty Statement does not by its existence indicate which, if any, of the equipment covered by this Owner's Manual may be sold in California.

Some equipment covered by this Owner's Manual may have been manufactured prior to certain affectivity dates requiring the inclusion of evaporative emission control systems. Therefore some equipment covered by this Owner's Manual may not include the evaporative emission control systems referred to in the preceding CARB and EPA Warranty Statement.



Parker
An Ariens Company Brand
655 West Ryan Street
Brillion, WI 54110
920-756-2141
Fax 920-756-2407
www.ariens.com
www.parkersweeper.com

 **WARNING** 

The engine exhaust from this product contains chemicals known to the State of California to cause cancer, birth defects or other reproductive harm.