

SWISHER

**INSTRUCTION
SHEET**

**MODEL NO.
10272**



IMPORTANT
Read and follow all
Safety Precautions
and Instructions
before operating this
equipment.

REV 08-086

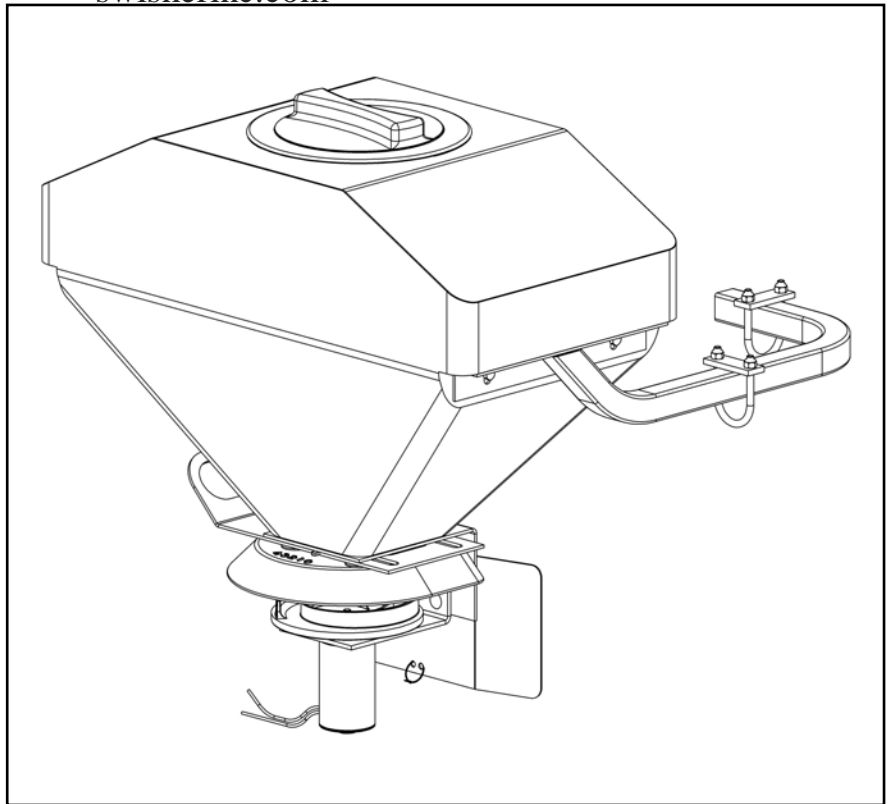

ATV SPREADER

**Assembly
Replacement Parts**

SWISHER

1602 CORPORATE DRIVE, P.O. BOX 67, WARRENSBURG, MISSOURI 64093
PHONE 660-747-8183 FAX 660-747-8650

Manufacturing quality lawn care equipment since 1945

Made In The

USA

Item Number	Part Number	Description
1	10113	Deflector - Spreader
2	NB505	5/16-18 x 1 1/2 HCC GR5
3	NB556	5/16 USS Flat Washer
4	NB579	5/16 x 1 1/4" OD Fender Washer
5	7825Z	Lift Bar Bushing
6	10051	Gate Spring
7	NB555	1/2" USS Flat Washer ZP
8	10112TK	Hopper Gate
9	10111TK	Motor Support Bracket - Upper
10	10110	Tank - Spreader
11	NB181	5/16-18 Nyloc Nut
24	10192	5/16" Nylon Retainer Washer

Step 1:
Assemble the components as shown.
Use the Nylon Retainer Washer (24)
to hold the parts together.

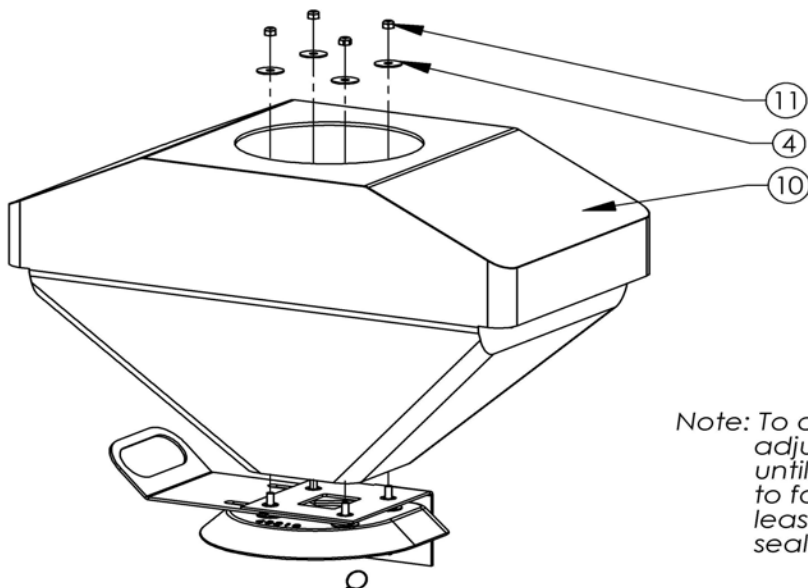
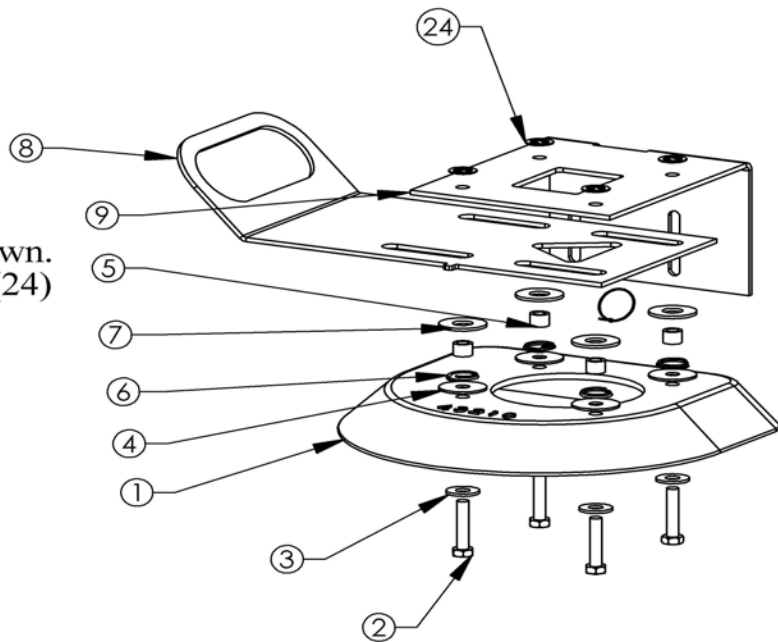

Step 2:

Attach the assembly made in step one to the tank (10) by sliding the bolts (2) up through the tank and placing a fender washer (4) over each bolt. Thread a nut (11) over each bolt and tighten securely.

Note: To change the amount of material being spread, adjust the hopper gate by pulling on the handle until the desired flow is attained. A scale of one to four has been provided with one being the least amount, and four being the most. Zero will seal the material from being distributed.

Item Number	Part Number	Description
9	10111TK	Motor Support Bracket - Upper
12	10114TK	Motor Support Bracket - Lower
13	10197	5/16-18 x 1 Carriage Bolt
14	10117TK	Spreader Shield
15	3844	T-Knob; 5/16-18
16	15118	12 Volt Spreader Motor
17	10118	Spinner/Distributor - Spreader

Step 3:

Remove the nuts and snap ring from the motor and place the Lower Motor Support Bracket (12) over the motor. Thread the nuts onto the motor studs and tighten. Slide the Spinner/Distributor (17) over the motor shaft and replace the roll pin.

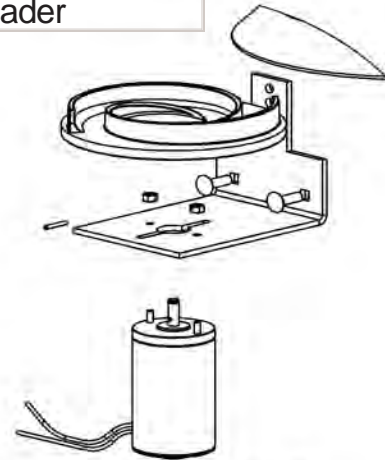

DETAIL B
SCALE 1 : 5

Step 4:

Insert the 5/16" Carriage Bolts (13) into the Lower Motor Bracket (12), through the Upper Motor Bracket (9), and through the Spreader Shield (14). Place the T-Knobs (15) on the bolts (13) and tighten. (The guide on the Lower Bracket will slide up through the slot in the Upper Bracket).

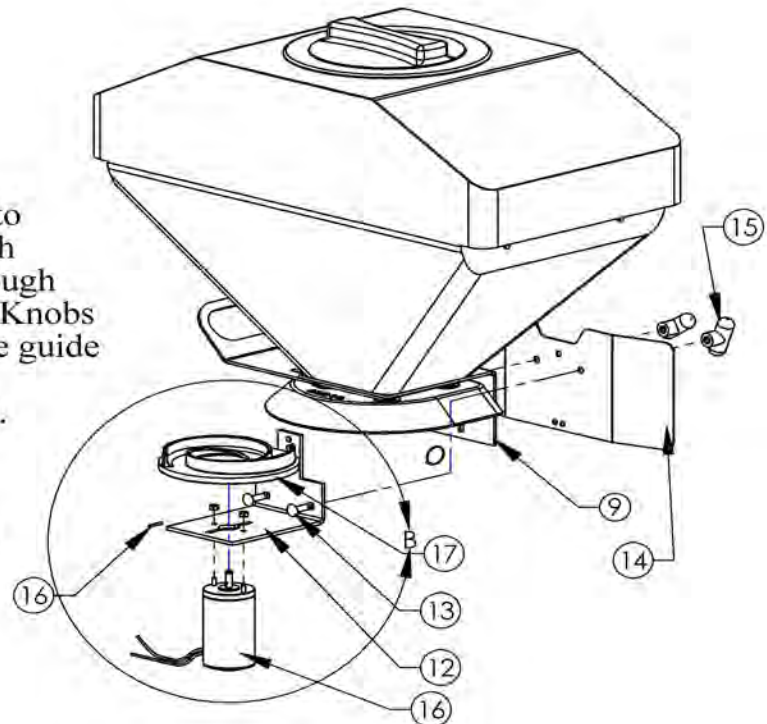

Note: To change the radius of material being spread, simply loosen the T-Knobs and slide the mechanism up (smaller radii) or down (larger radii).

Item Number	Part Number	Description
3	NB556	5/16 USS Flat Washer
11	NB181	5/16-18 Nyloc Nut
18	10107TK	Tank Support Tube Weldment - Right
19	10106TK	Tank Support Tube Weldment - Left
20	NB501	5/16-18 x 1 HCC GR5 ZP
26	AS021	Cable Tie - Black 5 1/2"

Step 5:

Attach the Support Tube Weldments (18 & 19) to the tank by inserting the bolts (20) through the Weldment, and into the holes on the side of the tank as shown. Place a washer (3) over each bolt on the inside of the tank and thread the nuts (11) onto the bolts and tighten securely.

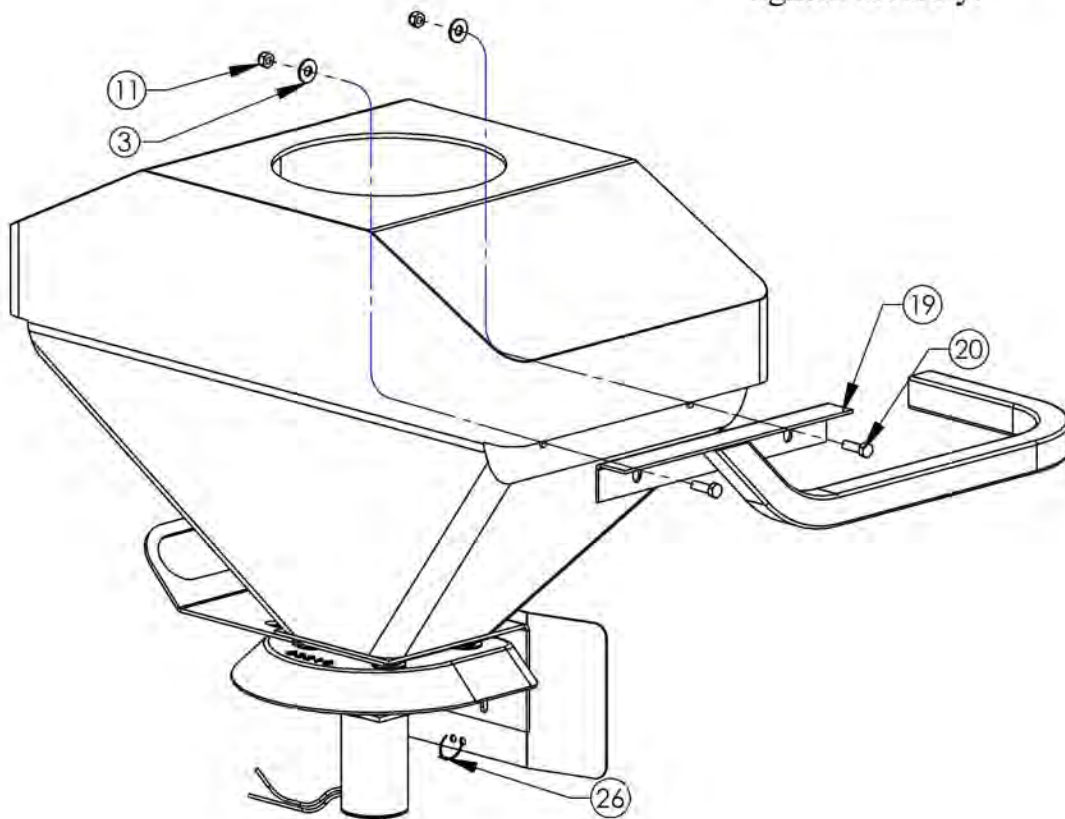

Item Number	Part Number	Description
11	NB181	5/16-18 Nyloc Nut
22	10109	5/16 x 1 3/8" x 3 11/16" U-Bolt
25		Existing Rack on Bike

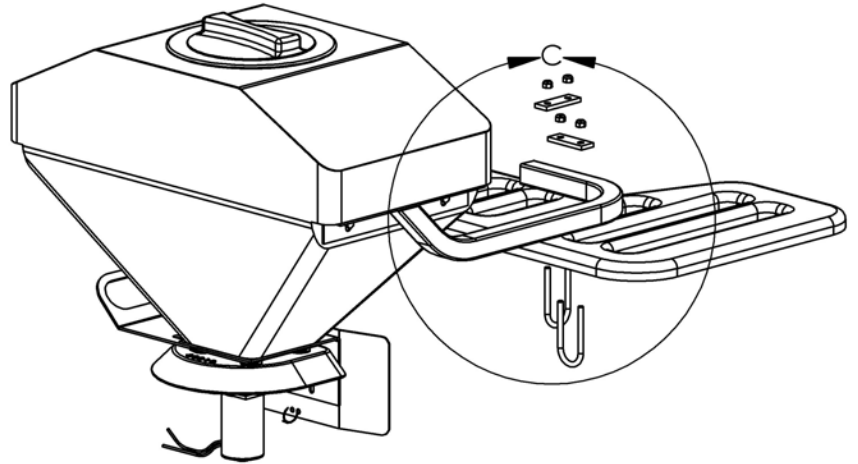

Step 6

Position the Spreader Support Tubes so that they line up with the bars on your Existing ATV Rear Rack. Slide the U-Bolts (22) up through the bottom of the ATV Rack, and place U-Bolt Block over the U-Bolt onto the top of the Support tubes as shown. Thread Nuts (11) down onto U-Bolts and tighten securely.

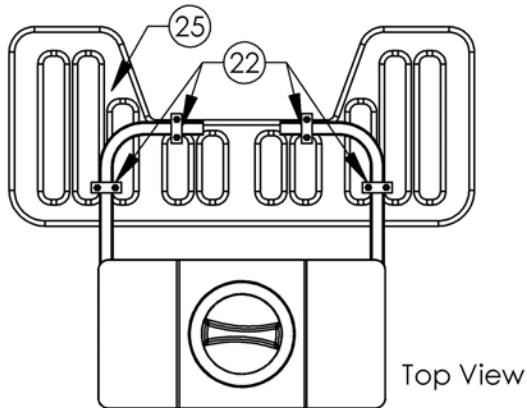
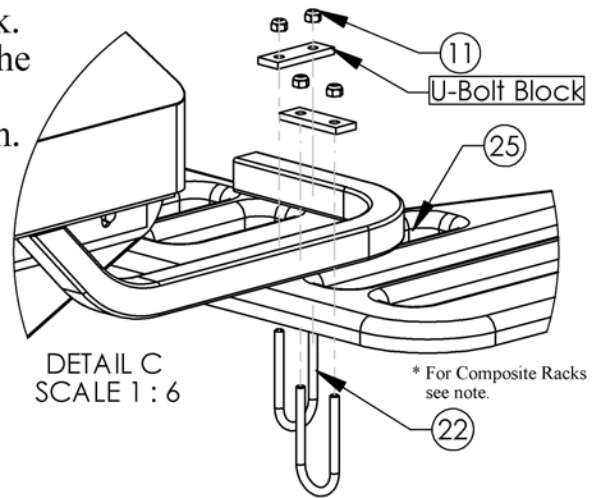

* For our customers with Composite Racks, we have provided plates that can be used underneath the rack and positioned so that the force exerted by the U-Bolts is spread out over the surface area of the rack.

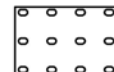

Power Hook-Up:

After assembling the Spreader, you must hook up the 12 Volt Spreader Motor. To do this you must first route the wires coming out of the male end of the 12 Volt Power Source through your ATV, and back to the rear of your ATV. (be sure to allow enough wire to be able to plug and unplug the power source from the receiver located on your ATV). Next, tie the wires from the motor through the holes located on the bottom of the Spreader Shield using the nylon tie supplied. Connect these wires to the ones coming from the 12 Volt Power Supply.*

To operate, just plug in the 12 Volt Power Supply, and begin using your SWISHER Spreader.

*Note: When hooking up the electrical, test the rotation of the motor shaft. Looking down on the motor shaft, the shaft should rotate clockwise. If the direction is counter clockwise, switch the wires coming out of the motor that plug into the 12 volt power source.

MATERIAL SPREADING CHART

(Calibrated at 4 MPH Ground Speed)

PRODUCT	Setting #1	Setting #2	Setting #3	Setting #4	SPREAD WIDTH
Fertilizer	41 lbs/Acre @ 4 mph	169 lbs/Acre @ 4 mph	NA	NA	12 ft
	20 lbs/Acre @ 8 mph	84 lbs/Acre @ 8 mph	NA	NA	
Rock Salt	NA	NA	226 lbs/Acre @4 mph	352 lbs/Acre @4 mph	12ft
	NA	NA	113 lbs/Acre @8 mph	176 lbs/Acre @ 8 mph	
Dry Sand	151 lbs/Acre @4 mph	536 lbs/Acre @4 mph	NA	NA	9ft
	75 lbs/Acre @8 mph	268 lbs/Acre @8 mph	NA	NA	
Barley	NA	56 LBS/Acre @4 mph	170 lbs/Acre @4 mph	NA	12ft
	NA	28 lbs/acre @8 mph	85 lbs/Acre @8 mph	NA	
Oats	NA	82 lbs/Acre @4 mph	288 lbs/Acre @4 mph	NA	12ft
	NA	41 lbs/Acre @ 8 mph	144 lbs/Acre @ 8 mph	NA	
Red Fescue	NA	53 lbs/Acre @4 mph	NA	NA	7ft
	NA	26 lbs/Acre @8 mph	NA	NA	

- Above Spreader Chart settings are approximate, always trial test applications rate.
- All measurements are taken with the motor spinner at the furthest setting from the deflector shield.
- Formula for calibration of other products not listed above:

$$\frac{\text{Flow Rate (lbs/min)}}{\text{Coverage (Sq-Ft/min)}} \times \frac{\text{lbs/Acre}}{43560 \text{ (sq-ft (1 acre))}}$$

Flow Rate (lbs/min): Material (lbs/min) that flows through selected hopper gate setting per minute.
(Motor and spinner removed with lower mount plate #11)

Coverage (sq-ft/min): Material spread width (Trial test required) multiplied by Distance traveled/min.
(IE 4 mph = 352 ft/min; 3 mph = 264 ft/min; 2 mph = 176 ft/min; 1 mph = 88 ft/min)

HELPFUL TIPS

- Read Owners Manual before use and be sure to follow all safety label cautions provided on the Spreader Hopper.
- Always use **ONLY CLEAN DRY MATERIAL** and be sure to remove all unused material from the hopper after each use. Damp materials will cause material flow problems and material freezing problems in cold temperatures.
- Be sure material is free of foreign matter such as packaging etc.
- Some materials may jam the hopper gate at lower settings so it may be necessary to use a larger setting and increase your MPH to compensate for the increased material flow rate. IE increasing your ground speed from 4Mph to 8Mph will decrease your application rate per acre by half if the same gate setting is used at both speeds.
- Light seed such as Kentucky Blue Grass can be mixed with a seed such as clover to aid in material flow at a 50/50 mix.
- Increased material density per acre can be achieved by adjusting the motor spinner closer to the deflector shield and hopper gate. This accomplishes a narrower spread width providing more pounds/square foot of material.
- Be sure not to attempt spreading light seeds in windy conditions; as poor coverage will result.
- Proper material coverage is achieved with the greatest satisfaction by covering the desired area twice at half the recommended application rate indicated by the manufacturer of the material. Once by traveling length ways then by subsequently by traveling cross ways to account for any underlap issues. The adjustment of the application rate can be made by either adjusting the hopper gate to a lesser setting; or increasing the ground speed of the application vehicle.
- When using the spreader for salt/icemelters/fertilizer or other corrosive materials it is imperative that the spreader is thoroughly cleaned to prevent corrosion causing premature failure of the product.



MANUFACTURING QUALITY LAWN CARE EQUIPMENT SINCE 1945

Owner's Manual

Model Numbers

***ATV
Spreader
10272***



***IMPORTANT
Read and follow all
Safety Precautions
and Instructions
Before Operating this
Equipment.***

ATV ACCESSORIES

***WHEN ORDERING PARTS, PLEASE HAVE THE
FOLLOWING INFORMATION AVAILABLE:***

- * PRODUCT - _____***
- * SERIAL NUMBER - _____***
- * MODEL NUMBER - _____***
- TYPE - _____***
- * PART NUMBER WITH PAINT CODE***
- * PART DESCRIPTION***

TELEPHONE - 1-800-222-8183

FAX - 1-660-747-8650

SWISHER MOWER & MACHINE CO. INC.

1602 CORPORATE DRIVE

P.O. BOX 67

WARRENSBURG, MO 64093

swisherinc.com